

^{38° 20'}
LATITUDE 38° 22' 30"

82° 32' 30"
82° 35'
LONGITUDE

*

7'5 OGIS topo location

7.5' loc	<u>1.80</u>	15' loc	<u>4.685</u>
	<u>1.54</u>	(calc.)	<u>3.80W</u>

Company _____

Farm _____

Quad Bornaugh Ceredo EC

County Wayne

District Ceredo

WELL LOCATION MAP

File No. Way-22

Ceredo C.M.V. Quadrangle

Wayne 22

UNITED FUEL GAS COMPANY

OUTSIDE LOCATIONS

Location by Wayne Co. Field Ohio Ky Gas Corp (Ohio South) Well No. F6751
P. J. Staley Farm, on waters of Duck Cr of Big Sandy R.
 Map Square 10-59
Ceredo District, Wayne County, West Virginia
 Scale 1/62500 Made Ceredo, 192

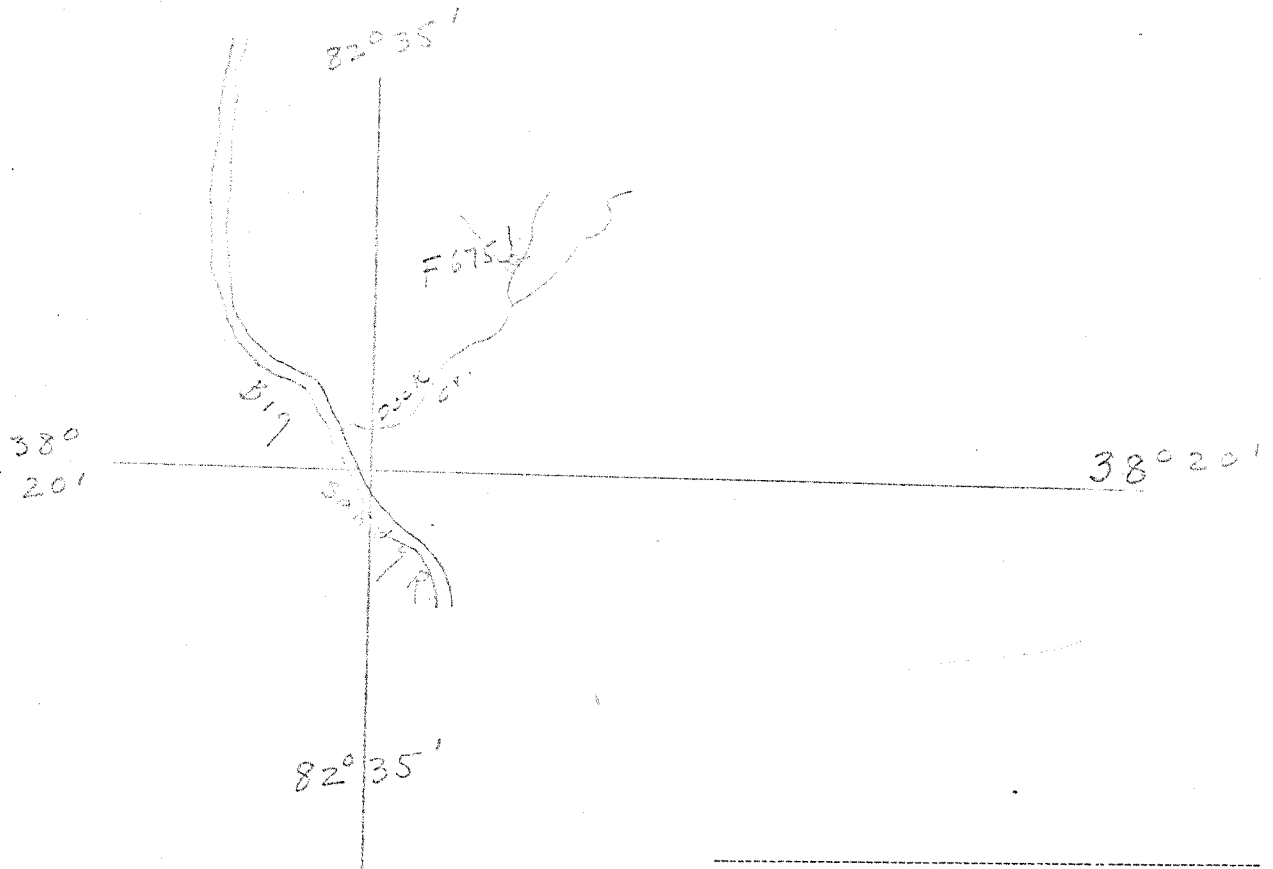

No. _____

cep Well

Ceredo District, Wayne County, W. Va.
 Ohio Kentucky Gas Co., Charleston, W. Va. (401 Union Bldg.)
 On 300 acres, on Docks Creek; surface owned by Perry J. Staley,
 RR. F.D., Kenova, W. Va.
 Drilled under permit Way-22, issued Nov. 28, 1930.
 Elevation, 601.0' L.
 13 1/2" conductor, 22'; 10" casing, 1117'; 8 1/4", 1947'.
 No coal encountered.
 Completion reported to Dept. of Mines Dec. 8, 1930.
 Well was shot at 2241 and 2795'.
 Fresh water at 70'.
 Dry hole.

	Top.	Bottom.
Soil	0	15
Sand	15	22
Red rock	22	35
Slate, white	35	50
Lime, bastard	50	60
Slate, black	60	75
Sand	75	130
Slate, white	130	140
Slate, black	140	160
Sand	160	185
Slate	185	230
Sand	230	250
Slate	250	280
Sand	280	305
Slate	305	310
Sand	310	345
Slate	345	350
Sand	350	375
Slate	375	395
Sand	395	435
Slate, black	435	480
Sand	480	488
Slate	488	525
Slate, dark	525	538
Sand	538	545
Slate	545	892
Sand	892	908
Slate	908	948
Salt Sand	948	1025
Slate, dark	1025	1080
Shells, sandy	1080	1112
Slate or shale	1112	1116
Big Lime	1116	1195
Slate, green	1195	1200
Big Injun Sand	1200	1345
Slate and shells	1345	1659
Waverly Shale	1659	1837
Coffee Shale	1837	1847
Berea Sand	1847	1876
Slate	1876	1883
Sandy lime	1883	1888
Slate	1888	1896
Lime, gritty	1896	1913
Slate	1913	1928
Shells, lime	1928	1945

P. J. STALEY NO. 94 WELL. (Continued).

	Top.	Bottom.
Shale, brown	1945	- 2025
Slate, white	2025	- 2135
Shale, brown	2135	- 2505
Slate, white	2505	- 2540
Shale, brown	2540	- 2600
Slate, white	2600	- 2745
Shale, light-brown	2745	- 2795
<i>dark</i> Sand, Corniferous	2795	- 2981
<i>dark</i> Black and white	2981	- 3100
<i>dark</i> Lime, brown	3100	- 3215
<i>dark</i> Shale, dark-brown	3215	- 3250
<i>dark</i> Lime, black	3250	- 3400
<i>dark</i> White sandy lime	3400	- 3425
<i>dark</i> Lime, dark, sandy	3425	- 3440
Red rock	3440	- 3585
Red rock and slate	3585	- 3615
Slate, white	3615	- 3628
Lime	3628	- 3636
Red rock	3636	- 3692
Niagara? Lime	3692	- 3712
Lime shells, green	3712	- 3740
Red Medina	3740	- 3776
Shale, light	3776	- 3786
<i>dark</i> White Medina, to bottom	3786	- 3805

3786

3,125

WAY-22

COMPLETION DATA SHEET
NO. 2
FORMATION RECORD

Ohio Kentucky Gas Company
401 Union Building Address
Charleston, W. Va.

Name	Color	Character	Oil, Gas or Water	Top	Bottom	Thickness	Total Depth	Remarks
Shale	Brown			21 35	25 05			
Slate	White			25 05	25 40			
Shale	Brown			25 40	26 00			
Slate	White			26 00	27 45			
Shale	Light Brown			27 45	27 95			
Sand		Corniferous		27 95	29 81			
Black & white				29 81	31 00			
Lime	Brown			31 00	32 15			
Shale	Dark Brown			32 15	32 50			
Lime	Black			32 50	34 00			
White Sandy Lime				34 00	34 25			
Lime	Dark Sandy			34 25	34 40			
Rock	Red			34 40	35 85			
Rock & Slate	Red			35 85	36 15			
Slate	White			36 15	36 28			
Lime				36 28	36 36			
Rock	Red			36 36	36 92			
Lime		Niagra		36 92	37 12			
Shells				37 12	37 40			
Lime Shells	Green			37 40	37 76			
Nodina	Red			37 76	37 86			
Shale	Light			37 86	38 05			
Nodina	White			38 05				
					3805	Total Depth		

Well was not shot at feet; well was shot at feet.

Salt Fresh water at feet; salt fresh water at feet.

Well was producing hole. dry

Date Approved Ohio Kentucky Gas Company Owner

NOTE: All bottom formations must be noted as indicated above and all key-rocks and oil and gas sands must be recorded under their proper geological names in the district as well as any local names commonly used in the district for such strata.