

Latitude 38° 15'

Longitude 82° 25'

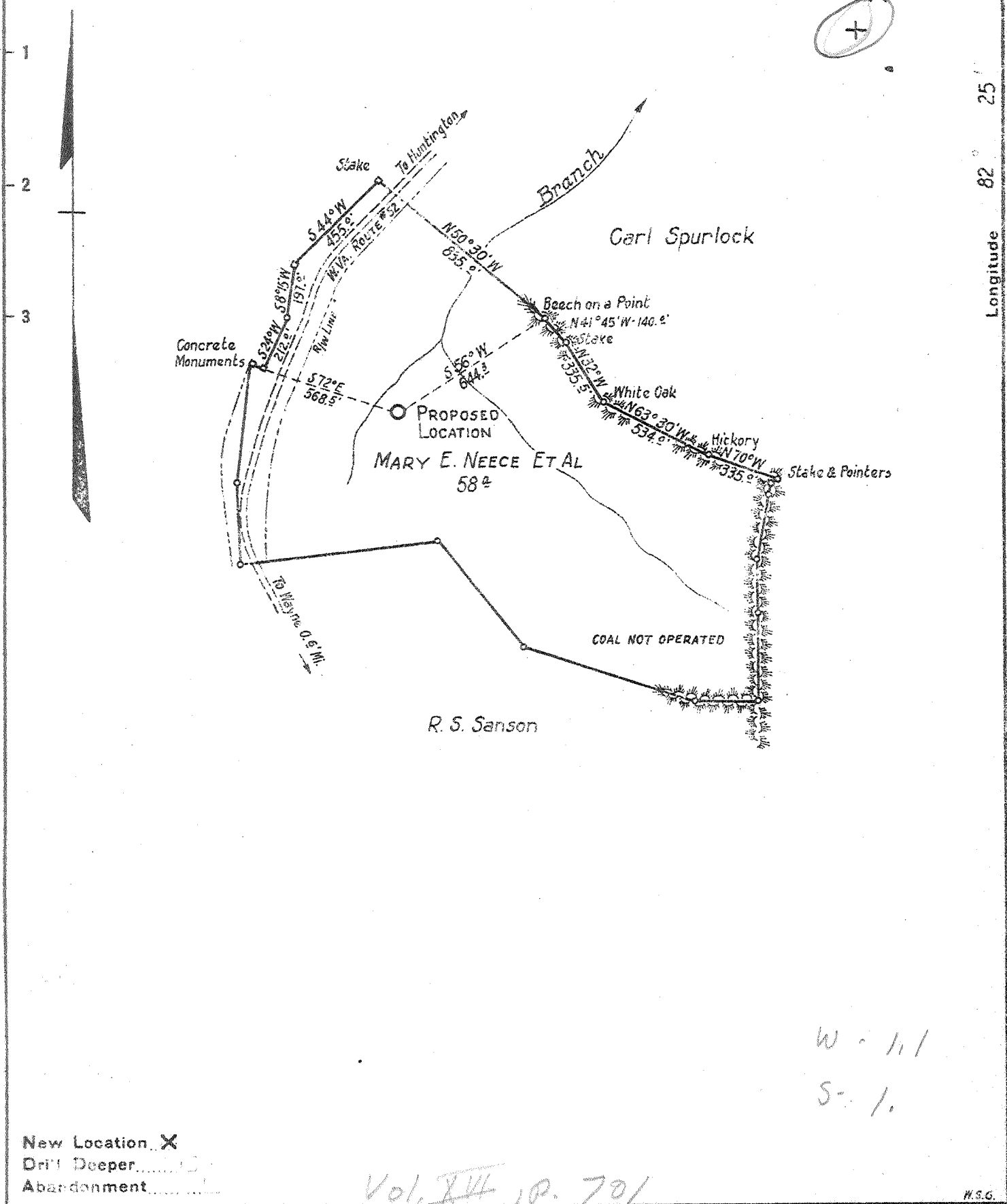

New Location X
 Drill Deeper
 Abandonment

Vol. IV p. 701

M.S.G.

Company	WEST VIRGINIA GAS CORPORATION		
Address	401 UNION BLDG., CHARLESTON, W. VA.		
Farm	MARY E. NEECE ET AL		
Tract	Acres	58	Lease No. WV 549
Well (Farm) No.	ONE	Serial No.	C 71
Elevation (Spirit Level)	679.25		
Quadrangle	WAYNE N.W. NW		
County	WAYNE	District	UNION
Engineer	L. B. DORSEY		
Engineer's Registration No.	402		
File No.	3	Drawing No.	WO 358
Date	Nov. 29, 1940.		
Scale:	1 INCH = 600 FEET		

STATE OF WEST VIRGINIA
 DEPARTMENT OF MINES
 OIL AND GAS DIVISION
 CHARLESTON

WELL LOCATION MAP
 FILE NO. WAY-226

+ Denotes location of well on United States Topographic Maps, scale 1 to 62,500, latitude and longitude lines being represented by border lines as shown.
 - Denotes one inch spaces on border line of original tracing.

W. 111
 S. 1.

Deep Well

WEST VIRGINIA DEPARTMENT OF MINES
OIL & GAS DIVISION
W E L L R E C O R D

Permit No. Wayne-226
Wayne Quad.

Gas Well

Company West Virginia Gas Corp.,
Address Box 404, Charleston, W. Va.
Farm Mary E. Neece, et al ACRES 58
Location Branch of Twelvepole Creek
Well No. 1 - Serial C-71 ELEV. 679.05
District Union - Wayne County
Surface & Mineral Mary A. Neece, et al
Address 2952 Chase St., Huntington, W. Va.
Commenced Dec. 10, 1940
Completed Jan. 20, 1941
Shot 1/21/41 - depth 2547-3141
Volume 166,840 c.f. 1 hr. after shot
Rock Pressure 635 lbs. 72 hrs.
Fresh Water 864, 882, 890-900

CASING & TUBING

10	5-8	
8-1/4	376	pulled
7	1516-6	
Not cemented		
Coal at 246'	12"	
420'	24"	

Surface	0	6
Slate	6	50
Broken	50	108
Slate	108	130
Broken	130	208
Slate	208	240
Broken	240	246
Coal	246	247
Slate	247	259
Sand	259	300
Broken Sand	300	340
Sand	340	370
Slate	370	386
Sand	386	405
Slate	405	415
Sand	415	420
Coal	420	422
Slate	422	430
Broken Sand	430	475
Slate	475	483
Sand	483	526
Slate	526	636
Sand	636	663
Slate&Sand	663	718
Sand	718	730
Broken	730	745
Dark Shale	745	782
Salt Sand	782	850
Slate	850	855
Salt Sand	855	975
Slate	975	980
Salt Sand	980	1037
Gritty Lime	1037	1110
Slate	1110	1116
Hard Lime	1116	1124
Slate	1124	1135
Red Rock	1135	1138
Slate	1138	1141
Gritty Lime	1141	1178
Little Lime	1178	1189
Pencil Cave	1189	1191
Big Lime	1191	1357
Black Lime	1357	1367
Big Injun	1367	1495
Dark Sand	1495	1533
Dard Sandy Lime	1533	1547
Black Slate	1547	1575
Slate & Shells	1575	1875
Hard Shells	1875	1960
Coffee Shale	1960	1988
Berea Grit	1988	1997

Black Gritty Lime	1997	2010
Berea Sand	2010	2037
Slate & Shells	2037	2044
Hard Shell	2044	2056
Gritty Lime	2050	2068
Slate&Sholls	2068	2110
Brown Shale	2110	2175
Broken Shale	2175	2229
White Slate, sholly	2229	2370
Broken Shale	2370	2413
Brown Shale	2413	2503
Light Shale	2508	2552
Brown Shale	2552	2665
Light Shale	2655	2684
Brown Shale	2684	2758
Light Shale	2758	2763
Brown Shale	2763	2878
Light Shale	2878	3075
Dark Shale	3075	3098
Brown Shale	3098	3140
Corniferous Lime	3140	3141
Total Depth		3141

Water 864 - enough to drill with;
882 - 5 bailers;
890 to 900 - hole full

Show oil 1412½ to 1421
Show gas 1485 to 1495; 2150; 2455; 2750 to 2765

Gas Pay - 2625 to 2640

Shot 1/21/41 from 2547 to 3141 with
4200# Gelatin.

Test: 1 hr. A.S. 166,840 c.f.
3 " " 116,448 c.f.
19 " " 94,030 c.f.

72 hr. R.P. 635#

3140
679
-2461

1367
679
658

875
679
196

950
679
300