



STATE OF WEST VIRGINIA
DEPARTMENT OF MINES
OIL AND GAS DIVISION

NOTICE OF PROPOSED LOCATION OF OIL AND GAS WELL

To THE DEPARTMENT OF MINES,
Charleston, W. Va.

Mrs. Emily F. Mathewson
COAL OPERATOR OR COAL OWNER

630 Bergen Ave., Jersey City, N. J.
ADDRESS

COAL OPERATOR OR COAL OWNER

ADDRESS

OWNER OF MINERAL RIGHTS

ADDRESS

OWENS, LIBBEY-OWENS GAS DEPARTMENT
NAME OF WELL OPERATOR

P. O. Box 4158, Charleston 4, W. Va.
COMPLETE ADDRESS

June 4, 19 54

PROPOSED LOCATION

Grant District

Wayne County

Well No. 13 (Serial No. 911) 38° 05'
82° 15'

F. E. Mathewson Farm

GENTLEMEN:

The undersigned well operator is entitled to drill upon the above named farm or tract of land for oil and gas, having fee title thereto, (or as the case may be) under grant or lease dated March 10, 1927, made by Frank E. Mathewson & Wife, to The Owens Bottle Co. & Libbey-Owens Sheet Glass Co., and recorded on the 14th day of September, 1927, in the office of the County Clerk for said County in Book 10, page 185.

The enclosed plat was prepared by a competent engineer and shows the proposed location of a well to be drilled for oil and gas by the undersigned well operator on the farm and in the Magisterial District and County above named, determined by survey and courses and distances from two permanent points, or land marks.

The undersigned well operator is informed and believes there are no coal operators operating beds of coal beneath said farm or tract of land on which said well is located, or within 500 feet of the boundaries of the same, who have mapped their workings and filed their maps as required by law, excepting the coal operators or coal owners (if any) above named as addressees.

The above named coal operators or coal owners (if any) are notified that any objections they may desire to make to such proposed location, or which they are required to make by Section 3 of said Code, if the drilling of a well at said proposed location will cause a dangerous condition in or about their respective coal mines, must be received by, or filed with the Department of Mines within ten* days from the receipt of a copy of this notice and accompanying plat by said Department. Said coal operators are further notified that forms for use in making such objections will be furnished to them by the Department of Mines promptly on request and that all such objections must set forth as definitely as is reasonably possible the ground or grounds on which such objections are based and indicate the direction and distance the proposed location should be moved to overcome same.

(The next paragraph is to be completed only in Department's copy.)

Copies of this notice and the enclosed plat were mailed by registered mail, or delivered to the above named coal operators or coal owners at their above shown respective address this day 1954, ~~or~~ on the same day with the mailing or delivery of this copy to the Department of Mines at Charleston, West Virginia.

Very truly yours,

OWENS, LIBBEY-OWENS GAS DEPARTMENT
WELL OPERATOR

P. O. Box 4158
STREET

Charleston 4,
CITY OR TOWN

West Virginia
STATE

Address of Well Operator }

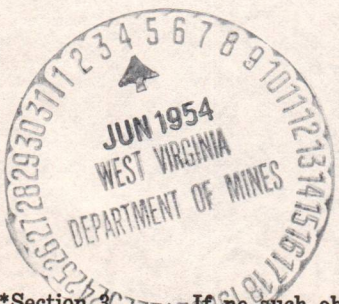

02/09/2024

*Section 3. If no such objections be filed or be found by the department of mines, within said period of ten days from the receipt of said notice and plat by the department of mines, to said proposed location, the department shall forthwith issue to the well operator a drilling permit reciting the filing of such plat, that no objections have been made by the coal operators to the location, or found thereto by the department, and that the same is approved and the well operator authorized to proceed to drill at said location.



STATE OF WEST VIRGINIA
DEPARTMENT OF MINES
OIL AND GAS DIVISION

NOTICE OF PROPOSED LOCATION OF OIL AND GAS WELL

To the Department of Mines
Charleston, W. Va.

NAME OF WELL OPERATOR: OWENS, LIBBEY-OWENS GAS TREATMENT

NAME OF COAL OWNER: Mrs. Emily E. Stephenson

COMPLETE ADDRESS: P. O. Box 1158, Charleston, W. Va.

ADDRESS: 630 Batten Ave., Jersey City, N. J.

PROPOSED LOCATION: Grant

COUNTY: Wayne

Well No. 13 (Serial No. 211)

OWNER OF MINERAL RIGHTS: F. E. Stephenson

ADDRESS: _____

The undersigned well operator is entitled to drill upon the above named farm or tract of land for oil and gas, having for this purpose (or as the case may be) under grant or lease dated March 10, 1927 to Frank T. Stephenson & Wife and recorded on the 15th day of September, 1927 in the office of the County Clerk for said County in Book 10, page 185

The enclosed plat was prepared by a competent engineer and shows the proposed location of a well to be drilled for oil and gas by the undersigned well operator on the farm and in the Mineral District and County above named, determined by survey and courses and distances from two permanent points on land owned by the Owens Bottle Co. & Libbey-Owens Sheet Glass Co.

The undersigned well operator is informed and believes there are no coal operators operating beds of coal beneath said farm or tract of land on which said well is located, or within 500 feet of the bounds of the same, who have mapped their workings and filed their maps as required by law, excepting the coal operators or coal owners (if any) above named as addressees.

The above named coal operators or coal owners (if any) are notified that any objections they may desire to make to such proposed location, or which they are required to make by Section 3 of said Code if the drilling of a well at said proposed location will cause a dangerous condition in or about their respective coal mines, must be received by or filed with the Department of Mines within ten days from the receipt of a copy of this notice and accompanying plat by said Department. Said coal operators are further notified that forms for use in making such objections will be furnished to them by the Department of Mines promptly on request and that all such objections must set forth as definitely as is reasonably possible the ground or grounds on which such objections are based and indicate the direction and distance the proposed location should be moved to overcome same.

(The next paragraph is to be completed only in Department's copy.)
Copies of this notice and the enclosed plat were mailed by registered mail or delivered to the above named coal operators or coal owners at their above shown respective addresses this day 1927 at Charleston in the County of Wayne, West Virginia.

Very truly yours,

OWENS, LIBBEY-OWENS GAS TREATMENT

WELL OPERATOR

P. O. Box 1158

STREET

Charleston, W. Va.

CITY OR TOWN

West Virginia

STATE

Address of Well Operator



02/09/2024

Section 3 of said Code provides that if no objections be filed or be found by the Department of Mines within said period of ten days from the receipt of said notice and plat by the Department of Mines, the location of said proposed location shall be deemed to have been approved and the well operator shall forthwith cause the well operator a written permit recording the date of such plat, that no objections have been made by the coal operators to the location or found thereon by the Department of Mines, and that the same is approved and the well operator authorized to proceed to drill at said location.

B I L L O F S A L E

INDUSTRIAL GAS CORPORATION, a Delaware corporation, (hereinafter called "Seller") in consideration of the sum of Forty Seven Hundred Dollars (\$4,700.00) and other good and valuable consideration, paid to Seller by A. C. "BUS" WILHELM, a drilling contractor, whose address is P. O. Box 99, Hamlin, West Virginia 25523, (hereinafter called "Purchaser"), the receipt of which consideration is hereby acknowledged, does hereby GRANT, BARGAIN, SELL, TRANSFER, and SET OVER unto the Purchaser, his heirs and assigns, the following personal property, to-wit:

Oil well equipment on the S. E. Mathewson #13 well owned by Industrial Gas Corporation, situated and located in Wayne County, West Virginia, consisting of all pipe, material casing or tubing, and including surface equipment, which has heretofore been delivered by Seller to Purchaser, to have and to hold the above described equipment to the Purchaser, his heirs and assigns, to his and their own use and behalf forever.

Industrial Gas Corporation does hereby SAVE AND EXCEPT AND RESERVE UNTO ITSELF the surface equipment, tubing, and sucker rods and A. C. Wilhelm, Purchaser, does hereby agree to pull and plug the well and retain all other material as described hereinabove. It is specifically a part of the consideration to this transaction that the rights received by Purchaser includes the obligation of the Purchaser to plug and abandon the well in accordance with the specifications and requirements of the Oil and Gas Division of the Department of Mines for the State of West Virginia.

Purchaser accepts the above described property in its present condition and Seller makes no representation of warranty, either express or implied, as to its fitness, operational ability for use, reasonable use intended, condition or otherwise.

IN WITNESS WHEREOF, the Seller has caused this instrument to be signed in its behalf, in its name by its President or one of its Vice Presidents, this the 12th day of July, 1974.

INDUSTRIAL GAS CORPORATION

By Henry Gruver
President *hd end*

STATE OF WEST VIRGINIA

COUNTY OF

I, Frances V. Stamper, a Notary Public in and for said county, do certify that Henry Gruver, who signed the writing hereto annexed as President for INDUSTRIAL GAS CORPORATION, a Delaware corporation, bearing date the 12th day of July, 1974, has this day in my said county, before me, acknowledged the said writing to be the act and deed of said corporation.

02/09/2024

Given under my hand and seal this 12th day of July, 1974.

My commission expires August 3, 1977

This instrument prepared by
William W. Hensley, Attorney
P. O. Box 1473
Charleston, West Virginia 25325

Frances V. Stamper
Notary Public

OIL & GAS DIVISION
DEPT. OF MINES

OCT 4 1974

RECEIVED

02/09/2024

B I L L O F S A L E

INDUSTRIAL GAS CORPORATION, a Delaware corporation, (hereinafter called "Seller") in consideration of the sum of Forty Seven Hundred Dollars (\$4,700.00) and other good and valuable consideration, paid to Seller by A. C. "BUS" WILHELM, a drilling contractor, whose address is P. O. Box 99, Hamlin, West Virginia 25523, (hereinafter called "Purchaser"), the receipt of which consideration is hereby acknowledged, does hereby GRANT, BARGAIN, SELL, TRANSFER, and SET OVER unto the Purchaser, his heirs and assigns, the following personal property, to-wit:

Oil well equipment on the S. E. Mathewson #13 well owned by Industrial Gas Corporation, situated and located in Wayne County, West Virginia, consisting of all pipe, material casing or tubing, and including surface equipment, which has heretofore been delivered by Seller to Purchaser, to have and to hold the above described equipment to the Purchaser, his heirs and assigns, to his and their own use and behalf forever.

Industrial Gas Corporation does hereby SAVE AND EXCEPT AND RESERVE UNTO ITSELF the surface equipment, tubing, and sucker rods and A. C. Wilhelm, Purchaser, does hereby agree to pull and plug the well and retain all other material as described hereinabove. It is specifically a part of the consideration to this transaction that the rights received by Purchaser includes the obligation of the Purchaser to plug and abandon the well in accordance with the specifications and requirements of the Oil and Gas Division of the Department of Mines for the State of West Virginia.

Purchaser accepts the above described property in its present condition and Seller makes no representation of warranty, either express or implied, as to its fitness, operational ability for use, reasonable use intended, condition or otherwise.

IN WITNESS WHEREOF, the Seller has caused this instrument to be signed in its behalf, in its name by its President or one of its Vice Presidents, this the 12th day of July, 1974.

INDUSTRIAL GAS CORPORATION

By *Henry Gruver*
President *hd and*

STATE OF WEST VIRGINIA
COUNTY OF

I, Frances V. Stamper, a Notary Public in and for said county, do certify that Henry Gruver, who signed the writing hereto annexed as President for INDUSTRIAL GAS CORPORATION, a Delaware corporation, bearing date the 12th day of July, 1974, has this day in my said county, before me, acknowledged the said writing to be the act and deed of said corporation.

02/09/2024

Given under my hand and seal this 12th day of July, 1974.

My commission expires August 3, 1977

This instrument prepared by
William W. Hensley, Attorney
P. O. Box 1473
Charleston, West Virginia 25325

Frances V. Stamper
Notary Public

02/09/2024

RECEIVED

OCT 8 1974

OIL & GAS DIVISION
DEPT. OF MINES

Formation	Color	Hard or Soft	Top	Bottom	Oil, Gas or Water	Depth Found	Remarks
Sl. & Shells	Grey	Soft	993	1001			
Sand	Light	Med.	1001	1029			
Sl. & Shells	Dark	Med.	1029	1071			
Shells	Black	Soft	1071	1080			
Sand	Light	Hard	1080	1134			
Sand	White	Soft	1134	1152			
Sl. & Shells	Dark	Soft	1152	1163			
Slate	Dark	Soft	1163	1168			
Sl. & Shells	White	Med.	1168	1184			
Maxton Sand	White	Soft	1184	1212			
Maxton Sand	White	Hard	1212	1236			
Maxton Sand	White	Soft	1236	1263			
Maxton Sand	White	Med.	1263	1282			
Maxton Sand	White	Hard	1282	1303			
Break	White	Soft	1303	1306			
Big Lime	White	Hard	1306	1400	SLM 1310 = Sand LM 1310'		
Big Lime	Sandy White	Hard	1400	1421	Gas, 1421, 5/10 W 1/8" = 2 M		
Big Lime	White	Hard	1421	1464	SLM 1421 = Sand 1422.		
					Ran 7" casing at 1428.		
					SLM 1429 = Sand LM 1429.		
					Dried up hole 7-22-54.		
					Test 1 qt. Salty Water at 1435 in 24 hours.		
					SLM 1464 = Sand LM 1464.		
Big Lime	Grey	Hard	1464	1495			
Injun Sand	Red	Med.	1495	1521			
Injun Sand	Grey	Med.	1521	1562	Gas, 1468', 15/10 W 3/8" =		4.2 M
Slate	Dark	Soft	1562	1580			
Shell	Grey	Hard	1580	1582			
Shell	Dark	Hard	1582	1587			
Sl. & Shells	Dark	Med.	1587	1612	Test 1597', 13/10 W 3/8" =		3.9 M
Shell	Grey	Hard	1612	1630	Gas ? 1620', 18/10 W 3/8" =		4.6 M
Slate	Light	Med.	1630	1650			
Sl. & Shells	Light	Soft	1650	1684			
Slate	Light	Soft	1684	1851	Test 1749', 16/10 W 3/8" =		4.4 M
Sl. & Shells	Light	Soft	1851	1859	Gas ? 1779', 22/10 W 3/8" =		5.1 M
Packer Shell	Dark	Hard	1859	1899	Test 1851', 16/10 W 3/8" =		4.4 M
Shell	White	Hard	1899	1909	Gas ? 1874', 22/10 W 3/8" =		5.1 M
Sl. & Shells	White	Soft	1909	1935			
Slate	White	Soft	1935	1997			
Shell	Light	Med.	1997	2017			
Slate	Light	Med.	2017	2049			
Slate	White	Soft	2049	2059			
Shale	Brown	Soft	2059	2076	Test 2075', 14/10 W 3/8" =		4.1 M
Berea	Light	Hard	2076	2114	Gas ? 2081', 20/10 W 3/8" =		4.9 M
Shells	Grey	Med.	2114	2119			
Slate	Light	Soft	2119	2132			
Sl. & Shells	Light	Med.	2132	2142			
Shell	Light	Hard	2142	2156			
Shale	Brown	Soft	2156	2199			
Slate	Light	Soft	2199	2210			
Sl. & Shells	Light	Med.	2210	2242			
Slate	Light	Med.	2242	2314			
Sl. & Shells	Light	Soft	2314	2350			
Slate	Light	Soft	2350	2393			
Sl. & Shells	Light	Soft	2393	2426			
Slate	Light	Soft	2426	2461	Test 15 gal. water in 48 hours at 2456'		
Shell	Grey	Hard	2461	2464			
Slate	Light	Soft	2464	2483			
Sl. & Shells	White	Soft	2483	2513			
Slate	Light	Soft	2513	2565			
Br. Shale	Brown	Soft	2565	2587			
Slate	Light	Soft	2587	2805			
Br. Shale	Brown	Soft	2805	2892	Test 2707', 16/10 W 3/8" =		4.4 M

02/09/2024

Date February 7, 19 55

APPROVED OWENS, LIBBEY-OWENS GAS DEPARTMENT, Owner

By *[Signature]*
(Title) Geologist



STATE OF WEST VIRGINIA
DEPARTMENT OF MINES
OIL AND GAS DIVISION

WELL RECORD

OIL
Oil or Gas Well (kind)

Permit No. MAY-924

02/00/24

OWENS, LIBBEY-OWENS GAS DEPARTMENT

Company P. O. Box 4158, Charleston 4, W. Va.

Address Frank E. Mathewson Acres 861

Location (waters) Well No. 13 (Serial #911) Elev. 705.91

District Grant County Wayne

The surface of tract is owned in fee by

Address 630 Bergen Ave., Jersey City, N.J.

Mineral rights are owned by Emily F. Mathewson

Address 630 Bergen Ave., Jersey City, N.J.

Drilling commenced 6-23-54

Drilling completed 8-25-54

Date Shot 10-13-54 From 2250 To 2760

With 4466-2/3# gelatin

Open flow /10ths Water in Inch

Volume /10ths Merc. in Inch

Rock Pressure lbs. hrs. Est. 10

Oil 45, 409

Fresh water 801, 883, 888

Salt water

Casing and Tubing Used in Drilling Left in Well Packers

Size 16 13 10

Kind of Packer

Size of 8 1/2-5/8 1561.3 1428.1

Depth set Pulled 2977 2952.6

Perf. top 2952.6

Perf. bottom

Liners Used 2

Perf. top

Perf. bottom

CASING CEMENTED SIZE No. Ft. Date

COAL WAS ENCOUNTERED AT FEET INCHES

FEET INCHES

FEET INCHES

FEET INCHES

FEET INCHES

FEET INCHES

FEET INCHES

FEET INCHES

FEET INCHES

FEET INCHES

FEET INCHES

FEET INCHES

FEET INCHES

FEET INCHES

FEET INCHES

FEET INCHES

FEET INCHES

FEET INCHES

FEET INCHES

FEET INCHES

FEET INCHES

FEET INCHES

FEET INCHES

FEET INCHES

FEET INCHES

FEET INCHES

FEET INCHES

FEET INCHES

FEET INCHES

FEET INCHES

FEET INCHES

FEET INCHES

FEET INCHES

FEET INCHES

FEET INCHES

FEET INCHES

FEET INCHES

FEET INCHES

FEET INCHES

FEET INCHES

FEET INCHES

FEET INCHES

FEET INCHES

FEET INCHES

FEET INCHES

FEET INCHES

FEET INCHES

FEET INCHES

FEET INCHES

FEET INCHES

FEET INCHES

FEET INCHES

FEET INCHES

FEET INCHES

FEET INCHES

FEET INCHES

FEET INCHES

FEET INCHES

FEET INCHES

FEET INCHES

FEET INCHES

FEET INCHES

FEET INCHES

FEET INCHES

FEET INCHES

FEET INCHES

FEET INCHES

FEET INCHES

FEET INCHES

FEET INCHES

FEET INCHES

FEET INCHES

FEET INCHES

FEET INCHES

FEET INCHES

FEET INCHES

FEET INCHES

FEET INCHES

FEET INCHES

FEET INCHES

FEET INCHES

Water, 45 - Hole full.

SIM 156 = Sand LM 152.

Ran 8-5/8" Csg. at 1561.

Water, 409, 1/3 BPH

Water, 883, 4 BPH

Water, 801, 1 1/2 BPH

Water, 888, Hole filling.

Oil, 801, show in sand pumpings.

SIM 707 = Sand LM 705.

Water, 801, show in sand pumpings.

Water, 883, 4 BPH

Water, 888, Hole filling.

Oil, 801, show in sand pumpings.

SIM 707 = Sand LM 705.

Water, 801, show in sand pumpings.

Water, 883, 4 BPH

Water, 888, Hole filling.

Oil, 801, show in sand pumpings.

SIM 707 = Sand LM 705.

Water, 801, show in sand pumpings.

Water, 883, 4 BPH

Water, 888, Hole filling.

Oil, 801, show in sand pumpings.

SIM 707 = Sand LM 705.

Water, 801, show in sand pumpings.

Water, 883, 4 BPH

Water, 888, Hole filling.

Oil, 801, show in sand pumpings.

SIM 707 = Sand LM 705.

Water, 801, show in sand pumpings.

Water, 883, 4 BPH

Water, 888, Hole filling.

Oil, 801, show in sand pumpings.

SIM 707 = Sand LM 705.

Water, 801, show in sand pumpings.

Water, 883, 4 BPH

Water, 888, Hole filling.

Oil, 801, show in sand pumpings.

SIM 707 = Sand LM 705.

Water, 801, show in sand pumpings.

Water, 883, 4 BPH

Water, 888, Hole filling.

Oil, 801, show in sand pumpings.

SIM 707 = Sand LM 705.

Water, 801, show in sand pumpings.

Water, 883, 4 BPH

Water, 888, Hole filling.

Oil, 801, show in sand pumpings.

SIM 707 = Sand LM 705.

Water, 801, show in sand pumpings.

Water, 883, 4 BPH

Water, 888, Hole filling.

Oil, 801, show in sand pumpings.

SIM 707 = Sand LM 705.

Water, 801, show in sand pumpings.

Water, 883, 4 BPH

Water, 888, Hole filling.

Oil, 801, show in sand pumpings.

SIM 707 = Sand LM 705.

Water, 801, show in sand pumpings.

Water, 883, 4 BPH

Water, 888, Hole filling.

Water, 888, Hole filling.

Oil, 801, show in sand pumpings.

SIM 707 = Sand LM 705.

Water, 801, show in sand pumpings.

Water, 883, 4 BPH

Water, 888, Hole filling.

Oil, 801, show in sand pumpings.

SIM 707 = Sand LM 705.

Water, 801, show in sand pumpings.

Water, 883, 4 BPH

Water, 888, Hole filling.

Oil, 801, show in sand pumpings.

SIM 707 = Sand LM 705.

Water, 801, show in sand pumpings.

Water, 883, 4 BPH

Water, 888, Hole filling.

Oil, 801, show in sand pumpings.

SIM 707 = Sand LM 705.

Water, 801, show in sand pumpings.

Water, 883, 4 BPH

Water, 888, Hole filling.

Oil, 801, show in sand pumpings.

SIM 707 = Sand LM 705.

Water, 801, show in sand pumpings.

Water, 883, 4 BPH

Water, 888, Hole filling.

Oil, 801, show in sand pumpings.

SIM 707 = Sand LM 705.

Water, 801, show in sand pumpings.

Water, 883, 4 BPH

Water, 888, Hole filling.

Water, 888, Hole filling.

Oil, 801, show in sand pumpings.

SIM 707 = Sand LM 705.

Water, 801, show in sand pumpings.

Water, 883, 4 BPH

Water, 888, Hole filling.

Oil, 801, show in sand pumpings.

SIM 707 = Sand LM 705.

Water, 801, show in sand pumpings.

Water, 883, 4 BPH

Water, 888, Hole filling.

Oil, 801, show in sand pumpings.

SIM 707 = Sand LM 705.

Water, 801, show in sand pumpings.

Water, 883, 4 BPH

Water, 888, Hole filling.

Oil, 801, show in sand pumpings.

SIM 707 = Sand LM 705.

Water, 801, show in sand pumpings.

Water, 883, 4 BPH

Water, 888, Hole filling.

Oil, 801, show in sand pumpings.

SIM 707 = Sand LM 705.

Water, 801, show in sand pumpings.

Water, 883, 4 BPH

Water, 888, Hole filling.

Oil, 801, show in sand pumpings.

SIM 707 = Sand LM 705.

Water, 801, show in sand pumpings.

Water, 883, 4 BPH

Water, 888, Hole filling.

Water, 888, Hole filling.

Oil, 801, show in sand pumpings.

SIM 707 = Sand LM 705.

Water, 801, show in sand pumpings.

Water, 883, 4 BPH

Water, 888, Hole filling.

Oil, 801, show in sand pumpings.

SIM 707 = Sand LM 705.

Water, 801, show in sand pumpings.

Water, 883, 4 BPH

Water, 888, Hole filling.

Oil, 801, show in sand pumpings.

SIM 707 = Sand LM 705.

Water, 801, show in sand pumpings.

Water, 883, 4 BPH

Water, 888, Hole filling.

Oil, 801, show in sand pumpings.

SIM 707 = Sand LM 705.

Water, 801, show in sand pumpings.

Water, 883, 4 BPH

Water, 888, Hole filling.

Oil, 801, show in sand pumpings.

SIM 707 = Sand LM 705.

Water, 801, show in sand pumpings.

Water, 883, 4 BPH

Water, 888, Hole filling.

Oil, 801, show in sand pumpings.

SIM 707 = Sand LM 705.

Water, 801, show in sand pumpings.

Water, 883, 4 BPH

Water, 888, Hole filling.

Water, 888, Hole filling.

Oil, 801, show in sand pumpings.

SIM 707 = Sand LM 705.

Water, 801, show in sand pumpings.

Water, 883, 4 BPH

Water, 888, Hole filling.

Oil, 801, show in sand pumpings.

SIM 707 = Sand LM 705.

Water, 801, show in sand pumpings.

Water, 883, 4 BPH

Water, 888, Hole filling.

Oil, 801, show in sand pumpings.

SIM 707 = Sand LM 705.

Water, 801, show in sand pumpings.

Water, 883, 4 BPH

Water, 888, Hole filling.

Oil, 801, show in sand pumpings.

SIM 707 = Sand LM 705.



STATE OF WEST VIRGINIA
DEPARTMENT OF MINES
OIL AND GAS DIVISION

Sheet 2

WELL RECORD

Permit No. WAY-924

Oil or Gas Well OIL
(KIND)

Company OWENS, LIBBEY-OWENS GAS DEPARTMENT
Address P. O. Box 4158, Charleston 4, W. Va.
Farm Frank E. Mathewson Acres 861
Location (waters) _____
Well No. 13 (Serial #911) Elev. 705.91
District Grant County Wayne
The surface of tract is owned in fee by _____
Address _____
Mineral rights are owned by Emily F. Mathewson
630 Bergen Ave., Address Jersey City, N.J.
Drilling commenced 6-23-54
Drilling completed 8-25-54
Date Shot 10-13-54 From 2250 To 2760
With 4466-2/3# Gelatin
Open Flow /10ths Water in _____ Inch
/10ths Merc. in _____ Inch
Volume _____ Cu. Ft.
Rock Pressure _____ lbs. _____ hrs.
Oil _____ Est. 10 bbls., 1st 24 hrs.
Fresh water 45, 409 feet _____ feet
Salt water 801, 883, 888 feet _____ feet

Casing and Tubing	Used in Drilling	Left in Well	Packers
Size			Kind of Packer
16			
18			Size of
10			
8 1/4			Depth set
6 5/8			
5 3/16			Perf. top
3			Perf. bottom
2			Perf. top
Liners Used			Perf. bottom

CASING CEMENTED _____ SIZE _____ No. Ft. _____ Date _____

COAL WAS ENCOUNTERED AT _____ FEET _____ INCHES
_____ FEET _____ INCHES
_____ FEET _____ INCHES

Formation	Color	Hard or Soft	Top	Bottom	Oil, Gas or Water	Depth Found	Remarks
Slate	Light	Soft	2892	2907	Gas, 2747'	21/10 W 3/8" =	5.0 M
Br. ShaLe	Brown	Soft	2907	2974	Test 2799'	14/10 W 3/8" =	4.1 M
			T.D.	2974	Gas, 2867'	18/10 W 3/8" =	4.6 M
					Test 2933'	14/10 W 3/8" =	4.1 M
					Gas, 2943'	70/10 W 1" =	65.5 M
					Blew down to 3/10 W = 1" =		13.5 M
					Oil 2943'		
					Bailed out 20 gal. oil.		
					Hole caving on bottom. Cleaned out.		
					Made two feet of hole.		
					Gas gauging from 6/10 W to 26/10 W in 1" (19.2 M to 39.9 M)		
					<u>8-23-54</u> Bailing oil and cleaning out cavings.		
					Test 2970', 48/10 W 5/8" =		21.2
					<u>8-25-54</u> Completed drilling.		
<u>9-8-54</u>	Oil level 1666 ft.				height of 1234 ft. from top of hole.		
Gas Test <u>44/10 W 5/8" =</u>				20.3 M	After pulling tubing, A. A. Burns reported Aqua-gel level was 1694 ft.		
<u>9-9-54</u>	Ran 5 1/2" casing to shut off cavings. Lowering casing and cleaning out.				<u>9-24-54</u> Drillers book shows top of oil at 1046 ft., top of Aqua-gel 1417 ft. Tools set down at 2659 ft. Gas Test after bailing oil 24/10 W 3/8" =		5.4 M
<u>9-10-54</u>	Bailing out oil.				<u>9-27-54</u> Bailing out Aqua-gel.		
SIM 2974' = Sand LM 2973'					<u>9-28-54</u> Bailing out Aqua-gel.		
<u>9-11-54</u>	Lowered casing to 2977.				Test 20/10 W 3/8" =		4.9
4' bad hole; waiting on orders. Tools won't run in bad hole. Bad hole due to crooked stem.					<u>9-29-54</u> Bailed out Aqua-gel & oil from 2115 to 2579. When started gas made 23/10 W 3/8" = 5.2		7.3
<u>9-13-54</u>	Pulled 2977 feet of 5 1/2" casing.				bailed out 45/10 W 3/8" =		7.3
<u>9-21-54</u>	Gas tested 13/10 W 3/8" = 3.9 MCF when started up. Cleaned out hole.				<u>9-30-54</u> Cleaned out 2579 to 2679. Bailed out 3 barrels of water. Top cement 2679'.		
<u>9-22-54</u>	Ran 30 sacks Aqua-gel and 50 sacks of cement--Haliburton Co. Did not get circulation. Pulled tubing. Examination of tubing showed Aqua-gel had been pumped to a				When started up 24/10 W 3/8" =		5.4
					When bailed out 50/10 W 3/8" =		7.7



(Title) Geologist

By

APPROVED OWENS, LIBBEY-OWENS GAS DEPARTMENT

Date February 7, 1955

Formation	Color	Hard or Soft	Top	Bottom	Oil, Gas or Water	Depth Found	Remarks
10-4-54	Bailing water. Test before cleaning out		2679 to 2879.				
10-6-54	50/10 W 3/8" = 5.2 M. After cleaning out						
10-5-54	50/10 W 3/8" = 7.7 M. Cleaned out 2879 to 2972 and bailed out water. Test before cleaning						
10-6-54	Test After cleaned out 50/10 W 3/8" = 7.7 M. out 70/10 W 3/8" = 9.2 M.						
10-11-54 to 10-13-54	Testing 38/10 W 3/8" = 6.7 M. Bailing out oil.						
10-13-54	Shot well with 4466-2/3# of gel, From 2250' to 2960'.						
10-15-54	Test before shot 36/10 W 3/8" = 6.6 M. Test 15 min. A.S. 22/10 W 2 1/2" = 230 M. Test 1 hr. A.S. 54/10 W 1" = 57.6 M. Test 2 hrs. " 20/10 W 1" = 35.0 M.						
10-15-54	3 hrs. " 50/10 W 5/8" 21.6 M. 4 hrs. " 42/10 W 5/8" 19.8 M. 8 hrs. " 36/10 W 5/8" 18.3 M. 9 hrs. " 40/10 W 5/8" 19.3 M. 14 hrs. " 33/10 W 5/8" 17.5 M. 20 hrs. " 23/10 W 5/8" 17.6 M. 23 hrs. " 22/10 W 5/8" 17.3 M. 41 hrs. " 15/10 W 5/8" 17.8 M.						
10-15-54	10-15-54 Ran 5 1/2" casing through shot hole to 2750', set on ring and slips. Cleaning out from 2925' to 2950'. Could not test due to 5 1/2" suspended in hole.						
10-20-54	10-20-54 Bailing out oil.						
10-27-54	10-27-54 Swabbed 18" oil into 100 bbl. tank,						
15 bbl.	15 bbl.						
10-28-54	10-28-54 Swabbed 22" oil into 100 bbl. tank,						
18 1/2 bbl.	18 1/2 bbl.						
11-2-54	11-2-54 Bailed 5" of oil in 100 bbl. tank,						
4.1 bbl.	4.1 bbl.						
11-5-54	11-5-54 Swabbed oil. Put 37" oil in 100 bbl. tank, approx. 30.7 bbl.						
11-8-54	11-8-54 Top of oil in hole 2300' to start with. Swabbed down in perforated joints.						
6 1/2" of oil in tank before swabbing. After	6 1/2" of oil in tank before swabbing. After						
11-9-54	11-9-54 Top of oil in hole 2700'. 108" oil in tank before swabbing. After						
swabbing had 11 1/2" oil in tank. Gas test 30/10 W 3/8" = 6.0 MCF	swabbing had 11 1/2" oil in tank. Gas test 30/10 W 3/8" = 6.0 MCF						
11-16-54	11-16-54 Attempted to pull 5 1/2" casing. Cleaned out 2932' to 2938'.						
Set hydraulic jacks.	Set hydraulic jacks.						
11-18-54	11-18-54 Attempted to pull 5 1/2" casing. Took down jacks.						
11-19-54	11-19-54 Could not pull casing.						
11-22-54	11-22-54 Swabbing oil. Top of oil at 1650'. No oil in tank when started; 51" when finished swabbing.						
11-23-54	11-23-54 7 1/2" of oil in tank before swabbing; 51" after swabbing. Swabbed 1 1/2" in tank. Shut-down. Will install pumping unit.						
12-13-54	12-13-54 Pumping unit not yet received. L.T.K. has instructed to consider well as completed on this date. Pumping unit to be installed later.						

STATE OF WEST VIRGINIA
DEPARTMENT OF MINES
OIL AND GAS WELLS DIVISION

INSPECTOR'S PLUGGING REPORT

Permit No. Way 924 Well No. 13 Ser 911
 COMPANY A. C. Wilhelm ADDRESS Hamlin W. Va.
 FARM Frank E. Mathewson DISTRICT Grant COUNTY Wayne
 Filling Material Used Cement & Gel, or Clay

Liner Location Amount Packer Location

PLUGS USED AND DEPTH PLACED			BRIDGES	CASING AND TUBING		
CEMENT-THICKNESS	WOOD-SIZE	LEAD	CONSTRUCTION-LOCATION	RECOVERED	SIZE	LOST
<p>Removed pumping track, Pooled sucker Rods, And 1 Joint of Tubing No one AT Rig @ 12:00 Noon Gas Coming out of casing head only</p>						

RECEIVED
OCT 9 1974

Drillers' Names _____

Remarks: _____

OIL & GAS DIVISION
DEPT. OF MINES

10-7-74 I hereby certify I visited the above well on this date.
DATE

Lee School
 DISTRICT WELL INSPECTOR 02/09/2024

STATE OF WEST VIRGINIA
DEPARTMENT OF MINES
OIL AND GAS WELLS DIVISION

INSPECTOR'S WELL REPORT

Permit No. _____

Oil or Gas Well _____
(KIND)

	CASING AND TUBING	USED IN DRILLING	LEFT IN WELL	PACKERS
Company _____	Size			
Address _____	16			Kind of Packer _____
Farm _____	13			
Well No. _____	10			Size of _____
District _____ County _____	8 1/4			
Drilling commenced _____	6 5/8			Depth set _____
Drilling completed _____ Total depth _____	5 3/16			
Date shot _____ Depth of shot _____	3			Perf. top _____
Initial open flow _____ /10ths Water in _____ Inch	2			Perf. bottom _____
Open flow after tubing _____ /10ths Merc. in _____ Inch	Liners Used _____			Perf. top _____
Volume _____ Cu. Ft.				Perf. bottom _____

CASING CEMENTED _____ SIZE _____ No. FT. _____ Date _____

NAME OF SERVICE COMPANY _____

COAL WAS ENCOUNTERED AT _____ FEET _____ INCHES

_____ FEET _____ INCHES _____ FEET _____ INCHES

_____ FEET _____ INCHES _____ FEET _____ INCHES

Drillers' Names _____

Remarks: _____

STATE OF WEST VIRGINIA
 DEPARTMENT OF MINES
 OIL AND GAS WELLS DIVISION

RECEIVED

OCT 15 1974

OIL & GAS DIVISION
 DEPT. OF MINES

INSPECTOR'S PLUGGING REPORT

Permit No. Way 924-P Well No. 13

COMPANY A.G. Wilhelm ADDRESS Hamlin W.VA

FARM Frank E. Mathanson DISTRICT Grant COUNTY Wayne

Filling Material Used Cement, Gel & Clay

Liner Location Amount Packer Location

PLUGS USED AND DEPTH PLACED			BRIDGES	CASING AND TUBING		
CEMENT-THICKNESS	WOOD-SIZE	LEAD	CONSTRUCTION-LOCATION	RECOVERED	SIZE	LOST
Pulled 2" Tubing						
Gelled hole to 2200'						
Preparing to shoot 5 1/2" casing @ 2650'						

Drillers' Names _____

Remarks: _____

10-11-74
DATE

I hereby certify I visited the above well on this date.

Joe Schaeffer 02/09/2024
 DISTRICT WELL INSPECTOR

STATE OF WEST VIRGINIA
DEPARTMENT OF MINES
OIL AND GAS WELLS DIVISION

INSPECTOR'S WELL REPORT

Permit No. _____

Oil or Gas Well _____
(KIND)

Company _____ Address _____ Farm _____ Well No. _____ District _____ County _____ Drilling commenced _____ Drilling completed _____ Total depth _____ Date shot _____ Depth of shot _____ Initial open flow _____ /10ths Water in _____ Inch Open flow after tubing _____ /10ths Merc. in _____ Inch Volume _____ Cu. Ft. Rock pressure _____ lbs. _____ hrs. Oil _____ bbls., 1st 24 hrs. Fresh water _____ feet _____ feet Salt water _____ feet _____ feet	CASING AND TUBING	USED IN DRILLING	LEFT IN WELL	PACKERS
	Size			Kind of Packer _____
	16			
	13			
	10			Size of _____
	8 1/4			
	6 5/8			Depth set _____
	5 3/16			
	3			Perf. top _____
	2			Perf. bottom _____
	Liners Used _____			Perf. top _____
				Perf. bottom _____
	CASING CEMENTED _____ SIZE _____ No. FT. _____ Date _____			
	NAME OF SERVICE COMPANY _____			
	COAL WAS ENCOUNTERED AT _____ FEET _____ INCHES			
	_____ FEET _____ INCHES _____ FEET _____ INCHES			
	_____ FEET _____ INCHES _____ FEET _____ INCHES			

Drillers' Names _____

Remarks:

STATE OF WEST VIRGINIA
DEPARTMENT OF MINES
OIL AND GAS WELLS DIVISION

INSPECTOR'S WELL REPORT

Permit No. _____

Oil or Gas Well _____
(KIND)

	CASING AND TUBING	USED IN DRILLING	LEFT IN WELL	PACKERS
Company _____	Size			Kind of Packer _____
Address _____	16 _____			
Farm _____	13 _____			Size of _____
Well No. _____	10 _____			
District _____ County _____	8 1/4 _____			Depth set _____
Drilling commenced _____	6 5/8 _____			
Drilling completed _____ Total depth _____	5 3/16 _____			Perf. top _____
Date shot _____ Depth of shot _____	3 _____			
Initial open flow _____ /10ths Water in _____ Inch	2 _____			Perf. bottom _____
Open flow after tubing _____ /10ths Merc. in _____ Inch	Liners Used _____			Perf. top _____
Volume _____ Cu. Ft.				Perf. bottom _____
Rock pressure _____ lbs. _____ hrs.	CASING CEMENTED _____ SIZE _____ No. FT. _____ Date _____			
Oil _____ bbls., 1st 24 hrs.	NAME OF SERVICE COMPANY _____			
Fresh water _____ feet _____ feet	COAL WAS ENCOUNTERED AT _____ FEET _____ INCHES			
Salt water _____ feet _____ feet	_____ FEET _____ INCHES _____ FEET _____ INCHES			
	_____ FEET _____ INCHES _____ FEET _____ INCHES			

Drillers' Names _____

Remarks:

DATE

DISTRICT WELL INSPECTOR

02/09/2024

PROPOSED MANNER OF PLUGGING AND FILLING WELL

(REQUIRED BY RULES AND REGULATIONS)

WEST VIRGINIA DEPARTMENT OF MINES

OIL AND GAS DIVISION

WORK ORDER

Well to be plugged and filled as follows:

Pull 5/8" sucker rods. Pull 2-3/8" tubing. Pull 5 1/2" casing.
 Gel shot hole 2960' to 2250'. Cement plug 2250' to 2210'.
 Gel 2210' to 2075'. Cement plug 2075' to 2030'.
 Gel or clay 2030' to 1930'. Set permanent bridge at 1575'.
 Neat cement 1575' to 1555'. Mud or gel to 1450'.
 Neat cement 1450' to 1430'. Pull 7" casing.
 Set a permanent bridge at 1160'. Neat cement 1160' to 1135'.
 Mud & clay or gel to 850'. Neat cement 850' to 825'.
~~Set~~ Set permanent bridge at 410'. Neat cement 410' to 390'.
 Mud or Gel to 180'. Neat cement 180' to 155'. Pull 8-5/8" casing.
 Fill with mud or clay to 25'. Cement 25' to surface.
 Erect monument.

To the Department of Mines
 Coal Owner or Operator,
 Lease or Property Owner.

IF PARTIAL PLUGGING
 PLEASE SUBMIT REVISED WELL RECORD
 WHEN WORK IS COMPLETED.

Gentlemen:

This "work order" is submitted for your approval and concurrence and unless notified of your disapproval or non-concurrence, the undersigned will proceed with the plugging and filling of said well in the above described manner on the date inspector is notified after permit is issued.

Very truly yours,

A. C. Wilhelm

Well Operator

No objections have been filed by the coal owner or coal operator, or any available adjacent lease or property owners or interposed by the Department of Mines to the manner herein described for the plugging and filling of the well above mentioned. Therefore, the same is hereby approved this

4th day of October, 1974.

DEPARTMENT OF MINES
 Oil and Gas Division

By: [Signature] 02/09/2024

NOTE: This "work order" shall be filed in triplicate, one copy for the files of the Department of Mines; one to be approved or corrected and returned to the well operator as his authority for plugging said well; and one for the well inspector.



STATE OF WEST VIRGINIA
DEPARTMENT OF MINES
OIL AND GAS WELLS DIVISION

RECEIVED
OCT 4 1974
OIL & GAS DIVISION
DEPT. OF MINES

NOTICE OF INTENTION TO PLUG AND ABANDON WELL

(REQUIRED BY SECTION 9, ARTICLE 4, CHAPTER 22 OF THE CODE)

TO THE DEPARTMENT OF MINES,
Charleston, W. Va.

no coal operation
Coal Operator

A. C. Wilhelm
Name of Well Operator

Address

Box 99
Hamlin, W. Va. 25523
Complete Address

Coal Owner

Oct. 2, 1974
Date

Address

WELL TO BE ABANDONED
Grant District

Frank E. Mathewson
Lease or Property Owner

Wayne County

Address

Well No. Well #13
Ser. #911

Frank E. Mathewson Farm

Inspector Kenneth Butcher

Mr Butcher ill - Mr Schoelkopf will take care of this
Telephone 736-4885

TO BE NOTIFIED 24 HOURS IN ADVANCE OF PLUGGING OPERATIONS

Gentlemen:—

The undersigned well operator is about to abandon the above described well and will commence the work of plugging and abandoning said well on the date inspector is notified (which date shall not be less than five days after the day on which this notice so mailed is received, or in due course should be received by the Department of Mines).

This notice is given you in order that your respective representatives may be present at the plugging and filling of said well. You are further notified that whether you are represented or not represented the undersigned will proceed on that date, or shortly thereafter, to plug and fill said well in the manner required by Section 10, Article 4, Chapter 22 of the Code and given in detail on the reverse side of this notice, in "Work Order."

This notice is being mailed by registered mail to each of you at the above addresses on the above date.

Very truly yours,

A. C. Wilhelm
Well Operator

NOTE: Upon the abandonment of any well drilled prior to June 1, 1929, a plat prepared by a registered engineer, shall be filed with THREE COPIES OF APPLICATION, (OG-9) AND "WORK ORDER" AND TWO COPIES OF THE WELL RECORD, (OG-10). The map must show the district and county in which the tract of land is located, the name and acreage of same, the name or names of the owners and names of adjacent tracts and the location of the well to be abandoned, determined by survey with the courses and distances of such well from two permanent points or landmarks on said tract, in compliance with Rule 5 of the Rules and Regulations.

NOTE: In case plugging is not commenced within four months from the date of permit, same shall expire and be of no further force or effect.

NOTE: PERMIT IS NON TRANSFERABLE.

BOND PLUG

Way-924-P

Permit Number *file*

AFFIDAVIT, FORM OG-8, MANNER WELL PLUGGED MUST BE SUBMITTED TO OBTAIN RELEASE OF WELL UNDER BOND.

STATE OF WEST VIRGINIA
DEPARTMENT OF MINES
OFFICE OF THE STATE MINER

REPORT OF PROGRESS AND FINDINGS

THIS REPORT WAS MADE IN THE FIELD OF THE STATE MINER AND IS SUBJECT TO THE APPROVAL OF THE STATE MINER. IT IS NOT TO BE TAKEN AS A FINAL REPORT OF THE STATE MINER.

NAME OF MINE: A. C. Williams
COUNTY: Boone
TOWNSHIP: Wayne
LOCALITY: 13-507, Hill

NAME OF STATE MINER: Frank E. Johnson
ADDRESS: 13-507, Hill

REPORT OF PROGRESS AND FINDINGS
The mine is a small, underground mine. It is located in the hills of Boone County, West Virginia. The mine is owned and operated by A. C. Williams. The mine is a coal mine. The mine is a small, underground mine. It is located in the hills of Boone County, West Virginia. The mine is owned and operated by A. C. Williams. The mine is a coal mine.

The mine is a small, underground mine. It is located in the hills of Boone County, West Virginia. The mine is owned and operated by A. C. Williams. The mine is a coal mine. The mine is a small, underground mine. It is located in the hills of Boone County, West Virginia. The mine is owned and operated by A. C. Williams. The mine is a coal mine.

The mine is a small, underground mine. It is located in the hills of Boone County, West Virginia. The mine is owned and operated by A. C. Williams. The mine is a coal mine. The mine is a small, underground mine. It is located in the hills of Boone County, West Virginia. The mine is owned and operated by A. C. Williams. The mine is a coal mine.

REPORT OF PROGRESS AND FINDINGS
The mine is a small, underground mine. It is located in the hills of Boone County, West Virginia. The mine is owned and operated by A. C. Williams. The mine is a coal mine. The mine is a small, underground mine. It is located in the hills of Boone County, West Virginia. The mine is owned and operated by A. C. Williams. The mine is a coal mine.

Frank E. Johnson
State Miner

02/09/2024

STATE OF WEST VIRGINIA
DEPARTMENT OF MINES
OIL AND GAS WELLS DIVISION

RECEIVED

JUN 13 1975

OIL & GAS DIVISION
DEPT. OF MINES

INSPECTOR'S WELL REPORT

Permit No. away 924 P

Oil or Gas Well _____
(KIND)

Company <u>A. C. Wilhelm</u>	CASING AND TUBING	USED IN DRILLING	LEFT IN WELL	PACKERS
Address <u>Hamlin, W. Va.</u>	Size			
Farm <u>Frank E. Malhears</u>	16			
Well No. <u>13-5-911</u>	13			
District <u>Grant</u> County <u>Wayne</u>	10			
Drilling commenced _____	8 3/4			
Drilling completed _____ Total depth _____	6 5/8			
Date shot _____ Depth of shot _____	5 3/16			
Initial open flow _____ /10ths Water in _____ Inch	3			
Open flow after tubing _____ /10ths Merc. in _____ Inch	2			
Volume _____ Cu. Ft.	Liners Used _____			
Rock pressure _____ lbs. _____ hrs.	CASING CEILING _____			
Oil _____ bbls., 1st 24 hrs.	NAME OF SERVICE _____			
Fresh water _____ feet _____ feet	COAL WAS _____			
Salt water _____ feet _____ feet	FEE _____			
Drillers' Names _____	FEE _____			

PS Form 3811, Nov. 1973

● SENDER: Complete items 1 and 2. Add your address in the "RETURN TO" space on reverse.

1. The following service is requested (check one).
 Show to whom and date delivered..... 15¢
 Show to whom, date, & address of delivery.. 35¢
 DELIVER ONLY TO ADDRESSEE and show to whom and date delivered..... 65¢
 DELIVER ONLY TO ADDRESSEE and show to whom, date, and address of delivery 85¢

2. ARTICLE ADDRESSED TO:
 Mr. A. C. Wilhelm
 Box 99
 Hamlin, W. Va. 25523

3. ARTICLE DESCRIPTION:
 REGISTERED NO. _____ CERTIFIED NO. 18758 INSURED NO. _____
 (Always obtain signature of addressee or agent)

I have received the article described above.
 SIGNATURE: A. C. Wilhelm

4. DATE OF DELIVERY 6-14-75 POSTMARK HAMLIN W. VA. JUN 14 1975

5. ADDRESS (Complete only if requested)

6. UNABLE TO DELIVER BECAUSE: _____ CLERK'S INITIALS [Signature]

RETURN RECEIPT, REGISTERED, INSURED AND CERTIFIED MAIL

* GPO : 1974 O - 527-803

Remarks:

Final inspection has been made.

6-10-75
DATE

A. E. Butcher
DISTRICT W. VA. 02/09/2024



State of West Virginia

Department of Mines

Oil and Gas Division

Charleston 25305

June 13, 1975

A. C. Wilhelm
Box 99
Hamlin, W.Va. 25523

In Re: Permit No. WAY-924-P
Farm Frank E. Mathewson
Well No. 13-S-911
District Grant
County Wayne

Gentlemen:

The final inspection report for the well which is described above has been received in this office. Only the column checked below applies.

 The bond covering the well designated by the above permit number has been released under your Blanket Bond.

XXXXXXX Please return the enclosed cancelled bond which covered the well designated by the above permit number to the Surety Company who executed said bond in your behalf, in order that they may give you credit on their records.

Very truly yours,

Deputy Director
Oil and Gas Division

Enclosure: RLD/cc
Single Bond dated 10-3-74 (Ohio Farmers Ins. Co.) \$2,500.00

02/09/2024

STATE OF WEST VIRGINIA
DEPARTMENT OF MINES
OIL AND GAS WELLS DIVISION

INSPECTOR'S WELL REPORT

Permit No. _____

Oil or Gas Well _____
(KIND)

	CASING AND TUBING	USED IN DRILLING	LEFT IN WELL	PACKERS
Company _____	Size			
Address _____	16			Kind of Packer _____
Farm _____	13			
Well No. _____	10			Size of _____
District _____ County _____	8 1/4			
Drilling commenced _____	6 5/8			Depth set _____
Drilling completed _____ Total depth _____	5 3/16			
Date shot _____ Depth of shot _____	3			Perf. top _____
Initial open flow _____ /10ths Water in _____ Inch	2			Perf. bottom _____
Open flow after tubing _____ /10ths Merc. in _____ Inch	Liners Used			Perf. top _____
				Perf. bottom _____

Volume _____ Cu. Ft. CASING CEMENTED _____ SIZE _____ No. FT. _____ Date _____

Rock pressure _____ lbs. _____ hrs. NAME OF SERVICE COMPANY _____

Oil _____ bbls., 1st 24 hrs. COAL WAS ENCOUNTERED AT _____ FEET _____ INCHES

Fresh water _____ feet _____ feet _____ FEET _____ INCHES _____ FEET _____ INCHES

Salt water _____ feet _____ feet _____ FEET _____ INCHES _____ FEET _____ INCHES

Drillers' Names _____

Remarks:

DATE

DISTRICT WELL INSPECTOR

02/09/2024

STATE OF WEST VIRGINIA
DEPARTMENT OF MINES
OIL AND GAS WELLS DIVISION

INSPECTOR'S WELL REPORT

Permit No. _____

Oil or Gas Well _____
(KIND)

Company _____ Address _____ Farm _____ Well No. _____ District _____ County _____ Drilling commenced _____ Drilling completed _____ Total depth _____ Date shot _____ Depth of shot _____ Initial open flow _____ /10ths Water in _____ Inch Open flow after tubing _____ /10ths Merc. in _____ Inch Volume _____ Cu. Ft. Rock pressure _____ lbs. _____ hrs. Oil _____ bbls., 1st 24 hrs. Fresh water _____ feet _____ feet Salt water _____ feet _____ feet	CASING AND TUBING	USED IN DRILLING	LEFT IN WELL	PACKERS
	Size			Kind of Packer _____
	16			
	13			Size of _____
	10			Depth set _____
	8 1/4			
	6 5/8			Perf. top _____
	5 3/16			Perf. bottom _____
	3			Perf. top _____
	2			Perf. bottom _____
	Liners Used _____			Perf. top _____
				Perf. bottom _____

CASING CEMENTED _____ SIZE _____ No. FT. _____ Date _____

NAME OF SERVICE COMPANY _____

COAL WAS ENCOUNTERED AT _____ FEET _____ INCHES

_____ FEET _____ INCHES _____ FEET _____ INCHES

_____ FEET _____ INCHES _____ FEET _____ INCHES

Drillers' Names _____

Remarks:

DATE

DISTRICT WELL INSPECTOR
02/09/2024

Latitude 38° 05'

Longitude 82° 15'

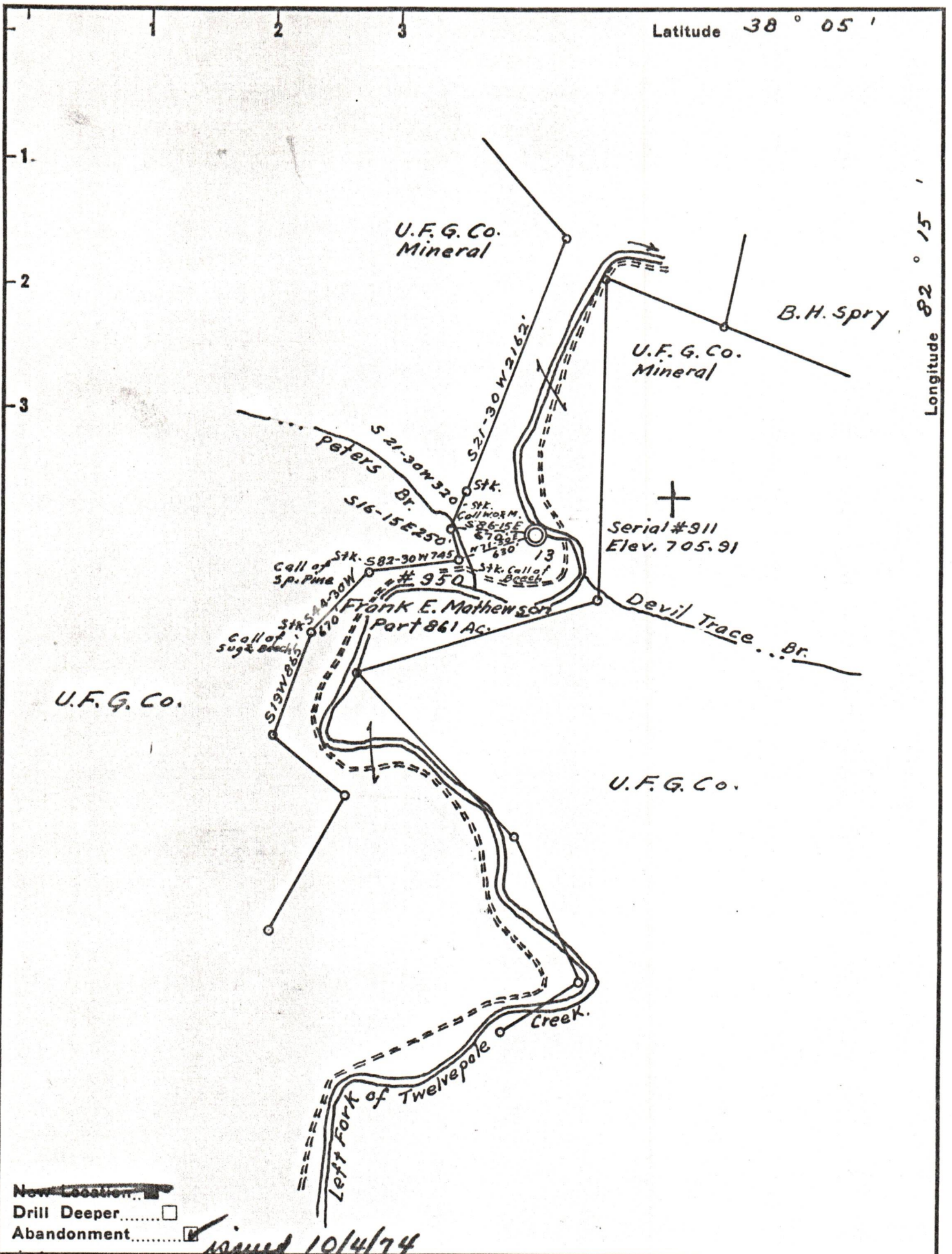

New Location
 Drill Deeper
 Abandonment

issued 10/4/74

A.C. Wilhelm
 Company ~~Owens, Lipboy-Owens Gas Dept.~~
 Box 99, Hamlin, W. Va.
 Address ~~Box 4158 Charleston W. Va. 25323~~
 Farm Frank E. Mathewson
 Tract _____ Acres 861 Lease No. 950
 Well (Farm) No. 13 Serial No. 911
 Elevation (Spirit Level) 705.91
 Quadrangle Wayne
 County Wayne District Grant
 Engineer T.S. Flournoy
 Engineer's Registration No. 269
 File No. _____ Drawing No. _____
 Date June 2, 1954 Scale 1" = 1000'

STATE OF WEST VIRGINIA
 DEPARTMENT OF MINES
 OIL AND GAS DIVISION
 CHARLESTON

WELL LOCATION MAP

FILE NO. WAY-924-9 02/09/2024

+ Denotes location of well on United States Topographic Maps, scale 1 to 62,500, latitude and longitude lines being represented by border lines as shown.

- Denotes one inch spaces on border line of original tracing.

47-099