



STATE OF WEST VIRGINIA
DEPARTMENT OF MINES
OIL AND GAS DIVISION

NOTICE OF PROPOSED LOCATION OF OIL AND GAS WELL

To THE DEPARTMENT OF MINES,
Charleston, W. Va.

Paul Crockett & Blanche Crockett Webster Myers
COAL OWNER (coal not operated) NAME OF WELL OPERATOR
Shoals, W. Va. 1614 Seventh Avenue
Huntington, W. Va.

ADDRESS

COMPLETE ADDRESS

June 26th, 19 54

COAL OPERATOR OR COAL OWNER

PROPOSED LOCATION

Union District

ADDRESS

Wayne County

Paul Crockett & Blanche Crockett
OWNER OF MINERAL RIGHTS

Well No. 1 38° 25'
82° 25'

Shoals, W. Va.
ADDRESS

Paul Crockett Farm

GENTLEMEN:

The undersigned well operator is entitled to drill upon the above named farm or tract of land for oil and gas, having fee title thereto, (or as the case may be) under grant or lease dated 1953, made by Paul Crockett & Blanche Crockett, to Webster Myers, and recorded on the _____ day of _____, in the office of the County Clerk for said County in Book _____, page _____.

The enclosed plat was prepared by a competent engineer and shows the proposed location of a well to be drilled for oil and gas by the undersigned well operator on the farm and in the Magisterial District and County above named, determined by survey and courses and distances from two permanent points, or land marks.

The undersigned well operator is informed and believes there are no coal operators operating beds of coal beneath said farm or tract of land on which said well is located, or within 500 feet of the boundaries of the same, who have mapped their workings and filed their maps as required by law, excepting the coal operators or coal owners (if any) above named as addressees.

The above named coal operators or coal owners (if any) are notified that any objections they may desire to make to such proposed location, or which they are required to make by Section 3 of said Code, if the drilling of a well at said proposed location will cause a dangerous condition in or about their respective coal mines, must be received by, or filed with the Department of Mines within ten* days from the receipt of a copy of this notice and accompanying plat by said Department. Said coal operators are further notified that forms for use in making such objections will be furnished to them by the Department of Mines promptly on request and that all such objections must set forth as definitely as is reasonably possible the ground or grounds on which such objections are based and indicate the direction and distance the proposed location should be moved to overcome same.

(The next paragraph is to be completed only in Department's copy.)

Copies of this notice and the enclosed plat were mailed by registered mail, or delivered to the above named coal operators or coal owners at their above shown respective address _____ day _____ before, or on the same day with the mailing or delivery of this copy to the Department of Mines at Charleston, West Virginia.

Very truly yours,

Webster Myers
WELL OPERATOR
1614 Seventh Avenue
STREET
Huntington
CITY OR TOWN
West Virginia.
STATE

Address of Well Operator }

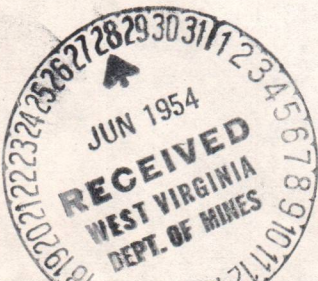

02/09/2024

*Section 3 of said Code. If no such objections be filed or be found by the department of mines, within said period of ten days from the receipt of said notice and plat by the department of mines, to said proposed location, the department shall forthwith issue to the well operator a drilling permit reciting the filing of such plat, that no objections have been made by the coal operators to the location, or found thereto by the department, and that the same is approved and the well operator authorized to proceed to drill at said location.



STATE OF WEST VIRGINIA
DEPARTMENT OF MINES
OIL AND GAS DIVISION

NOTICE OF PROPOSED LOCATION OF OIL AND GAS WELL

To The Department of Mines
Charleston, W. Va.

Paul Crockett & Blanche Crockett
1614 Seventh Avenue
Huntington, W. Va.

Webster Myers
1614 Seventh Avenue
Huntington, W. Va.

June 26th 1954

Union

Wayne

Well No. 1

Paul Crockett

Shoals, W. Va.

Paul Crockett & Blanche Crockett

Shoals, W. Va.

The undersigned well operator is entitled to drill upon the above named farm or tract of land for oil and gas, having fee title thereto, (or as the case may be) under grant or lease dated _____ 1953 made by Paul Crockett & Blanche Crockett and recorded on the _____ day of _____ 1953 in the office of the County Clerk for said County in _____ 1953.

The enclosed plat was prepared by a competent engineer and shows the proposed location of a well to be drilled for oil and gas by the undersigned well operator on the farm and in the Magisterial District and County above named, determined by survey and courses and distances from two permanent points or land markers.

The undersigned well operator is informed and believes there are no coal operators operating beds of coal beneath said farm or tract of land on which said well is located, or within 500 feet of the bounds of the same, who have mapped their workings and filed their maps as required by law, excepting the coal operators or coal owners (if any) above named as addressees.

The above named coal operator or coal owners (if any) are notified that any objections they may desire to make to such proposed location, or which they are required to make by Section 5 of said Code, if the drilling of a well at said proposed location will cause a dangerous condition in or about their respective coal mines, must be recorded by or filed with the Department of Mines within ten days from the receipt of a copy of this notice and accompanying plat by said Department. Said coal operators are further notified that forms for use in making such objections will be furnished to them by the Department of Mines promptly on request and that all such objections must set forth as definitely as is reasonably possible the grounds or grounds on which such objections are based and indicate the direction and distance the proposed location should be moved to overcome same.

(The next paragraph is to be completed only in Department's copy.)
Copies of this notice and the enclosed plat were mailed by registered mail, or delivered to the above named coal operators or coal owners at their above shown respective addresses _____ day _____ before, or on the same day with the mailing or delivery of this copy, to the Department of Mines at Charleston, West Virginia.

Very truly yours,

Webster Myers

1614 Seventh Avenue

Huntington

West Virginia

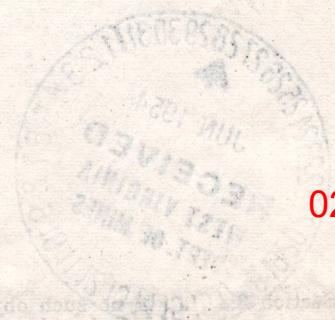

02/09/2024

Section 5 of said Code provides that if any objections are filed or be found by the Department of Mines within said period of ten days from the receipt of such notice and plat by the Department of Mines to such proposed location, the Department of Mines shall, within ten days from the receipt of such notice and plat, cause a hearing to be held at the location of such objections and the well operator shall be notified of the date and time of such hearing. If no objections are filed or found within the time specified in this notice, the well operator is authorized to proceed to drill at said location.



STATE OF WEST VIRGINIA
DEPARTMENT OF MINES
OIL AND GAS DIVISION

Quadrangle Muyardot

WELL RECORD

Permit No. Way 932

Oil or Gas Well Gas
(KIND)

Company David Gas Company (Webster Myers)
Address 1614 7th Ave Huntington, W.Va.
Farm XXXXX Paul Crockett Acres 30
Location (waters) Twelve Pole
Well No. 1 Elev. 670
District Union County Wayne
The surface of tract is owned in fee by Paul Crockett
Shoals, W.Va. Address _____
Mineral rights are owned by Same
Address _____

Drilling commenced July 19, 1954
Drilling completed Sept 6, 1954
Date Shot Sept 6 From 3050 To 2450
With 667 lbs Gela tin and 3333 lbs Gas Well B

Open Flow /10ths Water in _____ Inch
/10ths Merc. in _____ Inch
Volume 105 M (after shot) _____ Cu. Ft.
Rock Pressure 450 lbs. 40 hrs.
Oil _____ bbls., 1st 24 hrs.
Fresh water 125 feet _____ feet
Salt water 1100 feet _____ feet

Casing and Tubing	Used in Drilling	Left in Well	Packers
Size			Bottom hole
16			Wall & Anchor
13			Kind of Packer
10	30	30	5-3/16"x16"
8 1/4	154	154	2"x5"x16"
6 5/8	1235	Pulled	Size of
5 3/16	2130	2130	Bottom hole
3			2130
2	2885	2885	Depth set
Liners Used	none		Anchor 2222
			Perf. top 2715
			Perf. bottom 2885
			Perf. top
			Perf. bottom

CASING CEMENTED no SIZE _____ No. Ft. _____ Date _____

COAL WAS ENCOUNTERED AT none FEET _____ INCHES
FEET _____ INCHES FEET _____ INCHES
FEET _____ INCHES FEET _____ INCHES

Formation	Color	Hard or Soft	Top	Bottom	Oil, Gas or Water	Depth Found	Remarks
Surface	<u>fx</u>		0	75			
Slate			75	125			
Sand			125	235			
Slate			235	450			
Sand			450	675			
Blac k Slate			675	720			
Gas Sand			720	725			
Slate			725	740			
Salt Sand Broken			740	1180			
Slate			1180	1195			
Sand			1195	1214			
Slate			1214	1220			
Little Lime			1220	1235			
Big Lime			1235	1390			
Keener Sand			1390	1420			
Slate			1420	1450			
Injun Sand			1450	1520			
Slate			1520	1530			Brown Sha le 2685 to 2750
Sand			1530	1570			Grey Shale 2750 to 2780
Slate & Shells			1570	2020			Brown Shale 2780 - 2870
Brown Shale			2020	2042			Slate 2870 3020
Berea Sand			2042	2057			Brown Shale 3020 3050
Slate & Shells			2057	2110			Top of corniferous and total depth 3050
Brown Shale			2110	2230			Small show of gas 2685-2840
Slate & Shells			2230	2450			2850-
Brown Shale			2450	2660			
Slate			2660	2685			

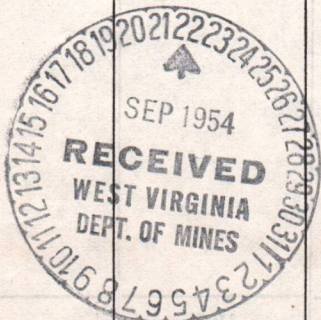

02/09/2024

Partners

(Title)

By

David Gas Co

APPROVED

Owner

Date

9-23

1954

WELL RECORD

Formation	Color	Hard or Soft	Top	Bottom	Oil, Gas or Water	Depth Found	Remarks
Surface	Gray		0	75			
Clay			75	125			
Sand			125	155			
Clay			155	175			
Sand			175	205			
Black shale			205	235			
Gas sand			235	265			
Clay			265	295			
Sand			295	325			
Clay			325	355			
Clay			355	385			
Clay			385	415			
Clay			415	445			
Clay			445	475			
Clay			475	505			
Clay			505	535			
Clay			535	565			
Clay			565	595			
Clay			595	625			
Clay			625	655			
Clay			655	685			
Clay			685	715			
Clay			715	745			
Clay			745	775			
Clay			775	805			
Clay			805	835			
Clay			835	865			
Clay			865	895			
Clay			895	925			
Clay			925	955			
Clay			955	985			
Clay			985	1015			
Clay			1015	1045			
Clay			1045	1075			
Clay			1075	1105			
Clay			1105	1135			
Clay			1135	1165			
Clay			1165	1195			
Clay			1195	1225			
Clay			1225	1255			
Clay			1255	1285			
Clay			1285	1315			
Clay			1315	1345			
Clay			1345	1375			
Clay			1375	1405			
Clay			1405	1435			
Clay			1435	1465			
Clay			1465	1495			
Clay			1495	1525			
Clay			1525	1555			
Clay			1555	1585			
Clay			1585	1615			
Clay			1615	1645			
Clay			1645	1675			
Clay			1675	1705			
Clay			1705	1735			
Clay			1735	1765			
Clay			1765	1795			
Clay			1795	1825			
Clay			1825	1855			
Clay			1855	1885			
Clay			1885	1915			
Clay			1915	1945			
Clay			1945	1975			
Clay			1975	2005			
Clay			2005	2035			
Clay			2035	2065			
Clay			2065	2095			
Clay			2095	2125			
Clay			2125	2155			
Clay			2155	2185			
Clay			2185	2215			
Clay			2215	2245			
Clay			2245	2275			
Clay			2275	2305			
Clay			2305	2335			
Clay			2335	2365			
Clay			2365	2395			
Clay			2395	2425			
Clay			2425	2455			
Clay			2455	2485			
Clay			2485	2515			
Clay			2515	2545			
Clay			2545	2575			
Clay			2575	2605			
Clay			2605	2635			
Clay			2635	2665			
Clay			2665	2695			
Clay			2695	2725			
Clay			2725	2755			
Clay			2755	2785			
Clay			2785	2815			
Clay			2815	2845			
Clay			2845	2875			
Clay			2875	2905			
Clay			2905	2935			
Clay			2935	2965			
Clay			2965	2995			
Clay			2995	3025			
Clay			3025	3055			
Clay			3055	3085			
Clay			3085	3115			
Clay			3115	3145			
Clay			3145	3175			
Clay			3175	3205			
Clay			3205	3235			
Clay			3235	3265			
Clay			3265	3295			
Clay			3295	3325			
Clay			3325	3355			
Clay			3355	3385			
Clay			3385	3415			
Clay			3415	3445			
Clay			3445	3475			
Clay			3475	3505			
Clay			3505	3535			
Clay			3535	3565			
Clay			3565	3595			
Clay			3595	3625			
Clay			3625	3655			
Clay			3655	3685			
Clay			3685	3715			
Clay			3715	3745			
Clay			3745	3775			
Clay			3775	3805			
Clay			3805	3835			
Clay			3835	3865			
Clay			3865	3895			
Clay			3895	3925			
Clay			3925	3955			
Clay			3955	3985			
Clay			3985	4015			
Clay			4015	4045			
Clay			4045	4075			
Clay			4075	4105			
Clay			4105	4135			
Clay			4135	4165			
Clay			4165	4195			
Clay			4195	4225			
Clay			4225	4255			
Clay			4255	4285			
Clay			4285	4315			
Clay			4315	4345			
Clay			4345	4375			
Clay			4375	4405			
Clay			4405	4435			
Clay			4435	4465			
Clay			4465	4495			
Clay			4495	4525			
Clay			4525	4555			
Clay			4555	4585			
Clay			4585	4615			
Clay			4615	4645			
Clay			4645	4675			
Clay			4675	4705			
Clay			4705	4735			
Clay			4735	4765			
Clay			4765	4795			
Clay			4795	4825			
Clay			4825	4855			
Clay			4855	4885			
Clay			4885	4915			
Clay			4915	4945			
Clay			4945	4975			
Clay			4975	5005			
Clay			5005	5035			
Clay			5035	5065			
Clay			5065	5095			
Clay			5095	5125			
Clay			5125	5155			
Clay			5155	5185			
Clay			5185	5215			
Clay			5215	5245			
Clay			5245	5275			
Clay			5275	5305			
Clay			5305	5335			
Clay			5335	5365			
Clay			5365	5395			
Clay			5395	5425			
Clay			5425	5455			
Clay			5455	5485			
Clay			5485	5515			
Clay			5515	5545			
Clay			5545	5575			
Clay			5575	5605			
Clay			5605	5635			
Clay			5635	5665			
Clay			5665	5695			
Clay			5695	5725			
Clay			5725	5755			
Clay			5755	5785			
Clay			5785	5815			
Clay			5815	5845			
Clay			5845	5875			
Clay			5875	5905			
Clay			5905	5935			
Clay			5935	5965			
Clay			5965	5995			
Clay			5995	6025			
Clay			6025	6055			

1.0 API well number: (If not available, leave blank. 14 digits.)	<u>47-099-2-932-00000</u>				
2.0 Type of determination being sought: (Use the codes found on the front of this form.)	<u>STRIPPER</u> Section of NGPA		<u>108</u> Category Code		
3.0 Depth of the deepest completion location: (Only needed if sections 103 or 107 in 2.0 above.)	_____ feet				
4.0 Name, address and code number of applicant: (35 letters per line maximum. If code number not available, leave blank.)	<u>DAVID GAS COMPANY</u> Name		_____ Seller Code		
	<u>1614 7TH AVENUE</u> Street				
	<u>HUNTINGTON</u> City	<u>W VA</u> State	<u>25703</u> Zip Code		
5.0 Location of this well: [Complete (a) or (b).] (a) For onshore wells (35 letters maximum for field name.)	<u>Southern W.VA.</u> Field Name		_____ State		
	<u>WAYNE</u> County		<u>W.VA.</u> State		
(b) For OCS wells:	<u>Southern W.VA.</u> Area Name		_____ Block Number		
	Date of Lease: <u>08.31.53</u> Mo. Day Yr.		_____ OCS Lease Number		
(c) Name and identification number of this well: (35 letters and digits maximum.)	<u>DAVID GAS CO #1 Well</u>				
(d) If code 4 or 5 in 2.0 above, name of the reservoir: (35 letters maximum.)	<u>BROWN SHALE</u>				
6.0 (a) Name and code number of the purchaser: (35 letters and digits maximum. If code number not available, leave blank.)	<u>GAS SUPPLY CORPORATION</u> Name		_____ Buyer Code		
(b) Date of the contract:	<u>09.27.53</u> Mo. Day Yr.				
(c) Estimated annual production:	_____ <u>5529</u> MMcf.				
		(a) Base Price (\$/MMBTU)	(b) Tax	(c) All Other Prices [Indicate (+) or (-).]	(d) Total of (a), (b) and (c)
7.0 Contract price: (As of filing date. Complete to 3 decimal places.)		<u>2.224</u>	<u>-.25</u>	<u>-.22</u>	<u>2.694</u>
8.0 Maximum lawful rate: (As of filing date. Complete to 3 decimal places.)		<u>2.224</u>	<u>-.25</u>	<u>-.22</u>	<u>2.694</u>
9.0 Person responsible for this application:	<u>DAVID GAS CO</u> <u>WALTER MYERS</u> Name				
Agency Use Only Date Received by Juris. Agency <u>JUN 1 1979</u>	_____ Title				
Date Received by FERC	_____ Signature				
	<u>4/2/79</u> Date Application is Completed		<u>(304) 523-6616</u> Phone Number		

PARTICIPANTS:

DATE:

BUYER-SELLER CODE

MAR 05 1980

004838

023382

WELL OPERATOR: David Gas Company

FIRST PURCHASER: Gas Supply Corporation

OTHER:

W. Va. Department of Mines, Oil & Gas Division

WELL DETERMINATION FILE NUMBER

790601 - 108 - 099 - 0932

Use Above File Number on all Communications Relating to Determination of this Well

reworked
Qualified
[Redacted]
J. E. Huzzey
New production attached 8-5-80

CHECK EACH ITEM AS COMPLETE OR NOTE WHAT IS MISSING

ITEM NO.

- 1 FERC-121 Items not completed - Line No. _____
- 2 IV-1 - Agent Webster Myers
- 3 IV-2 - Well Permit
- 4 IV-6 - Well Plat
- 5 IV-35- Well Record Drilling Deepening _____
- 6 IV-36- Gas-Oil Test: Gas Only 105 Was Oil Produced? _____ Ratio _____
- 7 IV-39- Annual Production 3 years
- * 8 IV-40- 90 day Production 90 Days off Line: _____
- 9 IV-48- Application for Certification. Complete?
- 10 - 17 IV Form #51 - 52 - 53 - 54 - 55 - 56 - 57 - 58. Complete Affidavit Signed
- 18 - 28 Other: Survey _____ Logs _____ Geological Charts _____ Structure Map _____
1:4000 Map _____ Well Tabulations _____ Gas Analyses _____
- (5) Date commenced: 7-19-54
Date Completed: 9-6-54 Deepened _____
- (5) Production Depth: 2660-2685
- (5) Production Formation: Slate
- (5) FINAL OPEN FLOW:
Initial Potential: 105 MCF
- (5) After Static R.P. ~~Initial~~ FRAC: 450 - 40 hrs.
- (6) Other Gas Test: _____
- (7) Avg. Daily Gas from Annual Production: 305 ^{7653/367 = 21.34} 13.4 MCFD
- * (8) Avg. Daily Gas from 90-day ending w/1-120 days 13.4 MCF
- (8) Line Pressure: N/A PSIG from Daily Report _____
- (5) Oil Production: No From Completion Report _____
- (10-17) Does lease inventory indicate enhanced recovery being done: No
- (10-17) Is affidavit signed? Notarized? 02/09/2024

Does official well record with the Department confirm the submitted information? Yes

Additional Information _____ Does computer program confirm? _____

Was Determination Objected to? _____ By Whom? _____

JMC

Describe the search made of any records listed above:

Are you aware of any other information which would tend to be inconsistent with the information specified above? Yes No . If yes, indicate the type and source of the information.

AFFIDAVIT

I, Webster Myers, having been first sworn according to law, state that I have caused to be made a diligent search of those records hereinbefore indicated in the manner herein described, that the information contained in this document is true and accurate and that on the basis of the records and examinations hereinbefore described, and to the best of my information, knowledge and belief, the well for which this certification is sought qualifies as a stripper well.

[Signature]

STATE OF WEST VIRGINIA,

COUNTY OF Cabell, TO WIT:

I, Sarah C. Reese, a Notary Public in and for the state and county aforesaid, do certify that Webster Myers whose name is signed to the writing above, bearing date the 20 day of March, 1979, has acknowledged the same before me, in my county aforesaid.

Given under my hand and official seal this 20th day of March, 1979

My term of office expires on the 1st day of April, 1980.

[Signature]
Notary Public

[NOTARIAL SEAL]

02/09/2024

STATE OF WEST VIRGINIA
DEPARTMENT OF MINES, OIL AND GAS DIVISION

Date April 2 19 79
Operator's Well No. #1
API Well No. 47 - 099 - 0932
State County Permit

WELL CLASSIFICATION FORM

STRIPPER GAS WELL

NGPA Section 108

DESIGNATED AGENT Webster Myers

ADDRESS 1614 7th AVE
Huntington, W. VA. 25703

LOCATION: Elevation 670

Watershed EAST FORK OF 12 POLE CREEK

Dist. UNION County WAYNE Quad. COYANDOT

Gas Purchase Contract No. ---

Meter Chart Code ---

Date of Contract Sept. 27, 53

WELL OPERATOR DAVID Gas Co

ADDRESS 1614 7th AVE
Huntington W. VA.

GAS PURCHASER Gas Supply Corp

ADDRESS Rt. 1, Box 5656
LAVALLETTE, W. VA.

* * * * *

Provide a complete inventory of the lease and production equipment used for the well for the previous 24 months or, if less than 24 months, the period the well has been in production. Include a complete list of equipment or processes used in connection with recognized enhanced recovery techniques during completion or production. (Attach separate sheets, if necessary.)

STANDARD WELL HEAD

List all records reasonably available to you which contain information relevant to a determination of eligibility (including production records, B&O Tax Records and royalty payment records) and indicate the location of such records:

IV-39-WC

STATE OF WEST VIRGINIA
DEPARTMENT - MINES
DIVISION - OIL AND GAS

YEAR 19__

OPERATOR

REPORT DATE

REPORT OF MONTHLY PRODUCTION
GAS VOLUMES IN MCF @ 14.73
OIL IN BARRELS @ 60 DEGREES

API	FARM	COUNTY	AVG. FLOW PRESSURE	SHUT-IN PRESSURE	TOTALS
GAS MCF		364	446	306	2119
OIL BBL	J- M- A- M- J- A- S- O- N- D-				
DAYS ON LINE			79		365

YEAR 19__

API	FARM	COUNTY	AVG. FLOW PRESSURE	SHUT-IN PRESSURE	TOTALS
GAS MCF					2023
OIL BBL	J- M- A- M- J- A- S- O- N- D-				
DAYS ON LINE					

SUMMARIZATION SCHEDULE
Section 271. 804 (b)

In accordance with Section 271.804 (b) please list all other wells which are to be used in determining this well classification under Part 271 Subpart H.

RECEIVED

RECEIVED

API NUMBERS

AUG 5 1980

OIL & GAS DIVISION
DEPT. OF MINES

OIL & GAS DIVISION
DEPT. OF MINES

A142 = 1111
5025

02/09/2024

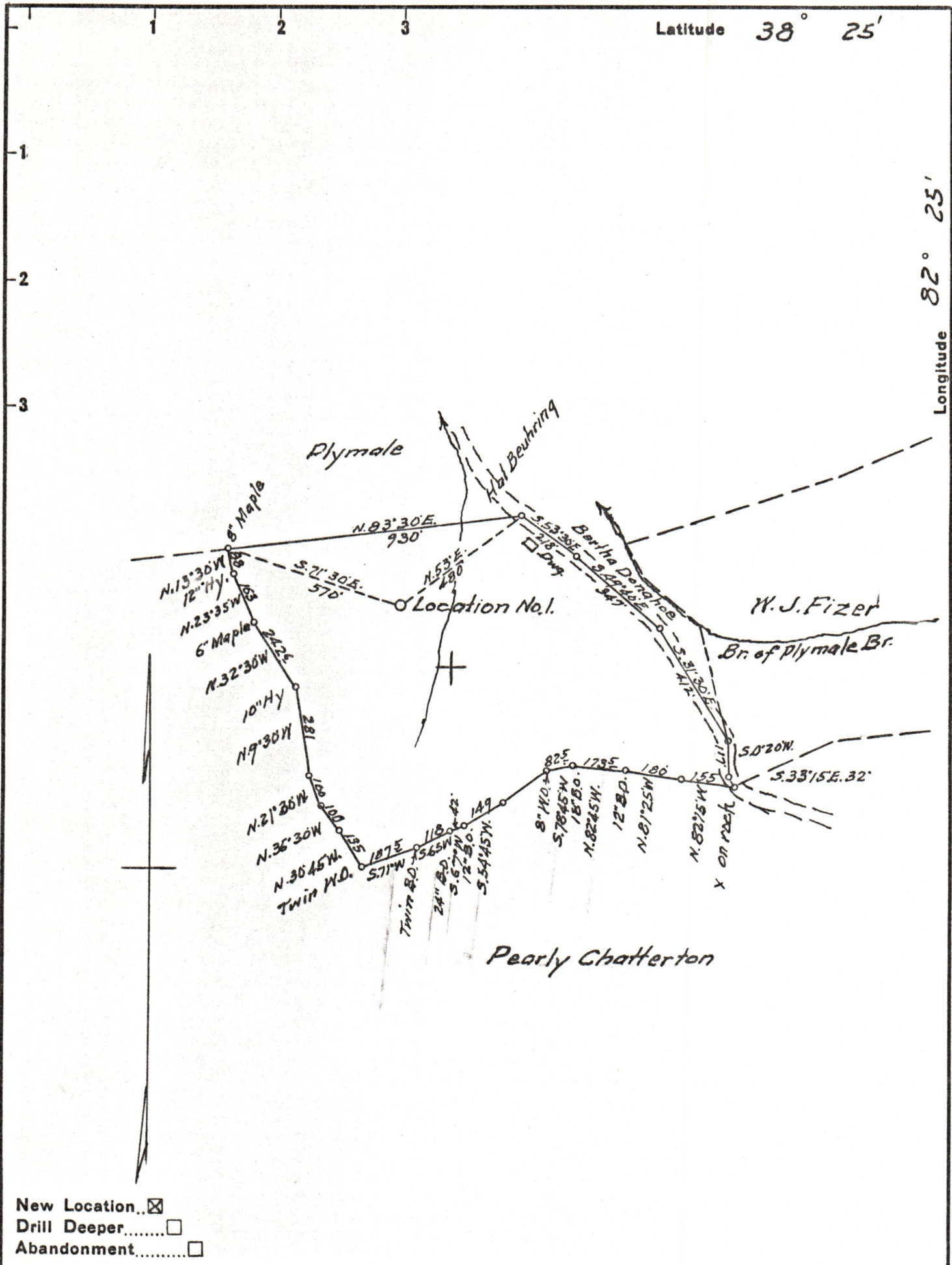

New Location..
 Drill Deeper.....
 Abandonment.....

Company WEBSTER MYERS
 Address HUNTINGTON, W.VA.
 Farm PAUL CROCKETT
 Tract _____ Acres 30 Lease No. _____
 Well (Farm) No. 1 Serial No. _____
 Elevation (Spirit Level) 670
 Quadrangle GUYANDOT
 County WAYNE District UNION
 Engineer A. E. Ewing
 Engineer's Registration No. 309
 File No. _____ Drawing No. _____
 Date 6-26-54 Scale 1"=400'

STATE OF WEST VIRGINIA
 DEPARTMENT OF MINES
 OIL AND GAS DIVISION
 CHARLESTON

WELL LOCATION MAP
 FILE NO. WAY-932

+ Denotes location of well on United States Topographic Maps, scale 1 to 62,500, latitude and longitude lines being represented by border lines as shown.
 - Denotes one inch spaces on border line of original tracing.

02/09/2024