



STATE OF WEST VIRGINIA
DEPARTMENT OF MINES
OIL AND GAS DIVISION

NOTICE OF PROPOSED LOCATION OF OIL AND GAS WELL

To THE DEPARTMENT OF MINES,
Charleston, W. Va.

R. K. Fry
COAL OPERATOR OR COAL OWNER not operated.
Route # 1, Wayne, W. Va.
ADDRESS

Webster Myers,
NAME OF WELL OPERATOR
1614 Seventh Avenue,
Huntington, W. Va.
COMPLETE ADDRESS

COAL OPERATOR OR COAL OWNER
ADDRESS

June 23rd, 19 56
PROPOSED LOCATION
Union District

R. K. Fry
OWNER OF MINERAL RIGHTS
Route # 1, Wayne, W. Va.
ADDRESS

Wayne County
Well No. 1 38° 20'
82° 25'
R. K. Fry Farm

GENTLEMEN:

The undersigned well operator is entitled to drill upon the above named farm or tract of land for oil and gas, having fee title thereto, (or as the case may be) under grant or lease dated Oct. 27th, 1955, made by R. K. Fry, to Webster Myers, and recorded on the 9th day of June, 1956, in the office of the County Clerk for said County in Book 45, page 546.

The enclosed plat was prepared by a competent engineer and shows the proposed location of a well to be drilled for oil and gas by the undersigned well operator on the farm and in the Magisterial District and County above named, determined by survey and courses and distances from two permanent points, or land marks.

The undersigned well operator is informed and believes there are no coal operators operating beds of coal beneath said farm or tract of land on which said well is located, or within 500 feet of the boundaries of the same, who have mapped their workings and filed their maps as required by law, excepting the coal operators or coal owners (if any) above named as addressees.

The above named coal operators or coal owners (if any) are notified that any objections they may desire to make to such proposed location, or which they are required to make by Section 3 of said Code, if the drilling of a well at said proposed location will cause a dangerous condition in or about their respective coal mines, must be received by, or filed with the Department of Mines within ten* days from the receipt of a copy of this notice and accompanying plat by said Department. Said coal operators are further notified that forms for use in making such objections will be furnished to them by the Department of Mines promptly on request and that all such objections must set forth as definitely as is reasonably possible the ground or grounds on which such objections are based and indicate the direction and distance the proposed location should be moved to overcome same.

(The next paragraph is to be completed only in Department's copy.)

Copies of this notice and the enclosed plat were mailed by registered mail, or delivered to the above named coal operators or coal owners at their above shown respective address _____ day _____ before, or on the same day with the mailing or delivery of this copy to the Department of Mines at Charleston, West Virginia.

Very truly yours,

Webster Myers
WELL OPERATOR
1614 Seventh Avenue,
STREET
Huntington
CITY OR TOWN
West Virginia.
STATE

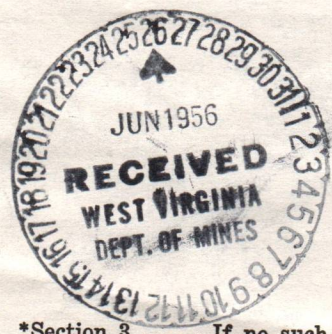

Address of Well Operator }

02/02/2024

*Section 3 If no such objections be filed or be found by the department of mines, within said period of ten days from the receipt of said notice and plat by the department of mines, to said proposed location, the department shall forthwith issue to the well operator a drilling permit reciting the filing of such plat, that no objections have been made by the coal operators to the location, or found thereto by the department, and that the same is approved and the well operator authorized to proceed to drill at said location.

1017



STATE OF WEST VIRGINIA
DEPARTMENT OF MINES
OIL AND GAS DIVISION

NOTICE OF PROPOSED LOCATION OF OIL AND GAS WELL

To The Department of Mines
Charleston, W. Va.

OWNER OF MINERAL RIGHTS
R. K. Fry
Route # 1, Wayne, W. Va.
ADDRESS

COAL OPERATOR OR COAL OWNER
not operated.
NAME OF WELL OPERATOR
Webster Myers
1614 Seventh Avenue,
Huntington, W. Va.
COMPLETE ADDRESS

PROPOSED LOCATION
June 23rd
1956

COUNTY
Wayne

WELL No. I

TOWN
R. K. Fry

The undersigned well operator is entitled to drill upon the above named farm or tract of land for oil and gas, having in this respect, (or as the case may be) under grant or lease dated Oct. 27th, 1955, made by R. K. Fry, and recorded on the 9th day of June, 1956, in the office of the County Clerk for said County in Book 45 page 346.

The enclosed plat was prepared by a competent engineer and shows the proposed location of a well to be drilled for oil and gas by the undersigned well operator on the farm and in the Mineral District and County above named, determined by survey and courses and distances from two permanent points on land marks.

The undersigned well operator is informed and believes there are no coal operators operating lands of coal beneath said farm or tract of land on which said well is located, or within 500 feet of the bounds of the same, who have tagged their workings and filed their maps as required by law, excepting the coal operators or coal owners (if any) above named as addressees.

The above named coal operators or coal owners (if any) are notified that any objections they may desire to make to such proposed location, or which they are required to make by Section 3 of said Code, if the drilling of a well at said proposed location will cause a dangerous condition in or about their respective coal mines, must be received by, or filed with the Department of Mines within ten days from the receipt of a copy of this notice and accompanying plat by said Department. Said coal operators are further notified that forms for use in making such objections will be furnished to them by the Department of Mines promptly on request and that all such objections must set forth as definitely as is reasonably possible the ground or grounds on which such objections are based and indicate the direction and distance the proposed location should be moved to overcome same.

(The next paragraph is to be completed only in Department's copy.)

Copies of this notice and the enclosed plat were mailed by registered mail, or delivered to the above named coal operators or coal owners at their above shown respective address _____ day _____ before _____ on the same day with the mailing or delivery of this copy to the Department of Mines at Charleston, West Virginia.

Very truly yours,

Webster Myers
WELL OPERATOR
1614 Seventh Avenue,
Huntington
West Virginia.



02/02/2024

Section 8. If no such objection be filed or be found by the department of mines within said period of ten days from the receipt of said notice and plat by the department of mines, to said proposed location, the department shall forthwith issue to the well operator a written permit setting the date of such plat, that no objections have been made by the coal operators to the location or found located by the department, and that the same is approved and the well operator authorized to proceed to drill at said location.



STATE OF WEST VIRGINIA
DEPARTMENT OF MINES
OIL AND GAS DIVISION

WELL RECORD

Oil or Gas Well Gas (KIND)

Permit No. Way-1017

Quadrangle *Maryland*

202/20/20

Company Big Creek Gas Company (Webster Myers)

Address 1614 7th Ave., Huntington, W. Va.

Farm R.K. Fry

Location (waters) Big Creek

Well No. 1

District Union

County Wayne

Elev. 655

The surface of tract is owned in fee by R.K. Fry

Address Same

Mineral rights are owned by Same

Drilling commenced July 7, 1956

Drilling completed Oct 28, 1956

Date Shot and shot from Oct 29, 1956

With 1st shot 200 lbs gel and shot 1050 lbs gel

Open Flow 8/10ths Water in 2

Volume 120 M

Rock Pressure 1200 lbs.

Oil 20 hrs., 1st 24 hrs.

Fresh water 250 l barrel per hr

Salt water 965 Hole In 1 hr

Bottom	Top	Hard or Soft	Color	Formation
15	0			State
35	15			Sand
43	35			State
60	43			Sand
140	60			State
175	140			Sand
260	175			State
260	260			Sand
280	260			State
345	280			State
410	345			Sand
540	410			State
680	540			Sand, broken
935	680			State
1130	935			Salt Sand
1155	1130			State
1205	1155			Maxon Sand
1230	1205			State
1246	1230			Little Lime
1248	1246			Pencil Cave
1248	1248			Big Lime
1396	1248			Injun Sand
1500	1396			State & shells
2045	1500			Cottie shale
2074	2045			Berea Sand
2094	2074			Sandy Shells
2105	2094			State
2152	2105			Brown Shale
2260	2152			State
2490	2260			Brown Shale
2550	2490			State
2600	2550			Brown Shale
2710	2600			State
2735	2710			State
2800	2735			Brown Shale
2818	2800			State
2918	2818			Brown Shale
3100	2918			State
3123	3100			Brown Shale
3190	3123			Corniferous Lime

Water fresh at 25 ft
Salt water 1 bbl per hr 350
Hole full water 965

Show of gas 2860
Gas at 2880 2/10 Water 1"
Gas at 3305 increased to 4/10 W
1" opening-Hyd. Sulphide gas
Water at 3295-Heavy with Hyd
Sulphide

7" casing set 2163
gas increased to 5/10 Water 2"
at 3793-Well shot twice blew
open 10 days tested 8/10 Water
2"
Big six 3790 to 3800
Slate 3800 to 3828
total depth 3828

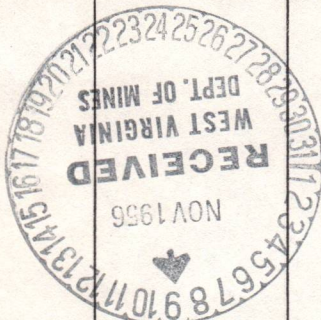

(Over)

STATE OF WEST VIRGINIA
DEPARTMENT OF MINES
OIL AND GAS DIVISION

INSPECTOR'S WELL REPORT

Permit No. Way-1017

Oil or Gas Well _____
(KIND)

Company Belster Myers
 Address 1614-7th Ave
Huntington, W.Va
 Farm R.K. Fry
 Well No. 1
 District Union County Wayne
 Drilling commenced 4-7-56
 Drilling completed _____ Total depth _____
 Date shot _____ Depth of shot _____
 Initial open flow _____ /10ths Water in _____ Inch
 Open flow after tubing _____ /10ths Merc. in _____ Inch
 Volume _____ Cu. Ft.
 Rock pressure _____ lbs. _____ hrs.
 Oil _____ bbls., 1st 24 hrs.
 Fresh water _____ feet _____ feet
 Salt water _____ feet _____ feet

CASING AND TUBING	USED IN DRILLING	LEFT IN WELL	PACKERS
Size			Kind of Packer _____
16			Size of _____
13	19'		Depth set _____
10			Perf. top _____
8 1/4			Perf. bottom _____
6 5/8			Perf. top _____
5 3/16			Perf. bottom _____
3			
2			
Liners Used			

CASING CEMENTED _____ SIZE _____ No. FT. _____ Date _____
 COAL WAS ENCOUNTERED AT _____ FEET _____ INCHES
 _____ FEET _____ INCHES FEET _____ INCHES
 _____ FEET _____ INCHES FEET _____ INCHES

Drillers' Names Belster Myers (tools)

Remarks: Drilling at 50 feet.

7-9-56
DATE

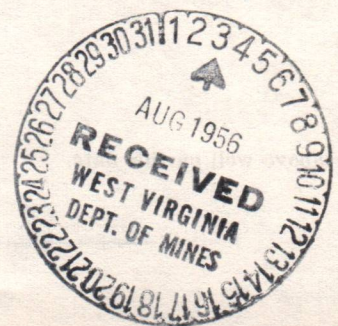

O.C. Allen
DISTRICT WELL INSPECTOR

02/02/2024

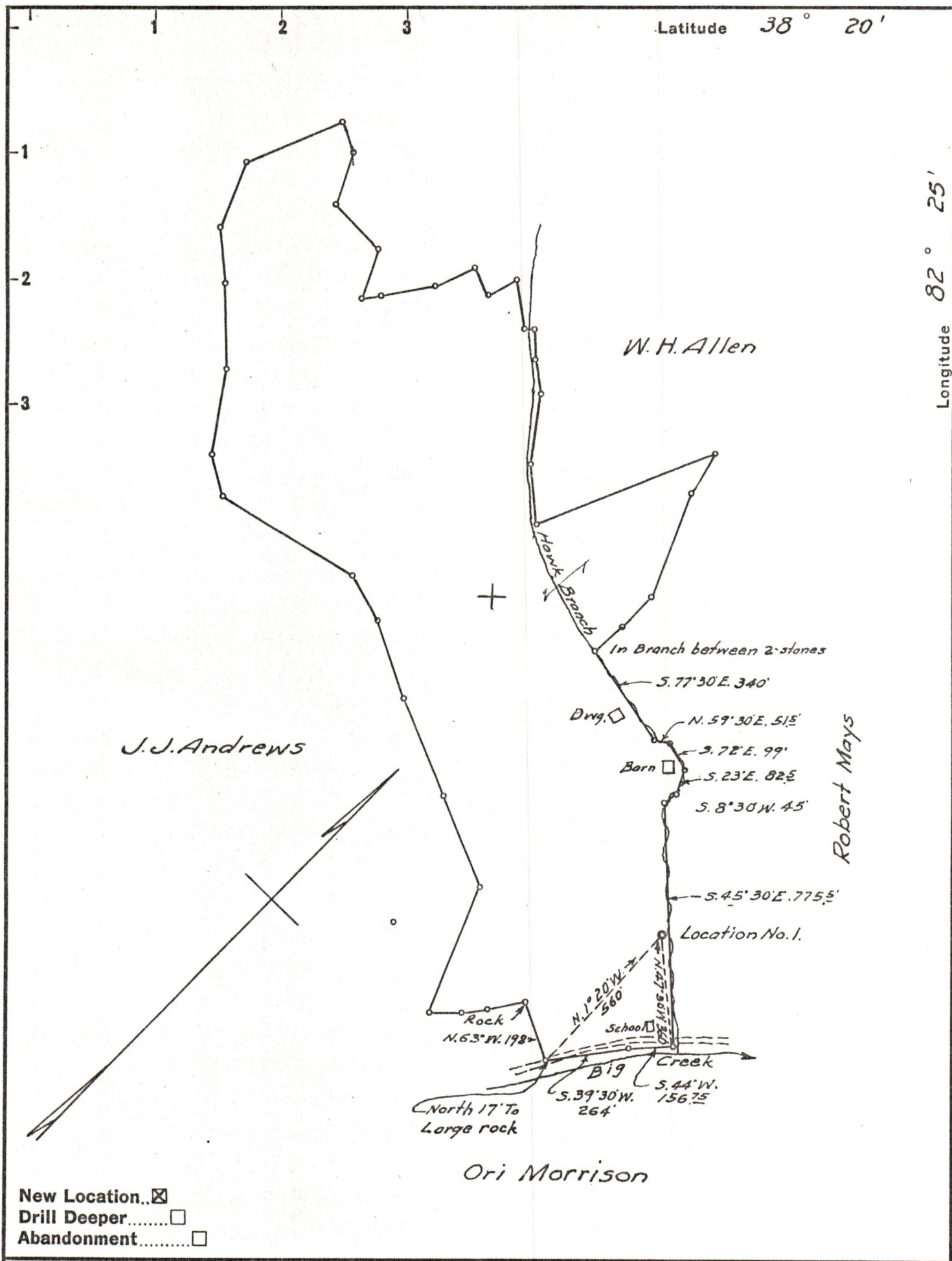

Company WEBSTER MYERS

Address HUNTINGTON, W. VA.

Farm R. K. FRY

Tract _____ Acres 57 Lease No. _____

Well (Farm) No. 1 Serial No. _____

Elevation (Spirit Level) 655

Quadrangle GUYANDOT

County WAYNE District UNION

Engineer G. E. Cawing

Engineer's Registration No. 309

File No. _____ Drawing No. _____

Date 6-12-56 Scale 1" = 400'

STATE OF WEST VIRGINIA
 DEPARTMENT OF MINES
 OIL AND GAS DIVISION
 CHARLESTON

WELL LOCATION MAP
 FILE NO. WAY-1017 02/02/2024

+ Denotes location of well on United States Topographic Maps, scale 1 to 62,500, latitude and longitude lines being represented by border lines as shown.

- Denotes one inch spaces on border line of original tracing.