



STATE OF WEST VIRGINIA
DEPARTMENT OF MINES
OIL AND GAS DIVISION

NOTICE OF PROPOSED LOCATION OF OIL AND GAS WELL

To THE DEPARTMENT OF MINES,
Charleston, W. Va.

No mines being operated
COAL OPERATOR OR COAL OWNER

R.B. Eichholz + Joe B. Hyman
NAME OF WELL OPERATOR

ADDRESS

216 Prince St. Alexandria Virginia
COMPLETE ADDRESS

None
COAL OPERATOR OR COAL OWNER

Sept 20, 1957
PROPOSED LOCATION

Mamie Ribbe (widow)
Elsie Wellman Vaughan (widow)
OWNER OF MINERAL RIGHTS

Butler District
Wayne County

Kenova, West Virginia
ADDRESS

Well No. # 1 Lat. 38° 15'
Long. 82° 30' Elev. 850.0'
Harold Lycan (Sun) Farm

GENTLEMEN:

The undersigned well operator is entitled to drill upon the above named farm or tract of land for oil and gas, having fee title thereto, (or as the case may be) under grant or lease dated Oct 10 - 1954, made by Mamie Ribbe + Elsie Wellman Vaughan, to Wayne Lycan + E. E. Mc Clure, and recorded on the 27 day of April 1957, in the office of the County Clerk for said County in Book 47, page 61.

The enclosed plat was prepared by a competent engineer and shows the proposed location of a well to be drilled for oil and gas by the undersigned well operator on the farm and in the Magisterial District and County above named, determined by survey and courses and distances from two permanent points, or land marks.

The undersigned well operator is informed and believes there are no coal operators operating beds of coal beneath said farm or tract of land on which said well is located, or within 500 feet of the boundaries of the same, who have mapped their workings and filed their maps as required by law, excepting the coal operators or coal owners (if any) above named as addressees.

The above named coal operators or coal owners (if any) are notified that any objections they may desire to make to such proposed location, or which they are required to make by Section 3 of said Code, if the drilling of a well at said proposed location will cause a dangerous condition in or about their respective coal mines, must be received by, or filed with the Department of Mines within ten* days from the receipt of a copy of this notice and accompanying plat by said Department. Said coal operators are further notified that forms for use in making such objections will be furnished to them by the Department of Mines promptly on request and that all such objections must set forth as definitely as is reasonably possible the ground or grounds on which such objections are based and indicate the direction and distance the proposed location should be moved to overcome same.

(The next paragraph is to be completed only in Department's copy.)

Copies of this notice and the enclosed plat were mailed by registered mail, or delivered to the above named coal operators or coal owners at their above shown respective address _____ day _____ before, or on the same day with the mailing or delivery of this copy to the Department of Mines at Charleston, West Virginia.

Very truly yours,

R.B. Eichholz + J.B. Hyman
By Wayne Lycan WELL OPERATOR

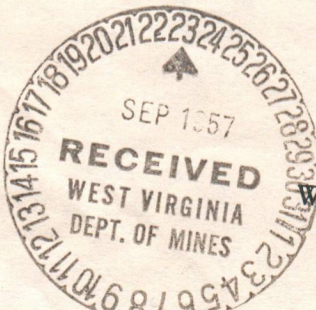

Address of Well Operator }

216 Prince St. STREET
Alexandria CITY OR TOWN
Virginia STATE

08/18/2023

*Section 3 If no such objections be filed or be found by the department of mines, within said period of ten days from the receipt of said notice and plat by the department of mines, to said proposed location, the department shall forthwith issue to the well operator a drilling permit reciting the filing of such plat, that no objections have been made by the coal operators to the location, or found thereto by the department, and that the same is approved and the well operator authorized to proceed to drill at said location.

1059

D 10

Ft. Gay W. Va.
Sept. 20 1957

Dept of Mines,
Oil & Gas Division
Mr. C. H. Hall,
Charleston, West Virginia

Dear Sir,

Enclosed find the well record of Emma Lalonde
Well # 1, also notice of proposed location of new
well, with sketch of same.

You please return the sketch to me, after you
have made your blueprints from it, as I want to
have 4 or 5 made my self.

Thanking you for your cooperation,
I am,

yours very truly

Wayne Lycan

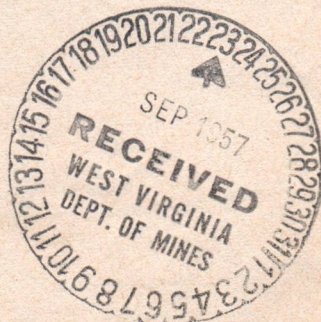

08/18/2023

A 11



STATE OF WEST VIRGINIA

DEPARTMENT OF MINES

CHARLESTON

September 23, 1957

CRAWFORD L. WILSON
CHIEF

LEE M. MORRIS
ASSISTANT CHIEF

2077
1659

Mr. Wayne Lycan
Fort Gay, West Virginia

Dear Mr. Lycan:

We are in receipt of your application to drill Well No. 1 on F. Wellman Heirs Tract, Butler District, Wayne County by R. B. Eichholz and J. B. Hyman of Alexandria, Virginia and you request the return of the tracing.

The tracing of the map must remain on file in this office, however, we wish to obtain the address of your Engineer, Mr. Lavan E. Wallace, so that the map can be returned to him for some correction that is needed and, if you will instruct him to prepare some blue prints for you, it can be done at that time.

Please give us the engineer's address as soon as possible so that permit for the drilling need not be delayed.

Very truly yours,

W. E. Griffith
Assistant Director
OIL AND GAS DIVISION

G:g

cc Mr. Ivan T. Henson, Inspector

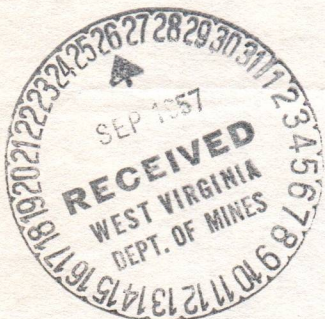

(address)

*Lavan E. Wallace, Civil Engineer,
R. F. D. # 1,
Louisa, Kentucky.*

*Very truly yours,
Wayne Lycan.*

08/18/2023



STATE OF WEST VIRGINIA

DEPARTMENT OF MINES

CHARLESTON

September 23, 1928

CRAWFORD & WILSON
CHIEF

Mr. Wayne Lyden
Fort Gay, West Virginia

Dear Mr. Lyden:

We are in receipt of your application for
drill well No. 1 on F. Wellman Heintz Tract, Butler District,
Wayne County by W. B. Bishnois and J. E. Hyman of Alexandria,
Virginia and you request the return of the tracing.

The tracing of the map must remain on file
in this office, however, we wish to obtain the address of
your Engineer, Mr. Lavan B. Wallace, so that the map
can be returned to him for some correction that is needed
and, if you will instruct him to prepare some blue prints
for you, it can be done at that time.

Please give us the engineer's address as
soon as possible so that permit for the drilling need not
be delayed.

Very truly yours,

Assistant Director
OIL AND GAS DIVISION

cc Mr. Ivan T. Hanson, Inspector



Labron F. Moller, Civil Engineer

R. F. H. # 1

Journal - Kentucky

08/18/2023

A 12

October 2, 1957

Mr. Ivan T. Henson, Inspector
Oil and Gas Wells
331 Elaine Court
Huntington, West Virginia

Dear Mr. Henson:

We have given verbal permission to Eichholt
and Hyman to begin operations of drilling Well No. 1 on Harold
Lycan Farm, Butler District, Wayne County. Mr. E. C. McClure
of Fort Gay, West Virginia is the Contractor.

Very truly yours,

Director
OIL AND GAS DIVISION

MG:g

cc Mr. E. C. McClure
c/o Wayne Lycan
Fort Gay, West Virginia

08/18/2023

Formation	Color	Hard or Soft	Top	Bottom	Oil, Gas or Water	Depth Found	Remarks
			5123				
			5131	5123			
			5105	5131			
			1830	5105			
			1830	1830			
			1282	1830			
			1280	1282			
			1290	1280			
			1225	1290			
			1212	1225			
			1342	1212			
			810	1342			
			892	810			
			820	892			
			852	820			
			880	852			
			820	880			
			830	820			
			802	830			
			802	802			
			820	802			
			870	820			
			812	870			
			810	812			
			810	810			

08/18/2023

MEET RECORD

Date _____, 19____

APPROVED _____, Owner

By _____ (Title)



STATE OF WEST VIRGINIA
DEPARTMENT OF MINES
OIL AND GAS DIVISION

QUADRANGLE - LOUISA, W.VA.

WELL RECORD

Permit No. WAY-1059

Oil or Gas Well Gas
(KIND)

Company J.B.Hyman & R.B.Eichholz
Address 216 Prince St. Alexandria, Va.
Farm Harold Lycan Acres 158
Location (waters) Left Fork Hurricane Creek
Well No. One Elev. 850 ft.
District Butler County Wayne
The surface of tract is owned in fee by Harold Lycan
Address Fert Gay, W.Va.
Mineral rights are owned by Elsie Wellman Vaughn & Mamie Wellman Rife
Address Keneva, W.Va.
Drilling commenced Sep. 30th, 1957
Drilling completed Nov. 4th, 1957
Date Shot Nov. 12th From 2153 To 2131
With 1000 lbs. Gelatin

Casing and Tubing	Used in Drilling	Left in Well	Packers
Size			Kind of Packer
16			
13			
10 19	19	19	Size of
8 1/4			
6 5/8 1552		1552	Depth set <u>Shoe</u>
5 3/16			
3			Perf. top
2			Perf. bottom
Liners Used			Perf. top
One inch syphon		2150	Perf. bottom <u>C</u>

Open Flow /10ths Water in _____ Inch
4 /10ths Merc. in 2 Inch
Volume 311,000 Cu. Ft.
Rock Pressure 590 lbs. 12 hrs.
Oil None bbls., 1st 24 hrs.
Fresh water 100 to 500 feet
Salt water 910 feet

CASING CEMENTED _____ SIZE _____ No. Ft. _____ Date _____
COAL WAS ENCOUNTERED XX None FEET INCHES
_____ FEET INCHES FEET INCHES
_____ FEET INCHES FEET INCHES

Formation	Color	Hard or Soft	Top	Bottom	Oil, Gas or Water	Depth Found	Remarks
Sur			0	19			
Slate			19	210			
Sand broken			210	2.50			
Slate			250	488			
Sand			488	505			
Slate			505	630			
Sand			630	650			
Slate			650	690			
Sand			690	725			
Slate			725	850			
Sand			850	865			
Slate			865	910			
Salt Sand			910	1345			
Big Lime			1345	1515			
Big Injun Sand			1515	1552			
Slate Shells			1552	1560			
Sandy Lime			1560	1580			
Broken Sand			1580	1625			
Sand			1625	1730			
Shale			1730	1830			
Slate			1830	2102			
Brown Coffee Shale			2102	2131			
Berea Sand			2131	2153			
Bottom Hole			2153				

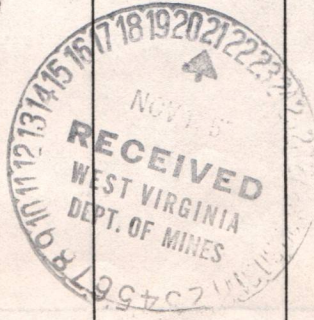

08/18/2023

STATE OF WEST VIRGINIA
DEPARTMENT OF MINES
OIL AND GAS DIVISION

INSPECTOR'S WELL REPORT

Permit No. Way 1059

Oil or Gas Well _____
(KIND)

Company <u>Wayne Sygan</u>	CASING AND TUBING	USED IN DRILLING	LEFT IN WELL	PACKERS
Address <u>Tortway W Va</u>	Size			
Farm <u>Harold Sycone</u>	16			Kind of Packer
Well No. <u>1</u>	13			
District <u>Butler</u> County <u>Wayne</u>	10			Size of
Drilling commenced _____	8 1/4			
Drilling completed _____ Total depth _____	6 5/8			Depth set
Date shot _____ Depth of shot _____	5 3/16			
Initial open flow _____ /10ths Water in _____ Inch	3			Perf. top
Open flow after tubing _____ /10ths Merc. in _____ Inch	2			Perf. bottom
Volume _____ Cu. Ft.	Liners Used			Perf. top
Rock pressure _____ lbs. _____ hrs.				Perf. bottom
Oil _____ bbls., 1st 24 hrs.	CASING CEMENTED _____ SIZE _____ No. FT. _____ Date _____			
Fresh water _____ feet _____ feet	COAL WAS ENCOUNTERED AT _____ FEET _____ INCHES			
Salt water _____ feet _____ feet	_____ FEET _____ INCHES _____ FEET _____ INCHES			

Drillers' Names _____

Remarks: This well is shut down no one
there at 12:30 PM

11/14/57
DATE

RECEIVED
NOV 1 57
WEST VIRGINIA
DEPT. OF MINES
Juan T Henson
DISTRICT WELL INSPECTOR
08/18/2023

STATE OF WEST VIRGINIA
DEPARTMENT OF MINES
OIL AND GAS DIVISION

INSPECTOR'S PLUGGING REPORT

Permit No. _____ Well No. _____

COMPANY _____ ADDRESS _____

FARM _____ DISTRICT _____ COUNTY _____

Filling Material Used _____

Liner			Location	Amount	Packer	Location	
PLUGS USED AND DEPTH PLACED			BRIDGES		CASING AND TUBING		
CEMENT-THICKNESS	WOOD-SIZE	LEAD	CONSTRUCTION-LOCATION		RECOVERED	SIZE	LOST

Drillers' Names _____

Remarks: _____

_____ I hereby certify I visited the above well on this date.
DATE

DISTRICT WELL INSPECTOR
08/18/2023

Latitude 38° 15'

Longitude 82° 30'

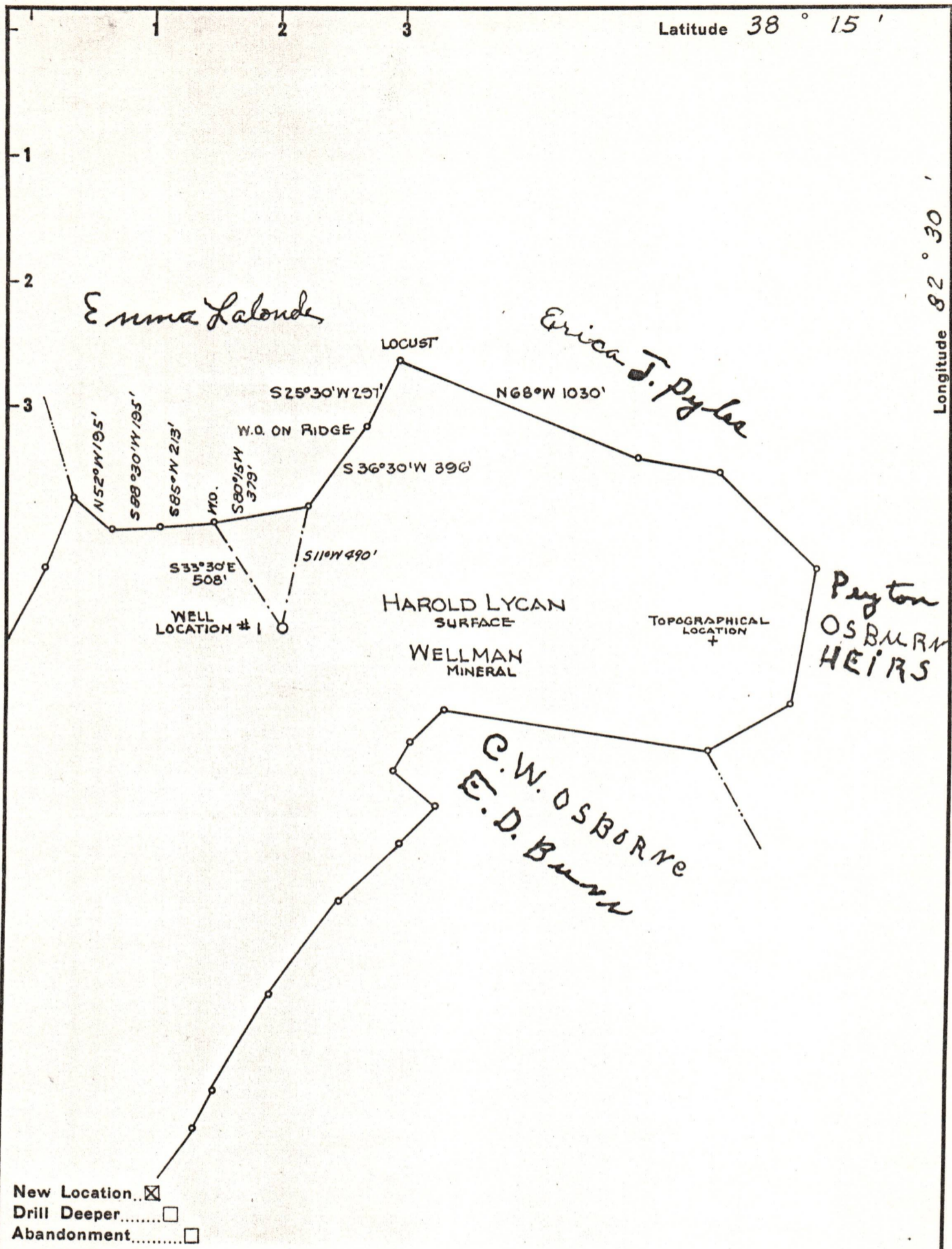

- New Location...
- Drill Deeper.....
- Abandonment.....

Company R.B.EICHHOLZ & J.B.HYMAN
 Address ALEXANDRA, VA.
 Farm F. WELLMAN HRS
 Tract _____ Acres 100+ Lease No. _____
 Well (Farm) No. 1 Serial No. _____
 Elevation (Spirit Level) 850.0
 Quadrangle LOUISA, W.VA
 County WAYNE District BUTLER
 Engineer [Signature]
 Engineer's Registration No. _____
 File No. _____ Drawing No. _____
 Date SEPT. 18 1957 Scale 1" = 500'

STATE OF WEST VIRGINIA
 DEPARTMENT OF MINES
 OIL AND GAS DIVISION
 CHARLESTON

WELL LOCATION MAP

FILE NO. WAY-1059

08/18/2023

+ Denotes location of well on United States Topographic Maps, scale 1 to 62,500, latitude and longitude lines being represented by border lines as shown.

- Denotes one inch spaces on border line of original tracing.