



Civil & Environmental  
Consultants, Inc.

3574 Teays Valley Road  
Hurricane, WV 25526

Ph: 304.933.3119

www.cecinc.com

SURFACE HOLE 4005'

Top Hole Latitude: 38°12'30"



Top Hole Longitude: 82°30'00"

SURFACE HOLE 1803'

FULLER ARTHUR B JR &  
TRELMA L  
TAX MAP 7 PARCEL 24  
228.98 ACRES±

MCCOY PAMELA A  
TAX MAP 7 PARCEL 38  
18.74 ACRES±

EXISTING WELL LOCATION (SHL):  
GEOGRAPHIC (NAD83):  
LATITUDE: 38.203993°  
LONGITUDE: -82.513791°  
UTM (NAD83, ZONE 17, FEET):  
NORTHING: 13,876,389.029  
EASTING: 1,205,570.118  
UTM (NAD83, ZONE 17, METERS):  
NORTHING: 4,229,531.835  
EASTING: 367,458.507

SCALE IN FEET

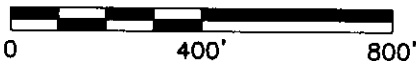

I, THE UNDERSIGNED, HEREBY CERTIFY THAT THIS PLAT IS  
CORRECT TO THE BEST OF MY KNOWLEDGE AND BELIEF AND SHOWS  
ALL THE INFORMATION REQUIRED BY LAW AND REGULATIONS ISSUED  
AND PRESCRIBED BY THE DEPARTMENT OF ENVIRONMENTAL PROTECTION.

P.S. 2396

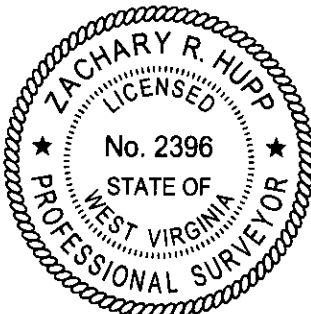

1. SURFACE AND ROYALTY OWNER INFORMATION AND THEIR  
BOUNDARIES SHOWN HEREON WERE PLOTTED FROM DEEDS AND/OR  
TAX PARCEL MAPS PROVIDED BY CLIENT AND/OR FIELD LOCATIONS.
2. THIS PLAT DOES NOT REPRESENT A BOUNDARY SURVEY OF THE  
PARCELS SHOWN HEREON.
4. ALL INSETS ARE GRID NORTH UNLESS OTHERWISE DEPICTED.

COMPANY:

**EAGLE WELL  
SERVICE, INC.**



(+) DENOTES LOCATION OF WELL ON  
UNITED STATES TOPOGRAPHIC MAPS

WVDEP  
OFFICE OF OIL & GAS  
601 57TH STREET  
CHARLESTON, WV 25034

MINIMUM DEGREE  
OF ACCURACY: 1/200

PROVEN SOURCE  
OF ELEVATION: SURVEY  
GRADE GPS  
(NAVD 88, US FT)

OPERATOR'S WELL #: 2

API WELL #: 47 099 01071  
STATE COUNTY PERMIT

WELL TYPE: OIL ☐ WASTE DISPOSAL ☐ PRODUCTION ☐ DEEP ☐ GAS ☒ LIQUID INJECTION ☐ STORAGE ☐ SHALLOW ☒

WATERSHED: WHITES CREEK-BIG SANDY RIVER

DISTRICT: BUTLER COUNTY: WAYNE

SURFACE OWNER: SCOTT CLIFFORD K & MELISSA D

OIL & GAS ROYALTY OWNER: N/A

ELEVATION: 640.92

QUADRANGLE: PRICHARD

ACREAGE: 30.48 ±

ACREAGE: N/A

DRILL ☐ DRILL DEEPER ☐ REDRILL ☐ FRACTURE OR STIMULATE ☐ PLUG OFF OLD FORMATION ☐ PERFORATE NEW FORMATION ☐

CONVERT ☐ PLUG & ABANDON ☒ CLEAN OUT & REPLUG ☐ OTHER CHANGE ☐ (SPECIFY)

TARGET FORMATION: N/A

ESTIMATED DEPTH: TVD TMD

WELL OPERATOR: UNKNOWN WVDEP PAID PLUGGING CONTRACT

DESIGNATED AGENT: JASON HARMON

ADDRESS: 601 57TH STREET

ADDRESS: 601 57TH STREET

CITY: CHARLESTON

STATE: WV

ZIP CODE: 25304 (WVDEP)

CITY: CHARLESTON

STATE: WV

ZIP CODE: 25304

LEGEND:

ACTIVE PRODUCING WELLHEAD

ABANDONED WELLHEAD

----- LEASE BOUNDARY  
----- ADJOINER LINE  
----- EXISTING ROAD  
----- EXISTING STREAM

REVISIONS:

DATE: 10-25-2025

356-112

DRAWN BY: S.C.S.

SCALE: 1" = 400'

DRAWING NO: 356-112

WELL LOCATION PLAT

ACCESS TO THE WELL SITE WILL BE GAINED USING AN EXISTING ACCESS ROAD OFF OF WAYNE COUNTY ROUTE 18/2. 350 FEET OF EXISTING ACCESS ROAD TO BE MAINTAINED AS NEEDED FOR PLUGGING OPERATIONS. DRAINAGE TO BE MAINTAINED. WELL SITE TO BE RECLAIMED AFTER WELL WORK. TOPSOIL IF ANY TO BE STOCKPILED FOR USE IN RECLAMATION.

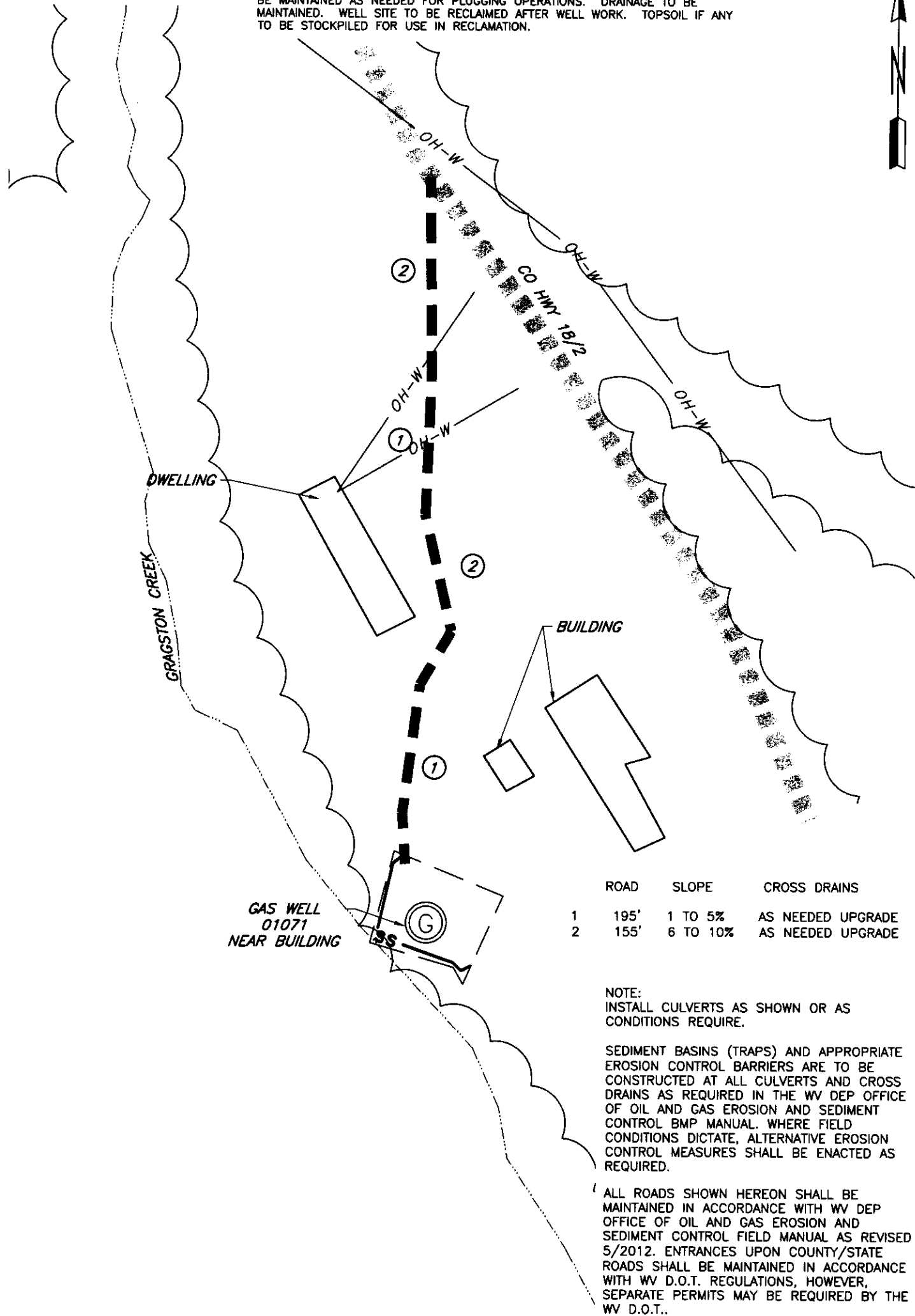

	ROAD	SLOPE	CROSS DRAINS
1	195'	1 TO 5%	AS NEEDED UPGRADE
2	155'	6 TO 10%	AS NEEDED UPGRADE

NOTE:  
INSTALL CULVERTS AS SHOWN OR AS  
CONDITIONS REQUIRE.

SEDIMENT BASINS (TRAPS) AND APPROPRIATE  
EROSION CONTROL BARRIERS ARE TO BE  
CONSTRUCTED AT ALL CULVERTS AND CROSS  
DRAINS AS REQUIRED IN THE WV DEP OFFICE  
OF OIL AND GAS EROSION AND SEDIMENT  
CONTROL BMP MANUAL. WHERE FIELD  
CONDITIONS DICTATE, ALTERNATIVE EROSION  
CONTROL MEASURES SHALL BE ENACTED AS  
REQUIRED.

ALL ROADS SHOWN HEREON SHALL BE  
MAINTAINED IN ACCORDANCE WITH WV DEP  
OFFICE OF OIL AND GAS EROSION AND  
SEDIMENT CONTROL FIELD MANUAL AS REVISED  
5/2012. ENTRANCES UPON COUNTY/STATE  
ROADS SHALL BE MAINTAINED IN ACCORDANCE  
WITH WV D.O.T. REGULATIONS, HOWEVER,  
SEPARATE PERMITS MAY BE REQUIRED BY THE  
WV D.O.T..

EARTHWORK CONTRACTORS ARE RESPONSIBLE  
FOR NOTIFICATIONS TO THE OPERATOR AND  
INSPECTOR PRIOR TO ANY DEVIATION FROM  
THIS PLAN.

01/23/2026

NOT TO SCALE

- LEGEND:
- EXISTING WELLHEAD
  - DIVERSION DITCH
  - EXISTING POWER POLE
  - ACCESS
  - SILT FENCE
  - OVERHEAD UTILITY
  - STREAM
  - TREE LINE
  - DRAINAGE
  - LANDING PAD

- NOTES
1. NO PIT WILL BE CONSTRUCTED.  
TANKS WILL BE USED FOR FLUIDS.

WELL OPERATOR:  
UNKNOWN-DEP PAID PLUGGING CONTRACT WYDEP

ADDRESS:  
601 57TH STREET, SE CHARLESTON, WV 25304

SURFACE OWNER:  
SCOTT CLIFFORD K & MELISSA D

WELL (FARM) NAME:  
FERGUSON, LAFAYETTE

COUNTY - CODE  
WAYNE - 050

DISTRICT;  
BUTLER

USGS 7 1/2 QUADRANGLE MAP NAME  
PRICHARD, WV

WELL #  
2