



STATE OF WEST VIRGINIA
DEPARTMENT OF MINES
OIL AND GAS DIVISION

NOTICE OF PROPOSED LOCATION OF OIL AND GAS WELL

To THE DEPARTMENT OF MINES,
Charleston, W. Va.

COAL OPERATOR OR COAL OWNER

ADDRESS

COAL OPERATOR OR COAL OWNER

ADDRESS

BURNIE BOOTH
OWNER OF MINERAL RIGHTS

WAYNE, W. VA.
ADDRESS

VELVET GAS CO.
PAUL DINGESS, AGT.
NAME OF WELL OPERATOR

BRANCHLAND W. VA.
COMPLETE ADDRESS

DECEMBER 29TH, 1958
PROPOSED LOCATION

BUTLER District

WAYNE County

Well No. 1 ^{38° 15'}
^{82° 35'} Elev. 652'

BURNIE BOOTH Farm
40-2-110

GENTLEMEN:

The undersigned well operator is entitled to drill upon the above named farm or tract of land for oil and gas, having fee title thereto, (or as the case may be) under grant or lease dated 5TH DECEMBER 1958, made by BURNIE BOOTH, to PAUL DINGESS AND WOODROW DINGESS, and recorded on the 5TH day of DECEMBER 1958, in the office of the County Clerk for said County in Book 49, page 260.

The enclosed plat was prepared by a competent engineer and shows the proposed location of a well to be drilled for oil and gas by the undersigned well operator on the farm and in the Magisterial District and County above named, determined by survey and courses and distances from two permanent points, or land marks.

The undersigned well operator is informed and believes there are no coal operators operating beds of coal beneath said farm or tract of land on which said well is located, or within 500 feet of the boundaries of the same, who have mapped their workings and filed their maps as required by law, excepting the coal operators or coal owners (if any) above named as addressees.

The above named coal operators or coal owners (if any) are notified that any objections they may desire to make to such proposed location, or which they are required to make by Section 3 of said Code, if the drilling of a well at said proposed location will cause a dangerous condition in or about their respective coal mines, must be received by, or filed with the Department of Mines within ten* days from the receipt of a copy of this notice and accompanying plat by said Department. Said coal operators are further notified that forms for use in making such objections will be furnished to them by the Department of Mines promptly on request and that all such objections must set forth as definitely as is reasonably possible the ground or grounds on which such objections are based and indicate the direction and distance the proposed location should be moved to overcome same.

(The next paragraph is to be completed only in Department's copy.)

Copies of this notice and the enclosed plat were mailed by registered mail, or delivered to the above named coal operators or coal owners at their above shown respective address _____ day _____ before, or on the same day with the mailing or delivery of this copy to the Department of Mines at Charleston, West Virginia.

Very truly yours, VELVET GAS CO
PAUL DINGESS, AGT.

WELL OPERATOR
BRANCHLAND
STREET

CITY OR TOWN
WEST VIRGINIA
STATE

08/18/2023

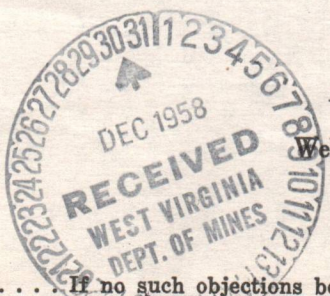

Address of Well Operator }

*Section 3 If no such objections be filed or be found by the department of mines, within said period of ten days from the receipt of said notice and plat by the department of mines, to said proposed location, the department shall forthwith issue to the well operator a drilling permit reciting the filing of such plat, that no objections have been made by the coal operators to the location, or found thereto by the department, and that the same is approved and the well operator authorized to proceed to drill at said location.

1156



STATE OF WEST VIRGINIA
DEPARTMENT OF MINES
OIL AND GAS DIVISION

NOTICE OF PROPOSED LOCATION OF OIL AND GAS WELL

To The Department of Mines
Charleston, W. Va.

VELVET GAS CO
PAUL DINGESS, AGT.
NAME OF WELL OPERATOR

BRANCHLAND W. VA.
COMPLETE ADDRESS

DECEMBER 27th 1928
PROPOSED LOCATION

BUTLER
District

WAYNE
County

Well No. 1
8 1/2 x 12
25 x 25
BURNIE BOOTH

BURNIE BOOTH
TOWN

COAL OPERATOR OR COAL OWNER

ADDRESS

COAL OPERATOR OR COAL OWNER

ADDRESS

BURNIE BOOTH
OWNER OF MINERAL RIGHTS

WAYNE, W. VA.
ADDRESS

GENTLEMEN:

The undersigned well operator is entitled to drill upon the above named farm or tract of land for oil and gas having the title thereto, (or as the case may be) under grant or lease dated _____ to _____ and recorded on the _____ day of _____ 1928, whereby BURNIE BOOTH, and recorded on the _____ day of _____ 1928, in the office of the County Clerk for said County in Book 17, page 250.

The enclosed plat was prepared by a competent engineer and shows the proposed location of a well to be drilled for oil and gas by the undersigned well operator on the farm and in the Mineral District and County above named, determined by survey and courses and distances from two permanent points or land marks.

The undersigned well operator is informed and believes there are no coal operators operating on or near the land on which said well is located, or within 300 feet of the boundary of the same, who have mapped their workings and filed their maps as required by law, excepting the coal operators or coal owners (if any) above named as addresses.

The above named coal operators or coal owners (if any) are notified that any objections they may desire to make to such proposed location or which they are required to make by Section 3 of said Code, if the drilling of a well at said proposed location will cause a dangerous condition in or about their respective coal mines, must be received by or filed with the Department of Mines within ten days from the receipt of a copy of this notice and accompanying plat by said Department. Said coal operators and further notified that forms for use in making such objections will be furnished to them by the Department of Mines promptly on request and that all such objections must set forth as definitely as is reasonably possible the ground or grounds on which such objections are based and indicate the direction and distance the proposed location should be moved to overcome same.

(The next paragraph is to be completed only in Department's copy.)
Copies of this notice and the enclosed plat were mailed by registered mail, or delivered to the above named coal operators or coal owners at their above shown respective addresses _____ (day) _____ (date) or on the same day with the mailing or delivery of this copy to the Department of Mines at Charleston, West Virginia.

Very truly yours,
PAUL DINGESS, AGT.
WELL OPERATOR

BRANCHLAND

WEST VIRGINIA

Address of Well Operator

08/18/2023

Section 3 of the Code provides that if no such objections be filed or be found by the department of mines within such period of ten days from the receipt of said notice and plat by the department of mines, to said proposed location, the department may proceed to drill at said location, and the well operator authorized to proceed to drill at said location.

Printer's Number



STATE OF WEST VIRGINIA
DEPARTMENT OF MINES
OIL AND GAS DIVISION

Quadrangle Wayne

WELL RECORD

Oil or Gas Well Oil
(KIND)

Permit No. Way-1156

Company Velvet (Velma) Gas Company
Address Branchland, (RFD 2) W. Va.
Farm Burnie Booth Acres 40
Location (waters) Patric Creek
Well No. #1 Elev. 652'
District Butler County Wayne
The surface of tract is owned in fee by Burnie Booth
Wayne Address West Virginia
Mineral rights are owned by Burnie Booth and Heirs
Wayne Address West Virginia
Drilling commenced 26 January 1959
Drilling completed 30 April 1959
Date Shot 15 Apr. From 1870' To 1890'
With Gas Well "B" (powder)
Open Flow 2/10ths Water in 1" Inch
/10ths Merc. in Inch
Volume 14000 Cu. Ft.
Rock Pressure Negative lbs. hrs.
Oil 8 bbls., 1st 24 hrs.
Fresh water 12' feet 40' feet
Salt water 800' feet 1 060 feet

Casing and Tubing	Used in Drilling	Left in Well	Packers
Size			Kind of Packer
16			<u>Anchor Packer</u>
13			Size of <u>5"</u>
10		<u>302XX</u>	Depth set <u>1800'</u>
8 1/4		<u>252' 3"</u>	Anchor Packer
6 1/2	#	<u>1990'</u>	Perf. top
5 3/16		<u>1990'</u>	Perf. bottom <u>X</u>
3			Perf. top
2 #		<u>1990'</u>	Perf. bottom
Liners Used			

CASING CEMENTED _____ SIZE _____ No. Ft. _____ Date _____

COAL WAS ENCOUNTERED AT Neg. FEET _____ INCHES
_____ FEET _____ INCHES FEET _____ INCHES
_____ FEET _____ INCHES FEET _____ INCHES

Formation	Color	Hard or Soft	Top	Bottom	Oil, Gas or Water	Depth Found	Remarks
soil	brown	soft	0'	58			
gravel & sand			5'	30'			
sand			30'	50'			
slate			50'	100'			
sand			100'	160'			
broken sand			160'	248'			
slate	grey		248'	405'			
broken sand			405'	455'			
slate	grey		455'	600'			
sand			600'	726'			
broken salt sand			726'	1060'			
little lime	white		1060'	1092'			
slate	grey		1092'	1095'			
big lime	white		1095'	1245'			
grey engine	grey		1245'	1270'			
slate & shale	grey		1270'	1340'			
engine			1340'	1460'			
slate & shells	dark		1460'	1600'			
slate & shells	dark		1600'	1814'			
slate	grey		1814'	1870'			
Brea sand	grey		1870'	1882'			
sand			1882'	1890'	oil	1870 - 1882	

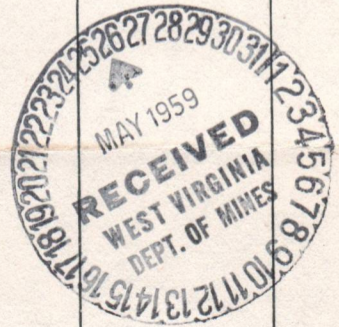

08/18/2023

STATE OF WEST VIRGINIA
DEPARTMENT OF MINES
OIL AND GAS DIVISION

INSPECTOR'S WELL REPORT

Permit No. WAY-1156

Oil or Gas Well one
(KIND)

Company <u>Velvet Gas Company</u> Address <u>Branchland, W. Va.</u> Farm <u>Burnie Booth</u> Well No. <u>1</u> District <u>Butler</u> County <u>Wayne</u> Drilling commenced _____ Drilling completed _____ Total depth _____ Date shot _____ Depth of shot _____ Initial open flow _____ /10ths Water in _____ Inch Open flow after tubing _____ /10ths Merc. in _____ Inch Volume _____ Cu. Ft. Rock pressure _____ lbs. _____ hrs. Oil _____ bbls., 1st 24 hrs. Fresh water _____ feet _____ feet Salt water _____ feet _____ feet	CASING AND TUBING USED IN DRILLING LEFT IN WELL			PACKERS Kind of Packer _____ Size of _____ Depth set _____ Perf. top _____ Perf. bottom _____ Perf. top _____ Perf. bottom _____
	Size			
	16			
	13			
	10			
	8 1/4			
	6 5/8			
	5 3/16			
	3			
	2			
	Liners Used			

Drillers' Names _____

Remarks: Machine moved in and rigging up to drill.

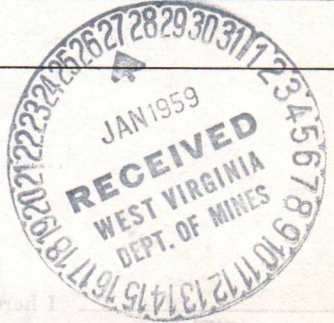

1-21-59
DATE

J.W. Pack
DISTRICT WELL INSPECTOR

08/18/2023

STATE OF WEST VIRGINIA
 DEPARTMENT OF MINES
 OIL AND GAS DIVISION
INSPECTOR'S PLUGGING REPORT

Permit No. _____ Well No. _____

COMPANY _____ ADDRESS _____

FARM _____ DISTRICT _____ COUNTY _____

Filling Material Used _____

Liner		Location		Amount	Packer	Location		
PLUGS USED AND DEPTH PLACED			BRIDGES		CASING AND TUBING			
CEMENT-THICKNESS	WOOD-SIZE	LEAD	CONSTRUCTION-LOCATION		RECOVERED	SIZE	LOST	

Drillers' Names _____

Remarks: _____

_____ I hereby certify I visited the above well on this date.
DATE

DISTRICT WELL INSPECTOR
08/18/2023

STATE OF WEST VIRGINIA
DEPARTMENT OF MINES
OIL AND GAS DIVISION

INSPECTOR'S WELL REPORT

Permit No. WAY-1156

Oil or Gas Well 1
(KIND)

Company <u>Velvet Gas Company</u> Address <u>Branchland, W. Va.</u> Farm <u>Burnie Booth</u> Well No. <u>one</u> District <u>Butler</u> County <u>Wayne</u> Drilling commenced _____ Drilling completed _____ Total depth _____ Date shot _____ Depth of shot _____ Initial open flow _____ /10ths Water in _____ Inch Open flow after tubing _____ /10ths Merc. in _____ Inch Volume _____ Cu. Ft. Rock pressure _____ lbs. _____ hrs. Oil _____ bbls., 1st 24 hrs. Fresh water _____ feet _____ feet Salt water _____ feet _____ feet	CASING AND TUBING USED IN DRILLING LEFT IN WELL			PACKERS Kind of Packer _____ Size of _____ Depth set _____ Perf. top _____ Perf. bottom _____ Perf. top _____ Perf. bottom _____
CASING CEMENTED _____ SIZE _____ No. FT. _____ Date _____				
COAL WAS ENCOUNTERED AT _____ FEET _____ INCHES				
_____ FEET _____ INCHES FEET _____ INCHES				
_____ FEET _____ INCHES FEET _____ INCHES				

Drillers' Names _____

Remarks: Visited Well #1 on the Burnie Booth farm, Butler District, Wayne County. Well not operating today; from the formation samples at well, I believe they have reached the Big Lime and have the Casing point. There is no 7" casing at well as of this date.

3-2-59

DATE

J.W. Pack
 DISTRICT WELL INSPECTOR
08/18/2023

STATE OF WEST VIRGINIA
DEPARTMENT OF MINES
OIL AND GAS DIVISION
INSPECTOR'S PLUGGING REPORT

Permit No. _____

Well No. _____

COMPANY _____ ADDRESS _____

FARM _____ DISTRICT _____ COUNTY _____

Filling Material Used _____

Liner	Location	Amount	Packer	Location			
PLUGS USED AND DEPTH PLACED			BRIDGES		CASING AND TUBING		
CEMENT-THICKNESS	WOOD-SIZE	LEAD	CONSTRUCTION-LOCATION		RECOVERED	SIZE	LOST

Drillers' Names _____

Remarks: _____

Visited well #1 on the Summit Booth farm, Butler District, Wayne County. Well not operating today; from the formation samples at well I believe they have reached the big lime and have the casing point. There is no 7" casing at well as of this date.

_____ I hereby certify I visited the above well on this date.

DATE

DISTRICT WELL INSPECTOR
08/18/2023

B-4

STATE OF WEST VIRGINIA
DEPARTMENT OF MINES
OIL AND GAS DIVISION

INSPECTOR'S WELL REPORT

Permit No. WAY-1156

Oil or Gas Well 1
(KIND)

Company <u>Velvet Gas Company</u>	CASING AND TUBING	USED IN DRILLING	LEFT IN WELL	PACKERS
Address <u>Branchland, W. Va.</u>	Size			
Farm <u>Burnie Booth</u>	16			Kind of Packer
Well No. <u>one</u>	13			
District <u>Butler</u> County <u>Wayne</u>	10	30		Size of
Drilling commenced <u>1-26-59</u>	8 1/4	252		
Drilling completed _____ Total depth _____	6 5/8	1135'		Depth set
Date shot _____ Depth of shot _____	5 3/16			
Initial open flow _____ /10ths Water in _____ Inch	3			Perf. top
Open flow after tubing _____ /10ths Merc. in _____ Inch	2			Perf. bottom
Volume _____ Cu. Ft.	Liners Used			Perf. top
Rock pressure _____ lbs. _____ hrs.				Perf. bottom
Oil _____ bbls., 1st 24 hrs.	CASING CEMENTED _____ SIZE _____ No. FT. _____ Date _____			
Fresh water <u>12</u> feet <u>80</u> feet	COAL WAS ENCOUNTERED AT _____ FEET _____ INCHES			
Salt water <u>800</u> feet _____ feet	_____ FEET _____ INCHES _____ FEET _____ INCHES			
	_____ FEET _____ INCHES _____ FEET _____ INCHES			

Drillers' Names Roy Yeager

O. H. Whited

Remarks: Salt Sand 720'-1060'; Big Lime 1095'-1245'; drilling depth @ 1560'.

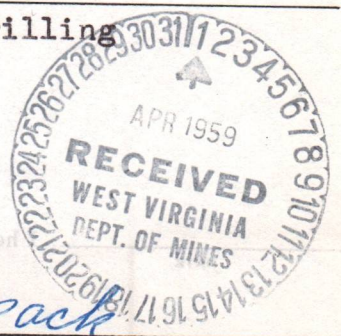

Jw. pack
DISTRICT WELL INSPECTOR

3-26-59

DATE

08/18/2023

STATE OF WEST VIRGINIA
DEPARTMENT OF MINES
OIL AND GAS DIVISION
INSPECTOR'S PLUGGING REPORT

Permit No. _____

Well No. _____

COMPANY _____ ADDRESS _____

FARM _____ DISTRICT _____ COUNTY _____

Filling Material Used _____

Liner	Location	Amount	Packer	Location		
PLUGS USED AND DEPTH PLACED			BRIDGES	CASING AND TUBING		
CEMENT-THICKNESS	WOOD-SIZE	LEAD	CONSTRUCTION-LOCATION	RECOVERED	SIZE	LOST

Drillers' Names _____

Remarks: _____

I hereby certify I visited the above well on this date.

DATE _____

DISTRICT WELL INSPECTOR

08/18/2023

13-5

STATE OF WEST VIRGINIA
DEPARTMENT OF MINES
OIL AND GAS DIVISION

INSPECTOR'S WELL REPORT

Permit No. WAY-1155

Oil or Gas Well 8771
(KIND)

Company <u>United Fuel Gas Company</u>	CASING AND TUBING	USED IN DRILLING	LEFT IN WELL	PACKERS
Address <u>P.O. Box 1273 Charleston 25, W. Va.</u>	Size			
Farm <u>U.F.G.Co. Fee Tract</u>	16			Kind of Packer
Well No. <u>8771</u>	18	<u>33'5"</u>		
District <u>Butler</u> County <u>Wayne</u>	10	<u>603'4"</u>		Size of
Drilling commenced <u>4-7-59</u>	8 1/4			
Drilling completed _____ Total depth _____	6 5/8			Depth set
Date shot _____ Depth of shot _____	5 3/16			
Initial open flow _____ /10ths Water in _____ Inch	3			Perf. top
Open flow after tubing _____ /10ths Merc. in _____ Inch	2			Perf. bottom
Volume _____ Cu. Ft.	Liners Used			Perf. top
Rock pressure _____ lbs. _____ hrs.				Perf. bottom
Oil _____ bbls., 1st 24 hrs.	CASING CEMENTED _____ SIZE _____ No. FT. _____ Date _____			
Fresh water <u>120</u> feet _____ feet	COAL WAS ENCOUNTERED AT _____ FEET _____ INCHES			
Salt water _____ feet _____ feet	_____ FEET _____ INCHES _____ FEET _____ INCHES			
	_____ FEET _____ INCHES _____ FEET _____ INCHES			

Drillers' Names Darrell Sansom

Frank Maynard

Remarks: Drilling at 700'.

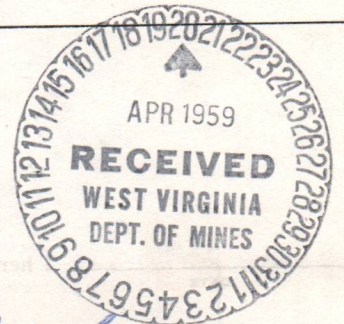

J.W. pack

DISTRICT WELL INSPECTOR

08/18/2023

4-13-59

DATE



STATE OF WEST VIRGINIA
 DEPARTMENT OF MINES
 OIL AND GAS DIVISION
INSPECTOR'S PLUGGING REPORT

Permit No. _____

Well No. _____

COMPANY _____ ADDRESS _____

FARM _____ DISTRICT _____ COUNTY _____

Filling Material Used _____

Liner			Location	Amount	Packer	Location
PLUGS USED AND DEPTH PLACED			BRIDGES		CASING AND TUBING	
CEMENT-THICKNESS	WOOD-SIZE	LEAD	CONSTRUCTION-LOCATION		RECOVERED	SIZE LOST

Drillers' Names _____

Remarks: _____

_____ I hereby certify I visited the above well on this date.
DATE

 DISTRICT WELL INSPECTOR
08/18/2023

B-6

June 8, 1959

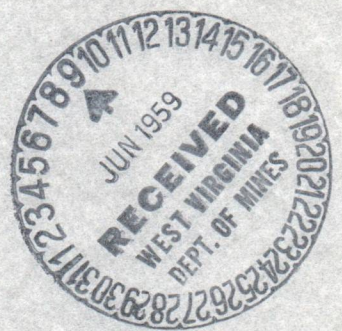

Mr. W. W. Ferrell, Supt. Prod. & Storage
United Fuel Gas Company
Charleston, West Virginia

Dear Sir:

We propose to plug and abandon Well No. 8771 on the United Fuel Gas Co. Fee Farm, Butler District, Wayne County, West Virginia, Map Square 14-43, in the following manner:

Set Bridge at	2011'	- 20' above Shot Hole
Put 2 sacks cement on top of bridge		
Crushed Stone	2011' - 2006'	
Mud & Clay	2006' - 1975'	
Set Bridge at	1559'	- 30' below Injun Sand
Put 2 sacks cement on top of bridge		
Crushed Stone	1559' - 1554'	
Mud & Clay	1554' - 1385'	
Lift 8-5/8" Casing to	1250'	
Mud & Clay	1385' - 1312'	- 20' above Big Line
Cement	1312' - 1302'	
Crushed Stone	1302' - 1297'	
Pull balance of 8-5/8" Casing		
Set Bridge at	1074'	- 30' below Salt Sand
Put 2 sacks cement on top of bridge		
Crushed Stone	1074' - 1069'	
Mud & Clay	1069' - 830'	- 20' above Salt Sand
Pull 10-3/4" Casing	603'	
Set Bridge at	502'	- 30' below Coal Seam
Cement	502' - 450'	- 20' above Coal Seam
Crushed Stone	450' - 445'	
Mud & Clay	445' - 422'	- 30' below Coal Seam
Cement	422' - 370'	- 20' above Coal Seam
Crushed Stone	370' - 365'	
Mud & Clay	365' - 53'	
Pull 13-3/8" Casing	33'	
Mud & Clay	53' - 3'	
Cement	3' - Surface	

Erect monument 30" above the surface with inscription "United Fuel Gas Co. Well No. 8771 - Abandoned"

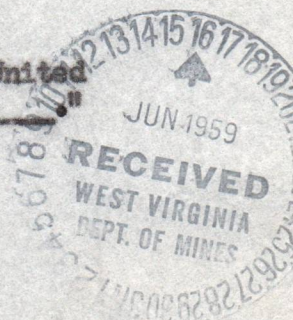

Yours very truly,

W. B. Osbourn
W. B. Osbourn
Division Superintendent

08/18/2023

*Mr. Back -
Please return
this when
finished with
it.*

13-2

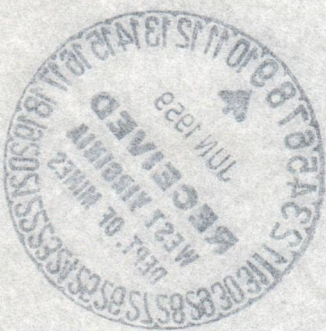

June 8, 1933

Mr. W. Foxwell, Sup't. Prod. & Storage
United Fuel Gas Company
Charleston, West Virginia

Dear Sir:

We propose to dig and examine Well No. 371 on the United
Fuel Gas Co. Ten Acres, Taylor District, Wayne County, West Virginia,
Map Square 14-43, in the following manner:

Set bridge at	2011'	- 20' above 300' High
Put 2 sacks cement on top of bridge	2011'	
Gravel Screen	2011' - 2008'	
Put 2 clay	2008' - 1972'	
Set bridge at	1972'	- 20' below Intake Head
Put 2 sacks cement on top of bridge	1972'	
Gravel Screen	1972' - 1954'	
Put 2 clay	1954' - 1938'	
Put 8-2 1/2" casing for	1938'	
Put 2 clay	1938' - 1922'	- 20' above 30' time
Cement	1922' - 1908'	
Gravel Screen	1908' - 1892'	
Full balance of 8-2 1/2" casing	1892'	
Set bridge at	1892'	- 20' below 300' Head
Put 2 sacks cement on top of bridge	1892'	
Gravel Screen	1892' - 1868'	
Put 2 clay	1868' - 1832'	- 20' above 300' Head
Full 10-2 1/2" casing	1832'	
Set bridge at	1832'	- 20' below Coal Seam
Cement	1832' - 1816'	
Gravel Screen	1816' - 1800'	- 20' above Coal Seam
Put 2 clay	1800' - 1784'	
Cement	1784' - 1768'	- 20' below Coal Seam
Gravel Screen	1768' - 1752'	- 20' above Coal Seam
Put 2 clay	1752' - 1736'	
Cement	1736' - 1720'	- 20' above Coal Seam
Gravel Screen	1720' - 1704'	
Put 2 clay	1704' - 1688'	
Full 13-2 1/2" casing	1688'	
Put 2 clay	1688' - 1672'	
Cement	1672' - 1656'	

Proof necessary for above the surface with description as attached
Fuel Gas Co. Well No. 371 - Attached

Yours very truly,

[Signature]
W. B. Johnson
Division of Geology

*Mr. Foxwell -
The return
should be
forwarded with
it.*

08/18/2023



B-7

STATE OF WEST VIRGINIA
DEPARTMENT OF MINES
OIL AND GAS DIVISION

INSPECTOR'S PLUGGING REPORT

Permit No. WAY-1155

Well No. 8771

COMPANY United Fuel Gas Company

ADDRESS P.O. Box 1273
Charleston, W. Va.

FARM United Fuel Gas Co. Feed DISTRICT Butler

COUNTY Wayne

Filling Material Used Cement - Clay - Stone

Liner	Location	Amount	Packer	Location		
PLUGS USED AND DEPTH PLACED			BRIDGES	CASING AND TUBING		
CEMENT-THICKNESS	WOOD-SIZE	LEAD	CONSTRUCTION-LOCATION	RECOVERED	SIZE	LOST
				1365'	8-5/8	0

Drillers' Names Darrell Sampson

Frank Maynard

Remarks: Set bottom bridge @ 2120'; crushed stone 2120'-2108'; put 2 sacks cement on bridge and filled with mud and clay to 2070'; bridged hole @ 1560'; 5 ft. crushed stone, 2 sacks cement and filled with clay to 1312'; 2 sacks cement 1312'-1308'; clay 1308'-1293'; set bridge @ 1074'; pulling 8-5/8" casing.

6-11-59

DATE

I hereby certify I visited the above well on this date.

J.W. Prock

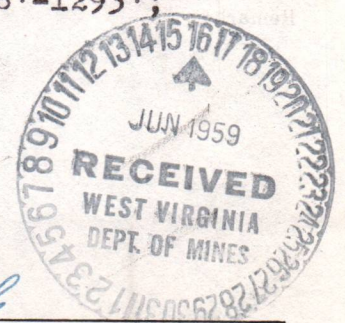

DISTRICT WELL INSPECTOR

08/18/2023

STATE OF WEST VIRGINIA
DEPARTMENT OF MINES
OIL AND GAS DIVISION

INSPECTOR'S WELL REPORT

Permit No. _____ Oil or Gas Well _____
(KIND)

	CASING AND TUBING	USED IN DRILLING	LEFT IN WELL	PACKERS
Company _____	Size _____			Kind of Packer _____
Address _____	16 _____			
Farm _____	13 _____			
Well No. _____	10 _____			Size of _____
District _____ County _____	8 1/4 _____			
Drilling commenced _____	6 5/8 _____			Depth set _____
Drilling completed _____ Total depth _____	5 3/16 _____			
Date shot _____ Depth of shot _____	3 _____			Perf. top _____
Initial open flow _____ /10ths Water in _____ Inch	2 _____			Perf. bottom _____
Open flow after tubing _____ /10ths Merc. in _____ Inch	Liners Used _____			Perf. top _____
Volume _____ Cu. Ft.				Perf. bottom _____
Rock pressure _____ lbs. _____ hrs.	CASING CEMENTED _____ SIZE _____ No. FT. _____ Date _____			
Oil _____ bbls., 1st 24 hrs.	COAL WAS ENCOUNTERED AT _____ FEET _____ INCHES			
Fresh water _____ feet _____ feet	_____ FEET _____ INCHES _____ FEET _____ INCHES			
Salt water _____ feet _____ feet	_____ FEET _____ INCHES _____ FEET _____ INCHES			

Drillers' Names _____

Remarks: _____

I hereby certify I visited the above well on this date _____

DATE _____ DISTRICT WELL INSPECTOR _____

08/18/2023

E-6
June 9, 1959

Mr. James W. Pack, Inspector
Oil and Gas Wells
Hamlin, West Virginia

Dear Mr. Pack:

Did Mr. William Osborne, Branchland call you about plugging Well No. 8771 on Fuel Fee Tract, Butler District, Wayne County? Well completed under Drilling Permit WAY-1155 which had off-set their Well No. 8772.

The plugging specifications were all right and I asked him to call you. Enclosed is a copy. As it takes about two weeks to get this through the regular channels in their main office, I approved the enclosed specifications.

Very truly yours,

Crawford L. Wilson, Director
DEPARTMENT OF MINES

BY

Assistant Director
OIL AND GAS DIVISION

MG/m
encl:

08/18/2023

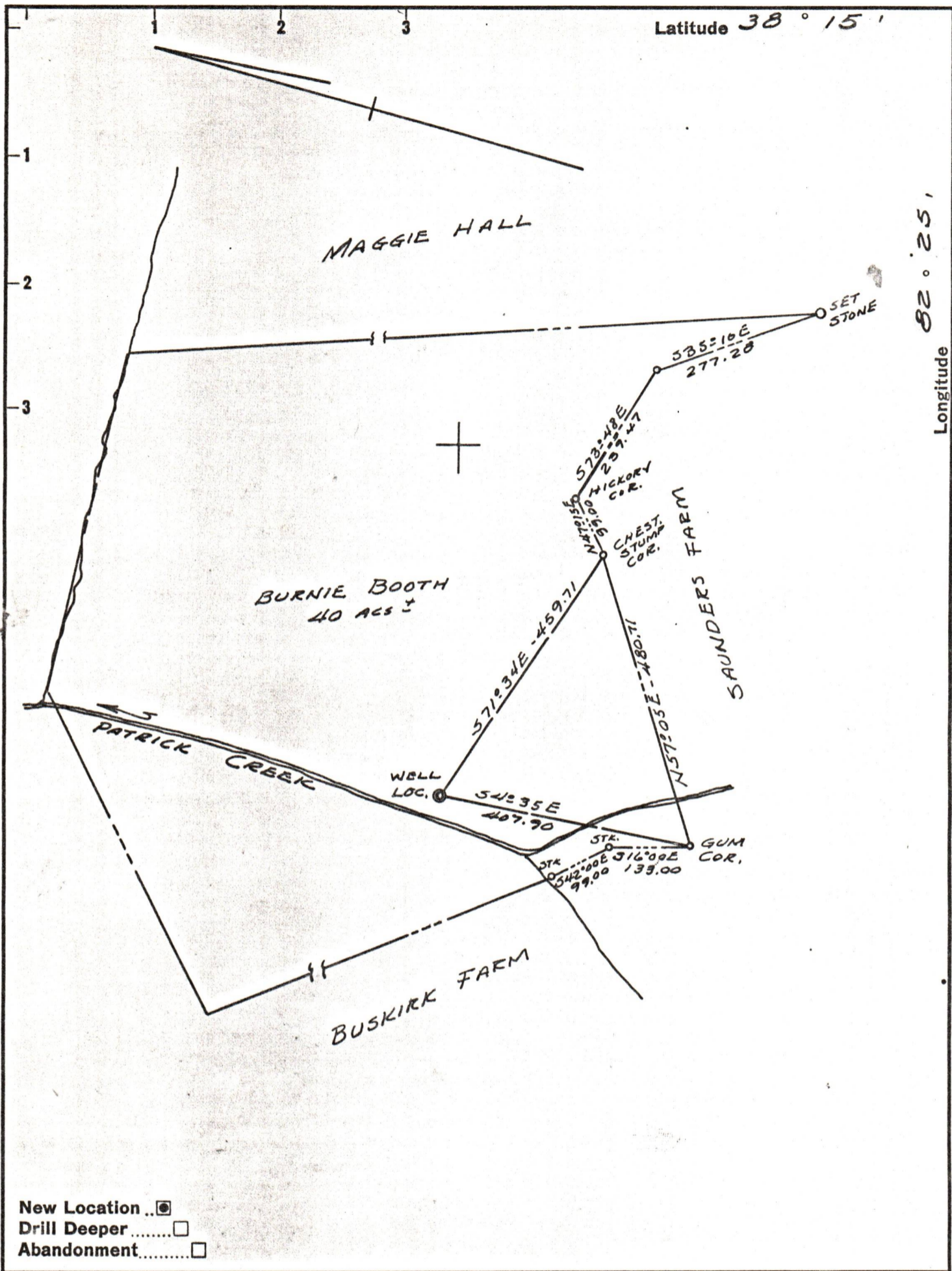

New Location ..
 Drill Deeper
 Abandonment

Company VELVET GAS CO.
 Address RT. 1 - BRANCLAND, W.VA.
 Farm BURNIE BOOTH
 Tract 1 Acres 40 ± Lease No. _____
 Well (Farm) No. 1 Serial No. _____
 Elevation (Spirit Level) 652.0
 Quadrangle WAYNE
 County WAYNE District BUTLER
 Engineer N. J. Sifton
 Engineer's Registration No. 1832
 File No. _____ Drawing No. _____
 Date DEC 29 '58 Scale 1" = 200'

STATE OF WEST VIRGINIA
 DEPARTMENT OF MINES
 OIL AND GAS DIVISION
 CHARLESTON

WELL LOCATION MAP
 FILE NO. WAY-1156 08/18/2023

+ Denotes location of well on United States Topographic Maps, scale 1 to 62,500, latitude and longitude lines being represented by border lines as shown.
 - Denotes one inch spaces on border line of original tracing.