



STATE OF WEST VIRGINIA
DEPARTMENT OF MINES
OIL AND GAS DIVISION

NOTICE OF PROPOSED LOCATION OF OIL AND GAS WELL

To THE DEPARTMENT OF MINES,
Charleston, W. Va.

No Coal Operation
COAL OPERATOR OR COAL OWNER

R. H. Adkins
NAME OF WELL OPERATOR

ADDRESS

Hamlin, W. Va.
COMPLETE ADDRESS

Earl Pelfrey (Owner)
COAL OPERATOR OR COAL OWNER

February 2, 1959
PROPOSED LOCATION

Route one, Wayne, W. Va.
ADDRESS

Butler District

Earl Pelfrey
OWNER OF MINERAL RIGHTS

Wayne County

Route one, Wayne, W. Va.
ADDRESS

Well No. 11 38° 15'
82° 25' Elev. 745'
Earl Pelfrey Farm
50 acres

GENTLEMEN:

The undersigned well operator is entitled to drill upon the above named farm or tract of land for oil and gas, having fee title thereto, (or as the case may be) under grant or lease dated Jan, 19, 1939 ~~1939~~, made by Earl Pelfrey, to United Fuel Gas Co To R. H. Adkins, and recorded on the First day of February 1939, in the office of the County Clerk for said County in Book 36, page 428.

The enclosed plat was prepared by a competent engineer and shows the proposed location of a well to be drilled for oil and gas by the undersigned well operator on the farm and in the Magisterial District and County above named, determined by survey and courses and distances from two permanent points, or land marks.

The undersigned well operator is informed and believes there are no coal operators operating beds of coal beneath said farm or tract of land on which said well is located, or within 500 feet of the boundaries of the same, who have mapped their workings and filed their maps as required by law, excepting the coal operators or coal owners (if any) above named as addressees.

The above named coal operators or coal owners (if any) are notified that any objections they may desire to make to such proposed location, or which they are required to make by Section 3 of said Code, if the drilling of a well at said proposed location will cause a dangerous condition in or about their respective coal mines, must be received by, or filed with the Department of Mines within ten* days from the receipt of a copy of this notice and accompanying plat by said Department. Said coal operators are further notified that forms for use in making such objections will be furnished to them by the Department of Mines promptly on request and that all such objections must set forth as definitely as is reasonably possible the ground or grounds on which such objections are based and indicate the direction and distance the proposed location should be moved to overcome same.

(The next paragraph is to be completed only in Department's copy.)

Copies of this notice and the enclosed plat were mailed by registered mail, or delivered to the above named coal operators or coal owners at their above shown respective address _____ day _____ before, or on the same day with the mailing or delivery of this copy to the Department of Mines at Charleston, West Virginia.

Very truly yours, R. H. Adkins
R. H. Adkins
WELL OPERATOR



Address of Well Operator }

STREET
Hamlin,
CITY OR TOWN
West Virginia
STATE

08/18/2023

*Section 3 If no such objections be filed or be found by the department of mines, within said period of ten days from the receipt of said notice and plat by the department of mines, to said proposed location, the department shall forthwith issue to the well operator a drilling permit reciting the filing of such plat, that no objections have been made by the coal operators to the location, or found thereto by the department, and that the same is approved and the well operator authorized to proceed to drill at said location.

1170

WAY-1170

PERMIT NUMBER



STATE OF WEST VIRGINIA
DEPARTMENT OF MINES
OIL AND GAS DIVISION

NOTICE OF PROPOSED LOCATION OF OIL AND GAS WELL

To the Department of Mines
Charleston, W. Va.

No. Coal Operation

R. H. Adkins

NAME OF WELL OPERATOR

LOCAL OPERATOR OR OIL AND GAS

ADDRESS

COUNTY AND ADDRESS

Earl Felley (Owner)

February 2, 1939

PROPOSED LOCATION

LOCAL OPERATOR OR OIL AND GAS

Route one, Wayne, W. Va.

Boiler

District

Earl Felley

Wayne

County

Route one, Wayne, W. Va.

Earl Felley

Name

The undersigned well operator is entitled to drill upon the above named tract or tract of land for oil and gas having the title thereto, for the case may be under grant or lease dated Jan. 19, 1939

to Earl Felley made Earl Felley

of United Fuel Gas Co. to R. H. Adkins and recorded on the first day

of February 1939

Book 30 page 458

The enclosed map was prepared by a competent engineer and shows the proposed location of a well to be drilled for oil and gas by the undersigned well operator on the tract and in the Mineral District of Wayne County, West Virginia, bounded by survey and corners and distances from two permanent points or land marks.

The undersigned well operator is informed and believes there are no coal operators operating beds of coal beneath said tract or tract of land on which said well is located, or within 500 feet of the boundary of the tract, who have mapped their workings and that their maps as required by law, excepting the coal operators in coal owners (if any) whose names are attached.

The above named coal operators in coal owners (if any) are notified that any objections they may desire to make to such proposed location, to which they are entitled to make by Section 3 of said Code, if the drilling of a well at said proposed location will cause a dangerous condition in or about their respective coal mines, must be received by or before the Department of Mines within ten days from the receipt of a copy of this notice and recommendation for said location. If such coal operators or further notified that forms for use in making such objections will be furnished to them by the Department of Mines promptly on request and that all such objections must be forth as definitely as is reasonably possible the ground or grounds on which such objections are based and indicate the location and distance the proposed location should be moved to or other error.

(The next paragraph is to be completed only in duplicate copy.)
Copies of this notice and the enclosed map were mailed by registered mail or delivered to the above named coal operators or coal owners at their above given respective address day before day before on or the same day with the mailing or delivery of this copy to the Department of Mines at Charleston, West Virginia.

Very truly yours,

R. H. Adkins

WELL OPERATOR

Address

W. J. O'Connell

Hunting

CITY OF TOWNSHIP

West Virginia

08/18/2023

Section 3 of the Code of West Virginia provides that no well shall be drilled for oil and gas on any tract of land owned or controlled by a coal operator or coal owner (if any) whose name is attached to this notice, unless the coal operator or coal owner (if any) has first been notified in writing of the proposed location of such well and has had ten days from the receipt of such notice to file objections with the Department of Mines. If no objections are filed within such ten-day period, the coal operator or coal owner (if any) shall be deemed to have consented to the proposed location of such well.

PERMIT NUMBER

B-3
February 16, 1959

Mr. James W. Pack, Inspector
Oil and Gas Wells
Hamlin, West Virginia

Dear Mr. Pack:

We are in receipt of application for permit to
drill Well No. 11 on Earl Pelfrey Farm, Butler District,
Wayne County from R. H. Adkins. Permit number will be
WAY-1170.

Very truly yours,

Crawford L. Wilson, Director
WEST VIRGINIA DEPARTMENT OF MINES

BY:

Assistant Director
OIL AND GAS DIVISION

MG/dm

08/18/2023

B4
February 26, 1959

Mr. R. H. Adkins
Hamlin, West Virginia

Dear Mr. Adkins:

May we have completion drilling record for No. 3 location on Okey Bartram Farm, Butler District, Wayne County - Permit WAY-1146?

According to our information, the well was completed early in January.

Very truly yours,

Crawford L. Wilson, Director
WEST VIRGINIA DEPARTMENT OF MINES

BY: _____

Assistant Director
OIL AND GAS DIVISION

MG/dm

cc Mr. James W. Pack, Inspector

08/18/2023

B-5

February 26, 1959

Mr. R. H. Adkins
Hamlin, West Virginia

Dear Mr. Adkins:

Please find enclosed permit WAY-1170 for drilling
Well No. 11 on Earl Pelfrey Farm, Butler District, Wayne County.

Please post one copy of the permit at the well site.
When drilling is completed, please send us two copies of the well
record.

Very truly yours,

Crawford L. Wilson, Director
WEST VIRGINIA DEPARTMENT OF MINES

BY

Assistant Director
OIL AND GAS DIVISION

MG/dm

encl:

cc Mr. James W. Pack, Inspector

Mr. R. C. Tucker, Assistant
State Geologist

Permit held until
March 6, 1959

08/18/2023



STATE OF WEST VIRGINIA
DEPARTMENT OF MINES
OIL AND GAS DIVISION 21

Quadrangle Wayne
Permit No. WAY-1170

WELL RECORD

Oil or Gas Well Gas
(KIND)

Company Butler Gas Company
Address Hamlin, W.Va.
Farm Earl Pelfry Acres 50
Location (waters) Trace Fork
Well No. 11 Elev. 745.00
District Butler County Wayne
The surface of tract is owned in fee by Earl Pelfry
Address Wayne, W.Va.
Mineral rights are owned by Same
Address _____
Drilling commenced February 11, 1959
Drilling completed March 20, 1959
Date Shot 3-20-59 From 1960 To 1972
With 4,000 M. Gas Well B
Open Flow 20 /10ths Water in 1 Inch
/10ths Merc. in _____ Inch
Volume 47 M. Cu. Ft.
Rock Pressure 500 lbs. 72 hrs.
Oil None bbls., 1st 24 hrs.
WELL ACIDIZED _____
WELL FRACTURED _____

Casing and Tubing	Used in Drilling	Left in Well	Packers
Size			Kind of Packer
16			<u>Anchor</u>
13			Size of
10		<u>18</u>	Depth set
8 1/4		<u>310</u>	Perf. top
6 5/8		<u>1,496</u>	Perf. bottom
5 3/16			Perf. top
3		<u>1,997</u>	Perf. bottom
2			
Liners Used			

CASING CEMENTED _____ SIZE _____ No. Ft. _____ Date _____

COAL WAS ENCOUNTERED AT _____ FEET _____ INCHES
_____ FEET _____ INCHES _____ FEET _____ INCHES
_____ FEET _____ INCHES _____ FEET _____ INCHES

RESULT AFTER TREATMENT _____

ROCK PRESSURE AFTER TREATMENT _____

Fresh Water _____ Feet _____ Salt Water _____ Feet _____

Formation	Color	Hard or Soft	Top	Bottom	Oil, Gas or Water	Depth	Remarks
Clay			20	25			
Slate			25	70			
Red Clay			70	90			
Sand			90	115			
Slate			115	120			
Sand			120	172			
Slate			172	215			
Sand			215	250			
Coal			250	254			
Sand			254	300			
Slate			300	354			
Sand			354	360			
Slate			360	435			
Broken Sand			365	509			
Slate			509	538			
Sand			538	550			
Slate			550	650			
Sand			650	697			
Slate			697	723			
Gas Sand			723	800			
Slate			800	820			
Water Sand			820	855			
Salt Sand			855	1025			
Slate			1025	1033			
Salt Sand			1033	1068			
Slate			1068	1098			
Maxon Sand			1098	1140			
Slate			1140	1148			
Little Lime			1148	1168			

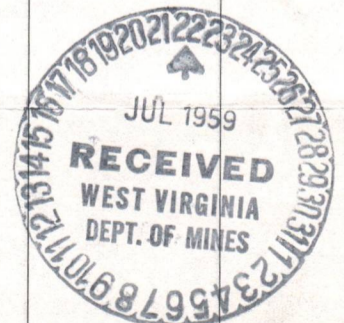

08/18/2023

APPROVED *W. J. Hendrich*
 Butler Gas Company, Owner
 By *W. J. Hendrich*
 Well (Title) Superintendent
 Date July 21, 1959

Formation	Color	Hard or Soft	Top	Bottom	Oil, Gas or Water	Depth Found	Remarks
Pencil Cave			1168	1173			
Big Lime			1173	1331			
Keokuk			1331	1345			
Slate			1345	1350			
Injun Sand			1350	1400			
Squaw Sand			1400	1485			
Shell			1485	1498			
White Slate			1498	1760			
Shell			1760	1780			
White Slate			1780	1868			
Shell			1868	1890			
Brown Slate			1890	1944			
Berea Sand			1944	1960			
Slate			1960	1972			
			1972	1997			

3202/81/80

B-2

B-6
March 3, 1959

Mr. Walter Hauldren
c/o Mr. R. H. Adkins
Hamlin, West Virginia

Dear Mr. Hauldren:

We have not yet received completion drilling record requested February 18 and 26th for your Okey Bartrum No. 3 Well, Butler District, Wayne County.

Please file immediately so that permit for your Earl Pelfrey Well No. 11, Wayne County can be issued.

Very truly yours,

Crawford L. Wilson, Director
WEST VIRGINIA DEPARTMENT OF MINES

BY: _____
Assistant Director
OIL AND GAS DIVISION

MG/dm

cc Mr. James W. Pack, Inspector

08/18/2023

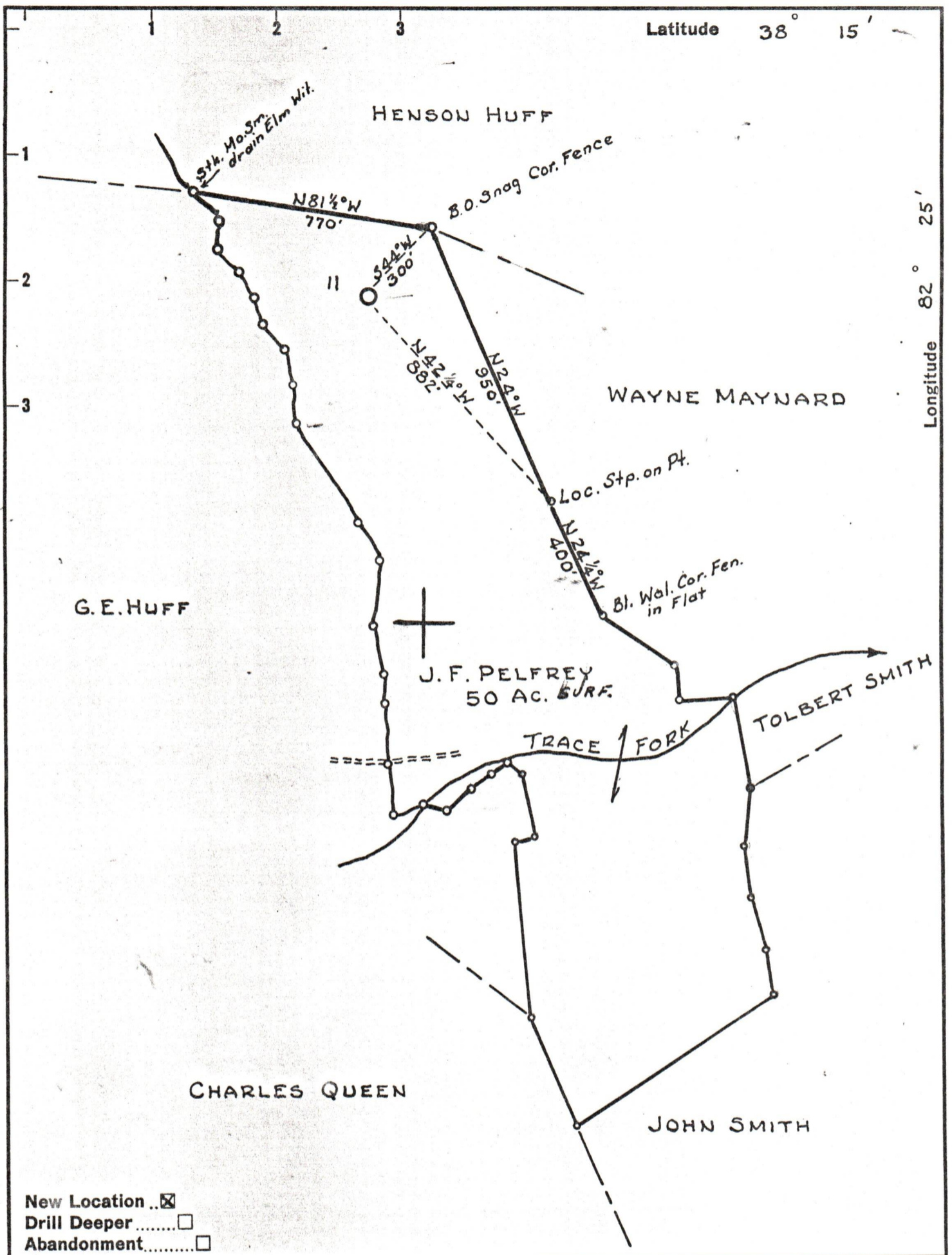

Company R.H. ADKINS

Address HAMLIN, W. VA.

Farm EARL PELFREY

Tract 1 Acres 50 Lease No. 42835

Well (Farm) No. 1 Serial No. 11

Elevation (Spirit Level) 745.00

Quadrangle WAYNE

County WAYNE District BUTLER

Engineer PAUL E. JOACHIM

Engineer's Registration No. 669

File No. 14-47 Drawing No. _____

Date FEB. 2, 1959 Scale 1" = 400'

STATE OF WEST VIRGINIA
DEPARTMENT OF MINES
OIL AND GAS DIVISION
CHARLESTON

WELL LOCATION MAP

FILE NO. WAY-1110 08/18/2023

+ Denotes location of well on United States Topographic Maps, scale 1 to 62,500, latitude and longitude lines being represented by border lines as shown.

- Denotes one inch spaces on border line of original tracing.