



STATE OF WEST VIRGINIA
DEPARTMENT OF MINES
OIL AND GAS DIVISION

NOTICE OF PROPOSED LOCATION OF OIL AND GAS WELL

To THE DEPARTMENT OF MINES,
Charleston, W. Va.

G. W. Workman Est., Ed Workman, Exec.

OWENS, LIBBEY-OWENS GAS DEPARTMENT

COAL OPERATOR OR COAL OWNER

NAME OF WELL OPERATOR

Wayne, West Virginia

P. O. Box 4168, Charleston 4, W. Va.

ADDRESS

COMPLETE ADDRESS

June 18, 19 59

COAL OPERATOR OR COAL OWNER

PROPOSED LOCATION

Butler District

ADDRESS

Wayne County

Same

Well No. 8 (Serial No. 1044) ^{38° 15'} ^{82° 25'} E. 780.82

OWNER OF MINERAL RIGHTS

ADDRESS

G. W. Workman Farm

600 acres

GENTLEMEN:

The undersigned well operator is entitled to drill upon the above named farm or tract of land for oil and gas, having fee title thereto, (or as the case may be) under grant or lease dated April 15, 1929, made by Ed Workman et al, to Owens Bottle Co. & Libbey-Owens Sheet Glass Co. (now Owens-Illinois Glass Co. & Libbey-Owens-Ford Glass Co.) and recorded on the 4th day of June, 1929, in the office of the County Clerk for said County in Book 13, page 362.

The enclosed plat was prepared by a competent engineer and shows the proposed location of a well to be drilled for oil and gas by the undersigned well operator on the farm and in the Magisterial District and County above named, determined by survey and courses and distances from two permanent points, or land marks.

The undersigned well operator is informed and believes there are no coal operators operating beds of coal beneath said farm or tract of land on which said well is located, or within 500 feet of the boundaries of the same, who have mapped their workings and filed their maps as required by law, excepting the coal operators or coal owners (if any) above named as addressees.

The above named coal operators or coal owners (if any) are notified that any objections they may desire to make to such proposed location, or which they are required to make by Section 3 of said Code, if the drilling of a well at said proposed location will cause a dangerous condition in or about their respective coal mines, must be received by, or filed with the Department of Mines within ten* days from the receipt of a copy of this notice and accompanying plat by said Department. Said coal operators are further notified that forms for use in making such objections will be furnished to them by the Department of Mines promptly on request and that all such objections must set forth as definitely as is reasonably possible the ground or grounds on which such objections are based and indicate the direction and distance the proposed location should be moved to overcome same.

(The next paragraph is to be completed only in Department's copy.)

Copies of this notice and the enclosed plat were mailed by registered mail, or delivered to the above named coal operators or coal owners at their above shown respective address _____ day _____ before, or on the same day with the mailing or delivery of this copy to the Department of Mines at Charleston, West Virginia.

Very truly yours,

OWENS, LIBBEY-OWENS GAS DEPARTMENT

WELL OPERATOR

P. O. Box 4168

STREET

Charleston 4,

CITY OR TOWN

West Virginia

STATE

08/25/2023



Address of Well Operator }

*Section 3 If no such objections be filed or be found by the department of mines, within said period of ten days from the receipt of said notice and plat by the department of mines, to said proposed location, the department shall forthwith issue to the well operator a drilling permit reciting the filing of such plat, that no objections have been made by the coal operators to the location, or found thereto by the department, and that the same is approved and the well operator authorized to proceed to drill at said location.

1202

WAY-1202 PERMIT NUMBER

A-10

OWENS, LIBBEY-OWENS GAS DEPARTMENT

5793 MACCORKLE AVENUE

P. O. BOX 4158

CHARLESTON 4, WEST VIRGINIA



June 18, 1959

W. Va. Department of Mines
Oil & Gas Division
Charleston, West Virginia

Gentlemen:

We are submitting an application for a permit to drill Well No. 8, on our G. W. Workman tract, situated in Butler District, Wayne County, West Virginia.

Attached to the application is a plat showing the proposed location of said well. Will you please issue us a permit to begin drilling this well at your earliest convenience.

Very truly yours,

OWENS, LIBBEY-OWENS GAS DEPARTMENT

By T. S. Flournoy
T. S. Flournoy, Chief Engineer

TSF/ed
Enclosures

cc: G. W. Workman Est.,
Ed Workman, Exec.
Wayne, W. Va.



08/25/2023

OWENS-LIBBEY-OWENS GAS DEPARTMENT

2500 MACCORRLE AVENUE
P.O. BOX 4122
CHARLESTON 4 WEST VIRGINIA



June 10, 1953

W. Va. Department of Mines
Oil & Gas Division
Charleston, West Virginia

Gentlemen:

We are submitting an application for a permit to
drill well No. 3, on our U. W. Workman tract, situated
in Butler District, Wayne County, West Virginia.
Attached to the application is a plat showing the
proposed location of said well. Will you please issue us
a permit to begin drilling this well as soon as possible
convenience.

Very truly yours,

OWENS-LIBBEY-OWENS GAS DEPARTMENT

T. S. Flournoy
T. S. Flournoy, Chief Engineer

TSF/ed
Enclosures

cc: G. W. Workman, Esq.,
155 Workman Bldg.,
Wayne, W. Va.

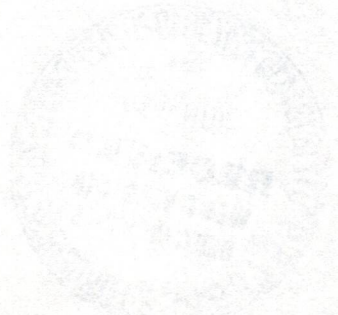

A-11
June 18, 1959

Mr. James W. Pack, Inspector
Oil and Gas Wells
Hamlin, West Virginia

Dear Mr. Pack:

We are in receipt of application for permit to drill Well No. 8 - SR-1044 on G. W. Workman Farm, Butler District, Wayne County from Owens, Libby-Owens Gas Department. Permit number will be WAY-1202.

Very truly yours,

Crawford L. Wilson, Director
DEPARTMENT OF MINES

BY

Assistant Director
OIL AND GAS DIVISION

MG/m

08/25/2023

A-12

June 29, 1959

Owens, Libbey-Owens Gas Dept
P. O. Box 4158
Charleston 4, West Virginia

Dear Sirs:

Enclosed is Permit WAY-1202 for drilling
Well No. 8, Serial 1044 on G. W. Workman Tract, Butler
District, Wayne County.

Very truly yours,

Crawford L. Wilson, Director
DEPARTMENT OF MINES

BY: _____
Assistant Director
OIL AND GAS DIVISION

MG:g
encl

cc James W. Pack, Inspector

R. C. Tucker, Assistant
State Geologist

08/25/2023

B-1



STATE OF WEST VIRGINIA
DEPARTMENT OF MINES
OIL AND GAS DIVISION

REC'D... 0607
...
23

Quadrangle Wayne

WELL RECORD

Oil or Gas Well Gas
(KIND)

Permit No. Way-1202

Company Owens, Libbey-Owens Gas Department
Address P.O. Box 4168, Charleston 4, W. Va.
Farm G. W. Workman Estate Acres 600
Location (waters) Right Fork of Twelve Pole Creek
Well No. 8 (Serial No. 1044) Elev. 780.82
District Butler County Wayne
The surface of tract is owned in fee by _____
Address _____
Mineral rights are owned by G. W. Workman Estate
(Ed Workman, Exec.) Address Wayne, W. Va.
Drilling commenced 6/27/59
Drilling completed 7/25/59
Date Shot 7/27, 29, 8/12/59 From 1988 To 2001
With 150# Trojan pdr, 2000# Trojan P., 3850# Trojan P.

Casing and Tubing	Used in Drilling	Left in Well	Packers
Size			
16			Kind of Packer
13			Oilwell B. H. & W & A
10			Size of $3\frac{1}{2} \times 6-5/8 \times 7$
$8\frac{3}{4} \times 5/8$	322'5"	322'5"	Depth set <u>1584'3" - 1590'</u>
$6\frac{5}{8} \times 7$	1574'4"	1574'4"	Perf. top <u>2015'3"</u>
$5\frac{3}{16}$			Perf. bottom <u>2026'</u>
$3\frac{1}{2}$	2027	Pulled	Perf. top <u>2004'4"</u>
$2\frac{3}{4}$	-----	2029'5"	Perf. bottom <u>2015'3"</u>
Liners Used			

Open Flow /10ths Water in _____ Inch
_____ /10ths Merc. in _____ Inch
Volume 79 MCF Berea Cu. Ft.
Rock Pressure 320 lbs. 24 hrs.
Oil _____ bbls., 1st 24 hrs.
Fresh water 280, 510, 850-870 feet
Salt water 850-870 feet

CASING CEMENTED	SIZE	No. Ft.	Date
COAL WAS ENCOUNTERED AT <u>100</u> FEET <u>36</u> INCHES			
_____	_____	_____	_____
_____	_____	_____	_____

Formation	Color	Hard or Soft	Top	Bottom	Oil, Gas or Water	Depth Found	Remarks
Soil	yellow	-	0	10			
Sand	yellow	-	10	30			
Slate	light	soft	30	100			
Coal	dark	soft	100	103			
Sl. & shls.	grey	soft	103	127			
Sand	grey	soft	127	151			
Slate	light	soft	151	171			
Sand	grey	soft	171	220			
Sand	light	soft	220	280			
Bro. Sand	dark	soft	280	310	Water at 280, $1\frac{1}{2}$ BPH		
Sand	white	soft	310	330			
Slate	light	soft	330	335			
Sand	white	medium	335	386			
Sl. & shls.	dark	soft	386	490			
Sand	grey	soft	490	515	Water at 510, $\frac{1}{2}$ BPH		
Sl. & shls.	dark	soft	515	550			
Sand	grey	soft	550	565			
Slate	dark	soft	565	578			
Sl. & shls.	dark	soft	578	686			
Salt sand	light	soft	686	750			
Sand	light	soft	750	846			
Sand	light	soft	846	999	Water 850 - 870, hole filling		
Sand	black	medium	999	1034			
Sand	white	soft	1034	1101			
Slate	dark	soft	1101	1106			
Sand	white	soft	1106	1160			
Slate	dark	soft	1160	1170			
Little Lime	dark	medium	1170	1175			
Little lime	dark	hard	1175	1205			
Big Lime	light	hard	1205	1282			
Big Lime	white	hard	1282	1368			
Slate	dark	soft	1368	1370			
Grey Injun	grey	soft	1370	1394			

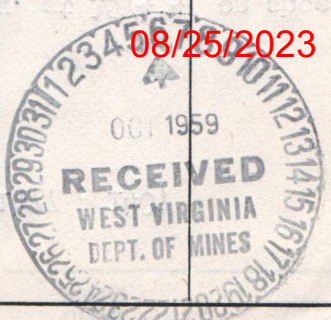

RECEIVED

FEB 28 1979

1.0 API well number: (If not available, leave blank. 14 digits.)	<u>47-099-1202</u>			
2.0 Type of determination being sought: (Use the codes found on the front of this form.)	<u>108</u> Section of NGPA	<u>DEPT. OF MINES</u> OIL & GAS DIVISION Category Code		
3.0 Depth of the deepest completion location: (Only needed if sections 103 or 107 in 2.0 above.)	<u>NA</u> feet			
4.0 Name, address and code number of applicant: (35 letters per line maximum. If code number not available, leave blank.)	<u>Industrial Gas Corporation</u> Name <u>P. O. Box 1473</u> Street <u>Charleston</u> <u>WV</u> <u>25325</u> City State Zip Code		<u>009283</u> Seller Code	
5.0 Location of this well: [Complete (a) or (b).] (a) For onshore wells (35 letters maximum for field name.)	<u>NA</u> Field Name <u>Wayne</u> <u>WV</u> County State			
(b) For OCS wells:	<u>NA</u> Area Name		<u>NA</u> Block Number	
	Date of Lease: Mo. Day Yr.		<u>NA</u> OCS Lease Number	
(c) Name and identification number of this well: (35 letters and digits maximum.)	<u>G. W. Workman 8-1044</u>			
(d) If code 4 or 5 in 2.0 above, name of the reservoir: (35 letters maximum.)	<u>NA</u>			
6.0 (a) Name and code number of the purchaser: (35 letters and digits maximum. If code number not available, leave blank.)	<u>See Addendum "A"</u> <u>Houdaille Industries, Inc.</u> Name		<u>N/Available</u> Buyer Code	
(b) Date of the contract:	<u>1 2 2 6 7 3</u> Mo. Day Yr.			
(c) Estimated annual production:	<u>1.7</u> MMcf.			
	(a) Base Price (\$/MMBTU)	(b) Tax	(c) All Other Prices [Indicate (+) or (-).]	(d) Total of (a), (b) and (c)
7.0 Contract price: <u>See Addendum "A"</u> (As of filing date. Complete to 3 decimal places.)	<u>1 2 8 3</u>	<u>0 0 5 1</u>	<u>0 0 0 3</u>	<u>1 3 3 6</u>
8.0 Maximum lawful rate: (As of filing date. Complete to 3 decimal places.)	<u>2.2 4 3</u>	<u>0.3 0 2</u>	<u>0.0</u>	<u>2.5 4 5</u>
9.0 Person responsible for this application:	<u>William C. Charlton</u> <u>Division Counsel</u> Name Title			
Agency Use Only	<u>William C. Charlton</u> Signature			
Date Received by Juris. Agency FEB 28 1979	<u>02 / 28 / 79</u> Date Application is Completed		<u>(304) 342-8166</u> Phone Number	
Date Received by FERC				

08/25/2023

WELL DETERMINATION REPORT

OCT 19 1979

PARTICIPANTS:

DATE:

BUYER-SELLER CODE

WELL OPERATOR: Industrial Gas Corporation

009283

FIRST PURCHASER: Houdaille Industries, Inc.

OTHER:

W. Va. Department of Mines, Oil & Gas Division
WELL DETERMINATION FILE NUMBER

790228 - 108-099-1202

Use Above File Number on all Communications
Relating to Determination of this Well

Quantities as Section 108, stripper well.

Robert L. Foster

CHECK EACH ITEM AS COMPLETE OR NOTE WHAT IS MISSING

ITEM NO.

- 1 FERC-121 Items not completed - Line No. _____
- 2 IV-1 - Agent William C. Charlton
- 3 IV-2 - Well Permit _____
- 4 IV-6 - Well Plat
- 5 IV-35- Well Record Drilling Deepening _____
- 6 IV-36- Gas-Oil Test: Gas Only _____ Was Oil Produced? Ratio _____
- 7 IV-39- Annual Production 0 years
- 8 IV-40- 90 day Production 87 Days off Line: _____
- 9 IV-48- Application for Certification. Complete?
- 10 - 17 IV Form #51 - 52 - 53 - 54 - 55 - (56) - 57 - 58. Complete Affidavit Signed
- 18 - 28 Other: Survey _____ Logs _____ Geological Charts _____ Structure Map _____

1:4000 Map _____

Well Tabulations _____

Gas Analyses _____

Commenced: 6-27-59

(5) Date Completed: 7-25-59 Deepened _____

(5) Fraced: _____
Production Depth: 1481-93

(5) Production Formation: Berea

(5) Final Open Flow Initial Potential: 79 mcf

(5) Static R.P. After Frac: Initially: 300#

(6) Other Gas Test: _____

(7) Avg. Daily Gas from Annual Production: 6.1 mcf

(2242 / 366)

(8) Avg. Daily Gas from 90-day ending w/1-120 days 9.5 mcf

(824 / 87)

(8) Line Pressure: 34 # PSIG from Daily Report

(5) Oil Production: _____ From Completion Report _____

(10-17) Does lease inventory indicate enhanced recovery being done: no 08/25/2023

(10-17) Is affidavit signed? Notarized?

Does official well record with the Department confirm the submitted information? yes

Additional Information _____ Does computer program confirm? _____

Was Determination Objected to? _____ By Whom? _____

FJ F DM

STATE OF WEST VIRGINIA
DEPARTMENT OF MINES, OIL AND GAS DIVISION

Date 02/28, 1979
Operator's Well No. 8-1044
API Well No. 47 - 099 - 1202
State County Permit

WELL CLASSIFICATION FORM

STRIPPER GAS WELL
NGPA Section 108

DESIGNATED AGENT William C. Charlton
ADDRESS P. O. Box 1473
Charleston, WV 25325

WELL OPERATOR Industrial Gas Corporation LOCATION: Elevation 780.82'
ADDRESS P. O. Box 1473 Watershed Not Available
Charleston, WV 25325 Dist. Butler County Wayne Quad. Wayne
GAS PURCHASER * _____ Gas Purchase Contract No. * _____
ADDRESS _____ Meter Chart Code R0361
Date of Contract * _____

*See FERC-121 - Addendum "A"

* * * * *

Provide a complete inventory of the lease and production equipment used for the well for the previous 24 months or, if less than 24 months, the period the well has been in production. Include a complete list of equipment or processes used in connection with recognized enhanced recovery techniques during completion or production. (Attach separate sheets, if necessary.)

(See Attachment)

List all records reasonably available to you which contain information relevant to a determination of eligibility (including production records, B&O Tax Records and royalty payment records) and indicate the location of such records:

All records required to determine production by meter stations are maintained in Charleston, West Virginia.

B&O Tax Records are located in Charleston, West Virginia, our Boston, Massachusetts office and the Houston, Texas office.

Royalty payment instructions are located in Charleston, West Virginia office and Houston, Texas office.

08/25/2023

Describe the search made of any records listed above:

I have made a diligent search of the production records located in Charleston, West Virginia. They were the records utilized in making the determination herein.

Are you aware of any other information which would tend to be inconsistent with the information specified above? Yes No X. If yes, indicate the type and source of the information.

AFFIDAVIT

I, Lawrence B. Mentzer, having been first sworn according to law, state that I have caused to be made a diligent search of those records hereinbefore indicated in the manner herein described, that the information contained in this document is true and accurate and that on the basis of the records and examinations hereinbefore described, and to the best of my information, knowledge and belief, the well for which this certification is sought qualifies as a stripper well.



STATE OF WEST VIRGINIA,

COUNTY OF Kanawha, TO WIT:

I, Charlotte I. Mathews, a Notary Public in and for the state and county aforesaid, do certify that Lawrence B. Mentzer whose name is signed to the writing above, bearing date the 28 day of February, 19 79, has acknowledged the same before me, in my county aforesaid.

Given under my hand and official seal this 28 day of February, 1979.

My term of office expires on the 5th day of December, 1985.

08/25/2023

Charlotte I. Mathews
Notary Public

Date February 28, 1979

Operator's Well No. 8-1044

API Well No. 47 - 099 - 1202
State County Permit

STATE APPLICATION FOR WELL CLASSIFICATION

Previous File No. NA
(IF Applicable)

WELL OPERATOR Industrial Gas Corporation

DESIGNATED AGENT William C. Charlton

ADDRESS P. O. Box 1473
Charleston, W. Va. 25325

ADDRESS P. O. Box 1473
Charleston, W. Va. 25325

Gas Purchase Contract No. * _____ and Date _____
(Month, day and year)

Meter Chart Code R0361

Name of First Purchaser * _____

(Street or P. O. Box)

(City)

(State)

(Zip Code)

FERC Seller Code 009283

FERC Buyer Code _____

TYPE OF DETERMINATION BEING SOUGHT:

- (1) Initial determination (See FERC Form 121.) 108 Section of NGPA NA Category Code
- (2) Determination that increased production is the result of enhanced recovery technology.
- (3) Determination of a seasonally affected well.

(*See FERC-121 Addendum "A")

William C. Charlton Division Counsel
Name (Print) Title

William C. Charlton
Signature

P. O. Box 1473
Street or P. O. Box

Charleston, W. Va. 25325
City State (Zip Code)

(304) 342-8166
Area Phone Number
Code

(Certificate of Proof of Service to Purchaser)

See Separate Certificate Attached

(All of the above to be completed by the Operator/Applicant)

(To be completed by Jurisdictional Agency. Executed copy to be returned to Operator/Applicant and purchaser, if known).

The Department of Mines has received a request, for certification of the above described well as meeting the requirements of Section _____ under the Natural Gas Policy Act of 1978. (NGPA); or for determination that increased production is the result of enhanced recovery technology under Section 108 of (NGPA); or for determination of a seasonally affected well under Section 108 of (NGPA)

All interested parties are hereby notified that on the _____ day of _____, 19____, at the office of the Oil and Gas Division in Charleston, West Virginia, or as soon thereafter as it may be heard, there will be a public hearing, if requested, or if objection is filed.

This Application is assigned File No. _____.

Initial review of information submitted indicates the well is, is not entitled to certification as claimed under the Natural Gas Policy Act (NGPA). A review of this evidence and any additional evidence will be made at the time appointed for a public hearing or as soon thereafter as the matter may be heard.

Unless objections are timely filed or a request for a hearing is made within fifteen (15) days, a hearing will not be held except on ex parte motion of the department and the matter will go to determination.

WEST VIRGINIA DEPARTMENT OF MINES

Robert S. [Signature]
Director

FEB 28 1979

Date received by
Jurisdictional Agency

By _____
Title _____

08/25/2023

IV-39-WC

STATE OF WEST VIRGINIA
DEPARTMENT OF MINES
DIVISION - OIL AND GAS

ANNUAL REPORT OF MONTHLY PRODUCTION-197A
GAS VOLUMES IN MFC @ 14.73
OIL IN DARRELLS @ 60 DEGREES
10, 18
OPERATOR : Industrial Gas Corporation

REPORT NO. CCA101P1 PG 00002
CURRENT DATE - 2/28/79
REPORT DATE - 2/28/79

API	47-099-01202	FARM	Workman	8-1044	COUNTY	Wayne	AVG. FLOW PRESSURE	23	SHUT-IN PRESSURE	NA	TOTALS
GAS MFC	108	131	100	111	87	66	123	89	79	105	1196
OIL BBL	J-	F-	M-	A-	M-	J-	A-	S-	0-	H-	OIL
DAYS ONLINE	30	34	31	32	28	18	37	29	28	32	355

1977

API	47-099-01202	FARM	Workman	8-1044	COUNTY	Wayne	AVG. FLOW PRESSURE	34	SHUT-IN PRESSURE	NA	TOTALS
GAS MFC	150	126	117	213	190	151	154	194	267	260	2242
OIL BBL	J-	F-	M-	A-	M-	J-	A-	S-	0-	H-	OIL
DAYS ONLINE	36	27	30	32	30	30	31	35	27	30	366

1978

SUMMARIZATION SCHEDULE
Section 271. 804 (b)

In accordance with Section 271.804(b) please list all other wells which are to be used in determining this well classification under Part 271 Subpart H.

08/25/2023

API NUMBERS 47-099-0958; 47-099-0980; 47-099-1015; 47-099-1019; 47-099-1205; 47-099-1202

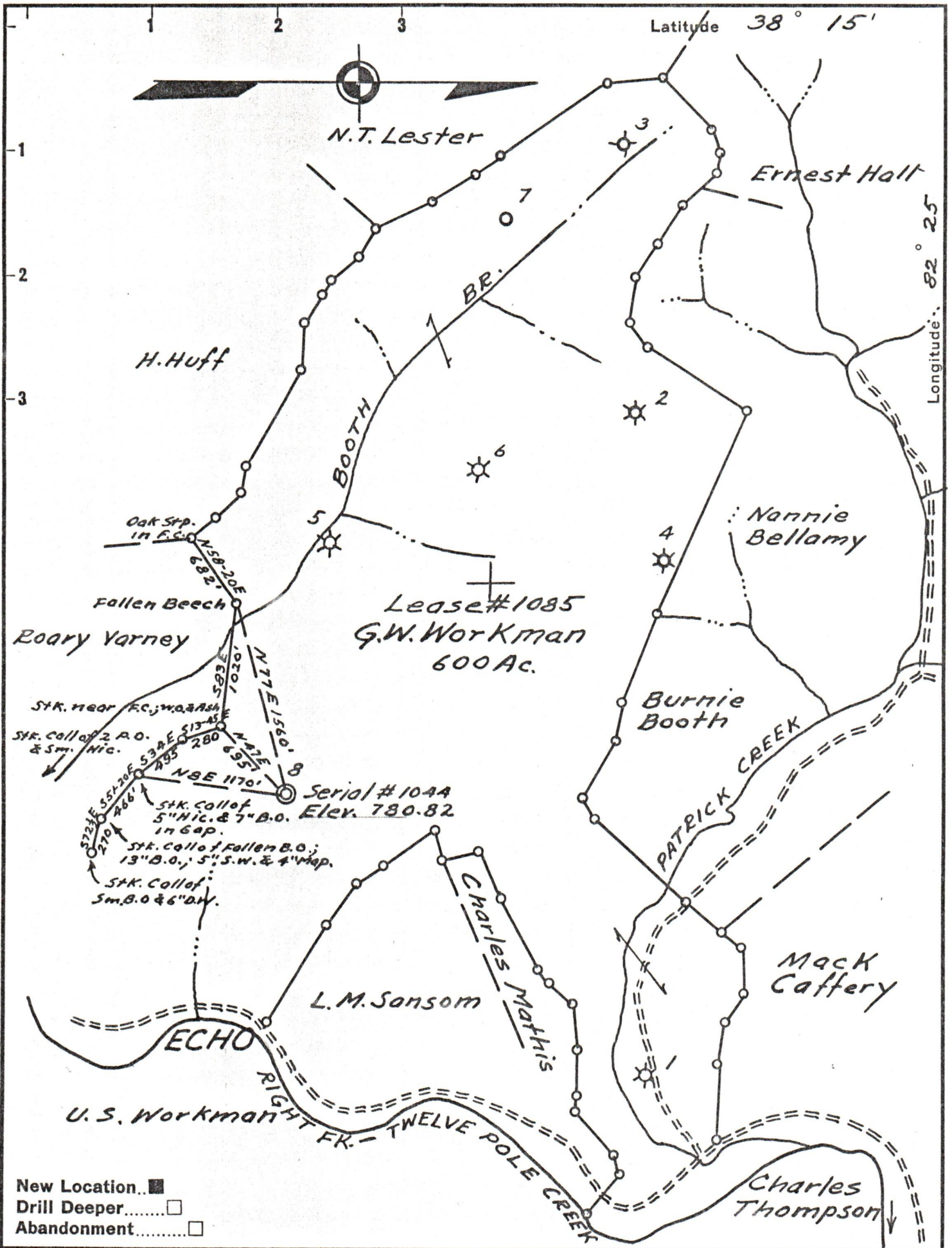

Company Owens, Libbey-Owens Gas Dept.
 Address Box 4158 Charleston 4 W. Va.
 Farm G. W. Workman
 Tract _____ Acres 600 Lease No. 1085
 Well (Farm) No. 8 Serial No. 1044
 Elevation (Spirit Level) 780.82
 Quadrangle Wayne 3 54.60" W 3.62"
 County Wayne District Butler
 Engineer T. S. Flournoy
 Engineer's Registration No. 269
 File No. _____ Drawing No. _____
 Date Jun. 11, 1959 Scale 1" = 1000 Ft.

STATE OF WEST VIRGINIA
 DEPARTMENT OF MINES
 OIL AND GAS DIVISION
 CHARLESTON

WELL LOCATION MAP
 FILE NO. Way-12.02 08/25/2023

+ Denotes location of well on United States Topographic Maps, scale 1 to 62,500, latitude and longitude lines being represented by border lines as shown.

- Denotes one inch spaces on border line of original tracing.