



STATE OF WEST VIRGINIA
DEPARTMENT OF MINES
OIL AND GAS DIVISION

NOTICE OF PROPOSED LOCATION OF OIL AND GAS WELL

To THE DEPARTMENT OF MINES,
Charleston, W. Va.

O. J. Spurlock
COAL OPERATOR OR COAL OWNER

P. O. Box 9027, Huntington, W. Va.
ADDRESS

COAL OPERATOR OR COAL OWNER

Same
ADDRESS

OWNER OF MINERAL RIGHTS

ADDRESS

OWENS, LIBBEY-OWENS GAS DEPARTMENT
NAME OF WELL OPERATOR

P. O. Box 4168, Charleston 4, W. Va.
COMPLETE ADDRESS

September 22, 1959

PROPOSED LOCATION
Union District

Wayne County

Well No. 4 (Serial No. 1086) ^{38° 20'} ^{82° 25' E} 825.4'

O. J. Spurlock Farm

125 acres

GENTLEMEN:

The undersigned well operator is entitled to drill upon the above named farm or tract of land for oil and gas, having fee title thereto, (or as the case may be) under grant or lease dated August 22, 1952, made by O. J. Spurlock, to Owens-Illinois Glass Co. & Libbey-Owens-Ford Glass Co., and recorded on the 1st day of September, 1953, in the office of the County Clerk for said County in Book 43, page 343.

The enclosed plat was prepared by a competent engineer and shows the proposed location of a well to be drilled for oil and gas by the undersigned well operator on the farm and in the Magisterial District and County above named, determined by survey and courses and distances from two permanent points, or land marks.

The undersigned well operator is informed and believes there are no coal operators operating beds of coal beneath said farm or tract of land on which said well is located, or within 500 feet of the boundaries of the same, who have mapped their workings and filed their maps as required by law, excepting the coal operators or coal owners (if any) above named as addressees.

The above named coal operators or coal owners (if any) are notified that any objections they may desire to make to such proposed location, or which they are required to make by Section 3 of said Code, if the drilling of a well at said proposed location will cause a dangerous condition in or about their respective coal mines, must be received by, or filed with the Department of Mines within ten* days from the receipt of a copy of this notice and accompanying plat by said Department. Said coal operators are further notified that forms for use in making such objections will be furnished to them by the Department of Mines promptly on request and that all such objections must set forth as definitely as is reasonably possible the ground or grounds on which such objections are based and indicate the direction and distance the proposed location should be moved to overcome same.

(The next paragraph is to be completed only in Department's copy.)

Copies of this notice and the enclosed plat were mailed by registered mail, or delivered to the above named coal operators or coal owners at their above shown respective address ~~day~~ before, ~~or~~ on the same day with the mailing or delivery of this copy to the Department of Mines at Charleston, West Virginia.

Very truly yours,

OWENS, LIBBEY-OWENS GAS DEPARTMENT

P. O. Box 4168

Charleston 4,

West Virginia

STATE

Address of Well Operator }

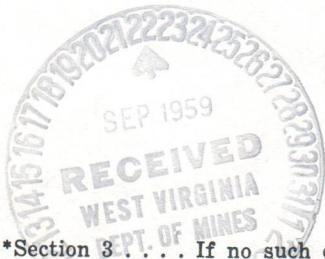

08/25/2023

*Section 3. . . If no such objections be filed or be found by the department of mines, within said period of ten days from the receipt of said notice and plat by the department of mines, to said proposed location, the department shall forthwith issue to the well operator a drilling permit reciting the filing of such plat, that no objections have been made by the coal operators to the location, or found thereto by the department, and that the same is approved and the well operator authorized to proceed to drill at said location.

WAY-1230

PERMIT NUMBER

1230



STATE OF WEST VIRGINIA
DEPARTMENT OF MINES
OIL AND GAS DIVISION

NOTICE OF PROPOSED LOCATION OF OIL AND GAS WELL

To the Department of Mines
Charleston, W. Va.

OWENS, LIBBEY-OWENS GAS DEPARTMENT

O. F. Sparlock

NAME OF WELL OPERATOR

COAL OPERATOR OR COAL OWNER

P. O. Box #108, Charleston, W. Va.

P. O. Box #202, Huntington, W. Va.

COMPLETE ADDRESS

ADDRESS

September 22, 1922

PROPOSED LOCATION

COAL OPERATOR OR COAL OWNER

District

Location

County

Same

Well No. 4 (Serial No. 1000) 8524

OWNER OF MINERAL RIGHTS

O. F. Sparlock

ADDRESS

Town

Geological

The undersigned well operator is entitled to drill upon the above named farm or tract of land for

oil and gas having the title interest for as the case may be under grant or lease dated

to August 22, 1922 made by O. F. Sparlock

and recorded on the day

September, 1922 in the office of the County Clerk for said County in

43

43

Book

The enclosed plat was prepared by a competent engineer and shows the proposed location of a well to be drilled for oil and gas by the undersigned well operator on the farm and in the Mineral District of said County as named, determined by survey and courses and distances from the permanent point on land named

The undersigned well operator is informed and believes there are no coal operators operating beds of coal beneath said farm or tract of land on which said well is located, or within 500 feet of the boundary of the same, who have mapped their workings and filed their maps as required by law, excepting the coal operators or coal owners (if any) above named as references.

The above named coal operators or coal owners (if any) are notified that any objections they may desire to make to such proposed location, or which they are required to make by Section 8 of said Code, if the drilling of a well at said proposed location will cause a dangerous condition or about their respective coal mines, must be received by or filed with the Department of Mines within ten days from the receipt of a copy of this notice and accompanying plat by said Department. Said coal operators are further notified that forms for use in making such objections will be furnished to them by the Department of Mines promptly on request and that all such objections must be filed as definitely as reasonably possible the ground or grounds on which such objections are based and indicate the direction and distance the proposed location should be moved to a safe distance.

The next paragraph is to be completed only in Department's copy.

Copies of this notice and the enclosed plat were mailed by registered mail or delivered to the above

named coal operators or coal owners at their above shown respective addresses

on the same day with the mailing or delivery of this copy to the Department of Mines at Charleston

Very truly yours,

OWENS, LIBBEY-OWENS GAS DEPARTMENT

WELL OPERATOR

P. O. Box #108

STREET

Charleston

CITY OR TOWN

West Virginia

STATE

Address

of

Well Operator

Section 8. All coal operators or coal owners who are notified by the Department of Mines within said period of ten days from the receipt of said notice and plat by the Department of Mines to said proposed location, the Department shall forthwith make to the well operator a return permit setting the time of such plat, that no objections have been made by interested parties to the location, or found correct by the Department, and that the same is approved and the well operator authorized to proceed to drill at said location.

WT-1230

Permit Number

08/25/2023

A-10

OWENS, LIBBEY-OWENS GAS DEPARTMENT

5793 MACCORKLE AVENUE

P. O. BOX 4158

CHARLESTON 4, WEST VIRGINIA



September 22, 1959

W. Va. Department of Mines
Oil & Gas Division
Charleston, West Virginia

Gentlemen:

We are submitting an application for a permit to drill well No. 4 (Serial No. 1086) on our O. J. Spurlock leasehold, situated in Union District, Wayne County, West Virginia. Attached to the application is a plat showing the proposed location of said well.

Very truly yours,

OWENS, LIBBEY-OWENS GAS DEPARTMENT

By T. S. Flournoy
T. S. Flournoy, Chief Engineer

TSF/ed
Enclosures

cc: Mr. O. J. Spurlock
P. O. Box 9027
Huntington, W. Va.



08/25/2023

OWENS LIBBEY-OWENS GAS DEPARTMENT

5753 MACGORKLE AVENUE
P. O. BOX 4122
CHARLESTON 4, WEST VIRGINIA



September 22, 1959

W. Va. Department of Mines
Oil & Gas Division
Charleston, West Virginia

Sir:

We are submitting an application for a permit to
drill well No. 4 (serial No. 100) on our O. I. S. Leasehold
located in Lincoln County, Wayne County,
West Virginia. Attached to the application is a plat
showing the proposed location of said well.

Very truly yours,

OWENS LIBBEY-OWENS GAS DEPARTMENT

[Signature]
T. S. Flannery, Sales Manager

Respectfully,
Enclosure

cc: Mr. O. J. Spunk
P. O. Box 9027
Huntington, W. Va.



STATE OF WEST VIRGINIA
 DEPARTMENT OF MINES
 CHARLESTON

October 2, 1959

COPY

Owens, Libby-Owens Gas Department
 P. O. Box 4168
 Charleston, West Virginia

Dear Sirs:

Enclosed are permits for drilling the following wells -

Permit No.	Well No.	Farm	District
WAY-1230	4-S-1086	O. J. Spurlock	Union
WAY-1229	54-S-1085	Heard-Baldwin Tract #11	Stonewall

Very truly yours,

Crawford L. Wilson, Director
 DEPARTMENT OF MINES

BY _____
 Assistant Director
 OIL AND GAS DIVISION

MG/m
 encl:
 cc Mr. James W. Pack, Inspector

Mr. R. C. Tucker, Assistant
 State Geologist



STATE OF WEST VIRGINIA
 DEPARTMENT OF MINES
 CHARLESTON

October 2, 1939

COPY

Genl. Libby - State Department
 P. O. Box 110
 Charleston, West Virginia

Dear Sirs:

Enclosed are permits for drilling the following wells -

Permit No.	Well No.	Owner
WV-1230	1-2-1085	C. A. Spaulding
WV-1231	2-2-1085	Hard-Baldwin Trust Co. of West Virginia

Very truly yours,

Granford L. Wilson, Director
 DEPARTMENT OF MINES

BY _____
 Assistant Director
 OIL AND GAS DIVISION

Mr. R. C. Taylor, Assistant
 State Geologist
 cc Mr. Jones W. Cook, Inspector
 Mr. Taylor

E-6

February 4, 1960

Owens, Libbey-Owens Gas Department
P. O. Box 4168
Charleston 4, West Virginia

Att: Mr. A. H. Smith

Gentlemen:

Please send us two copies of the completion
drilling record for the following Wells:

<u>Permit No.</u>	<u>Farm</u>	<u>Well No.</u>	<u>District</u>
WAY-1230	O. J. Spurlock	4-Sr. No. 1086	Union
WAY-1232	Ethel Goode "A" 167 acres	2-Sr. No. 1058	Butler
WAY-1233	Madge L. Matthews	1076-2	Butler

Very truly yours,

CRAWFORD L. WILSON, DIRECTOR
Department of Mines

Assistant Director
OIL AND GAS DIVISION

MG/b

cc: Mr. James W. Pack, Inspector



STATE OF WEST VIRGINIA
DEPARTMENT OF MINES
OIL AND GAS DIVISION 5

Quadrangle Guyandot

Permit No. Way-1230

WELL RECORD

Oil or Gas Well Gas
(KIND)

Company Owens, Libbey-Owens Gas Department
Address P.O. Box 4168, Charleston 4, W.Va.
Farm O. J. Spurlock Acres 533
Location (waters) _____
Well No. 4 (Serial No. 1086) Elev. 825.4
District Union County Wayne
The surface of tract is owned in fee by _____
Address _____

Mineral rights are owned by O. J. Spurlock
Address P.O. Box 9027
Huntington, W. Va.

Drilling commenced 9/28/59
Drilling completed 1/5/60
Date Shot 1/13, 21/60 From 3840 To 3861

With 133 1/3# Hercules Gel, 1166 2/3# Trojan Pdr.

Open Flow _____ /10ths Water in _____ Inch
_____ /10ths Merc. in _____ Inch

Volume Big Six 48 M Cu. Ft.

Rock Pressure 775 lbs. 48 hrs.

Oil _____ bbls., 1st 24 hrs.

Fresh water 103, 700 feet

Salt water 1051, 3371 feet

Casing and Tubing	Used in Drilling	Left in Well	Packers
Size			Kind of Packer
16			<u>Larkin upside down</u>
13			
10 <u>3/4</u>	<u>330'4"</u>	<u>330'4"</u>	Size of
<u>8 x 5/8</u>	<u>1333'3"</u>	<u>Pulled</u>	<u>3 1/2 x 5 1/2 x 16</u>
<u>7</u>	<u>2193'3"</u>	<u>2193'3"</u>	Depth set
<u>5 3/16 1/2</u>	<u>3609'7"</u>	<u>3609'7"</u>	<u>3767 - 3773</u>
<u>3 1/2</u>	<u>--</u>	<u>3849'</u>	Perf. top <u>3833</u>
<u>2</u>			Perf. bottom <u>3846</u>
Liners Used			Perf. top _____
			Perf. bottom _____

CASING CEMENTED _____ SIZE _____ No. Ft. _____ Date _____

COAL WAS ENCOUNTERED AT _____ FEET _____ INCHES
_____ FEET _____ INCHES
_____ FEET _____ INCHES

Formation	Color	Hard or Soft	Top	Bottom	Oil, Gas or Water	Depth Found	Remarks
Clay	Red	Soft	0	45			
Sand	White	Hard	45	113			
Slate	White	Soft	113	133			
Slate	Dark	Soft	133	135			
Slate	White	Soft	135	180			
Sand	White	Hard	135	205			
Slate	Blue	Soft	205	261			
Sand	White	Soft	261	293			
Slate	White	Soft	293	331			
Lime	White	Hard	331	369			
Sand	White	Hard	369	393			
Slate	White	Soft	393	476			
Sand	White	Soft	476	566			
Slate	White	Soft	566	591			
Lime	White	Hard	591	596			
Slate	White	Soft	596	664			
Sand	White	Soft	664	722			
Slate	Blue	Soft	722	729			
Slate	White	Hard	729	802			
Slate	White	Soft	802	852			
Sand	White	Hard	852	872			
Slate	White	Soft	872	902			
Sand	White	Hard	902	938			
Slate	Blue	Med.	938	990			
Sand	White	Hard	990	1088			
Lime	White	Hard	1088	1115			
Sand	White	Hard	1115	1152			
Slate	Blue	Soft	1152	1178			
Slate	White	Soft	1178	1203			
Red Rock	Red	Soft	1203	1223			
Slate	White	Soft	1223	1296			
Slate	White	Hard	1296	1302			
Little Lime	Grey	Hard	1302	1307			
Little Lime	White	Hard	1307	1317			

Water at 103, 2 BPH

Water at 700, 1 BPH

Water at 1051, hole full

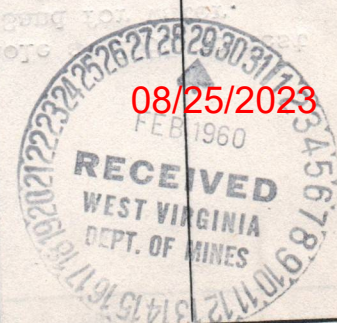

B-2

Formation	Color	Hard or Soft	Top 5	Bottom	Oil, Gas or Water	Depth Found	Remarks
Little Lime	White	Hard	1317	1320			
Pencil Cove	Dark	Soft	1320	1321			
Big Lime	White	Hard	1321	1334			
Big Lime	White	Hard	1334	1487			
Big Injun	Dark	Soft	1487	1519			
Big Injun	Grey	Med.	1519	1539			
Slate	Grey	Soft	1539	1549			
Stray Sand	Grey	Med.	1549	1555			
Stray Sand	Grey	Med.	1555	1576			Dried up hole at 1555 to test Big Injun Sand for water. In 27 hrs., 35 gal. water and skim of oil.
Slate	White	Soft	1576	1665			
Slate	Blue	Soft	1665	1975			
Slate	White	Soft	1975	2045			
Sl. & Shls.	Dark	Soft	2045	2106			
Brown Shale	Brown	Soft	2106	2123			
Berea	Grey	Hard	2123	2159			
Slate	Black	Soft	2159	2186			
Lime Shells	Blue	Hard	2186	2193			
Lime	Black	Hard	2193	2210			
Sl. & Shls.	Grey	Med.	2210	2230			
Brown Shale	Brown	Soft	2230	2320			
Slate	White	Soft	2320	2513			
Brown Shale	Brown	Soft	2513	2622			
Slate	White	Soft	2622	2655			
Shells	White	Med.	2655	2673			
Brown Shale	Brown	Soft	2673	2765			
Brown Shale	Brown	Med.	2765	2968			
Slate	White	Soft	2968	3136			
Brown Shale	Brown	Med.	3136	3184			
Corn. Lime	Grey	Hard	3184	3255			
Corn. Lime	Light	Hard	3255	3271			
Corn. Lime	Grey	Hard	3271	3373			Black water 3371, 1 Blr. in 12 hrs.
Slate	Black	Soft	3373	3376			
Corn. Lime	-	-	3376	3392			
Corn. Lime	Grey	Hard	3392	3416			
Corn. Lime	Black	Hard	3416	3456			
Corn. Lime	Grey	Hard	3456	3610			12-15-59 & 12-16-59 Installed 5 1/2" csg. at 3610' with Parmaco B. H. Pkr. set 3607 - 3610 and Anchor Pkr. set 3256 - 3260. Ran 110 gal. Kontol and 396 gal. water between Pkrs.
Cornif. Lime	Grey	Hard	3610	3616			
Cornif. Lime	Grey	Hard	3616	3838			
Big Six Sand	Grey	Hard	3838	3909			Gas show at 3854 Gas 3864 4.9 MCF Gas 3880 6.7 MCF Gas 3901 8 .6 MCF
Slate	White	Soft	3909	3916			
Red Rock	Red	Soft	3916	3921			Test 3921 8.6 MCF SIM 3921 = Sand IM 3919
			T. D.	3921			
			Cleaned out to	3859 SIM			Birdwell ran Gamma Ray and temperature logs from bottom of 5 1/2" csg. to 3909.
							1-12-60 Filled hole to 3860'
							1-13-60 Shot with 133# Hercules Gelatin from 3840 to 3861. Cleaned out for 95 hours. Shot second time at same interval with 110# Hercules Gelatin

Date February 18, 19

APPROVED Owens, Libbey-Owens Gas Department

By A. H. Smith, Mgr. (Title) Land, Engr

08/25/2023



STATE OF WEST VIRGINIA
DEPARTMENT OF MINES
OIL AND GAS DIVISION **5A**

Quadrangle Guyandot

WELL RECORD

Permit No. Way-1230

Oil or Gas Well Gas
(KIND)

Company Owens, Libbey-Owens Gas Department
 Address _____
 Farm O. J. Spurlock Acres _____
 Location (waters) _____
 Well No. 4 (Serial No. 1086) Elev. _____
 District _____ County _____
 The surface of tract is owned in fee by _____
 Address _____
 Mineral rights are owned by _____
 Address _____
 Drilling commenced 9/28/59
 Drilling completed 1/5/60
 Date Shot _____ From _____ To _____
 With _____
 Open Flow _____ /10ths Water in _____ Inch
 _____ /10ths Merc. in _____ Inch
 Volume _____ Cu. Ft.
 Rock Pressure _____ lbs. _____ hrs.
 Oil _____ bbls., 1st 24 hrs.
 Fresh water _____ feet _____ feet
 Salt water _____ feet _____ feet

Casing and Tubing	Used in Drilling	Left in Well	Packers
Size			Kind of Packer
16			
13			
10			Size of
8 1/4			
6 5/8			Depth set
5 3/16			
3			Perf. top
2			Perf. bottom
Liners Used			Perf. top
			Perf. bottom

CASING CEMENTED _____ SIZE _____ No. Ft. _____ Date _____

COAL WAS ENCOUNTERED AT _____ FEET _____ INCHES
 _____ FEET _____ INCHES FEET _____ INCHES
 _____ FEET _____ INCHES FEET _____ INCHES

Formation	Color	Hard or Soft	Top	Bottom	Oil, Gas or Water	Depth Found	Remarks
					<u>1-13-60</u>		Well cleaned out for 171 hours , then shut-in.
					<u>1-29-60</u>		F. O. F. Big Six 48 MCF

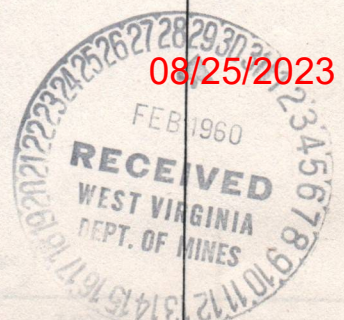

STATE OF WEST VIRGINIA
DEPARTMENT OF MINES
OIL AND GAS DIVISION

INSPECTOR'S WELL REPORT

Permit No. WAY-1230

Oil or Gas Well Gas
(KIND)

<p>Company <u>Owens Libby Owens Gas Dept.</u> <u>P.O. Box 1468</u> Address <u>Charleston, West Va.</u> Farm <u>O. J. Spurlock</u> Well No. <u>4 - SR- 1086</u> District <u>Union</u> County <u>Wayne</u> Drilling commenced <u>9-28-59</u> Drilling completed _____ Total depth _____ Date shot _____ Depth of shot _____ Initial open flow _____ /10ths Water in _____ Inch Open flow after tubing _____ /10ths Merc. in _____ Inch Volume _____ Cu. Ft. Rock pressure _____ lbs. _____ hrs. Oil _____ bbls., 1st 24 hrs. Fresh water <u>103</u> feet _____ feet Salt water _____ feet _____ feet</p>	<table border="1" style="width: 100%; border-collapse: collapse;"> <thead> <tr> <th style="width: 15%;">CASING AND TUBING</th> <th style="width: 15%;">USED IN DRILLING</th> <th style="width: 15%;">LEFT IN WELL</th> <th style="width: 55%;">PACKERS</th> </tr> </thead> <tbody> <tr> <td>Size</td> <td></td> <td></td> <td>Kind of Packer _____</td> </tr> <tr> <td>16</td> <td></td> <td></td> <td></td> </tr> <tr> <td>13</td> <td>12 ft. - wood</td> <td></td> <td></td> </tr> <tr> <td>10</td> <td>336'</td> <td></td> <td>Size of _____</td> </tr> <tr> <td>8 1/4</td> <td></td> <td></td> <td></td> </tr> <tr> <td>6 3/8</td> <td></td> <td></td> <td>Depth set _____</td> </tr> <tr> <td>5 3/16</td> <td></td> <td></td> <td></td> </tr> <tr> <td>3</td> <td></td> <td></td> <td>Perf. top _____</td> </tr> <tr> <td>2</td> <td></td> <td></td> <td>Perf. bottom _____</td> </tr> <tr> <td>Liners Used</td> <td></td> <td></td> <td>Perf. top _____</td> </tr> <tr> <td></td> <td></td> <td></td> <td>Perf. bottom _____</td> </tr> </tbody> </table> <p>CASING CEMENTED _____ SIZE _____ No. FT. _____ Date _____</p> <p>COAL WAS ENCOUNTERED AT _____ FEET _____ INCHES</p> <p>_____ FEET _____ INCHES _____ FEET _____ INCHES</p> <p>_____ FEET _____ INCHES _____ FEET _____ INCHES</p>	CASING AND TUBING	USED IN DRILLING	LEFT IN WELL	PACKERS	Size			Kind of Packer _____	16				13	12 ft. - wood			10	336'		Size of _____	8 1/4				6 3/8			Depth set _____	5 3/16				3			Perf. top _____	2			Perf. bottom _____	Liners Used			Perf. top _____				Perf. bottom _____
CASING AND TUBING	USED IN DRILLING	LEFT IN WELL	PACKERS																																														
Size			Kind of Packer _____																																														
16																																																	
13	12 ft. - wood																																																
10	336'		Size of _____																																														
8 1/4																																																	
6 3/8			Depth set _____																																														
5 3/16																																																	
3			Perf. top _____																																														
2			Perf. bottom _____																																														
Liners Used			Perf. top _____																																														
			Perf. bottom _____																																														

Drillers' Names Linnet McComas

Homer Yeager

Remarks: Drilling depth 625'.

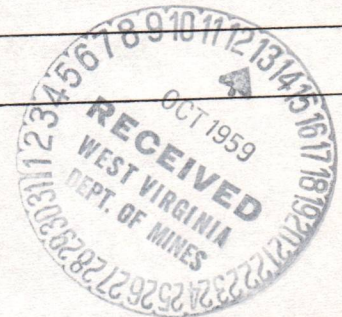

10-6-59
DATE

J.W. Pack
DISTRICT WELL INSPECTOR

08/25/2023

STATE OF WEST VIRGINIA
 DEPARTMENT OF MINES
 OIL AND GAS DIVISION

INSPECTOR'S PLUGGING REPORT

Permit No. _____ Well No. _____

COMPANY _____ ADDRESS _____

FARM _____ DISTRICT _____ COUNTY _____

Filling Material Used _____

Liner	Location	Amount	Packer	Location		
PLUGS USED AND DEPTH PLACED			BRIDGES	CASING AND TUBING		
CEMENT-THICKNESS	WOOD-SIZE	LEAD	CONSTRUCTION-LOCATION	RECOVERED	SIZE	LOST

Drillers' Names _____

Remarks: _____

 DATE I hereby certify I visited the above well on this date.

DISTRICT WELL INSPECTOR
 08/25/2023

B-5

STATE OF WEST VIRGINIA
DEPARTMENT OF MINES
OIL AND GAS DIVISION

INSPECTOR'S WELL REPORT

Permit No. WAY-1230

Oil or Gas Well 4-S-1086
(KIND) gas

Company	CASING AND TUBING	USED IN DRILLING	LEFT IN WELL	PACKERS
<u>Owens Libby Owens Gas Dept.</u>				
<u>P.O. Box 4168</u>	Size			
<u>Charleston, W. Va.</u>				
<u>O. J. Spurlock</u>	16			Kind of Packer
<u>4 - S 1086</u>	13	<u>12 ft. wood</u>		
<u>Union</u> County <u>Wayne</u>	10	<u>331'6"</u>		Size of
<u>9-28-59</u>	8 1/4	<u>1334'8"</u>		
<u>9-28-59</u>	6 5/8			Depth set
<u>9-28-59</u>	5 3/16			
<u>9-28-59</u>	3			Perf. top
<u>9-28-59</u>	2			Perf. bottom
<u>9-28-59</u>	Liners Used			Perf. top
<u>9-28-59</u>				Perf. bottom
<u>9-28-59</u>	CASING CEMENTED	SIZE	No. FT.	Date
<u>9-28-59</u>				
<u>9-28-59</u>	COAL WAS ENCOUNTERED AT	FEET	INCHES	
<u>9-28-59</u>		FEET	INCHES	
<u>9-28-59</u>		FEET	INCHES	

Drillers' Names Albert Miller

Fred Lusher

Remarks: Salt Sand 872'-902'; Big Lime 1328'-1493'; Berea Sand 2126'-2164'; Brown Shale 2658'-2968'; Brown Shale 3132'-3184'; corniferous Lime 3184'; drilling depth 3260'; no record of water or record of 7" casing in record book at well.

12-3-59
DATE

DEC 1959
RECEIVED
J.W. Park
DISTRICT WELL INSPECTOR
08/25/2023

STATE OF WEST VIRGINIA
DEPARTMENT OF MINES
OIL AND GAS DIVISION

INSPECTOR'S PLUGGING REPORT

Permit No. _____ Well No. _____

COMPANY _____ ADDRESS _____

FARM _____ DISTRICT _____ COUNTY _____

Filling Material Used _____

Liner Location Amount Packer Location

PLUGS USED AND DEPTH PLACED			BRIDGES	CASING AND TUBING		
CEMENT-THICKNESS	WOOD-SIZE	LEAD	CONSTRUCTION-LOCATION	RECOVERED	SIZE	LOST

Drillers' Names _____

Remarks: _____

_____ I hereby certify I visited the above well on this date.

DATE

DISTRICT WELL INSPECTOR
08/25/2023

B-6

STATE OF WEST VIRGINIA
DEPARTMENT OF MINES
OIL AND GAS DIVISION

INSPECTOR'S WELL REPORT

Permit No. WAY-1230

Oil or Gas Well 4-S-1086
(KIND)

		CASING AND TUBING	USED IN DRILLING	LEFT IN WELL	PACKERS
Company	<u>Owens Libby Owens Gas Dept.</u>	Size			
Address	<u>Box 4168 Charleston, W. Va.</u>	16			Kind of Packer
Farm	<u>O. J. Spurlock</u>	13	<u>12' (wood)</u>		
Well No.	<u>4-S-1086</u>	10	<u>330'</u>		Size of
District	<u>Union</u> County <u>Wayne</u>	8 1/4	<u>1333' (pulled)</u>		Depth set
Drilling commenced	<u>9-28-59</u>	6 5/8	<u>2193' 3"</u>		
Drilling completed	Total depth	5 3/16	<u>3610'</u>		Perf. top
Date shot	Depth of shot	3			Perf. bottom
Initial open flow	/10ths Water in Inch	2			Perf. top
Open flow after tubing	/10ths Merc. in Inch	Liners Used			Perf. bottom
Volume	Cu. Ft.	CASING CEMENTED SIZE No. FT. Date			
Rock pressure	lbs. hrs.	COAL WAS ENCOUNTERED AT FEET INCHES			
Oil	bbls., 1st 24 hrs.	FEET INCHES FEET INCHES			
Fresh water	feet feet	FEET INCHES FEET INCHES			
Salt water	feet feet				

Drillers' Names Linnet McComas

Albert Miller

Remarks:

Running 5-3/16" casing through Black Water in Corniferous Lime at 3610'. There is no sulphur gas at this depth in corniferous Lime. Set 5-3/16" casing on Bottom Hole Packer at 3610' and screw anchor packer set at 3270'; set 5-3/16" casing in 165 gallon of Konto # K141 mixed with 330 gallon of water to preserve 5-3/16" casing.

12-15-59

DATE

J.W. Pack
DISTRICT WELL INSPECTOR

DISTRICT WELL INSPECTOR

08/25/2023

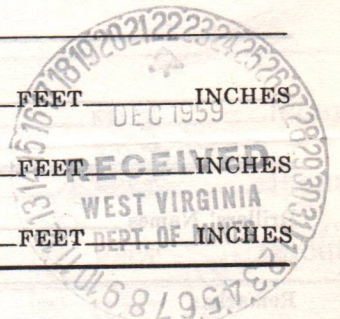

STATE OF WEST VIRGINIA
DEPARTMENT OF MINES
OIL AND GAS DIVISION
INSPECTOR'S PLUGGING REPORT

Permit No. _____ Well No. _____

COMPANY _____ ADDRESS _____

FARM _____ DISTRICT _____ COUNTY _____

Filling Material Used _____

Liner _____ Location _____ Amount _____ Packer _____ Location _____

PLUGS USED AND DEPTH PLACED			BRIDGES	CASING AND TUBING		
CEMENT-THICKNESS	WOOD-SIZE	LEAD	CONSTRUCTION-LOCATION	RECOVERED	SIZE	LOST

Drillers' Names _____

Remarks: _____

DATE _____ I hereby certify I visited the above well on this date.

DISTRICT WELL INSPECTOR _____
DISTRICT WELL INSPECTOR _____
08/25/2023

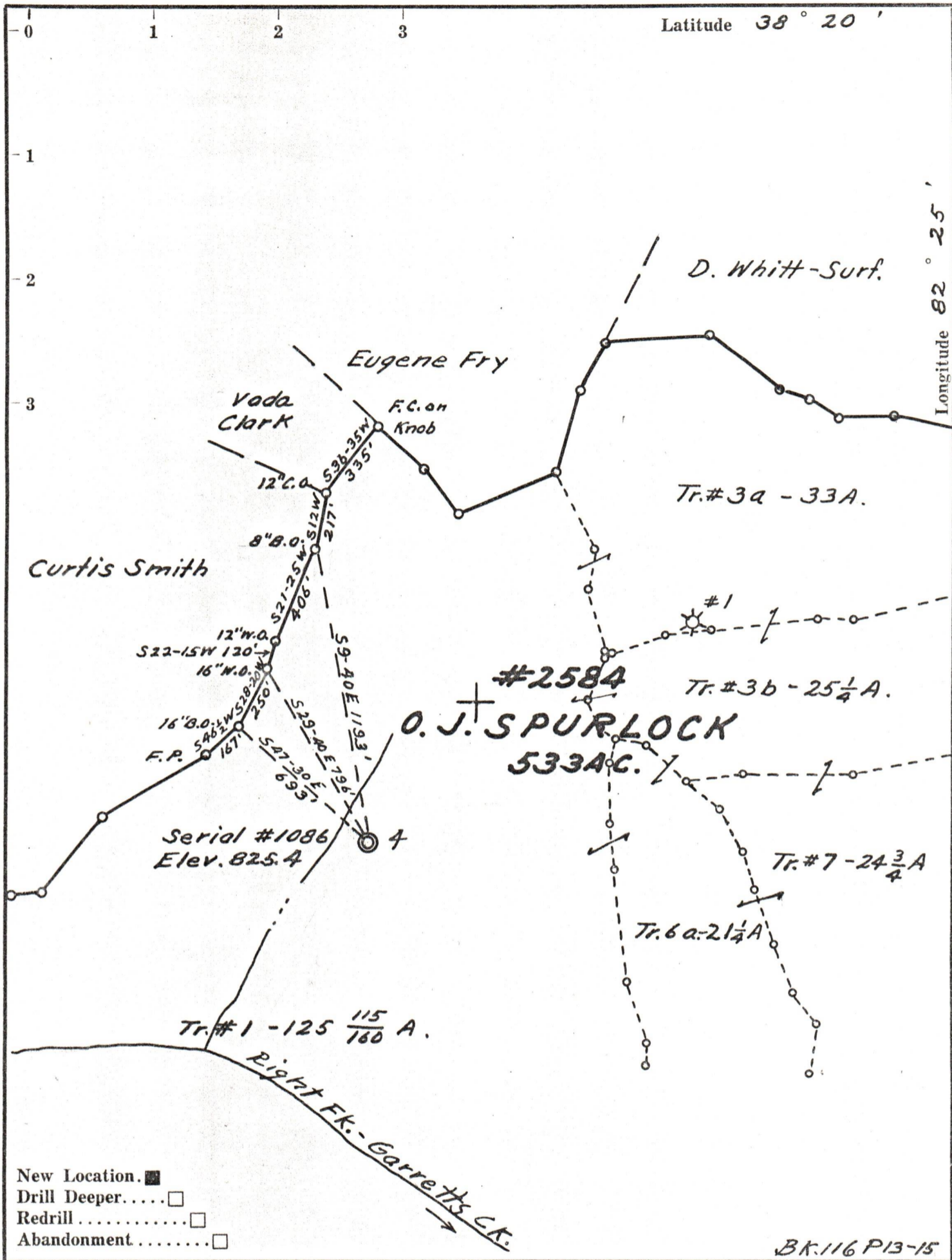

- New Location.
- Drill Deeper.....
- Redrill.....
- Abandonment.....

BR.116 P13-15

Company Owens, Libbey-Owens Gas Dept.
 Address Box 4168 Charleston 4 W. Va.
 Farm O.J. SPURLOCK
 Tract 1 Acres 125 ¹¹⁵/₁₆₀ Lease No. 2584
 Well (Farm) No. 4 Serial No. 1086
 Elevation (Spirit Level) 825.4
 Quadrangle Guyandot
 County Wayne District Union
 Engineer T.S. Flournoy
 Engineer's Registration No. 269
 File No. _____ Drawing No. _____
 Date Aug. 25, 1959 Scale 1" = 500 Ft.

STATE OF WEST VIRGINIA
 DEPARTMENT OF MINES
 OIL AND GAS DIVISION
 CHARLESTON

WELL LOCATION MAP
 FILE NO. WAY-1230

08/25/2023

+ Denotes location of well on United States Topographic Maps, scale 1 to 62,500, latitude and longitude lines being represented by border lines as shown.
 — Denotes one inch spaces on border line of original tracing.