



STATE OF WEST VIRGINIA
DEPARTMENT OF MINES
OIL AND GAS DIVISION

NOTICE OF PROPOSED LOCATION OF OIL AND GAS WELL

To The DEPARTMENT OF MINES,
Charleston, W. Va.

Oral Richardson
COAL OPERATOR OR COAL OWNER

Wayne, W. Va. - c/o Mat Richardson
ADDRESS

COAL OPERATOR OR COAL OWNER

Owens-Illinois Glass Company and
Libbey-Owens-Ford Glass Company
OWNER OF MINERAL RIGHTS

Charleston 4, W. Va.
ADDRESS

OWENS, LIBBEY-OWENS GAS DEPARTMENT
NAME OF WELL OPERATOR

P. O. Box 4168, Charleston 4, W. Va.
COMPLETE ADDRESS

December 15, 19 59

PROPOSED LOCATION

Stonewall District

Wayne County

Well No. 55 (Serial No. 1087) ^{38° 15'} _{82° 15'} Elev. 10 1/2

Hoard-Baldwin Tract No. 2 Farm

67 acres

GENTLEMEN:

The undersigned well operator is entitled to drill upon the above named farm or tract of land for oil and gas, having fee title thereto, (~~or as the case may be~~) under grant or lease dated December 17, 1936, made by H. Rummel Anderson & T. B. Jackson, to Owens-Illinois Glass Co. and Libbey-Owens-Ford Glass Co., and recorded on the 23rd day of December, 1936, in the office of the County Clerk for said County in Book 188, page 133.

The enclosed plat was prepared by a competent engineer and shows the proposed location of a well to be drilled for oil and gas by the undersigned well operator on the farm and in the Magisterial District and County above named, determined by survey and courses and distances from two permanent points, or land marks.

The undersigned well operator is informed and believes there are no coal operators operating beds of coal beneath said farm or tract of land on which said well is located, or within 500 feet of the boundaries of the same, who have mapped their workings and filed their maps as required by law, excepting the coal operators or coal owners (if any) above named as addressees.

The above named coal operators or coal owners (if any) are notified that any objections they may desire to make to such proposed location, or which they are required to make by Section 3 of said Code, if the drilling of a well at said proposed location will cause a dangerous condition in or about their respective coal mines, must be received by, or filed with the Department of Mines within ten* days from the receipt of a copy of this notice and accompanying plat by said Department. Said coal operators are further notified that forms for use in making such objections will be furnished to them by the Department of Mines promptly on request and that all such objections must set forth as definitely as is reasonably possible the ground or grounds on which such objections are based and indicate the direction and distance the proposed location should be moved to overcome same.

(The next paragraph is to be completed only in Department's copy.)

Copies of this notice and the enclosed plat were mailed by registered mail, or delivered to the above named coal operators or coal owners at their above shown respective address day before, or on the same day with the mailing or delivery of this copy to the Department of Mines at Charleston, West Virginia.

Very truly yours,

OWENS, LIBBEY-OWENS GAS DEPARTMENT
WELL OPERATOR

P. O. Box 4168

Charleston 4,
STREET

West Virginia
CITY OR TOWN

West Virginia
STATE

08/25/2023

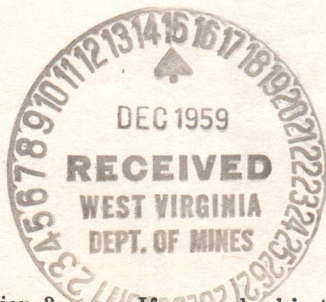

Address of Well Operator }

*Section 3. If no such objections be filed or be found by the department of mines, within said period of ten days from the receipt of said notice and plat by the department of mines, to said proposed location, the department shall forthwith issue to the well operator a drilling permit reciting the filing of such plat, that no objections have been made by the coal operators to the location, or found thereto by the department, and that the same is approved and the well operator authorized to proceed to drill at said location.

1248

WAY-1248

PERMIT NUMBER



STATE OF WEST VIRGINIA
DEPARTMENT OF MINES
OIL AND GAS DIVISION

NOTICE OF PROPOSED LOCATION OF OIL AND GAS WELL

To The Department of Mines
Charleston, W. Va.

OWENS, LIBBEY-OWENS GAS DEVELOPMENT

Oral Richardson

HAVE BY WELL OPERATOR

COAL OPERATOR OR COAL OWNER

W. O. Fox, AIG, Charleston, W. Va.

W. O. Fox, AIG, Charleston, W. Va.

COMPLETE ADDRESS

ADDRESS

December 15, 1936

COAL OPERATOR OR COAL OWNER

PROPOSED LOCATION

Stonewall

OWENS-LIBBEY GAS COMPANY and
LIBBEY-OWENS GAS COMPANY

County

Well No. 22 (Booklet No. 1007)

Charleston, W. Va.

East-Central Tract No. 2

ADDRESS

The undersigned well operator is entitled to drill upon the above named tract or tract of land for

oil and gas having the title thereto.

December 15, 1936

OWENS-LIBBEY GAS CO. and LIBBEY-OWENS GAS CO.

in the office of the County Clerk for said County in

Book 100 Page 153

The enclosed map was prepared by a competent engineer and shows the proposed location of a well to be drilled for oil and gas by the undersigned well operator on the tract and in the District of

and County above named, determined by survey and course and distance from the permanent point of

land mark.

The undersigned well operator is informed and believes there are no coal operators operating on

or coal bearing land or tract of land on which said well is located or within 500 feet of the point

of the same, who have marked their workings and filed their maps as required by law, excepting the

coal operators or coal owners (if any) above named as indicated.

The above named coal operators or coal owners (if any) are notified that any objections they may

have to make to such proposed location, at which they are required to make by Section 3 of said Code, if

the drilling of a well at said proposed location will cause a dangerous condition to exist on their respective

land, must be received by or filed with the Department of Mines within ten days from the receipt of

a copy of this notice and accompanying map by said Department. Said coal operators are further notified

that for the purpose of making such objections, they will be furnished to them by the Department of Mines promptly

on request and that all such objections must set forth as definitely as is reasonably possible the ground or

grounds on which such objections are based and indicate the direction and distance the proposed location should

be moved to overcome same.

08/25/2023

B-2

Formation	Color	Hard or Soft	Top 15'	Bottom	Oil, Gas or Water	Depth Found	Remarks
Little Lime	Dark	Hard	1443	1460			
Slate	Dark	Soft	1460	1462			
Big Lime	Grey	Hard	1462	1490	1-23-60		Installed 7" csg. at 1490 on shoe
Big Lime	White	Hard	1490	1501	1-26-60		Pulled 7" csg. at 1488' 11"
Big Lime	Grey	Hard	1501	1508	1-27-60		Installed 7" csg. at 1501 on shoe
Big Lime	Dark	Hard	1508	1514			
Big Lime	Grey	Hard	1514	1526			
Big Lime	Light	Hard	1526	1536	Gas 1531	11 MCF	
Big Lime	Grey	Hard	1536	1589	SIM 1536 = Sand IM 1536		
Big Lime	Light	Hard	1589	1622	Test 1536-70	1.5 MCF	
Big Lime	Grey	Hard	1622	1624	Gas 1589	3.8 MCF	
Red Rock	Red	Med.	1624	1638	Test 1598	3.4 MCF	
Grey Injun	Grey	Med.	1638	1700	Gas ? 1605	3.9 MCF	
					Gas 1674	31.3 MCF	
					Gas 1679	50.7 MCF	
					Gas 1684	66 MCF	
					Gas 1692	83 MCF	
					Gas 1696	86 MCF	
Sl. & Shls.	Dark	Med.	1700	1717			
			T. D.	1717	2-5-60		
					Shot with 300# DuPont Gelatin from 1670 to 1700 (2 P.M.)		
					Test BS:	73 MCF	
					2-8-60		
					Drilled out tamp at 11 A.M.		
					Test 11:00 P.M.	219 MCF	
					2-9-60		
					31 Hrs. A.T.O.	172 MCF	
					2-10-60		
					54 Hrs. A.T.O.	154 MCF	
					2-11-60		
					84 Hrs. A.T.O.	140 MCF	
					2-12-60		
					Shot Injun 2nd time with 4400# Trojan Powder from 1670 to 1700' (5:39 P.M.)		
					Test BS:	133 MCF	
					2-17-60		
					Drilled out tamp 8 A.M.		
					Test 3 Hrs. A.T.O.	695 MCF	
					2-18-60 to 2-29-60		
					Cleaning out and testing		
					3-2-60		
					Installed 3 1/2" tbg. at 1715 with "Oilwell Comb. W & A Packer		
					Final Open Flow		
					Big Injun	160 MCF	
					Shut-in at 3:20 P.M.		

08/25/2023

Date March 16, 1960

APPROVED Owens, Libbey-Owens Gas Department, Owner

By A. H. Smith
A. H. Smith, Mgr.(Title) Land, Engr., & Geol.

B-1



STATE OF WEST VIRGINIA DEPARTMENT OF MINES OIL AND GAS DIVISION 15

Quadrangle Wayne

Permit No. Way-1248

WELL RECORD

Oil or Gas Well Gas (KIND)

Company Owens, Libbey-Owens Gas Department
Address P.O. Box 4168, Charleston, W. Va.
Farm Hoard-Baldwin Acres 66-3/4
Location (waters)
Well No. 55 (Serial #1087) Elev. 1042.36
District Stonewall County Wayne
The surface of tract is owned in fee by Hoard-Baldwin

Mineral rights are owned by Owens, Libbey-Owens Gas Department

Drilling commenced 12-30-59
Drilling completed 2-5-60
Date Shot 2-5-60 From 1670 To 1700
With 300# DuPont Gelatin; 4400# Trojan Powder

Open Flow /10ths Water in In
/10ths Merc. in In
Volume Big Injun 160 M Cu. Ft.
Rock Pressure 186 lbs. 48 hrs.
Oil bbls., 1st 24 hrs.
Fresh water 510 feet 1030 feet
Salt water feet feet

Table with 4 columns: Casing and Tubing, Used in Drilling, Left in Well, Packers. Includes data for sizes 16, 13, 10, 8 1/2, 7, 5 1/2, 3 1/2, 2 and packer details like 'Oilwell Comb. W&A' and '3 1/2 x 7 x 16'.

CASING CEMENTED SIZE No. Ft. Date

COAL WAS ENCOUNTERED AT 521 FEET 72 INCHES
FEET INCHES FEET INCHES
FEET INCHES FEET INCHES

Main stratigraphic log table with columns: Formation, Color, Hard or Soft, Top, Bottom, Oil, Gas or Water, Depth Found, Remarks. Lists formations from Clay to Slate with depths and remarks like 'Water at 510, 2 BPH' and 'Installed 8-5/8" csg. at 565' on shoe'.

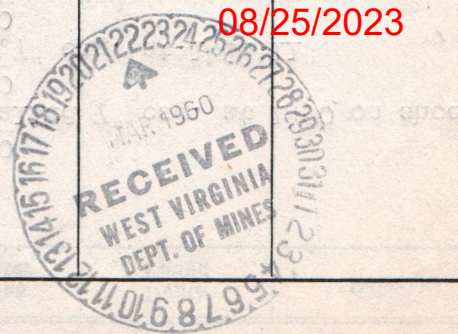

B-3

STATE OF WEST VIRGINIA
DEPARTMENT OF MINES
OIL AND GAS DIVISION

INSPECTOR'S WELL REPORT

Permit No. WAY-1248

Oil or Gas Well 55 SR 1087
(KIND)

Company <u>Owens Libby Owens Gas Dept.</u> <u>Box 4168</u> Address <u>Charleston, W. Va.</u> Farm <u>Hoard-Baldwin</u> Well No. <u>55 SR 1087</u> District <u>Stonewall</u> County <u>Wayne</u> Drilling commenced <u>1-2-60</u> Drilling completed _____ Total depth _____ Date shot _____ Depth of shot _____ Initial open flow _____ /10ths Water in _____ Inch Open flow after tubing _____ /10ths Merc. in _____ Inch Volume _____ Cu. Ft. Rock pressure _____ lbs. _____ hrs. Oil _____ bbls., 1st 24 hrs. Fresh water <u>510</u> feet _____ feet Salt water <u>985</u> feet _____ feet	CASING AND TUBING	USED IN DRILLING	LEFT IN WELL	PACKERS
	Size			Kind of Packer _____
	16			
	13			
	10	12'		Size of Shoe _____
	8 1/4	565'		8 1/4" --
	6 5/8	1501'		Depth set <u>1501'</u>
	5 3/16			shoe
	3			Perf. top _____
	2			Perf. bottom _____
Liners Used _____			Perf. top _____	
			Perf. bottom _____	

CASING CEMENTED 515 SIZE 60 No. FT. _____ Date _____

COAL WAS ENCOUNTERED AT _____ FEET _____ INCHES

_____ FEET _____ INCHES

_____ FEET _____ INCHES

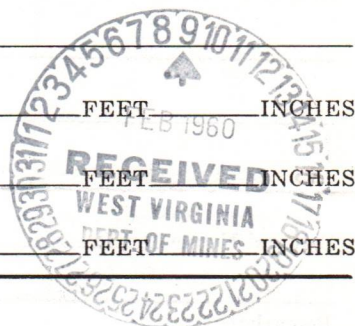

Drillers' Names Albert Miller
James Green

Remarks: Salt Sand 982'-1340'; Big Lime 1462'-; gas in Big Lime @ 1532'- testing 2/10 Water 1"; drilling in Big Lime @ 1616'.

2-3-60

DATE

J.W. Pack

DISTRICT WELL INSPECTOR

08/25/2023

STATE OF WEST VIRGINIA
 DEPARTMENT OF MINES
 OIL AND GAS DIVISION
INSPECTOR'S PLUGGING REPORT

Permit No. _____

Well No. _____

COMPANY _____ ADDRESS _____

FARM _____ DISTRICT _____ COUNTY _____

Filling Material Used _____

Liner	Location	Amount	Packer	Location	
PLUGS USED AND DEPTH PLACED			BRIDGES	CASING AND TUBING	
CEMENT-THICKNESS	WOOD-SIZE	LEAD	CONSTRUCTION-LOCATION	RECOVERED	SIZE LOST

Drillers' Names _____

Remarks: _____

_____ I hereby certify I visited the above well on this date.
 DATE

DISTRICT WELL INSPECTOR
08/25/2023

1.0 API well number: (If not available, leave blank. 14 digits.)	<u>47-099-1248</u>															
2.0 Type of determination being sought: (Use the codes found on the front of this form.)	<u>108</u> Section of NGPA	<u>NA</u> Category Code														
3.0 Depth of the deepest completion location: (Only needed if sections 103 or 107 in 2.0 above.)	<u>NA</u> feet															
4.0 Name, address and code number of applicant: (35 letters per line maximum. If code number not available, leave blank.)	<u>Industrial Gas Corporation</u> <u>009283</u> Name Seller Code <u>P. O, Box 1473</u> Street <u>Charleston</u> <u>WV</u> <u>25325</u> City State Zip Code															
5.0 Location of this well: [Complete (a) or (b).] (a) For onshore wells (35 letters maximum for field name.)	<u>NA</u> Field Name <u>Wayne</u> <u>WV</u> County State															
(b) For OCS wells:	<u>NA</u> <u>NA</u> Area Name Block Number Date of Lease: _____ Mo. Day Yr. <u>NA</u> OCS Lease Number															
(c) Name and identification number of this well: (35 letters and digits maximum.)	<u>Hoard Baldwin 55-1087</u>															
(d) If code 4 or 5 in 2.0 above, name of the reservoir: (35 letters maximum.)	<u>NA</u>															
6.0 (a) Name and code number of the purchaser: (35 letters and digits maximum. If code number not available, leave blank.)	See Addendum "A" <u>Houdaille Industries, Inc.</u> <u>N/Available</u> Name Buyer Code															
(b) Date of the contract:	<u>1 2 2 6 7 3</u> Mo. Day Yr.															
(c) Estimated annual production:	<u>2.9</u> MMcf.															
	(a) Base Price (\$/MMBTU)	(b) Tax	(c) All Other Prices [Indicate (+) or (-).]	(d) Total of (a), (b) and (c)												
7.0 Contract price: See Addendum "A" (As of filing date. Complete to 3 decimal places.)	<u>1 2 8 3</u>	<u>0 0 5 1</u>	<u>0 0 0 3</u>	<u>1 3 3 6</u>												
8.0 Maximum lawful rate: (As of filing date. Complete to 3 decimal places.)	<u>2.2 4 3</u>	<u>0.3 0 2</u>	<u>0.0</u>	<u>2.5 4 5</u>												
9.0 Person responsible for this application:	<table border="1" style="width:100%; border-collapse: collapse;"> <tr> <td style="width:30%; text-align: center;">Agency Use Only</td> <td style="text-align: center;"><u>William C. Charlton</u> <u>Division Counsel</u></td> </tr> <tr> <td style="text-align: center;">Date Received by Juris. Agency</td> <td style="text-align: center;">Name Title</td> </tr> <tr> <td style="text-align: center;"><u>FEB 28 1979</u></td> <td style="text-align: center;"><u>William C. Charlton</u></td> </tr> <tr> <td style="text-align: center;">Date Received by FERC</td> <td style="text-align: center;">Signature</td> </tr> <tr> <td></td> <td style="text-align: center;"><u>02/ 28/79</u> <u>(304) 342-8166</u></td> </tr> <tr> <td></td> <td style="text-align: center;">Date Application is Completed Phone Number</td> </tr> </table>				Agency Use Only	<u>William C. Charlton</u> <u>Division Counsel</u>	Date Received by Juris. Agency	Name Title	<u>FEB 28 1979</u>	<u>William C. Charlton</u>	Date Received by FERC	Signature		<u>02/ 28/79</u> <u>(304) 342-8166</u>		Date Application is Completed Phone Number
Agency Use Only	<u>William C. Charlton</u> <u>Division Counsel</u>															
Date Received by Juris. Agency	Name Title															
<u>FEB 28 1979</u>	<u>William C. Charlton</u>															
Date Received by FERC	Signature															
	<u>02/ 28/79</u> <u>(304) 342-8166</u>															
	Date Application is Completed Phone Number															

08/25/2023

WELL DETERMINATION REPORT

PARTICIPANTS:

DATE: NOV 19 1970

BUYER-SELLER CO:

WELL OPERATOR: Industrial Gas Corporation

009283

FIRST PURCHASER: Houdaille Industries, Inc.

OTHER: NER:

W. Va. Department of Mines, Oil & Gas Division
 WELL DETERMINATION FILE NUMBER
790228-108-099-1248
 Use Above File Number on all Communications
 Relating to Determination of this Well

Qualifies as Section 108, stripper well.
Robert [Signature]

CHECK EACH ITEM AS COMPLETE OR NOTE WHAT IS MISSING

ITEM NO.

- 1 FERC-121 Items not completed - Line No.
- 2 IV-1 - Agent William C. Charlton
- 3 IV-2 - Well Permit
- 4 IV-6 - Well Plat
- 5 IV-35- Well Record Drilling Deepening
- 6 IV-36- Gas-Oil Test: Gas Only Was Oil Produced? Ratio
- 7 IV-39- Annual Production 2 years
- 8 IV-40- 90 day Production 93 Days off line:
- 9 IV-48- Application for Certification. Complete?
- 10 - 17 IV Form #51 - 52 - 53 - 54 - 55 - ~~56~~ - 57 - 58. Complete Affidavit Signed
- 18 - 28 Other: Survey Logs Geological Charts Structure Map
- 1:4000 Map Well Tabulations Gas Analyses
- (5) Date ~~Completed~~: Commenced: 12-30-59
frac 2-5-60 Deepened
- (5) Production Depth: 1698-1715'
- (5) Production Formation: GREY INJUN
- (5) Final Open Flow
Initial Potential: 160 MCF
- (5) Static R.P. After frac 186*
~~Initially~~
- (6) Other Gas Test:
- (7) Avg. Daily Gas from Annual Production: 7.96 MCF 2913
36
- (8) Avg. Daily Gas from 90-day ending w/1-120 days 8.69 MCF 263+251+29
93
- (8) Line Pressure: 30* PSIG from Daily Report
- (5) Oil Production: From Completion Report
- (10-17) Does lease inventory indicate enhanced recovery being done:
- (10-17) Is affidavit signed? Notarized?

08/25/2023

Does official well records on the Department confirm the submitted information?

Additional Information Does computer program confirm?

Was Determination Objected to? By Whom? JPH

STATE OF WEST VIRGINIA
DEPARTMENT OF MINES, OIL AND GAS DIVISION

Date 02/28, 1979
Operator's Well No. 55-1087
API Well No. 47 - 099 - 1248
State County Permit

WELL CLASSIFICATION FORM

STRIPPER GAS WELL
NGPA Section 108

DESIGNATED AGENT William C. Charlton
ADDRESS P. O. Box 1473
Charleston, WV 25325

WELL OPERATOR Industrial Gas Corporation LOCATION: Elevation 1,042.36'
ADDRESS P. O. Box 1473 Watershed Not Available
Charleston, WV 25325 Dist. Stonewall County Wayne Quad. Wayne

GAS PURCHASER * _____ Gas Purchase Contract No. * _____
ADDRESS _____ Meter Chart Code R0205
Date of Contract * _____

*See FERC-121 - Addendum "A"

* * * * *

Provide a complete inventory of the lease and production equipment used for the well for the previous 24 months or, if less than 24 months, the period the well has been in production. Include a complete list of equipment or processes used in connection with recognized enhanced recovery techniques during completion or production. (Attach separate sheets, if necessary.)

(See Attachment)

List all records reasonably available to you which contain information relevant to a determination of eligibility (including production records, B&O Tax Records and royalty payment records) and indicate the location of such records:

All records required to determine production by meter stations are maintained in Charleston, West Virginia.

B&O Tax Records are located in Charleston, West Virginia, our Boston, Massachusetts office and the Houston, Texas office.

Royalty payment instructions are located in Charleston, West Virginia office and Houston, Texas office.

08/25/2023

Describe the search made of any records listed above:

I have made a diligent search of the production records located in Charleston, West Virginia. They were the records utilized in making the determination herein.

Are you aware of any other information which would tend to be inconsistent with the information specified above? Yes No . If yes, indicate the type and source of the information.

AFFIDAVIT

I, Lawrence B. Mentzer, having been first sworn according to law, state that I have caused to be made a diligent search of those records hereinbefore indicated in the manner herein described, that the information contained in this document is true and accurate and that on the basis of the records and examinations hereinbefore described, and to the best of my information, knowledge and belief, the well for which this certification is sought qualifies as a stripper well.



STATE OF WEST VIRGINIA,

COUNTY OF Kanawha, TO WIT:

I, Charlotte I. Mathews, a Notary Public in and for the state and county aforesaid, do certify that Lawrence B. Mentzer whose name is signed to the writing above, bearing date the 28 day of February, 19 79, has acknowledged the same before me, in my county aforesaid.

Given under my hand and official seal this 28 day of February, 19 79.

My term of office expires on the 5th day of December, 19 85.

08/25/2023

Charlotte I. Mathews
Notary Public

STATE OF WEST VIRGINIA
DEPARTMENT OF MINES, OIL AND GAS DIVISION

Date February 28, 1979

Operator's Well No. 55-1087

API Well No. 47 - 099 - 1248
State County Permit

STATE APPLICATION FOR WELL CLASSIFICATION

Previous File No. NA
(If Applicable)

WELL OPERATOR Industrial Gas Corporation

DESIGNATED AGENT William C. Charlton

ADDRESS P. O. Box 1473
Charleston, W. Va. 25325

ADDRESS P. O. Box 1473
Charleston, W. Va. 25325

Gas Purchase Contract No. * _____ and Date _____
(Month, day and year)

Meter Chart Code R0205

Name of First Purchaser * _____

(Street or P. O. Box)

(City)

(State)

(Zip Code)

FERC Seller Code 009283

FERC Buyer Code _____

TYPE OF DETERMINATION BEING SOUGHT:

- (1) Initial determination (See FERC Form 121.) Section of NGPA 108 Category Code NA
- (2) Determination that increased production is the result of enhanced recovery technology.
- (3) Determination of a seasonally affected well.

(*See FERC-121 Addendum "A")

William C. Charlton Division Counsel
Name (Print) Title

William C. Charlton
Signature

P. O. Box 1473
Street or P. O. Box

Charleston, W. Va. 25325
City State (Zip Code)

(304) 342-8166
Area Phone Number
Code

(Certificate of Proof of Service to Purchaser)

See Separate Certificate Attached

(All of the above to be completed by the Operator/Applicant)

(To be completed by Jurisdictional Agency. Executed copy to be returned to Operator/Applicant and purchaser, if known).

The Department of Mines has received a request, for certification of the above described well as meeting the requirements of Section _____ under the Natural Gas Policy Act of 1978. (NGPA); or for determination that increased production is the result of enhanced recovery technology under Section 108 of (NGPA); or for determination of a seasonally affected well under Section 108 of (NGPA)

All interested parties are hereby notified that on the _____ day of _____, 19____, at the office of the Oil and Gas Division in Charleston, West Virginia, or as soon thereafter as it may be heard, there will be a public hearing, if requested, or if objection is filed.

This Application is assigned File No. _____

Initial review of information submitted indicates the well is. is not entitled to certification as claimed under the Natural Gas Policy Act (NGPA). A review of this evidence and any additional evidence will be made at the time appointed for a public hearing or as soon thereafter as the matter may be heard.

Unless objections are timely filed or a request for a hearing is made within fifteen (15) days, a hearing will not be held except on ex parte motion of the department and the matter will go to determination.

WEST VIRGINIA DEPARTMENT OF MINES

[Signature]
Director

By _____ 08/25/2023
Title _____

FEB 28 1979

Date received by
Jurisdictional Agency

IV-39-WC

STATE OF WEST VIRGINIA
DEPARTMENT - MINES
DIVISION - OIL AND GAS

ANNUAL REPORT OF MONTHLY PRODUCTION-1977
GAS VOLUMES IN MFC @ 14.73
OIL IN BARRELS @ 60 DEGREES

REPORT NO. CCA101P1 PG. 00002
CURRENT DATE - 2/28/79
REPORT DATE - 2/28/79

OPERATOR : Industrial Gas Corporation

API	FARM	HOARD-BALDWIN	55-1087	COUNTY	WAYNE	AVG. FLOW PRESSURE	24	SHUT-IN PRESSURE	NA	TOTALS			
1977		388	326	427	274	275	327	368	248	278	319	GAS	3859
	J-	F-	M-	A-	M-	J-	A-	0-	H-	0-	0-	OIL	
	35	28	35	28	29	28	27	35	28	28	35		371

API	FARM	HOARD-BALDWIN	55-1087	COUNTY	WAYNE	AVG. FLOW PRESSURE	30	SHUT-IN PRESSURE	NA	TOTALS			
1978		253	257	307	228	265	194	254	263	251	294	GAS	2913
	J-	F-	M-	A-	M-	J-	A-	0-	H-	0-	0-	OIL	
	28	28	35	29	27	35	27	35	28	29	36		366

36
29
28
93

SUMMARIZATION SCHEDULE
Section 271. 804 (b)

In accordance with Section 271.804(b) please list all other wells which are to be used in determining this well classification under Part 271 Subpart H.

API NUMBERS

- 47-099-1653; 47-099-1010; 47-099-1011; 47-099-1029; 47-099-1033; 47-099-1039; 47-099-1020;
- 47-099-0950; 47-099-0973; 47-099-0977; 47-099-0990; 47-099-0985; 47-099-0034; 47-099-0048;
- 47-099-1417; 47-099-1418; 47-099-0466; 47-099-0267; 47-099-0991; 47-099-0290; 47-099-0279;
- 47-099-1219; 47-099-1229; 47-099-1248; 47-099-1273; 47-099-1278; 47-099-1288.

08/25/2023

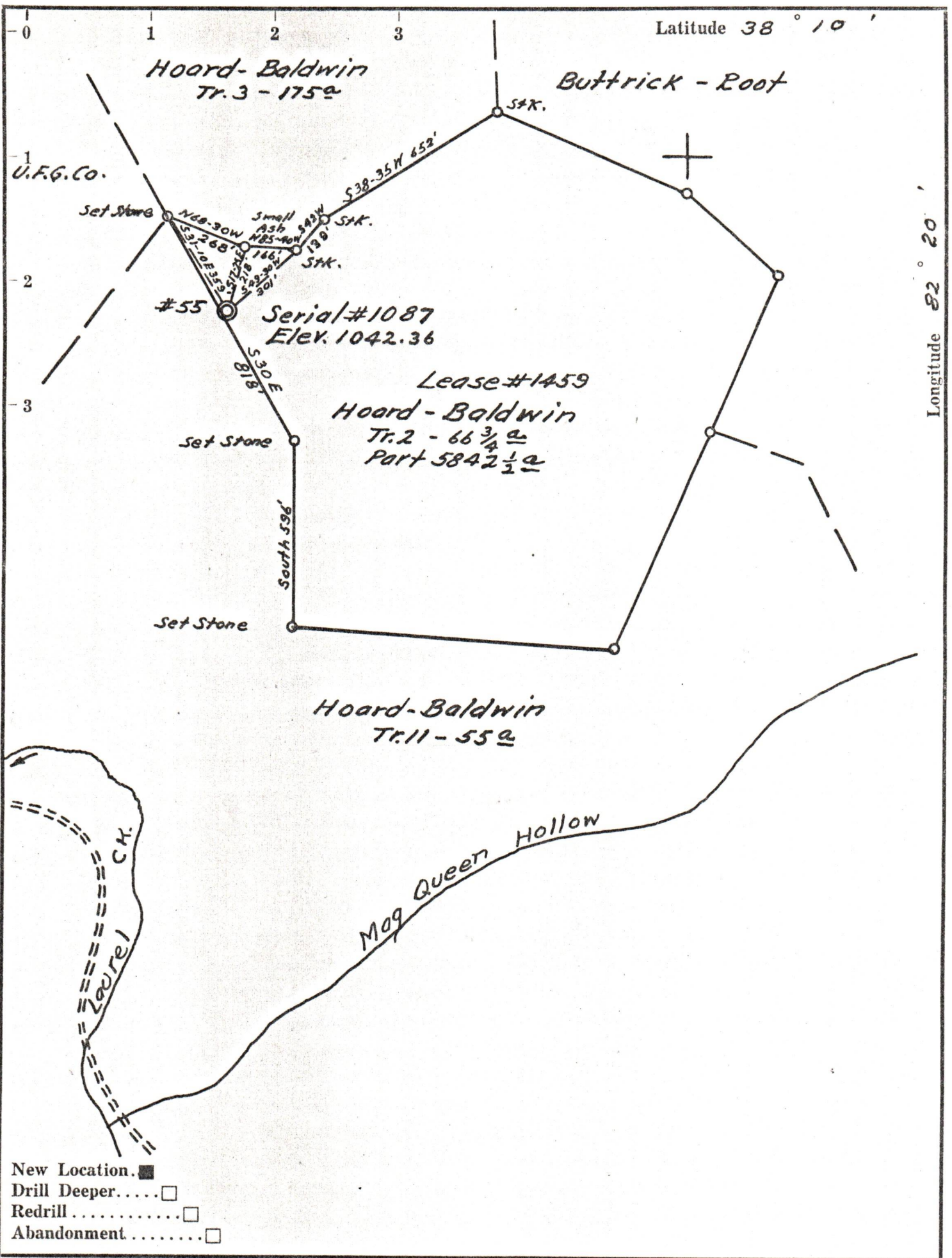

Company Owens, Libbey-Owens Gas Dept
 Address Box 4168 Charleston W. Va
 Farm Hoard-Baldwin
 Tract #2 Acres 66 3/4 Lease No. 1459
 Well (Farm) No. 55 Serial No. 1087
 Elevation (Spirit Level) 1042.36
 Quadrangle Wayne
 County Wayne District Stonewall
 Engineer T.S. Flournoy
 Engineer's Registration No. 269
 File No. _____ Drawing No. _____
 Date Nov. 23, 1959 Scale 1" = 400 Ft.

STATE OF WEST VIRGINIA
 DEPARTMENT OF MINES
 OIL AND GAS DIVISION
 CHARLESTON *corrected*
WELL LOCATION MAP 08/25/2023
 FILE NO. WAY-1248

+ Denotes location of well on United States Topographic Maps, scale 1 to 62,500, latitude and longitude lines being represented by border lines as shown.
 — Denotes one inch spaces on border line of original tracing.