



STATE OF WEST VIRGINIA  
DEPARTMENT OF MINES  
OIL AND GAS DIVISION

NOTICE OF PROPOSED LOCATION OF OIL AND GAS WELL

To THE DEPARTMENT OF MINES,  
Charleston, W. Va.

COAL OPERATOR OR COAL OWNER

United Fuel Gas Company  
NAME OF WELL OPERATOR

ADDRESS

Charleston, W. Va.  
COMPLETE ADDRESS

COAL OPERATOR OR COAL OWNER

April 28, 19 60  
PROPOSED LOCATION

ADDRESS

Grant District

United Fuel Gas Co.  
OWNER OF MINERAL RIGHTS

Wayne County

ADDRESS

Well No. 8741 82°10' E 1173.46'

United Fuel Gas Co. Min.Tr.#1 Farm

GENTLEMEN:

40,234.86 acres

The undersigned well operator is entitled to drill upon the above named farm or tract of land for oil and gas, having fee title thereto, (or as the case may be) under grant or lease dated December, 26, 1946, made by Huntington Development & Gas Co., to United Fuel Gas Co., and recorded on the 27th day of December, 1946, in the office of the County Clerk for said County in Book 234, page 318.

The enclosed plat was prepared by a competent engineer and shows the proposed location of a well to be drilled for oil and gas by the undersigned well operator on the farm and in the Magisterial District and County above named, determined by survey and courses and distances from two permanent points, or land marks.

The undersigned well operator is informed and believes there are no coal operators operating beds of coal beneath said farm or tract of land on which said well is located, or within 500 feet of the boundaries of the same, who have mapped their workings and filed their maps as required by law, excepting the coal operators or coal owners (if any) above named as addressees.

The above named coal operators or coal owners (if any) are notified that any objections they may desire to make to such proposed location, or which they are required to make by Section 3 of said Code, if the drilling of a well at said proposed location will cause a dangerous condition in or about their respective coal mines, must be received by, or filed with the Department of Mines within ten\* days from the receipt of a copy of this notice and accompanying plat by said Department. Said coal operators are further notified that forms for use in making such objections will be furnished to them by the Department of Mines promptly on request and that all such objections must set forth as definitely as is reasonably possible the ground or grounds on which such objections are based and indicate the direction and distance the proposed location should be moved to overcome same.

(The next paragraph is to be completed only in Department's copy.)

Copies of this notice and the enclosed plat were mailed by registered mail, or delivered to the above named coal operators or coal owners at their above shown respective address \_\_\_\_\_ day \_\_\_\_\_ before, or on the same day with the mailing or delivery of this copy to the Department of Mines at Charleston, West Virginia.

Very truly yours,

UNITED FUEL GAS COMPANY  
WELL OPERATOR  
P O. Box 1273  
STREET  
Charleston 25  
CITY OR TOWN  
West Virginia  
STATE

Address of Well Operator }

08/25/2023

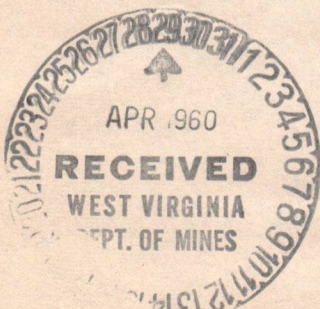

\*Section 3 . . . . If no such objections be filed or be found by the department of mines, within said period of ten days from the receipt of said notice and plat by the department of mines, to said proposed location, the department shall forthwith issue to the well operator a drilling permit reciting the filing of such plat, that no objections have been made by the coal operators to the location, or found thereto by the department, and that the same is approved and the well operator authorized to proceed to drill at said location.

1280

WAY-1280

PERMIT NUMBER

Formation	Color	Hard or Soft	Top 37	Bottom	Oil, Gas or Water	Depth Found	Remarks
Brown Shale			2555	2576	Shut in 8-1-60 in 7" casing		
Berea Sand			2576	2586			
Slate & Shells			2586	3350			
Brown Shale			3350	3385			
Total Depth			3385'		LOGS RUN:		
					Gamma Ray		
					Neutron		
					G. G. Density		
					Temperature		

08/25/2023

Date November 22, 19 60.

APPROVED UNITED FUEL GAS COMPANY, Owner

By S.R. Fennell  
(Title)

Supt., Civil Engineering Dept.



STATE OF WEST VIRGINIA  
DEPARTMENT OF MINES  
OIL AND GAS DIVISION 37

Quadrangle Midkiff

Permit No. WAY-1280

WELL RECORD

Oil or Gas Well Gas  
(KIND)

Company United Fuel Gas Company

Address P.O. Box 1273; Charleston 25, W. Va.

Farm United Fuel Gas Co. Min. Tr. #1 Acres 40,234.86

Location (waters) Parkers Br. of Kiah Creek

Well No. 8741 Elev. 1173.46

District Grant County Wayne

The surface of tract is owned in fee by \_\_\_\_\_

Address \_\_\_\_\_

Mineral rights are owned by United Fuel Gas Co.

Address Charleston, W. Va.

Drilling commenced June 14, 1960

Drilling completed Aug. 1, 1960

Date Shot NOT SHOT From \_\_\_\_\_ To \_\_\_\_\_

With \_\_\_\_\_

Open Flow /10ths Water in \_\_\_\_\_ Inch

100 /10ths Merc. in 4 1/2 Inch

Volume 7,872,000 - Br. Shale Cu. Ft.

Rock Pressure 48 hrs. ~~hrs.~~ 300# ~~lbs.~~

Oil \_\_\_\_\_ bbls., 1st 24 hrs.

WELL ACIDIZED \_\_\_\_\_

WELL FRACTURED \_\_\_\_\_

RESULT AFTER TREATMENT \_\_\_\_\_

ROCK PRESSURE AFTER TREATMENT \_\_\_\_\_

Fresh Water \_\_\_\_\_ Feet Salt Water \_\_\_\_\_ Feet

Formation	Color	Hard or Soft	Top	Bottom	Oil, Gas or Water	Depth	Remarks
Surface			0	5	Hole full water	250'	
Sand			5	175			
Slate			175	325	Gas	748-757'	show
Coal			325	330			
Slate			330	410	Show gas	900-910'	
Sand			410	440			
Slate			440	450	Water	1250-1265'	2 bbls. per hour
Sand			450	498			
Slate			498	748	Hole full water	1310'	
Sand			748	775			
Slate			775	850	Show oil	1840-1852'	
Sand			850	890			
Slate			890	980	Show gas	2153'	
Sand			980	1095			
Slate			1095	1180	Gas	3070-3085'	2/10 W 1" 15 M
Salt Sand			1180	1335	Gas	3168-3178'	6/10 W 1" 26 M
Slate			1335	1350	Gas	3340-3350'	60/10 W 2" 327 M
Sand			1350	1365			blew down to 8/10 W 2" 119 M
Slate			1365	1505			
Sand			1505	1602	Gas	3350-3385'	54/10 Merc. 7" 20#
Slate			1602	1645			11,890 M
Sand			1645	1745			
Little Lime			1745	1766	NOT SHOT		
Slate			1766	1780			
Big Lime			1780	2000			
Injnn Sand			2000	2025	Final open flow when shut in	100/10 Merc. 4 1/2" 7,872 M	08/25/2023
Lime Shell			2025	2060			
Slate & Shells			2060	2200	FINAL OPEN FLOW -	7,872 M - Br. Shale	
Packer Shell			2200	2330	48 hr. 300# R.P.		
Slate & Shells			2330	2555			

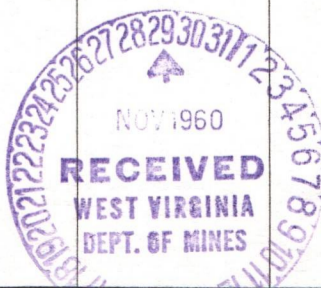

**UNITED FUEL GAS COMPANY**  
COMPANY

SERIAL WELL NO. 8741

LEASE NO. No Ref.

MAP SQUARE 28-35

RECORD OF WELL NO. <u>8741</u> on the G Co Min Tr. #1 <u>40,234.86</u> farm of Acres	CASING AND TUBING				TEST BEFORE SHOT
	SIZE	WEIGHT	USED IN DRILLING	LEFT IN WELL	
in <u>Grant</u> District	<u>10-3/4"</u>	<u>32#</u>	<u>21'</u>	<u>21'</u>	/10 of Water in _____ in
<u>Wayne</u> County	<u>8-5/8"</u>	<u>24#</u>	<u>649'</u>	<u>649'</u>	/10 of Merc. in _____ in
State of: <u>West Virginia</u>	<u>7"</u>	<u>20#</u>	<u>1805'</u>	<u>1805'</u>	Volume _____ Cu.
Field: <u>Central Division</u>					TEST AFTER SHOT
Rig Commenced <u>June 9,</u> 19 <u>60</u>					"Natural" /10 of Water in _____ in
Rig Completed <u>June 13,</u> 19 <u>60</u>					<u>100</u> /10 of Merc. in <u>4 1/2"</u> in
Drilling Commenced <u>June 11,</u> 19 <u>60</u>					Volume <u>7,872 MCF</u> Cu.
Drilling Completed <u>August 1,</u> 19 <u>60</u>					Hours After Sh
Drilling to cost _____ per foot					Rock Pressure <u>48 Hr. 300#</u>
Contractor is: <u>Ray Brothers Drilling Co.</u>					Date Shot <u>Not Shot</u>
Address: <u>Charleston, W. Va.</u>					Size of Torpedo _____
Driller's Name <u>Charles Skeens</u>					Oil Flowed _____ bbls. 1st 24 hr
<u>Ray Painter</u>					Oil Pumped _____ bbls. 1st 24 hr
					Well abandoned and
					Plugged _____ 19
Elevation: <u>1173.46'</u>					

**DRILLER'S RECORD**

FORMATION	TOP	BOTTOM	THICKNESS	REMARKS
Surface	0	5	5	
Sand	5	175	170	
Slate	175	325	150	Water @ 250' - Hole Full
Coal	325	330	5	
Slate	330	410	80	
Sand	410	440	30	
Slate	440	450	10	
Sand	450	498	48	
Slate	498	748	250	
Sand	748	775	27	Gas @ 748'-757'
Slate	775	850	75	
Sand	850	890	40	
Slate	890	980	90	Show of gas @ 900'-910'
Sand	980	1095	115	
Slate	1095	1180	85	
Salt Sand	1180	1335	155	Water @ 1250'-1265' - 2 BPH
Slate	1335	1350	15	Water @ 1310' - Hole Full

**APPROVED**  
*D. B. Robinson*  
DIVISION SUPERINTENDENT

08/25/2023

SERIAL WELL NO. 8712

LEASE NO. No Ref.

MAP SQUARE 28-35

DRILLER'S RECORD

FORMATION	TOP	BOTTOM	THICKNESS	REMARKS
Sand	1350	1365	15	
Slate	1365	1505	140	
Sand	1505	1602	97	
Slate	1602	1645	43	
Sand	1645	1745	100	
Little Lime	1745	1766	21	
Slate	1766	1780	14	
Big Lime	1780	2000	220	Show of Oil @ 1840'-1852'
Injun Sand	2000	2025	25	
Lime Shell	2025	2060	35	
Slate & Shells	2060	2200	140	Show of Gas @ 2153'
Packer Shell	2200	2330	130	
Slate & Shells	2330	2555	225	
Brown Shale	2555	2576	21	Gas @ 3070'-3085' - 2/10 W-1"
Berea Sand	2576	2586	10	Gas @ 3168'-3178' - 6/10 W-1"
Slate & Shells	2586	3350	764	Gas @ 3340'-3350' - 8/10 W-2"
Brown Shale	3350	3385	35	Gas @ 3360'-3385' - 5 1/10 M-7" 20# Csg.
TOTAL DEPTH	3385'			Closed in 100/10 M-4 1/2" Casing-7,872 MCI

Devonian Shale - 2586' to 3385'

Total Shale - 799'

no sand logged

no electric log

Mary S. Friend  
Geologist

08/25/2023

STATE OF WEST VIRGINIA  
DEPARTMENT OF MINES  
OIL AND GAS DIVISION

INSPECTOR'S WELL REPORT

Permit No. WAY-1280

Oil or Gas Well Gas  
(KIND)

Company <u>United Fuel Gas Company</u>	CASING AND TUBING	USED IN DRILLING	LEFT IN WELL	PACKERS
Address <u>P.O. Box 1273 Charleston, W. Va.</u>	Size			
Farm <u>U.F.G.Co. Min. Tr. #1</u>	16			Kind of Packer
Well No. <u>8741</u>	13			
District <u>Grant</u> County <u>Wayne</u>	10	<u>20'</u>		Size of
Drilling commenced <u>6-14-60</u>	8 1/4	<u>650'</u>		
Drilling completed _____ Total depth _____	6 5/8	<u>1825'</u>		Depth set
Date shot _____ Depth of shot _____	5 3/16			
Initial open flow _____ /10ths Water in _____ Inch	3			Perf. top
Open flow after tubing _____ /10ths Merc. in _____ Inch	2			Perf. bottom
Volume _____ Cu. Ft.	Liners Used			Perf. top
Rock pressure _____ lbs. _____ hrs.				Perf. bottom
Oil _____ bbls., 1st 24 hrs.	CASING CEMENTED _____ SIZE _____ No. FT. _____ Date _____			
Fresh water <u>250</u> feet _____ feet	COAL WAS ENCOUNTERED AT <u>325</u> FEET <u>60</u> INCHES			
Salt water <u>1250</u> feet _____ feet	_____ FEET _____ INCHES _____ FEET _____ INCHES			
	_____ FEET _____ INCHES _____ FEET _____ INCHES			

Drillers' Names Ray Painter  
Charlie Skeens

Remarks: Salt Sand 1180'-1335'; Big Lime 1780'-2000'; show gas @ 748'; gas 900'-910'; show gas @ 2153'; drilling in slate and shells @ 2427'.

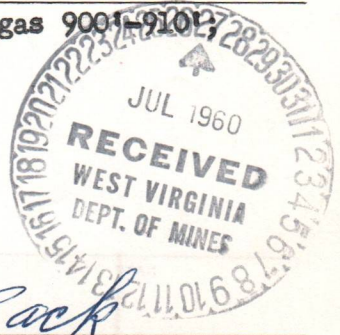

7-20-60  
DATE

*J.W. Pack*  
DISTRICT WELL INSPECTOR  
**08/25/2023**



**U.S. DEPARTMENT OF ENERGY  
Federal Energy Regulatory Commission  
Washington, D.C. 20426**

**APPLICATION FOR DETERMINATION OF THE MAXIMUM LAWFUL  
PRICE UNDER THE NATURAL GAS POLICY ACT (NGPA)  
(Sections 102, 103, 107 and 108)**

**PLEASE READ BEFORE COMPLETING THIS FORM:**

General Instructions:

Complete this form if you are applying for price classification under sections 102, 103, 107 or 108 of the NGPA. A separate application is required for each well. If any reservoir qualifies for a category which differs from the category applicable to the producing well, separate applications must be made for the producing well and the reservoir. Complete each appropriate item on the reverse side of this page. The code numbers used in items 4.0 and 6.0 can be obtained from the Buyer/Seller Code Book. If there is more than one purchaser or contract, identify the additional information in the space below. Enter any additional remarks in the space below.

Submit the completed application to the appropriate Jurisdictional Agency as listed in title 18 of the CFR, part 274.501. If there are any questions, call (202) 275-4539.

Specific Instructions for Item 2.0, Type of Determination:

<u>Section of NGPA</u>	<u>Category Code</u>	<u>Description</u>
102	1	New OCS Lease
102	2	New onshore well (2.5 mile test)
102	3	New onshore well (1,000 feet deeper test)
102	4	New onshore reservoir
102	5	New reservoir on old OCS Lease
103	-	New onshore production well
107	-	High cost natural gas
108	-	Stripper well

Other Purchasers/Contracts:

<u>Contract Date (Mo. Day Yr.)</u>	<u>Purchaser</u>	<u>Buyer Code</u>
_____	_____	_____
_____	_____	_____
_____	_____	_____

Remarks:

08/25/2023



1.0 API well number: (If not assigned, leave blank 14 digits.)	<u>47-099-01280-</u>				
2.0 Type of determination being sought (Use the codes found on the front of this form.)	<u>107 DV</u> Section of NGPA	_____ Category Code			
3.0 Depth of the deepest completion location (Only needed if sections 103 or 107 in 2.0 above.)	<u>3385</u> feet				
4.0 Name, address and code number of applicant (35 letters per line maximum. If code number not available, leave blank.)	Columbia Gas Transmission Corporation Name P. O. Box 1273 Street Charleston City		WV State	004030 Seller Code 25325 Zip Code	
5.0 Location of this well (Complete (a) or (b).) (a) For onshore wells (35 letters maximum for field name.)	<u>WU Field Area B</u> Field Name <u>Wayne</u> County WV State				
(b) For OCS wells	_____ Area Name _____ Block Number _____ Date of Lease _____ Mo. Day Yr. OCS Lease Number				
(c) Name and identification number of this well (35 letters and digits maximum.)	<u>TCO Min. Tr. No. 1</u> <u>808741</u>				
(d) If code 4 or 5 in 2.0 above, name of the reservoir (35 letters maximum.)	_____ <u>N/A</u>				
6.0 (a) Name and code number of the purchaser (35 letters and digits maximum. If code number not available, leave blank.)	_____ Name		* _____ Buyer Code	004030	
(b) Date of the contract:	_____ Mo. Day Yr. *				
(c) Estimated total annual production from the well	_____ Million Cubic Feet				
		(a) Base Price	(b) Tax	(c) All Other Prices (Indicate (+) or (-).)	(d) Total of (a), (b) and (c)
7.0 Contract price (As of filing date. Complete to 3 decimal places.)	S/MMBTU	_____	_____	_____	_____
8.0 Maximum lawful rate (As of filing date. Complete to 3 decimal places.)	S/MMBTU	<u>Dereg</u>	_____	_____	_____
9.0 Person responsible for this application:	Albert H. Mathena, Jr., Director, Production Eng. Name _____ Title _____ <u>Albert H. Mathena Jr.</u> Signature _____ <u>6-9-82</u> Date Application is Completed				
Agency Use Only Date Received by Juris. Agency <u>JUN 15 1982</u> Date Received by FERC	_____ Phone Number (304) 346-0951				

\*This is a pipeline production well. No contract exists and no sales are made.

08/25/2023

WELL CLASSIFICATION FORM  
HIGH COST GAS WELL - DEVONIAN SHALE  
NGPA Section 107

DESIGNATED AGENT James L. Weekley

ADDRESS P. O. Box 1273  
Charleston, WV 25325

LOCATION Elevation 1173.46'  
Watershed \_\_\_\_\_

WELL OPERATOR Columbia Gas Trans. Corp.

ADDRESS P. O. Box 1273  
Charleston, WV 25325

Dist. Stonewall County Wayne Quad.

Gas Purchase  
Contract No. N.A.

GAS PURCHASER N.A.

ADDRESS \_\_\_\_\_

Meter Chart Code \_\_\_\_\_

Date of Contract N.A.

This is a pipeline production well and no gas purchase contract exists.

Date surface drilling began: 6-14-1960

Indicate the bottom hole pressure of the well and explain how this was calculated.

*See Supplement*

AFFIDAVIT

I, Albert H. Mathena, Jr., having been first sworn according to law, state that I have calculated the percentage of footage of the producing interval which is not Devonian Shale as indicated by a Gamma Ray index of less than 0.7 if a Gamma Ray log described in subparagraph (3)(i) or (3)(ii)(A) has been filed, or as indicated by the report described in subparagraph (3)(ii)(B); I have demonstrated that the percentage of potentially disqualifying non-shale footage is equal to or less than five (5) percent of the gross Devonian age interval; and I have no knowledge of any information not described in the application which is inconsistent with a conclusion that the well qualifies as a high-cost natural gas well.

Albert H Mathena Jr

STATE OF WEST VIRGINIA

COUNTY OF KANAWHA, TO-WIT:

I, Larry G. Burdette, a Notary Public in and for the state and county aforesaid, do certify that Albert H. Mathena, Jr., whose name is signed to the writing above, bearing date the 9 day of June, 19 82 **08/25/2023** acknowledged the same before me, in my county aforesaid.

Given under my hand and official seal this 9 day of June, 19 82.  
My term of office expires on the 13 day of August, 19 89.

Larry G Burdette  
Notary Public

STATE OF WEST VIRGINIA  
DEPARTMENT OF MINES, OIL AND GAS DIVISION

Date 6-9, 19 82

Operator's Well No. 808741  
API Well No. 47 - 099 - 01280  
State County Permit

STATE APPLICATION FOR WELL CLASSIFICATION

Previous File No. \_\_\_\_\_  
(If Applicable)

WELL OPERATOR Columbia Gas Trans. Corp.

DESIGNATED AGENT James L. Weekley

ADDRESS P. O. Box 1273  
Charleston, WV 25325

ADDRESS P. O. Box 1273  
Charleston, WV 25325

Gas Purchase Contract No. NA\* and Date \_\_\_\_\_  
(Month, day and year)

Meter Chart Code \_\_\_\_\_

Name of First Purchaser NA\*

\_\_\_\_\_  
(Street or P. O. Box)  
\_\_\_\_\_  
(City) (State) (Zip Code)

FERC Seller Code NA\*

FERC Buyer Code NA\*

TYPE OF DETERMINATION BEING SOUGHT:

- (1) Initial determination (See FERC Form 121.) Section of NGPA 107 DV Category Code \_\_\_\_\_
- (2) Determination that increased production is the result of enhanced recovery technology.
- (3) Determination of a seasonally affected well.

\*This well is a pipeline production and no gas purchase contract exists.

Albert H. Mathena, Jr. Director,  
Name (Print) Production Engineering  
Albert H. Mathena, Jr. Title  
Signature  
P. O. Box 1273  
Street or P. O. Box  
Charleston WV 25325  
City State (Zip Code)  
304) 346-0951  
Area Phone Number  
Code

(Certificate of Proof of Service to Purchaser)

A copy of this filing is being retained by Columbia Gas Transmission Corporation, owner and operator of the identified well.

(All of the above to be completed by the Operator/Applicant)

(To be completed by Jurisdictional Agency. Executed copy to be returned to Operator/Applicant and purchaser, if known).

The Department of Mines has received a request,  for certification of the above described well as meeting the requirements of Section \_\_\_\_\_ under the Natural Gas Policy Act of 1978 (NGPA);  or for determination that increased production is the result of enhanced recovery technology under Section 108 of (NGPA);  or for determination of a seasonally affected well under Section 108 of (NGPA).

All interested parties are hereby notified that on the \_\_\_\_\_ day of \_\_\_\_\_, 19\_\_\_\_, at the office of the Oil and Gas Division in Charleston, West Virginia, or as soon thereafter as it may be heard, there will be a public hearing, if requested, or if objection is filed.

This Application is assigned File No. \_\_\_\_\_

Initial review of information submitted indicates the well  is,  is not entitled to certification as claimed under the Natural Gas Policy Act (NGPA). A review of this evidence and any additional evidence will be made at the time appointed for a public hearing or as soon thereafter as the matter may be heard.

Unless objections are timely filed or a request for a hearing is made within fifteen (15) days, a hearing will not be held except on ex parte motion of the department and the matter will go to determination.

WEST VIRGINIA DEPARTMENT OF MINES

JUN 15 1982

Date received by  
Jurisdictional Agency

By [Signature] Director  
Title \_\_\_\_\_  
08/25/2023

COLUMBIA GAS TRANSMISSION CORPORATION

WELL NO. 808741

SUPPLEMENT:  
-----

METHOD OF CALCULATION OF BOTTOM HOLE PRESSURE

$$PBH = PWH + PWH ( E**0.0000347*G*L - 1.)$$

WHERE:

- PBH = BOTTOM HOLE PRESSURE (PSIA) = 314.7
- PWH = WELLHEAD PRESSURE (PSIA) = 0.7170
- G = SPECIFIC GRAVITY OF GAS = 2986
- L = DEPTH TO MIDDLE OF PERFORATIONS (FT.) = 2986

STEPS:

- PBH = 314.7 + 314.7 (E\*\*0.0000347\*2140.962 -1.)
- PBH = 314.7 + 314.7 (E\*\*0.074291 -1.)
- PBH = 314.7 + 314.7 ( 1.07712 -1.)
- PBH = 314.7 + 314.7 ( 0.077)
- PBH = 314.7 + 24.3
- PBH = 339.0 (PSIA)



State of West Virginia

Department of Mines  
Oil and Gas Division  
Charleston 25305

WALTER N. MILLER  
DIRECTOR

THEODORE M. STREET  
ADMINISTRATOR

BEFORE THE OFFICE OF OIL AND GAS  
OF THE DEPARTMENT OF MINES  
OF THE STATE OF WEST VIRGINIA

IN THE MATTER OF THE APPLICATIONS )  
OF COLUMBIA GAS TRANSMISSION )  
CORPORATION REQUESTING CLASSI- )  
FICATION UNDER SECTION 107 OF THE )  
NATURAL GAS POLICY ACT OF CERTAIN )  
WELLS IN BOONE, CABELL, JACKSON, )  
KANAWHA, LINCOLN, LOGAN, MINGO )  
AND WAYNE COUNTIES, WEST VIRGINIA. }

CAUSE NO. 33

ORDER NO. 1

REPORT OF THE OFFICE

This cause came before the Administrator of the Office of Oil and Gas on June 28, 1982, at 1:00 p.m., in Conference Room C, Capitol Conference Center, Charleston, West Virginia, after giving notice of hearing as required by law on the applications of Columbia Gas Transmission Corporation for certification of certain wells in Boone, Cabell, Jackson, Kanawha, Lincoln, Logan, Mingo and Wayne Counties as Devonian Shale wells under Section 107(c)(4) of the Natural Gas Policy Act.

FINDINGS OF FACT

1. Applicant is an operator within the meaning of paragraph (w) of Chapter 22-4-1.
2. Applicant has made filings for certification pursuant to Rule 34.04.
3. The Natural Gas Policy Act (NGPA) in Section 107, Ceiling Price For High-Cost Natural Gas--(c) Definition of High-Cost Natural Gas-- "For purposes of this section, the term "high-cost natural gas" means natural gas determined in accordance with Section 503 to be....(4) produced from Devonian Shale."
4. The Federal Energy Regulatory Commission (FERC) by Rule 272.101-(c) prescribes the method by which the jurisdictional agency may determine gas produced from Devonian Shale.
5. Exhibits refer to evidence gathered at a public hearing held June 28, 1982.

08/25/2023

6. Exhibits No. 2 and 3 lists the wells to be under consideration for Section 107 pricing. All these wells are located on Exhibits No. 4 and 5 and have been completed in the Devonian Shale.

7. Applicant, by letter dated June 25, 1982 (Exhibit No. 3) requested that eight (8) of the wells listed on Attachment A be stricken from the docket for hearing and they have been withdrawn.

8. Exhibit No. 6 shows random sampling of already qualified Devonian Shale wells.

9. Various cross-sections throughout the interval show gamma ray logs of the wells (see Exhibits Nos. 7, 8 and 9).

10. No well has any non-shale greater than 5% in the Devonian interval penetrated.

11. No gamma ray logs are available on these wells since they were all drilled before logging was common in West Virginia.

CONCLUSION OF LAW

1. That due notice of the time, place and purpose of the hearing has been given in all respects as required by law.

2. That pursuant to Chapter 22, Article 4, Code of West Virginia of 1931, as amended, the Office has jurisdiction over the subject matter embraced in said notice, and the persons interested therein, and jurisdiction to promulgate the hereinafter prescribed Order.

ORDER

NOW, therefore, based on the aforementioned Findings of Fact and Conclusion of Law, it is found by the Administrator that Columbia Gas Transmission Corporation's applications for classification under Section 107 of the Natural Gas Policy Act for certain wells in Boone, Cabell, Jackson, Kanawha, Lincoln, Logan, Mingo and Wayne Counties, identified in Attachment A, are approved.

The Office of Oil and Gas further incorporates the Report of the Office and Findings of Fact and Conclusion of Law dated June 28, 1982, as if the same were fully set forth and includes hereto the Report of the Office and Findings of Fact and Conclusion of Law as a part of this Order.

Entered this 12th day of July, 1983.

IN THE NAME OF THE STATE OF WEST VIRGINIA:

OFFICE OF OIL AND GAS  
OF THE DEPARTMENT OF MINES  
OF THE STATE OF WEST VIRGINIA

By:  08/25/2023  
Theodore M. Streit, Administrator

Latitude  $38^{\circ} 05'$

Longitude  $82^{\circ} 10'$

U. F. G. CO. MIN.

EX. OF PARKER BR.

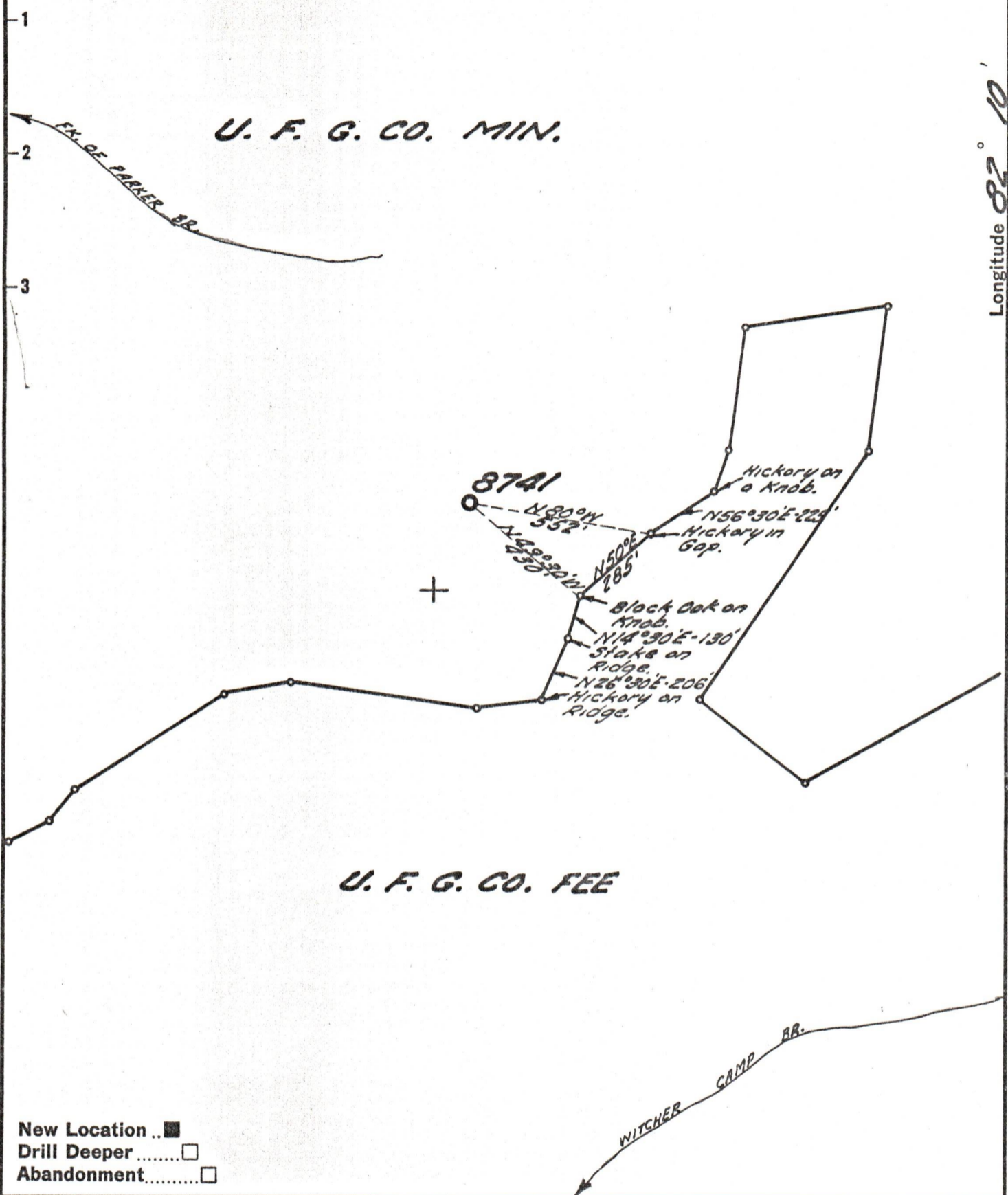

U. F. G. CO. FEE

- New Location ..
- Drill Deeper .....
- Abandonment .....

Company UNITED FUEL GAS CO.  
 Address CHARLESTON, W. VA.  
 Farm UNITED FUEL GAS CO. MIN.  
 Tract 1 Acres 40,234.86 Lease No. NO REF.  
 Well (Farm) No. \_\_\_\_\_ Serial No. 8741  
 Elevation (Spirit Level) 1173.46'  
 Quadrangle MIDKIFF  
 County WAYNE District GRANT  
 Engineer Hubert R. Jewell  
 Engineer's Registration No. 2529  
 File No. 28-35 Drawing No. \_\_\_\_\_  
 Date 4-12-60 Scale 1" = 400'

STATE OF WEST VIRGINIA  
 DEPARTMENT OF MINES  
 OIL AND GAS DIVISION  
 CHARLESTON

WELL LOCATION MAP

FILE NO. WAY-1280

08/25/2023

+ Denotes location of well on United States Topographic Maps, scale 1 to 62,500, latitude and longitude lines being represented by border lines as shown.

- Denotes one inch spaces on border line of original tracing.