



STATE OF WEST VIRGINIA
DEPARTMENT OF MINES
OIL AND GAS DIVISION

NOTICE OF PROPOSED LOCATION OF OIL AND GAS WELL

To THE DEPARTMENT OF MINES,
Charleston, W. Va.

COAL OPERATOR OR COAL OWNER

ADDRESS

COAL OPERATOR OR COAL OWNER

ADDRESS

United Fuel Gas Co.
OWNER OF MINERAL RIGHTS

ADDRESS

United Fuel Gas Company

NAME OF WELL OPERATOR

Charleston, W. Va.

COMPLETE ADDRESS

April 28, 19 60

PROPOSED LOCATION

Grant District

Wayne County

Well No. 8743 82°15' E. 1050.00'

United Fuel Gas Co. Min. Tr. #1 Farm

40,234.86 acres

GENTLEMEN:

The undersigned well operator is entitled to drill upon the above named farm or tract of land for oil and gas, having fee title thereto, (or as the case may be) under grant or lease dated December 26, 1946, made by Huntington Development & Gas Co., United Fuel Gas Co., and recorded on the 27th day of December, 1946, in the office of the County Clerk for said County in Book 234, page 318.

The enclosed plat was prepared by a competent engineer and shows the proposed location of a well to be drilled for oil and gas by the undersigned well operator on the farm and in the Magisterial District and County above named, determined by survey and courses and distances from two permanent points, or land marks.

The undersigned well operator is informed and believes there are no coal operators operating beds of coal beneath said farm or tract of land on which said well is located, or within 500 feet of the boundaries of the same, who have mapped their workings and filed their maps as required by law, excepting the coal operators or coal owners (if any) above named as addressees.

The above named coal operators or coal owners (if any) are notified that any objections they may desire to make to such proposed location, or which they are required to make by Section 3 of said Code, if the drilling of a well at said proposed location will cause a dangerous condition in or about their respective coal mines, must be received by, or filed with the Department of Mines within ten* days from the receipt of a copy of this notice and accompanying plat by said Department. Said coal operators are further notified that forms for use in making such objections will be furnished to them by the Department of Mines promptly on request and that all such objections must set forth as definitely as is reasonably possible the ground or grounds on which such objections are based and indicate the direction and distance the proposed location should be moved to overcome same.

(The next paragraph is to be completed only in Department's copy.)

Copies of this notice and the enclosed plat were mailed by registered mail, or delivered to the above named coal operators or coal owners at their above shown respective address _____ day _____ before, or on the same day with the mailing or delivery of this copy to the Department of Mines at Charleston, West Virginia.

Very truly yours,

UNITED FUEL GAS COMPANY

WELL OPERATOR

P. O. Box 1273

STREET

Charleston 25

CITY OR TOWN

West Virginia

STATE

08/25/2023

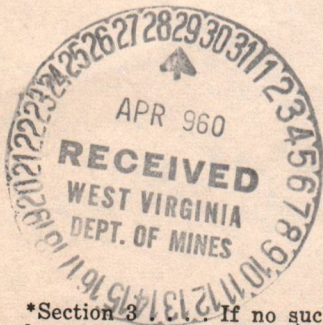

Address of Well Operator }

*Section 3. If no such objections be filed or be found by the department of mines, within said period of ten days from the receipt of said notice and plat by the department of mines, to said proposed location, the department shall forthwith issue to the well operator a drilling permit reciting the filing of such plat, that no objections have been made by the coal operators to the location, or found thereto by the department, and that the same is approved and the well operator authorized to proceed to drill at said location.

WAY-1281

PERMIT NUMBER

1281



STATE OF WEST VIRGINIA
DEPARTMENT OF MINES
OIL AND GAS DIVISION 31

STATE OF WEST VIRGINIA DEPARTMENT OF MINES

(1916)

MAILED 10:21 AM AUG 25 1960

Aug 25 1960

Quadrangle Naugatuck

Permit No. WAY-1281

WELL RECORD

Oil or Gas Well Gas
(KIND)

Company United Fuel Gas Company
Address P.O. Box 1273; Charleston 25, W. Va.
Farm United Fuel Gas Co. Min. Tr. #1 Acres 40,234.86
Location (waters) Left Fork of Wiley Branch
Well No. 8743 Elev. 1050.0
District Grant County Wayne
The surface of tract is owned in fee by _____
Address _____
Mineral rights are owned by United Fuel Gas Co.
Address _____
Drilling commenced 5-21-60
Drilling completed 7-5-60
Date Shot not shot From _____ To _____
With _____
Open Flow _____ /10ths Water in _____ Inch
32 /10ths Merc. in 3 Inch
Volume 1,980 M - Bhale Cu. Ft.
Rock Pressure 430 lbs. 48 hrs.
Oil _____ bbls., 1st 24 hrs.
WELL ACIDIZED _____
WELL FRACTURED _____

Casing and Tubing	Used in Drilling	Left in Well	Packers
Size			Kind of Packer _____
16			<u>Hookwall</u>
13			Size of _____
10 <u>3/4</u>		<u>17'</u>	<u>3 1/2" x 7"</u>
8 1/2 <u>5/8</u>		<u>518</u>	Depth set _____
7 <u>5/8</u>		<u>1606</u>	<u>2035'</u>
5 <u>3/16</u>			Perf. top _____
3 <u>1/2</u>		<u>3172</u>	Perf. bottom _____
2			Perf. top _____
Liners Used			Perf. bottom _____

CASING CEMENTED	SIZE	No. Ft.	Date
COAL WAS ENCOUNTERED AT <u>195</u> FEET <u>36</u> INCHES			
_____	FEET	INCHES	FEET INCHES
_____	FEET	INCHES	FEET INCHES

RESULT AFTER TREATMENT _____

ROCK PRESSURE AFTER TREATMENT _____

Fresh Water 200 Feet 1100' Salt Water _____ Feet

Formation	Color	Hard or Soft	Top	Bottom	Oil, Gas or Water	Depth	Remarks
Soil			0	14	Water 200'	2	bailers per hour
Sand			14	95			
Slate			95	195	Show gas 585'		
Coal			195	198			
Slate			198	222	Show of Coal with gas 650-655'		
Sand			222	368			
Slate			368	450	Hole full water 1100'		
Sand			450	479			
Slate			479	493	Oil at 1685'		
Sand			493	545			
Slate			545	574	Gas 2960'	4/10 W 1" 21 M	
Sand			574	596			
Slate			596	680	Gas 3050'	2/10 W 2" 60 M	
Sand			680	700			
Slate			700	815	Gas 3150'	14/10 W 2" 158 M	
Sand			815	935			
Slate			935	1030	Gas 3160-3170'	25/10 W 7" 20# 2,192 M	
Sand			1030	1260			
Slate			1260	1405	NOT SHOT		
Sand			1405	1500			
Slate & Shells			1500	1535	Test after tubed 32/10 Merc 3"		1,980 M
Red Rock			1535	1545			
Slate			1545	1570			
Lime			1570	1580			
Pencil Cave			1580	1582			
Big Lime			1582	1840	Shut in 4-6-60 in 3 1/2" tubing.		
Injun Sand			1840	1895			
Slate & Shells			1895	2400			
Brown Shale			2400	2418	LOGS:		
Berea Sand			2418	2400	(over)		

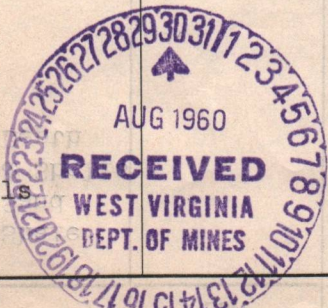

08/25/2023

(over)

UNITED FUEL GAS COMPANY
COMPANY

SERIAL WELL NO. 8743

LEASE NO. No Ref.

MAP SQUARE 26-33

RECORD OF WELL NO. <u>8743</u> on the	CASING AND TUBING				TEST BEFORE SHOT
<u>JFG Co. Min. Tr. #1</u> farm of <u>40,234.86</u> Acres	SIZE	WEIGHT	USED IN DRILLING	LEFT IN WELL	<u>Not Shot</u> /10 of Water in.....
in <u>Grant</u> District	<u>10-3/4"</u>	<u>32#</u>	<u>17'</u>	<u>17'</u>	/10 of Merc. in.....
<u>Wayne</u> County	<u>8-5/8"</u>	<u>24#</u>	<u>524'</u>	<u>524'</u>	Volume..... Cu.
State of: <u>West Virginia</u>	<u>7"</u>	<u>20#</u>	<u>1619'</u>	<u>1619'</u>	"NATURAL" TEST AFTER SHOT
Field: <u>Central Division</u>	<u>3-1/2"</u>	<u>9#</u>	<u>3189'</u>	<u>3189'</u>	/10 of Water in.....
Rig Commenced <u>May 17,</u> 19 <u>60</u>					<u>32</u> /10 of Merc. in... <u>3"</u>
Rig Completed <u>May 21,</u> 19 <u>60</u>					Volume <u>1,980 MCF</u> Cu.
Drilling Commenced <u>May 21,</u> 19 <u>60</u>					<u>When Shut In</u>
Drilling Completed <u>July 5,</u> 19 <u>60</u>					Rock Pressure <u>48 Hr. 430#</u>
Drilling to cost _____ per foot					Date Shot <u>Not Shot</u>
Contractor is: <u>Ray Brothers</u>					Size of Torpedo.....
Address: <u>Charleston, W. Va.</u>					Oil Flowed..... bbls. 1st 24 Hrs.
					Oil Pumped..... bbls. 1st 24 Hrs.
Driller's Name <u>James Maynard</u>	<u>3-1/2"</u> in.	<u>Tubing</u>	<u>Tubing or</u>	<u>Casing</u>	Well abandoned and
<u>B. D. Duncan</u>		<u>3-1/2"X7"</u>			Plugged..... 19
		<u>Hookwall</u>			
		1st. Perf. Set..... from.....			
Elevation: <u>1050'</u>		2nd Perf. Set..... from.....			

DRILLER'S RECORD

FORMATION	TOP	BOTTOM	THICKNESS	REMARKS
Soil	0	14	14	
Sand	14	95	81	
Slate	95	195	100	
Coal	195	198	3	
Slate	198	222	24	Water @ 200' - 2 BPH
Sand	222	368	146	
Slate	368	450	82	APPROVED
Sand	450	479	29	
Slate	479	493	14	
Sand	493	545	52	DIVISION SUPERINTENDENT
Slate	545	574	29	
Sand	574	596	22	Show of Gas @ 585'
Slate	596	680	84	Show of Coal with Gas @ 650'-655'
Sand	680	700	20	
Slate	700	815	115	
Sand	815	935	120	
Slate	935	1030	95	

08/25/2023

SERIAL WELL NO. 8743

LEASE NO. No Ref.

MAP SQUARE 26-33

DRILLER'S RECORD

FORMATION	TOP	BOTTOM	THICKNESS	REMARKS
Sand	1030	1260	230	Water @ 1100' - Hole Full
Slate	1260	1405	145	
Sand	1405	1500	95	
Slate & Shells	1500	1535	35	
Red Rock	1535	1545	10	
Slate	1545	1570	25	
Lime	1570	1580	10	
Pencil Cave	1580	1582	2	
Big Lime	1582	1840	258	Show of Oil @ 1685'
Injun Sand	1840	1895	55	
Slate & Shells	1895	2400	505	Gas @ 2960' - 4/10 W-1"
Brown Shale	2400	2418	18	Gas @ 3050' - 2/10 W-2"
Berea Sand	2418	2440	22	Gas @ 3150' - 11/10 W-2"
Slate & Shells	2440	3180	740	Gas @ 3160'-3170' - 25/10 W-7" Casing
TOTAL DEPTH	3180'			

Devonian Shale - 2440' to 3180'
 Total Shale - 740'

no sand logged
 no electric log

Mary S. Friend
 Geologist

08/25/2023

**U.S. DEPARTMENT OF ENERGY
Federal Energy Regulatory Commission
Washington, D.C. 20426**

**APPLICATION FOR DETERMINATION OF THE MAXIMUM LAWFUL
PRICE UNDER THE NATURAL GAS POLICY ACT (NGPA)
(Sections 102, 103, 107 and 108)**

PLEASE READ BEFORE COMPLETING THIS FORM:

General Instructions:

Complete this form if you are applying for price classification under sections 102, 103, 107 or 108 of the NGPA. A separate application is required for each well. If any reservoir qualifies for a category which differs from the category applicable to the producing well, separate applications must be made for the producing well and the reservoir. Complete each appropriate item on the reverse side of this page. The code numbers used in items 4.0 and 6.0 can be obtained from the Buyer/Seller Code Book. If there is more than one purchaser or contract, identify the additional information in the space below. Enter any additional remarks in the space below.

Submit the completed application to the appropriate Jurisdictional Agency as listed in title 18 of the CFR, part 274.501. If there are any questions, call (202) 275-4539.

Specific Instructions for Item 2.0, Type of Determination:

<u>Section of NGPA</u>	<u>Category Code</u>	<u>Description</u>
102	1	New OCS Lease
102	2	New onshore well (2.5 mile test)
102	3	New onshore well (1,000 feet deeper test)
102	4	New onshore reservoir
102	5	New reservoir on old OCS Lease
103	-	New onshore production well
107	-	High cost natural gas
108	-	Stripper well

Other Purchasers/Contracts:

<u>Contract Date</u> (Mo. Day Yr.)	<u>Purchaser</u>	<u>Buyer Code</u>
_____	_____	_____
_____	_____	_____
_____	_____	_____

Remarks:

1.0 API well number. (If not assigned, leave blank 14 digits.)	<u>47-099-01281</u>				
2.0 Type of determination being sought (Use the codes found on the front of this form.)	<u>107 DV</u> Section of NGPA		<u> </u> Category Code		
3.0 Depth of the deepest completion location (Only needed if sections 103 or 107 in 2.0 above.)	<u>3180</u> feet				
4.0 Name, address and code number of applicant (35 letters per line maximum. If code number not available, leave blank.)	<u>Columbia Gas Transmission Corporation</u> Name		<u>004030</u> Seller Code		
	<u>P. O. Box 1273</u> Street				
	<u>Charleston</u> City	<u>WV</u> State	<u>25325</u> Zip Code		
5.0 Location of this well (Complete (a) or (b).)	<u>WV Field Area B</u>				
(a) For onshore wells (35 letters maximum for field name.)	<u>Wayne</u> Field Name		<u>WV</u> State		
(b) For OCS wells	<u>NA</u>				
	<u>NA</u> Area Name		<u> </u> Block Number		
	Date of Lease				
	<u> </u> Mo.	<u> </u> Day	<u> </u> Yr.	<u> </u> OCS Lease Number	
(c) Name and identification number of this well (35 letters and digits maximum.)	<u>TCO Min. Tr. No. 1 808743</u>				
(d) If code 4 or 5 in 2.0 above, name of the reservoir (35 letters maximum.)	<u>NA</u>				
6.0 (a) Name and code number of the purchaser (35 letters and digits maximum. If code number not available, leave blank.)	<u>*</u> Name		<u>004030</u> Buyer Code		
(b) Date of the contract:	<u> </u> *				
	<u> </u> Mo.	<u> </u> Day	<u> </u> Yr.		
(c) Estimated total annual production from the well	<u>51</u> Million Cubic Feet				
		(a) Base Price	(b) Tax	(c) All Other Prices (Indicate (+) or (-).)	(d) Total of (a), (b) and (c)
7.0 Contract price (As of filing date. Complete to 3 decimal places.)	S/MMBTU	<u> </u>	<u> </u>	<u> </u>	<u> </u>
8.0 Maximum lawful rate (As of filing date. Complete to 3 decimal places.)	S/MMBTU	<u>Dereg</u>	<u> </u>	<u> </u>	<u> </u>
9.0 Person responsible for this application:	<u>Albert H. Mathena, Jr., Director, Production Eng.</u>				
Agency Use Only	<u>Albert H. Mathena, Jr.</u> Name		<u>Director</u> Title		
Date Received by Juris. Agency	<u>Albert H. Mathena, Jr.</u> Signature				
<u>JUN 15 1982</u>	<u>6-9-82</u> Date Application is Completed		<u>(304) 346-0951</u> Phone Number		
Date Received by FERC					

*This is a pipeline production well. No contract exists and no sales are made.

08/25/2023

Date 6-9-82

Operator's
Well No. 808743

API Well No.
47 - 099 - 01281
State County Permit

WELL CLASSIFICATION FORM
HIGH COST GAS WELL - DEVONIAN SHALE
NGPA Section 107

DESIGNATED AGENT James L. Weekley

ADDRESS P. O. Box 1273
Charleston, WV 25325

LOCATION Elevation 1050'
Watershed _____

WELL OPERATOR Columbia Gas Trans. Corp.

ADDRESS P. O. Box 1273
Charleston, WV 25325

Dist. Stonewall County Wayne Quad. _____

Gas Purchase
Contract No. N.A.

GAS PURCHASER N.A.

Meter Chart Code _____

ADDRESS _____

Date of Contract N.A.

This is a pipeline production well and no gas purchase contract exists.

Date surface drilling began: 5-21-1960

Indicate the bottom hole pressure of the well and explain how this was calculated.

See Supplement

AFFIDAVIT

I, Albert H. Mathena, Jr., having been first sworn according to law, state that I have calculated the percentage of footage of the producing interval which is not Devonian Shale as indicated by a Gamma Ray index of less than 0.7 if a Gamma Ray log described in subparagraph (3)(i) or (3)(ii)(A) has been filed, or as indicated by the report described in subparagraph (3)(ii)(B); I have demonstrated that the percentage of potentially disqualifying non-shale footage is equal to or less than five (5) percent of the gross Devonian age interval; and I have no knowledge of any information not described in the application which is inconsistent with a conclusion that the well qualifies as a high-cost natural gas well.

Albert H Mathena Jr

STATE OF WEST VIRGINIA

COUNTY OF KANAWHA, TO-WIT:

I, Larry G. Burdette, a Notary Public in and for the state and county aforesaid, do certify that Albert H. Mathena, Jr., whose name is signed to the writing above, bearing date the 9 day of June, 19 82, has acknowledged the same before me, in my county aforesaid. 08/25/2023

Given under my hand and official seal this 9 day of June, 19 82.
My term of office expires on the 13 day of August, 19 89.

(NOTARIAL SEAL)

Larry G Burdette
Notary Public

STATE OF WEST VIRGINIA
DEPARTMENT OF MINES, OIL AND GAS DIVISION

Date 6-9, 1982

Operator's Well No. 808743

API Well No. 47 - 099 - 01281
State County Permit

STATE APPLICATION FOR WELL CLASSIFICATION

Previous File No. _____
(If Applicable)

WELL OPERATOR Columbia Gas Trans. Corp.

DESIGNATED AGENT James L. Weekley

ADDRESS P. O. Box 1273
Charleston, WV 25325

ADDRESS P. O. Box 1273
Charleston, WV 25325

Gas Purchase Contract No. NA* and Date _____
(Month, day and year)

Meter Chart Code _____

Name of First Purchaser NA*

(Street or P. O. Box)

(City) (State) (Zip Code)

FERC Seller Code NA*

FERC Buyer Code NA*

TYPE OF DETERMINATION BEING SOUGHT:

- (1) Initial determination (See FERC Form 121.) 107 DV Section of NGPA _____ Category Code _____
- (2) Determination that increased production is the result of enhanced recovery technology.
- (3) Determination of a seasonally affected well.

Director,
Production Engineering

Albert H. Mathena, Jr.
Name (Print) Title
Albert H. Mathena, Jr.
Signature

*This well is a pipeline production and no gas purchase contract exists.

P. O. Box 1273
Street or P. O. Box
Charleston WV 25325
City State (Zip Code)
304) 346-0951
Area Code Phone Number

(Certificate of Proof of Service to Purchaser)

A copy of this filing is being retained by Columbia Gas Transmission Corporation, owner and operator of the identified well.

(All of the above to be completed by the Operator/Applicant)

(To be completed by Jurisdictional Agency. Executed copy to be returned to Operator/Applicant and purchaser, if known).

The Department of Mines has received a request, for certification of the above described well as meeting the requirements of Section _____ under the Natural Gas Policy Act of 1978. (NGPA); or for determination that increased production is the result of enhanced recovery technology under Section 108 of (NGPA); or for determination of a seasonally affected well under Section 108 of (NGPA).

All interested parties are hereby notified that on the _____ day of _____, 19____, at the office of the Oil and Gas Division in Charleston, West Virginia, or as soon thereafter as it may be heard, there will be a public hearing, if requested, or if objection is filed.

This Application is assigned File No. _____.

Initial review of information submitted indicates the well is. is not entitled to certification as claimed under the Natural Gas Policy Act (NGPA). A review of this evidence and any additional evidence will be made at the time appointed for a public hearing or as soon thereafter as the matter may be heard.

Unless objections are timely filed or a request for a hearing is made within fifteen (15) days, a hearing will not be held except on ex parte motion of the department and the matter will go to determination.

WEST VIRGINIA DEPARTMENT OF MINES

JUN 15 1982

Date received by
Jurisdictional Agency

By _____
Title _____

08/25/2023



State of West Virginia

Department of Mines

Oil and Gas Division

Charleston 25305

WALTER N. MILLER
DIRECTOR

THEODORE M. STREIT
ADMINISTRATOR

BEFORE THE OFFICE OF OIL AND GAS
OF THE DEPARTMENT OF MINES
OF THE STATE OF WEST VIRGINIA

IN THE MATTER OF THE APPLICATIONS)
OF COLUMBIA GAS TRANSMISSION)
CORPORATION REQUESTING CLASSI-)
FICATION UNDER SECTION 107 OF THE)
NATURAL GAS POLICY ACT OF CERTAIN)
WELLS IN BOONE, CABELL, JACKSON,)
KANAWHA, LINCOLN, LOGAN, MINGO)
AND WAYNE COUNTIES, WEST VIRGINIA.)

CAUSE NO. 33

ORDER NO. 1

REPORT OF THE OFFICE

This cause came before the Administrator of the Office of Oil and Gas on June 28, 1982, at 1:00 p.m., in Conference Room C, Capitol Conference Center, Charleston, West Virginia, after giving notice of hearing as required by law on the applications of Columbia Gas Transmission Corporation for certification of certain wells in Boone, Cabell, Jackson, Kanawha, Lincoln, Logan, Mingo and Wayne Counties as Devonian Shale wells under Section 107(c)(4) of the Natural Gas Policy Act.

FINDINGS OF FACT

1. Applicant is an operator within the meaning of paragraph (w) of Chapter 22-4-1.
2. Applicant has made filings for certification pursuant to Rule 34.04.
3. The Natural Gas Policy Act (NGPA) in Section 107, Ceiling Price For High-Cost Natural Gas--(c) Definition of High-Cost Natural Gas-- "For purposes of this section, the term "high-cost natural gas" means natural gas determined in accordance with Section 503 to be....(4) produced from Devonian Shale."
4. The Federal Energy Regulatory Commission (FERC) by Rule 272.101-(c) prescribes the method by which the jurisdictional agency may determine gas produced from Devonian Shale.
5. Exhibits refer to evidence gathered at a public hearing held June 28, 1982.

08/25/2023

6. Exhibits No. 2 and 3 lists the wells to be under consideration for Section 107 pricing. All these wells are located on Exhibits No. 4 and 5 and have been completed in the Devonian Shale.

7. Applicant, by letter dated June 25, 1982 (Exhibit No. 3) requested that eight (8) of the wells listed on Attachment A be stricken from the docket for hearing and they have been withdrawn.

8. Exhibit No. 6 shows random sampling of already qualified Devonian Shale wells.

9. Various cross-sections throughout the interval show gamma ray logs of the wells (see Exhibits Nos. 7, 8 and 9).

10. No well has any non-shale greater than 5% in the Devonian interval penetrated.

11. No gamma ray logs are available on these wells since they were all drilled before logging was common in West Virginia.

CONCLUSION OF LAW

1. That due notice of the time, place and purpose of the hearing has been given in all respects as required by law.

2. That pursuant to Chapter 22, Article 4, Code of West Virginia of 1931, as amended, the Office has jurisdiction over the subject matter embraced in said notice, and the persons interested therein, and jurisdiction to promulgate the hereinafter prescribed Order.

ORDER

NOW, therefore, based on the aforementioned Findings of Fact and Conclusion of Law, it is found by the Administrator that Columbia Gas Transmission Corporation's applications for classification under Section 107 of the Natural Gas Policy Act for certain wells in Boone, Cabell, Jackson, Kanawha, Lincoln, Logan, Mingo and Wayne Counties, identified in Attachment A, are approved.

The Office of Oil and Gas further incorporates the Report of the Office and Findings of Fact and Conclusion of Law dated June 28, 1982, as if the same were fully set forth and includes hereto the Report of the Office and Findings of Fact and Conclusion of Law as a part of this Order.

Entered this 12th day of July, 1983.

IN THE NAME OF THE STATE OF WEST VIRGINIA:

OFFICE OF OIL AND GAS
OF THE DEPARTMENT OF MINES
OF THE STATE OF WEST VIRGINIA

By: 
Theodore M. Streit, Administrator

08/25/2023

COLUMBIA GAS TRANSMISSION CORPORATION

WELL NO. 808743

SUPPLEMENT:

METHOD OF CALCULATION OF BOTTOM HOLE PRESSURE

$$PBH = PWH + PWH (E**0.0000347*G*L - 1.)$$

WHERE:

- PBH = BOTTOM HOLE PRESSURE (PSIA) = 444.7
- PWH = WELLHEAD PRESSURE (PSIA) = 0.7170
- G = SPECIFIC GRAVITY OF GAS = 2810
- L = DEPTH TO MIDDLE OF PERFORATIONS (FT.) = 2810

STEPS:

- PBH = 444.7 + 444.7 (E**0.0000347*2014.770 -1.)
- PBH = 444.7 + 444.7 (E**0.069912 -1.)
- PBH = 444.7 + 444.7 (1.07241 -1.)
- PBH = 444.7 + 444.7 (0.072)
- PBH = 444.7 + 32.2
- PBH = 476.9 (PSIA)

08/25/2023

19

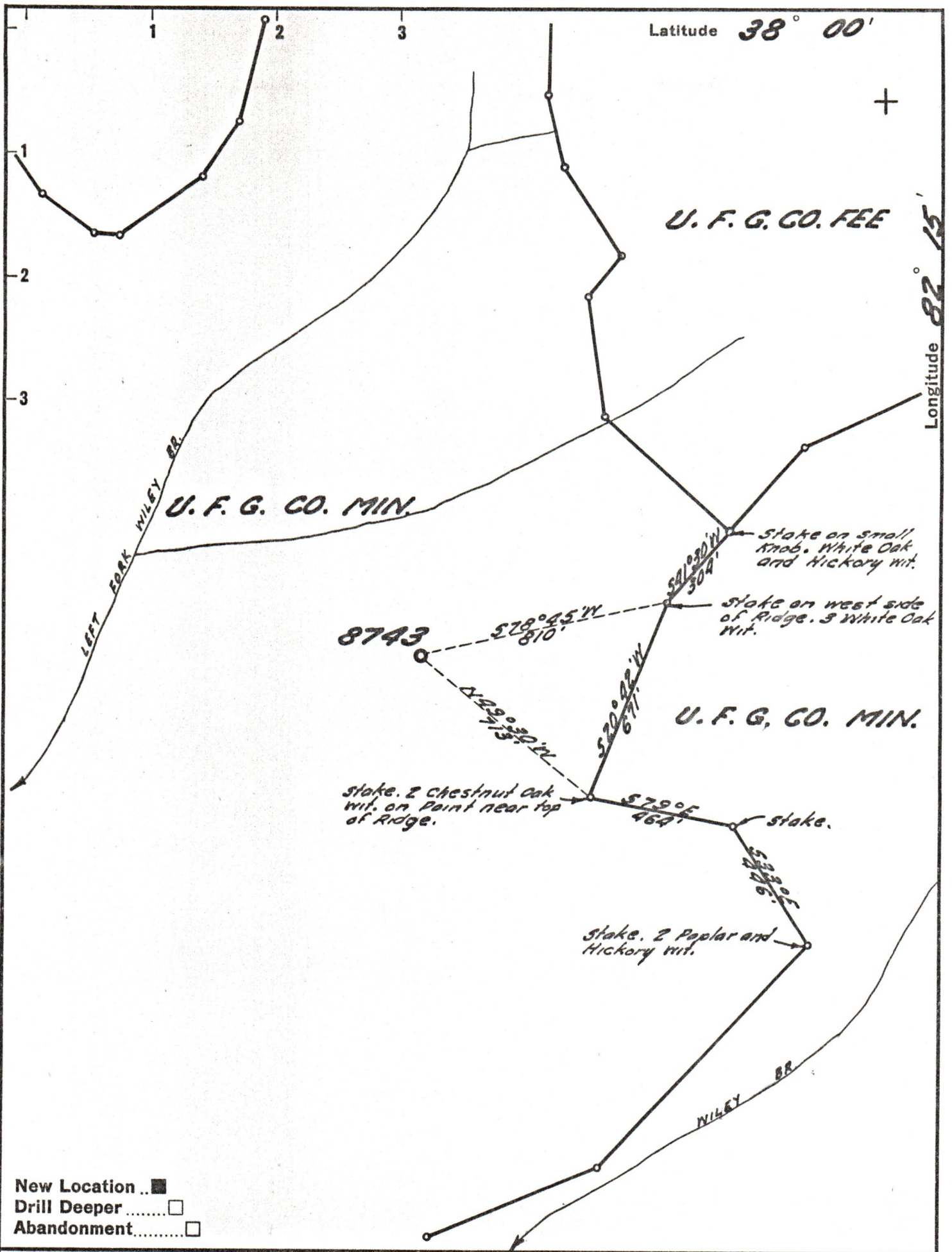

Company UNITED FUEL GAS CO.
 Address CHARLESTON, W. VA.
 Farm UNITED FUEL GAS CO. MIN.
 Tract 1 Acres 40,234.86 Lease No. NO REF.
 Well (Farm) No. _____ Serial No. 8743
 Elevation (Spirit Level) 1050.00'
 Quadrangle NAUGATUCK
 County WAYNE District GRANT
 Engineer Superior R. Farrell
 Engineer's Registration No. 2529
 File No. 26-33 Drawing No. _____
 Date 4-14-60 Scale 1" = 400'

STATE OF WEST VIRGINIA
 DEPARTMENT OF MINES
 OIL AND GAS DIVISION
 CHARLESTON

WELL LOCATION MAP
 FILE NO. WAY-1281 08/25/2023

+ Denotes location of well on United States Topographic Maps, scale 1 to 62,500, latitude and longitude lines being represented by border lines as shown.

- Denotes one inch spaces on border line of original tracing.