



STATE OF WEST VIRGINIA
DEPARTMENT OF MINES
OIL AND GAS DIVISION

NOTICE OF PROPOSED LOCATION OF OIL AND GAS WELL

To THE DEPARTMENT OF MINES,
Charleston, W. Va.

COAL OPERATOR OR COAL OWNER	United Fuel Gas Company <small>NAME OF WELL OPERATOR</small>
ADDRESS	Charleston, W. Va. <small>COMPLETE ADDRESS</small>
COAL OPERATOR OR COAL OWNER	May 31, 19 60 <small>PROPOSED LOCATION</small>
ADDRESS	Grant District
United Fuel Gas Co. <small>OWNER OF MINERAL RIGHTS</small>	Wayne County
ADDRESS	Well No. 8973 <i>38°05' 82°20' E. 952.71'</i>
	United Fuel Gas Co. Min. Tr. #1 Farm <i>40,496.86 Acres</i>

GENTLEMEN:

The undersigned well operator is entitled to drill upon the above named farm or tract of land for oil and gas, having fee title thereto, (or as the case may be) under grant or lease dated December 26, 1946, made by Huntington Devel. & Gas Co., to United Fuel Gas Co., and recorded on the 27th day of December, 1946, in the office of the County Clerk for said County in Book 234, page 318.

The enclosed plat was prepared by a competent engineer and shows the proposed location of a well to be drilled for oil and gas by the undersigned well operator on the farm and in the Magisterial District and County above named, determined by survey and courses and distances from two permanent points, or land marks.

The undersigned well operator is informed and believes there are no coal operators operating beds of coal beneath said farm or tract of land on which said well is located, or within 500 feet of the boundaries of the same, who have mapped their workings and filed their maps as required by law, excepting the coal operators or coal owners (if any) above named as addressees.

The above named coal operators or coal owners (if any) are notified that any objections they may desire to make to such proposed location, or which they are required to make by Section 3 of said Code, if the drilling of a well at said proposed location will cause a dangerous condition in or about their respective coal mines, must be received by, or filed with the Department of Mines within ten* days from the receipt of a copy of this notice and accompanying plat by said Department. Said coal operators are further notified that forms for use in making such objections will be furnished to them by the Department of Mines promptly on request and that all such objections must set forth as definitely as is reasonably possible the ground or grounds on which such objections are based and indicate the direction and distance the proposed location should be moved to overcome same.

(The next paragraph is to be completed only in Department's copy.)

Copies of this notice and the enclosed plat were mailed by registered mail, or delivered to the above named coal operators or coal owners at their above shown respective address _____ day _____ before, or on the same day with the mailing or delivery of this copy to the Department of Mines at Charleston, West Virginia.

Very truly yours,

UNITED FUEL GAS COMPANY

WELL OPERATOR

P. O. Box 1273

STREET

Charleston 25

CITY OR TOWN

West Virginia

STATE

08/25/2023

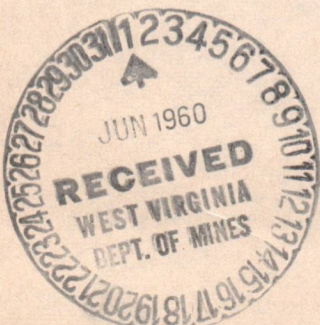

Address of Well Operator }

*Section 3 If no such objections be filed or be found by the department of mines, within said period of ten days from the receipt of said notice and plat by the department of mines, to said proposed location, the department shall forthwith issue to the well operator a drilling permit reciting the filing of such plat, that no objections have been made by the coal operators to the location, or found thereto by the department, and that the same is approved and the well operator authorized to proceed to drill at said location.

Formation	Color	Hard or Soft	Top ²⁷	Bottom	Oil, Gas or Water	Depth Found	Remarks
Pencil Cave			1439	1441			
Big Lime			1441	1454			
Break			1454	1456			
Big Lime			1456	1640			
Red Injun			1640	1682			
Grey Injun			1682	1721			
Slate			1721	1725			
Shell			1725	1745			
Slate			1745	1756			
Shell			1756	1850			
Slate & Shells			1850	2205			
Coffee Shale			2205	2243			
Hard Shell			2243	2286			
Brown Shale			2286	2370			
Slate & Shells			2370	2710			
Brown Shale			2710	2750			
Slate			2750	2803			
Brown Shale			2803	3191			
White Slate			3191	3213			
Total Depth			3213'				
							Perforated Big Lime at 1534-1546' and 1592-1598', 5/10 M T, 12 M
							Acidized 9-29-60 with 3000 gallons 15% HCL and 250 gallons MCA
							Test after acidized 6/10 W 2" 103 M
							Communication between Big Lime and Injun pays drowned out gas.
							Test before shot 26/10 W 1" 54 M
							Shot 12-7-60 with 6,666-2/3# Gelatin from 2227-3213'
							Test after tubed 86/10 W 2" 391 M - Shale
							Shut in 12-15-60 in 2-3/8" tubing.
							LOGS RUN: Gamma Ray G. G. Density Induction Temperature

08/25/2023

Date February 10, 19 61

APPROVED _____ UNITED FUEL GAS COMPANY, Owner

By S.R. Herrell
(Title)
Supt., Civil Engineering Dept.





STATE OF WEST VIRGINIA
DEPARTMENT OF MINES
OIL AND GAS DIVISION 27

Quadrangle Wayne

Permit No. WAY-1297

WELL RECORD

Oil or Gas Well Gas
(KIND)

Company United Fuel Gas Co.
Address P. O. Box 1273; Charleston 25, W. Va.
Farm United Fuel Gas Co. Min. Tr. #1 Acres 40,496.86
Location (waters) Milam Creek
Well No. 8973 Elev. 952.71
District Grant County Wayne
The surface of tract is owned in fee by _____
Address _____
Mineral rights are owned by United Fuel Gas Co.
Address Charleston, W. Va.
Drilling commenced 7-14-60
Drilling completed 12-5-60
Date Shot 12-7-60 From 2227 To 3213
With 6,666-2/3# Gelatin
Open Flow 86/10ths Water in 2 Inch
/10ths Merc. in _____ Inch
Volume 391,000 - Shale Cu. Ft.
Rock Pressure 410 lbs. 72 hrs.
Oil _____ bbls., 1st 24 hrs.
WELL ACIDIZED _____

Casing and Tubing	Used in Drilling	Left in Well	Packers
Size			Kind of Packer _____
16			<u>Hookwall</u>
13 <u>3/8</u>		<u>23'</u>	Size of _____
10 <u>3/4</u>		<u>378</u>	<u>2-3/8" x 5 1/2" x 16"</u>
8 1/4 <u>5/8</u>	<u>1481'</u>	<u>Pulled</u>	Depth set _____
6 5/8			<u>1771'</u>
5 3/4 <u>1/2</u>		<u>1754</u>	Perf. top _____
3			Perf. bottom _____
2 <u>3/8</u>		<u>3050</u>	Perf. top _____
Liners Used			Perf. bottom _____

CASING CEMENTED	SIZE	No. Ft.	Date

COAL WAS ENCOUNTERED AT 96 FEET 24 INCHES
228 FEET 24 INCHES FEET INCHES
FEET INCHES FEET INCHES

WELL FRACTURED _____

RESULT AFTER TREATMENT _____

ROCK PRESSURE AFTER TREATMENT _____

Fresh Water 97 Feet Salt Water 1125 Feet

Formation	Color	Hard or Soft	Top	Bottom	Oil, Gas or Water	Depth	Remarks
Surface			0	5	Water	97'	1 1/2 bailers per hour
Sand			5	96			
SH Coal			96	98	Hole full water	1125'	
Slate			98	107			
Sand			107	135	Gas	1534'	8/10 W 1" 30 M
Slate			135	153			
Broken Sand			153	228	Gas	1542'	14/10 W 1" 39 M
Coal			228	230			
Slate			230	275	Show oil	1579-1585'	
Sand			275	352			
Slate			352	400	Gas	1590'	17/10 W 1" 43 M
Sand			400	435			
Slate			435	475	Gas	2227-2233'	2/10 W 1" 15 M
Sand			475	511			
Slate & Shells			511	692	Gas	2980'	3/10 W 1" 18 M
Sand			692	704			
Slate & Shells			704	749	Gas	3080'	18/10 W 1" 45 M
Sand			749	788			blew down to 14/10 W 1" 63 M
Slate & Shells			788	827			
Sand			827	857	Gas	3147'	36/10 W 1" 63 M
Slate & Shells			857	954			
Sand			954	981	Perforated at	1673-1680'	
Slate & Shells			981	1010			
Salt Sand			1010	1277	Test before fracture	-0-	
Slate & Shells			1277	1292	Fractured Injun	9-25-60	3,000#
Gritty Lime			1292	1315	Sand and	440 bbls. water	
Slate & Shells			1315	1357	Test after fracture	45/10 W 2" 283 M and	
Red Rock			1357	1368	1 bbl. water		
Slate & Shells			1368	1410			
Little Lime			1410	1439			



(over)

08/25/2023

STATE OF WEST VIRGINIA
DEPARTMENT OF MINES
OIL AND GAS DIVISION

INSPECTOR'S WELL REPORT

Permit No. Way 1297

Oil or Gas Well 8973
(KIND)

Company	CASING AND TUBING	USED IN DRILLING	LEFT IN WELL	PACKERS
<u>U. F. G. Co.</u>	Size			
<u>Box 1273 Charleston, W. Va.</u>	16			Kind of Packer
<u>U. F. G. Min Tr. #1</u>	13			
Well No. <u>8973</u>	10			Size of
District <u>Grant</u> County <u>Wayne</u>	8 1/4			
Drilling commenced	6 5/8			Depth set
Drilling completed _____ Total depth _____	5 3/16			
Date shot _____ Depth of shot _____	3			Perf. top
Initial open flow _____ /10ths Water in _____ Inch	2			Perf. bottom
Open flow after tubing _____ /10ths Merc. in _____ Inch	Liners Used			Perf. top
Volume _____ Cu. Ft.				Perf. bottom
Rock pressure _____ lbs. _____ hrs.	CASING CEMENTED _____ SIZE _____ No. FT. _____ Date _____			
Oil _____ bbls., 1st 24 hrs.	COAL WAS ENCOUNTERED AT _____ FEET _____ INCHES			
Fresh water _____ feet _____ feet	_____ FEET _____ INCHES _____ FEET _____ INCHES			
Salt water _____ feet _____ feet	_____ FEET _____ INCHES _____ FEET _____ INCHES			

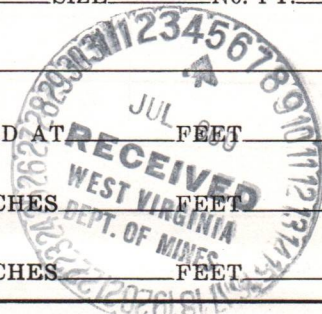

Drillers' Names C. P. Pinkerton
Ros. Nelson

Remarks: Rigging up national machine.

6/27/00
DATE

Jw. Pack
DISTRICT WELL INSPECTOR
08/25/2023

STATE OF WEST VIRGINIA
 DEPARTMENT OF MINES
 OIL AND GAS DIVISION
INSPECTOR'S PLUGGING REPORT

Permit No. _____ Well No. _____

COMPANY _____ ADDRESS _____

FARM _____ DISTRICT _____ COUNTY _____

Filling Material Used _____

Liner	Location	Amount	Packer	Location		
PLUGS USED AND DEPTH PLACED			BRIDGES	CASING AND TUBING		
CEMENT-THICKNESS	WOOD-SIZE	LEAD	CONSTRUCTION-LOCATION	RECOVERED	SIZE	LOST

Drillers' Names _____

Remarks: _____

_____ I hereby certify I visited the above well on this date.
DATE

DISTRICT WELL INSPECTOR
08/25/2023

STATE OF WEST VIRGINIA
DEPARTMENT OF MINES
OIL AND GAS DIVISION

INSPECTOR'S WELL REPORT

Permit No. WAY-1297

Oil or Gas Well 8973
(KIND)

		CASING AND TUBING	USED IN DRILLING	LEFT IN WELL	PACKERS
Company	<u>United Fuel Gas Co.</u>				
Address	<u>P.O. Box 1273 Charleston, W. Va.</u>	Size			
Farm	<u>U.F.G.Co. Min. Tr. #1</u>	16			Kind of Packer
Well No.	<u>8973</u>	13	<u>17'5"</u>		
District	<u>Grant</u> County <u>Wayne</u>	10	<u>37 5/8</u>		Size of
Drilling commenced	<u>7-14-60</u>	8 1/4			
Drilling completed	Total depth	6 5/8			Depth set
Date shot	Depth of shot	5 3/16			
Initial open flow	/10ths Water in Inch	3			Perf. top
Open flow after tubing	/10ths Merc. in Inch	2			Perf. bottom
Volume	Cu. Ft.	Liners Used			Perf. top
Rock pressure	lbs. hrs.				Perf. bottom
Oil	bbls., 1st 24 hrs.	CASING CEMENTED _____ SIZE _____ No. FT. _____ Date _____			
Fresh water	feet feet	COAL WAS ENCOUNTERED AT <u>96</u> FEET <u>24</u> INCHES			
Salt water	feet feet	<u>228</u> FEET <u>24</u> INCHES FEET INCHES			
		_____ FEET _____ INCHES FEET INCHES			

Drillers' Names Brady Williams

Ray Oxley

Remarks: Drilling in sand at 845'. Ronald Hoosier, Contractor.

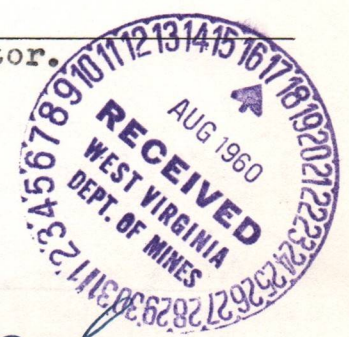

J.W. Pack
DISTRICT WELL INSPECTOR

08/25/2023

8-9-60

DATE



STATE OF WEST VIRGINIA
 DEPARTMENT OF MINES
 OIL AND GAS DIVISION
INSPECTOR'S PLUGGING REPORT

Permit No. _____ Well No. _____

COMPANY _____ ADDRESS _____

FARM _____ DISTRICT _____ COUNTY _____

Filling Material Used _____

Liner			Location	Amount	Packer	Location		
PLUGS USED AND DEPTH PLACED			BRIDGES			CASING AND TUBING		
CEMENT-THICKNESS	WOOD-SIZE	LEAD	CONSTRUCTION-LOCATION			RECOVERED	SIZE	LOST

Drillers' Names _____

Remarks: _____

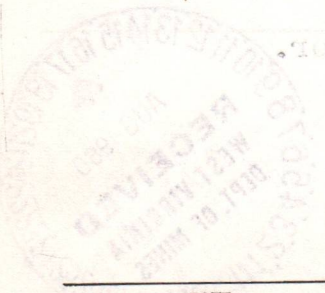

_____ I hereby certify I visited the above well on this date.
 DATE

DISTRICT WELL INSPECTOR
08/25/2023

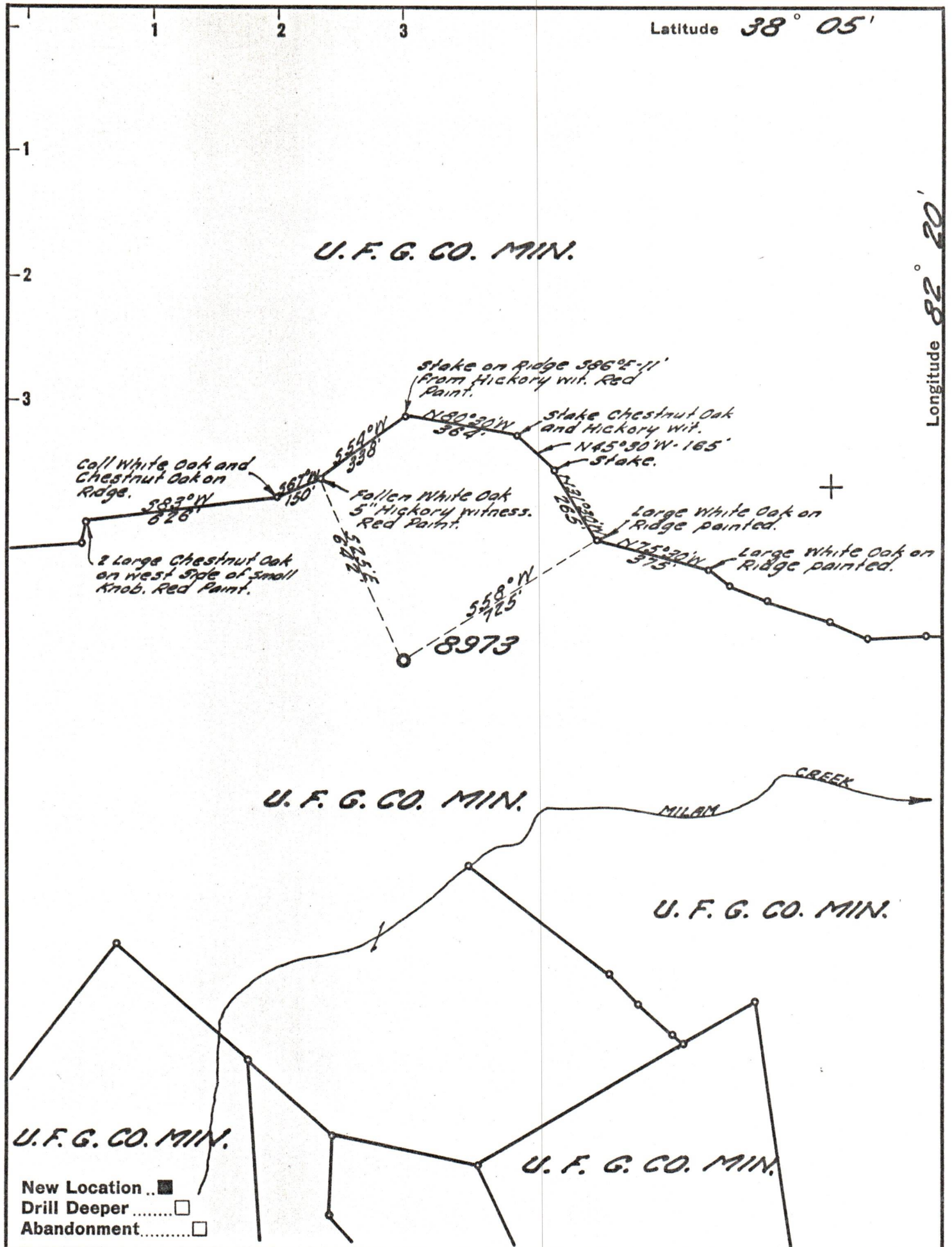

Company UNITED FUEL GAS CO.
 Address CHARLESTON, W. VA.
 Farm UNITED FUEL GAS CO. MIN.
 Tract 1 Acres 404.86 REF. 24689
 Well (Farm) No. _____ Serial No. 8973
 Elevation (Spirit Level) 952.71'
 Quadrangle WAYNE
 County WAYNE District GRANT
 Engineer Paul E. Joadant
 Engineer's Registration No. 669
 File No. 22-37 Drawing No. _____
 Date 5-20-60 Scale 1" = 400'

STATE OF WEST VIRGINIA
 DEPARTMENT OF MINES
 OIL AND GAS DIVISION
 CHARLESTON

WELL LOCATION MAP

FILE NO. WAY-1297

+ Denotes location of well on United States Topographic Maps, scale 1 to 62,500, latitude and longitude lines being represented by border lines as shown.
 - Denotes one inch spaces on border line of original tracing.