



STATE OF WEST VIRGINIA
DEPARTMENT OF MINES
OIL AND GAS DIVISION

NOTICE OF PROPOSED LOCATION OF OIL AND GAS WELL

To THE DEPARTMENT OF MINES,
Charleston, W. Va.

_____	United Fuel Gas Company
COAL OPERATOR OR COAL OWNER	NAME OF WELL OPERATOR
_____	Charleston, West Virginia
ADDRESS	COMPLETE ADDRESS
_____	September 5, 19 62
COAL OPERATOR OR COAL OWNER	PROPOSED LOCATION
_____	Lincoln District
ADDRESS	Wayne County
Glenhayes Company	Well No. 9227 $38^{\circ} 05'$
OWNER OF MINERAL RIGHTS	$82^{\circ} 30' E 830.21'$
c/o Clyde Daniel	GLENHAYES COMPANY Farm
Louisa, Kentucky	3, 518 Acres
ADDRESS	

GENTLEMEN:

The undersigned well operator is entitled to drill upon the above named farm or tract of land for oil and gas, having fee title thereto, (or as the case may be) under grant or lease dated December 22, 1956, made by Glenhayes Company, to United Fuel Gas Company, and recorded on the 28th day of February 1957, in the office of the County Clerk for said County in Book 46, page 385.

The enclosed plat was prepared by a competent engineer and shows the proposed location of a well to be drilled for oil and gas by the undersigned well operator on the farm and in the Magisterial District and County above named, determined by survey and courses and distances from two permanent points, or land marks.

The undersigned well operator is informed and believes there are no coal operators operating beds of coal beneath said farm or tract of land on which said well is located, or within 500 feet of the boundaries of the same, who have mapped their workings and filed their maps as required by law, excepting the coal operators or coal owners (if any) above named as addressees.

The above named coal operators or coal owners (if any) are notified that any objections they may desire to make to such proposed location, or which they are required to make by Section 3 of said Code, if the drilling of a well at said proposed location will cause a dangerous condition in or about their respective coal mines, must be received by, or filed with the Department of Mines within ten* days from the receipt of a copy of this notice and accompanying plat by said Department. Said coal operators are further notified that forms for use in making such objections will be furnished to them by the Department of Mines promptly on request and that all such objections must set forth as definitely as is reasonably possible the ground or grounds on which such objections are based and indicate the direction and distance the proposed location should be moved to overcome same.

(The next paragraph is to be completed only in Department's copy.)

Copies of this notice and the enclosed plat were mailed by registered mail, or delivered to the above named coal operators or coal owners at their above shown respective address _____ day _____ before, or on the same day with the mailing or delivery of this copy to the Department of Mines at Charleston, West Virginia.

Very truly yours,

UNITED FUEL GAS COMPANY

WELL OPERATOR

P. O. Box 1273

STREET

Charleston 25

CITY OR TOWN

West Virginia

STATE

10/27/2023

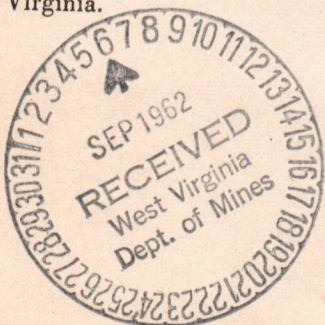

Address of Well Operator }

*Section 3 If no such objections be filed or be found by the department of mines, within said period of ten days from the receipt of said notice and plat by the department of mines, to said proposed location, the department shall forthwith issue to the well operator a drilling permit reciting the filing of such plat, that no objections have been made by the coal operators to the location, or found thereto by the department, and that the same is approved and the well operator authorized to proceed to drill at said location.

1443

WAY-1443

PERMIT NUMBER



STATE OF WEST VIRGINIA
DEPARTMENT OF MINES
OIL AND GAS DIVISION

NOTICE OF PROPOSED LOCATION OF OIL AND GAS WELL

To THE DEPARTMENT OF MINES
Charleston, W. Va.

United Fuel Gas Company

NAME OF WELL OPERATOR

COAL OPERATOR OR COAL OWNER

Charleston, West Virginia

COMPLETE ADDRESS

ADDRESS

September 3, 1930

PROPOSED LOCATION

COAL OPERATOR OR COAL OWNER

Lincoln

ADDRESS

Wayne

OWNER OF MINERAL RIGHTS

Glenhove Company

c/o Clyde Daniel

Louis, Kentucky

CITY

CLIMAX COMPANY

OPERATOR

The undersigned well operator is entitled to drill upon the above named tract or tract of land for oil and gas having the title thereto, for as the case may be, under grant or lease dated

Glenhove Company

December 22, 1930

was recorded on the

United Fuel Gas Company

to the effect of the County Clerk for said County in

February 1931

Book 40 Page 385

The enclosed plat was prepared by a competent engineer and shows the proposed location of a well to be drilled for oil and gas by the undersigned well operator on the tract and in the West Virginia District and county above named, determined by survey and corners and distances from permanent points on land herein.

The undersigned well operator's intention and belief that there are no well operations existing on or near the proposed location of such well and that no other well is being drilled or within 500 feet of the proposed location of such well, and that there are no other wells or operations on the land or within the vicinity of such location (if any) is hereby certified.

The above named coal operator or coal owners (if any) is certified that any operations for coal on the land to which the proposed location of such well is proposed to be made by Section 2 of said State is the drilling of a well at such proposed location will cause a substantial reduction in the coal reserves of the tract or tract of land within the limits of the proposed location of such well, and that the proposed location of such well is in violation of the provisions of said Section 2 of said State. The undersigned well operator is further advised that the proposed location of such well is in violation of the provisions of said Section 2 of said State, and that the proposed location of such well is in violation of the provisions of said Section 2 of said State, and that the proposed location of such well is in violation of the provisions of said Section 2 of said State.

The next paragraph only be completed only in Department's copy.

Copies of this notice and the enclosed plat were mailed or registered mail or delivered in the above named coal operators or coal owners at their above shown respective addresses, this day of

UNITED FUEL GAS COMPANY

WELL OPERATOR

P. O. Box 1213

ADDRESS

Charleston 23

CITY AND STATE

West Virginia

STATE

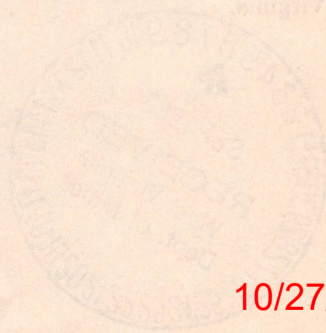

10/27/2023

If no such operations be found or be found by the department of mines within said period of time, the well operator is authorized to drill the well at the proposed location of such well, and that the proposed location of such well is in violation of the provisions of said Section 2 of said State, and that the proposed location of such well is in violation of the provisions of said Section 2 of said State, and that the proposed location of such well is in violation of the provisions of said Section 2 of said State.

WV-1413

STATE TUNING



STATE OF WEST VIRGINIA
 DEPARTMENT OF MINES
 CHARLESTON

September 17, 1962
 "CENTENNIAL '63"

C
O
P
Y

United Fuel Gas Company
 P. O. Box 1273
 Charleston 25, West Virginia

Att: Mr. Bernard Moon

Gentlemen:

Enclosed are Permits for drilling the following wells in Kanawha and Wayne Counties:

<u>PERMIT NO.</u>	<u>FARM</u>	<u>WELL NO.</u>	<u>DISTRICT</u>
KAN-1907	Olive Culpepper, et al	9076	Elk
WAY-1442	Glenhayes Company	9228	Lincoln
WAY-1443	Glenhayes Company	9227	Lincoln

Very truly yours,

Executive Secretary
 OIL AND GAS DIVISION

GW/dd
 enclosure

cc: Mr. Dana Lawson, Inspector

Mr. Kenneth E. Butcher, Inspector

Mr. R. C. Tucker, Assistant
 State Geologist



STATE OF WEST VIRGINIA
 DEPARTMENT OF MINES
 CHARLESTON

141

September 17, 1945
 "CENTRAL" # 21

COPY

United Fuel Gas Company
 P. O. Box 1573
 Charleston 25, West Virginia
 Attn: Mr. Edward Horn

Gentlemen:

Enclosed are permits for drilling the following wells in Kanawha and Wayne Counties:

DISTRICT	WELL NO.	NAME	PERMIT NO.
Wayne	2078	Olive Colquhoun, et al	WAY-1507
Lincoln	2559	Glennys Company	WAY-1492
Lincoln	2577	Glennys Company	WAY-1493

Very truly yours,

Executive Secretary
 OIL AND GAS DIVISION

Enclosure

cc: Mr. Dana Lawson, Inspector

Mr. Kenneth E. Rutherford, Inspector

Mr. H. C. Tucker, Assistant
 State Geologist

Formation	Color	Hard or Soft	Top	Bottom	Oil, Gas or Water	Depth Found	Remarks
10000			10000	10000			
9000			9000	9000			
8000			8000	8000			
7000			7000	7000			
6000			6000	6000			
5000			5000	5000			
4000			4000	4000			
3000			3000	3000			
2000			2000	2000			
1000			1000	1000			
0			0	0			

10/27/2023

Date February 18, 19 63

APPROVED UNITED FUEL GAS CO., Owner

By S. H. Jewell
(Title)

Supt., Civil Engineering Dept.

B-



STATE OF WEST VIRGINIA
DEPARTMENT OF MINES
OIL AND GAS DIVISION

Quadrangle Louisa

Permit No. WAY-1443

WELL RECORD

Oil or Gas Well Gas
(KIND)

Company United Fuel Gas Company
Address P.O. Box 1273 Charleston 25, W. Va.
Farm Glenhayes Company Acres 3518
Location (waters) Upper Stone Branch
Well No. 9227 Elev. 830.21'
District Lincoln County Wayne
The surface of tract is owned in fee by _____
Address _____
Mineral rights are owned by Glenhayes Company
% Clyde Daniel Address Louisa, Kentucky
Drilling commenced 9-20-62
Drilling completed 10-15-62
Date Shot _____ From _____ To _____
With _____
Open Flow _____ /10ths Water in _____ Inch
16 /10ths Merc. in 3 Inch
Volume 1,400,000 - Injun Cu. Ft.
Rock Pressure 497 lbs. 72 hrs.
Oil _____ bbls., 1st 24 hrs.
WELL ACIDIZED _____
WELL FRACTURED _____

Casing and Tubing	Used in Drilling	Left in Well	Packers
Size			Kind of Packer _____
16			
13			
10 <u>3/4</u>		<u>32'</u>	Size of _____
8 1/2 <u>5/8</u>		<u>332</u>	
6 3/8 <u>7"</u>	<u>1166'</u>	<u>Pulled</u>	Depth set _____
5 3/16			
3 1/2	<u>Cemented</u>	<u>1421'</u>	Perf. top _____
2			Perf. bottom _____
Liners Used			Perf. top _____
			Perf. bottom _____

CASING CEMENTED _____ SIZE _____ No. Ft. _____ Date _____

COAL WAS ENCOUNTERED AT 90 FEET 36 INCHES
____ FEET _____ INCHES _____ FEET _____ INCHES
____ FEET _____ INCHES _____ FEET _____ INCHES

RESULT AFTER TREATMENT _____

ROCK PRESSURE AFTER TREATMENT _____

Fresh Water _____ Feet Salt Water 695 Feet

Formation	Color	Hard or Soft	Top	Bottom	Oil, Gas or Water	Depth	Remarks
Surface			0	10	Show gas	1340'	
Sand			10	40			
Slate			40	90	Perforated 3 1/2" tubing from 1346-1358'		2 shots per foot.
Coal			90	93			
Slate			93	200			
Sand			200	230	Test before fracture 2/10 W 1" 15 M		
Slate			230	370	Fractured Injun 19 10-19-62 with		
Sand			370	417	27,000# sand and 400 bbls. sand		
Slate			417	480	laden fluid. Final open flow after		
Sand			480	550	fracture 16/10 Merc. 3" 1,400 M		
Slate			550	665			
Salt Sand			665	1022			
Red Rock			1022	1035	Shut in 10-22-62 in 3 1/2" tubing.		
Slate			1035	1070			
Red Rock			1070	1080			
Slate			1080	1100	LOGS RUN:		
Black Lime			1100	1123	Gamma Ray		
Slate			1123	1127	Density		
Big Lime			1127	1305	Induction		
Keener Sand			1305	1315			
Slate			1315	1339			
Injun Sand			1339	1376			
Slate & Shells			1376	1429			
Total Depth			1429'				

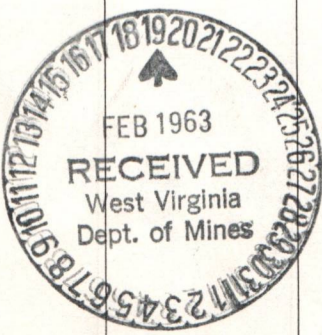

10/27/2023

U.S. DEPARTMENT OF ENERGY
Federal Energy Regulatory Commission
Washington, D.C. 20426

**APPLICATION FOR DETERMINATION OF THE MAXIMUM LAWFUL
PRICE UNDER THE NATURAL GAS POLICY ACT (NGPA)**
(Sections 102, 103, 107 and 108)

PLEASE READ BEFORE COMPLETING THIS FORM:

General Instructions:

Complete this form if you are applying for price classification under sections 102, 103, 107 or 108 of the NGPA. A separate application is required for each well. If any reservoir qualifies for a category which differs from the category applicable to the producing well, separate applications must be made for the producing well and the reservoir. Complete each appropriate item on the reverse side of this page. The code numbers used in items 4.0 and 6.0 can be obtained from the Buyer/Seller Code Book. If there is more than one purchaser or contract, identify the additional information in the space below. Enter any additional remarks in the space below.

Submit the completed application to the appropriate Jurisdictional Agency as listed in title 18 of the CFR, part 274.501. If there are any questions, call (202) 275-4539.

Specific Instructions for Item 2.0, Type of Determination:

<u>Section of NGPA</u>	<u>Category Code</u>	<u>Description</u>
102	1	New OCS Lease
102	2	New onshore well (2.5 mile test)
102	3	New onshore well (1,000 feet deeper test)
102	4	New onshore reservoir
102	5	New reservoir on old OCS Lease
103	-	New onshore production well
107	-	High cost natural gas
108	-	Stripper well

Other Purchasers/Contracts:

<u>Contract Date</u> (Mo. Day Yr.)	<u>Purchaser</u>	<u>Buyer Code</u>
_____	_____	_____
_____	_____	_____
_____	_____	_____

Remarks:

10/27/2023

1.0 API well number. (If not assigned, leave blank 14 digits.)	<u> - 47 - 099 - 01443 </u>				
2.0 Type of determination being sought (Use the codes found on the front of this form.)	<u> 108 </u> Section of NGPA	<u> — </u> Category Code			
3.0 Depth of the deepest completion location (Only needed if sections 103 or 107 in 2.0 above.)	<u> N/A </u> feet				
4.0 Name, address and code number of applicant (35 letters per line maximum. If code number not available, leave blank.)	Columbia Gas Transmission Corporation Name P. O. Box 1273 Street Charleston City			004030 Seller Code	
5.0 Location of this well (Complete (a) or (b).) (a) For onshore wells (35 letters maximum for field name.)		<u> W. VA. Field Area B </u> Field Name <u> Wayne </u> County <u> WVA </u> State			
(b) For OCS wells		<u> N/A </u> Area Name Date of Lease Mo. Day Yr. OCS Lease Number			
(c) Name and identification number of this well (35 letters and digits maximum.)		<u> Glen Hayes Co. </u> <u> 809227 </u>			
(d) If code 4 or 5 in 2.0 above, name of the reservoir (35 letters maximum.)		<u> N/A </u>			
6.0 (a) Name and code number of the purchaser (35 letters and digits maximum. If code number not available, leave blank.)	* Name			004030 Buyer Code	
(b) Date of the contract		* Mo. Day Yr.			
(c) Estimated total annual production from the well		<u> 2 </u> Million Cubic Feet			
		(a) Base Price	(b) Tax	(c) All Other Prices (Indicate (+) or (-).)	(d) Total of (a), (b) and (c)
7.0 Contract price (As of filing date. Complete to 3 decimal places.)	S/MMBTU	— . — . — .	— . — . — .	— . — . — .	— . — . — .
8.0 Maximum lawful rate (As of filing date. Complete to 3 decimal places.)	S/MMBTU	<u> 3.334 </u>	— . — . — .	— . — . — .	— . — . — .
9.0 Person responsible for this application		Albert H. Mathena, Jr., Director, Production Eng. Name <u> Albert H. Mathena </u> Signature <u> 5-18-82 </u> Date Application is Completed			
Agency Use Only Date Received by Juris. Agency <u> MAY 28 1982 </u> Date Received by FERC		Title (304) 346-0951 Phone Number			

*This is a pipeline production well. No contract exists and no sales are made.

10/27/2023

PARTICIPANTS:

DATE: NOV 30 1982

BUYER-SELLER CODE

WELL OPERATOR: Columbia Gas Trans. Corp

004030

FIRST PURCHASER: _____ *

*

OTHER: _____

W. Va. Department of Mines, Oil & Gas Division
 WELL DETERMINATION FILE NUMBER
820528-108-099-1443
 Use Above File Number on all Communications
 Relating to Determination of this Well

QUALIFIED

CHECK EACH ITEM AS COMPLETE OR NOTE WHAT IS MISSING

ITEM NO.

- 1. FERC -121 Items not completed - Line No. All 70 + 8.0 b,c,d
- 2. IV-1 Agent James L. Weekley
- 3. IV-2 Well Permit _____
- 4. IV-6 Well Plat
- 5. IV-35 Well Record Drilling Deepening
- 6. IV-36 Gas-Oil Test: Gas Only Was Oil Produced? Ratio
- 7. IV-39 Annual Production 42 Months years
- 8. IV-40 90 day Production 87 Days off line: _____
- 9. IV-48 Application for certification. Complete?
- 10-17. IV Form 51 - 52 - 53 - 54 - 55 - (56) - 57 - 58 Complete? Affidavit Signed
- 18-28. Other: Survey _____ Logs _____ Geological Charts _____
 Structure Map _____ 1: 4000 Map _____ Well Tabulations _____
 Gas Analyses _____
- (5) Date commenced: 9-20-62 Date completed 10-15-62 Deepened
- (5) Production Depth: 1340
- (5) Production Formation: Injun
- (5) Final Open Flow: 1400 MCF
- (5) After Frac. R. P. 497# 72 hr.
- (6) Other Gas Test: _____
- (7) Avg. Daily Gas from Annual Production: 7059 / 363 = 19.4 MCF
- (8) Avg. Daily Gas from 90-day ending w/1-120 days 1837 / 87 = 21.1 MCF
- (8) Line Pressure: NA PSIG from Daily Report
- (5) Oil Production: From Completion Report
- 10-17. Does lease inventory indicate enhanced recovery being done NO
- 10-17. Is affidavit signed? Notarized?
- Does official well record with the Department confirm the submitted information? YES 10/27/2023
- Additional information _____ Does computer program confirm? _____
- Was Determination Objected to _____ By Whom? _____

Describe the search of any records listed above:

Are you aware of any other information which would tend to be inconsistent with the information specified above? Yes No . If yes, indicate the type and source of the information.

AFFIDAVIT

I, Albert H. Mathena, Jr., having been first sworn according to law, state that I have caused to be made a diligent search of those records hereinbefore indicated in the manner herein described, that the information contained in this document is true and accurate and that on the basis of the records and examinations hereinbefore described, and to the best of my information, knowledge and belief, the well for which this certification is sought qualifies as a stripper well.

Albert H Mathena Jr

STATE OF WEST VIRGINIA.

COUNTY OF Kanawha. TO WIT:

I, Larry G. Burdette, a Notary Public in and for the state and county aforesaid, do certify that Albert H. Mathena, Jr whose name is signed to the writing above, bearing date the 18 day of May, 1982, has acknowledged the same before me, in my county aforesaid. Given under my hand and official seal this 18 day of May, 1982. My term of office expires on the 13 day of August, 1989.

Larry G. Burdette
Notary Public

[NOTARIAL SEAL]

10/27/2023

STATE OF WEST VIRGINIA
DEPARTMENT OF MINES, OIL AND GAS DIVISION

Date _____ 19__

Operator's Well No. 809227

API Well No. 47 - 099 - 01443
State County Permit

WELL CLASSIFICATION FORM

STRIPPER GAS WELL

MGPA Section 108

DESIGNATED AGENT James L. Weekley

ADDRESS P. O. Box 1273

Charleston, WV 25325

WELL OPERATOR Columbia Gas Trans. Corp.

ADDRESS P. O. Box 1273

Charleston, WV 25325

GAS PURCHASER NA

ADDRESS _____

LOCATION: Elevation _____

Watershed _____

Dist. Lincoln County Wayne Quad. _____

Gas Purchase Contract No. NA

Meter Chart Code 804593

Date of Contract NA

* * * * *
This is a pipeline production well and no gas purchase contract exists.

Provide a complete inventory of the lease and production equipment used for the well for the previous 24 months or, if less than 24 months, the period the well has been in production. Include a complete list of equipment or processes used in connection with recognized enhanced recovery techniques during completion or production. (Attach separate sheets, if necessary.)

NOT REQUIRED PER FERC REGULATIONS

List all records reasonably available to you which contain information relevant to a determination of eligibility (including production records, B&O Tax Records and royalty payment records) and indicate the location of such records:

SEE ATTACHED PRODUCTION SHEETS

10/27/2023

Operator's Well No 809227

API Well No. 47 - 099 - 01443
State County Permit

Previous File No _____
(If Applicable)

STATE APPLICATION FOR WELL CLASSIFICATION

WELL OPERATOR Columbia Gas Trans. Corp.
ADDRESS P. O. Box 1273
Charleston, W. Va. 25325

DESIGNATED AGENT James L. Weekley
ADDRESS P. O. Box 1273
Charleston, W. Va. 25325

Gas Purchase Contract No. NA* and Date _____
(Month, day and year)

Meter Chart Code 804593

Name of First Purchaser NA*

(Street or P. O. Box)
(City) (State) (Zip Code)

FERC Seller Code NA* FERC Buyer Code NA*

TYPE OF DETERMINATION BEING SOUGHT

- (1) Initial determination (See FERC Form 121.) Section of NGPA 108 Category Code _____
- (2) Determination that increased production is the result of enhanced recovery technology
- (3) Determination of a seasonally affected well. Production Engineering

*This well is a pipeline production and no gas purchase contract exists.

Albert H. Mathena, Jr., Director-
Name (Print)

Albert H. Mathena, Jr.
Signature

P. O. Box 1273
Street or P. O. Box

Charleston, W. Va. 25325
City State (Zip Code)

(304) 346-0951
Area Code Phone Number

(Certificate of Proof of Service to Purchaser)

A copy of this filing is being retained by Columbia Gas Transmission Corporation, owner and operator of the identified well.

(All of the above to be completed by the Operator/Applicant)

(To be completed by Jurisdictional Agency. Executed copy to be returned to Operator/Applicant and purchaser, if known).

The Department of Mines has received a request for certification of the above well as meeting the requirements of Section _____ under the Natural Gas Policy Act of 1975 (NGPA). for determination that increased production is the result of enhanced recovery technology under Section 108 of (NGPA). or for determination of a seasonally affected well under Section _____

All interested parties are hereby notified that on the _____ day of _____ at the office of the Oil and Gas Division in Charleston, West Virginia, or as soon thereafter as it may be heard, there will be a public hearing, if requested, or if objection is filed.

This Application is assigned File No. _____

Initial review of information submitted indicates the well is is not entitled to certification as claimed under the Natural Gas Policy Act (NGPA). A review of _____ and any additional evidence will be made at the time appointed for a public hearing or as soon thereafter as the matter may be heard.

Unless objections are timely filed or a request for a hearing is made within fifteen days, a hearing will not be held except on ex parte motion of the department and the matter will go to determination.

WEST VIRGINIA DEPARTMENT OF MINES

MAY 28 1982
Date received by
Jurisdictional Agency

by [Signature]
Title _____

10/27/2023

REPORT DATE 04/14/82
REPORT TIME 16:08:04

COLUMBIA GAS TRANSMISSION CORPORATION
N.G.P.A. SECTION 108
LIST OF WELLS FOR MEASURING STATION NUMBER 804593

PAGE 3

IN ACCORDANCE WITH SECTION 271.804(B), THE FOLLOWING IS A LIST OF ALL WELLS
ASSOCIATED WITH THIS MEASURING STATION. THESE ARE USED IN DETERMINING WELL
CLASSIFICATIONS UNDER PART 271 SUBPART H.

PRODUCING UNITS

809133 809200 809227 809228

API NUMBERS

47-099-01388
47-099-01415
47-099-01443
47-099-01442

10/27/2023

REPORT DATE 02/24/82
 REPORT TIME 17:22:45

COLUMBIA GAS TRANSMISSION CORPORATION
 N.G.P.A. SECTION 108
 APPLICATION FOR WELL CLASSIFICATION

PAGE 3415
 API WELL NO. 47-099-01443

WELL NUMBER : 809227 FARM NAME: GLENHAYES CO
 MEASURING STATION: 804593 LEASE : 53492
 STATE : WV

DATE MM/YY	THREE MONTH MCF/DAY	VOLUME -100- PERCENT	DAYS ON LINE	MCF/DAY -100- PERCENT	LINE PRSS PSIA	WELL COUNT
10/78		464	28	16.6	79	1.000
11/78		468	30	15.6	80	1.000
12/78		507	32	15.8	84	1.000
1/79	16.0	530	30	17.7	71	1.000
2/79	17.8	582	29	20.1	64	1.000
3/79	18.1	479	29	16.5	56	1.000
4/79	17.5	497	31	16.0	64	1.000
5/79	11.3	0	26	0.0	73	1.000
6/79	15.6	922	34	27.1	91	1.000
7/79	15.2	463	31	14.9	88	1.000
8/79	19.7	507	31	16.4	89	1.000
9/79	10.3	11	33	0.3	88	1.000
10/79	12.2	590	27	21.9	92	1.000
11/79	44.0	3358	30	111.9	78	1.000
12/79	52.5	670	31	21.6	124	1.000

10/27/2023

REPORT DATE 02/23/82
 REPORT TIME 16:51:55

COLUMBIA GAS TRANSMISSION CORPORATION
 N.G.P.A. SECTION 108
 APPLICATION FOR WELL CLASSIFICATION

PAGE 3364
 API WELL NO. 47-099-01443

WELL NUMBER : 809227
 MEASURING STATION: 804593

FARM NAME: GLENHAYES CO
 LEASE : 53492
 STATE : WV

DATE MM/YY	THREE MONTH MCF/DAY	VOLUME -100- PERCENT	DAYS ON LINE	MCF/DAY -100- PERCENT	LINE PRSS PSIA	WELL COUNT
11/79		3358	30	111.9	78	1.000
12/79		670	31	21.6	124	1.000
1/80	53.2	868	31	28.0	129	1.000
2/80	-8.0	-2269	29	-78.2	100	1.000
3/80	-10.0	495	31	16.0	89	1.000
4/80	-13.5	545	31	17.6	82	1.000
5/80	15.3	356	29	12.3	92	1.000
6/80	14.9	470	32	14.7	84	1.000
7/80	18.1	820	30	27.3	100	1.000
8/80	23.8	969	33	29.4	98	1.000
9/80	27.4	733	29	25.3	85	1.000
10/80	25.4	613	29	21.1	75	1.000
11/80	39.9	2326	34	68.4	74	1.000
12/80	32.3	0	28	0.0	97	1.000
1/81	30.8	475	29	16.4	84	1.000
2/81	19.4	1286	34	37.8	88	1.000
3/81	23.4	342	27	12.7	85	1.000
4/81	19.4	140	30	4.7	76	1.000
5/81	12.8	618	29	21.3	96	1.000
6/81	14.5	548	31	17.7	92	1.000
7/81	20.1	664	31	21.4	86	1.000
8/81	23.3	998	33	30.2	97	1.000
9/81	20.3	264	31	8.5	86	1.000
10/81	20.9	642	27	23.8	84	1.000
11/81	21.2	1026	33	31.1	86	1.000
12/81	21.9	322	31	10.4	78	1.000

10/27/2023

REPORT DATE 04/14/82
REPORT TIME 16:08:04

PAGE 3364
API WELL NO. 47-099-01443

COLUMBIA GAS TRANSMISSION CORPORATION
N.G.P.A. SECTION 108
APPLICATION FOR WELL CLASSIFICATION

WELL NUMBER : 809227 FARM NAME: GLENHAYES CO
MEASURING STATION: 804593 LEASE : 53492
STATE : WV

DATE MM/YY	THREE MONTH MCF/DAY	VOLUME -100- PERCENT	DAYS ON LINE	MCF/DAY -100- PERCENT	LINE PRSS PSIA	WELL COUNT
11/81		1025	31	33.4	85	1.000
1/82	24.1	938	31	30.3	75	1.000
2/82	20.2	620	31	20.0	79	1.000
3/82	20.6	279	27	10.3	82	1.000

10/27/2023

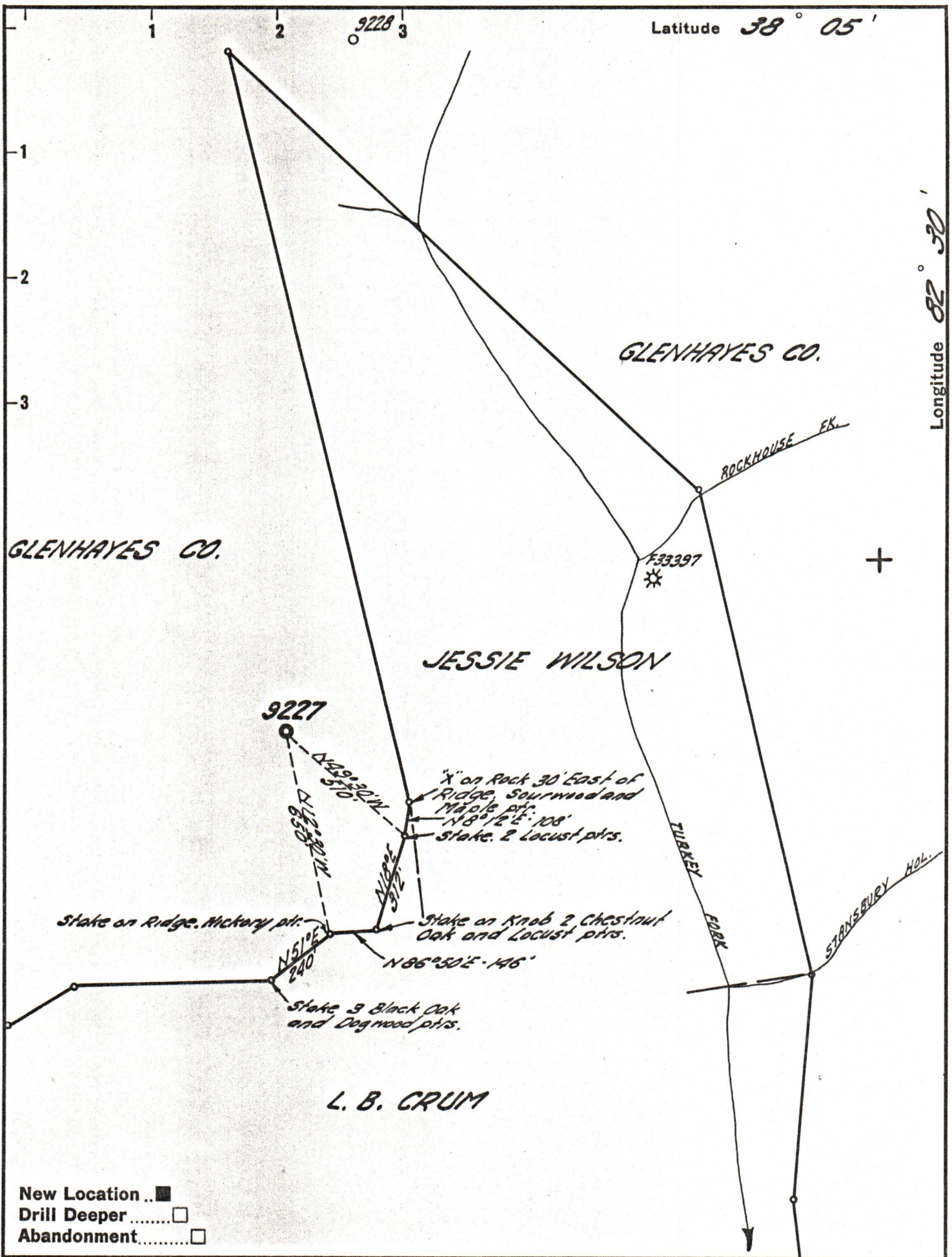

Company UNITED FUEL GAS CO.
 Address CHARLESTON, W. VA.
 Farm GLENHAYES CO.
 Tract _____ Acres 3518 Lease No. 53492
 Well (Farm) No. _____ Serial No. 9227
 Elevation (Spirit Level) 830.21'
 Quadrangle LOUISA
 County WAYNE District LINCOLN
 Engineer Seybert R. Ferrell
 Engineer's Registration No. 2529
 File No. 14-35 Drawing No. _____
 Date 8-22-62 Scale 1" = 400'

STATE OF WEST VIRGINIA
 DEPARTMENT OF MINES
 OIL AND GAS DIVISION
 CHARLESTON

WELL LOCATION MAP
 FILE NO. WAY-1443 10/27/2023

+ Denotes location of well on United States Topographic Maps, scale 1 to 62,500, latitude and longitude lines being represented by border lines as shown.

- Denotes one inch spaces on border line of original tracing.