



STATE OF WEST VIRGINIA
DEPARTMENT OF MINES
OIL AND GAS DIVISION

NOTICE OF PROPOSED LOCATION OF OIL AND GAS WELL

To The DEPARTMENT OF MINES,
Charleston, W. Va.

Piedmont Oil & Gas Co.
NAME OF WELL OPERATOR

WALTON, W. VA.
COMPLETE ADDRESS

Sept 21, 1962
PROPOSED LOCATION

LINCOLN District

WAYNE County

Well No. 1 38° 05'
82° 30' E 841.0

Hersel SALMONS Farm
130 acres

Hersel Salmon
OWNER OF MINERAL RIGHTS

Sart Loy, W. Va.
ADDRESS

GENTLEMEN:

The undersigned well operator is entitled to drill upon the above named farm or tract of land for oil and gas, having fee title thereto, (or as the case may be) under grant or lease dated Mar. 19 1962, made by Donald Ingle, to Kenneth Ingle & J. P. Purdy, and recorded on the 19 day of Mar. 1962, in the office of the County Clerk for said County in Book 10, page 230 and 227

The enclosed plat was prepared by a competent engineer and shows the proposed location of a well to be drilled for oil and gas by the undersigned well operator on the farm and in the Magisterial District and County above named, determined by survey and courses and distances from two permanent points, or land marks.

The undersigned well operator is informed and believes there are no coal operators operating beds of coal beneath said farm or tract of land on which said well is located, or within 500 feet of the boundaries of the same, who have mapped their workings and filed their maps as required by law, excepting the coal operators or coal owners (if any) above named as addressees.

The above named coal operators or coal owners (if any) are notified that any objections they may desire to make to such proposed location, or which they are required to make by Section 3 of said Code, if the drilling of a well at said proposed location will cause a dangerous condition in or about their respective coal mines, must be received by, or filed with the Department of Mines within ten* days from the receipt of a copy of this notice and accompanying plat by said Department. Said coal operators are further notified that forms for use in making such objections will be furnished to them by the Department of Mines promptly on request and that all such objections must set forth as definitely as is reasonably possible the ground or grounds on which such objections are based and indicate the direction and distance the proposed location should be moved to overcome same.

(The next paragraph is to be completed only in Department's copy.)

Copies of this notice and the enclosed plat were mailed by registered mail, or delivered to the above named coal operators or coal owners at their above shown respective address _____ day _____ before, or on the same day with the mailing or delivery of this copy to the Department of Mines at Charleston, West Virginia.

Very truly yours,

Piedmont Oil & Gas Co.
WELL OPERATOR
by - Roy S. Hancock, Supt.
STREET
Walton, West Va.
CITY OR TOWN
West Va.
STATE

Address of Well Operator }

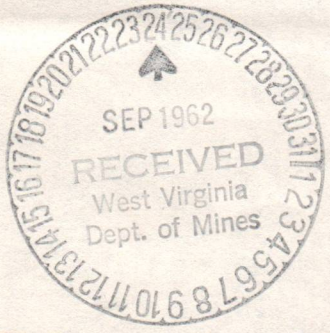

10/27/2023

*Section 3 If no such objections be filed or be found by the department of mines, within said period of ten days from the receipt of said notice and plat by the department of mines, to said proposed location, the department shall forthwith issue to the well operator a drilling permit reciting the filing of such plat, that no objections have been made by the coal operators to the location, or found thereto by the department, and that the same is approved and the well operator authorized to proceed to drill at said location.

1445

A-10



State of West Virginia
Department of Mines
Charleston 5

L. J. TIMMS
DIRECTOR

ELMER C. WORKMAN
DEPUTY DIRECTOR

September 24, 1962
"Centennial '63"

Piedmont Oil and Gas Company
Walton
West Virginia

Att: Mr. Roy S. Hancock
Superintendent

RE: Hersel Salmons Lease
Well No. 1, Lincoln
District, Wayne County.

Gentlemen:

Please send us the name and address of the owner of the mineral rights for the above described well location.

Please forward this data as soon as possible so your permit can be issued when due.

Very truly yours,

Marie E. Gypier
Assistant Director
OIL AND GAS DIVISION



*Mineral is owned by - Hersel Salmons
Ft. Gay, West Va.*

*Sincerely,
Roy Hancock*

10/27/2023



State of Massachusetts

Department of Conservation

Division of Fisheries and Wildlife

September 24, 1983
Concord, MA

Division of Fisheries and Wildlife
Department of Conservation

Division of Fisheries and Wildlife
Department of Conservation

William O. and G. E. Corbett
Union
West Virginia

Attn: Mr. E. Hancock
Superintendent

Re: Harold Belmont Lease
Well No. 14 Belmont
District, Wayne County

Dear Sir:

Please send us the name and address of the
owner of the mineral rights for the above described
well location.

Please forward this data as soon as possible
so your permit can be issued when due.

Assistant Director
Oil and Gas Division

WOM

A-11

October 4, 1962
"Centennial '63"

Mr. Roy S. Hancock, Superintendent
Piedmont Oil and Gas Company
Walton, West Virginia

Dear Mr. Hancock:

Enclosed is Permit WAY-1445 for drilling
Well No. 1 on Hersel Salmons Lease, Lincoln District,
Wayne County.

Please post one copy of permit at the well
site and send us two copies of the well record when
drilling is completed.

Please refer to directive regarding casing
of oil and gas wells sent you previously.

Yours very truly,

Executive Secretary
OIL AND GAS DIVISION

GW/sm

Enclosure

cc: Mr. Kenneth Butcher, Inspector

Mr. R. C. Tucker, Assistant
State Geologist

bc: Mr. C. E. Roberts, Deputy
Securities Commissioner

10/27/2023

B-1



STATE OF WEST VIRGINIA
DEPARTMENT OF MINES
OIL AND GAS DIVISION

Quadrangle Louisa
Permit No. Way-1445

WELL RECORD

Oil or Gas Well Gas
(KIND)

Company Piedmont Oil & Gas Co.
Address Walton, West Va.
Farm Hershel Salmons Acres 130
Location (waters) Turkeyfork of Lost Ck.
Well No. 1 Elev. 841
District Lincoln County Wayne
The surface of tract is owned in fee by Hershel Salmons
Address Ft. Gay, W. Va.
Mineral rights are owned by Hershel Salmon
Address _____

Casing and Tubing	Used in Drilling	Left in Well	Packers
Size			Kind of Packer
16			
13			
10	18'	18'	Size of
8 1/4	234' 8"	234' 8"	Gel behind pipe
6 5/8	1103	none	Depth set
5 3/16			
3 4 1/2"		1342'	Perf. top 1303
2			Perf. bottom 1300
Liners Used			Perf. top
			Perf. bottom

Drilling commenced Sept. 27, 1962
Drilling completed Oct. 24, 1962
Date Shot _____ From _____ To _____
With _____
Open Flow 6 /10ths Water in _____ Inch
_____/10ths Merc. in _____ Inch
Volume 26,000 nat. _____ Cu. Ft.
Rock Pressure _____ lbs. _____ hrs.
Oil _____ bbls., 1st 24 hrs.
WELL ACIDIZED _____

CASING CEMENTED 4 1/2 SIZE 240' No. Ft. 10/27/62 Date
cemented by Dowell

COAL WAS ENCOUNTERED AT 50' FEET 24" INCHES
____ FEET _____ INCHES _____ FEET _____ INCHES
____ FEET _____ INCHES _____ FEET _____ INCHES

WELL FRACTURED River Fract. 15750 gal water, 30,000 # sand
RESULT AFTER TREATMENT 1,300,000 4hrs. after fract. 24 hrs. after 1,510,000
ROCK PRESSURE AFTER TREATMENT 500# - 24 hrs.
Fresh Water _____ Feet _____ Salt Water _____ Feet _____

Formation	Color	Hard or Soft	Top	Bottom	Oil, Gas or Water	Depth	Remarks
Surface			0	19			
sand			19	40			
slate			40	50			
coal			50	52			
slate			52	100			
sand			100	140			
slate			140	220			
sand			220	250			
slate			250	305			
sand			305	380			
slate			380	440			
sand			440	502			
slate			502	642			
sand(salt)			642	907	salt water	650'	4 bailers p.hr.
slate			907	920			
sand			920	970			
Red rock			970	980			
sand			980	1000			
red rock			1000	1015			
slate			1015	1030			
Black lime			1030	1043			
slate			1043	1060			
little lime			1060	1084			
pinson c.			1084	1089			
big lime			1089	1280			
Injun sand			1280	1342	gas	1300 to 1312	

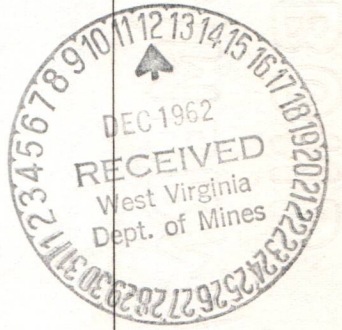

10/27/2023

B-2

OG-11

STATE OF WEST VIRGINIA
DEPARTMENT OF MINES
OIL AND GAS DIVISION



INSPECTOR'S WELL REPORT

Permit No. Way 1345

Oil or Gas Well _____
(KIND)

Company	Address	Farm	Well No.	District	County	Drilling commenced	Drilling completed	Date shot	Initial open flow	Open flow after tubing	Volume	Rock pressure	Oil	Fresh water	Salt water	CASING AND TUBING	USED IN DRILLING	LEFT IN WELL	PACKERS
																Size			Kind of Packer
<u>Adkins Oil Co</u>	<u>Huntington WVA</u>	<u>Jack Maynard</u>	<u>A3</u>	<u>Lincoln</u>	<u>Wayne</u>		<u>2657</u>									16			
																13			
																10	<u>30</u>		Size of
																8 1/4	<u>100</u>		
																6 5/8	<u>108B</u>		Depth set
																5 3/16			
																3			Perf. top
																2			Perf. bottom
																Liners Used			Perf. top
																			Perf. bottom

CASING CEMENTED _____ SIZE _____ No. FT. _____ Date _____

NAME OF SERVICE COMPANY _____

COAL WAS ENCOUNTERED AT _____ FEET _____ INCHES

_____ FEET _____ INCHES FEET _____ INCHES

_____ FEET _____ INCHES FEET _____ INCHES

Drillers' Names Ohler Adkins

Remarks: Cleaning out Bridge

2, 20-69
DATE

[Signature]
DISTRICT WELL INSPECTOR

10/27/2023

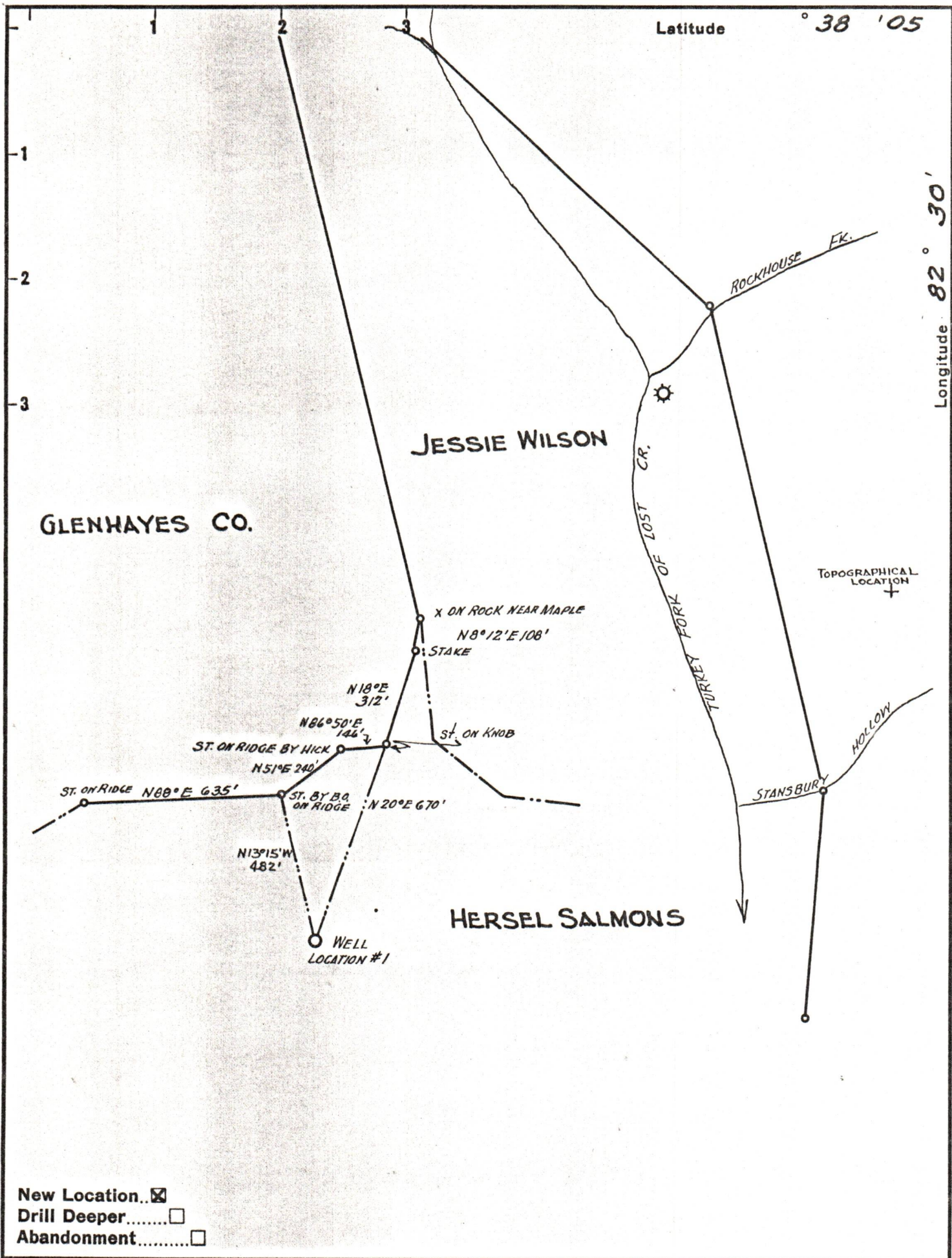

New Location..
 Drill Deeper.....
 Abandonment.....

Company PIEDMONT OIL & GAS CO.
 Address WALTON, W. VA.
 Farm HERSEL SALMONS
 Tract _____ Acres 130 Lease No. _____
 Well (Farm) No. 1 Serial No. _____
 Elevation (Spirit Level) 841.0
 Quadrangle LOUISA
 County WAYNE District LINCOLN
 Engineer Robert Wallace Jr.
 Engineer's Registration No. LOW CO. ENGR.
 File No. _____ Drawing No. 1962-40
 Date SEPT 8 1962 Scale 1" = 400'

STATE OF WEST VIRGINIA
 DEPARTMENT OF MINES
 OIL AND GAS DIVISION
 CHARLESTON

WELL LOCATION MAP
 FILE NO. WAY-1445

10/27/2023

+ Denotes location of well on United States Topographic Maps, scale 1 to 62,500, latitude and longitude lines being represented by border lines as shown.

- Denotes one inch spaces on border line of original tracing.