

FILE #:
DRAWING #: Bruce Thompson 1
SCALE: 1" = 1000'
MINIMUM DEGREE OF ACCURACY: 1 : 12,729
PROVEN SOURCE OF ELEVATION: Global Positioning System (GPS)

I THE UNDERSIGNED, HEREBY CERTIFY THAT THIS PLAT IS CORRECT TO THE BEST OF MY KNOWLEDGE AND BELIEF AND SHOWS ALL THE INFORMATION REQUIRED BY LAW AND THE REGULATIONS ISSUED AND PRESCRIBED BY THE DEPARTMENT OF ENVIROMENTAL PROTECTION.

Signed: *Don K. Cunningham*
R.P.E.: _____ L.L.S.: 701

PLACE SEAL HERE

(+) DENOTES LOCATION OF WELL ON UNITED STATES TOPOGRAPHIC MAPS
WVDEP
OFFICE OF OIL & GAS
601 57TH STREET
CHARLESTON, WV 25304



DATE: May 5, 2014
OPERATOR'S WELL #: Bruce Thompson 1
API WELL #: 47 099 02003 P
STATE COUNTY PERMIT

Well Type: Oil Waste Disposal Production Deep
 Gas Liquid Injection Storage Shallow

WATERSHED: Sycamore Branch of West Fork of Twelvepole Creek ELEVATION: 1,035.79'
COUNTY/DISTRICT: Wayne / Butler QUADRANGLE: Wayne
SURFACE OWNER: George Holland, et ux ACREAGE: 24
OIL & GAS ROYALTY OWNER: Bruce Conley Thompson, Jr., et al ACREAGE: 105
LEASE #: 47-10357 DRILL CONVERT DRILL DEEPER REDRILL FRACTURE OR STIMULATE
PLUG OFF OLD FORMATION PERFORATE NEW FORMATION PLUG & ABANDON
CLEAN OUT & REPLUG OTHER CHANGE (SPECIFY): _____
TARGET FORMATION: _____ ESTIMATED DEPTH: _____
WELL OPERATOR Cabot Oil & Gas Corp. DESIGNATED AGENT Whitney Johnson
Address Five Penn Center West, Suite 401 Address P.O. Box 450
City Pittsburgh State PA Zip Code 15276 City Glasgow State WV Zip Code 26033

08/29/2014

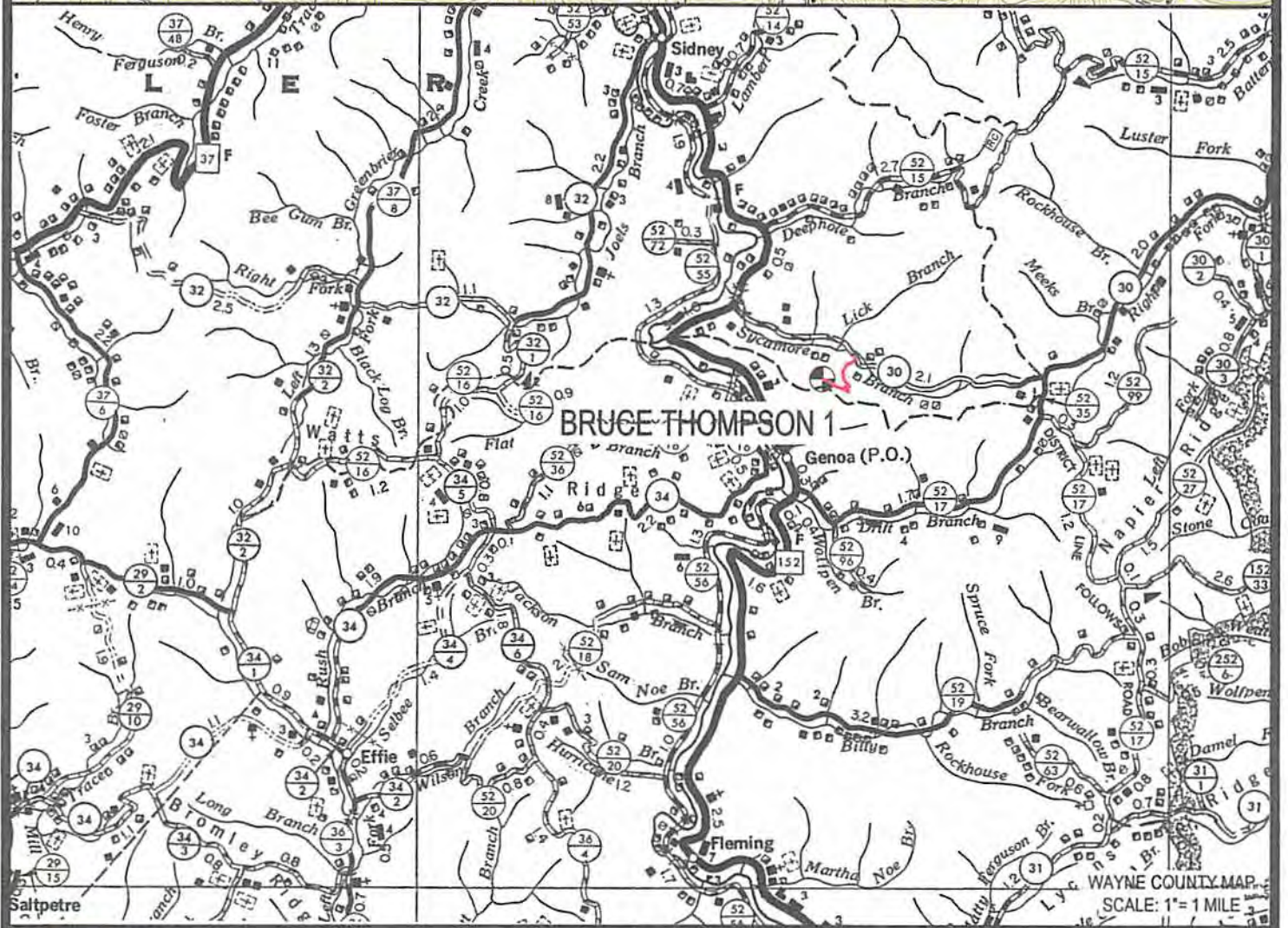
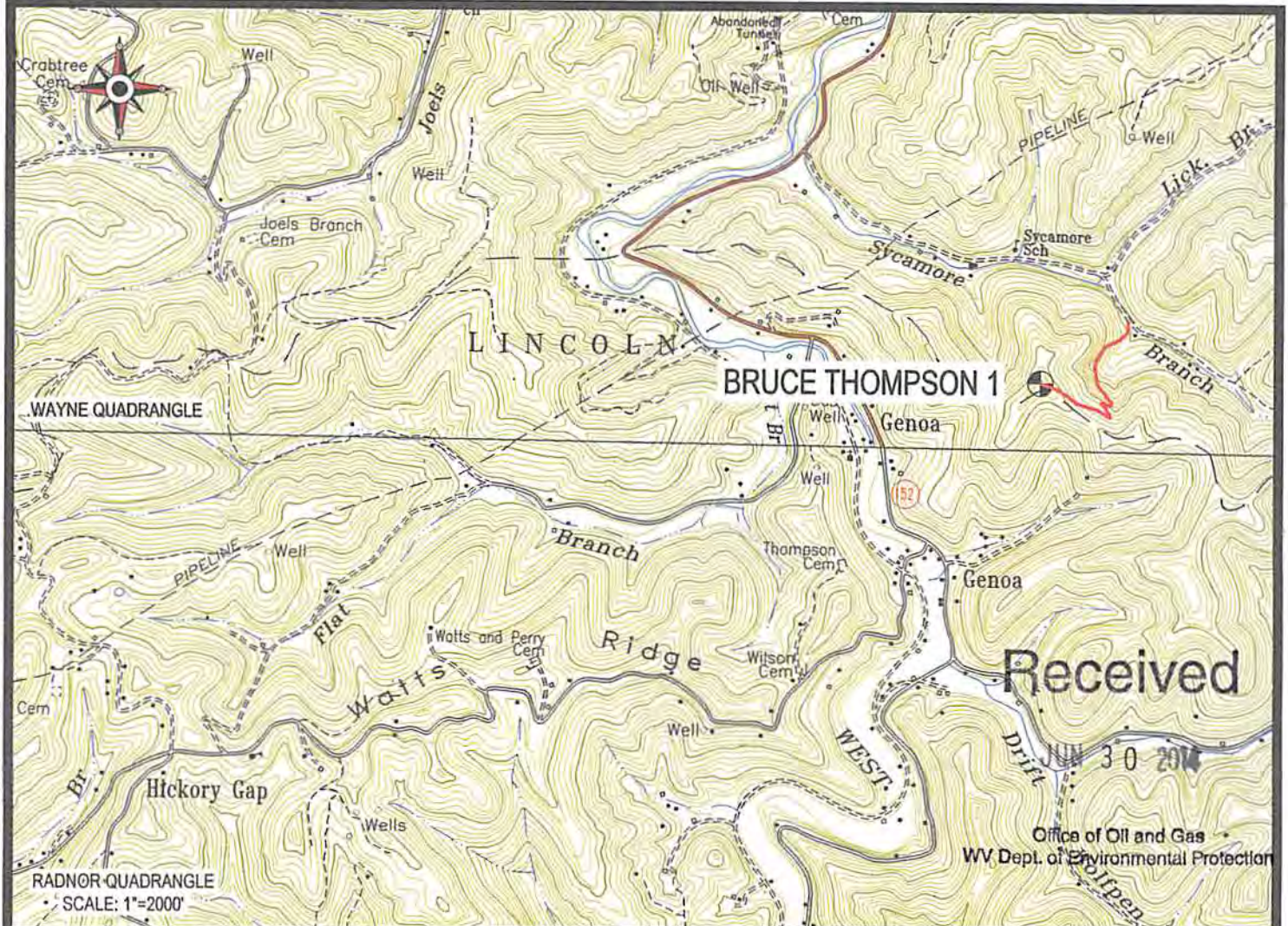

Cabot Oil & Gas Corporation



CUNNINGHAM
 LAND SURVEYING & MAPPING SERVICES, LLC
 5213 STEPHEN WAY
 CROSS LANES, WEST VIRGINIA 25313
 VOICE (304) 561-4129 FAX (304) 776-0703
 E-MAIL ADDRESS DKCUNNINGHAM@SUDDENLINK.NET

BRUCE THOMPSON 1
 LOCATION MAP

LOCATED ON THE WATERS OF SYCAMORE BRANCH
 OF THE WEST FORK OF TWELVEPOLE CREEK
 BUTLER DISTRICT, WAYNE COUNTY, WV
 WAYNE 7.5' QUADRANGLE

PROJECT NO. CABOT	DWG. BRUCE THOMPSON 1 LOC
DATE: 05-06-14	SCALE: AS NOTED
DRAWN BY: J. JONES	CHK'D BY: D.K.C.
FILE: C:\PROJECT FOLDER\CABOT	