

NOTICE OF PROPOSED LOCATION OF OIL AND GAS WELL
(REQUIRED BY SECTION 2, CHAPTER 36, ACTS 1929)
WEST VIRGINIA DEPARTMENT OF MINES
OIL AND GAS SECTION

To THE DEPARTMENT OF MINES,
Charleston, W. Va.

Geo. E. Rice

COAL OPERATOR OR COAL OWNER

Waynesburg, Pa.

ADDRESS

Samuel Meals

COAL OPERATOR OR COAL OWNER

c/o Carnegie Natural Gas Co.,
Frick Annex, Pittsburgh, Pa.

ADDRESS

COAL OPERATOR OR COAL OWNER

ADDRESS

The Manufacturers Light & Heat Company

NAME OF WELL OPERATOR

800 Union Trust Bldg., Pittsburgh, Pa.

COMPLETE ADDRESS

May 23rd, 1936

PROPOSED LOCATION

Proctor District

Wetzel County

Well No. 1 - 3528

Catherine Richmond Farm

82.42

GENTLEMEN:

The undersigned well operator is entitled to drill upon the above named farm or tract of land for oil and gas, having fee title thereto, (or as the case may be) under grant or lease dated.....

February 27th, 1931

, made by Catherine Richmond, single, to

The Manufacturers Light & Heat Company

, and recorded on the 12th day

of March, 1931, in the office of the County Clerk for said County in

Book 26-A, page 159

The enclosed plat was prepared by a competent engineer and shows the proposed location of a well to be drilled for oil and gas by the undersigned well operator on the farm and in the Magisterial District and County above named, determined by survey and courses and distances from two permanent points, or land marks.

The undersigned well operator is informed and believes there are no coal operators operating beds of coal beneath said farm or tract of land on which said well is located, or within 500 feet of the boundaries of the same, who have mapped their workings and filed their maps as required by law, excepting the coal operators or coal owners (if any) above named as addressees.

The above named coal operators or coal owners (if any) are notified that any objections they may desire to make to such proposed location, or which they are required to make by Section 3 of said Act, if the drilling of a well at said proposed location will cause a dangerous condition in or about their respective coal mines, must be received by, or filed with the Department of Mines within ten* days from the receipt of a copy of this notice and accompanying plat by said Department. Said coal operators are further notified that forms for use in making such objections will be furnished to them by the Department of Mines promptly on request and that all such objections must set forth as definitely as is reasonably possible the ground or grounds on which such objections are based and indicate the direction and distance the proposed location should be moved to overcome same.

(The next paragraph is to be completed only in Department's copy.)

Copies of this notice and the enclosed plat were mailed by registered mail, or delivered to the above

named coal operators or coal owners at their above shown respective address this.....day.... before, or on the same day with the mailing or delivery of this copy to the Department of Mines at Charleston, West Virginia.

Very truly yours, THE MANUFACTURERS LIGHT & HEAT COMPANY

Hary H. Fowler
WELL OPERATOR

Land Agent

800 Union Trust Bldg.,

STREET

Pittsburgh

CITY OR TOWN

09/29/2023

Pennsylvania

STATE

Address of Well Operator }



*Section 3 If no such objections be filed, or be found by the department of mines, within said period of ten days from the receipt of said notice and plat by the department of mines, to said proposed location, the department shall forthwith issue to the well operator a drilling permit reciting the filing of such plat, that no objections have been made by the coal operators to the location, or found thereto by the department, and that the same is approved and the well operator authorized to proceed to drill at said location.

NOTICE OF PROPOSED LOCATION OF OIL AND GAS WELL
 WEST VIRGINIA DEPARTMENT OF MINES
 OIL AND GAS SECTION

To The Department of Mines
 Charleston, W. Va.

Geo. E. Rice

COAL OPERATOR OR COAL OWNER

Waynesburg, Pa.

ADDRESS

Samuel Meale

COAL OPERATOR OR COAL OWNER

c/o Carnegie Natural Gas Co.,
 Brick Annex, Pittsburgh, Pa.

ADDRESS

COAL OPERATOR OR COAL OWNER

ADDRESS

NAME OF WELL OPERATOR

The Manufacturers Light & Heat Company

COMPLETE ADDRESS

800 Union Trust Bldg., Pittsburgh, Pa.

PROPOSED LOCATION

May 23rd, 1936

DISTRICT

District

Wetzel

County

Well No. 1 - 3523

Catherine Richmond Farm

DETAILS:

The undersigned well operator is entitled to drill upon the above named farm or tract of land for oil and gas having fee title thereto (or as the case may be) under grant or lease dated

February 27th, 1931 made by Catherine Richmond, single, to

The Manufacturers Light & Heat Company and recorded on the 12th day

March, 1931

in the office of the County Clerk for said County in

Book 26-A page 150

The enclosed plat was prepared by a competent engineer and shows the proposed location of a well to be drilled for oil and gas by the undersigned well operator on the farm and in the Wetzel District and County above named, determined by survey and courses and distances from two permanent points on land marked.

The undersigned well operator is informed and believes there are no coal operators operating upon adjacent farms or tract of land on which said well is located, or within 500 feet of the boundary of the same, who have mapped their workings and filed their maps as required by law, excepting the coal operators or coal owners (if any) above named as addressee.

The above named coal operators or coal owners (if any) are notified that any objections they may desire to make to such proposed location or which they are required to make by Section 3 of said Act, if the drilling of a well at said proposed location will cause a dangerous condition in or about their respective coal mines, must be received by, or filed with the Department of Mines within ten days from the receipt of a copy of this notice and accompanying plat by said Department. Said coal operators are further notified that forms for use in making such objections will be furnished to them by the Department of Mines promptly on request and that all such objections must set forth as definitely as is reasonably possible the ground or grounds on which such objections are based and indicate the direction and distance the proposed location should be moved to overcome same.

(The next paragraph is to be completed only in Department's copy.)
 Copies of this notice and the enclosed plat were mailed by registered mail or delivered to the above

named coal operators or coal owners at their above shown respective address this day before or on the same day with the mailing or delivery of this copy to the Department of Mines at Charleston, West Virginia.

Very truly yours, THE MANUFACTURERS LIGHT & HEAT COMPANY

WELL OPERATOR
 Land Agent

800 Union Trust Bldg.,

STREET

Pittsburgh

CITY OR TOWN

Pennsylvania

STATE

Address
 of
 Well Operator



09/29/1936

Section 3. If no such objections be filed or be found by the department of mines within said period of ten days from the receipt of said notice and plat by the department of mines, to said proposed location, the department shall forthwith issue to the well operator a drilling permit covering the full of such plat, that no objections have been made by the coal operators to the location or found therein by the department, and that the same is approved and the well operator authorized to proceed to drill at said location.

A-10

June 4, 1936

The Manufacturers Light & Heat Company
800 Union Trust Bldg.,
Pittsburgh, Pennsylvania

Gentlemen:

Permit Wet-121 to drill Well No. 1-3528
on the Catherine Richmond Farm, Proctor District,
Wetzel County, is enclosed.

Very truly yours,

Oil and Gas Division.

G/g
encl

copy to Inspector Courtney.

09/29/2023

B-1

N

Well abandoned
10/27/36

Wet-121-8

WEST VIRGINIA DEPARTMENT OF MINES

OIL AND GAS DIVISION

PRELIMINARY DATA SHEET NO. 1

File No. _____

Well No. 3528

The Manufacturers Light & Heat Company of 800 Union Trust Building,

Pittsburgh Pa. on the Catherine Richmond Farm

containing 82 acres. Location _____

Procter District, in Wetzel County, West Virginia

The surface of the above tract is owned in fee by Catherine Richmond

of Bebee, W. Va., address, and the mineral rights are owned by

The Manufacturers Light & Heat Company of Pittsburgh, Pa.,

The oil and gas privileges are held under lease by the above named company, and this well is drilled under permit

No. Wet-121 issued by the West Virginia Department of Mines, Oil and Gas Division

June 4th, 1936

Elevation of surface at top of well, 1018 feet Spirit Barometric.

The number of feet of the different sized casings used in the well.

16' feet 13 size. Wood conductor.

839'6" feet 10" size, csg. 1422'5" feet 8 1/4" sized csg.

2018'7" feet 6 5/8" size, csg. _____ feet _____ sized csg.

_____ feet _____ size, csg. _____ feet _____ sized csg.

_____ packer of _____ size, set at _____

_____ packer of _____ size, set at _____

_____, in casing perforated at _____ feet to _____ feet.

_____, in casing perforated at _____ feet to _____ feet.

Coal was encountered at 507 feet, thick ness 36 inches, and at 700

feet; thickness 48 inches; and at 795 feet; thickness 84 inches.

895 60

Liners were used as follows: (Give details) _____

This well is a dry hole and no casing or tubing was left in well.

November 20, 1936. Date.

Approved THE MANUFACTURERS LIGHT & HEAT COMPANY 09/29/2023

By _____ (TITLE) Land Department

7.



WEST VIRGINIA DEPARTMENT OF MINES

OF ANI GAS DIVISION

PRELIMINARY DATA SHEET NO. 1

3838

The Manufacturers Light & Heat Co. 800 Union Trust Building,

Pittsburgh Pa. Catherine Richmond

63

Proctor

Local

Catherine Richmond

Bobo, W. V.

Pittsburgh, Pa.

The Manufacturers Light & Heat Company

100-121

6

June 1936

1018 feet

13

16'

6 1/2"

10 1/2"

10'

330"

6 1/2"

300"

700

30

507

80

738

48

80

838

This well is a dry hole and no casing or tubing was left in well.

November 20, 1936.

09/29/2023

THE MANUFACTURERS LIGHT & HEAT COMPANY

Land Department

B-9

PROPOSED MANNER OF PLUGGING AND FILLING WELL

(REQUIRED BY RULES AND REGULATIONS)

WEST VIRGINIA DEPARTMENT OF MINES

OIL AND GAS DIVISION

WORK ORDER

Well to be plugged and filled as follows:

Total depth	3151'	
Fill with non-porus material	3151-2889	
Set Wood plug	2889-2886	
Cement	2886-2876	Sealing Gordon sand
Set permanent bridge using cement @	2470	
Fill with non-porus material	2470-2400	
Set wood plug	2400-2397	
Cement	2397-2387	Plugs.
Fill with non-porus material	2387-2040	20' above Injun sand, Pull 6 5/8" casing set @ 2073'
Set permanent bridge using cement	1930	20' below 3rd salt sand.
Fill with non-porus material	1930-1750	20' above 2nd salt sand.
Set wood plug	1750-1747	
Fill with non-porus material	1747-1585	20' above 1st salt sand
Set wood plug	1585-1582	
Cement	1582-1572	Sealing salt sands
Fill with clay	1572-1495	30' below Freeport Coal
Cement	1495-1440	Sealing Freeport Coal, Pull 8" casing set @ 1397'
Fill with clay	1440-930	30' below Pitts. Coal
Cement	930-875	Sealing Pitts. Coal
Fill with clay	875-832	30' below Mapletown coal, Pull 10" cas. Set @ 830'
Cement	832-775	Sealing PMapletown Coal
Fill with Clay	775-540	30' below Waynesburg coal
Cement	540-487	Sealing Waynesburg Coal
Fill with clay	487	to Surface

Erect monument as described in rules and regulations.

This order has been made out and Approved By D.G.Courtney, Clarksburg, W.Va.

NOTE BY THE DEPARTMENT OF MINES:

SET SUITABLE PLUGS ABOVE THE BIG INJUN SAND AT 2040'

To the Department of Mines,
Coal Owner or Operator,
Lease or Property Owner.

Gentlemen:

This "work order" is submitted for your approval and concurrence and unless notified of your disapproval or non-concurrence, the undersigned will proceed with the plugging and filling of said well in the above described manner on the date stated in the notice of intention to plug and abandon the said well on opposite side of this sheet.

Very truly yours,

Well Operator.

No objections have been filed by the coal owner or coal operator, or any available adjacent lease or property owners or interposed by the Department of Mines to the manner herein described for the plugging and filling of the well above mentioned. Therefore, the same is hereby approved this 25th day

of September, 1936

DEPARTMENT OF MINES
Oil and Gas Division

09/29/2023

By: _____

NOTE: This "work order" must be filed in duplicate, one copy for the files of the Department of Mines and the other to be approved or corrected and returned to the well operator as his authority for plugging said well.

B-8

121-8

FORM G-9

NOTICE OF INTENTION TO PLUG AND ABANDON WELL

(REQUIRED BY SECTION 9, ARTICLE 4, CHAPTER 22 OF THE CODE)

WEST VIRGINIA DEPARTMENT OF MINES

OIL AND GAS DIVISION

To THE DEPARTMENT OF MINES,
Charleston, W. Va.

George Rice and Sam Meals
COAL OPERATOR OR COAL OWNER

.....
ADDRESS

.....
COAL OPERATOR OR COAL OWNER

.....
ADDRESS

.....
LEASE OR PROPERTY OWNER

.....
ADDRESS

The Manufacturers Light & Heat Company
NAME OF WELL OPERATOR

800 Union Trust Building
Pittsburgh Pa.
COMPLETE ADDRESS

September 12th, 1936 19.....

WELL TO BE ABANDONED

Proctor District

Wetzel County

Well No. 3528

Catherine Richmond Farm

Gentlemen:—

The undersigned well operator is about to abandon the above described well and will commence the work of plugging and abandoning said well on the 15th day of September, 19 36, (which date shall not be less than five days after the day on which this notice so mailed is received, or in due course should be received by the Department of Mines).

This notice is given you in order that your respective representatives may be present at the plugging and filling of said well. You are further notified that whether you are represented or not represented the undersigned will proceed on that date, or shortly thereafter, to plug and fill said well in the manner required by Section 10, Article 4, Chapter 22 of the Code and given in detail on the reverse side of this notice, in "Work Order."

This notice is being mailed by registered mail to each of you at the above addresses on the above date.

Very truly yours,

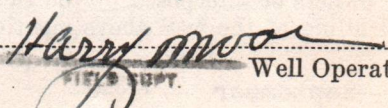
APPROVED

 Well Operator.

NOTE: Upon the abandonment of all wells drilled prior to June 1, 1929, a plat prepared by a competent engineer, showing the district and county in which the tract of land is located, the name and acreage of same, the names of the owners of adjacent tracts, and the location of the about to be abandoned well, determined by survey, and the courses and distances of such well from two permanent points or landmarks on said tract, shall be submitted with this notice.

09/29/2023

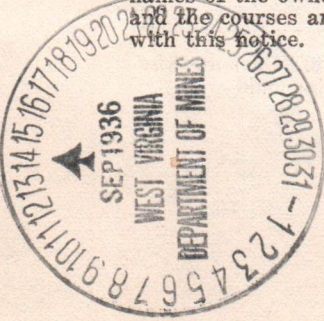
(Over)



B-10

FORM G-8

AFFIDAVIT IN TRIPLICATE TO TIME AND MANNER OF PLUGGING AND FILLING WELL

(REQUIRED BY SECTION 9, ARTICLE 4, CHAPTER 22 OF THE CODE)

WEST VIRGINIA DEPARTMENT OF MINES OIL AND GAS DIVISION

George Rice & Samuel Meals
 COAL OPERATOR OR OWNER
 Waynesburg, Pa.
 ADDRESS

Samuel Meals
 COAL OPERATOR OR OWNER
 % Carnegie Natural Gas Co.,
 ADDRESS
 10th Floor, Frick Bldg., Pittsburgh, Pa.
 LEASE OR PROPERTY OWNER
 ADDRESS

The Manufacturers Light & Heat
 NAME OF WELL OPERATOR
 800 Union Trust Building
 Pittsburgh Pa.
 COMPLETE ADDRESS

November 9th 1936 19...
 WELL AND LOCATION

Proctor District
 Wetzels County
 Well No. 3528
 Catherine Richmond Farm

AFFIDAVIT TO BE MADE IN TRIPLICATE, ONE COPY TO BE MAILED BY REGISTERED MAIL TO THE DEPARTMENT, ONE COPY TO BE RETAINED BY THE WELL OPERATOR AND THE THIRD COPY (AND EXTRA COPIES IF REQUIRED) TO BE MAILED TO EACH COAL OPERATOR ABOVE NAMED AT THEIR RESPECTIVE ADDRESSES.

AFFIDAVIT

STATE OF WEST VIRGINIA,
 COUNTY OF Wetzels } SS:

James A. Blair and Charles M. Burgess
 being first duly sworn according to law depose and say that they are experienced in the work of plugging and filling oil and gas wells and were employed by The Manufacturers Light & Heat Co., well operator, and participated in the work of plugging and filling the above well, that said work was commenced on the 5th day of October, 1936, and that the well was plugged and filled in the following manner:

Manner in which sand was plugged: Red mud 3151-2889, Wood plug 2889-2886, Cement 2886-2876
 Cement bridge 2470', Red mud 2470-2400, Wood plug 2400-2397, Cement 2397-2387, Red mud 2387-2040, Cement bridge @ 1930, Red mud 1930-1750, Wood plug 1750-1747, Red mud 1747-1585, Wood plug 1585-1582, Cement 1582-1572, Red mud 1572-1495, Cement 1495-1440, Red mud 1440-930.

Manner in which coal was plugged: Cement 930-875, Red mud 875-832, Cement 832-775, Red mud 775-540, Cement 540-487, Red mud 487 to surface.
 2nd Vent pipe extending from below Pitts, Coal to surface.

Description of monument: Monument erected as per Rule # 18.

(THE ABOVE DESCRIPTIONS MUST BE IN DETAIL AND IN ACCORDANCE WITH THE PROVISIONS OF SECTION 10, ARTICLE 4, CHAPTER 22 OF THE CODE)

and that the work of plugging and filling said well was completed on the 27 day of October, 1936.

And further deponents saith not.

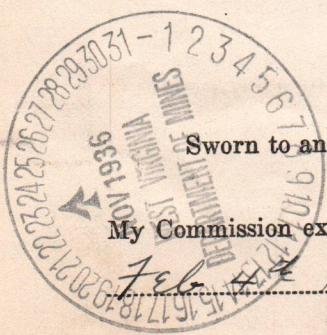

James A. Blair
 Charles M. Burgess
 Sworn to and subscribed before me this 17 day of November, 1936
 Notary Public.

09/29/2023

STATE OF VIRGINIA
DEPARTMENT OF MINES
ON THE 25th DAY OF

The undersigned, James A. ...
800 Union Street, ...
November 25th 1933

George Rice & Samuel ...

Samuel ...

George Rice & Samuel ...

10th floor, ...

Inspector

Hotel

Williams 3222

Catherine Richmond

AFFIDAVIT

STATE OF WEST VIRGINIA

Hotel

James A. ...

Charles E. ...

The undersigned, ...

October

25th

and the undersigned, ...

General

and the undersigned, ...

and the undersigned, ...

October

25

09/29/2023

PLAT OF THE PROPOSED LOCATION OF WELL NO3528 OF
 THE MANUFACTURERS LIGHT & HEAT CO , OF PITTSBURGH, P.A.
 ON THE CATHERINE RICHMOND FARM CONSISTING OF 82.4 ACRES
 LOCATED IN PROCTOR DISTRICT, WETZEL COUNTY, W. VA.
 COAL OWNED BY G. RICE & S. MEALS

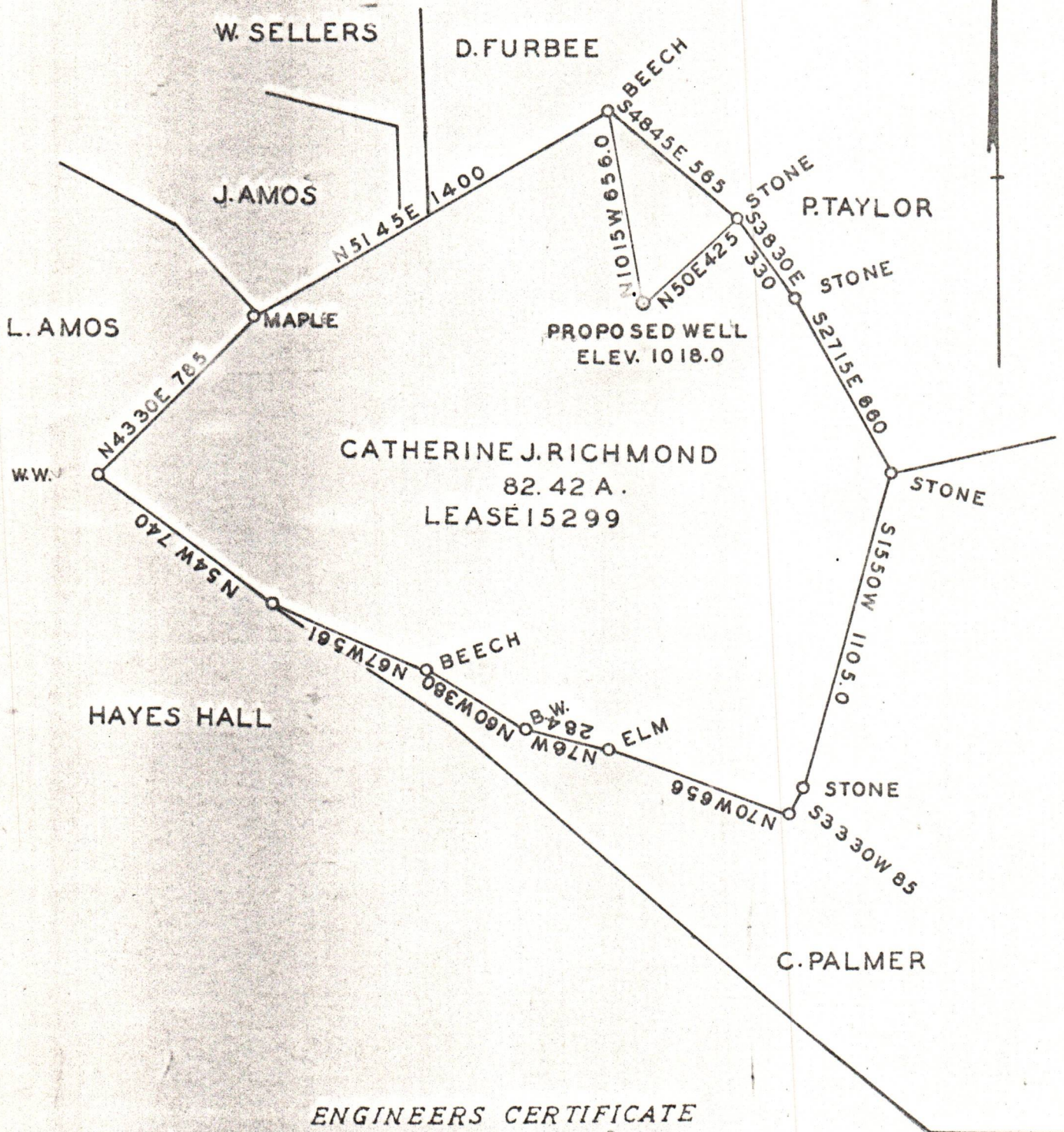

ENGINEERS CERTIFICATE

I, THE UNDERSIGNED, HEREBY CERTIFY THAT THIS MAP IS CORRECT AND SHOWS ALL THE INFORMATION TO THE BEST OF MY KNOWLEDGE AND BELIEF REQUIRED BY THE OIL AND GAS SECTION OF THE MINING LAWS OF WEST VIRGINIA.

09/29/2023
 Fred H. Saylor
 ENGINEER

WET - 121

The Manufacturers Light & Heat Company
 800 Union Trust Building,
 Pittsburgh Pa. Address

Well No. 3528

COMPLETION DATA SHEET
 No. 2
 FORMATION RECORD

Catherine Richmond farm

Name	Color	Character	Oil, Gas or Water	Top	Bottom	Thickness	Total Depth	Remarks
Clay		Soft		0				
Lime		Hard		14	14	14		
Red rock	Red	Soft		60	60	46		
Slate		Soft		90	90	30		
Sand		Hard		160	160	70		
Slate		Soft		185	185	25		
Lime		Hard		200	200	15		
Red rock	Red	Soft		230	230	30		
Lime		Hard		240	240	10		
Slate		Soft		320	320	80		
Gritty Lime		Hard		380	380	60		
Waynesburg Coal	Black	Soft		420	420	40		
Lime		Hard		480	480	60		
Red rock	Red	Soft		507	507	27		
Lime		Soft		510	510	3		
Gritty Lime		Soft		615	615	105		
Lime		Soft		630	630	15		
Coal		Soft		650	650	20		
Red rock	Black	Soft		675	675	25		
Lime	Red	Soft		700	700	25		
Mapletown coal	Black	Soft		704	704	4		
Lime		Hard		715	715	11		
Slate		Soft		795	795	80		
Pittsburgh Coal	Black	Hard		795	802	7		
Lime		Soft		802	830	28	78	
Sand		Hard		880	895	15		
Red rock	Red	Soft		895	900	5		
Lime		Soft		900	950	50		
Gritty Lime	Red	Soft		950	960	10		
Slate	Black	Hard		960	965	5		
Red rock	Red	Soft		965	1000	35		
Slate	S	Soft		1000	1050	50		
Red rock	Red	Soft		1050	1095	45		
Slate	Black	Soft		1095	1110	15		
Red rock	Red	Soft		1110	1175	65		
Lime		Hard		1175	1200	25		
Slate		Soft		1200	1210	10		
Lime		Hard		1210	1230	20		
Slate	Black	Soft		1230	1240	10		
Red rock	Red	Soft		1240	1285	45		
Lime		Hard		1285	1290	5		
Little Dunkard		Hard		1290	1305	15		
Slate		Soft		1305	1320	15		
Lime		Hard		1320	1325	5		
Slate	Black	Soft		1325	1335	10		
Dunkard	Black	Soft		1335	1385	50		
Lime		Hard		1385	1460	75		
Slate	Black	Soft		1460	1465	5		
Lime		Soft		1465	1475	10		
Slate		Hard		1475	1510	35		
Lime		Soft		1510	1555	45		
Slate		Hard		1555	1580	25		
Lime		Soft		1580	1605	25		
at sand		Hard	Water @ 1610	1605	1665	60		
Slate		Soft	1655	1665	1690	25		
Red rock		Hard		1690	1710	20		
Slate		Soft		1710	1770	60		
at sand		Hard		1770	1805	35		
Slate & shells		Hard		1805	1820	15		
at sand		Hard		1820	1900	80		

Well was not shot at _____ feet; well was shot at _____ feet.

Fresh water at _____ feet; salt fresh water at _____ feet.

Well was ~~producing~~ hole.
dry

THE MANUFACTURERS LIGHT & HEAT COMPANY

November 20, 1936.
Date

Approved _____ Owner
 Land Department

09/29/2023

NOTE: All bottom formations must be noted as indicated above and all key-rocks and oil and gas sands must be recorded under their proper geological names in the district as well as any local names commonly used in the district for such strata.

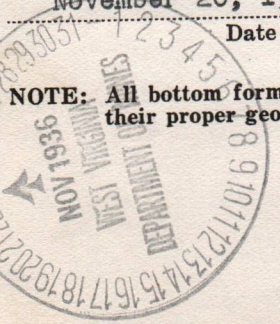

COMPLETION DATA SHEET
No. 2
FORMATION RECORD

The Manufacturers Light & Heat
Company
800 Union Trust Building
Pittsburgh Pa.
Address

Well No. 3222

Geological Record Form

Remarks	Total Depth	Thickness	Bottom	Top	Oil Gas or Water	Character	Color	Name
			14	0		Soft	Red	Clay
		14	60	14		Hard	Red	lime
		46	90	60		Soft	Red	red rock
		30	120	90		Soft	Red	slate
		30	150	120		Hard	Red	sand
		70	180	150		Hard	Red	slate
		25	205	180		Soft	Red	lime
		25	230	205		Hard	Red	red rock
		15	245	230		Soft	Red	lime
		30	275	245		Hard	Red	slate
		10	285	275		Soft	Red	lime
		30	315	285		Hard	Red	slate
		30	345	315		Soft	Red	lime
		40	385	345		Hard	Red	crystal lime
		30	415	385		Hard	Black	Waynesburg Coal
		30	445	415		Soft	Red	lime
		37	482	445		Soft	Red	red rock
		3	485	482		Soft	Red	lime
		105	590	485		Soft	Black	crystal lime
		15	605	590		Soft	Black	lime
		30	635	605		Soft	Black	red rock
		25	660	635		Soft	Black	lime
		4	664	660		Soft	Black	lime
		11	675	664		Soft	Black	Waynesburg coal
		30	705	675		Hard	Black	lime
		7	712	705		Hard	Black	slate
		78	790	712		Soft	Black	Waynesburg Coal
		15	805	790		Hard	Black	lime
		5	810	805		Soft	Black	lime
		30	840	810		Soft	Red	red rock
		10	850	840		Soft	Black	lime
		15	865	850		Hard	Black	crystal lime
		35	900	865		Hard	Black	lime
		30	930	900		Soft	Red	red rock
		45	975	930		Soft	Black	lime
		15	990	975		Soft	Black	lime
		65	1055	990		Soft	Black	red rock
		25	1080	1055		Soft	Black	lime
		10	1090	1080		Soft	Black	lime
		10	1100	1090		Soft	Black	lime
		10	1110	1100		Soft	Black	lime
		10	1120	1110		Soft	Black	lime
		10	1130	1120		Soft	Black	lime
		10	1140	1130		Soft	Black	lime
		10	1150	1140		Soft	Black	lime
		10	1160	1150		Soft	Black	lime
		10	1170	1160		Soft	Black	lime
		10	1180	1170		Soft	Black	lime
		10	1190	1180		Soft	Black	lime
		10	1200	1190		Soft	Black	lime
		10	1210	1200		Soft	Black	lime
		10	1220	1210		Soft	Black	lime
		10	1230	1220		Soft	Black	lime
		10	1240	1230		Soft	Black	lime
		10	1250	1240		Soft	Black	lime
		10	1260	1250		Soft	Black	lime
		10	1270	1260		Soft	Black	lime
		10	1280	1270		Soft	Black	lime
		10	1290	1280		Soft	Black	lime
		10	1300	1290		Soft	Black	lime
		10	1310	1300		Soft	Black	lime
		10	1320	1310		Soft	Black	lime
		10	1330	1320		Soft	Black	lime
		10	1340	1330		Soft	Black	lime
		10	1350	1340		Soft	Black	lime
		10	1360	1350		Soft	Black	lime
		10	1370	1360		Soft	Black	lime
		10	1380	1370		Soft	Black	lime
		10	1390	1380		Soft	Black	lime
		10	1400	1390		Soft	Black	lime
		10	1410	1400		Soft	Black	lime
		10	1420	1410		Soft	Black	lime
		10	1430	1420		Soft	Black	lime
		10	1440	1430		Soft	Black	lime
		10	1450	1440		Soft	Black	lime
		10	1460	1450		Soft	Black	lime
		10	1470	1460		Soft	Black	lime
		10	1480	1470		Soft	Black	lime
		10	1490	1480		Soft	Black	lime
		10	1500	1490		Soft	Black	lime
		10	1510	1500		Soft	Black	lime
		10	1520	1510		Soft	Black	lime
		10	1530	1520		Soft	Black	lime
		10	1540	1530		Soft	Black	lime
		10	1550	1540		Soft	Black	lime
		10	1560	1550		Soft	Black	lime
		10	1570	1560		Soft	Black	lime
		10	1580	1570		Soft	Black	lime
		10	1590	1580		Soft	Black	lime
		10	1600	1590		Soft	Black	lime
		10	1610	1600		Soft	Black	lime
		10	1620	1610		Soft	Black	lime
		10	1630	1620		Soft	Black	lime
		10	1640	1630		Soft	Black	lime
		10	1650	1640		Soft	Black	lime
		10	1660	1650		Soft	Black	lime
		10	1670	1660		Soft	Black	lime
		10	1680	1670		Soft	Black	lime
		10	1690	1680		Soft	Black	lime
		10	1700	1690		Soft	Black	lime
		10	1710	1700		Soft	Black	lime
		10	1720	1710		Soft	Black	lime
		10	1730	1720		Soft	Black	lime
		10	1740	1730		Soft	Black	lime
		10	1750	1740		Soft	Black	lime
		10	1760	1750		Soft	Black	lime
		10	1770	1760		Soft	Black	lime
		10	1780	1770		Soft	Black	lime
		10	1790	1780		Soft	Black	lime
		10	1800	1790		Soft	Black	lime

Well was not shot at _____ feet; well was shot at _____ feet.
 Fresh water at _____ feet; lean water at _____ feet.
 Salt _____ feet.

Well was _____ hole.
 dry
 Approved _____
 Date 09/29/2023
 Owner Land Department

NOTE: All bottom formations must be noted as indicated above and all key-rocks and oil and gas sands must be recorded under their proper geological names in the district as well as any local names commonly used in the district for such strata.

B-3

121

SHEET # 2

.....Company
.....Address
Well No.....

COMPLETION DATA SHEET
No. 2
FORMATION RECORD

Name	Color	Character	Oil, Gas or Water	Top	Bottom	Thickness	Total Depth	Remarks
Slate		Soft		1900	1925	25		
Lime		Hard		1925	1965	40		
Maxon sand		Hard		1965	2020	55		
Lime		Hard		2020	2025	5		
Pencil Cave		Soft		2025	2035	10		
Lime (Big)		Hard		2035	2040	5		
Slate				2040	2042	2		
Big lime		Hard		2042	2060	18		
Big Injun sand		Hard		2060	2270	210		
Slate				2270	2272	2		
Squaw sand		Hard		2272	2300	28		
Slate				2300	2350	50		
Lime shells				2350	2420	70		
Berea sand				2420	2440	20		
Slate & shells				2440	2470	30		
Slate				2470	2480	10		
Lime shells				2480	2575	95		
Slate		Soft		2575	2690	115		
Pink rock	Pink							
Lime shells		Hard		2690	2710	20		
Slate		Soft		2710	2750	40		
Pink Rock	Pink	Soft		2750	2765	15		
Slate & shells				2765	2909	144		
Gordon sand		Hard		2909	2915	6		
Slate				2915	2973	58		
4th sand				2973	2975	2		
Slate				2975	3060	85		
Lime shells		Soft		3060	3062	2		
Slate				3062	3151	89		
							3151	

Well was not shot at.....feet; well was shot at.....feet.
Salt
Fresh water at.....1610.....feet; salt
fresh water at.....1655.....feet.

Well was ~~producing~~ Dry hole.

THE MANUFACTURERS LIGHT & HEAT COMPANY,

November 20, 1936.
Date

Approved.....
Owner Land Department

NOTE: All bottom formations must be noted as indicated above and all key-rocks and oil and gas sands must be recorded under their proper geological names in the district as well as any local names commonly used in the district for such strata.

Copied for...

COMPLETION DATA SHEET
No. 2
FORMATION RECORD

Company: _____
Address: _____
Well No: _____

Remarks	Total Depth	Thickness	Bottom	Top	Oil Gas or Water	Character	Color	Name
		25	1825	1800		Soft		Lime
		40	1865	1825		Hard		Lime
		55	1920	1865		Hard		Carbon sand
		5	1925	1920		Hard		Lime
		10	1935	1925		Soft		Penell Gave
		5	1940	1935		Hard		Lime (thin)
		2	1942	1940				Glate
		25 18	1967	1942		Hard		Big lime
		210	2177	1967		Hard		Big lagoon sand
		2	2179	2177				Glate
		28	2207	2179		Hard		Green sand
		80	2287	2207				Glate
		70	2357	2287				Lime shells
		20	2377	2357				Carbon sand
		30	2407	2377				Glate & shells
		10	2417	2407				Glate
		35	2452	2417				Lime shells
		115	2567	2452		Soft		Glate
		30	2597	2567		Hard	tanish	Carbon sand
		40	2637	2597		Soft		Lime shells
		15	2652	2637		Soft	Pink	Glate
		145	2797	2652				Glate & shells
		6	2803	2797		Hard		Carbon sand
		55	2858	2803				Glate
		2	2860	2858				Light sand
		55	2915	2860				Glate
		2	2917	2915				Lime shells
		85	3002	2917				Glate
		2	3004	3002				Lime shells
		85	3089	3004				Glate

2191

Well was not shot at _____ feet; well was shot at _____ feet.
 Fresh water at _____ feet; fresh water at _____ feet.
 Well was _____ hole.
 Approved _____
 Owner _____
 THE MANUFACTURING LIGHT & HEAT COMPANY
 November 20, 1958
 09/29/2023
 NOTE: All bottom formations must be noted as indicated above and all key rocks and oil and gas sands must be recorded under their proper geological names in the district as well as any local names commonly used in the district for such strata.