

NOTICE OF PROPOSED LOCATION OF OIL AND GAS WELL

(REQUIRED BY SECTION 2, CHAPTER 86, ACTS 1929)

WEST VIRGINIA DEPARTMENT OF MINES OIL AND GAS SECTION

To THE DEPARTMENT OF MINES, Charleston, W. Va.

Daisy B. Patterson

COAL OPERATOR OR COAL OWNER

P. O. Box 265, Moundsville, W. Va.

ADDRESS

COAL OPERATOR OR COAL OWNER

ADDRESS

OWNER OF MINERAL RIGHTS

ADDRESS

THE MANUFACTURERS LIGHT & HEAT COMPANY

NAME OF WELL OPERATOR

800 Union Trust Bldg., Pittsburgh, Pa.

COMPLETE ADDRESS

September 29th, 1936

PROPOSED LOCATION

Proctor District

Wetzel County

Well No. 1 - 3533 39° 45' 8.0° 40' 115 acres

E. F. Kelley Farm

GENTLEMEN:

The undersigned well operator is entitled to drill upon the above named farm or tract of land for oil and gas, having fee title thereto, (or as the case may be) under grant or lease dated January 23rd, 1934, made by E. F. Kelley, et al., to The Manufacturers Light & Heat Company, and recorded on the 2nd day of May, 1934, in the office of the County Clerk for said County in

O&G Book 29 A, page 117

The enclosed plat was prepared by a competent engineer and shows the proposed location of a well to be drilled for oil and gas by the undersigned well operator on the farm and in the Magisterial District and County above named, determined by survey and courses and distances from two permanent points, or land marks.

The undersigned well operator is informed and believes there are no coal operators operating beds of coal beneath said farm or tract of land on which said well is located, or within 500 feet of the boundaries of the same, who have mapped their workings and filed their maps as required by law, excepting the coal operators or coal owners (if any) above named as addressees.

The above named coal operators or coal owners (if any) are notified that any objections they may desire to make to such proposed location, or which they are required to make by Section 3 of said Act, if the drilling of a well at said proposed location will cause a dangerous condition in or about their respective coal mines, must be received by, or filed with the Department of Mines within ten\* days from the receipt of a copy of this notice and accompanying plat by said Department. Said coal operators are further notified that forms for use in making such objections will be furnished to them by the Department of Mines promptly on request and that all such objections must set forth as definitely as is reasonably possible the ground or grounds on which such objections are based and indicate the direction and distance the proposed location should be moved to overcome same.

(The next paragraph is to be completed only in Department's copy.)

Copies of this notice and the enclosed plat were mailed by registered mail, or delivered to the above

named coal operators or coal owners at their above shown respective address this day before, or on the same day with the mailing or delivery of this copy to the Department of Mines at Charleston, West Virginia.

Very truly yours, THE MANUFACTURERS LIGHT & HEAT COMPANY

[Signature] Land Dept.

WELL OPERATOR

800 Union Trust Bldg.,

STREET

Pittsburgh

CITY OR TOWN

Pennsylvania.

STATE

09/29/2023

Address of Well Operator }

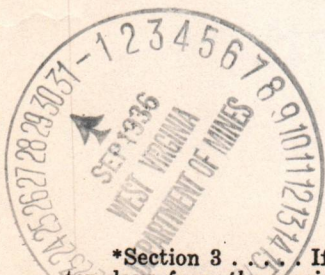

\*Section 3. If no such objections be filed, or be found by the department of mines, within said period of ten days from the receipt of said notice and plat by the department of mines, to said proposed location, the department shall forthwith issue to the well operator a drilling permit reciting the filing of such plat, that no objections have been made by the coal operators to the location, or found thereto by the department, and that the same is approved and the well operator authorized to proceed to drill at said location.

NOTICE OF PROPOSED LOCATION OF OIL AND GAS WELL  
WEST-VIRGINIA DEPARTMENT OF MINES  
AND RECLAMATION

THE MANUFACTURING LIGHT & HEAT COMPANY

John A. Patterson

500 Union Trust Bldg., Pittsburgh, Pa.

P. O. Box 205, Connsville, W. Va.

September 29th, 1931

PROPOSED LOCATION

Section 1

West

1 - 3333

J. F. Kelley

The undersigned will operate a well in the above named tract of land...

in and for having the title thereto (under the laws now in force)...

January 29th, 1931

The Manufacturing Light & Heat Company

in the office of the County Clerk for said County in

500 Union Trust Bldg., Pittsburgh, Pa.

The undersigned has been provided by a competent surveyor and shows the proposed location of a well...

The undersigned will operate a well in the above named tract of land...

The above named well operator on each of the (1) lots is notified that any objections they may...

have to make to such proposed location, or within they are required to cause by return of said lot...

the filing of a well in said proposed location will cause a permanent condition in or upon the respective...

lots of the tract and the same shall be returned to the Department of Mines and Reclamation...

of the same and the enclosed files were mailed by registered mail, or delivered to the above...

named well operator or coal owners at their above shown respective address. This day before...

me in the presence of the undersigned, J. F. Kelley, County Clerk for said County in...

500 Union Trust Bldg., Pittsburgh, Pa.

West Virginia

Section 1

West

1 - 3333

J. F. Kelley

09/29/2023

A-10

October 10, 1936

The Manufacturers Light & Heat Company  
800 Union Trust Building  
Pittsburgh, Pennsylvania

Gentlemen:

Permit Wet-134 to drill Well No. 1-3533  
on the E. F. Kelley Farm, Proctor District, Wetzel  
County, is enclosed.

Please send us a complete record of the  
well as soon as it is completed. Blanks are enclosed.

Very truly yours,

OIL AND GAS DIVISION.

MG:g  
encl

copy to Inspector Courtney.  
lat 39d-45'  
long 80d-40'

09/29/2023

WELL RECORD

CO.

Well No. ....

Farm. ....

District. ....

County. ....

State. ....

Owned by. ....

Division. ....

Date. .... 19 .....

Entered W. R. Book Folio. ....

By. ....

09/29/2023

The Manufacturers Light & Heat Co

134

B-1

Company

Division 4

Record of Well No. **3533** on **E.F. Kelley** Farm **115** Acres  
**Proctor** Field **Proctor** District **Wetzel** County **W.Va.** State

Rig Commenced 19 , Completed 19

Drilling Commenced 19 , Completed 19

Cost per Foot Contractor **Rawe, Bro,s** Address **New Martinsville, West Va.**

Drillers' Names

BOILER

ENGINE

RIG

H.P.	No.	Name of Maker	H. P.	No.	Name of Maker	New	Old	Height	Name of Boiler
------	-----	---------------	-------	-----	---------------	-----	-----	--------	----------------

CONDUCTOR AND CASING USED IN DRILLING

Conductor	13 inch	10 inch	8 1/4 inch	6 3/4 inch	6 1/4 inch	5 3/4 inch	5 1/2 inch	5 inch	4 inch
3x16"		415-5"	1592-1"	2211-8"					

CONDUCTOR AND CASING LEFT IN WELL

Conductor	13 inch	10 inch	8 1/4 inch	6 3/4 inch	6 1/4 inch	5 3/4 inch	5 1/2 inch	5 inch	4 inch	3 inch
-----------	---------	---------	------------	------------	------------	------------	------------	--------	--------	--------

OIL WELL

GAS WELL

When Shot	Size of Torepdo	1st Day's Production	Tubing	Rods	Tanks	Size of Packer	Depth Set	Packed with	1st Minute Pressure	Rock Pressure
-----------	-----------------	----------------------	--------	------	-------	----------------	-----------	-------------	---------------------	---------------

Initial Open Flow Production      Cubic Feet Per 24 Hours      Shut in Pressure      Cubic Feet Per 24 Hours

FORMATION

Top      Bottom      Thickness

REMARKS

Red Rock	0	200	200	
Sand	200	220	20	Water at 200' 4 Bailer per Hour
Slate	220	250	30	
Red Rock	250	275	25	
Slate	275	300	25	
Red Rock	300	470	170	415' - 10"
Slate	470	540	70	
Slate Dark	540	735	195	
Red Rock	735	745	10	
Slate	745	780	35	
Show of Coal	780			
Slate	780	790	10	
Lime	790	815	25	
Slate	815	825	10	
Lime	825	984	159	
Slate	984	992	8	
Mapletown Coal	992	993	1	
Lime	993	1035	42	
Slate	1035	1074	39	
Lime	1074	1080	6	
Slate	1080	1091	11	
Pgh. Coal	1091	1096	5	
Lime	1096	1106	10	
Slate	1106	1123	17	
Sand	1123	1140	17	Show of water 1128
Red Rock	1140	1155	15	
Lime	1155	1163	8	
Slate	1163	1200	37	

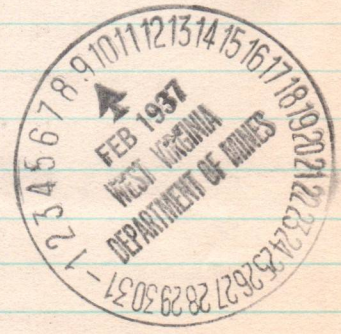

09/29/2023

Examined above information and measurements and found to be correct by Rawe Bros Contractor  
 Examined and approved by Harry Moore Superintendent of Co.  
 NOT: The above blank must be filled out carefully by the contractor, with a complete and accurate record of the Well, and accompany, when presented for payment of the bill for drilling.  
 All formations and known sands must be given by their proper name, with steel line measurements, and under the head of "Remarks" must be recorded in what sand and at what depth Oil, Gas or Water was found, the quantity of same, the quality of the sand, and thickness of pay.  
 Make no memoranda of boiler and engine if owned by contractor.

134

The Manufacturers Light & Heat Co  
Company

Division.....

Record of Well No. **3533** on **E.F. Kelley** Farm **116** Acres  
**Proctor** Field **Proctor** District **Wetzel** County **W.Va.** State

Rig Commenced 19 , Completed 19

Drilling Commenced **Dec. 16. 1936** 19 , Completed **February 3rd. 19 37**

Cost per Foot Contractor **Rave, Bro.s** Address **New Martinsville, West Va.**

Drillers' Names

BOILER			ENGINE			RIG			
H.P.	No.	Name of Maker	H. P.	No.	Name of Maker	New	Old	Height	Name of Boiler

CONDUCTOR AND CASING USED IN DRILLING									
Conductor	13 inch	10 inch	8 1/4 inch	6 5/8 inch	6 1/4 inch	5 3/8 inch	5 1/2 inch	5 inch	4 inch
<b>13x16'</b>		<b>415'-5"</b>	<b>1592'-4"</b>	<b>2211'-8"</b>					

CONDUCTOR AND CASING LEFT IN WELL										
Conductor	13 inch	10 inch	8 1/4 inch	6 5/8 inch	6 1/4 inch	5 3/8 inch	5 1/2 inch	5 inch	4 inch	3 inch

OIL WELL					GAS WELL					
When Shot	Size of Torepdo	1st Day's Production	Tubing	Rods	Tanks	Size of Packer	Depth Set	Packed with	1st Minute Pressure	Rock Pressure

Initial Open Flow Production      Cubic Feet Per 24 Hours      Shut in Pressure      Cubic Feet Per 24 Hours

FORMATION	Top	Bottom	Thickness	REMARKS
Sand	1200	1241	41	
Gas Sand-	1205	1210		Small Show of gas
Slate	1241	1272	31	
Red Rock	1272	1285	13	
Lime	1285	1295	10	
Red R ck	1295	1318	23	
Slate	1318	1365	47	
Red Rock	1365	1423	58	
Slate	1423	1445	22	
Sand	1445	1476	21	
Slate	1476	1487	11	
Lime	1487	1516	29	
Slate	1516	1570	54	
Red Rock	1570	1582	12	
Dunkard Sand	1582	1597	15	
Slate	1597	1655	58	Show of Coal at 1640
Gas Sand	1655	1694	39	Show of Coal at 1694
Slate	1694	1745	41	
Lime	1745	1762	17	
Slate	1762	1785	23	
Lime	1785	1795	10	
1st. Salt Sand	1795	1850	55	Water 1829 to 1842 Fresh 400
Slate	1850	1898	48	
2nd. Salt Sand	1898	1944	46	
Slate	1944	1961	17	
Lime	1961	1975	14	
Slate	1975	2015	40	
Lime	2015	2024	9	

WET-134

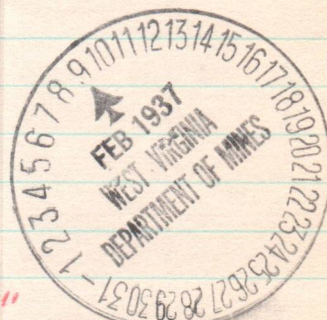

1592'-8 1/4"

09/29/2023

Examined above information and measurements and found to be correct by *Jesse Proctor* Contractor  
 Examined and approved by *Harry Moore* Superintendent of Co.  
 NOTE—The above blank must be filled out carefully by the contractor, with a complete and accurate record of the Well, and accompany, when presented for payment of the bill for drilling.  
 All formations and known sands must be given by their proper name, with steel line measurements, and under the head of "Remarks" must be recorded in what sand and at what depth Oil, Gas or Water was found, the quantity of same, the quality of the sand, and thickness of pay.  
 Make no memoranda of boiler and engine if owned by contractor.

WELL RECORD

CO.

Well No. ....

Farm .....

District .....

County .....

State .....

Owned by .....

Division .....

Date .....

Entered W. R. Book Folio .....

By .....

09/29/2023

134

The Manufacturers Light & Heat CO  
Company

Division.....4.....

Record of Well No. 3533

on E.F. Kelley

Farm 115

Acres

Proctor Field Proctor

District  
Township Wetzel

County W.Va.

State

Rig Commenced 19 , Completed 19

Drilling Commenced 19 , Completed 19

Cost per Foot Contractor Address

Drillers' Names

BOILER

ENGINE

RIG

H.P.	No.	Name of Maker	H. P.	No.	Name of Maker	New	Old	Height	Name of Boiler
------	-----	---------------	-------	-----	---------------	-----	-----	--------	----------------

CONDUCTOR AND CASING USED IN DRILLING

Conductor	13 inch	10 inch	8 1/4 inch	6 3/8 inch	6 1/4 inch	5 3/8 inch	5 3/8 inch	5 inch	4 inch
13x16'	4	415'5"	1592'	2211.8"					

CONDUCTOR AND CASING LEFT IN WELL

Conductor	13 inch	10 inch	8 1/4 inch	6 3/8 inch	6 1/4 inch	5 3/8 inch	5 3/8 inch	5 inch	4 inch	3 inch
-----------	---------	---------	------------	------------	------------	------------	------------	--------	--------	--------

OIL WELL

GAS WELL

When Shot	Size of Torepdo	1st Day's Production	Tubing	Rods	Tanks	Size of Packer	Depth Set	Packed with	1st Minute Pressure	Rock Pressure
-----------	-----------------	----------------------	--------	------	-------	----------------	-----------	-------------	---------------------	---------------

Initial Open Flow Production      Cubic Feet Per 24 Hours      Shut in Pressure      Cubic Feet Per 24 Hours

FORMATION

Top      Bottom      Thickness

REMARKS

Slate	2024	2042	18	
3rd, Salt Sand	2042	2075	33	
Slate	2075	2106	31	
Lime	2106	2110	4	
Maxon Sand	2110	2128	18	
Slate	2128	2133	5	
Lime	2133	2145	12	
Slate	2145	2153	9	
Lime	2153	2165	12	
Pencil Cave	2165	2176	11	
Big Lime	2176	2234	58	2211' - 6 5/8"
Big Injun Sand	2234	2504	270	Slate 2454 to 2462' Brake in Sand
Slate	2504	2550	46	
Lime	2550	2565	15	
Slate	2565	2595	30	
Lime	2595	2618	23	
Slate	2618	2637	19	
Berea Sand	2637	2676	39	
Slate & Shells	2676	2838	162	
50' Sand	2838	2845	7	
Lime	2845	2863	18	
Slate & Shells	2863	2930	67	
Red Rock	2930	2955	25	
Lime	2955	2985	30	
Red Rock	2985	2995	10	
Slate & Shells	2995	3045	50	
Lime Shells	3045	3051	5	
Slate	3051	3065	14	

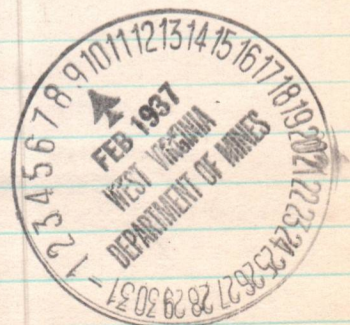

09/29/2023

Examined above information and measurements and found to be correct by Paul M. S. Contractor  
Examined and approved by Harry M. O. Superintendent of Co.

NOTE - The above blank must be filled out carefully by the contractor, with a complete and accurate record of the Well, and accompany, when presented for payment of the bill for drilling.  
All formations and known sands must be given by their proper name, with steel line measurements, and under the head of "Remarks" must be recorded in what sand and at what depth Oil, Gas or Water was found, the quantity of same, the quality of the sand, and thickness of pay.  
Make no memoranda of boiler and engine if owned by contractor.



WELL RECORD

CO.

Well No.-----

Farm-----

District-----

County-----

State-----

Owned by-----

Division-----

Date----- 19-----

Entered W. R. Book Folio-----

By-----

09/29/2023

134

The Manufacturers Light & Heat Co  
Company

Division 4

Record of Well No. 3533

on E.F. Kelley

Farm 115

Acres

Proctor

Field

Proctor

District  
Township

Wetzel

County W.Va.

State

Rig Commenced

19

Completed

19

Drilling Commenced

19

Completed

19

Cost per Foot

Contractor Rawe, Bro.,s

Address New Martinsville, West Va.

Drillers' Names

BOILER

ENGINE

RIG

H.P.	No.	Name of Maker	H. P.	No.	Name of Maker	New	Old	Height	Name of Boiler
------	-----	---------------	-------	-----	---------------	-----	-----	--------	----------------

CONDUCTOR AND CASING USED IN DRILLING

Conductor	13 inch	10 inch	8 1/4 inch	6 3/4 inch	6 1/4 inch	5 3/4 inch	5 1/2 inch	5 inch	4 inch
-----------	---------	---------	------------	------------	------------	------------	------------	--------	--------

CONDUCTOR AND CASING LEFT IN WELL

Conductor	13 inch	10 inch	8 1/4 inch	6 3/4 inch	6 1/4 inch	5 3/4 inch	5 1/2 inch	5 inch	4 inch	3 inch
-----------	---------	---------	------------	------------	------------	------------	------------	--------	--------	--------

OIL WELL

GAS WELL

When Shot	Size of Torepdo	1st Day's Production	Tubing	Rods	Tanks	Size of Packer	Depth Set	Packed with	1st Minute Pressure	Rock Pressure
-----------	-----------------	----------------------	--------	------	-------	----------------	-----------	-------------	---------------------	---------------

Initial Open Flow Production

Cubic Feet Per 24 Hours

Shut in Pressure

Cubic Feet Per 24 Hours

FORMATION	Top	Bottom	Thickness	REMARKS
Gordon Stray	3065	3078	13	No Sand Limy
Slate	3078	3096	18	
Gordon Sand	3096	3110	14	No Sand Limy
Slate	3110	3310	200	
Total Depth	3310			Dry In All Sands,



09/29/2023

Examined above information and measurements and found to be correct by

Examined and approved by

*Rawe Bros*

Contractor

*Harry Moore*

Superintendent of Co.

NOTE—The above blank must be filled out carefully by the contractor, with a complete and accurate record of the Well, and accompany, when presented for payment of the bill for drilling.

All formations and known sands must be given by their proper name, with steel line measurements, and under the head of "Remarks" must be recorded in what sand and at what depth Oil, Gas or Water was found, the quantity of same, the quality of the sand, and thickness of pay.

Make no memoranda of boiler and engine if owned by contractor.

WELL RECORD

CO.

Well No. ....

Farm .....

District .....

County .....

State .....

Owned by .....

Division .....

Date .....

19

Entered W. R. Book Folio .....

By .....

09/29/2023

B-5

134

Well abandoned  
3/3/37

WEST VIRGINIA DEPARTMENT OF MINES

OIL AND GAS DIVISION

PRELIMINARY DATA SHEET No. 1

File No. .... Well No. 3533

The Manufacturers Light & Heat Co. Company, of 800 Union Trust Building,

Pittsburgh Pa. on the E.F. Kelley Farm

containing 115 acres. Location .....

Proctor District, in Wetzel County, West Virginia

The surface of the above tract is owned in fee by E. F. Kelley

of Bebee, W. Va. address, and the mineral rights are owned by

The Manufacturers Light & Heat Company of Pittsburgh, Pa.

The oil and gas privileges are held under lease by the above named company, and this well is drilled under permit

No. Wet-134 issued by the West Virginia Department of Mines, Oil and Gas Division

October 10th, 1936

Elevation of surface at top of well, ..... Spirit Barometric.

The number of feet of the different sized casings used in the well.

.....feet.....size. Wood conductor.

415'-5" feet 10 size, csg. 1592'-1" feet 8 1/4" sized csg.

2211'-8" feet 6 5/8 size, csg. ....feet.....sized csg.

.....feet.....size, csg. ....feet.....sized csg.

No packer packer of.....size, set at.....

.....packer of.....size, set at.....

....., in casing perforated at.....feet to.....feet.

....., in casing perforated at.....feet to.....feet.

Coal was encountered at 992 feet; thickness 12 inches, and at 1091

feet; thickness 60 inches; and at.....feet; thickness.....inches.

Liners were used as follows: (Give details) None

March 24th, 1937.

Date.

Approved THE MANUFACTURERS LIGHT & HEAT CO. 09/29/2020 Divsr.

By J. H. Fowler (TITLE) Land Dept. Office Mgr.



WEST VIRGINIA DEPARTMENT OF MINES

OIL AND GAS DIVISION

PRELIMINARY DATA SHEET NO. 1

Well No. 3553 File No.

The Manufacturers Light & Heat Co. Company of 800 Union Trust Building,

Pittsburgh Pa. on the E. F. Kelley Farm

containing 115 acres. Location

Proctor District in Wetzel County, West Virginia

The surface of the above tract is owned in fee by E. F. Kelley

of Boboe, W. Va. address, and the mineral rights are owned by

The Manufacturers Light & Heat Company of Pittsburgh, Pa.

The oil and gas privileges are held under lease by the above named company, and this well is drilled under permit

No. 100-134 issued by the West Virginia Department of Mines, Oil and Gas Division

October 1937 1938

Elevation of surface at top of well, Spirit Barometric

The number of feet of the different sized casings used in the well.

Wood conductor size feet

12 1/2" 10" 100' 1 1/2"

6 3/8" 6 3/8" 6 3/8"

6 3/8" 6 3/8" 6 3/8"

No packer packer of size set at

packer of size set at

in casing perforated at feet to

in casing perforated at feet to

Coal was encountered at 922 feet; thickness 12 inches; and at 1091

feet; thickness 60 inches; and at feet; thickness inches

Liners were used as follows: (Give details) None

March 21st, 1937

Approved THE MANUFACTURERS LIGHT & HEAT CO., Owner

By (Print Name) Land Dept. Office M.T.

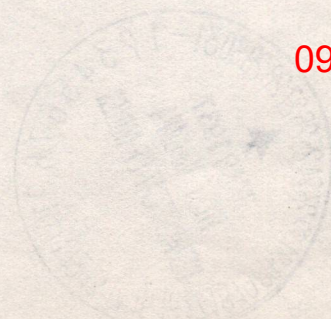

09/29/2023

B-8

Wet-134-8

FORM G-9

NOTICE OF INTENTION TO PLUG AND ABANDON WELL

(REQUIRED BY SECTION 9, ARTICLE 4, CHAPTER 22 OF THE CODE)

WEST VIRGINIA DEPARTMENT OF MINES  
OIL AND GAS DIVISION

To THE DEPARTMENT OF MINES,  
Charleston, W. Va.

A.M. Nichols, et al.  
COAL OPERATOR OR COAL OWNER

Waynesburg, Penna.  
ADDRESS

COAL OPERATOR OR COAL OWNER

ADDRESS

E.F. Kelley  
LEASE OR PROPERTY OWNER

Bebee, West Virginia  
ADDRESS

The Manufacturers Light & Heat Co  
800 Union Trust Building  
P.O. Box #1196  
Pittsburgh, Penna.

COMPLETE ADDRESS

19

WELL TO BE ABANDONED

Proctor District

Wetzel County

Well No. #1 No. 3533

E.F. Kelley Farm

Gentlemen:—

The undersigned well operator is about to abandon the above described well and will commence the

work of plugging and abandoning said well on the 14<sup>th</sup> day of February, 1937, (which date shall not be less than five days after the day on which this notice so mailed is received, or in due course should be received by the Department of Mines).

This notice is given you in order that your respective representatives may be present at the plugging and filling of said well. You are further notified that whether you are represented or not represented the undersigned will proceed on that date, or shortly thereafter, to plug and fill said well in the manner required by Section 10, Article 4, Chapter 22 of the Code and given in detail on the reverse side of this notice, in "Work Order."

This notice is being mailed by registered mail to each of you at the above addresses on the above date.

Very truly yours,

THE MANUFACTURERS LIGHT & HEAT CO.

By Harry Moore, Well Operator.

NOTE: Upon the abandonment of all wells drilled prior to June 1, 1929, a plat prepared by a competent engineer, showing the district and county in which the tract of land is located, the name and acreage of same, the names of the owners of adjacent tracts, and the location of the about to be abandoned well, determined by survey, and the courses and distances of such well from two permanent points or landmarks on said tract, shall be submitted with this notice.

(Over)

09/29/2023

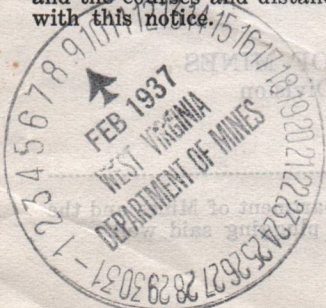

Wet-134-P

B-9

PROPOSED MANNER OF PLUGGING AND FILLING WELL

(REQUIRED BY RULES AND REGULATIONS)

WEST VIRGINIA DEPARTMENT OF MINES

OIL AND GAS DIVISION

WORK ORDER

Well to be plugged and filled as follows:

Total Depth.	3310		
Fill with Clay	3310	to 3045	20' above Gordon Stray
Drive Wood Plug	3045	to 3042	
Cement	3042	to 3032	
Set Bridge at	2534		30' Below Big Injun Sand
Fill with Clay	2534	to 2214	
Drive Wood Plug	2214	to 2211	
Cement	2211	to 2201	Pull 6 5/8" Casing set at 2211'-8"
Fill with Clay	2201	to 2090	20' above Maxon Sand
Drive Wood Plug	2090	to 2087	
Cement	2087	to 2077	
Fill with Clay	2077	to 1878	20' Above 2nd Salt Sand
Drive Wood Plug	1878	to 1875	
Cement	1875	to 1855	
Clay	1855	to 1775	20' Above 1st. Salt Sand
Drive Wood Plug	1775	to 1772	
Cement	1772	to 1762	
Fill with Clay	1762	to 1635	20' above Gas Sand
Wood Plug	1635	to 1632	
Cement	1632	to 1622	Pull 8 1/4" Casing Set at 1592'-1
Fill with Clay	1622	to 1180	20' Above Sand
Drive Wood Plug	1180	to 1177	
Cement	1177	to 1167	
Fill with Clay	1167	to 1103	
Drive Wood Plug	1103	to 1100	
Cement	1100	to 1090	
Set vent pipe with Morning Glory Packer suspended to 1126'			30' Below Pittsburgh Coal
Cement	1126	to 1071	
Fill with Clay	1071	to 428	10' Below 10" Casing. Pull 10" Casing Set at 415'-5"
Fill with Clay	428	to Surface	
Erect Monument.			

NOTE BY THE DEPARTMENT OF MINES:

The above work order shows filling to 1090' and in that case could not set vent pipe at 1126' - would suggest that

the above work order be followed to 1167' Anchor Vent pipe with Morning Glory Packer at 1126' with 10' of perforated vent pipe below packer and Cement from 1126' to 1071' - 30' and 20' above Pittsburgh Coal and complete as in original work order.

To the Department of Mines, Coal Owner or Operator, Lease or Property Owner.

Gentlemen:

This "work order" is submitted for your approval and concurrence and unless notified of your disapproval or non-currence, the undersigned will proceed with the plugging and filling of said well in the above described manner on the date stated in the notice of intention to plug and abandon the said well on opposite side of this sheet.

Very truly yours,

THE MANUFACTURERS LIGHT & HEAT CO.

By Harry ... Well Operator.

No objections have been filed by the coal owner or coal operator, or any available adjacent lease or property owners or interposed by the Department of Mines to the manner herein described for the plugging and filling of the well above mentioned. Therefore, the same is hereby approved this 9th day of February, 1937.

09/29/2023

DEPARTMENT OF MINES Oil and Gas Division

Copy to Inspector Courtney.

By: .....

NOTE: This "work order" must be filed in duplicate, one copy for the files of the Department of Mines and the other to be approved or corrected and returned to the well operator as his authority for plugging said well.

B-10

FORM G-8

**AFFIDAVIT IN TRIPLICATE TO TIME AND MANNER OF PLUGGING AND FILLING WELL**

(REQUIRED BY SECTION 9, ARTICLE 4, CHAPTER 22 OF THE CODE)

**WEST VIRGINIA DEPARTMENT OF MINES  
OIL AND GAS DIVISION**

Daisy B. Patterson  
 -----  
 COAL OPERATOR OR OWNER  
 P. O. Box 265, Moundsville, WVa.  
 -----  
 ADDRESS  
 -----  
 COAL OPERATOR OR OWNER  
 -----  
 ADDRESS  
 -----  
 LEASE OR PROPERTY OWNER  
 -----  
 ADDRESS

The Manufacturers Light & Heat Company  
 -----  
 NAME OF WELL OPERATOR  
 800 Union Trust Bldg., Pittsburgh Pa.  
 -----  
 COMPLETE ADDRESS  
 -----  
 March 15th 1937 ..... 19.....  
 -----  
 WELL AND LOCATION  
 Proctor ..... District  
 -----  
 Wetzel ..... County  
 -----  
 Well No. 3533 .....  
 -----  
 E.F. Kelley ..... Farm

AFFIDAVIT TO BE MADE IN TRIPLICATE, ONE COPY TO BE MAILED BY REGISTERED MAIL TO THE DEPARTMENT, ONE COPY TO BE RETAINED BY THE WELL OPERATOR AND THE THIRD COPY (AND EXTRA COPIES IF REQUIRED) TO BE MAILED TO EACH COAL OPERATOR ABOVE NAMED AT THEIR RESPECTIVE ADDRESSES.

**AFFIDAVIT**

STATE OF WEST VIRGINIA, }  
COUNTY OF Wetzel } SS:

~~James A. Blair~~ ..... and William C. Moffitt .....  
 being first duly sworn according to law depose and say that they are experienced in the work of plugging  
 and filling oil and gas wells and were employed by The Manufacturers Light & Heat Co. Well operator,  
 and participated in the work of plugging and filling the above well, that said work was commenced on the  
 ..11th.....day of February....., 19..37..., and that the well was plugged and filled in  
 the following manner:

Manner in which sand was plugged: Clay 3310-3045, Wood plug 3045-3042, Cement 3042-3032  
 Bridged @ 2534, Clay 2534-2214, Wood plug 2214-2211, Cement 2211-2201, Clay 2201-2090  
 Wood plug 2090-2087, Cement 2087-2077, Clay 2077-1878, Wood plug 1878-1875, Cement  
 1875-1855, Clay 1855-1775, Wood plug 1775-1772, Cement 1772-1762, Clay 1762-1635,  
 Wood plug 1635-1632, Cement 1632-1622, 1622, Clay 1622-1180, Wood plug 1180-1177,  
 Cement 1177-1167,

Manner in which coal was plugged: Morning glory packer at 1126 with 10' of perforated  
 pipe below packer, Cement 1126-1071, Clay 1071 to surface. 2" vent pipe from 30'  
 below Pitts Coal to surface.

Description of monument: Erected as per Rule # 18.

*O.K. M.*

(THE ABOVE DESCRIPTIONS MUST BE IN DETAIL AND IN ACCORDANCE WITH THE PROVISIONS OF SECTION 10, ARTICLE 4, CHAPTER 22 OF THE CODE)

and that the work of plugging and filling said well was completed on the 3rd day of March,  
19..37.....

And further deponents saith not.

William C. Moffitt

09/29/2023

Sworn to and subscribed before me this 16th day of March, 19..37.....

*[Signature]*  
Notary Public.

My Commission expires: Feb 1st 1946

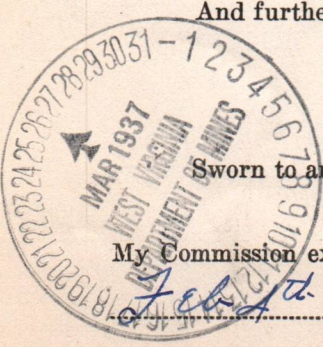



AFFIDAVIT IN SUPPORT OF PETITION FOR  
 FLOORING AND FILLING WELL  
 (CHAPTER 45, ARTICLE 3, SECTION 11-12 OF THE CODE)  
 WEST VIRGINIA DEPARTMENT OF MINES  
 OIL AND GAS DIVISION

The Manufacturer Light & Heat Company  
 800 Union Trust Bldg., Pittsburgh Pa.

James L. Peterson  
 207 South 3rd St., Louisville, Mo.

March 12th 1937

Proctor

Notary

West Va. 3333

E.F. Kolley

AFFIDAVIT

Notary

William C. Morris

James H. Morris

- Concrete 117-117
- Wood plug 155-152, Cement 153-153, Clay 152-150, Wood plug 1180-1177
- 1875-1875, Clay 1855-1175, Wood plug 1175-1175, Cement 1175-1175, Clay 1175-1875
- Wood plug 2090-2087, Cement 2087-2077, Clay 2077-1878, Wood plug 1878-1875, Cement
- Bridged 2275, Clay 2212-2212, Wood plug 2211-2201, Cement 2211-2201, Clay 2201-2090
- Clay 3310-3010, Wood plug 3010-3010, Cement 3010-3072

When a well was drilled, working clay packer at 152 with 10' of perforated pipe below packer, Cement 112-107, Clay 107 to surface, 2" vent pipe from 30' below filler coal to surface.

Production of mineral, proved as per title # 124

*William C. Morris*

09/29/2023

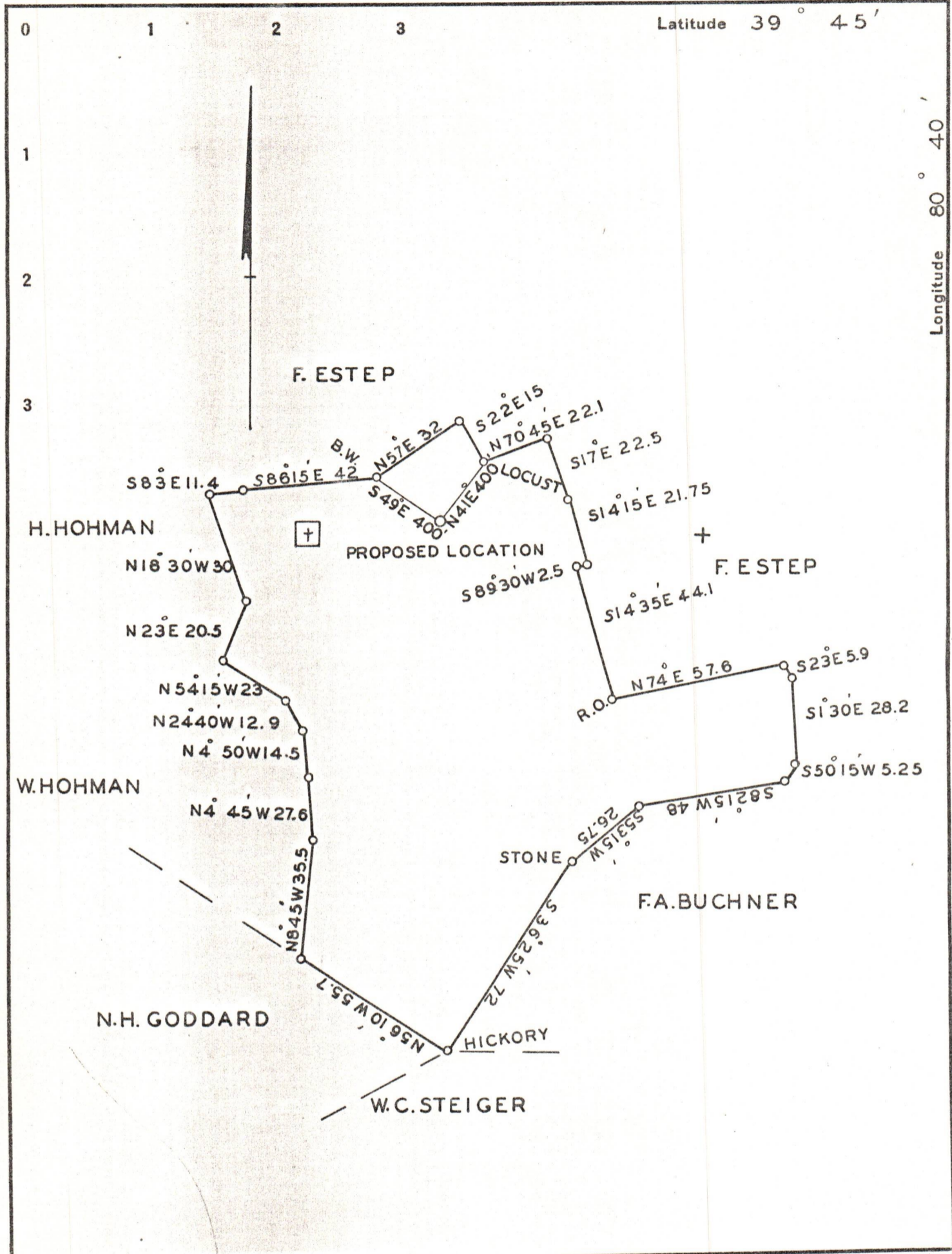

Company THE MANUFACTURERS LIGHT & HEAT

Address 800 UNION TRUST BUILDING

Farm E. F. KELLEY ET AL.

Tract \_\_\_\_\_ Acres 115 Lease No. 16830

Well (Farm) No. 1 Serial No. 3533

Elevation (Spirit Level) 1255.0

Quadrangle LITTLETON N.W.

County WETZEL District PROCTOR

Engineer F. H. SOCHOR

Engineer's Registration No. \_\_\_\_\_

File No. \_\_\_\_\_ Drawing No. Y-7-487

Date 9-22-36 Scale 1" = 660'

STATE OF WEST VIRGINIA  
 DEPARTMENT OF MINES  
 OIL AND GAS DIVISION  
 CHARLESTON

**WELL LOCATION MAP**

FILE NO. WET-134 09/29/2023

† Denotes location of well on United States Topographic Maps, scale 1 to 62,500, latitude and longitude lines being represented by border lines as shown.

— Denotes one inch spaces on border line of original tracing.