

NOTICE OF PROPOSED LOCATION OF OIL AND GAS WELL

(REQUIRED BY SECTION 2, CHAPTER 86, ACTS 1929)

WEST VIRGINIA DEPARTMENT OF MINES

OIL AND GAS SECTION

To THE DEPARTMENT OF MINES, Charleston, W. Va.

Roosevelt Coal & Coke Co., COAL OPERATOR OR COAL OWNER

Wilmerding, Pa. ADDRESS

COAL OPERATOR OR COAL OWNER

ADDRESS

OWNER OF MINERAL RIGHTS

ADDRESS

THE MANUFACTURERS LIGHT & HEAT COMPANY NAME OF WELL OPERATOR

800 Union Trust Bldg., Pittsburgh, Pa. COMPLETE ADDRESS

September 9th, 1937 PROPOSED LOCATION

Proctor District

Wetzel County

Well No. 1 - 3555 39° 45' 80° 40' 92.93ac

Thurman Goddard Farm

GENTLEMEN :

The undersigned well operator is entitled to drill upon the above named farm or tract of land for oil and gas, having fee title thereto, (or as the case may be) under grant or lease dated.....

October 23rd, 1934, made by Thurman and Bessie Goddard, to

The Manufacturers Light & Heat Company, and recorded on the 20th day of November, 1934, in the office of the County Clerk for said County in

Book 29-A, page 404

The enclosed plat was prepared by a competent engineer and shows the proposed location of a well to be drilled for oil and gas by the undersigned well operator on the farm and in the Magisterial District and County above named, determined by survey and courses and distances from two permanent points, or land marks.

The undersigned well operator is informed and believes there are no coal operators operating beds of coal beneath said farm or tract of land on which said well is located, or within 500 feet of the boundaries of the same, who have mapped their workings and filed their maps as required by law, excepting the coal operators or coal owners (if any) above named as addressees.

The above named coal operators or coal owners (if any) are notified that any objections they may desire to make to such proposed location, or which they are required to make by Section 3 of said Act, if the drilling of a well at said proposed location will cause a dangerous condition in or about their respective coal mines, must be received by, or filed with the Department of Mines within ten\* days from the receipt of a copy of this notice and accompanying plat by said Department. Said coal operators are further notified that forms for use in making such objections will be furnished to them by the Department of Mines promptly on request and that all such objections must set forth as definitely as is reasonably possible the ground or grounds on which such objections are based and indicate the direction and distance the proposed location should be moved to overcome same.

(The next paragraph is to be completed only in Department's copy.)

Copies of this notice and the enclosed plat were mailed by registered mail, or delivered to the above named coal operators or coal owners at their above shown respective address this day before, or on the same day with the mailing or delivery of this copy to the Department of Mines at Charleston, West Virginia.

Very truly yours, THE MANUFACTURERS LIGHT & HEAT CO.,

Hary H. Fowler Land Dept. WELL OPERATOR Office Manager 800 Union Trust Building

STREET

Pittsburgh CITY OR TOWN

Pennsylvania STATE

09/22/2023

Address of Well Operator



\*Section 3 . . . . . If no such objections be filed, or be found by the department of mines, within said period of ten days from the receipt of said notice and plat by the department of mines, to said proposed location, the department shall forthwith issue to the well operator a drilling permit reciting the filing of such plat, that no objections have been made by the coal operators to the location, or found thereto by the department, and that the same is approved and the well operator authorized to proceed to drill at said location.

NOTICE OF PROPOSED LOCATION OF OIL AND GAS WELL

(Required by SECTION 3, CHAPTER 88, ACTS 1929)

WEST VIRGINIA DEPARTMENT OF MINES

OIL AND GAS SECTION

To The Department of Mines  
Charleston, W. Va.

Rosevelt Coal & Coke Co.,  
COAL OPERATOR OR COAL OWNER

THE MANUFACTURERS LIGHT & HEAT COMPANY  
NAME OF WELL OPERATOR

800 Union Trust Bldg., Pittsburgh, Pa.  
COMPLETE ADDRESS

Wilmerding, Pa.  
ADDRESS

September 29th, 1931  
PROPOSED LOCATION

COAL OPERATOR OR COAL OWNER

Proctor  
District

ADDRESS

Wetzel  
County

OWNER OF MINERAL RIGHTS

Well No. 1 - 3255  
80° 44' 00" 42'

ADDRESS

Timman Goddard  
Farm

ENTIREMENT:

The undersigned well operator is entitled to drill upon the above named farm or tract of land for oil and gas having fee title thereto (or as the case may be) under grant or lease dated

October 27th, 1931 made by Timman and Beattie Goddard to

The Manufacturers Light & Heat Company and recorded on the 20th day

of November, 1931 in the office of the County Clerk for said County in

Book 29-A page 101

The enclosed plat was prepared by a competent engineer and shows the proposed location of a well to be drilled for oil and gas by the undersigned well operator on the farm and in the Mineral District and County above named, determined by survey and courses and distances from two permanent points or land marks.

The undersigned well operator is informed and believes there are no coal operators operating beds of coal beneath said farm or tract of land on which said well is located, or within 500 feet of the boundaries of the same, who have mapped their workings and filed their maps as required by law, excepting the coal operators or coal owners (if any) above named as addressees.

The above named coal operators or coal owners (if any) are notified that any objections they may desire to make to such proposed location, or which they are required to make by Section 3 of said Act, if the drilling of a well at said proposed location will cause a dangerous condition in or about their respective coal mines must be received by, or filed with the Department of Mines within ten days from the receipt of a copy of this notice and accompanying plat by said Department. Said coal operators are further notified that forms for use in making such objections will be furnished to them by the Department of Mines promptly on request and that all such objections must set forth as definitely as is reasonably possible the ground or grounds on which such objections are based and indicate the direction and distance the proposed location should be moved to overcome same.

(The next paragraph is to be completed only in Department's copy.)  
Copies of this notice and the enclosed plat were mailed by registered mail, or delivered to the above

named coal operators or coal owners at their above shown respective address this day before or on the same day with the mailing or delivery of this copy to the Department of Mines at Charleston, West Virginia.

Very truly yours, THE MANUFACTURERS LIGHT & HEAT CO.

John H. Jones  
Land Dept. WELL OPERATOR Office Manager

800 Union Trust Building  
STREET

Address of Well Operator

Pittsburgh  
CITY OR TOWN

Pennsylvania  
STATE

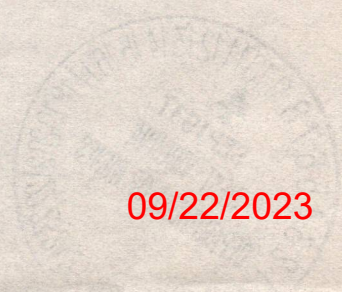

09/22/2023

Section 3. If no such objections be filed, or be found by the department of mines, within said period of ten days from the receipt of said notice and plat by the department of mines, to said proposed location, the department shall forthwith issue to the well operator a drilling permit reciting the filing of such plat, that no objections have been made by the coal operators to the location, or found thereto by the department, and that the same is approved and the well operator authorized to proceed to drill at said location.



STATE OF WEST VIRGINIA  
DEPARTMENT OF MINES  
OIL AND GAS DIVISION

NOTICE OF PROPOSED LOCATION OF OIL AND GAS WELL

To THE DEPARTMENT OF MINES,  
Charleston, W. Va.

\_\_\_\_\_  
COAL OPERATOR OR COAL OWNER

\_\_\_\_\_  
ADDRESS

\_\_\_\_\_  
COAL OPERATOR OR COAL OWNER

\_\_\_\_\_  
ADDRESS

\_\_\_\_\_  
OWNER OF MINERAL RIGHTS

\_\_\_\_\_  
ADDRESS

THE MANUFACTURERS LIGHT AND HEAT COMPANY  
NAME OF WELL OPERATOR  
800 UNION TRUST BUILDING  
PITTSBURGH, PENNSYLVANIA  
COMPLETE ADDRESS

\_\_\_\_\_  
August 24, 19 53

PROPOSED LOCATION

\_\_\_\_\_  
Proctor District

\_\_\_\_\_  
Wetzel County

Well No. 1-3555 39°45' 80°40'

\_\_\_\_\_  
Thurman Goddard Farm

GENTLEMEN:

The undersigned well operator is entitled to drill upon the above named farm or tract of land for oil and gas, having fee title thereto, (or as the case may be) under grant or lease dated January 22, 1953, made by Bessie & Thurman Goddard, to THE MANUFACTURERS LIGHT AND HEAT COMPANY, and recorded on the 10th day of February, 1953, in the office of the County Clerk for said County in O. & G. Book 40A, page 277.

The enclosed plat was prepared by a competent engineer and shows the proposed location of a well to be drilled for oil and gas by the undersigned well operator on the farm and in the Magisterial District and County above named, determined by survey and courses and distances from two permanent points, or land marks.

The undersigned well operator is informed and believes there are no coal operators operating beds of coal beneath said farm or tract of land on which said well is located, or within 500 feet of the boundaries of the same, who have mapped their workings and filed their maps as required by law, excepting the coal operators or coal owners (if any) above named as addressees.

The above named coal operators or coal owners (if any) are notified that any objections they may desire to make to such proposed location, or which they are required to make by Section 3 of said Code, if the drilling of a well at said proposed location will cause a dangerous condition in or about their respective coal mines, must be received by, or filed with the Department of Mines within ten\* days from the receipt of a copy of this notice and accompanying plat by said Department. Said coal operators are further notified that forms for use in making such objections will be furnished to them by the Department of Mines promptly on request and that all such objections must set forth as definitely as is reasonably possible the ground or grounds on which such objections are based and indicate the direction and distance the proposed location should be moved to overcome same.

(The next paragraph is to be completed only in Department's copy.)

Copies of this notice and the enclosed plat were mailed by registered mail, or delivered to the above named coal operators or coal owners at their above shown respective address \_\_\_\_\_ day \_\_\_\_\_ before, or on the same day with the mailing or delivery of this copy to the Department of Mines at Charleston, West Virginia.

Very truly yours,

ASST. LAND AGENT

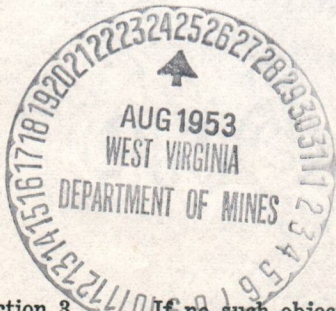

Address of Well Operator }

THE MANUFACTURERS LIGHT AND HEAT COMPANY  
STREET  
800 Union Trust Building  
CITY OR TOWN  
Pittsburgh, Pennsylvania  
STATE

09/22/2023

\*Section 3. If no such objections be filed or be found by the department of mines, within said period of ten days from the receipt of said notice and plat by the department of mines, to said proposed location, the department shall forthwith issue to the well operator a drilling permit reciting the filing of such plat, that no objections have been made by the coal operators to the location, or found thereto by the department, and that the same is approved and the well operator authorized to proceed to drill at said location.

wet-167-Redrill



STATE OF WEST VIRGINIA  
DEPARTMENT OF MINES  
OIL AND GAS DIVISION

NOTICE OF PROPOSED LOCATION OF OIL AND GAS WELL

To The Department of Mines,  
Charleston, W. Va.

THE MANUFACTURERS LIGHT AND HEAT COMPANY

NAME OF WELL OPERATOR  
800 UNION TRUST BUILDING  
PITTSBURGH, PENNSYLVANIA

COMPLETE ADDRESS

August 24, 1923

PROPOSED LOCATION

District Proctor

County Wetzel

Well No. 1-3555 30° 40' 39° 42'

Town Thurman Goddard

COAL OPERATOR OR COAL OWNER

ADDRESS

COAL OPERATOR OR COAL OWNER

ADDRESS

OWNER OF MINERAL RIGHTS

ADDRESS

GENTLEMEN:

The undersigned well operator is entitled to drill upon the above named farm or tract of land for oil and gas having fee title thereto, (or as the case may be) under grant or lease dated

January 22, 1923 whereby Beasie & Thurman Goddard

and recorded on the 10th day

of February, 1923, in the office of the County Clerk for said County in

Book 40A page 277

The enclosed plat was prepared by a competent engineer and shows the proposed location of a well to be drilled for oil and gas by the undersigned well operator on the farm and in the Magisterial District and County above named, determined by survey and courses and distances from two permanent points or land marks.

The undersigned well operator is informed and believes there are no coal operators operating beds of coal beneath said farm or tract of land on which said well is located, or within 500 feet of the boundary of the same, who have mapped their workings and filed their maps as required by law, excepting the coal operators or coal owners (if any) above named as addresses.

The above named coal operators or coal owners (if any) are notified that any objections they may desire to make to such proposed location or which they are required to make by Section 5 of said Code in the drilling of a well at said proposed location will cause a hazardous condition in or about their respective coal mines must be received by or filed with the Department of Mines within ten days from the receipt of a copy of this notice and accompanying plat by said Department. Said coal operators are further notified that forms for use in making such objections will be furnished to them by the Department of Mines promptly on request and that all such objections must set forth as definitely as is reasonably possible the ground or grounds on which such objections are based and indicate the question and distance the proposed location should be moved to overcome same.

(The next paragraph is to be completed only in Department's copy.)  
Copies of this notice and the enclosed plat were mailed by registered mail or delivered to the above

named coal operators or coal owners at their above shown respective addresses \_\_\_\_\_ day \_\_\_\_\_ before \_\_\_\_\_ or on the same day with the mailing or delivery of this copy to the Department of Mines at Charleston, West Virginia.

Very truly yours

ADMINISTRATOR ASST. LAND AGENT

THE MANUFACTURERS LIGHT AND HEAT COMPANY

800 Union Trust Building

Pittsburgh, Pennsylvania

Address  
Well Operator

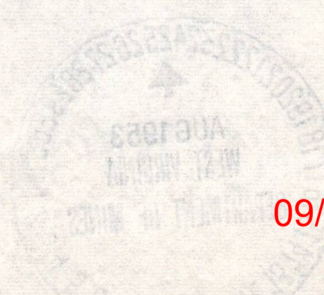

09/22/2023

Section 5. If any such objections be filed or be found by the department of mines, within said period of ten days from the receipt of said notice and plat by the department of mines, to said proposed location, the department shall forthwith cause the well operator a drilling permit covering the tract of land on which no objections have been made by the coal operators to the location, or found thereby by the department, and that this same is approved and the well operator authorized to proceed to drill at said location.

Permit Number WET-157-B

A-10

September 4, 1953

The Manufacturers Light & Heat Company  
800 Union Trust Building  
Pittsburgh, Pennsylvania

Gentlemen:

Enclosed is permit WET-167-Redrill for  
reopening Well No. 1, Serial 3555 on the Thurman Goddard  
Farm, Proctor District, Wetzel County.

Very truly yours,

Administrative Assistant  
OIL AND GAS DIVISION

MG:g  
encl

cc: Mr. D. F. Desist, Inspector  
Mr. R. C. Tucker, Assistant State  
Geologist

A-11

September 20, 1937

The Manufacturers Light & Heat Co.,  
800 Union Trust Building  
Pittsburgh, Pennsylvania

Gentlemen:

Permit Wet-167 to drill Well No. 1-3555  
on the Thurman Goddard Farm, Proctor District, Wetzel  
County, is enclosed.

Very truly yours,

Secretary  
OIL AND GAS DIVISION.

MG:g  
encl

copy to Inspector Courtney.  
Lat 39d-45'  
Long 80d-40'

Will this department Please  
send me a copy of the  
plugging order issued to  
Manufacture light & heat Co,  
to plug well no 3555 on  
Thurman Goddard Wetzel Co? send to  
Thurman Goddard  
Beber West Virginia

09/22/2023



B-1

WEST VIRGINIA DEPARTMENT OF MINES  
OIL AND GAS DIVISION

WELL RECORD

Permit No. Wet 167

Oil or Gas Well Gas-Dry hole  
(Kind)

Company The Manufacturers Light & Heat Co.  
 Address 800 Union Trust Bldg., Pittsburgh, Pa.  
 Farm Thurman Goddard Acres 93  
 Location (waters) \_\_\_\_\_  
 Well No. 1 - 3555 Elev. 1262 ft.  
 District Proctor County Wetzel  
 The surface of tract is owned in fee by Thurman Goddard  
 Address Bebee, W. Va.  
 Mineral rights are owned by The Manufacturers Light & Heat Company  
 Address Pittsburgh, Pa.  
 Drilling commenced October 6th, 1937  
 Drilling completed November 19th, 1937  
 Date shot \_\_\_\_\_ Depth of shot \_\_\_\_\_  
 Open Flow /10ths Water in DRY HOLE Inch  
 \_\_\_\_\_ /10ths Merc. in \_\_\_\_\_ Inch  
 Volume \_\_\_\_\_ Cu. Ft.  
 Rock Pressure \_\_\_\_\_ lbs. \_\_\_\_\_ hrs.  
 Oil \_\_\_\_\_ bbls., 1st 24 hrs.  
 Fresh water \_\_\_\_\_ feet \_\_\_\_\_ feet  
 Salt water \_\_\_\_\_ feet \_\_\_\_\_ feet

Casing and Tubing	Used in Drilling	Left in Well	Packers
Size			Kind of Packer
16			
13			
10	509' 9"		Size of
8 1/4	1585' 7"		
6 5/8	2222' 7"		Depth set
5 3/16			
3			Perf. top
2			Perf. bottom
Liners Used			Perf. top
			Perf. bottom

CASING CEMENTED \_\_\_\_\_ SIZE \_\_\_\_\_ No. FT. \_\_\_\_\_ Date \_\_\_\_\_  
 COAL WAS ENCOUNTERED AT 646 FEET 12 INCHES  
705 FEET 12 INCHES 1101 FEET 24 INCHES  
1084 FEET 24 INCHES \_\_\_\_\_ FEET \_\_\_\_\_ INCHES

Formation	Color	Hard or Soft	Top	Bottom	Oil Gas or Water	Depth Found	Remarks
Clay, Shale, Lime			0	220			
Red Rock			220	300			
Slate, Lime Sand & Red Rock			300	646	511'-10"		
Coal			646	647			
Slate, Lime			647	705			
Coal			705	706			
Slate & Lime			706	1001			
Mapletown Coal			1001	1003			
Slate & Lime			1003	1084			
Pittsburgh Coal			1084	1086	1/2 bailer water per hr. in Pgh. Coal		
Slate, Lime			1086	1125			
Murphy Sand			1125	1135			
Red Rock			1135	1150			
Slate			1150	1180			
Red Rock			1180	1212			
Lime, Slate & Red Rock			1212	1275			
Red Rock			1275	1325			
Slate, Lime, Red Rock			1325	1435			
Little Dunkard			1435	1470			
Slate, Shells, Red Rock			1470	1580	1585'-8 1/4'		
Big Dunkard			1580	1630			
Slate & Shale			1630	1690			
Gas Sand			1690	1715			
Slate & Shells			1715	1790			
1st Salt Sand			1790	1815	1/4 bailer water per hr. in 1798-1800		
Shale			1815	1860			
2nd Salt Sand			1860	1896	Salt Water 1880 - 6 bailers per hour		
Shale & Lime			1896	1962			
3rd Salt Sand			1962	2010			
Shale & Lime			2010	2050			
Maxon Sand			2050	2095			
Slate, Shells, Lime			2095	2137			
Pencil Cave			2137	2157			
Blue Monday Sand			2157	2185	2223'-6 5/8		
Big Lime			2185	2227			
Big Injun Sand			2227	2503	Show water at 2295		

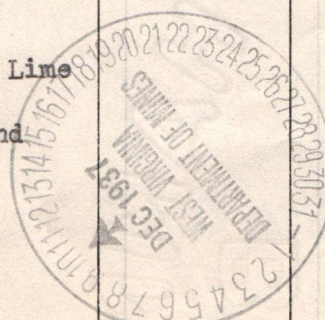

09/22/2023



Formation	Color	Hard or Soft	Top	Bottom	Oil, Gas or Water	Depth Found	Remarks
3rd salt			1962	2010		1890	
Shale	Black		2010	2025			
Lime Gritty			2025	2050		1880-1890	
Maxon sand			2050	2095			
Slate & Shella			2095	2132			
Lime shells			2132	2137			
Pencil Cave			2137	2157			
Blu Monday			2157	2185			
Big Lime			2185	2227			
Big Injun sand			2227	2503	Water	2295	Show of gas 2295.
Total depth			2508				

09/22/2023

Date January 26th, 19 38

APPROVED THE MANUFACTURERS LIGHT & HEAT CO., Owner

By Harry H. Fowler Land Dept. (Title) Office Manager.

WEST VIRGINIA DEPARTMENT OF MINES  
OIL AND GAS DIVISION

WELL RECORD

Wet-167

Permit No. ....

Oil or Gas Well Dry Hole  
(Kind)

Company The Manufacturers Light & Heat  
 Address 800 Union Trust Building, Pittsburgh Pa.  
 Farm Thurman Goddard Acres 101  
 Location (waters) .....  
 Well No. 3555 Elev. ....  
 District Proctor County Wetzel  
 The surface of tract is owned in fee by Thurman Goddard  
 Address Beebe, W. Va.  
 Mineral rights are owned by The Manufacturers Light & Heat Company  
 Address Pittsburgh, Pa.  
 Drilling commenced 10/6/37  
 Drilling completed 11/13/37  
 Date shot Not shot Depth of shot .....  
 Open Flow 0 /10ths Water in ..... Inch  
 /10ths Merc. in ..... Inch  
 Volume None Cu. Ft. ....  
 Rock Pressure None lbs. .... hrs.  
 Oil None bbls., 1st 24 hrs. ....  
 Fresh water None 1084 feet. 1086 feet  
1796 feet 1800 feet  
 Salt water 1880 feet. 1800 feet

Casing and Tubing	Used in Drilling	Left in Well	Packers
Size			
16 Conductor		Yes	Kind of Packer.....
13.....			None
10.....	509-9	None	Size of.....
8 1/4.....	1585'-7"	None	Depth set.....
6 5/8.....	2222' 7"	None.	
5 3/16.....			
3.....			Perf. top.....
2.....			Perf. bottom.....
Liners Used.....			Perf. top.....
			Perf. bottom.....

CASING CEMENTED..... SIZE..... No. FT..... Date.....  
 COAL WAS ENCOUNTERED AT 646 FEET 12 INCHES  
705 FEET 12 INCHES 1001 FEET 24 INCHES  
1084 FEET 24 INCHES..... FEET..... INCHES

Formation	Color	Hard or Soft	Top	Bottom	Oil Gas or Water	Depth Found	Remarks
Clay shale	Brown	Soft	150	155			
Red rock	Red	Soft	150	155			
Shale	Black						
Lime	White						
Shale	Dark						
and shale	White						
Red rock	Dark						
plate	Red	Soft					
lime							
plate	White						
Red rock	Red	Soft					
lime		Soft					
Red rock	Red	Soft					
plate							
Red rock							
and							
plate	Red	Soft					
Red rock							
plate	White						
lime	Red						
plate							
Red rock							
and							
plate	Black	Soft					
lime	Dark						
plate	White	Soft					
and	Black						
plate							
lime							
plate							
Sand							
Lime shells							
Coal Mapletown	Black	Soft					
plate							
lime							
plate							
plate	Black	Soft					
plate	White						
lime							
plate							
Murphy sand							
Red rock	Red	Soft					
plate							
Red rock							
lime							
plate	Red	Soft					
Red rock							
lime	Red	Soft					
plate							
Red rock	Red	Soft					
plate							
Red rock	Red	Soft					
plate							
lime							
plate							
little Dunk.							
plate	Dark						
Red rock	Red	Soft					
gritty shell							
Pink Rock	Pink						
Big Dunkard							
plate							
shale	Black						
gas sand							
plate							
1/2 Salt sand		Soft			Water	1798-1800	
Shale	Black						
2. Salt sand					Water	1880	
Shale	Black						
Gritty Lime							
Shale							

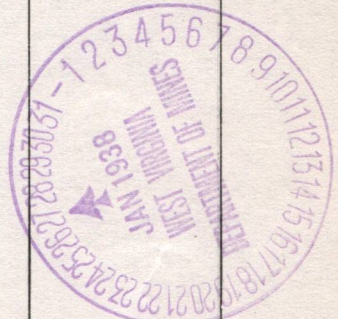

09/22/2023





STATE OF WEST VIRGINIA  
DEPARTMENT OF MINES  
OIL AND GAS DIVISION

WELL RECORD

Permit No. WET-167-Redrill

Oil or Gas Well Storage  
(KIND)

*Littleton*  
Company THE MANUFACTURERS LIGHT AND HEAT COMPANY  
Address 800 Union Trust Bldg., Pgh., Penna.  
Farm Thurman Goddard Acres 92.93  
Location (waters) \_\_\_\_\_  
Well No. 1-3555 Elev. 1262'  
District Proctor County Wetzel  
The surface of tract is owned in fee by \_\_\_\_\_  
Address \_\_\_\_\_  
Mineral rights are owned by \_\_\_\_\_  
Address \_\_\_\_\_  
Drilling commenced September 12, 1953  
Drilling completed November 11, 1953  
Date Shot \_\_\_\_\_ From \_\_\_\_\_ To \_\_\_\_\_  
With \_\_\_\_\_  
Open Flow \_\_\_\_\_ /10ths Water in \_\_\_\_\_ Inch  
\_\_\_\_\_ /10ths Merc. in \_\_\_\_\_ Inch  
Volume \_\_\_\_\_ None \_\_\_\_\_ Cu. Ft.  
Rock Pressure \_\_\_\_\_ lbs. \_\_\_\_\_ hrs.  
Oil \_\_\_\_\_ bbls., 1st 24 hrs.  
Fresh water \_\_\_\_\_ feet \_\_\_\_\_ feet  
Salt water \_\_\_\_\_ feet \_\_\_\_\_ feet

Casing and Tubing	Used in Drilling	Left in Well	Packers
Size			
16			Kind of Packer _____
13			
10		503'11"	Size of _____
8 1/4		1582'9"	
6 5/8			Depth set _____
5 3/16		2077'6"	
3			Perf. top _____
2			Perf. bottom _____
Liners Used			Perf. top _____
			Perf. bottom _____

CASING CEMENTED \_\_\_\_\_ SIZE \_\_\_\_\_ No. Ft. \_\_\_\_\_ Date \_\_\_\_\_  
COAL WAS ENCOUNTERED AT \_\_\_\_\_ FEET \_\_\_\_\_ INCHES  
\_\_\_\_\_ FEET \_\_\_\_\_ INCHES FEET \_\_\_\_\_ INCHES  
\_\_\_\_\_ FEET \_\_\_\_\_ INCHES FEET \_\_\_\_\_ INCHES

Formation	Color	Hard or Soft	Top	Bottom	Oil, Gas or Water	Depth Found	Remarks
Top of Maxon Sand			2060		Schlumberger Measurement		
Bottom of Maxon Sand			2073		Casing Centralizers set at the following depths from bottom of casing:		
Set Lead Plug			2114				
Cement			2073	2114			
Total Depth				2073			
					1	33'4"	
					2	131'7"	
					3	164'7"	
					4	400'5"	
					5	596'3"	
					6	761'6"	
					7	1176'0"	

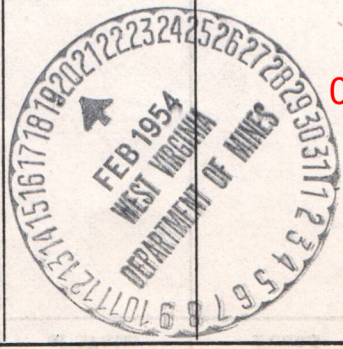

09/22/2023

B-5

STATE OF WEST VIRGINIA  
DEPARTMENT OF MINES  
OIL AND GAS DIVISION

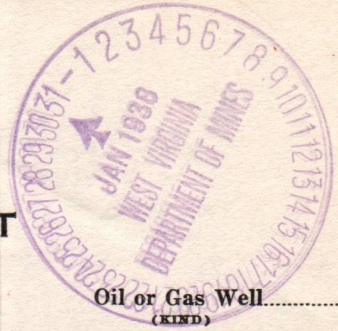

INSPECTOR'S WELL REPORT

Permit No. Wet 167 P.

Oil or Gas Well  
(KIND)

Company <u>Manuf. Light &amp; Heat Co</u>	Casing and Tubing	Used in Drilling	Left in Well	Packers
Address <u>Pittsburgh Pa.</u>	Size			
Farm <u>T. S. Guddard.</u>	16			Kind of Packer.....
Well No. <u>3555.</u>	13			Size of.....
District <u>Proctor</u> County <u>Wet.</u>	10			
Drilling commenced.....	8 1/4			
Drilling completed..... Total Depth.....	6 5/8			Depth set.....
Date shot..... Depth of shot.....	5 3/16			
Initial Open Flow...../10ths Water in..... Inch	3			Perf. top.....
Open Flow after tubing...../10ths Merc. in..... Inch	2			Perf. bottom.....
Volume..... Cu. Ft.	Liners Used.....			Perf. top.....
Rock Pressure..... lbs..... hrs.				Perf. bottom.....
Oil..... bbls., 1st 24 hrs.	CASING CEMENTED..... SIZE..... No. FT..... Date			
Fresh water..... feet..... feet	COAL WAS ENCOUNTERED AT..... FEET..... INCHES			
Salt water..... feet..... feet	..... FEET..... INCHES..... FEET..... INCHES			

Drillers' Names .....

Well Abandoned and Plugged....., 19.....

REMARKS: Completed plugging  
Blizzard today did not get to Geo Eagon wells as  
I intended to do.  
Jan 25 1938  
 DATE

[Signature]  
 DISTRICT WELL INSPECTOR

09/22/2023

STATE OF WEST VIRGINIA  
DEPARTMENT OF MINES  
OIL AND GAS DIVISION

INSPECTOR'S WELL REPORT

Oil or Gas Well  
No.

Permit No.

Company	Address	City	County	District	Well No.	Kind of Well	Lead in Drilling	Casing and Tubing	Lead in Well	Kind of Casing
							✓			

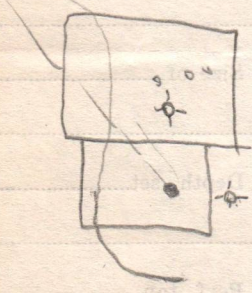

09/22/2023

B-9

PROPOSED MANNER OF PLUGGING AND FILLING WELL

(REQUIRED BY RULES AND REGULATIONS)

WEST VIRGINIA DEPARTMENT OF MINES

OIL AND GAS DIVISION

WORK ORDER

Well to be plugged and filled as follows:

<b>Total Depth,</b>	<b>2503</b>	<b>Cable Measurement</b>	
Red Mud	2503	- 2227	
Wood Plug	2227	- 2224	Lift 6 5/8" Casing
Cement	2224	- 2214	
Bridge at	2095		
Red Mud	2095	- 2050	
Wood Plug	2050	- 2047	
Cement	2047	- 2037	
Bridge at	1630		
Red Mud	1630	- 1580	
Wood Plug	1580	- 1577	
Cement	1577	- 1567	Lift 8 1/4" Casing
Bridge at	1066		30' Below Pgh. Coal
Cement	1066	- 1014	20' Above Pgh. Coal
<del>Monument</del>	1014	- 981	20' Above Mapletown Coal.
Red Mud	981	To Surface.	Lift 10" Casing

Erect Monument as per Rule 18.

WORK ORDER INTERPOSED BY THE DEPARTMENT OF MINES;

- Same as above to 2037'
- Set permanent bridge at 1910' - 30' below 2nd Sald Sand.
- 1 sack Cement on top of bridge.
- Fill with red Clay 1910' - 1770' - 20' above 1st Salt Sand.
- Wood plug 1770' - 1767'
- Cement 1767' - 1757' - Sealing Salt Sands above.
- Fill with Clay to 1595' - 10' below 8 1/4" Casing.
- Wood plug 1595' - 1592'
- Pull 8 1/4" Casing and
- Cement 1592' - 1582' - Sealing hole
- Set a permanent bridge 1116' - 30' below Pittsburgh Coal.
- Cement 1116' - 1064' - 20' above Pittsburgh Coal
- Clay 1064' - 1033' 30' below Mapletown Coal
- Cement 1033' - 981' - 20' above Mapletown Coal.
- Clay 981' - 520' - 10' below 10" Casing.
- Wood plug 520' - 517'
- Cement 517' - 512'
- Pull 10" Casing and
- Fill with Clay to surface

To the Department of Mines,  
Coal Owner or Operator,  
Lease or Property Owner.

Erect markers as per Rule 18, 1931 regulations

Gentlemen:

This "work order" is submitted for your approval and concurrence and unless notified of your disapproval or non-concurrence, the undersigned will proceed with the plugging and filling of said well in the above described manner on the date stated in the notice of intention to plug and abandon the said well on opposite side of this sheet.

Very truly yours, THE MANUFACTURERS LIGHT & HEAT CO.,

*Harry H. Fowler*

Land Dept. Office Mgr. Well Operator.

No objections have been filed by the coal owner or coal operator, or any available adjacent lease or property owners or interposed by the Department of Mines to the manner herein described for the plugging and filling of the well above mentioned. Therefore, the same is hereby approved this.....10th.....day

of.....December....., 193.7.....

DEPARTMENT OF MINES  
Oil and Gas Division

09/22/2023

By: .....

NOTE: This "work order" must be filed in duplicate, one copy for the files of the Department of Mines and the other to be approved or corrected and returned to the well operator as his authority for plugging said well.

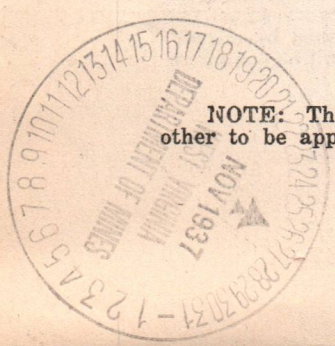

NOTICE OF INTENTION TO PLUG AND ABANDON WELL

(REQUIRED BY SECTION 9, ARTICLE 4, CHAPTER 22 OF THE CODE)

WEST VIRGINIA DEPARTMENT OF MINES

OIL AND GAS DIVISION

167-8

To THE DEPARTMENT OF MINES,  
Charleston, W. Va.

Roosevelt Coal & Coke Co.,  
COAL OPERATOR OR COAL OWNER

Wilmerding, Penn'a.  
ADDRESS

COAL OPERATOR OR COAL OWNER

ADDRESS

LEASE OR PROPERTY OWNER

ADDRESS

The Manufacturers Light & Heat Co

NAME OF WELL OPERATOR

800 Union Trust Building

Pittsburgh, Penna.  
COMPLETE ADDRESS

November 22nd, 19 37

WELL TO BE ABANDONED

Proctor District

Wetzel County

Well No. No. 1. No. 3555

Thurman Goddard Farm

Gentlemen:—

The undersigned well operator is about to abandon the above described well and will commence the

work of plugging and abandoning said well on the <sup>15th</sup> 1st day of December, 19 37,  
(which date shall not be less than five days after the day on which this notice so mailed is received, or in  
due course should be received by the Department of Mines).

This notice is given you in order that your respective representatives may be present at the plugging  
and filling of said well. You are further notified that whether you are represented or not represented the  
undersigned will proceed on that date, or shortly thereafter, to plug and fill said well in the manner  
required by Section 10, Article 4, Chapter 22 of the Code and given in detail on the reverse side of this  
notice, in "Work Order."

This notice is being mailed by registered mail to each of you at the above addresses on the above date.

Very truly yours,

THE MANUFACTURERS LIGHT & HEAT COMPANY,

Harry H. Fowler

Land Dept. Office Mgr. Well Operator.

NOTE: Upon the abandonment of all wells drilled prior to June 1, 1929, a plat prepared by a competent en-  
gineer, showing the district and county in which the tract of land is located, the name and acreage of same, the  
names of the owners of adjacent tracts, and the location of the about to be abandoned well, determined by 1929  
and the courses and distances of such well from two permanent points or landmarks on said tract, shall be submitted  
with this notice.

09/22/2023

(Over)



**AFFIDAVIT IN TRIPLICATE TO TIME AND MANNER OF  
PLUGGING AND FILLING WELL**

(REQUIRED BY SECTION 9, ARTICLE 4, CHAPTER 22 OF THE CODE)

**WEST VIRGINIA DEPARTMENT OF MINES  
OIL AND GAS DIVISION**

Roosevelt Coal & Coke Company  
COAL OPERATOR OR OWNER

Wilmerding, Penna.  
ADDRESS

COAL OPERATOR OR OWNER

ADDRESS

LEASE OR PROPERTY OWNER

ADDRESS

The Manufacturers Light & Heat Company  
NAME OF WELL OPERATOR

800 Union Trust Bldg., Pittsburgh Pa.  
COMPLETE ADDRESS

Jan. 19th 1938 19  
WELL AND LOCATION

Proctor District

Wetzel County

Well No. 1 - 3555

Thurman Goddard Farm

AFFIDAVIT TO BE MADE IN TRIPLICATE, ONE COPY TO BE MAILED BY REGISTERED MAIL TO THE DEPARTMENT, ONE COPY TO BE RETAINED BY THE WELL OPERATOR AND THE THIRD COPY (AND EXTRA COPIES IF REQUIRED) TO BE MAILED TO EACH COAL OPERATOR ABOVE NAMED AT THEIR RESPECTIVE ADDRESSES.

**AFFIDAVIT**

STATE OF WEST VIRGINIA,  
COUNTY OF Wetzel } SS:

M. E. Hawkins and Charles Hebrack

being first duly sworn according to law depose and say that they are experienced in the work of plugging and filling oil and gas wells and were employed by The Manufacturers Light & Heat Co., well operator, and participated in the work of plugging and filling the above well, that said work was commenced on the 27th day of December, 1937, and that the well was plugged and filled in the following manner:

Manner in which sand was plugged: Red mud 2503-2227, Wood plug 2227-2224, Lifted 6 5/8" casing, Cement 2224-2214, Bridged @ 2095, Red mud 2095-2050, Wood plug 2050-2047, Cement 2047-2037, Bridged @ ~~20~~ 1910, 1 sack of cement on top of bridge, Red clay 1910-1770, Wood plug 1770-1767, Cement 1767-1757, Red mud 1757-1595, Wood plug 1595-1592, Lifted 8 1/4" Casing, Cement 1592-1582, Bridged @ 1116.

Manner in which coal was plugged: Cement 1116-1064, Clay 1064-1033, Cement 1033-981, Clay 981-520, Wood plug 520-517, Cement 517-512, Lifted 10" casing, Clay 512 to surface.

Description of monument: Erected as per Rule # 18.

(THE ABOVE DESCRIPTION MUST BE IN DETAIL AND IN ACCORDANCE WITH THE PROVISIONS OF SECTION 10, ARTICLE 4, CHAPTER 22 OF THE CODE)

and that the work of plugging and filling said well was completed on the 13th day of January, 1938.

And further deponents saith not.

Sworn to and subscribed before me this 22nd day of January, 1938.

My Commission expires:  
Sept. 26th 1940.

M. E. Hawkins  
C. S. Hebrack  
H. A. Morgan  
Notary Public.

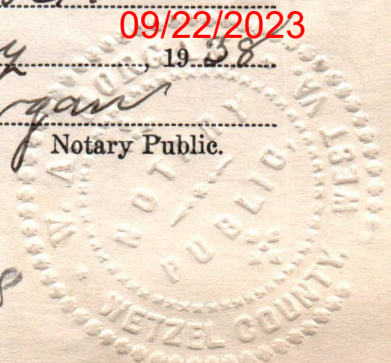
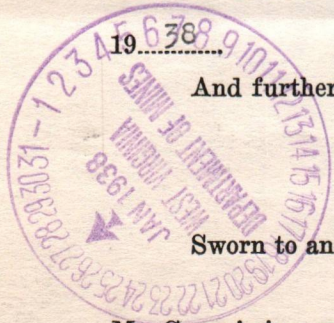

Net-167-8

WEST VIRGINIA DEPARTMENT OF MINES  
OIL AND GAS DIVISION  
AFFIDAVIT IN TRIPLICATE TO TIME AND MANNER OF  
PLUGGING AND FILLING WELL  
(PREPARED BY SECTION ON ARTICLE 4, CHAPTER 22 OF THE CODE)

The Landlord's name is \_\_\_\_\_  
The name of the well is \_\_\_\_\_

The name of the owner is \_\_\_\_\_  
The name of the well is \_\_\_\_\_

Well No. 1 - 2222  
District \_\_\_\_\_  
County \_\_\_\_\_

Well No. 1 - 2222  
District \_\_\_\_\_  
County \_\_\_\_\_

Plugged \_\_\_\_\_  
Filled \_\_\_\_\_

Plugged \_\_\_\_\_  
Filled \_\_\_\_\_

I, the undersigned, being duly sworn, depose and say that the above well was plugged and filled in \_\_\_\_\_ day of \_\_\_\_\_, 1927, and that the well was plugged and filled in \_\_\_\_\_ day of \_\_\_\_\_, 1927.

AFFIDAVIT

STATE OF WEST VIRGINIA

COUNTY OF \_\_\_\_\_

and \_\_\_\_\_  
being first duly sworn according to law depose and say that they are experienced in the work of plugging and filling oil and gas wells and were employed by \_\_\_\_\_ well operator and participated in the work of plugging and filling the above well, that said work was commenced on the \_\_\_\_\_ day of \_\_\_\_\_, 1927, and that the well was plugged and filled in \_\_\_\_\_ day of \_\_\_\_\_, 1927.

Manner in which well was plugged: \_\_\_\_\_  
Manner in which well was filled: \_\_\_\_\_

Description of monument, placed as per \_\_\_\_\_

and that the work of plugging and filling said well was completed on the \_\_\_\_\_ day of \_\_\_\_\_, 1927.

And further deponents with me

09/22/2023



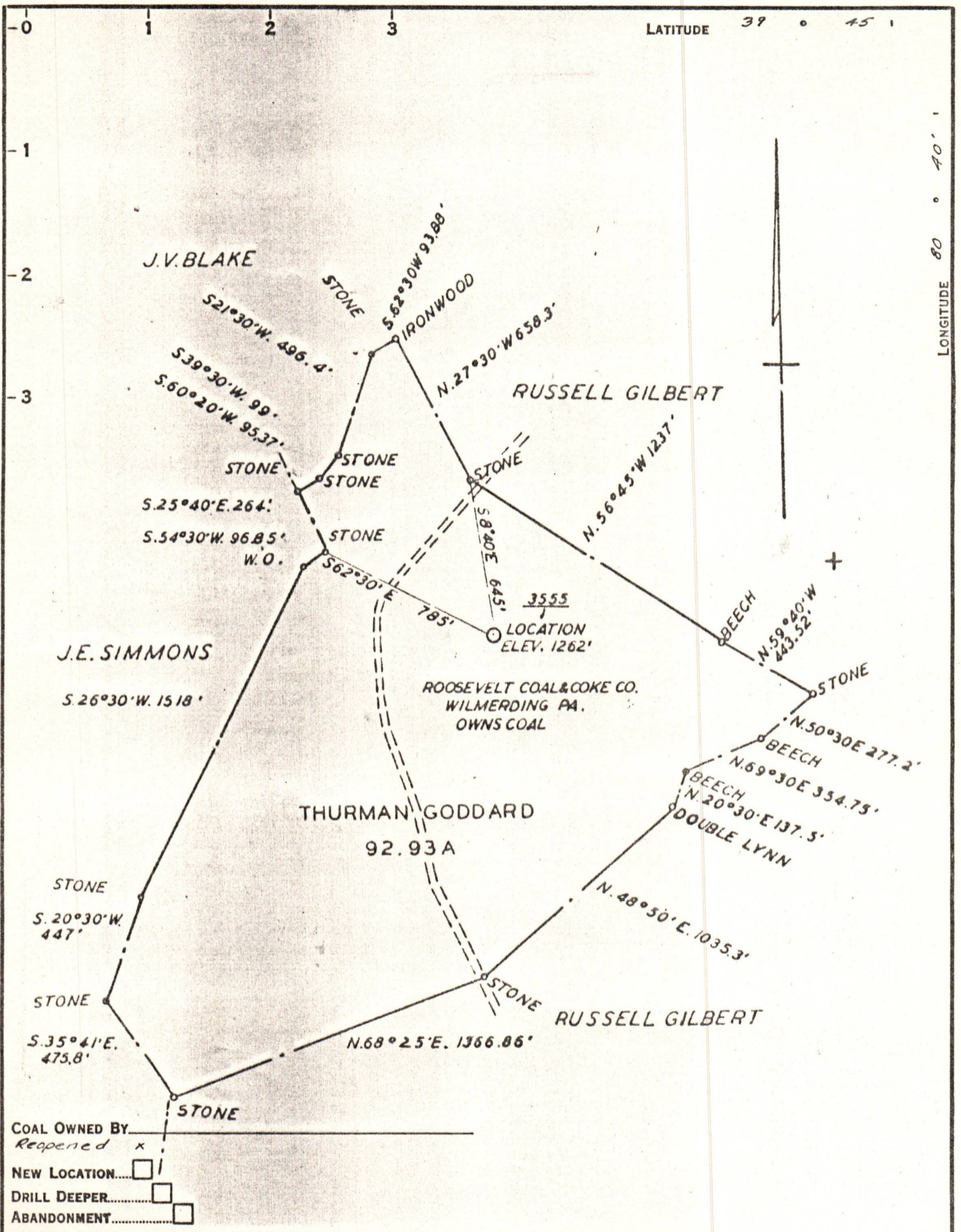

COAL OWNED BY \_\_\_\_\_  
 Requested  x  
 NEW LOCATION   
 DRILL DEEPER   
 ABANDONMENT

COMPANY The Manufacturers Light & Heat Co.  
 ADDRESS 800 Union Trust Bldg. Pgh. Pa.  
 FARM Thurman Goddard  
 TRACT 1 ACRES 92.93 LEASE NO. 26909  
 WELL (FARM) NO. 1 SERIAL NO. 3555  
 ELEVATION (SPIRIT LEVEL) 1262'  
 QUADRANGLE Littleton  
 COUNTY Wetzel DISTRICT Prator  
 ENGINEER John A. Loudon  
 ENGINEER'S REGISTRATION NO. 12710  
 FILE NO. \_\_\_\_\_ DRAWING NO. V-13-880  
 DATE 18 Aug. 1953 SCALE 1" = 800'

STATE OF WEST VIRGINIA  
 DEPARTMENT OF MINES  
 OIL AND GAS DIVISION  
 CHARLESTON

WELL LOCATION MAP  
 FILE NO. Wet-167-Redrill

+ DENOTES LOCATION OF WELL ON UNITED STATES TOPOGRAPHIC MAPS, SCALE 1 TO 62,500, LATITUDE AND LONGITUDE LINES BEING REPRESENTED BY BORDER LINES AS SHOWN.  
 — DENOTES ONE INCH SPACES ON BORDER LINE OF ORIGINAL TRACING.

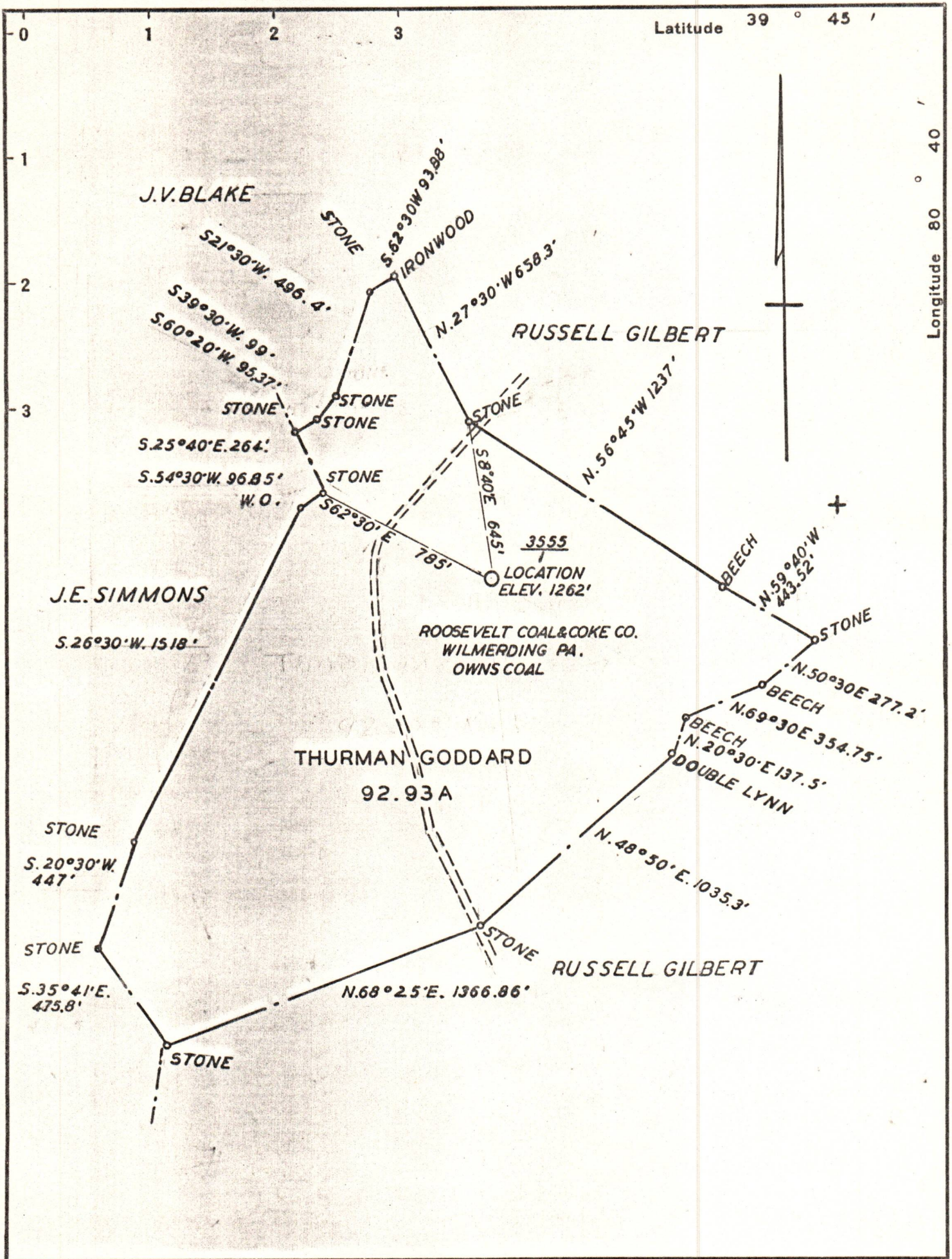

Company THE MANUFACTURERS LIGHT & HEAT CO.  
 Address PITTSBURGH PA  
 Farm THURMAN GODDARD  
 Tract 1 Acres 92.93 Lease No. 17172  
 Well (Farm) No. 1 Serial No. 3555  
 Elevation (Spirit Level) 1262 FT.  
 Quadrangle LITTLETON N.W. 1/4  
 County WETZEL District PROCTOR  
 Engineer Russell  
 Engineer's Registration No. \_\_\_\_\_  
 File No. \_\_\_\_\_ Drawing No. Y-7 798  
 Date AUG 27-1937 Scale 1" = 500'

STATE OF WEST VIRGINIA  
 DEPARTMENT OF MINES  
 OIL AND GAS DIVISION  
 CHARLESTON

**WELL LOCATION MAP**  
 FILE NO. WET-167

09/22/2023

+ Denotes location of well on United States Topographic Maps, scale 1 to 62,500, latitude and longitude lines being represented by border lines as shown.

- Denotes one inch spaces on border line of original tracing.