

NOTICE OF PROPOSED LOCATION OF OIL AND GAS WELL

(REQUIRED BY SECTION 2, CHAPTER 22, CODE 1931)

WEST VIRGINIA DEPARTMENT OF MINES

OIL AND GAS SECTION

To THE DEPARTMENT OF MINES,
Charleston, W. Va.

Clarence Blatt

COAL OPERATOR OR COAL OWNER

J. H. Ferrell

NAME OF WELL OPERATOR

Beebe, W. Va.

ADDRESS

Grantsville, W. Va.

COMPLETE ADDRESS

November 2, 1938

PROPOSED LOCATION

Procter

District

Wetzel

County

Clarence Blatt

OWNER OF MINERAL RIGHTS

Well No. 1

Beebe, W. Va.

ADDRESS

Clarence Blatt

Farm

GENTLEMEN:

The undersigned well operator is entitled to drill upon the above named farm or tract of land for oil and gas, having fee title thereto, (or as the case may be) under grant or lease dated Sept.

17th, 1938

, made by Clarence Blatt et al

J. H. Ferrell

, and recorded on the 17th day

of September 1938

, in the office of the County Clerk for said County in

Book 33A, page 38.

The enclosed plat was prepared by a competent engineer and shows the proposed location of a well to be drilled for oil and gas by the undersigned well operator on the farm and in the Magisterial District and County above named, determined by survey and courses and distances from two permanent points, or land marks.

The undersigned well operator is informed and believes there are no coal operators operating beds of coal beneath said farm or tract of land on which said well is located, or within 500 feet of the boundaries of the same, who have mapped their workings and filed their maps as required by law, excepting the coal operators or coal owners (if any) above named as addressees.

The above named coal operators or coal owners (if any) are notified that any objections they may desire to make to such proposed location, or which they are required to make by Section 3 of said Code, if the drilling of a well at said proposed location will cause a dangerous condition in or about their respective coal mines, must be received by, or filed with the Department of Mines within ten* days from the receipt of a copy of this notice and accompanying plat by said Department. Said coal operators are further notified that forms for use in making such objections will be furnished to them by the Department of Mines promptly on request and that all such objections must set forth as definitely as is reasonably possible the ground or grounds on which such objections are based and indicate the direction and distance the proposed location should be moved to overcome same.

(The next paragraph is to be completed only in Department's copy.)

Copies of this notice and the enclosed plat were mailed by registered mail, or delivered to the above named coal operators or coal owners at their above shown respective address _____ day _____ before, or on the same day with the mailing or delivery of this copy to the Department of Mines at Charleston, West Virginia.

Very truly yours,

J. H. Ferrell
WELL OPERATOR

Grantsville
STREET

W. Va
CITY OR TOWN

STATE

09/22/2023



Address of Well Operator }

*Section 3 . . . If no such objections be filed, or be found by the department of mines, within said period of ten days from the receipt of said notice and plat by the department of mines, to said proposed location, the department shall forthwith issue to the well operator a drilling permit reciting the filing of such plat, that no objections have been made by the coal operators to the location, or found thereto by the department, and that the same is approved and the well operator authorized to proceed to drill at said location.



NOTICE OF PROPOSED LOCATION OF OIL AND GAS WELL

ISSUED BY SECTION 2, DEPARTMENT OF MINES, WEST VIRGINIA

WEST VIRGINIA DEPARTMENT OF MINES

OIL AND GAS SECTION

In the Department of Mines
Charleston, W. Va.

NAME OF WELL OPERATOR	LOCAL OPERATOR OR COAL OWNER
ADDRESS	ADDRESS
PROPOSED LOCATION	COAL OPERATOR OR COAL OWNER
ADDRESS	ADDRESS
NAME OF MINERAL RIGHTS	ADDRESS
ADDRESS	ADDRESS

The undersigned operator is entitled to drill upon the above named tract of land for oil and gas having the title thereto or as the same may hereafter be acquired by the operator.

and is located on the _____
in the office of the County Clerk for said County in _____

The above named well operator is authorized and believes there are no well operators operating in or about the tract of land on which said well is located or within the foot of the board of the same who have inspected their workings and find them conforming to the provisions of the Coal Mines Act of 1900.

The undersigned well operator is authorized and believes there are no well operators operating in or about the tract of land on which said well is located or within the foot of the board of the same who have inspected their workings and find them conforming to the provisions of the Coal Mines Act of 1900.

Copies of this notice and the location map as required shall be delivered to the above named coal operators or coal owners at their above shown respective addresses before _____ day _____ 19____ or on the same day with the mailing of this copy to the Department of Mines at Charleston, West Virginia.

Very truly yours,

WELL OPERATOR	Address of Well Operator
ADDRESS	
CITY OR TOWN	
STATE	



09/22/2023

Section 2, Department of Mines, West Virginia, is authorized to issue this notice and the location map as required by the provisions of the Coal Mines Act of 1900.



STATE OF WEST VIRGINIA
DEPARTMENT OF MINES
OIL AND GAS DIVISION

NOTICE OF PROPOSED LOCATION OF OIL AND GAS WELL

To THE DEPARTMENT OF MINES,
Charleston, W. Va.

Redrill

Everett F. Moore
COAL OPERATOR OR COAL OWNER
Moundsville
West Virginia
ADDRESS

THE MANUFACTURERS LIGHT AND HEAT COMPANY
NAME OF WELL OPERATOR
800 Union Trust Building
Pittsburgh, Pennsylvania
COMPLETE ADDRESS

COAL OPERATOR OR COAL OWNER
ADDRESS

August 21, 1953

PROPOSED LOCATION

Proctor District

Wetzel County

OWNER OF MINERAL RIGHTS
ADDRESS

Well No. F-15652 39° 45' 2-4761
80° 40'

Clarence Blatt Farm

GENTLEMEN:

The undersigned well operator is entitled to drill upon the above named farm or tract of land for oil and gas, having fee title thereto, (or as the case may be) under grant or lease dated March 10, 1952, made by Clarence Blatt, et al, to The Manufacturers Light and Heat Company, and recorded on the 17th day of April, 1952, in the office of the County Clerk for said County in O. & G. Book 40, page 46.

The enclosed plat was prepared by a competent engineer and shows the proposed location of a well to be drilled for oil and gas by the undersigned well operator on the farm and in the Magisterial District and County above named, determined by survey and courses and distances from two permanent points, or land marks.

The undersigned well operator is informed and believes there are no coal operators operating beds of coal beneath said farm or tract of land on which said well is located, or within 500 feet of the boundaries of the same, who have mapped their workings and filed their maps as required by law, excepting the coal operators or coal owners (if any) above named as addressees.

The above named coal operators or coal owners (if any) are notified that any objections they may desire to make to such proposed location, or which they are required to make by Section 3 of said Code, if the drilling of a well at said proposed location will cause a dangerous condition in or about their respective coal mines, must be received by, or filed with the Department of Mines within ten* days from the receipt of a copy of this notice and accompanying plat by said Department. Said coal operators are further notified that forms for use in making such objections will be furnished to them by the Department of Mines promptly on request and that all such objections must set forth as definitely as is reasonably possible the ground or grounds on which such objections are based and indicate the direction and distance the proposed location should be moved to overcome same.

(The next paragraph is to be completed only in Department's copy.)

Copies of this notice and the enclosed plat were mailed by registered mail, or delivered to the above named coal operators or coal owners at their above shown respective address _____ day _____ before, or on the same day with the mailing or delivery of this copy to the Department of Mines at Charleston, West Virginia.

Very truly yours,

Paul F. Wood
ASST. LAND AGT. ~~INVESTIGATOR~~

Address of Well Operator }

THE MANUFACTURERS LIGHT AND HEAT CO
STREET
800 Union Trust Building
CITY OR TOWN
Pittsburgh, Pennsylvania
STATE

09/22/2023

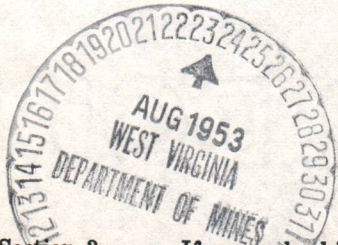

*Section 3 If no such objections be filed or be found by the department of mines, within said period of ten days from the receipt of said notice and plat by the department of mines, to said proposed location, the department shall forthwith issue to the well operator a drilling permit reciting the filing of such plat, that no objections have been made by the coal operators to the location, or found thereto by the department, and that the same is approved and the well operator authorized to proceed to drill at said location.

208



STATE OF WEST VIRGINIA
DEPARTMENT OF MINES
OIL AND GAS DIVISION

NOTICE OF PROPOSED LOCATION OF OIL AND GAS WELL

To The Department of Mines
Charleston, W. Va.

Red Hill

THE MANUFACTURERS LIGHT AND HEAT COMPANY
300 Union Trust Building
Pittsburgh, Pennsylvania
COMPLETE ADDRESS

Everett F. Moore
Coal Operator or Coal Owner
Moundsville
West Virginia
ADDRESS

August 21, 1953
PROPOSED LOCATION

COAL OPERATOR OR COAL OWNER

Proctor
District
Wetzel
County

ADDRESS

Well No. T-15522
CLARENCE BLATT

OWNER OF MINERAL RIGHTS

CLARENCE BLATT

ADDRESS

GENTLEMEN:

The undersigned well operator is entitled to drill upon the above named farm or tract of land for oil and gas, having fee title thereto, (or as the case may be) under grant or lease dated March 10, 1952, whereby Clarence Blatt, of said County, West Virginia, and recorded on the 11th day of April, 1952, in the office of the County Clerk for said County in

Book 40 page 46

The enclosed plat was prepared by a competent engineer and shows the proposed location of a well to be drilled for oil and gas by the undersigned well operator on the farm and in the Mineral District and County above named, determined by survey and courses and distances from two permanent points, or land marks.

The undersigned well operator is informed and believes there are no coal operators operating beds of coal beneath said farm or tract of land on which said well is located, or within 500 feet of the boundary of the same, who have mapped their workings and filed their maps as required by law, excepting the coal operators or coal owners (if any) above named as addressees.

The above named coal operators or coal owners (if any) are notified that any objections they may desire to make to such proposed location, or which they are required to make by Section 8 of said Code, if the drilling of a well at said proposed location will cause a dangerous condition in or about their respective coal mines, must be received by or filed with the Department of Mines within ten days from the receipt of a copy of this notice and accompanying plat by said Department. Said coal operators are further notified that forms for use in making such objections will be furnished to them by the Department of Mines promptly on request and that all such objections must set forth as definitely as is reasonably possible the ground or grounds on which such objections are based and indicate the direction and distance the proposed location should be moved to overcome same.

(The next paragraph is to be completed only in Department's copy.)
Copies of this notice and the enclosed plat were mailed by registered mail, or delivered to the above named coal operators or coal owners at their above shown respective address _____ day _____ before _____ or on the same day with the mailing or delivery of this copy to the Department of Mines at Charleston, West Virginia.

Very truly yours,

ASST. LAND AGT.

THE MANUFACTURERS LIGHT AND HEAT CO
300 Union Trust Building
Pittsburgh, Pennsylvania

Address of Well Operator



09/22/2023

Section 8. If no such objections be filed or be found by the department of mines within said period of ten days from the receipt of said notice and plat by the department of mines, to said proposed location, the department shall forthwith issue to the well operator a drilling permit, vesting the right of such plat, that no objections have been made by the coal operators to the location, or found thereby by the department, and that the same is approved and the well operator authorized to proceed to drill at said location.

Permit Number WVT-302-9
Red Hill

A-10



STATE OF WEST VIRGINIA
DEPARTMENT OF MINES
CHARLESTON

N. P. RHINEHART
CHIEF

November 14, 1938

Mr. Bruce Ferrell, Jr.
Grantsville, West Virginia

Dear Mr. Ferrell:

We are returning tracing for the Clarence Blatt Well No. 1, Proctor District, Wetzel County, for correction.

You have failed to show the quadrangle which we presume to be "New Martinsville" However, if it is in the New Martinsville quadrangle then the longitude is not correct.

We are also enclosing the W. S. Dailey tracing for location on the S. M. Maze tract, as you have failed to show the well number both on the tracing proper and in the footnote.

Please check and make the necessary corrections.

Very truly yours,

Marie E. Fizzith
Secretary
OIL AND GAS DIVISION

Bruce Ferrell

I have corrected the within plats, Thanks

MG/ar
enc-2

File Wet-208

Littleton

No. 1

A-11

November 15, 1938

Mr. J. H. Ferrell
Grantsville, W. Va.

Dear Sir:

Permit Wet-208 to drill Well No. 1 on
the Clarence Blatt Farm, Proctor District, Wetzel
County, is enclosed.

Duplicate permit shall be posted on the rig.

When well is completed, please file complete
record on the enclosed Form OG-10.

Very truly yours,

Secretary
OIL AND GAS DIVISION

MG/ar
enc-2

09/22/2023

A-12

September 3, 1953

The Manufacturers Light & Heat Company
800 Union Trust Building
Pittsburgh 19, Pennsylvania

Gentlemen:

Enclosed is permit WET-208-Redrill for the reopening of Well No. F-15652 (J. H. Ferrell #1) on the Clarence Elatt Farm, Proctor District, Wetzel County.

Very truly yours,

Administrative Assistant
OIL AND GAS DIVISION

MG:g
encl

cc: Mr. D. F. Desist, Inspector
Mr. R. C. Tucker, Assistant State
Geologist

09/22/2023

B-2

Formation	Color	Hard or Soft	Top	Bottom	Oil, Gas or Water	Depth Found	Remarks
					WATER	2090'	
Slate	Black	Soft	2122	2130			
MAXON			2170	2202			
slate			2202	2212			
BIG LIME			2212	2230			
BIG INJUN			2230	2480			
Slate			2480	2625'			
Berea Grit			2725	2975			
Slate & Shells			2975	2828			
Sand			2828	2832			
Lime shells			2832	28 80			
Slate			2880	2910			
Red Rock			2910	2990'			
Slate and shells			2990	3000			
Sand			3000	3020			
Slate			3020	3030			
shell			3030	3060			
GORDON			3085				
Fourth			3112	3125			
Shells			3125	3140			
Total Depth				3235			

22 35' - 5 3/16'

09/22/2023

MEET RECORD

Date....., 19.....

APPROVED....., Owner

By..... (Title)

STATE OF WEST VIRGINIA
DEPARTMENT OF MINES
OIL AND GAS DIVISION

Tyler Hotel - Sistersville, W. Va.

WELL RECORD

Permit No. Wet-208

Oil or Gas Well DRY
(Kind)

Company J. H. Ferrell
Address Grantsville, West Virginia
Farm Clarence Blatt Acres 45
Location (waters) _____
Well No. 1 Elev. 1265'
District Proctor County Wetzel
The surface of tract is owned in fee by _____
Address _____
Mineral rights are owned by Clarence Blatt
Address Bebee, W. Va.
Drilling commenced October 14, 1938
Drilling completed November 5, 1938
Date shot _____ Depth of shot _____
Open Flow /10ths Water in _____ Inch
/10ths Merc. in _____ Inch
Volume _____ Cu. Ft.
Rock Pressure _____ lbs. _____ hrs.
Oil _____ bbls., 1st 24 hrs.
Fresh water _____ feet _____ feet
Salt water _____ feet _____ feet

Casing and Tubing	Used in Drilling	Left in Well	Packers
Size			
16.			Kind of Packer
13.			
10.	290	290	Size of
8 1/4.	1107	1107	
6 5/8.	1580	1580	Depth set
5 3/16.	2235	2235	
3.			Perf. top
2.			Perf. bottom
Liners Used			Perf. top
			Perf. bottom

CASING CEMENTED _____ SIZE _____ No. FT. _____ Date _____
COAL WAS ENCOUNTERED AT _____ FEET _____ INCHES
_____ FEET _____ INCHES _____ FEET _____ INCHES
_____ FEET _____ INCHES _____ FEET _____ INCHES

Formation	Color	Hard or Soft	Top	Bottom	Oil Gas or Water	Depth Found	Remarks
Clay	yellow	soft	0	14			
Sand	yellow	soft	14	35			
slate	white	soft	35	90			
Red Rock	red	"	90	110			
Sand	yellow	"	110	150			
Slate & Lime	white	"	150	190			
Lime	White	hard	190	220	water 220		
Slate			220	255			
Lime	White	hard	255	265			
Red Rock	Red	Soft	265	275			
Slate	white	"	275	370	290' - 10"		
Red Rock	Red	"	370	380			
Slate	White	"	380	495			
Red Rock	Red	"	495	500			
Slate shells			500	715			
Sand	White	Hard	715	735			
Slate	White	soft	735	780			
Lime	White	Hard	780	790			
Red Rock	Red	soft	790	810			
Slate & Lime	White	Hard	810	840			
Lime	White	Hard	840	955			
Mapletown Coal		Soft	955	960			
Lime	White	Hard	960	1076			
PITTSBURGH COAL		Soft	1076	1084	water		
Slate	White	Soft	1084	1110			
Red Rock	Red	Soft	1110	1145	1107' - 8 1/4"		
Sand	White	Hard	1145	1160			
Slate	White	Hard	1160	1185			
Red Rock	Red	Soft	1185	1285			
Slate	White	Soft	1285	1350			
Red Rock	Red	Soft	1350	1360			
Slate			1360	1425			
LITTLE DUNKARD		Hard	1425	1460			
Slate			1460	1548			
Red Rock	Red	Soft	1548	1560			
Slate	White	Soft	1560	1580	1580' - 6 5/8"		
Lime	White	Hard	1580	1610			
Slate	White	Soft	1610	1640			
Sand		Hard	1640	1675			
Slate & Shells		Soft	1675	2070			
Lime	Dark	Hard	2070	2082			
Sand	White	Soft	2082	2122			

09/22/2023

B-3



STATE OF WEST VIRGINIA DEPARTMENT OF MINES OIL AND GAS DIVISION

WELL RECORD

Permit No. WET-208-Redrill

Oil or Gas Well Stor. (KIND)

Company THE MANUFACTURERS LIGHT AND HEAT CO. Address 800 Union Trust Bldg., Pgh., Penna. Farm Clarence Blatt Acres 45 Location (waters) Well No. 2-4261 Elev. 1254.4' District Proctor County Wetzel The surface of tract is owned in fee by Mineral rights are owned by Drilling commenced June 2, 1953 Drilling completed March 12, 1954 Date Shot From To With Open Flow 0/10ths Water in 3/8 Inch /10ths Merc. in Inch Volume 0000 Cu. Ft. Rock Pressure 0 lbs. hrs. Oil bbls., 1st 24 hrs. Fresh water feet feet Salt water feet feet

Table with columns: Casing and Tubing, Used in Drilling, Left in Well, Packers. Rows include sizes 16, 13, 10, 8 1/4, 7, 5 3/16, 4, and Liners Used.

Table with columns: CASING CEMENTED, SIZE, No. Ft., Date. COAL WAS ENCOUNTERED AT FEET INCHES.

Main well log table with columns: Formation, Color, Hard or Soft, Top, Bottom, Oil, Gas or Water, Depth Found, Remarks. Includes entries for Maxon Sand, Lead Plug Set, and Schlumberger Measurement.

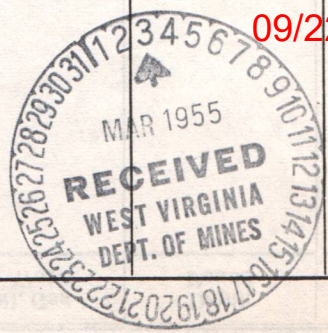

09/22/2023

B-9

PROPOSED MANNER OF PLUGGING AND FILLING WELL

(REQUIRED BY RULES AND REGULATIONS)

WEST VIRGINIA DEPARTMENT OF MINES

OIL AND GAS DIVISION

WORK ORDER

Well to be plugged and filled as follows:

WORK ORDER ARRANGED BY THE DEPARTMENT OF MINES

Total Depth	3235'
Fill with red clay	3235' - 3065' - 20' above Gordon Sand.
Wood Plug	3065' - 3062'
1 sack cement on plug.	
Set a permanent bridge at	2480' - bottom of Big Injun Sand.
1 sack cement on bridge.	
Fill with red clay	2480' - 2255' - 20' below 5-3/16" casing
Wood Plug	2255' - 2253'
Cement	2253' - 2243' - Sealing Big Injun Sand.
Pull 5-3/16" casing.	
Continue to fill with red clay to	1590' - 10' below 6-5/8" casing.
Wood Plug	1590' - 1587'
Pull 6-5/8" casing.	
Fill with red clay	1587' - 1400' - 25' above Little Dunkar
Cement	1400' - 1390' - sealing hcle.
Set a permanent bridge	1130' - 23' below 8 1/2" casing.
1 sack cement on bridge.	
Red Clay	1130' - 1114' - 30' below Pittsburgh Co
Cement	1114' - 1056' - 20' above Pittsburgh "
Red Clay	1056' - 990' - 30' below Mapletown Coal
Cement	990' - 935' - 20' above Mapletown Coal
Red Clay	935' - 300' - 10' below 10" casing.
Wood Plug	300' - 290'
1 sack cement on plug.	
Red Clay to surface.	
Erect Marker such as is required by Rule 18, 1931 regulations.	
NOTE: CEMENT FOR MAKING CEMENT PLUGS BE MIXED WITH WATER ONLY--APPROXIMATELY FIVE GAL WATER TO ONE SACK CEMENT.	

To the Department of Mines
Coal Owner or Operator,
Lease or Property Owner.

Gentlemen:

This "work order" is submitted for your approval and concurrence and unless notified of your disapproval or non-concurrence, the undersigned will proceed with the plugging and filling of said well in the above described manner on the date stated in the notice of intention to plug and abandon the said well on opposite side of this sheet.

Very truly yours,

Well Operator.

No objections have been filed by the coal owner or coal operator, or any available adjacent lease or property owners or interposed by the Department of Mines to the manner herein described for the plugging and filling of the well above mentioned. Therefore, the same is hereby approved this.....day

of January 9, 1939

DEPARTMENT OF MINES
Oil and Gas Division 09/22/2023

By:

NOTE: This "work order" shall be filed in triplicate, one copy for the files of the Department of Mines; one to be approved or corrected and returned to the well operator as his authority for plugging said well; and one for the well inspector.

STATE OF WEST VIRGINIA
DEPARTMENT OF MINES
OIL AND GAS DIVISION

NOTICE OF INTENTION TO PLUG AND ABANDON WELL
(REQUIRED BY SECTION 9, ARTICLE 4, CHAPTER 22 OF THE CODE)

To THE DEPARTMENT OF MINES,
Charleston, W. Va.

.....
COAL OPERATOR OR COAL OWNER
.....
ADDRESS
.....
COAL OPERATOR OR COAL OWNER
.....
ADDRESS
.....
LEASE OR PROPERTY OWNER
.....
ADDRESS

..... J. H. Ferrell
NAME OF WELL OPERATOR
..... Grantsville, W. Va.
COMPLETE ADDRESS
..... January 23, 19 39
WELL TO BE ABANDONED
..... Proctor District
..... Wetzel County
Well No. 1
..... Clarence Blatt Farm

Gentlemen:—

The undersigned well operator is about to abandon the above described well and will commence the work of plugging and abandoning said well on the 28th day of January, 19 39, (which date shall not be less than five days after the day on which this notice so mailed is received, or in due course should be received by the Department of Mines.)

This notice is given you in order that your respective representatives may be present at the plugging and filling of said well. You are further notified that whether you are represented or not represented the undersigned will proceed on that date, or shortly thereafter, to plug and fill said well in the manner required by Section 10, Article 4, Chapter 22 of the Code and given in detail on the reverse side of this notice, in "Work Order."

This notice is being mailed by registered mail to each of you at the above addresses on the above date.

Very truly yours,

J. H. Ferrell
.....
Well Operator.

NOTE: Upon the abandonment of all wells drilled prior to June 1, 1929, a plat prepared by a competent engineer, showing the district and county in which the tract of land is located, the name and acreage of same, the names of the owners of adjacent tracts, and the location of the about to be abandoned well determined by survey, and the courses and distances of such well from two permanent points or landmarks on said tract, shall be submitted with this notice.

(Over)

WET-208-P PERMIT NUMBER

09/22/2023

STATE OF WEST VIRGINIA
DEPARTMENT OF MINES
OIL AND GAS DIVISION

AFFIDAVIT OF PLUGGING AND FILLING WELL

AFFIDAVIT SHOULD BE MADE IN TRIPPLICATE, ONE COPY MAILED TO THE DEPARTMENT, ONE COPY TO BE RETAINED BY THE WELL OPERATOR AND THE THIRD COPY (AND EXTRA COPIES IF REQUIRED) SHOULD BE MAILED TO EACH COAL OPERATOR AT THEIR RESPECTIVE ADDRESSES.

None	J. H. Ferrell
COAL OPERATOR OR OWNER	NAME OF WELL OPERATOR
	Grantsville, W. Va.
ADDRESS	COMPLETE ADDRESS
	May 14th, 1942
COAL OPERATOR OR OWNER	WELL AND LOCATION
	Proctor District
ADDRESS	
Clarence Blatt	Wetzel County
LEASE OR PROPERTY OWNER	
Bebee, W. Va.	Well No. One
ADDRESS	
	Clarence Blatt Farm

STATE INSPECTOR SUPERVISING PLUGGING.....

AFFIDAVIT

STATE OF WEST VIRGINIA,
County of Calhoun } SS:

J. H. Ferrell and F. D. Pyles
being first duly sworn according to law depose and say that they are experienced in the work of plugging and filling oil and gas wells and were employed by J. H. Ferrell, well operator, and participated in the work of plugging and filling the above well, that said work was commenced on the 28th day of January, 1939, 194, and that the well was plugged and filled in the following manner:

SAND OR ZONE RECORD	FILLING MATERIAL			PLUGS USED	CASING	
	FORMATION	CONTENT	FROM TO		SIZE & KIND	CSG PULLED
		Red clay	3235 3065	5-3/16" Wood		
		Cement	3062 3055			
		Stone bridge	2492 2478			
		Cement	2478 2472			
		Red clay	2472 2255	5-3/16" Wood		
		Cement	2255 2243		5-3/16"	
		Red clay	2243 1592	6-5/8" Wood		
		Red clay	1589 1394			
		Cement	1394 1383		6-5/8"	
		Stone bridge	1142 1130		8 1/2"	
		Cement	1130 1120			
		Red clay	1120 1112			
		Cement	1112 1054			
		Red clay	1054 988-			
		Cement	988 932	10" Wood	10"	
COAL SEAMS		Red clay	932 300	DESCRIPTION OF MONUMENT		
(NAME) Pittsburgh		Cement	297 287	6" casing set 4' in the ground		
(NAME) Mapletown		Red clay	287 0	and filled with concrete and extending 34" above the surface		
(NAME)						
(NAME)						

and that the work of plugging and filling said well was completed on the 15th day of February, 1939, 194.

And further deponents saith not.

J. H. Ferrell
F. D. Pyles
09/22/2023

Sworn to and subscribed before me this 14th day of May, 1942.

My commission expires:
April 10th, 1946

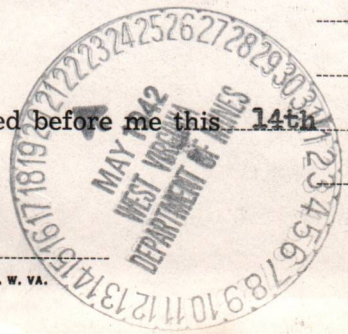

O. B. Hathaway
Notary Public.

Permit No. WET-208-P

AFFIDAVIT OF PLUGGING AND FILLING WELL

AFFIDAVIT SHOULD BE MADE IN TRIPPLICATE. ONE COPY MAILED TO THE DEPARTMENT, ONE COPY TO BE RETAINED BY THE WELL OPERATOR AND THE THIRD COPY, AND EXITS COPIES IF REQUIRED, SHOULD BE MAILED TO EACH COAL OPERATOR AT THEIR RESPECTIVE ADDRESSES.

Name: _____
 COAL OPERATOR OR OWNER: _____
 ADDRESS: _____
 COAL OPERATOR OR OWNER: _____
 ADDRESS: _____
 Well No. _____
 Name: _____
 ADDRESS: _____
 DISTRICT: _____
 COUNTY: _____
 WELL AND LOCATION: _____
 COMPLETE ADDRESS: _____
 NAME OF WELL OPERATOR: _____

AFFIDAVIT

STATE OF WEST VIRGINIA

County of Calhoun

I, J. H. Forrester, and F. D. Pyles, being first duly sworn according to law depose and say that they are experienced in the work of plugging and filling oil and gas wells and were employed by J. H. Forrester well operator and participated in the work of plugging and filling the above well, that said work was commenced on the 30th day of January, 1933, and that the well was plugged and filled in the following manner:

DEPTH OF WELL		PLUGGING MATERIAL		FORMATION	
DEPTH FEET IN	FEET DOWN	TYPE AND AMOUNT	DEPTH FEET IN	FEET DOWN	FORMATION
		Red clay	130	130	
		Cement	125	125	
		Stone bridge	110	110	
		Cement	105	105	
		Red clay	100	100	
		Cement	95	95	
		Red clay	90	90	
		Cement	85	85	
		Stone bridge	80	80	
		Cement	75	75	
		Red clay	70	70	
		Cement	65	65	
		Red clay	60	60	
		Cement	55	55	
		Stone bridge	50	50	
		Cement	45	45	
		Red clay	40	40	
		Cement	35	35	
		Red clay	30	30	
		Cement	25	25	
		Stone bridge	20	20	
		Cement	15	15	
		Red clay	10	10	
		Cement	5	5	
		Red clay	0	0	

and that the work of plugging and filling said well was completed on the 13th day of February, 1933.

09/22/2023

Notary Public

Permit No. 112-308-P

My commission expires

April 10th, 1934

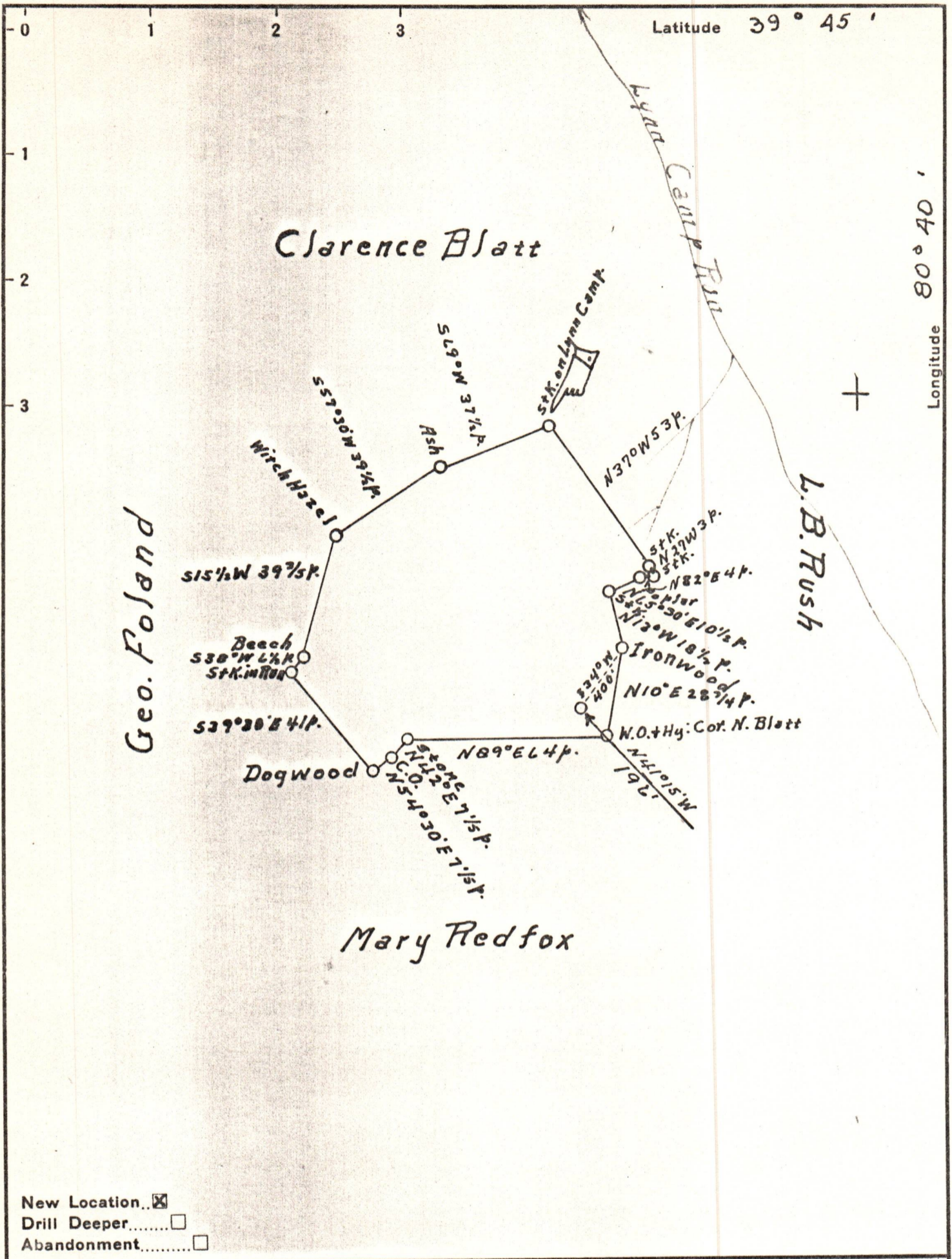

New Location
 Drill Deeper
 Abandonment

Company J. H. Ferrell
 Address Grantsville, W. Va.
 Farm Clarence Blatt
 Tract _____ Acres 45 Lease No. _____
 Well (Farm) No. 1 Serial No. _____
 Elevation (Spirit Level) 1265'
 Quadrangle Littleton
 County Wetzel District Proctor
 Engineer Bruce Ferrell, Jr.
 Engineer's Registration No. _____
 File No. _____ Drawing No. _____
 Date Nov 2, 1938 Scale 40 p. = 1"

STATE OF WEST VIRGINIA
 DEPARTMENT OF MINES
 OIL AND GAS DIVISION
 CHARLESTON

WELL LOCATION MAP
 FILE NO. Wet-208 09/22/2023

+ Denotes location of well on United States Topographic Maps, scale 1 to 62,500, latitude and longitude lines being represented by border lines as shown.

- Denotes one inch spaces on border line of original tracing.

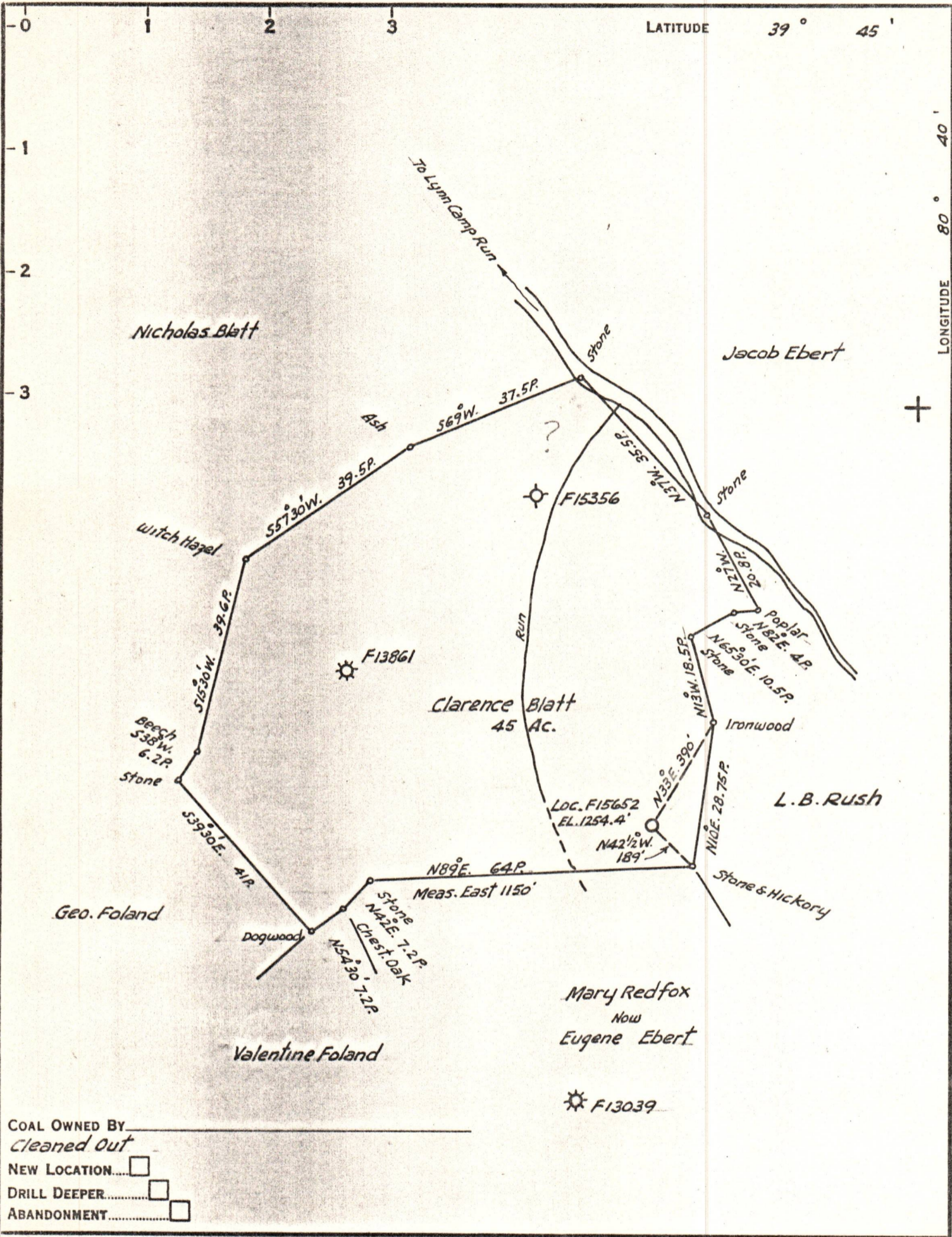

COAL OWNED BY _____
Cleaned Out

NEW LOCATION.....

DRILL DEEPER.....

ABANDONMENT.....

COMPANY *The Manufacturers Light & Heat Co.*

ADDRESS *800 Union Trust Bldg. Pittsburgh Pa.*

FARM *Clarence Blatt et al*

TRACT _____ ACRES *45* LEASE No. *26470*

WELL (FARM) No. *2* SERIAL No. *F15652*

ELEVATION (SPIRIT LEVEL) *1254.4'*

QUADRANGLE *Littleton*

COUNTY *Wetzel* DISTRICT *Proctor*

ENGINEER *Thom. E. Virgin E.L*

ENGINEER'S REGISTRATION No. *1503*

FILE No. _____ DRAWING No. *Y-13-869*

DATE *Aug. 17, 1953* SCALE *1" = 400'*

STATE OF WEST VIRGINIA
 DEPARTMENT OF MINES
 OIL AND GAS DIVISION
 CHARLESTON

WELL LOCATION 09/22/2023
 FILE No. *Wet-208-Redrill*

+ DENOTES LOCATION OF WELL ON UNITED STATES TOPOGRAPHIC MAPS, SCALE 1 TO 62,500. LATITUDE AND LONGITUDE LINES BEING REPRESENTED BY BORDER LINES AS SHOWN.

— DENOTES ONE INCH SPACES ON BORDER LINE OF ORIGINAL TRACING.