



STATE OF WEST VIRGINIA  
DEPARTMENT OF MINES  
OIL AND GAS DIVISION

NOTICE OF PROPOSED LOCATION OF OIL AND GAS WELL

To THE DEPARTMENT OF MINES,  
Charleston, W. Va.

1/2 - Benedum & Trees,  
COAL OPERATOR OR COAL OWNER  
Pittsburgh, Pa.  
ADDRESS

SOUTH PENN NATURAL GAS COMPANY,  
NAME OF WELL OPERATOR  
Union Trust Building,  
Parkersburg, W. Va.  
COMPLETE ADDRESS

1/2 - State of West Virginia,  
COAL OPERATOR OR COAL OWNER  
Edgar B. Sims, Auditor,  
Charleston, W. Va.  
ADDRESS

August 4, 19 43.

PROPOSED LOCATION  
Grant District

South Penn Natural Gas Co., et al.  
OWNER OF MINERAL RIGHTS  
Union Trust Building,  
Parkersburg, W. Va.  
ADDRESS

Wetzel County

Well No. 18 39° 35'  
80° 30'

Barr Tract Farm

GENTLEMEN:

The undersigned well operator is entitled to drill upon the above named farm or tract of land for oil and gas, having fee title thereto, (or as the case may be) under grant or lease dated March 1, 1943, made by Hope Construction and Refining Co. to South Penn Natural Gas Co., and recorded on the -- day of ---, in the office of the County Clerk for said County in Book ---, page ---.

The enclosed plat was prepared by a competent engineer and shows the proposed location of a well to be drilled for oil and gas by the undersigned well operator on the farm and in the Magisterial District and County above named, determined by survey and courses and distances from two permanent points, or land marks.

The undersigned well operator is informed and believes there are no coal operators operating beds of coal beneath said farm or tract of land on which said well is located, or within 500 feet of the boundaries of the same, who have mapped their workings and filed their maps as required by law, excepting the coal operators or coal owners (if any) above named as addressees.

The above named coal operators or coal owners (if any) are notified that any objections they may desire to make to such proposed location, or which they are required to make by Section 3 of said Code, if the drilling of a well at said proposed location will cause a dangerous condition in or about their respective coal mines, must be received by, or filed with the Department of Mines within ten\* days from the receipt of a copy of this notice and accompanying plat by said Department. Said coal operators are further notified that forms for use in making such objections will be furnished to them by the Department of Mines promptly on request and that all such objections must set forth as definitely as is reasonably possible the ground or grounds on which such objections are based and indicate the direction and distance the proposed location should be moved to overcome same.

(The next paragraph is to be completed only in Department's copy.)

Copies of this notice and the enclosed plat were mailed by registered mail, or delivered to the above named coal operators or coal owners at their above shown respective address --- day --- before, or on the same day with the mailing or delivery of this copy to the Department of Mines at Charleston, West Virginia.

Very truly yours,

SOUTH PENN NATURAL GAS COMPANY,  
By Elton Blaney Land Agent,

WELL OPERATOR  
Union Trust Building,

STREET  
Parkersburg,

CITY OR TOWN

West Virginia.

STATE

10/06/2023

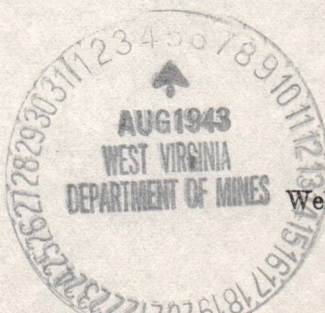

Address of Well Operator }

\*Section 3 . . . . If no such objections be filed or be found by the department of mines, within said period of ten days from the receipt of said notice and plat by the department of mines, to said proposed location, the department shall forthwith issue to the well operator a drilling permit reciting the filing of such plat, that no objections have been made by the coal operators to the location, or found thereto by the department, and that the same is approved and the well operator authorized to proceed to drill at said location.





STATE OF WEST VIRGINIA  
DEPARTMENT OF MINES  
OIL AND GAS DIVISION

NOTICE OF PROPOSED LOCATION OF OIL AND GAS WELL

To The Department of Mines,  
Charleston, W. Va.

SOUTH PENN NATURAL GAS COMPANY,

1/2 - Benedum & Trees,

NAME OF WELL OPERATOR  
Union Trust Building,  
Parkersburg, W. Va.

COAL OPERATOR OR COAL OWNER  
Pittsburgh, Pa.

COMPLETE ADDRESS

ADDRESS

August 4, 19 45

1/2 - State of West Virginia,

PROPOSED LOCATION

COAL OPERATOR OR COAL OWNER  
Edgar B. Sims, Auditor,  
Charleston, W. Va.

Grant District

ADDRESS

Wetzel County

South Penn Natural Gas Co., et al.

Well No. 18 39° 30' 80° 30'

OWNER OF MINERAL RIGHTS  
Union Trust Building,  
Parkersburg, W. Va.

Barb Tract Farm

ADDRESS

GENUINENESS:

The undersigned well operator is entitled to drill upon the above named farm or tract of land for oil and gas having fee title thereto. (or as the case may be) under grant or lease dated \_\_\_\_\_ made by Hope Construction and Refining Co. to South Penn Natural Gas Co. and recorded on the \_\_\_\_\_ day of \_\_\_\_\_ in the office of the County Clerk for said County in \_\_\_\_\_ Book \_\_\_\_\_ page \_\_\_\_\_

The enclosed plat was prepared by a competent engineer and shows the proposed location of a well to be drilled for oil and gas by the undersigned well operator on the farm and in the Mineral District and County above named, determined by survey and courses and distances from two permanent points on land marks.

The undersigned well operator is informed and believes there are no coal operators operating beds of coal beneath said farm or tract of land on which said well is located, or within 500 feet of the boundary of the same, who have mapped their workings and filed their maps as required by law, excepting the coal operators or coal owners (if any) above named as addressees.

The above named coal operators or coal owners (if any) are notified that any objections they may desire to make to such proposed location, or which they are required to make by Section 3 of said Code, if the drilling of a well at said proposed location will cause a dangerous condition in or about their respective coal mines, must be received by or filed with the Department of Mines within ten days from the receipt of a copy of this notice and accompanying plat by said Department. Said coal operators are further notified that forms for use in making such objections will be furnished to them by the Department of Mines promptly on request and that all such objections must set forth as definitely as is reasonably possible the ground or grounds on which such objections are based and indicate the direction and distance the proposed location should be moved to overcome same.

(The next paragraph is to be completed only in Department's copy.)  
Copies of this notice and the enclosed plat were mailed by registered mail, or delivered to the above named coal operators or coal owners at their above shown respective addresses \_\_\_\_\_ day \_\_\_\_\_ before, or on the same day with the mailing or delivery of this copy to the Department of Mines at Charleston, West Virginia.

Very truly yours,  
SOUTH PENN NATURAL GAS COMPANY,  
By \_\_\_\_\_ Land Agent

WELL OPERATOR  
Union Trust Building,  
Parkersburg,  
West Virginia.

Address of Well Operator  
of  
Department of Mines  
West Virginia

10/06/2023

Section 3 . . . . . If no such objections be filed or be found by the department of mines, within said period of ten days from the receipt of said notice and plat by the department of mines, to said proposed location, the department shall forthwith issue to the well operator a drilling permit, reserving the right of such plat, that no objections have been made by the coal operators to the location or found thereto by the department, and that the same is approved and the well operator authorized to proceed to drill at said location.



A-10

# SOUTH PENN NATURAL GAS COMPANY

UNION TRUST BUILDING

**PARKERSBURG, W. VA.**

August 4, 1943.

Department of Mines,

Charleston, W. Va.

Attention: M. E. Griffith.

Gentlemen:-

We enclose herewith notice of proposed location of South Penn Natural Gas Company's well No. 18 on the Barr Tract Fam, Grant District, Wetzel County, West Virginia. Cloth tracing showing proposed location of this well is being forwarded under separate cover.

The minerals in the Barr Tract are owned by South Penn Natural Gas Company etal., Union Trust Building, Parkersburg, W. Va.

Yours very truly,

*Elton E. Young*  
Elton E. Young,  
Land Agent.

EEY-JRM

Enc.



10/06/2023



A-11

August 20, 1943

South Penn Natural Gas Company  
Union Trust Building  
Parkersburg, West Virginia

Gentlemen:

Enclosed is Permit Wet-295 to drill Well No. 18  
on the Barr Tract, Grant District, Wetzel County.

Please keep duplicate permit posted at the  
well site.

Very truly yours,

Secretary  
OIL AND GAS DIVISION.

MG:g  
encl

Copy to Inspector Sumney

10/06/2023



B-2

Formation	Color	Hard or Soft	Top	Bottom	Oil, Gas or Water	Depth Found	Remarks
(CONTINUED)							
Murphy Sand			1319	1335			
Pink Slate			1335	1343			
Lime			1343	1357			
Red Rock			1357	1363			
Lime			1363	1380			
Slate			1380	1388			
Lime			1388	1394			
Red Rock			1394	1408			
Lime			1408	1418			
Slate			1418	1425			
Dark Lime			1425	1455			
Slate			1455	1475			
Red Rock			1475	1483			
Lime			1483	1494			
Slate			1494	1500			
Red Rock			1500	1506			
Slate & Shells			1506	1518			
Little Dunkard			1518	1528			
Slate			1528	1542			
Sand			1542	1552			
Slate			1552	1575			
Lime			1575	1600			
Slate			1600	1605			
Lime			1605	1612			
Slate			1612	1622			
Sand			1622	1634			
Dark Slate			1634	1668			
Big Dunkard			1668	1678			
Slate			1678	1685			
Lime			1685	1690			
Slate			1690	1722			
Lime			1722	1755			
Slate			1755	1770			
Shale			1770	1785			
Lime			1785	1825			
Gas Sand			1825	1893			
Slate			1893	1898			
Sand			1898	1912			
Shale			1912	1945			
White Slate			1945	1960			
Lime			1960	1970			
1st. Salt Sand			1970	1984			
Brown Slate			1984	1995			
White Lime			1995	2018			
Slate			2018	2026			
Lime			2026	2037			
Shale			2037	2048			
Lime Shells			2048	2058			
Shale			2058	2085			
2nd. Salt Sand			2085	2265			
					Water	2098-2100	1 Bailer per hr.
					Water	2140-2145	2 " " " "
Slate			2265	2270			
Lime			2270	2280			
Red Rock			2280	2288			
Lime			2288	2295			
Red Rock			2295	2302			
Slate			2302	2345			
Red Rock			2345	2363			
Gray Slate			2363	2370			
Little Lime			2370	2381			
Pencil Cave			2381	2396			
Hard Lime			2396	2401			
Pencil Cave			2401	2406			
Big Lime			2406	2453			

(CONTINUED ON NEXT PAGE)

Date \_\_\_\_\_, 194\_\_

APPROVED \_\_\_\_\_, Owner

By \_\_\_\_\_ (Title)

10/06/2023



B-1



STATE OF WEST VIRGINIA  
DEPARTMENT OF MINES  
OIL AND GAS DIVISION

*Littleton*

WELL RECORD

Permit No. WET-295

Oil or Gas Well See remarks  
(KIND)

Company South Penn Natural Gas Company  
Address Union Trust Bldg., Parkersburg, W. Va.  
Farm Barr Tract Acres 1003-3/4  
Location (waters) -  
Well No. 18 Elev. 1438.67  
District Grant County Wetzel  
The surface of tract is owned in fee by C. Roy Hinerman,  
et al. Address Mobley, W. Va.  
Mineral rights are owned by South Penn Nat. Gas Co.,  
et al. Address Union Trust Bldg.,  
Parkersburg, W. Va.  
Drilling commenced Oct. 20, 1943  
Drilling completed November 27, 1943  
Date Shot 12-1-43 From 2561 To 2575  
With 60 Qts.  
Open Flow /10ths Water in          Inch  
         /10ths Merc. in          Inch  
Volume (See remarks) 13.192 Cu. Ft.  
Rock Pressure - lbs.          hrs.  
Oil (See remarks) 17 bbls., 1st 24 hrs.  
Fresh water. 2098-2100 feet. 2140-2145 feet  
Salt water - feet          feet

Casing and Tubing	Used in Drilling	Left in Well	Packers
Size			Kind of Packer
16			-
18			
10	479'	(Pulled)	Size of
8 1/4	1688'		Depth set
6 1/2	2441'		
5 3/16			Perf. top
3			Perf. bottom
2			Perf. top
Liners Used			Perf. bottom
Conductor	12'		

CASING CEMENTED - SIZE          No. Ft.          Date           
COAL WAS ENCOUNTERED AT 1075 FEET 48 INCHES  
1175 FEET 96 INCHES FEET INCHES  
         FEET          INCHES FEET INCHES

Formation	Color	Hard or Soft	Top	Bottom	Oil, Gas or Water	Depth Found	Remarks
Conductor			0	12			
Clay			12	50			
Dark Slate			50	85			
White Lime			85	100			
Dark Slate			100	150			
Dark Lime			150	175			
Slate Lime			175	300			
Dark Slate			300	465			
White Lime			465	490			
Slate			490	550			
Lime Shells			550	600			
Slate Shells			600	690			
Lime			690	696			
Dark Slate			696	725			
White Lime			725	760			
Slate			760	790			
Gritty Lime			790	818			
Slate			818	822			
Slate Shells			822	885			
Bluff Sand			885	926			
Black Slate			926	930			
Dark Slate			930	955			
White Lime			955	1072			
Dark Slate			1072	1075			
Mapletown Coal			1075	1079			
Dark Slate			1079	1090			
Dark Lime			1090	1125			
Slate			1125	1175			
Pgh. Coal			1175	1183			
Gritty Lime			1183	1228			
Slate			1228	1234			
Lime			1234	1253			
White Lime			1253	1267			
Red Rock			1267	1278			
Lime			1278	1284			
Slate			1284	1314			
Shale			1314	1319			



(CONTINUED)

(Over)



Formation	Color	Hard or Soft	Top	Bottom	Oil, Gas or Water	Depth Found	Remarks

10/06/2023

DEPARTMENT OF MINES  
DIVISION OF METAL MINING

Date January 29th., 1944.

APPROVED SOUTH PENN NATURAL GAS COMPANY, Owner

By Etton Blaney, Land Agent  
(Title)



B-3



STATE OF WEST VIRGINIA  
DEPARTMENT OF MINES  
OIL AND GAS DIVISION

WELL RECORD

Permit No. 295

Oil or Gas Well (KIND)

Company.....	Casing and Tubing	Used in Drilling	Left in Well	Packers
Address.....	Size			
Farm Barr Tract Acres.....	16			Kind of Packer.....
Location (waters).....	18			
Well No. 18 Elev.....	10			Size of.....
District..... County.....	8 1/4			Depth set.....
The surface of tract is owned in fee by.....	6%			
Address.....	5 3/16			Perf. top.....
Mineral rights are owned by.....	3			Perf. bottom.....
Address.....	2			Perf. top.....
Drilling commenced.....	Liners Used.....			Perf. bottom.....
Drilling completed.....				
Date Shot From To.....				
With.....				

Open Flow /10ths Water in..... Inch	CASING CEMENTED.....	SIZE.....	No. Ft.....	Date.....
/10ths Merc. in..... Inch				
Volume..... Cu. Ft.	COAL WAS ENCOUNTERED AT.....	FEET.....	INCHES.....	
Rock Pressure..... lbs..... hrs.		FEET.....	INCHES.....	
Oil..... bbls., 1st 24 hrs.		FEET.....	INCHES.....	
Fresh water..... feet..... feet		FEET.....	INCHES.....	
Salt water..... feet..... feet		FEET.....	INCHES.....	

Formation	Color	Hard or Soft	Top	Bottom	Oil, Gas or Water	Depth Found	Remarks
(CONTINUED FROM PRECEDING PAGE)							
Big Injun			2453		Oil & Gas Smell	2554-2557	
					Gas	2562-2568	
					Oil	2570-2575	
TOTAL DEPTH				2580			
<u>REMARKS</u>							
Well was cleaned out 18 days after shot by Drilling Contractor. Has been making 13 barrels of oil per day since put to pumping after cleaning out. Gas test 13,192 cu. ft. per day. No rock pressure taken. Well is producing from the Big Injun sand.							

10/06/2023

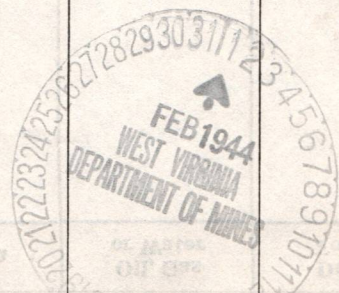



**RECEIVED**

1.0 API well number: (If not available, leave blank. 14 digits.)	47-103-0295 / OCT 29 1980				
2.0 Type of determination being sought: (Use the codes found on the front of this form.)	108 / Section of NGPA		OIL & GAS DIVISION DEPT. OF MINES		
3.0 Depth of the deepest completion location: (Only needed if sections 103 or 107 in 2.0 above.)	_____ feet				
4.0 Name, address and code number of applicant: (35 letters per line maximum. If code number not available, leave blank.)	Pennzoil Company Name		014730 Seller Code		
	P. O. Box 1588 Street				
	Parkersburg WV 26101 City State Zip Code				
5.0 Location of this well: [Complete (a) or (b).] (a) For onshore wells (35 letters maximum for field name.)	Grant Field Name				
	Wetzel WV County State				
(b) For OCS wells:	Area Name _____ Block Number _____				
	Date of Lease:           Mo. Day Yr.		OCS Lease Number _____		
(c) Name and identification number of this well: (35 letters and digits maximum.)	Barr Tract #18				
(d) If code 4 or 5 in 2.0 above, name of the reservoir: (35 letters maximum.)	_____				
6.0 (a) Name and code number of the purchaser: (35 letters and digits maximum. If code number not available, leave blank.)	Consolidated Gas Supply Corp. Name		004228 Buyer Code		
(b) Date of the contract:	0 8 1 9 7 6 Mo. Day Yr.				
(c) Estimated annual production:	_____ MMcf.				
		(a) Base Price (\$/MMBTU)	(b) Tax	(c) All Other Prices [Indicate (+) or (-).]	(d) Total of (a), (b) and (c)
7.0 Contract price: (As of filing date. Complete to 3 decimal places.)		2.740	0.192	0.586	3.518
8.0 Maximum lawful rate: (As of filing date. Complete to 3 decimal places.)		2.740	0.192	0.586	3.518
9.0 Person responsible for this application:	James A. Crews Name		Manager, East. Div. Title		
Agency Use Only Date Received by Juris. Agency <b>OCT 29 1980</b> Date Received by FERC	_____ Signature				
	October 3, 1980 Date Application is Completed		(304) 422-6565 Phone Number		

10/06/2023



PARTICIPANTS: C-2 DATE: \_\_\_\_\_ BUYER-SELLER CO  
 OPERATOR: Pennzoil Company MAR 30 1981 014730  
 PURCHASER: Consolidated Gas Supply Corp 004228  
 ER: \_\_\_\_\_

Va. Department of Mines, Oil & Gas Division  
 WELL DETERMINATION FILE NUMBER  
010-29-108-103-0295  
 Above File Number on all Communications  
 Relating to Determination of this Well

*Qualifies J E Augzey*

CHECK EACH ITEM AS COMPLETE OR NOTE WHAT IS MISSING

NO. \_\_\_\_\_

1. FERC -121  Items not completed - Line No. \_\_\_\_\_

2. IV-1 Agent  James A. Crews

3. IV-2 Well Permit

4. IV-6 Well Plat

5. IV-35 Well Record  Drilling  Deepening

6. IV-36 Gas-Oil Test:  Gas Only \_\_\_\_\_ Was Oil Produced?  Ratio \_\_\_\_\_

7. IV-39 Annual Production 21 <sup>months</sup>/<sub>years</sub>

8. IV-40 90 day Production 92 Days off line: \_\_\_\_\_

9. IV-48 Application for certification. Complete?

10. IV Form 51 - 52 - 53 - 54 - 55 - (56) - 57 - 58 Complete?  Affidavit Signed

Other: Survey \_\_\_\_\_ Logs \_\_\_\_\_ Geological Charts \_\_\_\_\_  
 Structure Map \_\_\_\_\_ 1: 4000 Map \_\_\_\_\_ Well Tabulations \_\_\_\_\_  
 Gas Analyses \_\_\_\_\_

11. Date commenced: 10-20-43 Date completed 11-27-43 Deepened

12. Production Depth: 2362-68

13. Production Formation: Big Injun

14. Final Open Flow: IV A

15. After Frac. R. P.: IV A

16. Other Gas Test: \_\_\_\_\_

17. Avg. Daily Gas from Annual Production:  $\frac{31}{366} = .08 \text{ MCF}$ ,  $\frac{103}{366} = 0.2 \text{ BBL}$

18. Avg. Daily Gas from 90-day ending w/1-120 days  $\frac{3}{92} = .03 \text{ MCF}$ ,  $\frac{14}{92} = 0.1 \text{ BBL}$

19. Line Pressure: IV A PSIG from Daily Rep \_\_\_\_\_

20. Oil Production:  From Completion Report 2570-75

21. Does lease inventory indicate enhanced recovery being done No

22. Is affidavit signed?  Notarized?

23. Official well record with the Department confirm the submitted information? no

24. Additional information \_\_\_\_\_ Does computer program confirm? \_\_\_\_\_

25. Determination Objected to \_\_\_\_\_ By Whom? \_\_\_\_\_

10/06/2023

TS



C-3

FORM WV-2040  
(11-13)

STATE OF WEST VIRGINIA  
DEPARTMENT OF MINES, OIL AND GAS DIVISION

Date October 3 1980

Operator's  
Well No Barr Tract #18

API Well  
No. 103 - 0295  
State County Parcel

WELL CLASSIFICATION FORM

STRIPPER GAS WELL  
NGPA Section 108

DESIGNATED AGENT James A. Crews, Mgr. East. Div

ADDRESS P. O. Box 1588

Parkersburg, WV 26101

WELL OPERATOR PENNZOIL COMPANY

LOCATION: Elevation NA

ADDRESS P. O. Box 1588

Watershed North Fk, Fishing Ck

Parkersburg, WV 26101

Dist. Grant County Wetzel Quad. Big Run

GAS PURCHASER Consolidated Gas Supply Corp. Gas Purchase Contract No. 3866 7.!

ADDRESS P. O. Box 2450

Meter Chart Code 6809

Clarksburg, WV 26301

Date of Contract 02-19-76

\* \* \* \* \*

Provide a complete inventory of the lease and production equipment used for the well for the previous 24 months or, if less than 24 months, the period the well has been in production. Include a complete list of equipment or processes used in connection with recognized enhanced recovery techniques during completion or production. (Attach separate sheets, if necessary.)

Standard wellhead arrangement with no extraordinary lease production equipment.

List all records reasonably available to you which contain information relevant to a determination of eligibility (including production records, B&O Tax Records and royalty payment records) and indicate the location of such records.

Gas Production Records) Location: Pennzoil Company  
Oil Production Records) 601 Grand Central Ave..  
Vienna, WV 26105

10/06/2023



c-4

Form No. 10  
1-1-59

Describe the search made of any records listed above:

Are you aware of any other information which would tend to be inconsistent with the information specified above? Yes \_\_\_\_\_ No X. If yes, indicate the type and source of the information.

AFFIDAVIT

I, James A. Crows, having been first sworn according to law, state that I have caused to be made a diligent search of those records hereinbefore indicated in the manner herein described, that the information contained in this document is true and accurate and that on the basis of the records and examinations hereinbefore described, and to the best of my information, knowledge and belief, the well for which this certification is sought qualifies as a scripper well.

James A. Crows

STATE OF WEST VIRGINIA,  
COUNTY OF Wood, to wit.

I, Jean Paden, a Notary Public in and for the state and county aforesaid do certify that James A. Crows, whose name is signed to the writing above, bearing date the 3 day of October 1980, has acknowledged the same before me, in my county aforesaid.

Given under my hand and official seal this \_\_\_\_\_ day of \_\_\_\_\_, 19\_\_\_\_.

My term of office expires on the 14 day of November, 1986/2023

\_\_\_\_\_  
Notary Public

NOTARIAL SEAL



2-5

IV-39-WC

STATE OF WEST VIRGINIA  
DEPARTMENT - MINES  
DIVISION - OIL AND GAS

REPORT OF MONTHLY PRODUCTION  
GAS VOLUMES IN MCF @ 14.73  
OIL IN BARRELS @ 60 DEGREES

REPORT DATE

10/06/2023 10/3/80

YEAR 1979

OPERATOR Fennell Company

API# 103-0062 FARM Bon Treat # 8 COUNTY Lincoln

AVG. FLOW PRESSURE

SHIFT-IN PRESSURE

TOTALS

GAS MCF	8	8	7	6	3	1	1	2	1	2	5	8	GAS	52
---------	---	---	---	---	---	---	---	---	---	---	---	---	-----	----

OIL BBL.	J-2	F-0	M-2	A-6	M-10	J-6	J-7	A-8	S-5	0	N-4	D-8	OIL	65
----------	-----	-----	-----	-----	------	-----	-----	-----	-----	---	-----	-----	-----	----

DAYS ON LINE	31	28	31	30	31	30	31	31	30	31	30	31		
--------------	----	----	----	----	----	----	----	----	----	----	----	----	--	--

YEAR 1980

API	FARM	COUNTY	AVG. FLOW PRESSURE	SHIFT-IN PRESSURE	TOTALS
-----	------	--------	--------------------	-------------------	--------

GAS MCF	4	6	5	4	3	1	1	1	1	1	1	1	GAS	
---------	---	---	---	---	---	---	---	---	---	---	---	---	-----	--

OIL BBL.	J-8	F-7	M-1	A-4	M-8	J-6	J-0	A-7	S-7	0	N-	D-	OIL	
----------	-----	-----	-----	-----	-----	-----	-----	-----	-----	---	----	----	-----	--

DAYS ON LINE	31	29	31	30	31	30	31	31	30	30				
--------------	----	----	----	----	----	----	----	----	----	----	--	--	--	--

SUMMARIZATION SCHEDULE  
Section 271. 804 (b)

In accordance with Section 271.804 (b) please list all other wells which are to be used in determining this well classification under Part 271 Subpart H.

API NUMBERS



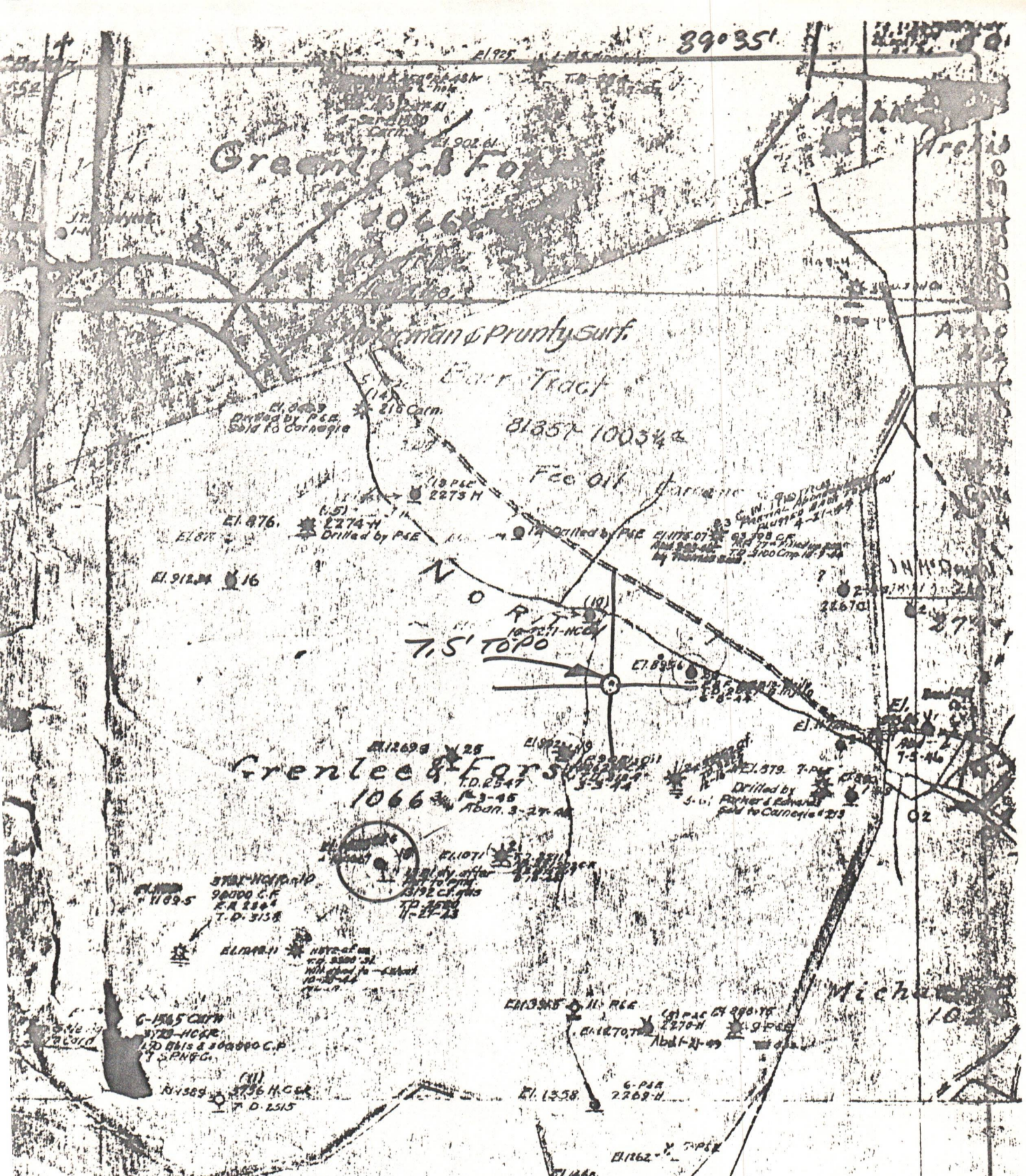

(+) DENOTES LOCATION OF WELL ON UNITED STATES TOPOGRAPHIC MAPS

FORM IV-6  
(8-78)  
**N59 N8 E4**



DATE 1-4-1979  
 OPERATOR'S WELL NO 13  
 API WELL NO. 47-103-0295  
 STATE COUNTY PERMIT

STATE OF WEST VIRGINIA  
DEPARTMENT OF MINES  
OIL AND GAS DIVISION

WELL TYPE: OIL  GAS  LIQUID INJECTION  WASTE DISPOSAL   
 ( IF "GAS", PRODUCTION  STORAGE  DEEP  SHALLOW   
 LOCATION: ELEVATION \_\_\_\_\_ WATER SHED NORTH FK FISHING CR  
 DISTRICT GRANT COUNTY WETZEL  
 QUADRANGLE BIG RUN 7.5'

SURFACE OWNER \_\_\_\_\_ ACREAGE \_\_\_\_\_  
 OIL & GAS ROYALTY OWNER \_\_\_\_\_ LEASE ACREAGE \_\_\_\_\_

PROPOSED WORK: DRILL  CONVERT  DRILL DEEPER  REDRILL  FRACTURE OR STIMULATE  PLUS OFF OLD FORMATION  PERFORATE NEW FORMATION  OTHER PHYSICAL CHANGE IN WELL (SPECIFY) \_\_\_\_\_

PLUS AND ABANDON  CLEAN OUT AND REPLUG   
 TARGET FORMATION \_\_\_\_\_ ESTIMATED DEPTH \_\_\_\_\_  
 WELL OPERATOR Pennzoil Company DESIGNATED AGENT James A. Crews  
 ADDRESS P. O. Box 1588 ADDRESS P. O. Box 1588  
Parkersburg, WV 26101 Parkersburg, WV 26101

10/06/2023



