



STATE OF WEST VIRGINIA  
DEPARTMENT OF MINES  
OIL AND GAS DIVISION

NOTICE OF PROPOSED LOCATION OF OIL AND GAS WELL

To THE DEPARTMENT OF MINES,  
Charleston, W. Va.

1/2 - Benedum & Trees,  
COAL OPERATOR OR COAL OWNER  
Pittsburgh, Pa.  
ADDRESS

SOUTH PENN NATURAL GAS COMPANY,  
NAME OF WELL OPERATOR  
Union Trust Building,  
Parkersburg, W. Va.  
COMPLETE ADDRESS

1/2 - State of West Virginia,  
COAL OPERATOR OR COAL OWNER  
Edgar B. Sims, Auditor,  
Charleston, W. Va.  
ADDRESS

December 22, 19 43

PROPOSED LOCATION  
Grant District

South Penn Natural Gas Co. et al  
OWNER OF MINERAL RIGHTS  
Union Trust Building,  
Parkersburg, W. Va.  
ADDRESS

Wetzel County

Well No. 19 <sup>39° 35'</sup> <sub>80° 30'</sub>

Barr Tract Farm

GENTLEMEN:

The undersigned well operator is entitled to drill upon the above named farm or tract of land for oil and gas, having fee title thereto, (or as the case may be) under grant or lease dated March 1, 1943, made by Hope Construction and Refining Co. to South Penn Natural Gas Co., and recorded on the --- day of -----, in the office of the County Clerk for said County in Book ----, page ----.

The enclosed plat was prepared by a competent engineer and shows the proposed location of a well to be drilled for oil and gas by the undersigned well operator on the farm and in the Magisterial District and County above named, determined by survey and courses and distances from two permanent points, or land marks.

The undersigned well operator is informed and believes there are no coal operators operating beds of coal beneath said farm or tract of land on which said well is located, or within 500 feet of the boundaries of the same, who have mapped their workings and filed their maps as required by law, excepting the coal operators or coal owners (if any) above named as addressees.

The above named coal operators or coal owners (if any) are notified that any objections they may desire to make to such proposed location, or which they are required to make by Section 3 of said Code, if the drilling of a well at said proposed location will cause a dangerous condition in or about their respective coal mines, must be received by, or filed with the Department of Mines within ten\* days from the receipt of a copy of this notice and accompanying plat by said Department. Said coal operators are further notified that forms for use in making such objections will be furnished to them by the Department of Mines promptly on request and that all such objections must set forth as definitely as is reasonably possible the ground or grounds on which such objections are based and indicate the direction and distance the proposed location should be moved to overcome same.

(The next paragraph is to be completed only in Department's copy.)

Copies of this notice and the enclosed plat were mailed by registered mail, or delivered to the above named coal operators or coal owners at their above shown respective address ----- day --- before, or on the same day with the mailing or delivery of this copy to the Department of Mines at Charleston, West Virginia.

Very truly yours,

SOUTH PENN NATURAL GAS COMPANY,  
By Olton Young Land Agent,  
WELL OPERATOR

Union Trust Building,

STREET

Parkersburg,

CITY OR TOWN

West Virginia.

STATE

10/06/2023

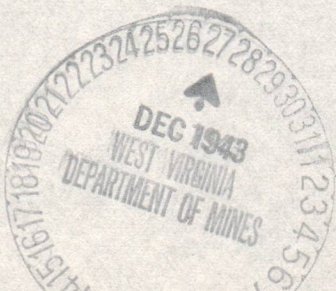

Address of Well Operator }

\*Section 3 . . . . . If no such objections be filed or be found by the department of mines, within said period of ten days from the receipt of said notice and plat by the department of mines, to said proposed location, the department shall forthwith issue to the well operator a drilling permit reciting the filing of such plat, that no objections have been made by the coal operators to the location, or found thereto by the department, and that the same is approved and the well operator authorized to proceed to drill at said location.

302



STATE OF WEST VIRGINIA  
DEPARTMENT OF MINES  
OIL AND GAS DIVISION

NOTICE OF PROPOSED LOCATION OF OIL AND GAS WELL

To The Department of Mines,  
Charleston, W. Va.

SOUTH PENN NATURAL GAS COMPANY,  
NAME OF WELL OPERATOR  
Union Trust Building,  
TANKERSBURG, W. VA.  
COMPLETE ADDRESS

Benadum & Treese, - 1/2  
COAL OPERATOR OR COAL OWNER  
Pittsburgh, Pa.  
ADDRESS

December 22, 1943  
PROPOSED LOCATION  
Grant  
District

State of West Virginia, - 1/2  
COAL OPERATOR OR COAL OWNER  
Robert S. Sims, Auditor,  
Charleston, W. Va.  
ADDRESS

Wetzel  
County  
Well No. 10  
Barb Tract  
Farm

South Penn Natural Gas Co. et al  
OWNER OF MINERAL RIGHTS  
Union Trust Building,  
Parkersburg, W. Va.  
ADDRESS

GENTLEMEN:

The undersigned well operator is entitled to drill upon the above named farm or tract of land for oil and gas having fee title thereto, (or as the case may be) under grant or lease dated March 1, 1943, made by Hope Construction and Refining Co. to South Penn Natural Gas Co. and recorded on the --- day of --- in the office of the County Clerk for said County in Book --- page ---

The enclosed plat was prepared by a competent engineer and shows the proposed location of a well to be drilled for oil and gas by the undersigned well operator on the farm and in the Magisterial District and County above named, determined by survey and courses and distances from two permanent points on land marks.

The undersigned well operator is informed and believes there are no coal operators operating beds of coal beneath said farm or tract of land on which said well is located, or within 500 feet of the boundary of the same, who have mapped their workings and filed their maps as required by law, excepting the coal operators or coal owners (if any) above named as addressees.

The above named coal operators or coal owners (if any) are notified that any objections they may desire to make to such proposed location, or which they are required to make by Section 3 of said Code, in the drilling of a well at said proposed location will cause a dangerous condition in or about their respective coal mines, must be received by or filed with the Department of Mines within ten days from the receipt of a copy of this notice and accompanying plat by said Department. Said coal operators are further notified that forms for use in making such objections will be furnished to them by the Department of Mines promptly on request and that all such objections must set forth as definitely as is reasonably possible the ground or grounds on which such objections are based and indicate the direction and distance the proposed location should be moved to overcome same.

(The next paragraph is to be completed only in Department's copy.)  
Copies of this notice and the enclosed plat were mailed by registered mail, or delivered to the above named coal operators or coal owners at their above shown respective addresses day before, or on the same day with the mailing or delivery of this copy to the Department of Mines at Charleston, West Virginia.

Very truly yours,

SOUTH PENN NATURAL GAS COMPANY,  
BY --- LAND AGENT

Union Trust Building,  
STREET  
Parkersburg,  
CITY OR TOWN  
West Virginia,  
STATE

Address  
of  
Well Operator



10/06/2023

\*Section 3... If no such objections be filed or be found by the department of mines, within said period of ten days from the receipt of said notice and plat by the department of mines, to said proposed location, the department shall forthwith issue to the well operator a drilling permit reciting the date of such plat, that no objections have been made by the coal operators to the location, or found thereto by the department, and that the same is approved and the well operator authorized to proceed to drill at said location.

Permit Number

A-10

# SOUTH PENN NATURAL GAS COMPANY

UNION TRUST BUILDING

**PARKERSBURG, W. VA.**

Dec. 22, 1943.

Department of Mines,  
Charleston, W. Va.

Attention: M. E. Griffith.

Gentlemen:-

We enclose herewith notice of proposed location of South Penn Natural Gas Company's well No. 19 on the Barr Tract, Grant District, Wetzel County, West Virginia. Cloth tracing showing proposed location of this well is being forwarded under separate cover.

The minerals in the Barr Tract are owned by South Penn Natural Gas Company et al., Union Trust Building, Parkersburg, W. Va.

Yours very truly,

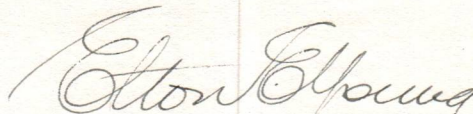

Elton E. Young,  
Land Agent.

EEY-JRM

Enc.

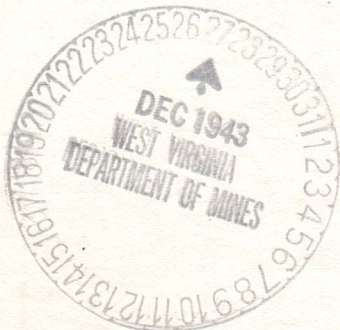

Southwestern Natural Gas Company

UNION TRUST BUILDING

11th Street, New York, N.Y.

Dear Sir:

Reference is made to your letter of the 10th inst.

concerning the above captioned matter.

Very truly yours,

The undersigned is authorized to advise you that the same has been forwarded to the proper authorities for their consideration.

Very truly yours,  
[Signature]

Very truly yours,

[Signature]

A-11

January 6, 1944

South Penn Natural Gas Company  
Union Trust Building  
Parkersburg, West Virginia

Gentlemen:

Permit WET-302 to drill Well No. 19 on the Barr  
Tract, Grant District, Wetzel County, is enclosed.

Very truly yours,

Secretary  
OIL AND GAS DIVISION

MG/jh  
enc-2

CC: Inspector Herbert A. Sumney

10/06/2023

A-12

# SOUTH PENN NATURAL GAS COMPANY

UNION TRUST BUILDING

**PARKERSBURG, W. VA.**

Dec. 9, 1944.

Department of Mines,

Charleston, W. Va.

Attention: M. E. Griffith.

Gentlemen:-

We enclose herewith Well Record, in duplicate, for well No. 19 on the Barr Tract, Grant District, Wetzel County, West Virginia, - drilled under Permit No. WET-302.

Yours very truly,

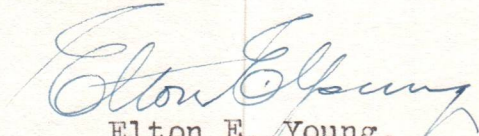
  
Elton E. Young,  
Land Agent.

EEY-JRM

Enc.

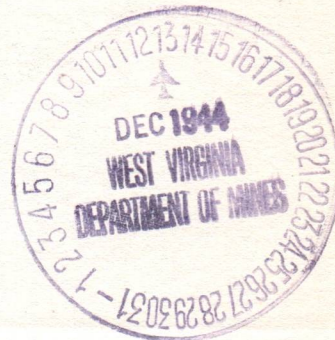

B-2

Formation	Color	Hard or Soft	Top	Bottom	Oil, Gas or Water	Depth Found	Remarks
Slate			865	870			
Lime			870	880	<del>Pink Slate</del>		
Pink Slate			880	885			
Lime			885	928			
Red Rock			928	933			
White Lime			933	963			
Red Rock			963	970			
White Lime			970	983			
White Slate			983	994			
Lime			994	1002			
Red Rock			1002	1014			
Slate			1014	1032			
Red Rock			1032	1045			
Lime			1045	1052			
Red Rock			1052	1065			
Gritty Lime			1065	1100			
Dark Lime			1100	1120			
White Lime			1120	1135			
Slate			1135	1149			
Little Dunkard			1149	1182			
Black Slate			1182	1220			
Big Dunkard			1220	1233			
Slate			1233	1280			
White Sand			1280	1315			
Black Shale			1315	1325			
White Lime			1325	1333			
White Slate			1333	1352			
Gritty Lime			1352	1370			
White Gas Sand			1370	1443			
Dark Slate			1443	1448			
Dark Sand			1448	1462			
Dark Slate			1462	1480			
Dark Shale			1480	1503			
Gritty Lime			1503	1512			
Dark Slate			1512	1518			
Lime			1518	1532			
Shale			1532	1540			
1st Salt Sand			1540	1590			
					Water	1568-1570	1 blr. per hr
					Water	1580 -1583	4 blr per hr
Slate			1590	1610			
2nd Salt Sand			1610	1793			
					Water	1649-1652	2 blr per hr
Water Sand			1693	1696			
Slate			1793	1809			
White Sand			1809	1825			
White Slate			1825	1830			
White Lime			1830	1848			
Red Rock			1848	1855			
Gritty Lime			1855	1868			
Red Rock			1868	1872			
Lime			1872	1880			
Red Rock			1880	1898			
White Lime			1898	1914			
White Slate			1914	1922			
Little Lime			1922	1934			
Slate			1934	1945			
Lime			1945	1949			
Pencil Cave			1949	1951			
Big Lime			1951	1999			
Big Injun			1999				
Gas & Oil Pay			2098	2104	Oil	8 bbls per day	
Gas & Oil			2111	2117	Oil	82 bbls per day	
Total Depth				2124			

Remarks: Gas test on both gas pays was 306,274 cu ft and blowed down to 78,261 cu ft on Mar. 3, 1944 @ 2:30 P.M. The oil started to flow and no gas test could be taken after that, due to the flow of oil.

10/06/2023

Date Dec. 9, 1944, 194

SOUTH PENN NATURAL GAS COMPANY

APPROVED \_\_\_\_\_, Owner

By Elton Spang  
(Title) Land Agent.



73-1

*Littleton*



STATE OF WEST VIRGINIA  
DEPARTMENT OF MINES  
OIL AND GAS DIVISION

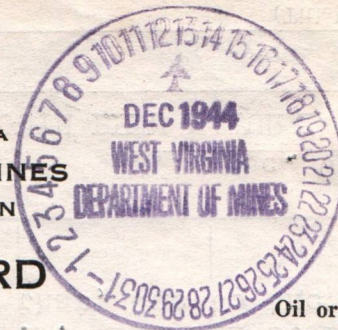

WELL RECORD

Permit No. WET 302

Oil or Gas Well Oil

Company South Penn Natural Gas Company,  
Address Union Trust Bldg. Parkersburg, W. Va.  
Farm Barr Tract Acres 1003.75  
Location (waters) No. Fork of Big Fishing Creek  
Well No. 19 Elev. 994.66  
District Grant County Wetzel  
The surface of tract is owned in fee by C. Roy Hinerman et al  
Address Mobley, W. Va.  
1/2 Benedum & Trees, Pittsburgh, Pa.  
Mineral rights are owned by State of West Virginia.  
Address \_\_\_\_\_

Casing and Tubing	Used in Drilling	Left in Well	Packers
Size			
16			Kind of Packer _____
13			
10	497	Pulled	Size of _____
8 1/4	1235		
6 5/8	1972		Depth set _____
5 3/16			
3			Perf. top _____
2			Perf. bottom _____
Liners Used			Perf. top _____
			Perf. bottom _____

Drilling commenced Feb. 2, 1944  
Drilling completed Mar. 3, 1944  
Date Shot 3/17/44 From 2097 To 2116  
6/14/44 60 qts. & 60 qts.  
Open Flow /10ths Water in \_\_\_\_\_ Inch  
/10ths Merc. in \_\_\_\_\_ Inch  
Volume 206,274 see remarks Cu. Ft.  
Rock Pressure \_\_\_\_\_ lbs. \_\_\_\_\_ hrs.  
Oil 90 bbls., 1st 24 hrs.  
Fresh water \_\_\_\_\_ feet \_\_\_\_\_ feet  
Salt water 1568-1570 feet 1580-1583 feet  
1649-1652

CASING CEMENTED \_\_\_\_\_ SIZE \_\_\_\_\_ No. Ft. \_\_\_\_\_ Date \_\_\_\_\_  
COAL WAS ENCOUNTERED AT \_\_\_\_\_ FEET \_\_\_\_\_ INCHES  
\_\_\_\_\_ FEET \_\_\_\_\_ INCHES \_\_\_\_\_ FEET \_\_\_\_\_ INCHES  
\_\_\_\_\_ FEET \_\_\_\_\_ INCHES \_\_\_\_\_ FEET \_\_\_\_\_ INCHES

Formation	Color	Hard or Soft	Top	Bottom	Oil, Gas or Water	Depth Found	Remarks
Conductor			0	13			
Yellow Clay			0	13			
White Lime			13	21			
Dark Slate			21	33			
White Lime			33	47			
Slate & Lime			47	65			
Gritty Lime			65	100			
White Slate			100	125			
White Lime			125	153			
Slate & Lime			153	200			
Gritty Lime			200	215			
Dark Slate			215	250			
White Lime			250	300			
White Slate			300	325			
White Lime			325	345			
White Sand			345	385			
Slate			385	400			
Gritty Lime			400	430			
White Sand			430	478			
Dark Slate			478	489			
White Lime			489	505			
White Slate			505	512			
White Lime			512	560			
Slate & Lime			560	630			
White Slate			630	645			
White Lime			645	650			
Dark Slate			650	664			
White Lime			664	715			
Dark Slate			715	725			
Pittsburgh Coal			725	733			
Slate			733	740			
White Sand			740	770			
Dark Slate			770	775			
White Lime			775	780			
Red Rock			780	783			
White Lime			783	810			
Red Rock			810	818			
White Lime			818	830			
Red Rock			830	840			
Lime Shells			840	865			

10/06/2023



B-3

STATE OF WEST VIRGINIA  
DEPARTMENT OF MINES  
OIL AND GAS DIVISION

INSPECTOR'S WELL REPORT

Permit No. WE7-30Y

Oil or Gas Well Oil  
(KIND)

Company Smith & Sons Drilling  
Address Barrenburg  
Farm Barren Tract

Well No. 19  
District Grant County Netzel

Drilling commenced \_\_\_\_\_

Drilling completed \_\_\_\_\_ Total depth \_\_\_\_\_

Date shot \_\_\_\_\_ Depth of shot \_\_\_\_\_

Initial open flow \_\_\_\_\_ /10ths Water in \_\_\_\_\_ Inch

Open flow after tubing \_\_\_\_\_ /10ths Merc. in \_\_\_\_\_ Inch

Volume \_\_\_\_\_ Cu. Ft.

Rock pressure \_\_\_\_\_ lbs. \_\_\_\_\_ hrs.

Oil \_\_\_\_\_ bbls., 1st 24 hrs.

Fresh water \_\_\_\_\_ feet \_\_\_\_\_ feet

Salt water \_\_\_\_\_ feet \_\_\_\_\_ feet

CASING AND TUBING	USED IN DRILLING	LEFT IN WELL	PACKERS
Size			
16			Kind of Packer
13			
10			Size of
8 1/4			
6 5/8			Depth set
5 3/16			
3			Perf. top
2			Perf. bottom
Liners Used			Perf. top
			Perf. bottom

CASING CEMENTED \_\_\_\_\_ SIZE \_\_\_\_\_ No. FT. \_\_\_\_\_ Date \_\_\_\_\_

COAL WAS ENCOUNTERED AT \_\_\_\_\_ FEET \_\_\_\_\_ INCHES

\_\_\_\_\_ FEET \_\_\_\_\_ INCHES \_\_\_\_\_ FEET \_\_\_\_\_ INCHES

\_\_\_\_\_ FEET \_\_\_\_\_ INCHES \_\_\_\_\_ FEET \_\_\_\_\_ INCHES

Drillers' Names \_\_\_\_\_

Well Adandoned and Plugged \_\_\_\_\_, 19\_\_\_\_.

REMARKS: Material on ground. Well placed  
erection of rig tomorrow

1-12-44

DATE

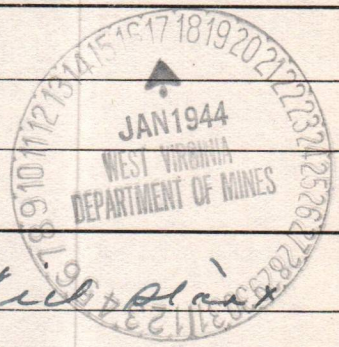

Heckman  
DISTRICT WELL INSPECTOR

10/06/2023

B-4

STATE OF WEST VIRGINIA  
DEPARTMENT OF MINES  
OIL AND GAS DIVISION

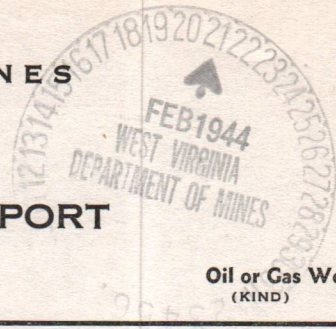

INSPECTOR'S WELL REPORT

Permit No. Net 302

Oil or Gas Well Oil  
(KIND)

Company	Casing and Tubing	Used in Drilling	Left in Well	Packers
<u>David L. Lewis, Trust</u>	Size			
<u>Franklin</u>	16			Kind of Packer
<u>Yard Road</u>	18			
Well No. <u>19</u>	10	<u>4 1/2</u>		Size of
District <u>Grant</u> County <u>Netzer</u>	8 1/4			
Drilling commenced	6 5/8			Depth set
Drilling completed	5 3/16			
Date shot	3			Perf. top
Initial Open Flow	2			Perf. bottom
Open Flow after tubing	Liners Used			Perf. top
Volume				Perf. bottom
Rock Pressure	CASING CEMENTED	SIZE	No. FT.	Date
Oil	COAL WAS ENCOUNTERED AT <u>715</u> FEET <u>96</u> INCHES			
Fresh water	FEET INCHES FEET INCHES			
Salt water	FEET INCHES FEET INCHES			

Drillers' Names Thomas

Well Abandoned and Plugged \_\_\_\_\_, 19\_\_\_\_

REMARKS: Little break at 1149-1182  
Drilling at 1533' Expect to  
reach Big Injuns at 2100'

7-17-44  
DATE

W. H. ...  
DISTRICT WELL INSPECTOR  
10/06/2023

0-1

FERC-121

RECEIVED

OCT 29 1980

1.0 API well number: (If not available, leave blank. 14 digits.)	47-103-0302			
2.0 Type of determination being sought: (Use the codes found on the front of this form.)	108 ✓ Section of NGPA		OIL & GAS DIVISION DEPT. OF MINES	
3.0 Depth of the deepest completion location: (Only needed if sections 103 or 107 in 2.0 above.)	_____ feet			
4.0 Name, address and code number of applicant: (35 letters per line maximum. If code number not available, leave blank.)	Pennzoil Company Name P. O. Box 1588 Street Parkersburg City		WV State	26101 Zip Code 014730 Seller Code
5.0 Location of this well: [Complete (a) or (b).] (a) For onshore wells (35 letters maximum for field name.)	Grant Field name Wetzel County		WV State	
(b) For OCS wells:	Area Name _____		Block Number _____	
	Date of Lease:  _ _ _ _ _ _ _  Mo. Day Yr.		OCS Lease Number _____	
(c) Name and identification number of this well: (35 letters and digits maximum.)	Barr Tract #19			
(d) If code 4 or 5 in 2.0 above, name of the reservoir: (35 letters maximum.)	_____			
6.0 (a) Name and code number of the purchaser: (35 letters and digits maximum. If code number not available, leave blank.)	Consolidated Gas Supply Corp. Name		004228 Buyer Code	
(b) Date of the contract:	0, 8, 1, 9, 7, 6 Mo. Day Yr.			
(c) Estimated annual production:	? MMcf.			
	(a) Base Price (\$/MMBTU)	(b) Tax	(c) All Other Prices [Indicate (+) or (-).]	(d) Total of (a), (b) and (c)
7.0 Contract price: (As of filing date. Complete to 3 decimal places.)	2.740	0.192	0.586	3.518
8.0 Maximum lawful rate: (As of filing date. Complete to 3 decimal places.)	2.740	0.192	0.586	3.518
9.0 Person responsible for this application:	James A. Crews Name		Manager, East. Div. Title	
Agency Use Only	Signature <i>James A. Crews</i>			
Date Received by Juris. Agency	October 3, 1980 Date Application is Completed		(304) 422-6565 Phone Number	
Date Received by FERC	OCT 29 1980			

10/06/2023

DATE: \_\_\_\_\_  
 OPERATOR: Pennzoil Company MAR 30 1981  
 PURCHASER: Consolidated Gas Supply Corp  
 MAR 30 1981

BUYER-SELLER CODE  
014730  
004228

Va. Department of Mines, Oil & Gas Division  
 WELL DETERMINATION FILE NUMBER  
10-29-108-103 = 0302  
 Above File Number on all Communications  
 Relating to Determination of this Well

*Qualifies J. Huggins*

CHECK EACH ITEM AS COMPLETE OR NOTE WHAT IS MISSING

NO. \_\_\_\_\_

1. FERC -121  Items not completed - Line No. \_\_\_\_\_

2. IV-1 Agent  James A. Crews

3. IV-2 Well Permit \_\_\_\_\_

4. IV-6 Well Plat

5. IV-35 Well Record  Drilling  Deepening \_\_\_\_\_

6. IV-36 Gas-Oil Test  Gas Only \_\_\_\_\_ Was Oil Produced?  Ratio \_\_\_\_\_

7. IV-39 Annual Production 21 <sup>months</sup>/<sub>years</sub>

8. IV-40 90 day Production 92 Days off line: \_\_\_\_\_

9. IV-48 Application for certification. Complete?

10. IV Form 51 - 52 - 53 - 54 - 55 - 56 - 57 - 58 Complete?  Affidavit Signed

11. Other: Survey \_\_\_\_\_ Logs \_\_\_\_\_ Geological Charts \_\_\_\_\_  
 Structure Map \_\_\_\_\_ 1: 4000 Map \_\_\_\_\_ Well Tabulations \_\_\_\_\_  
 Gas Analyses \_\_\_\_\_

12. Date commenced: 2-2-44 Date completed 3-3-44 Deepened \_\_\_\_\_

13. Production Depth: 1999 - 2117

14. Production Formation: Big Injun

15. Final Open Flow: NA

16. After Frac. R. P.: NA

17. Other Gas Test: \_\_\_\_\_

18. Avg. Daily Gas from Annual Production:  $\frac{41}{266} = .15 \text{ MCF}$ , oil  $\frac{102}{365} = 0.28 \text{ BBL}$

19. Avg. Daily Gas from 90-day ending w/1-120 days  $\frac{3}{92} = .03 \text{ MCF}$ , oil  $\frac{24}{92} = .26 \text{ BBL}$

20. Line Pressure: NA PSIG from Daily Report \_\_\_\_\_

21. Oil Production:  From Completion Report 2099-2117

22. Does lease inventory indicate enhanced recovery being done NO

23. Is affidavit signed?  Notarized?  10/06/2023

24. Official well record with the Department confirm the submitted information? No

25. Additional information \_\_\_\_\_ Does computer program confirm? \_\_\_\_\_

26. Determination Objected to \_\_\_\_\_ By Whom? \_\_\_\_\_

STATE OF WEST VIRGINIA  
DEPARTMENT OF MINES, OIL AND GAS DIVISION

Date October 3 1980  
Operator's  
Well No. Barr Tract #19  
API Well  
No. 17 - 103 - 0302  
State County Farm

WELL CLASSIFICATION FORM

STRIPPER GAS WELL

NGPA Section 103

DESIGNATED AGENT James A. Crews, Mgr. East. Div.

ADDRESS P. O. Box 1588

Parkersburg, WV 26101

WELL OPERATOR PENNZOIL COMPANY

ADDRESS P. O. Box 1588

Parkersburg, WV 26101

GAS PURCHASER Consolidated Gas Supply Corp. Gas Purchase Contract No. 3865 7.5'

ADDRESS P. O. Box 2450

Clarksburg, WV 26301

LOCATION: Elevation NA

Watershed North Fork, Fishing Ck

Dist. Grant County Wetzel Quad Big Run

Meter Chart Code 6809

Date of Contract 06-19-76

\* \* \* \* \*

Provide a complete inventory of the lease and production equipment used for the well for the previous 24 months or, if less than 24 months, the period the well has been in production. Include a complete list of equipment or processes used in connection with recognized enhanced recovery techniques during completion or production. (Attach separate sheets, if necessary.)

Standard wellhead arrangement with no extraordinary lease production equipment.

List all records reasonably available to you which contain information relevant to a determination of eligibility (including production records, B&O Tax Records and royalty payment records) and indicate the location of such records.

Gas Production Records) Location: Pennzoil Company  
Oil Production Records) 601 Grand Central Ave..  
Vienna, WV 26105

10/06/2023

Describe the search made of any records listed above:

Are you aware of any other information which would tend to be inconsistent with the information specified above? Yes  No . If yes, indicate the type and source of the information.

AFFIDAVIT

I, James A. Crews, having been first sworn according to law, state that I have caused to be made a diligent search of those records hereinbefore indicated in the manner herein described, that the information contained in this document is true and accurate and that on the basis of the records and examinations hereinbefore described, and to the best of my information, knowledge and belief, the well for which this certification is sought qualifies as a stripper well.

James A. Crews

STATE OF WEST VIRGINIA,

COUNTY OF Wood TO WIT.

I, Jean Paden, a Notary Public in and for the state and county aforesaid, do certify that James A. Crews, whose name is signed to the writing above, bearing date the 16 day of September, 19 80, has acknowledged the same before me, in my county aforesaid.

Given under my hand and official seal this 10 day of October, 1980. 10/06/2023

My term of office expires on the 14 day of November, 1989.

Jean Paden  
Notary Public

IV-39-WC

STATE OF WEST VIRGINIA  
DEPARTMENT - MINES  
DIVISION - OIL AND GAS

OPERATOR

*Ferdinand Company*

REPORT OF MONTHLY PRODUCTION  
GAS VOLUMES IN MCF @ 14.73  
OIL IN BARRELS @ 60 DEGREES

REPORT DATE

10/06/2023

10/3/80

YEAR 1979

API# 103-0302 FARM *Bar Tract # 19* COUNTY *Lincoln*

GAS MCF	OIL BBL	DAYS ON LINE	FARM	COUNTY	AVG. FLOW PRESSURE												SHIFT-IN PRESSURE	TOTALS
					J	F	M	A	M	J	J	A	S	O	N	D		
8	11	31			1	1	2	1	2	1	2	5	8	31	31	31	52	
8	10	31			3	3	3	3	3	3	3	3	3	31	31	31	136	
TOTALS																		

YEAR 1980

GAS MCF	OIL BBL	DAYS ON LINE	FARM	COUNTY	AVG. FLOW PRESSURE												SHIFT-IN PRESSURE	TOTALS
					J	F	M	A	M	J	J	A	S	O	N	D		
4	14	31			1	1	1	1	1	1	1	1	1	31	31	31		
6	10	31			4	4	4	4	4	4	4	4	4	31	31	31		
5	6	31			3	3	3	3	3	3	3	3	3	31	31	31		
TOTALS																		

SUMMARIZATION SCHEDULE  
Section 271. 804 (b)

In accordance with Section 271.804 (b) please list all other wells which are to be used in determining this well classification under Part 271 Subpart H.

API NUMBERS

39°35'

Greenlee & Forsythe

Prunty surf

Bar Tract

81257-1003 1/2

Fee Oil

NORTH RIVER

7.5' TOPO

Greenlee & Forsythe

1066 3/4

Michael

(+) DENOTES LOCATION OF WELL ON UNITED STATES TOPOGRAPHIC MAPS

FORM IV-6 (8-78)

N59 N8 E4



DATE 1-4-1979  
OPERATOR'S WELL NO 19  
API WELL NO. 47-103-0302  
STATE COUNTY PERMIT

STATE OF WEST VIRGINIA DEPARTMENT OF MINES OIL AND GAS DIVISION

WELL TYPE: OIL  GAS \_\_\_\_\_ LIQUID INJECTION \_\_\_\_\_ WASTE DISPOSAL \_\_\_\_\_ (IF "GAS", PRODUCTION \_\_\_\_\_ STORAGE \_\_\_\_\_ DEEP \_\_\_\_\_ SHALLOW

LOCATION: ELEVATION \_\_\_\_\_ WATER SHED NORTH FORK FISHING CK DISTRICT GRANT COUNTY WETZEL

QUADRANGLE BIG RUN 7.5' SURFACE OWNER \_\_\_\_\_ ACREAGE \_\_\_\_\_

OIL & GAS ROYALTY OWNER \_\_\_\_\_ LEASE NO. \_\_\_\_\_ LEASE ACREAGE \_\_\_\_\_

PROPOSED WORK: DRILL \_\_\_\_\_ CONVERT \_\_\_\_\_ DRILL DEEPER \_\_\_\_\_ REDRILL \_\_\_\_\_ FRACTURE OR STIMULATE \_\_\_\_\_ PLUG OFF OLD FORMATION \_\_\_\_\_ PERFORATE NEW FORMATION \_\_\_\_\_ OTHER PHYSICAL CHANGE IN WELL (SPECIFY) \_\_\_\_\_

PLUG AND ABANDON \_\_\_\_\_ CLEAN OUT AND REPLUG \_\_\_\_\_ TARGET FORMATION \_\_\_\_\_ ESTIMATED DEPTH \_\_\_\_\_

WELL OPERATOR Pennzoil Company DESIGNATED AGENT James A. Crews

ADDRESS P. O. Box 1588 ADDRESS P. O. Box 1588

Parkersburg, WV 26101 Parkersburg, WV 26101

10/06/2023



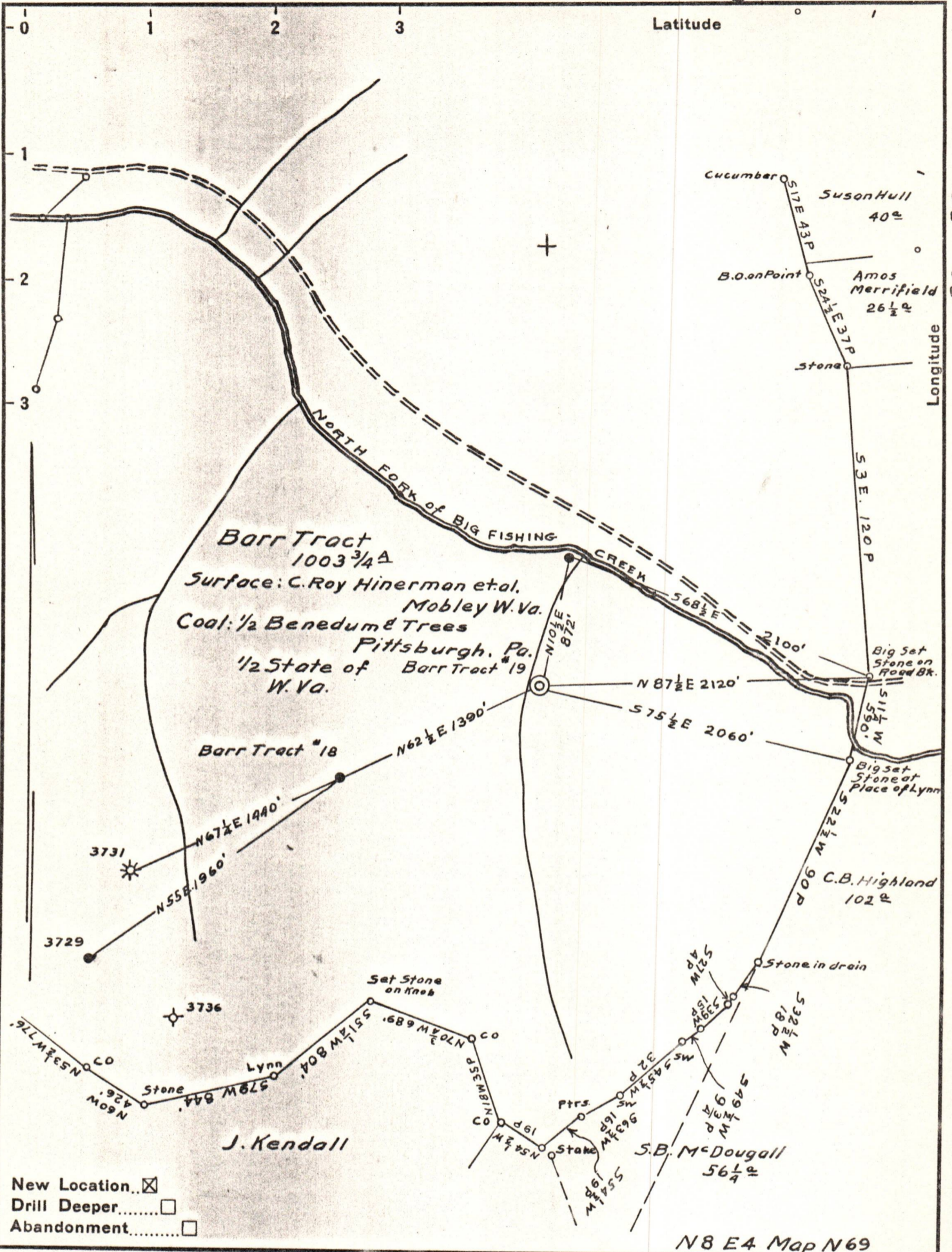

Company	South Penn Natural Gas Co.
Address	Parkersburg, W. Va.
Farm	Barr Tract
Tract	Acres 1003. <sup>75</sup> Lease No. 81357
Well (Farm) No.	19 Serial No.
Elevation (Spirit Level)	994.66'
Quadrangle	Littleton
County	Wetzel District Grant
Engineer	E.C. Tabler
Engineer's Registration No.	
File No.	Drawing No.
Date	12-14-43. Scale 1" = 800'

STATE OF WEST VIRGINIA  
DEPARTMENT OF MINES  
OIL AND GAS DIVISION  
CHARLESTON

**WELL LOCATION MAP**  
FILE NO. WEL-302 10/06/2023

+ Denotes location of well on United States Topographic Maps, scale 1 to 62,500, latitude and longitude lines being represented by border lines as shown.

- Denotes one inch spaces on border line of original tracing.

"IMPERIAL" TRACING CLOTH K & E CO., N. Y.