

A-1 FORM OG-1



STATE OF WEST VIRGINIA  
DEPARTMENT OF MINES  
OIL AND GAS DIVISION

NOTICE OF PROPOSED LOCATION OF OIL AND GAS WELL

To THE DEPARTMENT OF MINES,  
Charleston, W. Va.

BERTHA COAL HOLDING CO.  
COAL OPERATOR OR COAL OWNER  
% Robinson & Robinson, Attorneys,  
UNIONTOWN, PA.  
ADDRESS

CARNEGIE NATURAL GAS COMPANY  
NAME OF WELL OPERATOR  
1015 FRICK BUILDING  
PITTSBURGH, PA.  
COMPLETE ADDRESS

OWNERS of MINERAL RIGHTS:  
~~X. LEGAL OPERATOR OR COAL OWNER~~  
CLARA BAKER PYLES,  
JOHN BAKER,  
ADDRESS  
LILLIAN NEELY,  
WARREN A. BAKER,  
OWNER OF MINERAL RIGHTS  
GRETTA A. BAKER,  
CAMERON, W. VA.  
ADDRESS

OCTOBER 31, 1944  
PROPOSED LOCATION  
CENTER District  
WETZEL County  
Well No. 1612 39° 45'  
80° 25'  
CLARA BAKER PYLES Farm

GENTLEMEN:

The undersigned well operator is entitled to drill upon the above named farm or tract of land for oil and gas, having fee title thereto, (or as the case may be) under grant or lease dated FEBRUARY 11, 1943, made by CLARA BAKER PYLES ET AL, to CARNEGIE NATURAL GAS COMPANY, and recorded on the 20th day of APRIL, 1943, in the office of the County Clerk for said County in Book 36-A, page 328.

The enclosed plat was prepared by a competent engineer and shows the proposed location of a well to be drilled for oil and gas by the undersigned well operator on the farm and in the Magisterial District and County above named, determined by survey and courses and distances from two permanent points, or land marks.

The undersigned well operator is informed and believes there are no coal operators operating beds of coal beneath said farm or tract of land on which said well is located, or within 500 feet of the boundaries of the same, who have mapped their workings and filed their maps as required by law, excepting the coal operators or coal owners (if any) above named as addressees.

The above named coal operators or coal owners (if any) are notified that any objections they may desire to make to such proposed location, or which they are required to make by Section 3 of said Code, if the drilling of a well at said proposed location will cause a dangerous condition in or about their respective coal mines, must be received by, or filed with the Department of Mines within ten\* days from the receipt of a copy of this notice and accompanying plat by said Department. Said coal operators are further notified that forms for use in making such objections will be furnished to them by the Department of Mines promptly on request and that all such objections must set forth as definitely as is reasonably possible the ground or grounds on which such objections are based and indicate the direction and distance the proposed location should be moved to overcome same.

(The next paragraph is to be completed only in Department's copy.)

Copies of this notice and the enclosed plat were mailed by registered mail, or delivered to the above named coal operators or coal owners at their above shown respective address \_\_\_\_\_ day \_\_\_\_\_ before, or on the same day with the mailing or delivery of this copy to the Department of Mines at Charleston, West Virginia.

Very truly yours,

CARNEGIE NATURAL GAS COMPANY,

By B. V. Archer  
WELL OPERATOR Land Agent.

1015 FRICK BUILDING

STREET

PITTSBURGH

CITY OR TOWN

PENNSYLVANIA

STATE

10/06/2023

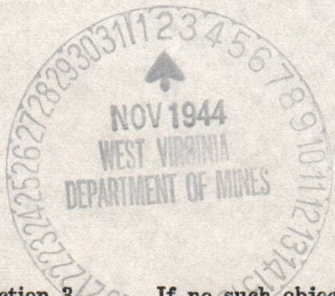

Address of Well Operator }

\*Section 3. . . . If no such objections be filed or be found by the department of mines, within said period of ten days from the receipt of said notice and plat by the department of mines, to said proposed location, the department shall forthwith issue to the well operator a drilling permit reciting the filing of such plat, that no objections have been made by the coal operators to the location, or found thereto by the department, and that the same is approved and the well operator authorized to proceed to drill at said location.

323



STATE OF WEST VIRGINIA  
DEPARTMENT OF MINES  
OIL AND GAS DIVISION

NOTICE OF PROPOSED LOCATION OF OIL AND GAS WELL

To The Department of Mines,  
Charleston, W. Va.

UNIONTOWN, PA.  
GOAL OPERATOR OR COAL OWNER  
ROBINSON & ROBINSON, ATTORNEYS,  
BERNIE COAL HOLDING CO.

CAMERON, W. VA.  
OWNER OF MINERAL RIGHTS  
GERTTA A. BAKER,  
WARREN A. BAKER,  
LILLIAN BERRY,  
JOHN BAKER,  
CLARA BAKER PYLES

PITTSBURGH, PA.  
NAME OF WELL OPERATOR  
1015 PRICK BUILDING  
CARNegie NATURAL GAS COMPANY

Well No. 1015  
County WEST VIR  
District CENTER  
PROPOSED LOCATION  
OCTOBER 31  
CLARA BAKER PYLES

The undersigned well operator is entitled to drill upon the above named farm or tract of land for oil and gas having the title thereto, (or as the case may be) under grant or lease dated FEBRUARY 11, 1913, made by CLARA BAKER PYLES ET AL to CARNegie NATURAL GAS COMPANY, and recorded on the 30th day of APRIL, 1913, in the office of the County Clerk for said County in Book 36-A, page 358.

The enclosed plat was prepared by a competent engineer and shows the proposed location of a well to be drilled for oil and gas by the undersigned well operator on the farm and in the Magisterial District and County above named, determined by survey and courses and distances from two permanent points, or land marks. The undersigned well operator is informed and believes there are no coal operators operating beds of coal beneath said farm or tract of land on which said well is located, or within 500 feet of the boundary of the same, who have mapped their workings and filed their maps as required by law, excepting the coal operators or coal owners (if any) above named as addressees. The above named coal operators or coal owners (if any) are notified that any objections they may desire to make to such proposed location, or which they are required to make by Section 3 of said Code, if coal mines must be received by or filed with the Department of Mines within ten days from the receipt of a copy of this notice and accompanying plat by said Department. Said coal operators are further notified that forms for use in making such objections will be furnished to them by the Department of Mines promptly on request and that all such objections must set forth as definitely as is reasonably possible the ground or grounds on which such objections are based and indicate the direction and distance the proposed location should be moved to overcome same.

(The next paragraph is to be completed only in Department's copy.) Copies of this notice and the enclosed plat were mailed by registered mail, or delivered to the above named coal operators or coal owners at their above shown respective addresses \_\_\_\_\_ day \_\_\_\_\_ before, or on the same day with the mailing or delivery of this copy to the Department of Mines at Charleston, West Virginia.

Very truly yours,  
CARNegie NATURAL GAS COMPANY,  
By \_\_\_\_\_  
WELL OPERATOR  
1015 PRICK BUILDING  
PITTSBURGH  
PENNSYLVANIA

Address of Well Operator

10/06/2023

\*Section 3. If no such objections be filed or be found by the department of mines, within said period of ten days from the receipt of said notice and plat by the department of mines, to said proposed location, the department shall forthwith issue to the well operator a drilling permit reciting the filing of such plat, that no objections have been made by the coal operators to the location, or found thereto by the department, and that the same is approved and the well operator authorized to proceed to drill at said location.

A-9

November 3, 1944

Bertha Coal Holding Company  
Uniontown, Pennsylvania

Att: Robinson & Robinson, Attorneys

Gentlemen:

A notice of proposed location of Well No. 1612 on the Clara Baker Pyles Farm, Center District, Wetzel County, has been received from the Carnegie Natural Gas Company, Pittsburgh, Pennsylvania.

If there are any objections to the location coming our jurisdiction, please file same not later than November 13, 1944.

Very truly yours,

Secretary  
OIL AND GAS DIVISION

MG:g

10/06/2023

A10

November 13, 1944

Carnegie Natural Gas Company  
1015 Frick Building  
Pittsburgh, Pennsylvania

Gentlemen:

Permit WET-323 to drill Well No. 1612 on the Clara  
Baker Pyles Farm, Center District, Wetzel County, is enclosed.

Very truly yours,

Secretary  
OIL AND GAS DIVISION

MG/jh  
enc-2

CC: Inspector D. F. Desist

10/06/2023

A-11

# Carnegie Natural Gas Company

General Offices; Frick Building

Pittsburgh, Pa.

November 17, 1944.

B. H. ARCHER,  
Land Agent.

State of West Virginia,  
Department of Mines,  
Charleston, West Virginia

Attention: Marie E. Griffith, Secretary,  
Oil and Gas Division.

Dear Sirs:

On November 13 you issued and forwarded to us Permit No. GIL-681 to drill well #6-1613 on the Despard Heirs farm, Center District, Gilmer County. This Permit was in order and properly filled in.

On the same day you wrote a letter which we quote:

"Permit WET-323 to drill Well No. 1612 on the Clara Baker Pyles farm, Center District, Wetzel County, is enclosed."

The Permit, however, was a repetition of GIL-681 covering well #6-1613, Despard Heirs farm, Center District, Gilmer County. It is enclosed for the purpose of correction.

Yours very truly,

CARNEGIE NATURAL GAS COMPANY,

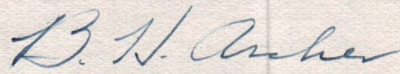

Land Agent.

BHA: MV  
cc  
enc.



10/06/2023

Commercial National Gas Company

General Office, 1000 Building

November 14, 1944

E. H. ARONER  
Land Agent

State of West Virginia,  
Department of Mines,  
Charleston, West Virginia

Attention: Marie E. GILLIN, Secretary,  
Oil and Gas Division

Dear Sir:

On November 12 you asked and forwarded to  
us permit No. 411-041 to drill well No. 1118 on the  
Dartford Farm, Center District, Gilmer County.  
This permit was in order and properly filled in.

On the same day you wrote a letter which  
we quote:

"Permit 411-041 to drill well No. 1118 on  
the Dartford Farm, Center District,  
Gilmer County, is enclosed."

The permit, however, was a repetition of 411-041  
covering well No. 1118, Dartford Farm, Center  
District, Gilmer County. It is enclosed for the  
purpose of correction.

Yours very truly,

CARLENE WALKER, GAS COMPANY

EHA:WV  
cc  
enc.

Land Agent

A-12

November 20, 1944

Carnegie Natural Gas Company  
1015 Frick Building  
Pittsburgh, Pennsylvania

Gentlemen:

Corrected permit WET-323 to drill Well No. 1612  
on the Clara Baker Pyles Farm, Center District, Wetzel County,  
is enclosed.

Very truly yours,

Secretary  
OIL AND GAS DIVISION

MG/jh  
enc-2

10/06/2023

B-2

Formation	Color	Hard or Soft	Top	Bottom	Oil, Gas or Water	Depth Found	Remarks
Slate	Light	Soft	995	1015			
Rock	Red	Soft	1015	1063			
Slate	Light	Soft	1063	1075			
Lime	Light	Hard	1075	1110			
Slate	Light	Soft	1110	1180			
Slate	Dark	Soft	1180	1220			
Lime	Light	Soft	1220	1250			
Sand	Light	Med. Hard	1250	1275			
Slate	Dark	Soft	1275	1315			
Slate	Light	Soft	1315	1330			
Rock	Pink	Soft	1330	1340			
Sand	Light	Hard	1340	1415			Big Dunkard
Slate	Dark	Soft	1415	1470			
Sand	Light	Hard	1470	1500			Gas Sand
Slate	Dark	Soft	1500	1525			
Lime	Light	Hard	1525	1532			
Slate	Light	Soft	1532	1548			
Sand	Light	Hard	1548	1557			
Slate	Dark	Soft	1557	1595			
Sand	Light	Hard	1595	1610			1st Salt
Slate	Light	Soft	1610	1645			
Sand	Light	Hard	1645	1685	Water	1650	2nd Salt
Slate	Dark	Soft	1685	1742			
Sand	Light	Hard	1742	1775	Water-hole full -	1760'	3rd Salt
Slate	Light	Soft	1775	1790			
Sand	Light	Hard	1790	1825			Maxton
Slate	Dark	Soft	1825	1904			
Sand	Light	Hard	1904	1915			Little Lime
Slate	Dark	Soft	1915	1955			
Sand	Light	Hard	1955	2012			Big Lime
Sand	Light	Hard	2012	2248			Big Injun
Slate	Dark	Soft	2248	2350			
Lime	Light	Hard	2350	2450			
Slate and Lime Shells	Dark	Soft and Hard	2450	2495			
Shale	Dark	Soft	2495	2550			
Slate & Shells	Dark	Soft	2550	2585			
Lime	Light	Hard	2585	2605			
Slate	Dark	Soft	2605	2612			
Slate and Lime Shells	Dark	Med. Hard	2612	2684			
Rock	Red	Soft	2684	2728			
Slate & Shells	Light	Soft	2728	2830	Oil - show	2834'	
Sand	Light	Hard	2830	2844			Gordon Stray
Slate	Light	Soft	2844	2870			
Sand	Light	Soft	2870	2890			
Slate	Light	Soft	2890	2908			
Sand	Light	Hard	2908	2916	Gas	2912'	Gordon
					40/10 Water	in 1"	
Slate	Light	Soft	2916	2985			
Lime	Light	Medium	2985	2990	Gas	2986'	
					70/10 Water	in 3"	
Slate	Light	Soft	2990	3081	Blew down to	9/10 Water	in 1/2"
TOTAL DEPTH				3081			
			<b>OWNERS of SURFACE and MINERAL RIGHTS:</b>				
			Clara Baker Pykos, John Baker, Lillian Neely, Warren A. Baker, Gretta A. Baker, Cameron, W. Va.				

10/06/2023

Date FEBRUARY 14, 1945

APPROVED CARNEGIE NATURAL GAS COMPANY, Owner

By B. N. Archer  
(Title) Land Agent.



06-10  
B-1



STATE OF WEST VIRGINIA  
DEPARTMENT OF MINES  
OIL AND GAS DIVISION

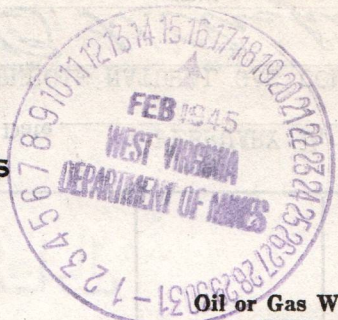

WELL RECORD

DRY HOLE

Permit No. WET-323

Oil or Gas Well XXXXX  
(KIND)

Company Carnegie Natural Gas Company  
Address 1015 Frick Bldg., Pittsburgh, Pa.  
Farm Clara Baker Pyles Acres 65  
Location (waters) Laurel Run  
Well No. E-1612 Elev. 1155  
District Center County Wetzel  
The surface of tract is owned in fee by SEE REVERSE SIDE  
Address SEE REVERSE SIDE  
Mineral rights are owned by SEE REVERSE SIDE  
Address SEE REVERSE SIDE  
Drilling commenced December 4, 1944  
Drilling completed February 5, 1945  
Date Shot Feb. 8, 1945 From 2907'6" To 2915'  
With 30 quarts' nitroglycerine  
Open Flow 70 /10ths Water in 3 Inch  
/10ths Merc. in      Inch  
Volume 794,000 cu.ft. blew down to 8,000 Cu. Ft.  
Rock Pressure 24# lbs 24 hrs.  
Oil --- bbls., 1st 24 hrs.  
Fresh water 40 feet 845 feet  
Salt water      feet      feet

Casing and Tubing	Used in Drilling	Left in Well	Packers
Size			
16			Kind of Packer
18			
10	231'		Size of
8 1/4	1352'		
6	1794'		Depth set
5 3/16			
3			Perf. top
2			Perf. bottom
Liners Used			Perf. top
			Perf. bottom

CASING CEMENTED      SIZE      No. Ft.      Date     

COAL WAS ENCOUNTERED AT 735 FEET      INCHES  
840 FEET      INCHES      FEET      INCHES  
     FEET      INCHES      FEET      INCHES

Formation	Color	Hard or Soft	Top	Bottom	Oil, Gas or Water	Depth Found	Remarks
Clay	Yellow	Soft	0	10			
Lime	Light	Medium	10	20			
Slate	Light	Soft	20	30			
Rock	Red	Soft	30	35			
Lime	Light	Hard	35	60	Fresh Water	40'	Hole full
Slate	Light	Soft	60	75			
Sand	Light	Medium	75	83			
Slate	Light	Soft	83	150			
Rock	Red	Soft	150	160			
Slate	Light	Soft	160	200			
Rock	Red	Soft	200	210			
Slate	Dark	Soft	210	225			
Lime	Light	Medium Hard	225	240			
Slate	Light	Soft	240	250			
Lime	Light	Hard	250	280			
Slate	Dark	Soft	280	310			
Sand	Light	Hard	310	330			
Slate	Light	Soft	330	345			
Lime	Light	Hard	345	360			
Slate	Light	Soft	360	375			
Coal	Black	Soft	375	377			
Slate	Dark	Soft	377	470			
Sand	Light	Soft	470	505			
Slate	Dark	Soft	505	575			
Lime	Light	Hard	575	620			
Slate	Dark	Soft	620	735			
Coal	Black	Hard	735	740			Mapletown
Lime	Light	Soft	740	840			
Coal	Black	Soft	840	845			Pittsburgh
Lime	Light	Hard	845	855			
Slate	Light	Soft	855	875			
Lime	Light	Hard	875	890			
Slate	Light	Soft	890	920			
Lime	Light	Hard	920	952			
Rock	Red	Soft	952	960			
Sand	Light	Hard	960	970	Water	845'	1/2 bailer per hr.
Slate	Light	Hard	970	975			
Rock	Red	Soft	975	995			

10/06/2023

B-3

STATE OF WEST VIRGINIA  
DEPARTMENT OF MINES  
OIL AND GAS DIVISION

INSPECTOR'S WELL REPORT

Permit No. C WET-323-P

Oil or Gas Well Gas  
(KIND)

		CASING AND TUBING	USED IN DRILLING	LEFT IN WELL	PACKERS
Company	<u>Carnegie Natural Gas Co.</u>				
Address	<u>1015 Frick Building, Pittsburgh, Pa.</u>	Size			
Farm	<u>John Booth,</u>	16			Kind of Packer
Well No.	<u>15-1612</u>	13			
District	<u>Church</u> County <u>Wetzel</u>	10			Size of
Drilling commenced		8 3/4			
Drilling completed	Total depth	6 5/8			Depth set
Date shot	Depth of shot	5 3/16			
Initial open flow	/10ths Water in Inch	3			Perf. top
Open flow after tubing	/10ths Merc. in Inch	2			Perf. bottom
Volume	Cu. Ft.	Liners Used			Perf. top
Rock pressure	lbs. hrs.				Perf. bottom
Oil	bbls., 1st 24 hrs.	CASING CEMENTED	SIZE	No. FT.	Date
Fresh water	feet				
Salt water	feet	COAL WAS ENCOUNTERED AT	FEET	INCHES	
			FEET	INCHES	FEET
			FEET	INCHES	FEET

Drillers' Names Jacob Wilson did this work on contract.

Well Adandoned and Plugged Feb. 26th, 19 45

REMARKS: All casing recovered. Job completed. Well Record attached, affidavit will be mailed

Feb 27th, 1945.  
DATE

*Benjamin*

DISTRICT WELL INSPECTOR

10/06/2023

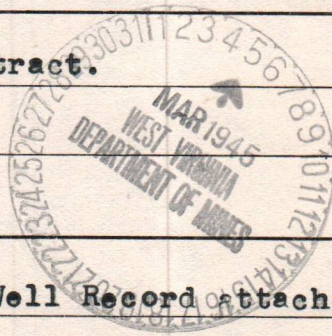

B-9

PROPOSED MANNER OF PLUGGING AND FILLING WELL

(REQUIRED BY RULES AND REGULATIONS)

WEST VIRGINIA DEPARTMENT OF MINES

OIL AND GAS DIVISION

WORK ORDER

Well to be plugged and filled as follows: TOTAL DEPTH - 3081'

	Clay	3081' - 2888'	
6-5/8" Solid Wood Plug	Cement	2888' - 2885'	
	Clay	2885' - 2875'	
	Cement	2875' - 2720'	
Anchor permanent bridge at 1855', one sack neat cement on bridge.			
	Clay	1855' - 1817'	
6-5/8" Solid Wood Plug	Cement	1817' - 1814'	
Remove 1794' of 7.00" O.D. casing.		1814' - 1804'	
	Clay	1804' - 1625'	
8-1/4" Solid Wood Plug	Cement	1625' - 1622'	
	Cement	1622' - 1612'	
Anchor permanent bridge at 1445', one sack neat cement on bridge.			
	Clay	1445' - 1372'	
	Cement	1372' - 1362'	
Remove 1352' of 8.625" casing.			
Anchor permanent bridge at 875'.	Cement	875' - 820'	-- This being 30' below to 20' above Pittsburgh Coal.
	Clay	820' - 770'	
	Cement	770' - 715'	-- This being 30' below to 20' above Mapleten Coal.
	Clay	715' - 250'	
	Cement	250' - 240'	
Remove 231' of 10.750" O.D. casing.			
	Clay	240' to surface.	

Erect marker such as described in Rule 18, 1931 Regulations. All work to be done in workmanlike manner.

To the Department of Mines  
Coal Owner or Operator,  
Lease or Property Owner.

Gentlemen:

This "work order" is submitted for your approval and concurrence and unless notified of your disapproval or non-concurrence, the undersigned will proceed with the plugging and filling of said well in the above described manner on the date stated in the notice of intention to plug and abandon the said well on opposite side of this sheet.

Very truly yours,  
CARNEGIE NATURAL GAS COMPANY,

By [Signature]  
President. Well Operator.

No objections have been filed by the coal owner or coal operator, or any available adjacent lease or property owners or interposed by the Department of Mines to the manner herein described for the plugging and filling of the well above mentioned. Therefore, the same is hereby approved this

10/06/2023

17th day of February, 1945.

DEPARTMENT OF MINES  
Oil and Gas Division

By: \_\_\_\_\_

NOTE: This "work order" shall be filed in triplicate, one copy for the files of the Department of Mines; one to be approved or corrected and returned to the well operator as his authority for plugging said well; and one for the well inspector.

B-8



STATE OF WEST VIRGINIA  
DEPARTMENT OF MINES  
OIL AND GAS DIVISION

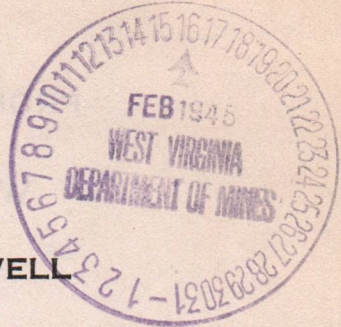

NOTICE OF INTENTION TO PLUG AND ABANDON WELL

(REQUIRED BY SECTION 9, ARTICLE 4, CHAPTER 22 OF THE CODE)

To THE DEPARTMENT OF MINES,  
Charleston, W. Va.

BERTHA COAL HOLDING CO.

COAL OPERATOR OR COAL OWNER

% Robinsen & Robinsen, Attorneys,  
UNIONTOWN, PA.

ADDRESS

CARNEGIE NATURAL GAS COMPANY

NAME OF WELL OPERATOR

1015 FRICK BUILDING  
PITTSBURGH, PA.

COMPLETE ADDRESS

OWNERS of MINERAL RIGHTS:

~~NAME OF PROPERTY OWNER~~

CLARA BAKER PYLES

JOHN BAKER

~~ADDRESS~~

LILLIAN NEELY

WARREN A. BAKER

~~NAME OF PROPERTY OWNER~~

GRETTA A. BAKER,

CAMERON, W. VA.

ADDRESS

FEBRUARY 14 1945

WELL TO BE ABANDONED

CENTER District

WETZEL County

Well No. 1612

CLARA BAKER PYLES Farm

NOTE: If work cannot begin on date scheduled below, write Inspector  
Gentlemen:— A. C. Beeson, Mannington, W. Va., or call the Oil & Gas Division  
Charleston - 34-741

The undersigned well operator is about to abandon the above described well and will commence

the work of plugging and abandoning said well on the 20th day of FEBRUARY, 1945,  
(which date shall not be less than five days after the day on which this notice so mailed is received,  
or in due course should be received by the Department of Mines.)

This notice is given you in order that your respective representatives may be present at the  
plugging and filling of said well. You are further notified that whether you are represented or not  
represented the undersigned will proceed on that date, or shortly thereafter, to plug and fill said  
well in the manner required by Section 10, Article 4, Chapter 22 of the Code and given in detail on the  
reverse side of this notice, in "Work Order."

This notice is being mailed by registered mail to each of you at the above addresses on the  
above date.

Very truly yours,

CARNEGIE NATURAL GAS COMPANY,

By [Signature]  
President. Well Operator.

10/06/2023

NOTE: Upon the abandonment of all wells drilled prior to June 1, 1929, a plat prepared by a competent  
engineer, showing the district and county in which the tract of land is located, the name and acreage of same,  
the names of the owners and adjacent tracts, and the location of the about to be abandoned well, determined  
by survey, and the courses and distances of such well from two permanent points or landmarks on said tract, shall  
be submitted with this notice.

(Over)

WET-323-P PERMIT NUMBER



STATE OF WEST VIRGINIA  
DEPARTMENT OF MINES  
OIL AND GAS DIVISION

AFFIDAVIT OF PLUGGING AND FILLING WELL

AFFIDAVIT SHOULD BE MADE IN TRIPPLICATE, ONE COPY MAILED TO THE DEPARTMENT, ONE COPY TO BE RETAINED BY THE WELL OPERATOR AND THE THIRD COPY (AND EXTRA COPIES IF REQUIRED) SHOULD BE MAILED TO EACH COAL OPERATOR AT THEIR RESPECTIVE ADDRESSES.

<u>BERTHA COAL HOLDING CO.</u>	<u>CARNEGIE NATURAL GAS COMPANY</u>
<u>% Robinson &amp; Robinson, Attorneys,</u> <u>UNIONTOWN, PA.</u>	<u>1015 FRICK BUILDING</u> <u>PITTSBURGH, PA.</u>
ADDRESS	COMPLETE ADDRESS
<u>OWNER of MINERAL RIGHTS:</u>	<u>FEBRUARY 28,</u> 194 <u>5.</u>
<u>CLARA BAKER PYLES</u>	<u>WELL AND LOCATION</u>
<u>JOHN BAKER</u>	<u>CENTER</u> District
<u>LILLIAN NEELY</u>	<u>WETZEL</u> County
<u>WARREN A. BAKER</u>	Well No. <u>E-1612</u>
<u>GRETTA A. BAKER,</u>	<u>CLARA BAKER PYLES</u> Farm
ADDRESS	
<u>CAMERON, W. VA.</u>	

STATE INSPECTOR SUPERVISING PLUGGING A. C. Beeson, Mannington, W. Va.

AFFIDAVIT

STATE OF WEST VIRGINIA,  
County of Wetzel } ss:

Adam W. Wilson and Chas. E. Ice  
being first duly sworn according to law depose and say that they are experienced in the work of plugging and filling oil and gas wells and were employed by CARNEGIE NATURAL GAS COMPANY, well operator, and participated in the work of plugging and filling the above well, that said work was commenced on the 20 day of February, 194 5., and that the well was plugged and filled in the following manner:

SAND OR ZONE RECORD	FILLING MATERIAL		PLUGS USED	CASING			
	FORMATION	CONTENT		FROM	TO	CSG PULLED	CSG LEFT IN
Gordon Sand	Clay	3081'	2888'	6-5/8" Wood			
	Wood Plug	2888'	2885'				
	Cement	2885'	2875'				
Gordon Stray	Clay	2875'	2720'	6-5/8" Wood			
	Cement	2720'	2710'				
Big Lime	Bridge	1855'	One sack neat cement on bridge				
	Clay	1855'	1817'	6-5/8" Wood			
	Wood Plug	1817'	1814'				
Maxton Sand	Cement	1814'	1804'			1794'	7" O.D.
	Clay	1804'	1625'	8-1/2" Wood			
	Wood Plug	1625'	1622'				
2nd, Salt Sand	Cement	1622'	1612'				
	Bridge	1445'	One sack neat cement on bridge	8-1/2" Wood			
	Clay	1445'	1372'				
Big Dunkard	Cement	1372'	1362'			1352'	8.625" O.D.
	Bridge	875'	One sack neat cement on bridge	8-1/2" Wood			
Pittsburgh Coal	Cement	875'	820'			231'	10.750" O.D.
	Clay	820'	770'				
<u>Mapletown Coal</u>	Cement	770'	715'	DESCRIPTION OF MONUMENT Size 2' x 1'-6" x 1'-2" Carnegie Natural Gas Company SURFACE. February 25, 1945. C.B.Pyles No. E-1612			
(NAME)	Clay	715'	250'				
(NAME)	Cement	250'	240'				
(NAME)	Clay	240'	SURFACE.				

and that the work of plugging and filling said well was completed on the 25 day of February, 194 5.

And further deponents saith not.

Sworn to and subscribed before me this 8th day of March, 194 5.

My commission expires:

May 19 1945

Notary Public.

Permit No. Wet-323-P

10/06/2023

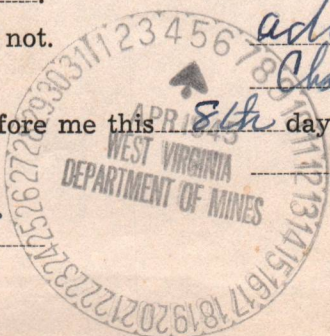
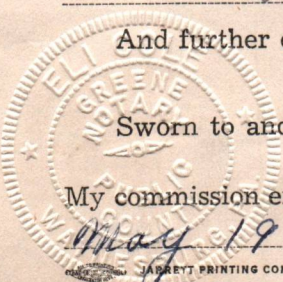

STATE OF WEST VIRGINIA  
DEPARTMENT OF MINES  
OIL AND GAS DIVISION

AFFIDAVIT OF PLUGGING AND FILLING WELL

THIS AFFIDAVIT SHOULD BE MADE IN TRIPlicate, one copy to be filed in the Department, one copy to be retained by the well owner and the third copy to be retained by the well operator. It is required to be filed in the Department at the time the well is plugged and filled.

STATE OF WEST VIRGINIA  
County of NEWCASTLE  
I, Edwin W. Wilson, being duly sworn, depose and say that I am the owner of the well known as WELL NO. 101-B, located in NEAR BRACKEN RIDGE, BRACKEN RIDGE TOWNSHIP, NEWCASTLE COUNTY, WEST VIRGINIA, and that said well was plugged and filled with CEMENT on the 28th day of APRIL, 1928.  
I, A. C. Seaman, being duly sworn, depose and say that I am the operator of the well known as WELL NO. 101-B, located in NEAR BRACKEN RIDGE, BRACKEN RIDGE TOWNSHIP, NEWCASTLE COUNTY, WEST VIRGINIA, and that said well was plugged and filled with CEMENT on the 28th day of APRIL, 1928.  
I, John Baker, being duly sworn, depose and say that I am the well operator of the well known as WELL NO. 101-B, located in NEAR BRACKEN RIDGE, BRACKEN RIDGE TOWNSHIP, NEWCASTLE COUNTY, WEST VIRGINIA, and that said well was plugged and filled with CEMENT on the 28th day of APRIL, 1928.  
I, William Henry, being duly sworn, depose and say that I am the well operator of the well known as WELL NO. 101-B, located in NEAR BRACKEN RIDGE, BRACKEN RIDGE TOWNSHIP, NEWCASTLE COUNTY, WEST VIRGINIA, and that said well was plugged and filled with CEMENT on the 28th day of APRIL, 1928.  
I, John Baker, being duly sworn, depose and say that I am the well operator of the well known as WELL NO. 101-B, located in NEAR BRACKEN RIDGE, BRACKEN RIDGE TOWNSHIP, NEWCASTLE COUNTY, WEST VIRGINIA, and that said well was plugged and filled with CEMENT on the 28th day of APRIL, 1928.  
I, William Henry, being duly sworn, depose and say that I am the well operator of the well known as WELL NO. 101-B, located in NEAR BRACKEN RIDGE, BRACKEN RIDGE TOWNSHIP, NEWCASTLE COUNTY, WEST VIRGINIA, and that said well was plugged and filled with CEMENT on the 28th day of APRIL, 1928.  
I, John Baker, being duly sworn, depose and say that I am the well operator of the well known as WELL NO. 101-B, located in NEAR BRACKEN RIDGE, BRACKEN RIDGE TOWNSHIP, NEWCASTLE COUNTY, WEST VIRGINIA, and that said well was plugged and filled with CEMENT on the 28th day of APRIL, 1928.  
I, William Henry, being duly sworn, depose and say that I am the well operator of the well known as WELL NO. 101-B, located in NEAR BRACKEN RIDGE, BRACKEN RIDGE TOWNSHIP, NEWCASTLE COUNTY, WEST VIRGINIA, and that said well was plugged and filled with CEMENT on the 28th day of APRIL, 1928.

STATE OF WEST VIRGINIA  
County of NEWCASTLE  
I, Edwin W. Wilson, being duly sworn, depose and say that I am the owner of the well known as WELL NO. 101-B, located in NEAR BRACKEN RIDGE, BRACKEN RIDGE TOWNSHIP, NEWCASTLE COUNTY, WEST VIRGINIA, and that said well was plugged and filled with CEMENT on the 28th day of APRIL, 1928.  
I, A. C. Seaman, being duly sworn, depose and say that I am the operator of the well known as WELL NO. 101-B, located in NEAR BRACKEN RIDGE, BRACKEN RIDGE TOWNSHIP, NEWCASTLE COUNTY, WEST VIRGINIA, and that said well was plugged and filled with CEMENT on the 28th day of APRIL, 1928.  
I, John Baker, being duly sworn, depose and say that I am the well operator of the well known as WELL NO. 101-B, located in NEAR BRACKEN RIDGE, BRACKEN RIDGE TOWNSHIP, NEWCASTLE COUNTY, WEST VIRGINIA, and that said well was plugged and filled with CEMENT on the 28th day of APRIL, 1928.  
I, William Henry, being duly sworn, depose and say that I am the well operator of the well known as WELL NO. 101-B, located in NEAR BRACKEN RIDGE, BRACKEN RIDGE TOWNSHIP, NEWCASTLE COUNTY, WEST VIRGINIA, and that said well was plugged and filled with CEMENT on the 28th day of APRIL, 1928.  
I, John Baker, being duly sworn, depose and say that I am the well operator of the well known as WELL NO. 101-B, located in NEAR BRACKEN RIDGE, BRACKEN RIDGE TOWNSHIP, NEWCASTLE COUNTY, WEST VIRGINIA, and that said well was plugged and filled with CEMENT on the 28th day of APRIL, 1928.  
I, William Henry, being duly sworn, depose and say that I am the well operator of the well known as WELL NO. 101-B, located in NEAR BRACKEN RIDGE, BRACKEN RIDGE TOWNSHIP, NEWCASTLE COUNTY, WEST VIRGINIA, and that said well was plugged and filled with CEMENT on the 28th day of APRIL, 1928.  
I, John Baker, being duly sworn, depose and say that I am the well operator of the well known as WELL NO. 101-B, located in NEAR BRACKEN RIDGE, BRACKEN RIDGE TOWNSHIP, NEWCASTLE COUNTY, WEST VIRGINIA, and that said well was plugged and filled with CEMENT on the 28th day of APRIL, 1928.  
I, William Henry, being duly sworn, depose and say that I am the well operator of the well known as WELL NO. 101-B, located in NEAR BRACKEN RIDGE, BRACKEN RIDGE TOWNSHIP, NEWCASTLE COUNTY, WEST VIRGINIA, and that said well was plugged and filled with CEMENT on the 28th day of APRIL, 1928.

Well No.	Location	Operator	Plugged and Filled With	Date
101-B	Near Bracken Ridge	Edwin W. Wilson	Cement	April 28, 1928
101-C	Bracken Ridge	A. C. Seaman	Cement	April 28, 1928
101-D	Bracken Ridge	John Baker	Cement	April 28, 1928
101-E	Bracken Ridge	William Henry	Cement	April 28, 1928
101-F	Bracken Ridge	John Baker	Cement	April 28, 1928
101-G	Bracken Ridge	William Henry	Cement	April 28, 1928
101-H	Bracken Ridge	John Baker	Cement	April 28, 1928
101-I	Bracken Ridge	William Henry	Cement	April 28, 1928
101-J	Bracken Ridge	John Baker	Cement	April 28, 1928
101-K	Bracken Ridge	William Henry	Cement	April 28, 1928
101-L	Bracken Ridge	John Baker	Cement	April 28, 1928
101-M	Bracken Ridge	William Henry	Cement	April 28, 1928
101-N	Bracken Ridge	John Baker	Cement	April 28, 1928
101-O	Bracken Ridge	William Henry	Cement	April 28, 1928
101-P	Bracken Ridge	John Baker	Cement	April 28, 1928
101-Q	Bracken Ridge	William Henry	Cement	April 28, 1928
101-R	Bracken Ridge	John Baker	Cement	April 28, 1928
101-S	Bracken Ridge	William Henry	Cement	April 28, 1928
101-T	Bracken Ridge	John Baker	Cement	April 28, 1928
101-U	Bracken Ridge	William Henry	Cement	April 28, 1928
101-V	Bracken Ridge	John Baker	Cement	April 28, 1928
101-W	Bracken Ridge	William Henry	Cement	April 28, 1928
101-X	Bracken Ridge	John Baker	Cement	April 28, 1928
101-Y	Bracken Ridge	William Henry	Cement	April 28, 1928
101-Z	Bracken Ridge	John Baker	Cement	April 28, 1928



10/06/2023

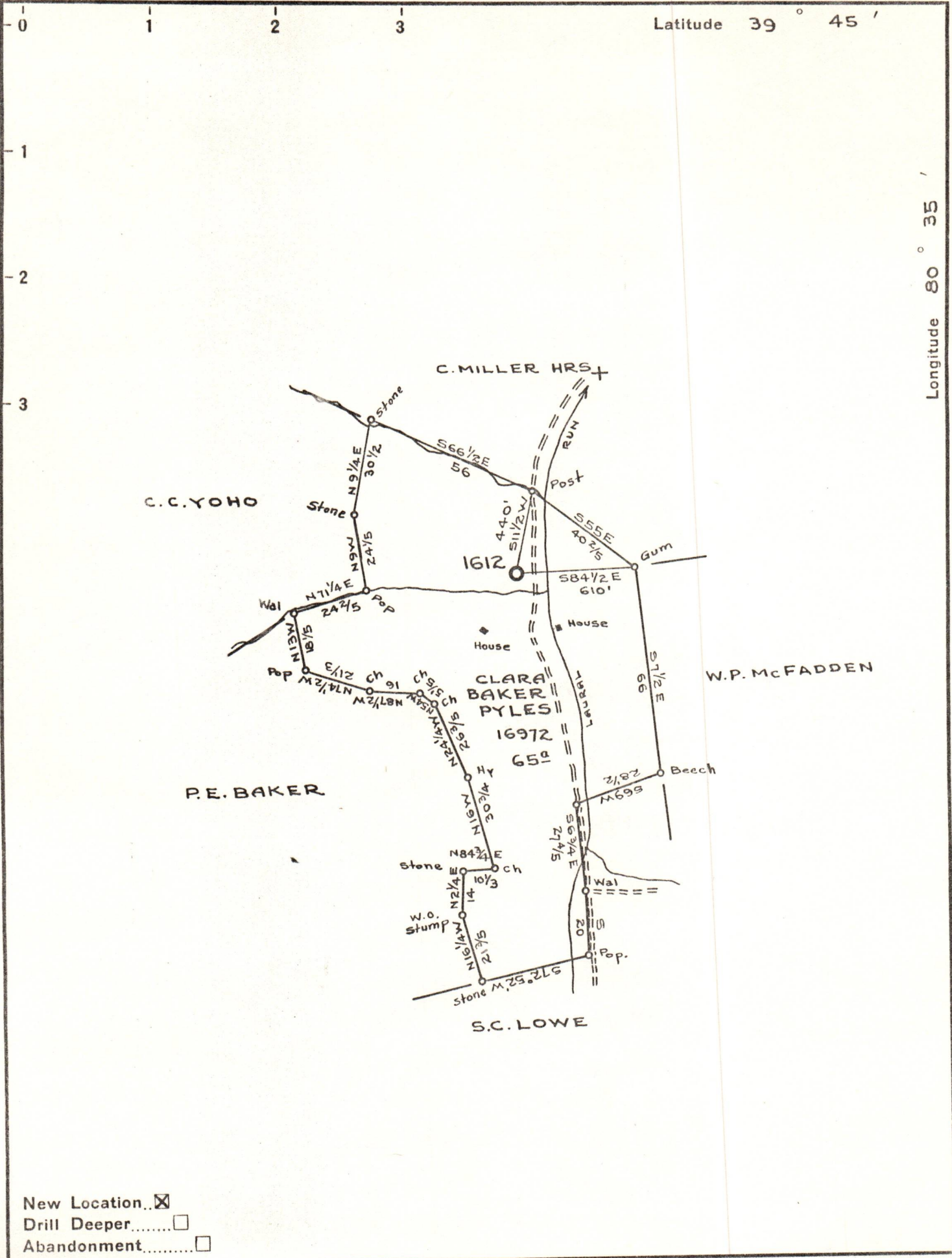

New Location..   
 Drill Deeper.....   
 Abandonment.....

Company CARNEGIE NATURAL GAS  
 Address PITTSBURGH, PENNA.  
 Farm CLARA BAKER PYLES  
 Tract \_\_\_\_\_ Acres 65 Lease No. E-16972-71  
 Well (Farm) No. 1 Serial No. 1612  
 Elevation (Spirit Level) 1155  
 Quadrangle LITTLETON NW  
 County WETZEL District CENTER  
 Engineer D.T. BRITTON  
 Engineer's Registration No. \_\_\_\_\_  
 File No. \_\_\_\_\_ Drawing No. \_\_\_\_\_  
 Date 10-30-44 Scale 1" = 40 rods

STATE OF WEST VIRGINIA  
 DEPARTMENT OF MINES  
 OIL AND GAS DIVISION  
 CHARLESTON

**WELL LOCATION MAP**  
 FILE NO. WET-372 10/06/2023

+ Denotes location of well on United States Topographic Maps, scale 1 to 62,500, latitude and longitude lines being represented by border lines as shown.  
 - Denotes one inch spaces on border line of original tracing.