



STATE OF WEST VIRGINIA  
 DEPARTMENT OF MINES  
 OIL AND GAS DIVISION

NOTICE OF PROPOSED LOCATION OF OIL AND GAS WELL

To THE DEPARTMENT OF MINES,  
 Charleston, W. Va.

None  
 COAL OPERATOR OR COAL OWNER

E. H. JENNINGS BROS. COMPANY  
 NAME OF WELL OPERATOR

ADDRESS

1212 Clark Building  
Pittsburgh 22, Pa.  
 COMPLETE ADDRESS

COAL OPERATOR OR COAL OWNER

May 15, 1947  
 PROPOSED LOCATION

ADDRESS

Grant District

Mills Wetzel Lands, Inc.  
 OWNER OF MINERAL RIGHTS

Wetzel County

6th & Putman Sts., Marietta, Ohio  
 ADDRESS

Well No. 139  
39° 35'  
80° 35'  
John Mills Farm

GENTLEMEN:

The undersigned well operator is entitled to drill upon the above named farm or tract of land for oil and gas, having fee title thereto, (or as the case may be) under grant or lease dated April 12, 1895, made by John Mills, to Kanawha Oil Company, and recorded on the 4th day of March, 1896, in the office of the County Clerk for said County in Book 47, page 611.

The enclosed plat was prepared by a competent engineer and shows the proposed location of a well to be drilled for oil and gas by the undersigned well operator on the farm and in the Magisterial District and County above named, determined by survey and courses and distances from two permanent points, or land marks.

The undersigned well operator is informed and believes there are no coal operators operating beds of coal beneath said farm or tract of land on which said well is located, or within 500 feet of the boundaries of the same, who have mapped their workings and filed their maps as required by law, excepting the coal operators or coal owners (if any) above named as addressees.

The above named coal operators or coal owners (if any) are notified that any objections they may desire to make to such proposed location, or which they are required to make by Section 3 of said Code, if the drilling of a well at said proposed location will cause a dangerous condition in or about their respective coal mines, must be received by, or filed with the Department of Mines within ten\* days from the receipt of a copy of this notice and accompanying plat by said Department. Said coal operators are further notified that forms for use in making such objections will be furnished to them by the Department of Mines promptly on request and that all such objections must set forth as definitely as is reasonably possible the ground or grounds on which such objections are based and indicate the direction and distance the proposed location should be moved to overcome same.

(The next paragraph is to be completed only in Department's copy.)

Copies of this notice and the enclosed plat were mailed by registered mail, or delivered to the above named coal operators or coal owners at their above shown respective address \_\_\_\_\_ day before, or on the same day with the mailing or delivery of this copy to the Department of Mines at Charleston, West Virginia.

Very truly yours,   
 President  
E. H. JENNINGS BROS. COMPANY  
 WELL OPERATOR

Address of Well Operator }

1212 Clark Building, Pittsburgh 22, Pa.  
 STREET

CITY OR TOWN

**10/06/2023**

STATE

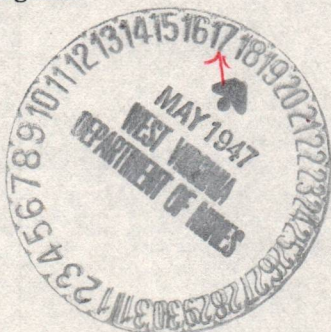

\*Section 3 . . . If no such objections be filed or be found by the department of mines, within said period of ten days from the receipt of said notice and plat by the department of mines, to said proposed location, the department shall forthwith issue to the well operator a drilling permit reciting the filing of such plat, that no objections have been made by the coal operators to the location, or found thereto by the department, and that the same is approved and the well operator authorized to proceed to drill at said location.





STATE OF WEST VIRGINIA  
DEPARTMENT OF MINES  
OIL AND GAS DIVISION

NOTICE OF PROPOSED LOCATION OF OIL AND GAS WELL

To The Department of Mines,  
Charleston, W. Va.

NAME OF WELL OPERATOR  
E. H. JENNINGS BROS. COMPANY  
1212 Clark Building  
Pittsburgh 22, Pa.  
COMPLETE ADDRESS

COAL OPERATOR OR COAL OWNER  
None  
ADDRESS

PROPOSED LOCATION  
May 12, 1937

COAL OPERATOR OR COAL OWNER  
ADDRESS

District  
Grant

ADDRESS

County  
Wetzel

OWNER OF MINERAL RIGHTS  
Wills Wetzel Land, Inc.

Well No. 133  
37° 32'  
80° 32'

ADDRESS  
Ed & Truman Sts., Marietta, Ohio

Farm  
John Wills

GENTLEMEN:  
The undersigned well operator is entitled to drill upon the above named farm or tract of land for oil and gas, having fee title thereto, (or as the case may be) under grant or lease dated April 12, 1936 made by John Wills to Kanawha Oil Company, and recorded on the 4th day of March, 1936 in the office of the County Clerk for said County in Book 47 page 611

The enclosed plat was prepared by a competent engineer and shows the proposed location of a well to be drilled for oil and gas by the undersigned well operator on the farm and in the Magisterial District and County above named, determined by survey and courses and distances from two permanent points or land marks

The undersigned well operator is informed and believes there are no coal operators operating beds of coal beneath said farm or tract of land on which said well is located, or within 500 feet of the boundaries of the same, who have mapped their workings and filed their maps as required by law, excepting the coal operators or coal owners (if any) above named as addressees.

The above named coal operators or coal owners (if any) are notified that any objections they may desire to make to such proposed location, or which they are required to make by Section 3 of said Code, if the drilling of a well at said proposed location will cause a dangerous condition in or about their respective coal mines, must be received by, or filed with the Department of Mines within ten days from the receipt of a copy of this notice and accompanying plat by said Department. Said coal operators are further notified that forms for use in making such objections will be furnished to them by the Department of Mines promptly on request and that all such objections must set forth as definitely as is reasonably possible the ground or grounds on which such objections are based and indicate the direction and distance the proposed location should be moved to overcome same.

(The next paragraph is to be completed only in Department's copy.)  
Copies of this notice and the enclosed plat were mailed by registered mail, or delivered to the above named coal operators or coal owners at their above shown respective addresses day before, or on the same day with the mailing or delivery of this copy to the Department of Mines at Charleston, West Virginia.

Very truly yours,  
[Signature]  
President  
E. H. JENNINGS BROS. COMPANY  
WELL OPERATOR

1212 Clark Building, Pittsburgh 22, Pa.  
STREET  
CITY OR TOWN

Address of Well Operator

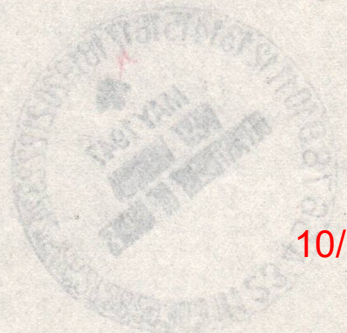

10/06/2023

Section 3. . . . If no such objections be filed or be found by the department of mines, within said period of ten days from the receipt of said notice and plat by the department of mines, to said proposed location, the department shall forthwith issue to the well operator a drilling permit locating the line of such plat, that no objections have been made by the coal operators to the location or found thereby by the department, and that the same is approved and the well operator authorized to proceed to drill at said location.



A-10

May 27, 1947

E. H. Jennings Brothers Company  
1212 Clark Building  
Pittsburgh 22, Pennsylvania

Gentlemen:

Enclosed is permit WEX-339 to drill Well  
No. 139 on the John Mills Farm, Grant District,  
Wetzel County.

Very truly yours,

Administrative Assistant  
OIL AND GAS DIVISION

CHH:K  
Encl-2

CC: Inspector Oliver W. Lindberg

10/06/2023



A-11

# E. H. JENNINGS BROS. COMPANY

GENERAL OFFICE  
1212 CLARK BLDG., LIBERTY AVE. & SEVENTH ST.

**PITTSBURGH 22, PENNA.**

September 2, 1947

Department of Mines  
Oil and Gas Division  
Charleston, West Virginia

Attention: Mr. C. N. Hall

Gentlemen:

Enclosed please find a Well Record, in duplicate, of Well No. 139 drilled on the John Mills lands in Wetzel County, West Virginia, under Permit No. WET-339.

The oil and gas production in this well is so small that we have decided to abandon it. Would you kindly send us, by return mail, a permit to do this. If there is any reason for delay in the issuing of the permit, would you kindly 'phone the writer at Court 2986, Pittsburgh, Pennsylvania. We are anxious to get the well plugged at an early date so that the drilling contractor may start another well.

Very truly yours,

E. H. JENNINGS BROS. COMPANY

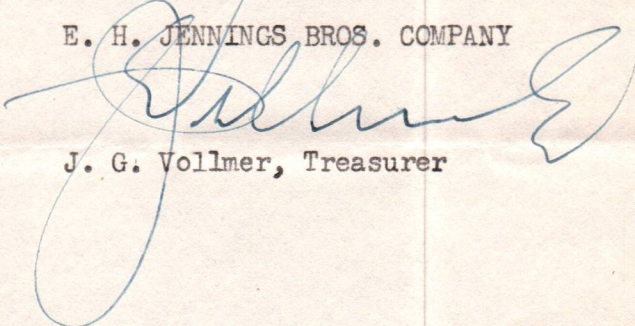

J. G. Vollmer, Treasurer

jgv/jim  
enc.

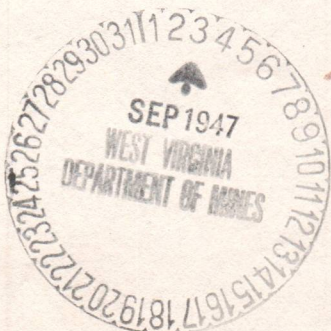

10/06/2023



STATE OF WEST VIRGINIA  
DEPARTMENT OF MINES  
OIL AND GAS DIVISION

WELL RECORD

Permit No. WET - 339

Oil or Gas Well Oil & Gas  
(Kind)

Company E.H. JENNINGS BROS. COMPANY  
Address 1212 Clark Building, Pittsburgh 22, Pa.  
Farm John Mills Acres 5451  
Location (waters).....  
Well No. 139 Elev. 926  
District Grant County Wetzel  
The surface of tract is owned in fee by Mills Wetzel Lands, Inc.  
6th & Putnam Sts.  
Address Marietta, Ohio  
Mineral rights are owned by Mills Wetzel Lands, Inc.  
6th & Putnam Sts.  
Address Marietta, Ohio  
Drilling commenced June 24, 1947  
Drilling completed August 14, 1947  
Date shot Aug. 18, '47 30 qts. 2804 to 2789  
Aug. 28, '47 30 qts. Depth of shot 2789 to 2778  
Open Flow /10ths Water in.....Inch  
...../10ths Merc. in.....Inch  
Volume.....10,000.....Cu. Ft.  
Rock Pressure.....none.....lbs.....hrs.  
Oil 16 gallons after shooting twice bbls., 1st 24 hrs.  
Fresh water.....none.....feet.....feet  
Salt water.....feet.....feet

Casing and Tubing	Used in Drilling	Left in Well	Packers
Size			
16.....			Kind of Packer.....
13.....			Size of.....
8 1/4.....	<u>334' 1"</u>		Depth set.....
6%.....	<u>1252' 10"</u>		Perf. top.....
5 3/16.....	<u>1970</u>		Perf. bottom.....
3.....			Perf. top.....
2.....			Perf. bottom.....
Liners Used.....			Perf. top.....
			Perf. bottom.....
CASING CEMENTED.....SIZE.....No. Ft.....Date			
COAL WAS ENCOUNTERED AT <u>741</u> FEET.....INCHES			
.....FEET.....INCHES.....FEET.....INCHES			
.....FEET.....INCHES.....FEET.....INCHES			

Formation	Color	Hard or Soft	Top	Bottom	Oil, Gas or Water	Depth Found	Remarks
Pitts. Coal			741	746			
Big Duncard Sand			1244	1254			
Salt Sand			1590	1635			
Water (3 Bailers Hr)				1625			
Maxon Sand			1895	1915			
Pencil Cave			1956	1961			
Keener Sand			2016	2024			
Break			2024	2028			
Big Injun Sand			2028	2215			
Gantz Sand			2240	2260			
Pink Rock			2640	2655			
Stray Sand			2762	2767			
Break?(Slate)			2767	2770			
Gordon Sand			2770	2809			
Light Skum							
Oil? (Black)			2771				
Show Gas			2794				
Bottom Hole				2879			Steel Line Measure

All Slate Bottom of Gordon Sand to Bottom of Hole.  
Steel Line Run on Pitts. Coal, 8" Casing, 6-1/4 Casing, Bottom Hole  
Gordon Sand not Very Good.

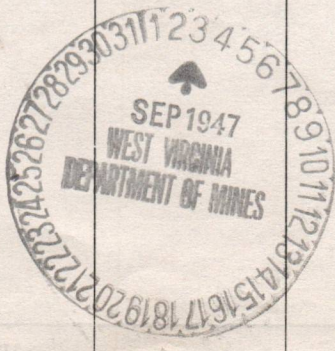

10/06/2023







B-2

STATE OF WEST VIRGINIA  
DEPARTMENT OF MINES  
OIL AND GAS DIVISION

INSPECTOR'S PLUGGING REPORT

Permit No. WET-379-P

Well No. 179

COMPANY P. H. Jenkins Bros Co ADDRESS 1212 Clark Bldg. Pittsburgh, Pa.

FARM John Mills DISTRICT Grant COUNTY Wetzel

Filling Material Used \_\_\_\_\_

Liner Location Amount Packer Location

PLUGS USED AND DEPTH PLACED			BRIDGES	CASING AND TUBING		
CEMENT-THICKNESS	WOOD-SIZE	LEAD	CONSTRUCTION-LOCATION	RECOVERED	SIZE	LOST
				339' 11"	10"	
				1252' 10"	8 1/4"	
				1970	6 3/8"	

Drillers' Names Mr. H. L. Bartrug and Mr. E. D. Rowe

Remarks:

This well was plugged to surface and completed 9/17/47 according to Mr. H. L. Bartrug. Well record inclosed.

9/18/47  
DATE

I hereby certify I visited the above well on this date.

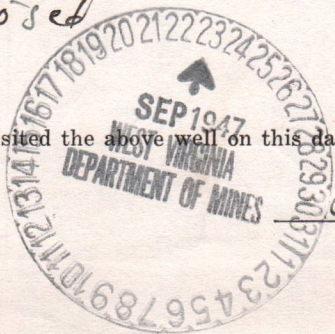

Oliver W. Lumberg

DISTRICT WELL INSPECTOR  
**10/06/2023**



STATE OF WEST VIRGINIA  
DEPARTMENT OF MINES  
OIL AND GAS DIVISION

INSPECTOR'S WELL REPORT

Permit No. \_\_\_\_\_

Oil or Gas Well \_\_\_\_\_  
(KIND)

		CASING AND TUBING	USED IN DRILLING	LEFT IN WELL	PACKERS
Company _____		Size			
Address _____		16			Kind of Packer _____
Farm _____		13			
Well No. _____		10			Size of _____
District _____	County _____	8 1/4			
Drilling commenced _____		6 5/8			Depth set _____
Drilling completed _____		5 3/16			
Total depth _____		3			Perf. top _____
Date shot _____		2			Perf. bottom _____
Depth of shot _____					
Initial open flow _____		Liners Used			Perf. top _____
/10ths Water in _____ Inch					Perf. bottom _____
Open flow after tubing _____					
/10ths Merc. in _____ Inch					
Volume _____	Cu. Ft.	CASING CEMENTED _____	SIZE _____	No. FT. _____	Date _____
Rock pressure _____	lbs. _____				
	hrs. _____				
Oil _____	bbls., 1st 24 hrs.	COAL WAS ENCOUNTERED AT _____	FEET _____	INCHES _____	
Fresh water _____	feet _____		FEET _____	INCHES _____	
Salt water _____	feet _____		FEET _____	INCHES _____	

Drillers' Names \_\_\_\_\_

Remarks: \_\_\_\_\_

DATE \_\_\_\_\_

DISTRICT WELL INSPECTOR \_\_\_\_\_



10/06/2023



B-9

PROPOSED MANNER OF PLUGGING AND FILLING WELL

(REQUIRED BY RULES AND REGULATIONS)

WEST VIRGINIA DEPARTMENT OF MINES

OIL AND GAS DIVISION

WORK ORDER

Well to be plugged and filled as follows:

WORK ORDER PREPARED BY THE DEPARTMENT OF MINES

Fill with clay from total depth 2879' - 2742'
Cement 2742' - 2732' - sealing pay sands

BRIDGE HOLE AT 2235'
Fill with clay to 1985'
Cement 1985' - 1975'
Lift 6-5/8" casing set at 1970'
Continue filling with clay to 1875'
Cement 1875' - 1865'

BRIDGE HOLE AT 1650'
Fill with clay to 1570'
Cement 1570' - 1560'

BRIDGE HOLE AT 1275'
Fill with clay to 1250'
Lift 8 1/2" pipe and continue filling with clay to 1200'
Cement 1200' - 1190' - as pipe is lifted
Continue to lift pipe to and bridge hole at 800'
Fill with clay to 776'
Cement 776' - 721' - sealing Pittsburgh coal
Continue to remove pipe and fill with clay to surface.

ERECT MARKER SUCH AS IS DESCRIBED IN RULE 18, 1931 REGULATIONS

To the Department of Mines
Coal Owner or Operator,
Lease or Property Owner.

Gentlemen:

This "work order" is submitted for your approval and concurrence and unless notified of your disapproval or non-concurrence, the undersigned will proceed with the plugging and filling of said well in the above described manner on the date stated in the notice of intention to plug and abandon the said well on opposite side of this sheet.

Very truly yours,

Well Operator.

No objections have been filed by the coal owner or coal operator, or any available adjacent lease or property owners or interposed by the Department of Mines to the manner herein described for the plugging and filling of the well above mentioned. Therefore, the same is hereby approved this

10/06/2023

3d day of September, 19 47.

DEPARTMENT OF MINES
Oil and Gas Division

By: \_\_\_\_\_

NOTE: This "work order" shall be filed in triplicate, one copy for the files of the Department of Mines; one to be approved or corrected and returned to the well operator as his authority for plugging said well; and one for the well inspector.





STATE OF WEST VIRGINIA  
DEPARTMENT OF MINES  
OIL AND GAS DIVISION

NOTICE OF INTENTION TO PLUG AND ABANDON WELL

(REQUIRED BY SECTION 9, ARTICLE 4, CHAPTER 22 OF THE CODE)

To THE DEPARTMENT OF MINES,  
Charleston, W. Va.

COAL OPERATOR OR COAL OWNER	E. H. JENNINGS BROS. COMPANY
ADDRESS	NAME OF WELL OPERATOR 1212 CLARK BUILDING PITTSBURGH, PA.
COAL OPERATOR OR COAL OWNER	COMPLETE ADDRESS
ADDRESS	SEPTEMBER 3, 19 47
COAL OPERATOR OR COAL OWNER	WELL TO BE ABANDONED
ADDRESS	GRANT District
LEASE OR PROPERTY OWNER	WETZEL County
ADDRESS	Well No. 139
ADDRESS	JOHN MILLS Farm

NOTIFY INSPECTOR OLIVER W. LINEBERG, MORGANTOWN, W. VA. - TELEPHONE 3967  
24 HOURS IN ADVANCE OF PLUGGING DATE

Gentlemen:—

The undersigned well operator is about to abandon the above described well and will commence

the work of plugging and abandoning said well on the 8th day of SEPTEMBER, 19 47,  
(which date shall not be less than five days after the day on which this notice so mailed is received,  
or in due course should be received by the Department of Mines.)

This notice is given you in order that your respective representatives may be present at the  
plugging and filling of said well. You are further notified that whether you are represented or not  
represented the undersigned will proceed on that date, or shortly thereafter, to plug and fill said  
well in the manner required by Section 10, Article 4, Chapter 22 of the Code and given in detail on the  
reverse side of this notice, in "Work Order."

This notice is being mailed by registered mail to each of you at the above addresses on the  
above date.

Very truly yours,

Well Operator.

10/06/2023

NOTE: Upon the abandonment of all wells drilled prior to June 1, 1929, a plat prepared by a competent  
engineer, showing the district and county in which the tract of land is located, the name and acreage of same,  
the names of the owners and adjacent tracts, and the location of the about to be abandoned well, determined  
by survey, and the courses and distances of such well from two permanent points or landmarks on said tract, shall  
be submitted with this notice.

(Over)

WET-339-P

PERMIT NUMBER



B-10



FORM OG-8

STATE OF WEST VIRGINIA  
DEPARTMENT OF MINES  
OIL AND GAS DIVISION

AFFIDAVIT OF PLUGGING AND FILLING WELL

AFFIDAVIT SHOULD BE MADE IN TRIPPLICATE. ONE COPY MAILED TO THE DEPARTMENT. ONE COPY TO BE RETAINED BY THE WELL OPERATOR AND THE THIRD COPY (AND EXTRA COPIES IF REQUIRED) SHOULD BE MAILED TO EACH COAL OPERATOR AT THEIR RESPECTIVE ADDRESSES.

COAL OPERATOR OR OWNER	E. H. JENNINGS BROS. COMPANY	NAME OF WELL OPERATOR
ADDRESS	1212 Clark Bldg., Pittsburgh 22, Pa.	COMPLETE ADDRESS
COAL OPERATOR OR OWNER	September 17,	1947
ADDRESS	Grant	District
Mills Wetzel Lands, Inc.	Wetzel	County
LEASE OR PROPERTY OWNER	Well No. 139	
c/o L. N. Dana, Belpre, Ohio	John Mills	Farm
ADDRESS		

STATE INSPECTOR SUPERVISING PLUGGING Oliver W. Lineberg

AFFIDAVIT

STATE OF WEST VIRGINIA, }  
 County of Wetzel } ss:  
H. L. Bartrug and E. D. Rawe  
 being first duly sworn according to law depose and say that they are experienced in the work of plugging and filling oil and gas wells and were employed by E. H. Jennings Bros. Co., well operator, and participated in the work of plugging and filling the above well, that said work was commenced on the 10 day of Sept, 1947, and that the well was plugged and filled in the following manner:

SAND OR ZONE RECORD	FILLING MATERIAL			PLUGS USED	CASING	
	FORMATION	CONTENT	FROM TO		SIZE & KIND	CSG PULLED
	Clay		2879 2742	6" Wood Seasoned		
	Cement		2742 2732			
	Rock & Mud		2732 2235	Bridge		0
	Clay		2235 1985			
	Cement		1985 1975		1970'	6-5/8" 0
	Clay		1975 1875			
	Cement		1875 1865			
	Rock & Mud		1865 1650			
	Clay		1650 1570			
	Cement		1570 1560			
	Mud & Rock		1560 1275	Bridge		
	Clay		1275 1250		1253'	8 1/4" 0
	Clay		1250 1200			
	Cement		1200 1190			
	Mud & Rock		1190 800	Bridge	334'	10" 0
COAL SEAMS	Clay		800 776	DESCRIPTION OF MONUMENT		
(NAME) Pittsburgh	Cement		776 721	10x12 = 30" High		
(NAME)	Clay		721 Top			
(NAME)						
(NAME)						

and that the work of plugging and filling said well was completed on the 17 day of September, 1947. 10/06/2023  
 And further deponents saith not.

Sworn to and subscribed before me this 19 day of Sept, 1947.  
H. L. Bartrug  
E. D. Rawe  
Bruce Brookover  
 Notary Public.

My commission expires:  
June 7 1955  
 JARRETT PRINTING COMPANY, CHARLESTON, W. VA.

Permit No. WV-339-P

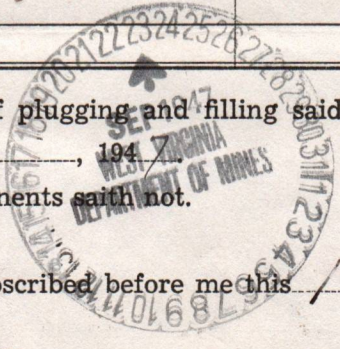

Handwritten initials or mark





STATE OF WEST VIRGINIA  
DEPARTMENT OF MINES  
OIL AND GAS DIVISION

FORM NO. 6

AFFIDAVIT OF PLUGGING AND FILLING WELL

THIS AFFIDAVIT SHOULD BE MADE IN TRIPlicate, one copy mailed to the Department, one copy to be retained by the well operator and the third copy and extra copies if desired, should be mailed to each coal operator at their respective addresses.

NAME OF WELL OPERATOR: John Williams  
 COMPLETE ADDRESS: 123 Main St., Charleston, W. Va.  
 WELL AND LOCATION: John Williams  
 COAL OPERATOR OR OWNER: John Williams  
 ADDRESS: 123 Main St., Charleston, W. Va.  
 LEASE OR PROPERTY OWNER: John Williams  
 ADDRESS: 123 Main St., Charleston, W. Va.  
 Well No. 123

AFFIDAVIT

STATE OF WEST VIRGINIA

County of Putnam

I, John Williams and John Williams being first duly sworn according to law depose and say that they are experienced in the work of plugging and filling oil and gas wells and were employed by John Williams well operator, and participated in the work of plugging and filling the above well, that said work was commenced on the 10/06/2023 day of October, and that the well was plugged and filled in the following manner:

BAND OR ZONE RECORD	FORMATION	FILLING MATERIAL		RINGS USED	CASING
		DEPTH	CONTENT		
	CLAY	1215	CLAY		
	CLAY	1220	CLAY		
	CLAY	1225	CLAY		
	CLAY	1230	CLAY		
	CLAY	1235	CLAY		
	CLAY	1240	CLAY		
	CLAY	1245	CLAY		
	CLAY	1250	CLAY		
	CLAY	1255	CLAY		
	CLAY	1260	CLAY		
	CLAY	1265	CLAY		
	CLAY	1270	CLAY		
	CLAY	1275	CLAY		
	CLAY	1280	CLAY		
	CLAY	1285	CLAY		
	CLAY	1290	CLAY		
	CLAY	1295	CLAY		
	CLAY	1300	CLAY		
	CLAY	1305	CLAY		
	CLAY	1310	CLAY		
	CLAY	1315	CLAY		
	CLAY	1320	CLAY		
	CLAY	1325	CLAY		
	CLAY	1330	CLAY		
	CLAY	1335	CLAY		
	CLAY	1340	CLAY		
	CLAY	1345	CLAY		
	CLAY	1350	CLAY		
	CLAY	1355	CLAY		
	CLAY	1360	CLAY		
	CLAY	1365	CLAY		
	CLAY	1370	CLAY		
	CLAY	1375	CLAY		
	CLAY	1380	CLAY		
	CLAY	1385	CLAY		
	CLAY	1390	CLAY		
	CLAY	1395	CLAY		
	CLAY	1400	CLAY		
	CLAY	1405	CLAY		
	CLAY	1410	CLAY		
	CLAY	1415	CLAY		
	CLAY	1420	CLAY		
	CLAY	1425	CLAY		
	CLAY	1430	CLAY		
	CLAY	1435	CLAY		
	CLAY	1440	CLAY		
	CLAY	1445	CLAY		
	CLAY	1450	CLAY		
	CLAY	1455	CLAY		
	CLAY	1460	CLAY		
	CLAY	1465	CLAY		
	CLAY	1470	CLAY		
	CLAY	1475	CLAY		
	CLAY	1480	CLAY		
	CLAY	1485	CLAY		
	CLAY	1490	CLAY		
	CLAY	1495	CLAY		
	CLAY	1500	CLAY		
	CLAY	1505	CLAY		
	CLAY	1510	CLAY		
	CLAY	1515	CLAY		
	CLAY	1520	CLAY		
	CLAY	1525	CLAY		
	CLAY	1530	CLAY		
	CLAY	1535	CLAY		
	CLAY	1540	CLAY		
	CLAY	1545	CLAY		
	CLAY	1550	CLAY		
	CLAY	1555	CLAY		
	CLAY	1560	CLAY		
	CLAY	1565	CLAY		
	CLAY	1570	CLAY		
	CLAY	1575	CLAY		
	CLAY	1580	CLAY		
	CLAY	1585	CLAY		
	CLAY	1590	CLAY		
	CLAY	1595	CLAY		
	CLAY	1600	CLAY		
	CLAY	1605	CLAY		
	CLAY	1610	CLAY		
	CLAY	1615	CLAY		
	CLAY	1620	CLAY		
	CLAY	1625	CLAY		
	CLAY	1630	CLAY		
	CLAY	1635	CLAY		
	CLAY	1640	CLAY		
	CLAY	1645	CLAY		
	CLAY	1650	CLAY		
	CLAY	1655	CLAY		
	CLAY	1660	CLAY		
	CLAY	1665	CLAY		
	CLAY	1670	CLAY		
	CLAY	1675	CLAY		
	CLAY	1680	CLAY		
	CLAY	1685	CLAY		
	CLAY	1690	CLAY		
	CLAY	1695	CLAY		
	CLAY	1700	CLAY		
	CLAY	1705	CLAY		
	CLAY	1710	CLAY		
	CLAY	1715	CLAY		
	CLAY	1720	CLAY		
	CLAY	1725	CLAY		
	CLAY	1730	CLAY		
	CLAY	1735	CLAY		
	CLAY	1740	CLAY		
	CLAY	1745	CLAY		
	CLAY	1750	CLAY		
	CLAY	1755	CLAY		
	CLAY	1760	CLAY		
	CLAY	1765	CLAY		
	CLAY	1770	CLAY		
	CLAY	1775	CLAY		
	CLAY	1780	CLAY		
	CLAY	1785	CLAY		
	CLAY	1790	CLAY		
	CLAY	1795	CLAY		
	CLAY	1800	CLAY		
	CLAY	1805	CLAY		
	CLAY	1810	CLAY		
	CLAY	1815	CLAY		
	CLAY	1820	CLAY		
	CLAY	1825	CLAY		
	CLAY	1830	CLAY		
	CLAY	1835	CLAY		
	CLAY	1840	CLAY		
	CLAY	1845	CLAY		
	CLAY	1850	CLAY		
	CLAY	1855	CLAY		
	CLAY	1860	CLAY		
	CLAY	1865	CLAY		
	CLAY	1870	CLAY		
	CLAY	1875	CLAY		
	CLAY	1880	CLAY		
	CLAY	1885	CLAY		
	CLAY	1890	CLAY		
	CLAY	1895	CLAY		
	CLAY	1900	CLAY		
	CLAY	1905	CLAY		
	CLAY	1910	CLAY		
	CLAY	1915	CLAY		
	CLAY	1920	CLAY		
	CLAY	1925	CLAY		
	CLAY	1930	CLAY		
	CLAY	1935	CLAY		
	CLAY	1940	CLAY		
	CLAY	1945	CLAY		
	CLAY	1950	CLAY		
	CLAY	1955	CLAY		
	CLAY	1960	CLAY		
	CLAY	1965	CLAY		
	CLAY	1970	CLAY		
	CLAY	1975	CLAY		
	CLAY	1980	CLAY		
	CLAY	1985	CLAY		
	CLAY	1990	CLAY		
	CLAY	1995	CLAY		
	CLAY	2000	CLAY		

and that the work of plugging and filling said well was completed on the 10/06/2023 day of October.

Sworn to and subscribed before me this 10/06/2023 day of October, 2023.

Notary Public  
 Putnam County, West Virginia  
 My commission expires 10/06/2023

WV-288-P



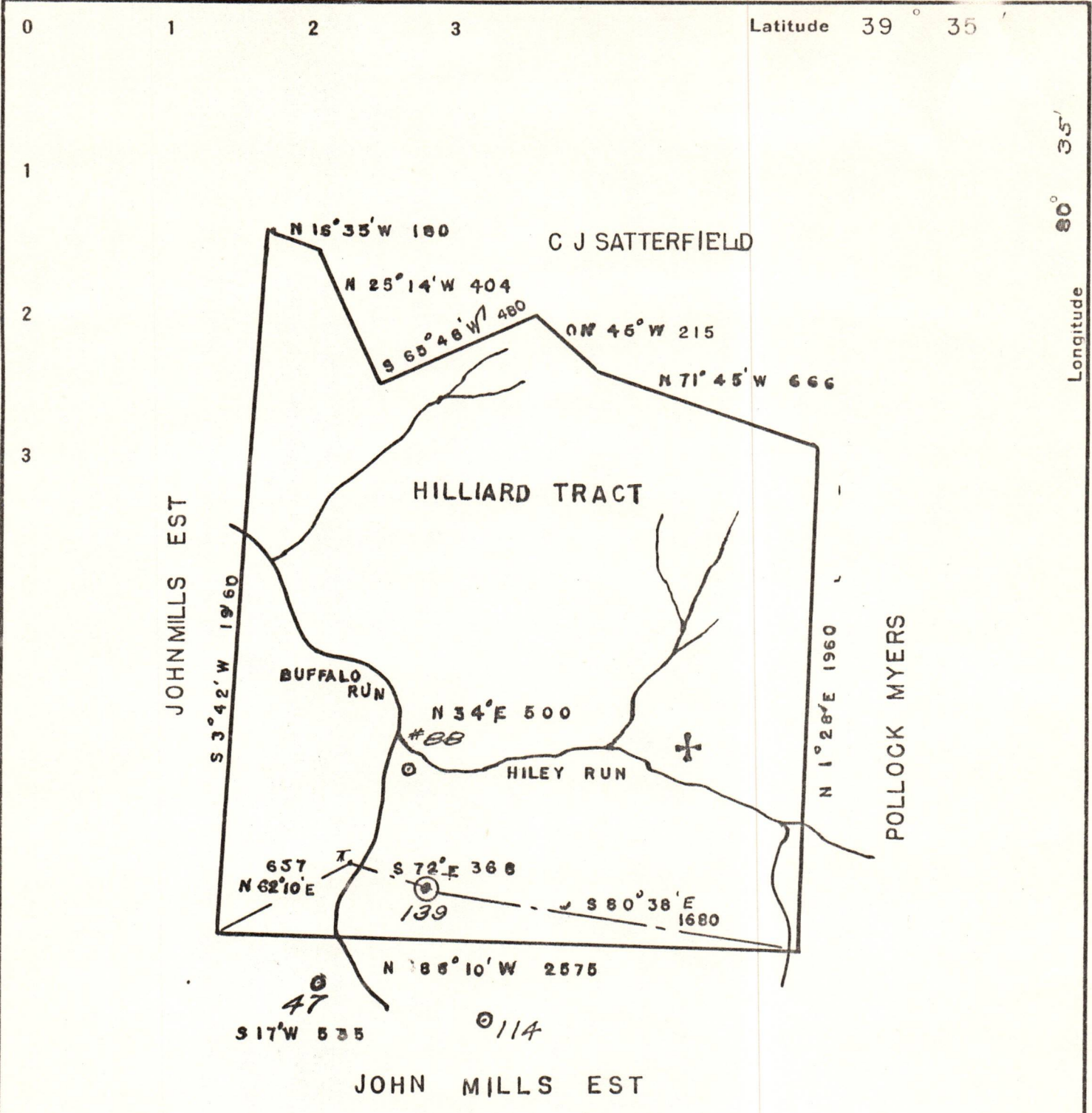

NEW LOCATION  
 ELEV. 926  
 SCALE 1" = 40 RODS

Company JENNINGS BROS  
 Address 1212 CLARK BLDG PITTSBURG PA  
 Farm JOHN MILLS  
 Tract \_\_\_\_\_ Acres \_\_\_\_\_ Lease No. \_\_\_\_\_  
 Well (Farm) No. 139 Serial No. \_\_\_\_\_  
 Quadrangle LITTLETON  
 County WETZEL  
 District GRANT  
 Engineer e. Hogg  
 Engineer's Registration No. 6647 PENN. R.  
 File No. \_\_\_\_\_ Drawing No. \_\_\_\_\_  
 Date 5/15/47 Scale \_\_\_\_\_

STATE OF WEST VIRGINIA  
 DEPARTMENT OF MINES  
 OIL AND GAS DIVISION  
 CHARLESTON

WELL LOCATION MAP  
 FILE NO. Wet-339 10/06/2023

+ Denotes location of well on United States Topographic Maps, scale 1 to 62,500, latitude and longitude lines being represented by border lines as shown.

- Denotes one inch spaces on border line of original tracing.