



STATE OF WEST VIRGINIA
DEPARTMENT OF MINES
OIL AND GAS DIVISION

NOTICE OF PROPOSED LOCATION OF OIL AND GAS WELL

To THE DEPARTMENT OF MINES,
Charleston, W. Va.

Robinson & Lutes
COAL OPERATOR OR COAL OWNER
c/o D. Fred Robinson
412 Market St., Brownsville, Pa.
ADDRESS

P. C. McKenzie Co.
NAME OF WELL OPERATOR
P. O. Box 10396, Pgh. 34, Pa.
COMPLETE ADDRESS

September 3, 19 53

COAL OPERATOR OR COAL OWNER
ADDRESS

PROPOSED LOCATION
Grant District

Joseph Shiben, et al
OWNER OF MINERAL RIGHTS
New Martinsville, W. Va.
ADDRESS

Well No. 4 ^{39° 40'} _{80° 30'}
J. P. Ashcraft Farm

GENTLEMEN:

The undersigned well operator is entitled to drill upon the above named farm or tract of land for oil and gas, having fee title thereto, (or as the case may be) under grant or lease dated July 19, 1894, made by J. P. Ashcraft, et al, to The Oxford Oil Co., and recorded on the 19th day of July, 1894, in the office of the County Clerk for said County in Book 39, page 471.

The enclosed plat was prepared by a competent engineer and shows the proposed location of a well to be drilled for oil and gas by the undersigned well operator on the farm and in the Magisterial District and County above named, determined by survey and courses and distances from two permanent points, or land marks.

The undersigned well operator is informed and believes there are no coal operators operating beds of coal beneath said farm or tract of land on which said well is located, or within 500 feet of the boundaries of the same, who have mapped their workings and filed their maps as required by law, excepting the coal operators or coal owners (if any) above named as addressees.

The above named coal operators or coal owners (if any) are notified that any objections they may desire to make to such proposed location, or which they are required to make by Section 3 of said Code, if the drilling of a well at said proposed location will cause a dangerous condition in or about their respective coal mines, must be received by, or filed with the Department of Mines within ten* days from the receipt of a copy of this notice and accompanying plat by said Department. Said coal operators are further notified that forms for use in making such objections will be furnished to them by the Department of Mines promptly on request and that all such objections must set forth as definitely as is reasonably possible the ground or grounds on which such objections are based and indicate the direction and distance the proposed location should be moved to overcome same.

(The next paragraph is to be completed only in Department's copy.)

Copies of this notice and the enclosed plat were mailed by registered mail, or delivered to the above named coal operators or coal owners at their above shown respective address _____ day _____ before, or on the same day with the mailing or delivery of this copy to the Department of Mines at Charleston, West Virginia.

Very truly yours,

P. C. McKenzie Co.
WELL OPERATOR
P. O. Box 10396
Pittsburgh 34
Pennsylvania

Address of Well Operator }



10/06/2023

*Section 3 If no such objections be filed or be found by the department of mines, within said period of ten days from the receipt of said notice and plat by the department of mines, to said proposed location, the department shall forthwith issue to the well operator a drilling permit reciting the filing of such plat, that no objections have been made by the coal operators to the location, or found thereto by the department, and that the same is approved and the well operator authorized to proceed to drill at said location.

NOTICE OF PROBATION LOCATION FOR AND GAS WELL

J. F. Associates Co.

London, Ohio

P.O. Box 1033

London, Ohio

London, Ohio

London, Ohio

Client

London, Ohio

Referral

New Martinsville, W. Va.

J. F. Associates

The undersigned, J. F. Associates, a corporation organized under the laws of the State of Ohio, and its principal office is located at London, Ohio, do hereby certify that the following is a true and correct copy of the original as the same appears on the records of the State of Ohio.

J. F. Associates, et al

The Oxford Oil Co.

1932

July, 1931

Witness my hand and seal of office at London, Ohio, this 12th day of July, 1931.

Notary Public for the State of Ohio

My commission expires on the 12th day of July, 1932.

Notary Public for the State of Ohio

My commission expires on the 12th day of July, 1932.

J. F. Associates Co.

P.O. Box 1033

London, Ohio

London, Ohio

10/06/2023

P. C. MCKENZIE CO.

(INCORPORATED)

3829 WILLOW AVENUE, CASTLE SHANNON, PA.

MAILING ADDRESS — P. O. BOX 10396, PITTSBURGH 34, PA.

THE GRISCOM-RUSSELL CO.
HEAT EXCHANGERS
OIL COOLERS & HEATERS
INTER-COOLERS & AFTER-COOLERS
PROCESS CONDENSERS
AIR COOLERS & HEATERS
FIN-FAN COOLERS

LE ROI COMPANY
ENGINES
ENGINE GENERATOR SETS
ROTARY GAS COMPRESSORS
GARRETT RELIEF VALVES

THE FLUOR CORP. LTD.
REFINERY & COMPRESSOR
STATION CONSTRUCTION
COOLING TOWERS
PULSATION DAMPENERS
MUFFLERS
GAS CLEANERS

September 3, 1953

Department of Mines
Oil and Gas Division
Charleston, West Virginia

Gentlemen:

Attached is Proposed Location of gas well #4 located
on the J. P. Ashcraft Farm, Grant District, Wetzel County, West
Virginia.

Very truly yours,

P. C. MCKENZIE COMPANY

E. R. Rigatti
E. R. Rigatti

NRR/hs

Attachment

- cc: Mr. J. M. Shields (2)
- Mr. J. H. Newlon
- Mr. Joseph Shiben
- Robinson & Lutes
- Mrs. Marguerite H. Coughlin, Atty, In Fact.

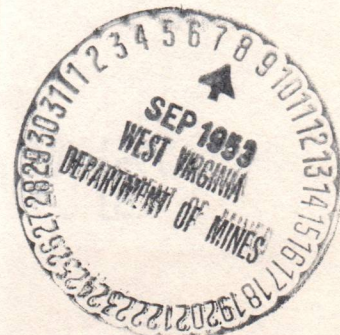

P. C. MCKENZIE CO.

(INCORPORATED)

3825 WILLOW AVENUE, CASTLE SHANNON, PA.

MAILING ADDRESS — P. O. BOX 10396, PITTSBURGH 34, PA.

THE FLUOR CORP. LTD.
REFRIGERATION & COMPRESSION
STATION CONSTRUCTION
COOLING TOWERS
FULTON DAMPERS
MUFFLERS
GAS CLEANERS

LE ROI COMPANY
ENGINEERS
ENGINE GENERATOR SETS
ROTARY GAS COMPRESSORS
GARRETT RELIEF VALVES

THE GRISCOM-RUSSELL CO.
HEAT EXCHANGERS
OIL COOLERS & HEATERS
INTER-COOLERS & AFTER-COOLERS
PROCESS CONDENSERS
AIR COOLERS & HEATERS
FAN COOLERS

September 3, 1953

Department of Mines
Oil and Gas Division
Charleston, West Virginia

Gentlemen:

Attached is proposed location of gas well #1 located
on the J. B. Baharoff Farm, Grant District, Putnam County, West
Virginia.

Very truly yours,

P. C. MCKENZIE COMPANY

L. H. Rizatti

HRB/ps

Attachment

cc: Mr. J. B. Shields (2)
Mr. J. E. Newton
Mr. Joseph Shiben
Robinson & Lucas
Mrs. Margarette E. Douglas, Atty. in Charge



A-11

September 18, 1953

P. C. McKenzie Company
P. O. Box 10396
Pittsburgh 34, Pennsylvania

Gentlemen:

Enclosed is permit WET-389 to drill Well
No. 4 on the J. P. Ashcraft Farm, Grant District,
Wetzel County.

Very truly yours,

Administrative Assistant
OIL AND GAS DIVISION

CNH:K
Encl-2

CC: Inspector D. F. Desist

10/06/2023

P. C. MCKENZIE CO.

(INCORPORATED)

3829 WILLOW AVENUE, CASTLE SHANNON, PA.

MAILING ADDRESS — P. O. BOX 10396, PITTSBURGH 34, PA.

THE GRISCOM-RUSSELL CO.
HEAT EXCHANGERS
OIL COOLERS & HEATERS
INTER-COOLERS & AFTER-COOLERS
PROCESS CONDENSERS
AIR COOLERS & HEATERS
FIN-FAN COOLERS

LE ROI COMPANY
ENGINES
ENGINE GENERATOR SETS
ROTARY GAS COMPRESSORS
GARRETT RELIEF VALVES

THE FLUOR CORP. LTD.
REFINERY & COMPRESSOR
STATION CONSTRUCTION
COOLING TOWERS
PULSATION DAMPENERS
MUFFLERS
GAS CLEANERS

November 2, 1953

Department of Mines
Oil and Gas Division
Charleston, West Virginia

Gentlemen:

Attached, in duplicate, is our Record of the drilling
of Well No. 5 on the J. P. Ashcraft Farm located in Grant District,
Wetzel County, West Virginia.

Very truly yours,

P. C. MCKENZIE COMPANY

E. R. Rigatti
E. R. Rigatti

ERR/nlm

Attachments

cc: Mr. J. M. Shields
Mr. J. H. Newlon
Robinson & Lutes
Mr. Joseph Shibben
Mrs. Marguerite H. Dunning

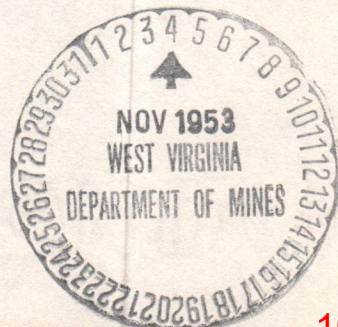

10/06/2023

Formation	Color	Hard or Soft	Top	Bottom	Oil, Gas or Water	Depth Found	Remarks
Slate			613	616			
Lime		Hard	616	676			
Lime, Broken			676	680			Steel Line Run @ 619'
Lime		Very Hard	680	703			
Slate	Dark		703	707			Little Gas 704'
Shell-Lime		Hard	707	709			
Coal, Pittsburgh			709	718			Gas 709-718'
Slate			718	719			
Lime			719	721			
			TOTAL DEPTH	721'			

10/06/2023

Date _____, 19____

APPROVED _____, Owner

By _____ (Title)



STATE OF WEST VIRGINIA
DEPARTMENT OF MINES
OIL AND GAS DIVISION 7

Liatetion

WELL RECORD

Permit No. WET-389

Oil or Gas Well GAS
(KIND)

Company P. C. McKenzie Co.
Address P. O. Box 10396, Pgh. 34, Pa.
Farm J. T. Ashcraft Acres 1028
Location (waters) Big Run
Well No. 4 Elev. 930
District _____ County _____
The surface of tract is owned in fee by Joseph Shiben, et al
New Address Martinsville, W. Va. 8 1/4
Mineral rights are owned by Joseph Shiben, et al
New Address Martinsville, W. Va. 5 3/16
Drilling commenced 9-4-53
Drilling completed 9-20-53
Date Shot _____ From _____ To _____
With _____
Open Flow 6 1/10ths Water in _____ 1 Inch
_____ /10ths Merc. in _____ Inch
Volume 96,000 Cu. Ft.
Rock Pressure 170 lbs. 40 hrs.
Oil _____ bbls., 1st 24 hrs.
Fresh water 35 feet 102 & 345 feet
Salt water _____ feet _____ feet

Casing and Tubing	Used in Drilling	Left in Well	Packers
Size			Kind of Packer
16			
13			Size of
6%	309	309	Depth set
5 3/16	660	660	
3			Perf. top
2			Perf. bottom
Liners Used			Perf. top
			Perf. bottom

CASING CEMENTED _____ SIZE _____ No. Ft. _____ Date _____
COAL WAS ENCOUNTERED AT 249 FEET _____ INCHES
610 FEET _____ INCHES 709 FEET _____ INCHES
_____ FEET _____ INCHES _____ FEET _____ INCHES

Formation	Color	Hard or Soft	Top	Bottom	Oil, Gas or Water	Depth Found	Remarks
Clay			0	16			
Rock			16	32			
Slate			32	38	Water 35'		
Shale	Blue		38	57			
Slate			57	90			
Lime			90	102			
Sand			102	108	Hole Full Water @ 102'		
Slate			108	114			
Rock	Red		114	123			
Slate			123	136			
Lime			136	141			
Slate			141	187			
Shale	Blue		187	224			
Sand			224	238			
Slate			238	249			
Coal			249	250			
Slate			250	260			
Lime			260	275			
Slate			275	294			
Sand			294	306			
Slate			306	318	Steel Line Run @ 309'		
Lime			318	330			
Lime		Gritty	330	345			
Sand			345	370	Water @ 345' (One Bailer/Hr.)		
Slate	Black		370	383			
Slate			383	390			
Lime			390	408			
Slate			408	417			
Rock	Red		417	424			
Lime			424	430			
Rock	Red		430	440			
Lime			440	518			
Rock	Red		518	524			
Shale			524	529			
Lime, Broken			529	550			
Lime			550	608			
Slate			608	610			
Coal, Mapleton			610	613			

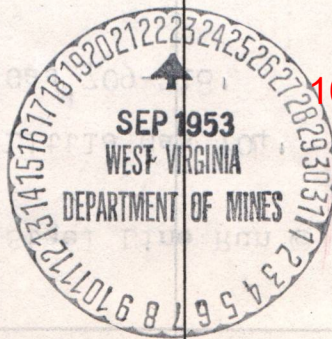

10/06/2023

1.0 API well number: (If not available, leave blank. 14 digits.)	<u>47-103-238900000</u>			
2.0 Type of determination being sought: (Use the codes found on the front of this form.)	<u>108</u> Section of NGPA	Category Code		
3.0 Depth of the deepest completion location: (Only needed if sections 103 or 107 in 2.0 above.)	<u>N/A</u> feet			
4.0 Name, address and code number of applicant: (35 letters per line maximum. If code number not available, leave blank.)	<u>Pemco Gas. Inc.</u> Name		<u>014652</u> Seller Code	
	<u>3930 Fulton Dr. N.W.</u> Street	<u>Ohio</u> State	<u>44718</u> Zip Code	
	<u>Canton</u> City			
5.0 Location of this well: [Complete (a) or (b).] (a) For onshore wells (35 letters maximum for field name.) (b) For OCS wells:	<u>Grant District</u> Field Name		<u>West Va.</u> State	
	<u>Wetzel</u> County			
	<u>N/A</u> Area Name		Block Number	
	Date of Lease: _____ Mo. Day Yr.		OCS Lease Number	
(c) Name and identification number of this well: (35 letters and digits maximum.)	<u>J. P. Ashcraft No. 4</u>			
(d) If code 4 or 5 in 2.0 above, name of the reservoir: (35 letters maximum.)	<u>N/A</u>			
6.0 (a) Name and code number of the purchaser: (35 letters and digits maximum. If code number not available, leave blank.)	<u>Equitable Gas Company</u> Name		<u>005939</u> Buyer Code	
(b) Date of the contract:	<u>06 16 52</u> Mo. Day Yr.			
(c) Estimated annual production:	<u>1600 MCF</u> MMcf.			
7.0 Contract price: (As of filing date. Complete to 3 decimal places.)	(a) Base Price (\$/MMBTU) <u>6 6 8</u>	(b) Tax _____	(c) All Other Prices [Indicate (+) or (-).] _____	(d) Total of (a), (b) and (c) <u>6 6 8</u>
8.0 Maximum lawful rate: (As of filing date. Complete to 3 decimal places.)	<u>2 4 2 6</u>	_____	_____	<u>2 4 2 6</u>
9.0 Person responsible for this application:	<u>J. R. Barati</u> Name			
Agency Use Only Date Received by Juris. Agency <u>OCT 05 1979</u> Date Received by FERC	<u>J. R. Barati</u> Signature		<u>President</u> Title	
	<u>SEP 17 1979</u> Date Application is Completed		<u>(216)492-4419</u> Phone Number	

10/06/2023

PARTICIPANTS:

DATE:

FEB 18 1980

BUYER-SELLER CODE

WELL OPERATOR: Pemco Gas, Inc.

014652

FIRST PURCHASER: Equitable Gas Company

005939

OTHER: _____

Deferred test

Production as Section 108, stringer well

New production recalculated and attached: 3-18-80

W. Va. Department of Mines, Oil & Gas Division
WELL DETERMINATION FILE NUMBER

7901005-108-103-0389

Use Above File Number on all Communications
Relating to Determination of this Well

CHECK EACH ITEM AS COMPLETE OR NOTE WHAT IS MISSING

ITEM NO.

- 1 FERC-121 Items not completed - Line No. _____
- 2 IV-1 - Agent Thomas M. Hough
- 3 IV-2 - Well Permit
- 4 IV-6 - Well Plat
- 5 IV-35- Well Record Drilling Deepening _____
- 6 IV-36- Gas-Oil Test: Gas Only _____ Was Oil Produced? _____ Ratio _____
- 7 IV-39- Annual Production 1 years & 8 mos.
- 8 IV-40- 90 day Production 91 Days off Line: _____
- 9 IV-48- Application for Certification. Complete?
- 10 - 17 IV Form #51 - 52 - 53 - 54 - 55 - 56 - 57 - 58. Complete Affidavit Signed
- 18 - 28 Other: Survey _____ Logs _____ Geological Charts _____ Structure Map _____
1:4000 Map _____ Well Tabulations _____ Gas Analyses _____
- (5) Date commenced: 9-4-53
Date Completed: 9-20-53 Deepened _____
- (5) Production Depth: 703-707; 707-709
- (5) Production Formation: Shell Lime; Shell-Lime
- (5) Final open flow 96 MCF
- (5) Static R.P. ~~_____~~ After frac 170 - 40 hrs.
- (6) Other Gas Test: ~~_____~~
- (7) Avg. Daily Gas from Annual Production: 1901/365 = 5 MCF
- (8) Avg. Daily Gas from 90-day enrollment: 535/90 = 6 MCF
- (8) Line Pressure: N/A PSIG from Daily Rep _____
- (5) Oil Production: No From Completion Report _____
- (10-17) Does lease inventory indicate enhanced recovery being done: N/A
- (10-17) Is affidavit signed? Notarized?

Does official well record with the Department confirm the submitted information? Yes

Additional Information _____ Does computer program confirm? _____

Was Determination Objected to? _____ By Whom? _____

JML

Describe the search made of any records listed above:

Reviewed files maintained on well.

Are you aware of any other information which would tend to be inconsistent with the information specified above? Yes ___ No X. If yes, indicate the type and source of the information.

AFFIDAVIT

I, J. R. Barati, having been first sworn according to law, state that I have caused to be made a diligent search of those records hereinbefore indicated in the manner herein described, that the information contained in this document is true and accurate and that on the basis of the records and examinations hereinbefore described, and to the best of my information, knowledge and belief, the well for which this certification is sought qualifies as a stripper well.

J. R. Barati

STATE OF Ohio
XXXXXXXXXXA.

COUNTY OF Stark, TO WIT:

I, Gerald A. Warehime, a Notary Public in and for the state and county aforesaid, do certify that J. R. Barati, whose name is signed to the writing above, bearing date the 10th day of September, 1979, has acknowledged the same before me, in my county aforesaid.

Given under my hand and official seal this 10th day of September, 19 79.

My term of office expires on the 20th day of February, 19 81.

Gerald A. Warehime
Notary Public

[NOTARIAL SEAL]

GERALD A. WAREHIME
Notary Public, Stark County, Ohio
My Commission Expires Feb. 20, 1981

10/06/2023

STATE OF WEST VIRGINIA
DEPARTMENT OF MINES, OIL AND GAS DIVISION

Date August 21, 1979
Operator's Well No. Ashcraft #4
API Well No. 47 - 103 - 238900000
State County Permit

WELL CLASSIFICATION FORM
STRIPPER GAS WELL
NGPA Section 108

DESIGNATED AGENT Thomas M. Hough
ADDRESS 1575 Smith Road No. 2
Charleston, West Va. 25314
LOCATION: Elevation 930'
Watershed North Fork Fishing Creek
Dist. Grant County Wetzel Quad. Littleton
Gas Purchase Contract No. 4888
Meter Chart Code 01000
Date of Contract June 16, 1952

WELL OPERATOR Pemco Gas, Inc.
ADDRESS 3930 Fulton Dr. N.W.
Canton, Ohio 44718

GAS PURCHASER Equitable Gas Co.
ADDRESS 420 Blvd. of the Allies
Pittsburgh, Pa. 15219

* * * * *

Provide a complete inventory of the lease and production equipment used for the well for the previous 24 months or, if less than 24 months, the period the well has been in production. Include a complete list of equipment or processes used in connection with recognized enhanced recovery techniques during completion or production. (Attach separate sheets, if necessary.)

- 309' - 6-5/8" casing
- 660' - 5-3/16" casing
- Steel shoe on 6-5/8" and 5-3/16"
- Well not fractured

List all records reasonably available to you which contain information relevant to a determination of eligibility (including production records, B&O Tax Records and royalty payment records) and indicate the location of such records:

- Production records
- Bus. & Occup., Personal Property tax records
- Royalty payment records
- Permit application & plat
- Well completion record
- Equipment list
- Well log
- Gas Purchase Contract

Located at 3930 Fulton Dr. N.W. - Suite 107
Canton, Ohio 44718

10/06/2023

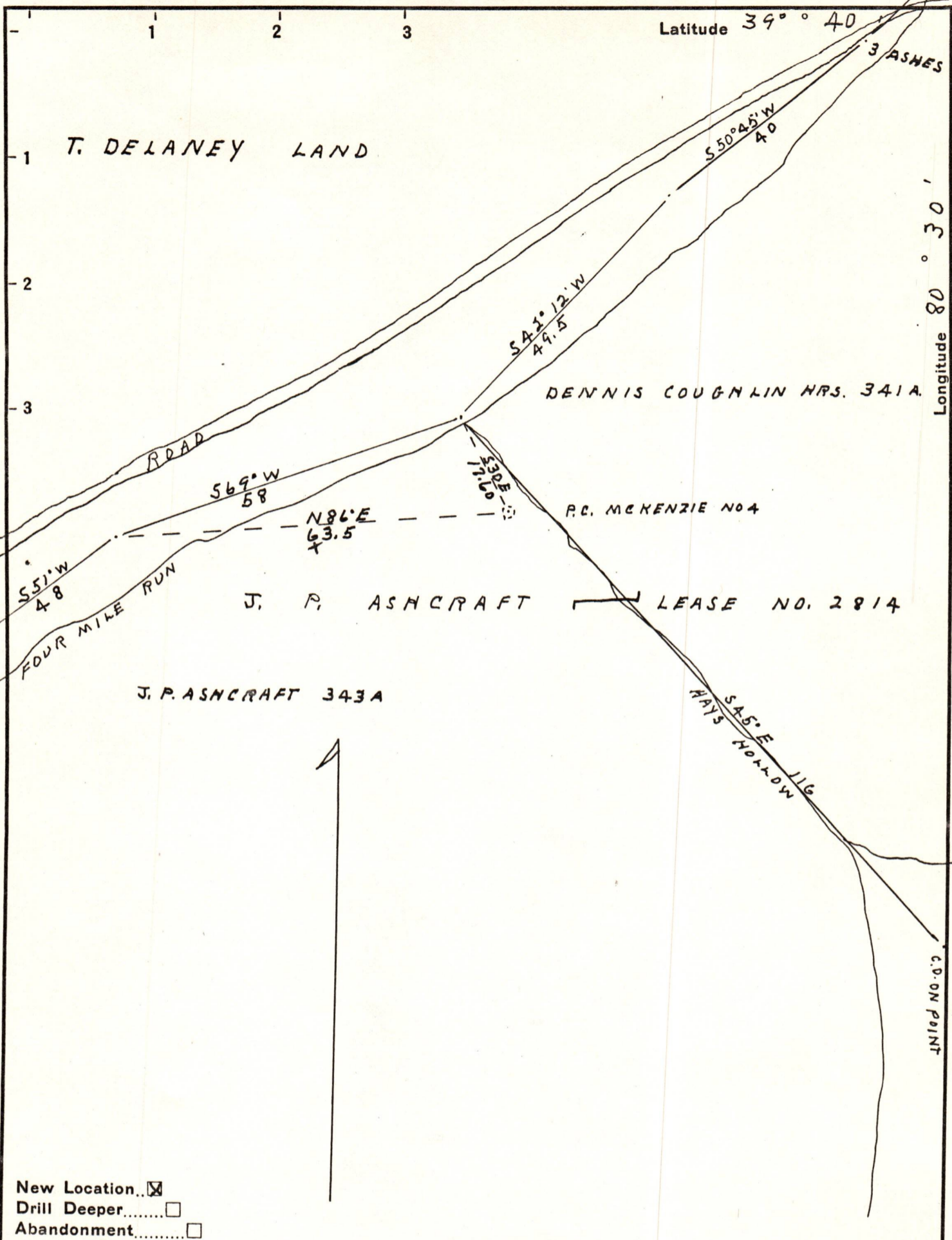

Company P.C. MCKENZIE CO.
 Address 3829 WILLOW AVE. CASTLE SHANNON PA.
 Farm J. P. ASHCRAFT
 Tract _____ Acres 1028 Lease No. 2814
 Well (Farm) No. 4 Serial No. _____
 Elevation (Spirit Level) 930
 Quadrangle LITTLETON
 County WETZEL District GRANT
 Engineer J. M. Cochran
 Engineer's Registration No. CO. SURVEYOR
 File No. _____ Drawing No. _____
 Date AUGUST 28, 1953 Scale 20000 = 1"

STATE OF WEST VIRGINIA
 DEPARTMENT OF MINES
 OIL AND GAS DIVISION
 CHARLESTON

WELL LOCATION MAP
 FILE NO. Wet - 389

+ Denotes location of well on United States Topographic Maps, scale 1 to 62,500, latitude and longitude lines being represented by border lines as shown.
 - Denotes one inch spaces on border line of original tracing.

10/06/2023