

HOPE NATURAL GAS COMPANY.

LOCATION FOR WELL No. 23

Pine Grove DISTRICT

APR 15 1913

On P. Haught Farm, on waters of Piney Fork

Greene District, Netzel County, West Virginia.

Lease No. 735 Acres 200 N. 8 S. - E. - W. 4

Scale, one inch equals 80p Sent to..... 1

Location to be.....

BK 146, pg. 70

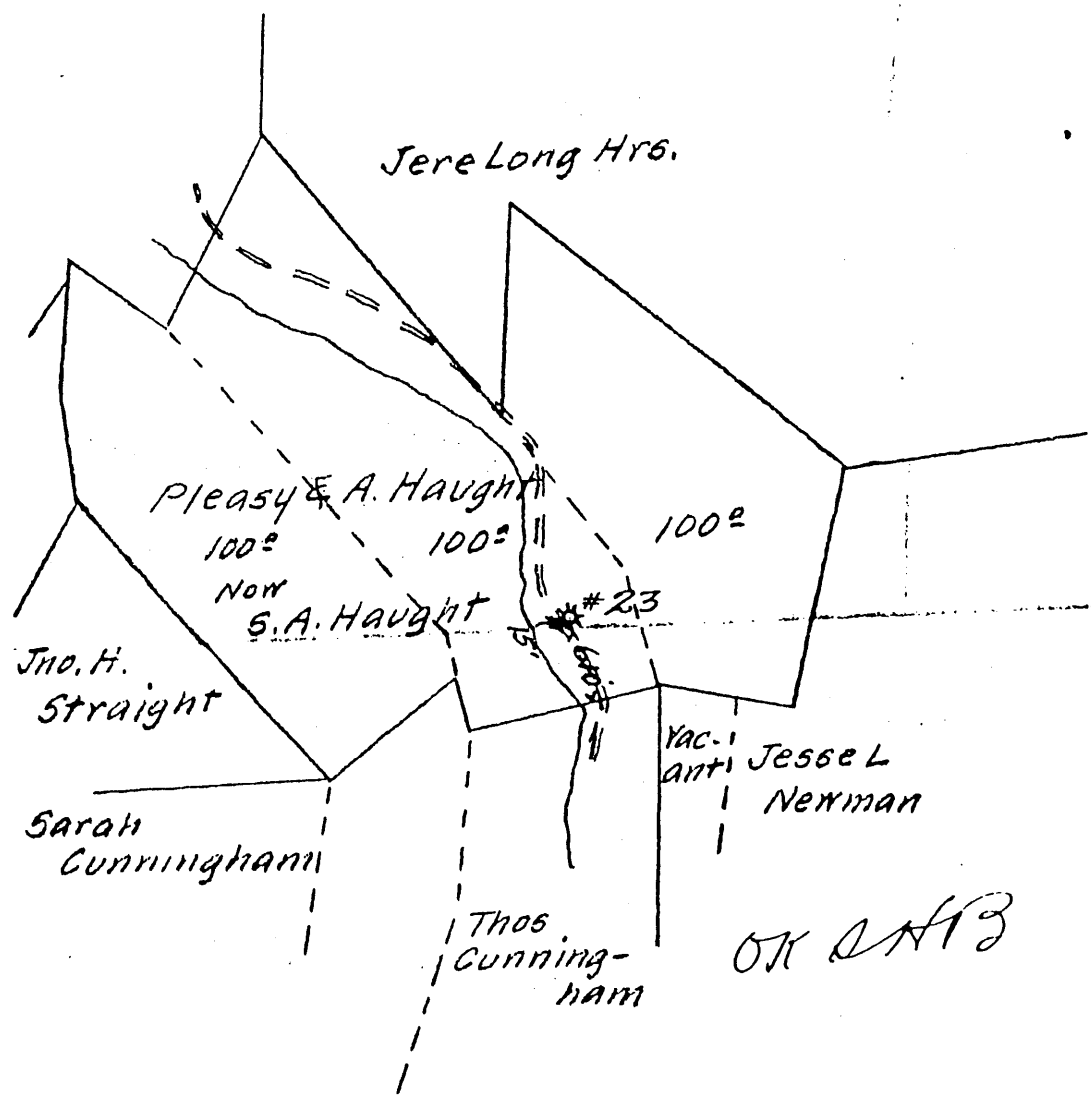

OK SAT 3

Well - 653

RESERVE.....

SPECIAL INSTRUCTIONS.....

Location ^{Meas} ~~made~~ 6-5 14 by O.C. Straight As per plat, except as noted. On field

Returned to Pittsburgh..... 1

Location changed on account of.....
Authorized by..... Date..... 1 Signed.....

REPAIR RECORD

Well No. Pine Grove
 Farm Name Pleasy N 8 S E W 4
 Date First Work Done 4-4-50 Nature of Work Moving in spider
 Commenced: Pulling Tbg. 4-17-50 Completed: Pull Tbg. 4-18-50
 Cleaning Out 4-19-50 Cleaning Out 4-23-50
 Drilling Deeper 4-28-50 Drilling Deeper 5-12-50
 Run Tbg. 5-17-50 Run Tbg. 5-17-50

CASING AND TUBING RECORD

Size	Before Repair		Pulled		Put in Wall		After Repair		Weight
	Tally	Steel Line	Tally	Steel Line	Tally	Steel Line	Tally	Steel Line	
3" Tbg.	2540'	✓	2540'	✓	2642'	✓	2642'	✓	3 1/2'
2 3/16"	1938'	✓	None	✓	None	✓	1938'	✓	
2-5/8"	1589'	✓	None	✓	None	✓	1589'	✓	
2-1/4"	988'	✓	None	✓	None	✓	988'	✓	
10"	240'	✓	None	✓	None	✓	240'	✓	

SHOOTING RECORD (Show if Open Shot or Tamped Shot)

Date	Quartz	Top of Shell	Bottom of Shell	Diameter	Sand	TEST BEFORE SHOT			TEST AFTER SHOT			Test Taken After Shot No. Hours	By Whom Shot	
						Reading	Liquid	Opening	Reading	Liquid	Opening			

RECORD OF ANY DEEPER DRILLING

Formation	Top	Bottom	Oil at	Gas at
Commenced drilling at depth of		2511 ✓		2515 ✓
Gordon		2535 ✓		2517 ✓
Shale	2535 ✓	2608 ✓		2523 ✓
			2608	
			2511	
			97 new ftg	
Total Depth		2608 ✓		

PACKER RECORD

Size	Kind	Set At (Steel Line)
5-3/16"x3"	Hook Wall and Anchor Packer	1991'
5-3/16"x3"	Cave Catcher	2493'
PACKER PULLED		
Size 5-3/16"x3"	Kind L.A. Packer	
-OIL PRODUCTION		
Estimated	bbbl per day	NONE
CLARKSBURG OFFICE ENTRIES		
Repair Card	✓	6/7/50
Well Card	✓	" "
Memo Book	✓	" "
Well Map		JUN 8 1950 C.D.R.
Map Sheets		JUN 12 1950 A.F.A.

VOLUME AND PRESSURE REPORT

BEFORE CLEANING OUT (Take Test When Ready to Clean Out)

Date of Test	Flow Meter or Open Flow	PILOT TUBE			CUBIC FEET	Sands Gas From	Time Blows
		Reading	Liquid Used	Opening			
4-11-50 ✓	FM	6/10	Water	1"	30,123	Stray & Gordon	

AFTER CLEANING OUT

Date of Test	Flow Meter or Open Flow	PILOT TUBE			CUBIC FEET	Sands Gas From	Time Blows
		Reading	Liquid Used	Opening			
4-28-50 ✓	FM	26/10	Water	3/4"	21,600	Stray & Gordon	

AFTER DRILLING DEEPER

Date of Test	Flow Meter or Open Flow	PILOT TUBE			CUBIC FEET	Sands Gas From	Time Blows
		Reading	Liquid Used	Opening			
5-17-50 ✓	FM	16/10	Mercury	1"	111,000	Stray & Gordon	

PRESSURE TEST

Date of Test	Opening	1 Min.	2 Min.	3 Min.	4 Min.	5 Min.	6 Min.	7 Min.	8 Min.	9 Min.	10 Min.	30 Min.	60 Min.	Hrs.	Rock
4-23-50	3" Tubing	4	7	9	10	12	13	14	14	14	15	16	17	24	2

Remarks: "Over"

ORIGINAL - For Land Dept. Only

Inspector Report

B. 183

23 7 1/2

WELL RECORD.

Pleasy Haugh Farm, Acres
 Greene District Metzger County W Va State

Well No. 1

Rig Commenced 189 } Contractor.
 Rig Completed 189 }
 Drilling Commenced Aug 1, 1900 189 }
 Drilling Completed Oct 4, 1900 189 } Cochran & Junt Contractor.

FORMATION.	TOP.	REMARKS.	BOTTOM
Conductor	16	no casing pulled	
10 ^m casing	240		
8 1/4 "	956		
6 7/8 "	1569		
5 3/16 "	1952		
Pgh Coal	435		
Top of Injun Sand	1692		
Pay of Gas & Oil	1807		
Bottom Injun Sand	1921		
Top of Stray Sand	2480		
Pay of Gas	2482		
Bottom Stray Sand	2500		
Top of Gordon Sand	2506		
Pay of Gas	2511		
Total depth	2511		
<p>Left at Well</p> <p>126 ft 10^m casing</p> <p>424 " 8 1/4 "</p> <p>590 " 6 7/8 "</p> <p>103 " 5 3/16 "</p>			

OK.
910

NOTE:

A good record must show the formation from top to bottom of well.

Well - 653