

LATITUDE 39° 32' 30"

LONGITUDE 88° 30' 00"

7.5 OGIS topo location

7.5' loc 0.23 S
0.02 W

15' loc _____
(calc.) _____

Company _____

Farm _____

Quad BIG RUN 7 1/2'

County WETZEL

District GRANT

WELL LOCATION MAP

File No. 103 - 0719

(101)

HOPE NATURAL GAS COMPANY

LOCATION FOR WELL No. *6653*

c 2 50
Instructions *u*

Op. *Grant*
Grant

Grant

DISTRICT

Farm, on waters of *Dickinson Run*

District, *Grant*

County, West Virginia.

Lease No. *47-6* Acres *70*

S. E. 7 W.

Scale one inch equals *80 poles* Location made in Pittsburgh *Nov. 29-24* Sent to Clarksburg *Dec 1-1924*

Location to be *400 feet from intersection farm at a point 200 feet from the corner, per plat.*

COPY SENT TO PHILADELPHIA COMM.

Wet-719

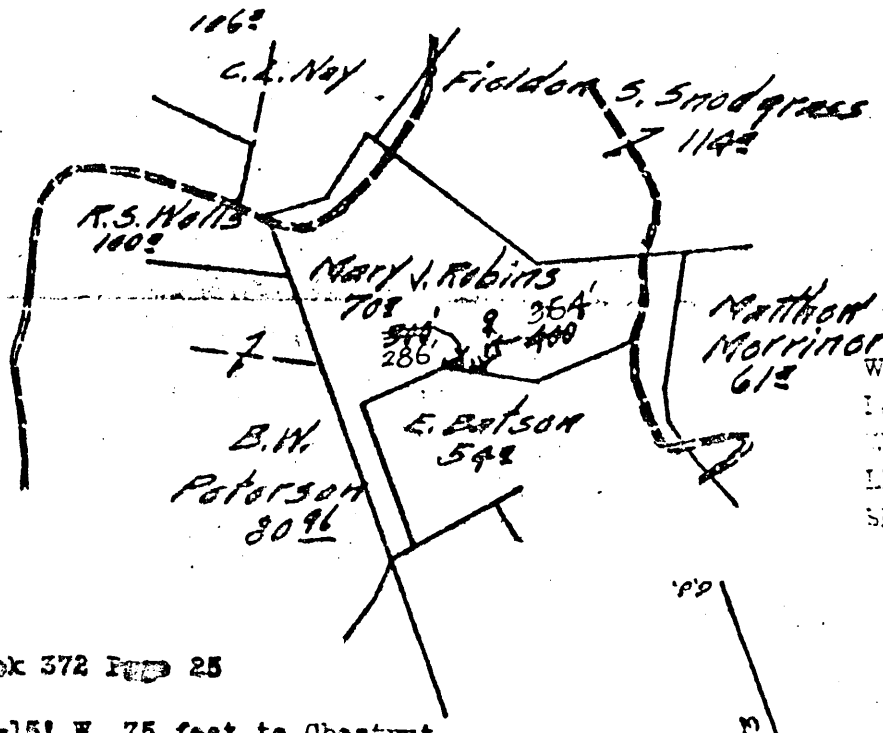

Well Book _____
Range Book _____
Well Map _____
Line Map (LB. 21, 1925 A. J. B.)
Sheets FEB 20 1925 H.E.B.

Field Book 372 *Page 25*

Ref. S59-15' W 75 feet to Obseant
S15-30' E 134 feet to B. Walnut

Notes: - USE No. (2) TWO STAKES

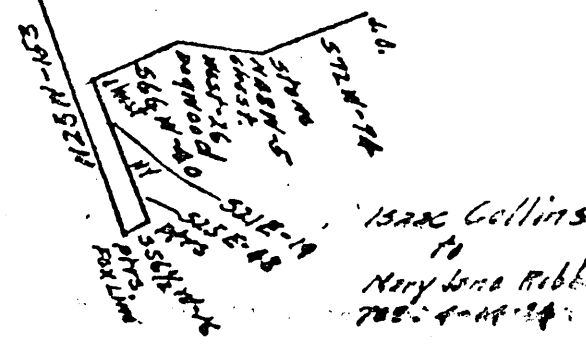

TITLE RESERVE *Five acres around the buildings*

SPECIAL INSTRUCTIONS: COMPLETE WELL ON OR BEFORE

Same Lease on which *15* Located Well No. *670*

Location made Dec. 15, 1924 by N. D. Linger As per plat, except as noted. On field map

Dec. 16, 1924 Returned to Pittsburgh Dec. 16, 1924

Location changed on account of *Original location came in Rock Cliff*

Authorized by J. B. Cerrin, Date Dec. 16, 1924

Signed S. H. Bradley, Fy-Talley

Well No. 6653

Mary J. Robins

Farm

June 9th

1925

District Pine Grove

719 REPAIRS

Commenced May 26th, 1925

N 7 S E 7 W

Completed June 5th, 1925

CASING AND TUBING RECORD

Size	Before Repairs	Pulled	Put in Well	After Repairs	Disposition of Amount Pulled
10"	336-8	none	none	336-8	
8-1/4"	1441-0	16'	none	1441-0	in stock at well
6-5/8"	2180-0	none	none	2180-0	
5-3/16	3000-0	None	none	3000-0	
2" Tbg.	3223-0	none	none	3223-0	TD?

SHOOTING RECORD

Date	Quarts	Top of Shell	Bottom of Shell	Diameter	Sand	TEST BEFORE SHOT			TEST AFTER SHOT			Test Taken After Shot No. Hours	By Whom Shot	
						Reading	Liquid	Opening	Reading	Liquid	Opening			
SEE ORIGINAL WELL RECORD														

RECORD OF ANY DEEPER DRILLING

Formation	Top	Bottom
Commenced drilling at depth of		
We used every effort possible to pull outside casing, also tried jumbo blocks, but failed. Pulled 8 1/2" casing 16 feet off of bottom.		
Total Depth		

Names of Drillers	Time (Days)
John Lowe	8
Names of Tool Dressers	Time (Days)
Ross Kendall	8

PACKER RECORD (ALSO NOTE BELOW IF ANY PACKERS ARE PULLED)

Size	Kind	Anchor	Amount Above A
See Original well record			

OIL AND GAS DISCOVERIES IN DEEPER DRILLING

Oil at	Ft. in
Gas at	Ft. in

VOLUME AND PRESSURE REPORT

BEFORE REPAIRS

Reading	Liquid	Opening	Rock or Minute Pressure	Sands Gas From

AFTER REPAIRS

VOLUME TEST

Date of Test	Opening	PITOT TUBE		OPEN FLOW	Sands Gas From
		Reading	Liquid Used	Lbs.	
6-8-25	2" Casing	90/10	Water	452/160	Stray, Carl & 4TH
Time Blown	" Tubing				

PRESSURE TEST

Date of Test	Opening	1 Min.	2 Min.	3 Min.	4 Min.	5 Min.	6 Min.	7 Min.	8 Min.	9 Min.	10 Min.	30 Min.	60 Min.	Hrs.
6-8-25	8" Casing	60	95	120	130	140	150	155	160	165	170	195	205	24
Time Blown	" Tubing													

OIL: From Sand

Estimated Production Bbl. per Day

Remarks:

M. J. Robins
FOREMAN

WET -719