

LATITUDE 39° 37' 30"

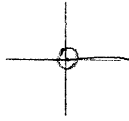

LONGITUDE 80° 32' 30"

7'5 OGIS topo location

7.5' loc 0.295 15' loc _____
 1.52w (calc.) _____

Company _____

Farm _____

Quad BIG RUN 7 1/2'

County WETZEL

District CENTER

WELL LOCATION MAP

File No. 103-0722

THE MANUFACTURERS LIGHT & HEAT CO.

191

To THE PITTSBURGH OFFICE:—

Location No. _____ has been made by the _____ Co.
 on the _____ farm of _____ acres, bounded on the North by _____
 _____; on the East by _____; on the South
 by _____, and on the West by _____ in
 _____ District _____ Township _____ Co., _____ as
 shown on the following sketch.

Signed _____

NORTH

Lat. 39° 31' 16"
 Long. 80° 34' 17"

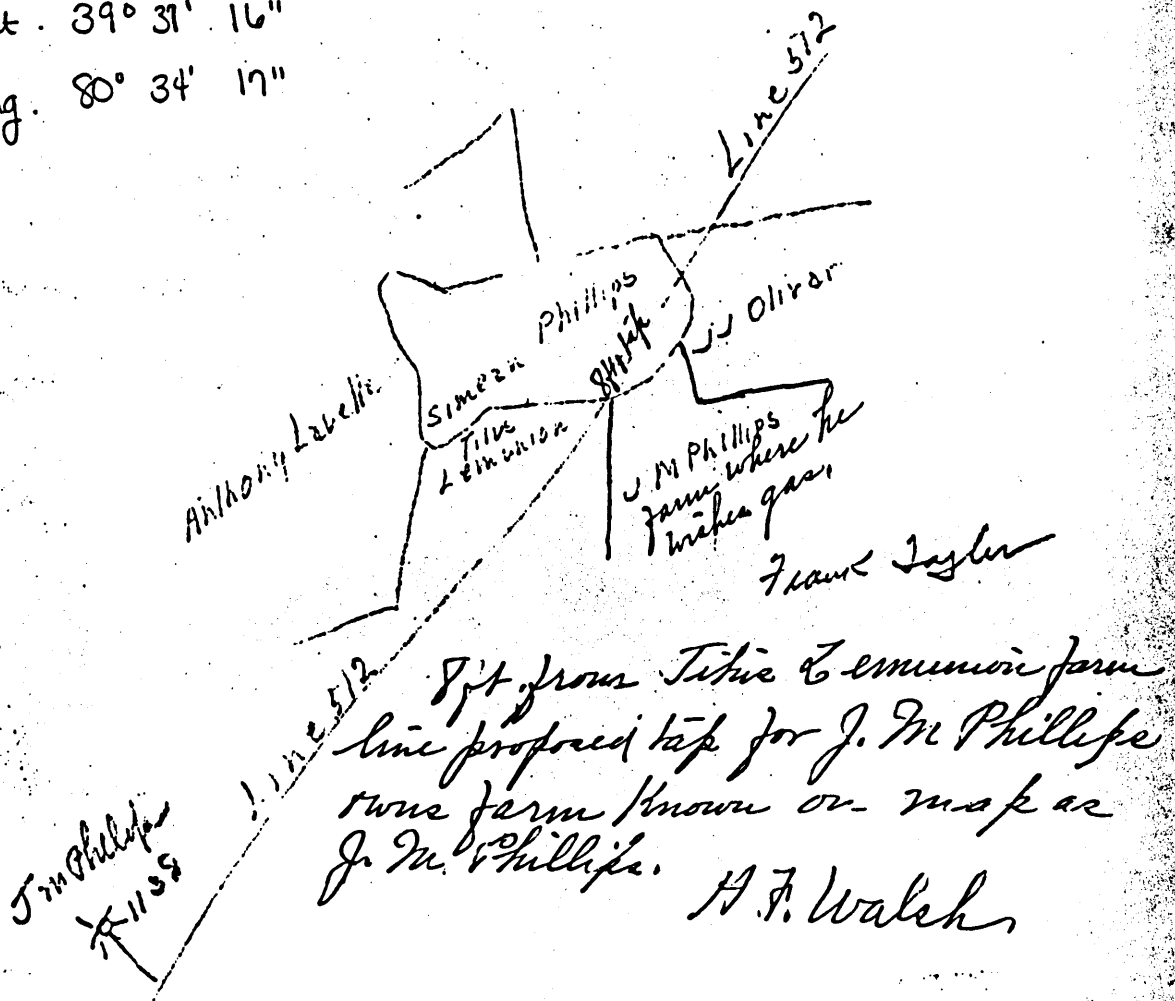

Frank Taylor

80.000 per hour

WET-722

The Manufacturers Light and Heat Co.

Farmers Bank Building, Pittsburgh, Penna.

Division
 Record of Well No. 1 1138 on *John M. Phillips* Farm
Haweswood Field *Wetzel* County *W. Va* State
 Rig commenced *July 1905* Completed *July 25 1905*
 Drilling commenced *Aug 5 1905* Completed *Sept 28 1905*
 Coal per foot *1.40* Contractor *J. Fishel*
 Drillers' names *C. K. Knight & M. Sloan* Tool dresser *W. H. Day*

BOILER			ENGINE			RIG			
No.	Name of Maker	H. P.	No.	Name of Maker	H. P.	New	Old	Height	Name of Builder
						<i>New</i>		<i>82 ft</i>	<i>Sam J. Davis</i>

CONDUCTOR AND CASING USED IN DRILLING									
Conductor	12 inch	10 inch	8 1/2 inch	6 1/2 inch	6 inch	5 1/2 inch	5 inch	4 inch	3 inch
<i>16</i>			<i>24x1505</i>	<i>2186</i>					

CONDUCTOR AND CASING LEFT IN WELL									
Conductor	12 inch	10 inch	8 1/2 inch	6 1/2 inch	6 inch	5 1/2 inch	5 inch	4 inch	3 inch
<i>14x</i>			<i>1505 ft</i>	<i>2186 ft</i>				<i>4</i>	<i>3</i>
								<i>2366</i>	

OIL WELL					GAS WELL					
When Shot	Size of Torpedo	1st Day's Production	Tubing	Boots	Tanks	Size of Packer	Depth Set	Packed With	1st Minute's Pressure	Booth Pressure
						<i>6 3/4 x 6</i>	<i>2201</i>	<i>Limestone</i>	<i>300</i>	<i>250</i>

FORMATION	Top	Bottom	Thickness	REMARKS
<i>Pitting Coal</i>	<i>948</i>	<i>954</i>	<i>6</i>	<i>Did not get Mafitown Lime & shells no regular very little plate between these sands</i>
<i>Little Dunkard</i>	<i>1356</i>	<i>1390</i>	<i>34</i>	
<i>Big</i>	<i>1474</i>			
<i>Gas sand</i>	<i>1550</i>			
<i>1/2 salt sand</i>	<i>1685</i>			
<i>2/3 " "</i>	<i>1740</i>			
<i>3 " "</i>	<i>1855</i>			
<i>Bottom</i>	<i>2050</i>			
<i>Mason sand</i>	<i>2055</i>	<i>2130</i>	<i>75</i>	
<i>Gas in</i>	<i>2070</i>			
<i>Water</i>	<i>2120</i>			
<i>Pencil carb</i>	<i>2130</i>	<i>2188</i>	<i>8</i>	<i>Water 1960 very little little lime and Mason cell sand - very little water in Mason</i>
<i>Big lign</i>	<i>2138</i>	<i>2210</i>	<i>72</i>	
<i>Big lign</i>	<i>2210</i>			
<i>Gas</i>	<i>2230</i>			
<i>Gas</i>	<i>2310</i>			
<i>Total depth</i>	<i>2370</i>			

Drilled deeper by J. P. Fishel Dec 12 - 1906

By	Depth	Remarks
<i>Reg. Lign</i>	<i>2440</i>	<i>1st min in 6 5/8 - 20"</i>
<i>C. K. Knight</i>	<i>3003</i>	<i>2 " "</i>
<i>W. H. Day</i>	<i>3052</i>	<i>3 " "</i>
<i>W. H. Day</i>	<i>3052</i>	<i>4 " "</i>
<i>W. H. Day</i>	<i>3259</i>	<i>5 " "</i>
<i>W. H. Day</i>	<i>3325</i>	<i>6 " "</i>
<i>W. H. Day</i>	<i>3379</i>	<i>7 " "</i>
<i>W. H. Day</i>	<i>3379</i>	<i>8 " "</i>
<i>W. H. Day</i>	<i>3379</i>	<i>9 " "</i>
<i>W. H. Day</i>	<i>3379</i>	<i>10 " "</i>
<i>W. H. Day</i>	<i>3379</i>	<i>11 " "</i>
<i>W. H. Day</i>	<i>3379</i>	<i>12 " "</i>
<i>W. H. Day</i>	<i>3379</i>	<i>13 " "</i>
<i>W. H. Day</i>	<i>3379</i>	<i>14 " "</i>
<i>W. H. Day</i>	<i>3379</i>	<i>15 " "</i>
<i>W. H. Day</i>	<i>3379</i>	<i>16 " "</i>
<i>W. H. Day</i>	<i>3379</i>	<i>17 " "</i>
<i>W. H. Day</i>	<i>3379</i>	<i>18 " "</i>
<i>W. H. Day</i>	<i>3379</i>	<i>19 " "</i>
<i>W. H. Day</i>	<i>3379</i>	<i>20 " "</i>
<i>W. H. Day</i>	<i>3379</i>	<i>21 " "</i>
<i>W. H. Day</i>	<i>3379</i>	<i>22 " "</i>
<i>W. H. Day</i>	<i>3379</i>	<i>23 " "</i>
<i>W. H. Day</i>	<i>3379</i>	<i>24 " "</i>
<i>W. H. Day</i>	<i>3379</i>	<i>25 " "</i>
<i>W. H. Day</i>	<i>3379</i>	<i>26 " "</i>
<i>W. H. Day</i>	<i>3379</i>	<i>27 " "</i>
<i>W. H. Day</i>	<i>3379</i>	<i>28 " "</i>
<i>W. H. Day</i>	<i>3379</i>	<i>29 " "</i>
<i>W. H. Day</i>	<i>3379</i>	<i>30 " "</i>
<i>W. H. Day</i>	<i>3379</i>	<i>31 " "</i>
<i>W. H. Day</i>	<i>3379</i>	<i>32 " "</i>
<i>W. H. Day</i>	<i>3379</i>	<i>33 " "</i>
<i>W. H. Day</i>	<i>3379</i>	<i>34 " "</i>
<i>W. H. Day</i>	<i>3379</i>	<i>35 " "</i>
<i>W. H. Day</i>	<i>3379</i>	<i>36 " "</i>
<i>W. H. Day</i>	<i>3379</i>	<i>37 " "</i>
<i>W. H. Day</i>	<i>3379</i>	<i>38 " "</i>
<i>W. H. Day</i>	<i>3379</i>	<i>39 " "</i>
<i>W. H. Day</i>	<i>3379</i>	<i>40 " "</i>
<i>W. H. Day</i>	<i>3379</i>	<i>41 " "</i>
<i>W. H. Day</i>	<i>3379</i>	<i>42 " "</i>
<i>W. H. Day</i>	<i>3379</i>	<i>43 " "</i>
<i>W. H. Day</i>	<i>3379</i>	<i>44 " "</i>
<i>W. H. Day</i>	<i>3379</i>	<i>45 " "</i>
<i>W. H. Day</i>	<i>3379</i>	<i>46 " "</i>
<i>W. H. Day</i>	<i>3379</i>	<i>47 " "</i>
<i>W. H. Day</i>	<i>3379</i>	<i>48 " "</i>
<i>W. H. Day</i>	<i>3379</i>	<i>49 " "</i>
<i>W. H. Day</i>	<i>3379</i>	<i>50 " "</i>
<i>W. H. Day</i>	<i>3379</i>	<i>51 " "</i>
<i>W. H. Day</i>	<i>3379</i>	<i>52 " "</i>
<i>W. H. Day</i>	<i>3379</i>	<i>53 " "</i>
<i>W. H. Day</i>	<i>3379</i>	<i>54 " "</i>
<i>W. H. Day</i>	<i>3379</i>	<i>55 " "</i>
<i>W. H. Day</i>	<i>3379</i>	<i>56 " "</i>
<i>W. H. Day</i>	<i>3379</i>	<i>57 " "</i>
<i>W. H. Day</i>	<i>3379</i>	<i>58 " "</i>
<i>W. H. Day</i>	<i>3379</i>	<i>59 " "</i>
<i>W. H. Day</i>	<i>3379</i>	<i>60 " "</i>
<i>W. H. Day</i>	<i>3379</i>	<i>61 " "</i>
<i>W. H. Day</i>	<i>3379</i>	<i>62 " "</i>
<i>W. H. Day</i>	<i>3379</i>	<i>63 " "</i>
<i>W. H. Day</i>	<i>3379</i>	<i>64 " "</i>
<i>W. H. Day</i>	<i>3379</i>	<i>65 " "</i>
<i>W. H. Day</i>	<i>3379</i>	<i>66 " "</i>
<i>W. H. Day</i>	<i>3379</i>	<i>67 " "</i>
<i>W. H. Day</i>	<i>3379</i>	<i>68 " "</i>
<i>W. H. Day</i>	<i>3379</i>	<i>69 " "</i>
<i>W. H. Day</i>	<i>3379</i>	<i>70 " "</i>
<i>W. H. Day</i>	<i>3379</i>	<i>71 " "</i>
<i>W. H. Day</i>	<i>3379</i>	<i>72 " "</i>
<i>W. H. Day</i>	<i>3379</i>	<i>73 " "</i>
<i>W. H. Day</i>	<i>3379</i>	<i>74 " "</i>
<i>W. H. Day</i>	<i>3379</i>	<i>75 " "</i>
<i>W. H. Day</i>	<i>3379</i>	<i>76 " "</i>
<i>W. H. Day</i>	<i>3379</i>	<i>77 " "</i>
<i>W. H. Day</i>	<i>3379</i>	<i>78 " "</i>
<i>W. H. Day</i>	<i>3379</i>	<i>79 " "</i>
<i>W. H. Day</i>	<i>3379</i>	<i>80 " "</i>
<i>W. H. Day</i>	<i>3379</i>	<i>81 " "</i>
<i>W. H. Day</i>	<i>3379</i>	<i>82 " "</i>
<i>W. H. Day</i>	<i>3379</i>	<i>83 " "</i>
<i>W. H. Day</i>	<i>3379</i>	<i>84 " "</i>
<i>W. H. Day</i>	<i>3379</i>	<i>85 " "</i>
<i>W. H. Day</i>	<i>3379</i>	<i>86 " "</i>
<i>W. H. Day</i>	<i>3379</i>	<i>87 " "</i>
<i>W. H. Day</i>	<i>3379</i>	<i>88 " "</i>
<i>W. H. Day</i>	<i>3379</i>	<i>89 " "</i>
<i>W. H. Day</i>	<i>3379</i>	<i>90 " "</i>
<i>W. H. Day</i>	<i>3379</i>	<i>91 " "</i>
<i>W. H. Day</i>	<i>3379</i>	<i>92 " "</i>
<i>W. H. Day</i>	<i>3379</i>	<i>93 " "</i>
<i>W. H. Day</i>	<i>3379</i>	<i>94 " "</i>
<i>W. H. Day</i>	<i>3379</i>	<i>95 " "</i>
<i>W. H. Day</i>	<i>3379</i>	<i>96 " "</i>
<i>W. H. Day</i>	<i>3379</i>	<i>97 " "</i>
<i>W. H. Day</i>	<i>3379</i>	<i>98 " "</i>
<i>W. H. Day</i>	<i>3379</i>	<i>99 " "</i>
<i>W. H. Day</i>	<i>3379</i>	<i>100 " "</i>

Examined above information and measurements and found to be correct by *J. P. Fishel* Contractor. Examined and approved by *W. L. Snyder Jr.* Superintendent.

NOTE - The above blank must be filled out carefully by the Contractor with a complete and accurate record of the Well, and accompany, when presented for payment, the bill for drilling.

All formations and known sands must be given by their proper name, with steel line measurements, and under the head of "Remarks" must be recorded in what sand and at what depth Oil, Gas or Water was found, the quantity of same, the quality of the sand, and thickness of pay.

Make no memoranda of boiler and engine if owned by Contractor.

WET - 722