



West Virginia Department of Environmental Protection
Office of Oil and Gas
WELL LOCATION FORM: GPS

API: 47-103-00771 P WELL NO.: WV 651986 (Morris #671)

FARM NAME: Morris

RESPONSIBLE PARTY NAME: EQT Production Company

COUNTY: Wetzel DISTRICT: Church

QUADRANGLE: Hundred 7.5'

SURFACE OWNER: Laura Rose Williams and Leslie N. Williams

ROYALTY OWNER: J.E. and L.E. Morris

UTM GPS NORTHING: 4390515

UTM GPS EASTING: 544662 GPS ELEVATION: 387 m (1268 ft)

The Responsible Party named above has chosen to submit GPS coordinates in lieu of preparing a new well location plat for a plugging permit or assigned API number on the above well. The Office of Oil and Gas will not accept GPS coordinates that do not meet the following requirements:

- Datum: NAD 1983, Zone: 17 North, Coordinate Units: meters, Altitude: height above mean sea level (MSL) – meters.
- Accuracy to Datum – 3.05 meters
- Data Collection Method:
Survey grade GPS _____ : Post Processed Differential _____
Real-Time Differential _____
Mapping Grade GPS X : Post Processed Differential X
Real-Time Differential _____
- Letter size copy of the topography map showing the well location.**

I the undersigned, hereby certify this data is correct to the best of my knowledge and belief and shows all the information required by law and the regulations issued and prescribed by the Office of Oil and Gas.

Ben R. Saylor
Signature
12/7/11
Date

P.S. 2092
Title

RECEIVED
Office of Oil & Gas

FEB 10 2012

WV Department of
Environmental Protection

Topo Quad: Hundred
County: Wetzel
District: Church

Scale: 1" = 2000' 103-00771P
Date: October 25, 2011
Project No: 40-34-00-09

47-103-00771 (WV 651986)

Topo

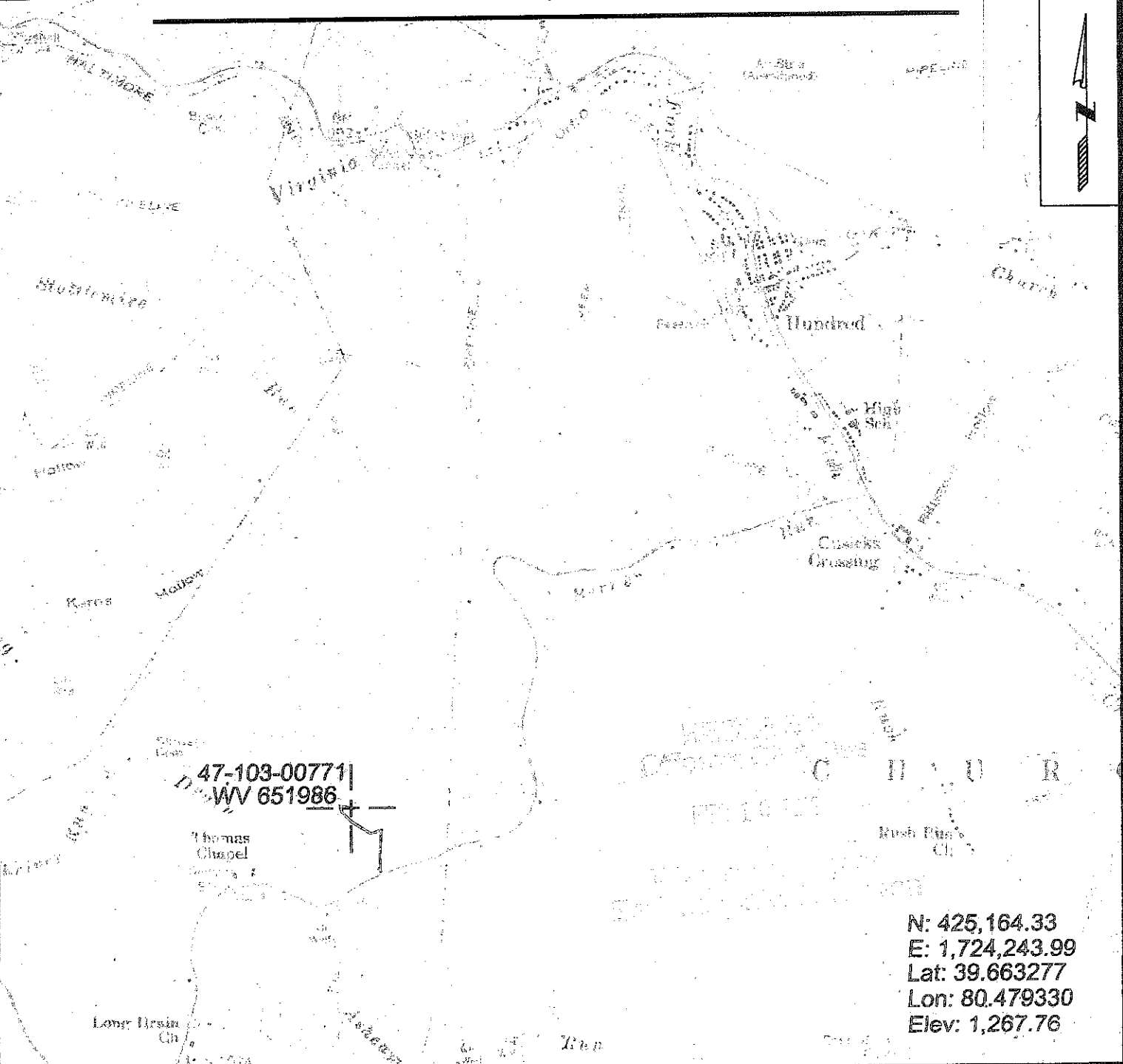

SURVEYING AND MAPPING SERVICES PERFORMED BY:
ALLEGHENY SURVEYS, INC.
1-800-482-8606
P.O. BOX 438
BIRCH RIVER, WV 26610
PH: (304) 649-8606
FAX: (304) 649-8608

PREPARED FOR:
EQT Production Company
1710 Pennsylvania Ave.
Charleston, WV 25302