

LATITUDE 39° 27' 30"



80° 30' 00"

LONGITUDE

7.5 OGIS topo location

7.5' 10c	<u>0.755</u>	15' 10c	_____
	<u>1.48 w</u>	(calc.)	_____

Company _____

Farm _____

Quad FOLSOM 7 1/2

County WETZEL

District GRANT

WELL LOCATION MAP

File No. 103-0964

(103)

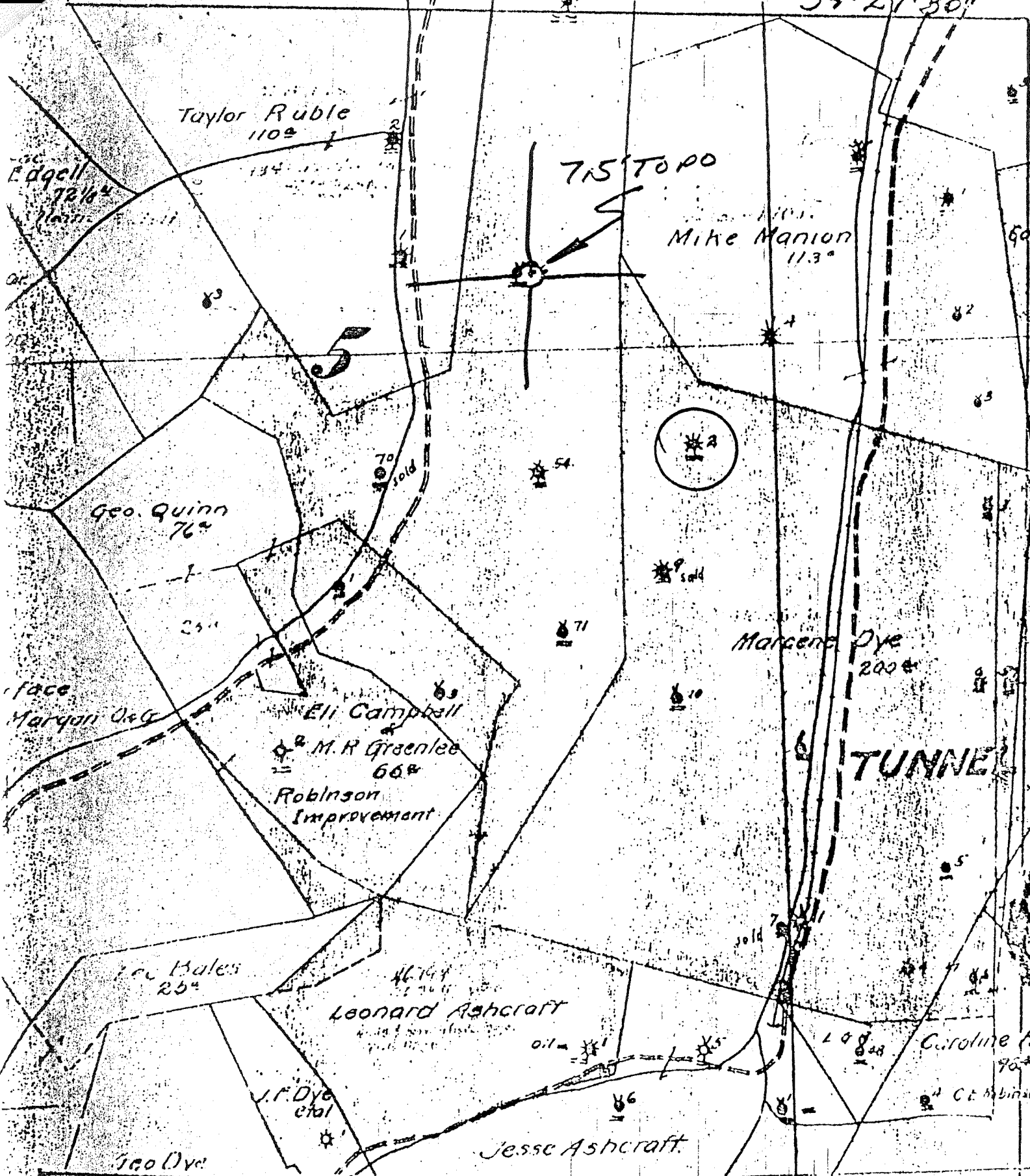

(+) DENOTES LOCATION OF WELL ON UNITED STATES TOPOGRAPHIC MAPS



DATE 1-9-1972
 OPERATOR'S WELL NO. _____
 API WELL NO. 47-103-0964
 STATE COUNTY PERMIT

FORM IV-B
 (8-78)
N49 S1 E5

STATE OF WEST VIRGINIA
 DEPARTMENT OF MINES
 OIL AND GAS DIVISION

WELL TYPE: OIL GAS _____ LIQUID INJECTION _____ WASTE DISPOSAL _____
 (IF "GAS", PRODUCTION _____ STORAGE _____ DEEP _____ SHALLOW _____)
 LOCATION: ELEVATION _____ WATER SHED SOUTH FORK FISHING CREEK
 DISTRICT GRANT COUNTY WETZEL
 QUADRANGLE FOLSOM 7.51

SURFACE OWNER _____ ACREAGE _____
 OIL & GAS ROYALTY OWNER _____ LEASE NO. _____ LEASE ACREAGE _____

PROPOSED WORK: DRILL _____ CONVERT _____ DRILL DEEPER _____ REDRILL _____ FRACTURE OR STIMULATE _____ PLUG OFF OLD FORMATION _____ PERFORATE NEW FORMATION _____ OTHER PHYSICAL CHANGE IN WELL (SPECIFY) _____

PLUG AND ABANDON _____ CLEAN OUT AND REPLUG _____
 TARGET FORMATION _____ ESTIMATED DEPTH _____
 WELL OPERATOR Pennzoil Company DESIGNATED AGENT James A. Craws
 ADDRESS P. O. Box 1588 ADDRESS P. O. Box 1588
Parkersburg, WV 26101 Parkersburg, WV 26101

Well No. *2* *M. P. Ryle* Farm *210* Acres
 Lease No. *Grant* District *Harrison* County *W. Va.* State
 Contractor *Wetzel* Contractor
 Drilling Commenced *May 29, 1907* Drilling Completed *July 27, 1907.*

ROCK FORMATION	TOP	BOTTOM	Steel Line Measurement	REMARKS
<i>Pittsburgh Coal</i>	<i>1095</i>			
<i>Little Dunkard</i>	<i>1510</i>	<i>1555</i>		
<i>Big Dunkard</i>	<i>1595</i>	<i>1670</i>		
<i>Gale Sand</i>	<i>1854</i>	<i>1870</i>		
<i>1st Salt Sand</i>	<i>2080</i>	<i>2115</i>		
<i>Little Limestone</i>	<i>2283</i>	<i>2324</i>		
<i>Pencil Limestone</i>	<i>2322</i>	<i>2326</i>		
<i>Big Limestone</i>	<i>2326</i>	<i>2376</i>		
<i>Big Injun</i>	<i>2376</i>	<i>2507</i>		
<i>Forty Foot</i>	<i>2958</i>	<i>2970</i>		
<i>Thirty Foot</i>	<i>3058</i>	<i>3073</i>		<i>Hole Reduced 3095</i>
<i>Horseshoe Sand</i>	<i>3167</i>			
<i>Small Pay</i>	<i>3170</i>	<i>3172</i>		
<i>Pay</i>	<i>3180</i>	<i>3184</i>		
<i>Total Depth</i>		<i>3191</i>		

*4 7/8" liner 3 sections
 11 joints each 3095-2395*

CASING RECORD AS TALLIED. NOT STEEL LINE MEASUREMENT

SIZE	PUT IN WELL		PULLED OUT		LEFT IN WELL	Shot Date	Amount Sand	Result	Packer Size	Depth Set
	FEET	IN.	FEET	IN.						
<i>10"</i>	<i>700</i>	<i>-</i>	<i>160</i>	<i>-</i>		<i>3/6/07</i>	<i>30</i>	<i>4/4/08</i>		
<i>8 1/4"</i>	<i>1595</i>	<i>-</i>	<i>1595</i>	<i>-</i>			<i>60</i>			
<i>6 7/8"</i>	<i>2350</i>	<i>-</i>								
<i>5 3/8"</i>	<i>3095</i>	<i>-</i>								

Production First 24 Hours Bbls. Gas Test

Approved by Superintendent