

89°37'39"

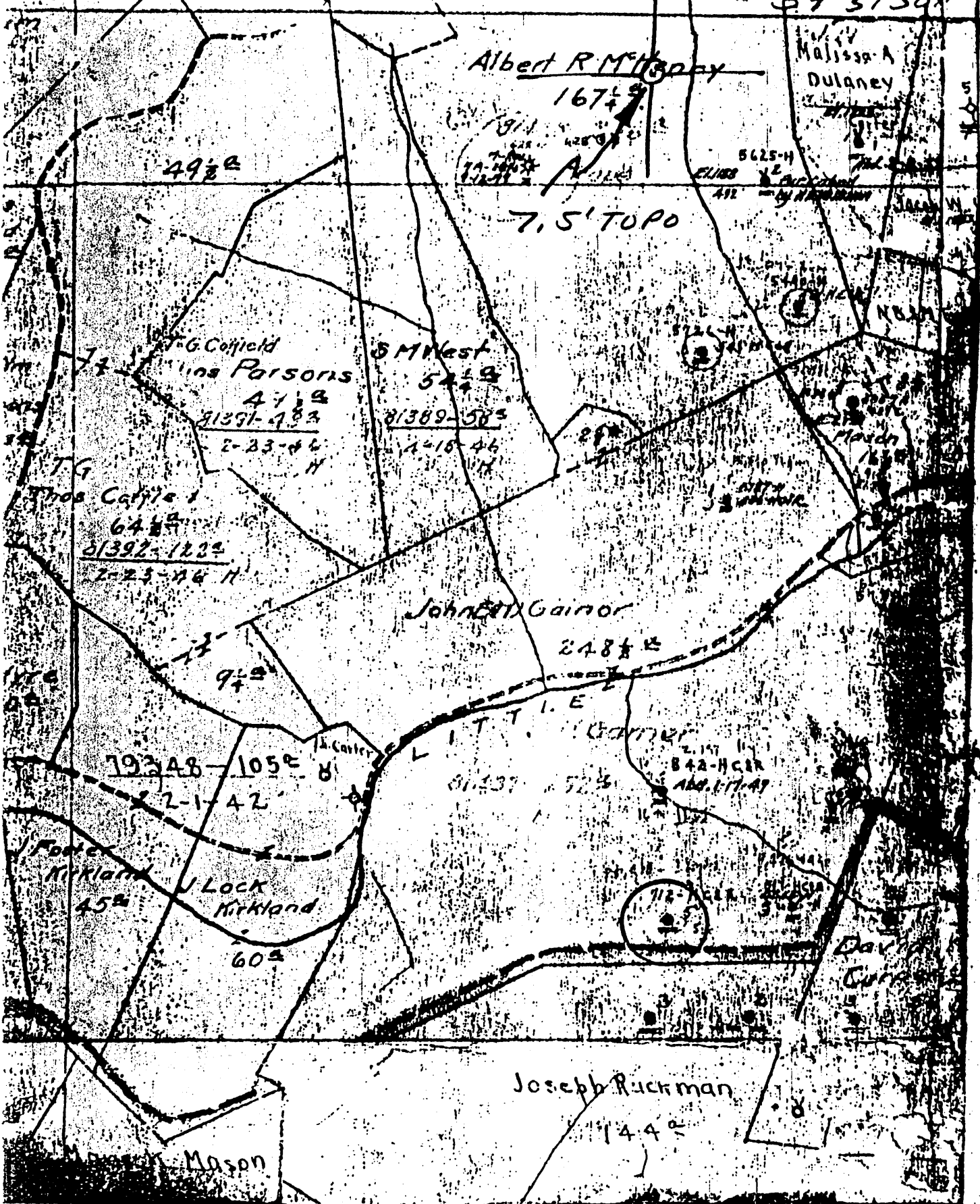

(+) DENOTES LOCATION OF WELL ON UNITED STATES TOPOGRAPHIC MAPS
 FORM IV-6
 (8-78)



DATE 1-5-, 1979
 OPERATOR'S WELL NO. 5
 API WELL NO. 47-103-0979
 STATE COUNTY PERMIT

STATE OF WEST VIRGINIA
 DEPARTMENT OF MINES

OIL AND GAS DIVISION
 WELL TYPE: OIL A GAS _____ LIQUID INJECTION _____ WASTE DISPOSAL _____
 (IF "GAS", PRODUCTION _____ STORAGE _____ DEEP _____ SHALLOW _____
 LOCATION: ELEVATION _____ WATER SHED LITTLE FISHING CR
 DISTRICT PROCTOR COUNTY WETZEL
 QUADRANGLE PINE GROVE 7.5'
 SURFACE OWNER _____ ACREAGE _____
 OIL & GAS ROYALTY OWNER _____ LEASE NO. _____ LEASE ACREAGE _____
 PROPOSED WORK: DRILL _____ CONVERT _____ DRILL DEEPER _____ REDRILL _____ FRACTURE OR
 STIMULATE _____ PLUS OFF OLD FORMATION _____ PERFORATE NEW
 FORMATION _____ OTHER PHYSICAL CHANGE IN WELL (SPECIFY) _____

PLUG AND ABANDON _____ CLEAN OUT AND REPLUG _____
 TARGET FORMATION _____ ESTIMATED DEPTH _____
 WELL OPERATOR Pennzoil Company DESIGNATED AGENT James A. Crews
 ADDRESS P. O. Box 1588 ADDRESS P. O. Box 1588
Parkersburg, WV 26101 Parkersburg, WV 26101

S.H. GARNER-5

LATITUDE 39° 37' 30"



80° 40' 00" LONGITUDE

7'5 OGIS topo location

7.5' LOC 0.15 S 15' LOC _____
 1.21 W (calc.) _____

Company _____

Farm _____

Quad PINE GROVE 7 1/2'

County WETZEL

District PROCTOR

WELL LOCATION MAP

File No. 103-0979

(038)