

I THE UNDERSIGNED, HEREBY CERTIFY THAT THIS PLAT IS CORRECT TO THE BEST OF MY KNOWLEDGE AND BELIEF AND SHOWS ALL THE INFORMATION REQUIRED BY LAW AND THE REGULATIONS ISSUED AND PRESCRIBED BY THE DEPARTMENT OF ENERGY.

L.L.S. Gregory A. Smith
677

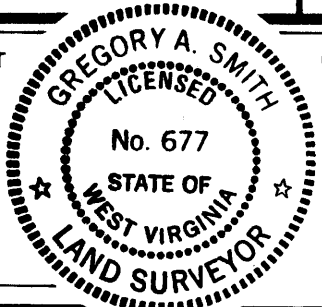

(+) DENOTES LOCATION OF WELL ON UNITED STATES TOPOGRAPHIC MAPS.
DATE MARCH 2, 19 89
OPERATORS WELL NO. BAXTER NO. 1
API WELL NO. 47-103-1458
STATE COUNTY PERMIT
Cancelled

MINIMUM DEGREE OF ACCURACY 1 / 200 FILE NO. 2023(26-62)
PROVEN SOURCE OF ELEVATION BM 635' SCALE 1" = 400'

STATE OF WEST VIRGINIA
DEPARTMENT OF ENERGY
OIL AND GAS DIVISION

WELL TYPE: OIL GAS LIQUID INJECTION WASTE DISPOSAL "GAS" PRODUCTION STORAGE DEEP SHALLOW

LOCATION: ELEVATION 690' WATERSHED PROCTOR CREEK
DISTRICT PROCTOR COUNTY WETZEL QUADRANGLE NEW MARTINSVILLE 7.5'

SURFACE OWNER GEORGE BAXTER ACREAGE 85.27
ROYALTY OWNER GEORGE BAXTER LEASE ACREAGE 85.27

PROPOSED WORK: LEASE NO. _____
DRILL CONVERT DRILL DEEPER REDRILL FRACTURE OR STIMULATE PLUG OFF OLD FORMATION PERFORATE NEW FORMATION PLUG AND ABANDON CLEAN OUT AND REPLUG OTHER _____
PHYSICAL CHANGE IN WELL (SPECIFY) _____ TARGET FORMATION GORDON
ESTIMATED DEPTH 2400'

WELL OPERATOR MURVIN OIL CORP. DESIGNATED AGENT P. NATHAN BOWLES JR.
ADDRESS P.O. BOX 297, OLNEY, IL 62450 ADDRESS P.O. BOX 1386, CHARLESTON, WV 25325

Donie Hadley
BAXTER

C. BAXTER

WELL NO. 1

LEASE

12" AMERICAN ELM

S85-45E 1188'

N51-52E 673.93'

N12-22E 173.30'

S63-24W 551.36'

S13-18W 280.5'

M. BAXTER

18" BEECH

N17-15E 112.2'

N19-15E 227.7'

N1E 155.1'

N32-50E 230.18'

N46E 247.5'

85.27 ACRES ±

0.90
0.90
378
3.13

NORTH

N32-25W 458.7'

S77-50W 202.95'

N38W 478.5'

W. HORNER

S56-30W 205.42'

N59-15W 610.5'

S69-15W 379.5'

S75-15W 663.30'

E/C

S1-56W 792'

REFERENCES

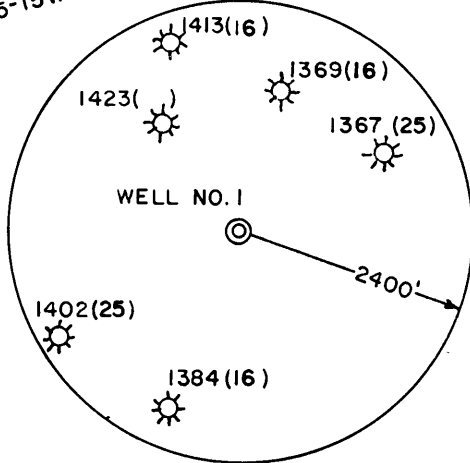
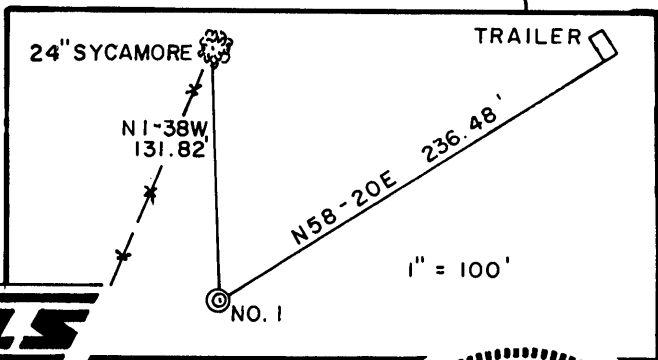

I THE UNDERSIGNED, HEREBY CERTIFY THAT THIS PLAT IS CORRECT TO THE BEST OF MY KNOWLEDGE AND BELIEF AND SHOWS ALL THE INFORMATION REQUIRED BY LAW AND THE REGULATIONS ISSUED AND PRESCRIBED BY THE DEPARTMENT OF ENERGY.

L.L.S. 677 *Gregory A. Smith*

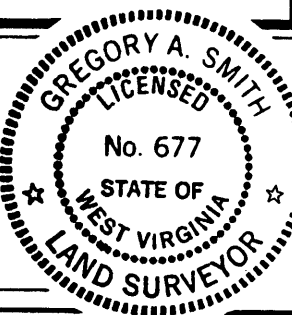

(+) DENOTES LOCATION OF WELL ON UNITED STATES TOPOGRAPHIC MAPS.

DATE MARCH 2, 19 89

OPERATORS WELL NO. BAXTER NO. 1

API WELL NO. 47-103-1458
STATE COUNTY PERMIT

MINIMUM DEGREE OF ACCURACY 1 / 200 FILE NO. 2023(26-62)
PROVEN SOURCE OF ELEVATION BM 635' SCALE 1" = 400'

STATE OF WEST VIRGINIA DEPARTMENT OF ENERGY OIL AND GAS DIVISION



WELL TYPE: OIL ___ GAS X LIQUID INJECTION ___ WASTE DISPOSAL ___ IF "GAS" PRODUCTION X STORAGE ___ DEEP ___ SHALLOW X

LOCATION: ELEVATION 690' WATERSHED PROCTOR CREEK
DISTRICT PROCTOR 1 COUNTY WETZEL QUADRANGLE NEW MARTINSVILLE 7.5'

SURFACE OWNER GEORGE BAXTER ACREAGE 85.27 509
ROYALTY OWNER GEORGE BAXTER LEASE ACREAGE 85.27 091

PROPOSED WORK: LEASE NO. 3
DRILL X CONVERT ___ DRILL DEEPER ___ REDRILL ___ FRACTURE OR STIMULATE X PLUG OFF OLD FORMATION ___ PERFORATE NEW FORMATION ___ PLUG AND ABANDON ___ CLEAN OUT AND REPLUG ___ OTHER
PHYSICAL CHANGE IN WELL (SPECIFY) ___ TARGET FORMATION GORDON
ESTIMATED DEPTH 2400

WELL OPERATOR MURVIN OIL CORP. DESIGNATED AGENT P. NATHAN BOWLES JR.
ADDRESS PO BOX 297, OLNEY, IL 62450 ADDRESS P.O. BOX 1386, CHARLESTON, WV 25325

COUNTY NAME PERMIT

STATE OF WEST VIRGINIA
 DEPARTMENT OF ENERGY, DIVISION OF OIL AND GAS
 WELL WORK PERMIT APPLICATION

- 1) Well Operator: Murvin Oil Corporation 34050 (7) 508
- 2) Operator's Well Number: G. Baxter #1 3) Elevation: 690'
- 4) Well type: (a) Oil / or Gas X /
 (b) If Gas: Production X / Underground Storage /
 Deep / Shallow /
- 5) Proposed Target Formation(s): Gordon
- 6) Proposed Total Depth: 2400 feet
- 7) Approximate fresh water strata depths: 30', 400', 225'
- 8) Approximate salt water depths: 920', 1670-1690'
- 9) Approximate coal seam depths: 745-751', 425', 1400', 225'-228'
- 10) Does land contain coal seams tributary to active mine? Yes / No X /
- 11) Proposed Well Work: New Well Drill
- 12)

CASING AND TUBING PROGRAM

TYPE	SPECIFICATIONS			FOOTAGE INTERVALS		CEMENT
	Size	Grade	Weight per ft.	For drilling	Left in well	
Conductor	11 3/4"	F-25	38	145'	145'	38CSRB-11.3 CTS
Fresh Water	8 5/8"	H-40	23 #	925'	925'	45 38CSRB-11.2
Coal						
Intermediate						38CSRB-11.1
Production	4 1/2"	J-55	10.5 #	2400'	2400'	227
Tubing						
Liners						

RECEIVED
 APR 10 1989

PACKERS : Kind _____
 Sizes _____
 Depths set _____

DIVISION OF OIL & GAS
 DEPARTMENT OF ENERGY

For Division of Oil and Gas Use Only

5404
 Fee(s) paid: Well Work Permit Reclamation Fund WPCP
 Plat WW-9 WW-2B Bond Blanket AB Agent
 (Type)



DIVISION OF OIL & GAS³
DEPARTMENT OF ENERGY

Date: April 4, 1989
Operator's well number
G. Baxter #1
API Well No: 47 - 103 - 1458
State - County - Permit

STATE OF WEST VIRGINIA
DEPARTMENT OF ENERGY, DIVISION OF OIL AND GAS

NOTICE AND APPLICATION FOR A WELL WORK PERMIT

- 4) Surface Owner(s) to be served:
- (a) Name George Baxter
Address Route 1, Box 64
Proctor, West Virginia 26055
 - (b) Name _____
Address _____
 - (c) Name _____
Address _____
- 5) (a) Coal Operator:
Name None
Address _____
- (b) Coal Owner(s) with Declaration
Name Same as Royalty Owner
Address _____
- Name _____
Address _____
- 6) Inspector Mike Underwood
Address Route 2, Box 315
Salem, West Virginia 26426
Telephone (304)-782-1043
- (c) Coal Lessee with Declaration
Name _____
Address _____

TO THE PERSON(S) NAMED ABOVE TAKE NOTICE THAT:

 Included is the lease or leases or other continuing contract or contracts by which I hold the right to extract oil and gas OR

 X Included is the information required by Chapter 22B, Article 1, Section 8(d) of the Code of West Virginia (see page 2)

I certify that as required under Chapter 22B of the West Virginia Code I have served copies of this notice and application, a location plat, and accompanying documents pages 1 through 7 on the above named parties, by:

- Personal Service (Affidavit attached)
- X Certified Mail (Postmarked postal receipt attached)
- Publication (Notice of Publication attached)

I have read and understand Chapter 22B and 38 CSR 11-18, and I agree to the terms and conditions of any permit issued under this application.

I certify under penalty of law that I have personally examined and am familiar with the information submitted on this application form and all attachments, and that based on my inquiry of those individuals immediately responsible for obtaining the information, I believe that the information is true, accurate, and complete.

I am aware that there are significant penalties for submitting false information, including the possibility of fine and imprisonment.

Well Operator Murvin Oil Corporation
By: Gary L. Hill
Its: Executive Vice-President Gary L. Hill
Address P. O. Box 297
Olney, Illinois 62450
Telephone 618-393-2124

Subscribed and sworn before me this 4th day of April, 1989

Barbara A. Hill Notary Public
My commission expires November 8, 1991