

WW-7
8-30-06



West Virginia Department of Environmental Protection
Office of Oil and Gas
WELL LOCATION FORM: GPS

API: 47-103-02526 WELL NO.: WV 519055 (Leasure #2)

FARM NAME: Leasure

RESPONSIBLE PARTY NAME: EQT Production Company

COUNTY: Wetzel DISTRICT: Green

QUADRANGLE: Porters Falls 7.5'

SURFACE OWNER: Delbert L. Leasure

ROYALTY OWNER: Delbert Lindsay Leasure / Central Michigan Exploration LLC

UTM GPS NORTHING: 4384009

UTM GPS EASTING: 518721 GPS ELEVATION: 284 m (934 ft)

The Responsible Party named above has chosen to submit GPS coordinates in lieu of preparing a new well location plat for a plugging permit or assigned API number on the above well. The Office of Oil and Gas will not accept GPS coordinates that do not meet the following requirements:

1. Datum: NAD 1983, Zone: 17 North, Coordinate Units: meters, Altitude: height above mean sea level (MSL) – meters.
2. Accuracy to Datum – 3.05 meters
3. Data Collection Method:

Survey grade GPS _____ : Post Processed Differential _____
Real-Time Differential _____
Mapping Grade GPS X : Post Processed Differential X
Real-Time Differential _____

4. **Letter size copy of the topography map showing the well location.**

I the undersigned, hereby certify this data is correct to the best of my knowledge and belief and shows all the information required by law and the regulations issued and prescribed by the Office of Oil and Gas.

Ben R. Stahl
Signature

P.S. 2092
Title

12/30/21
Date

RECEIVED
Office of Oil and Gas
MAR 22 2022
WV Department of
Environmental Protection

04/29/2022

Topo Quad: Porters Falls 7.5'

Scale: 1" = 2000' **4710302526P**

County: Wetzel

Date: Decmeber 30, 2021

District: Green

Project No: 40-34-00-09

47-103-02526 WV 519055 (Leasure #2)

Topo

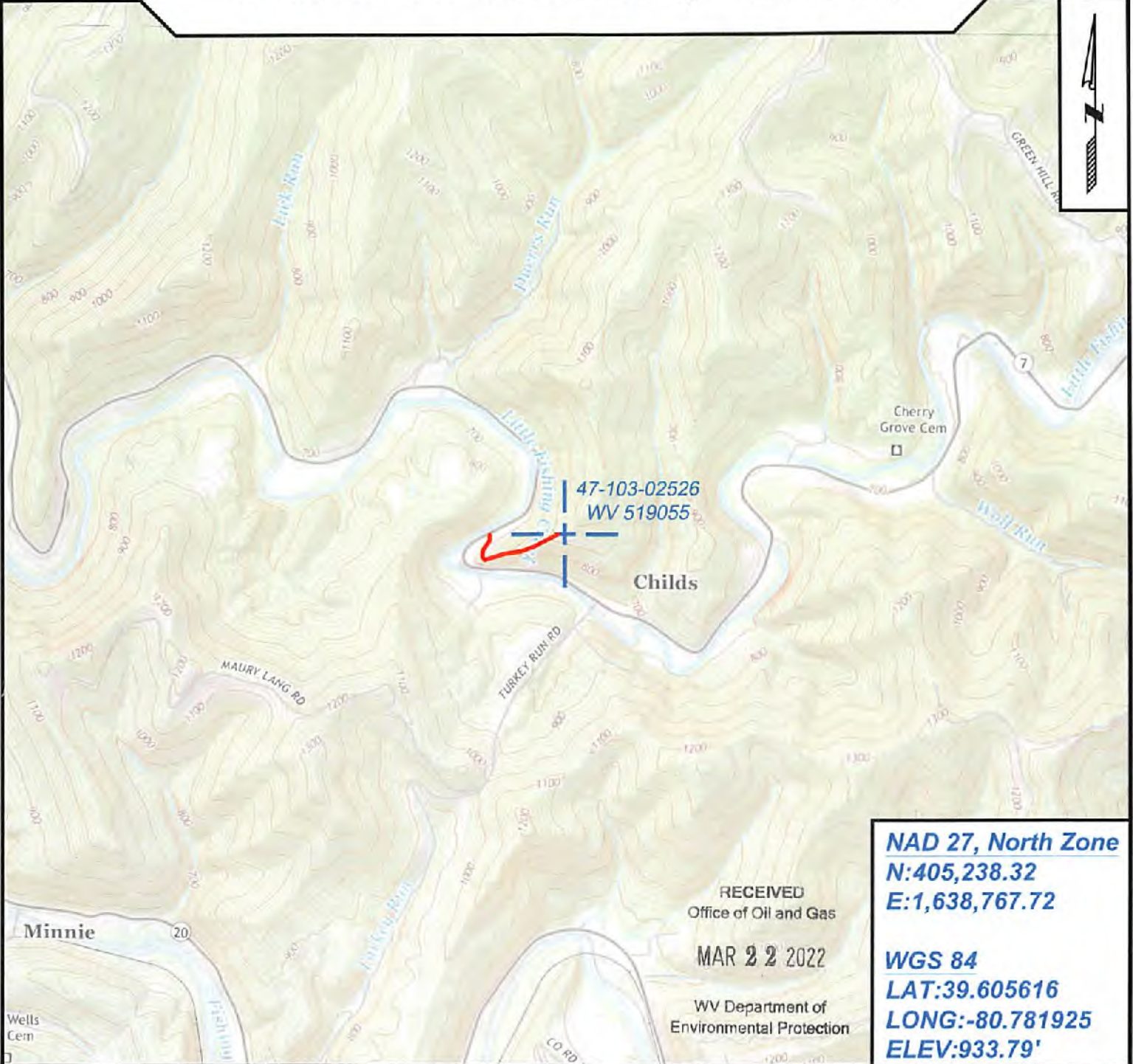

47-103-02526
WV 519055

Childs

NAD 27, North Zone
N:405,238.32
E:1,638,767.72

RECEIVED
Office of Oil and Gas

MAR 22 2022

WV Department of
Environmental Protection

WGS 84
LAT:39.605616
LONG:-80.781925
ELEV:933.79'



SURVEYING AND MAPPING SERVICES PERFORMED BY:

ALLEGHENY SURVEYS, INC.

1-800-482-8606
237 Birch River Road
Birch River, WV 26610
PH: (304) 649-8606
FAX: (304) 649-8608

PREPARED FOR:

EQT Production Company

2400 Ansys Drive
Canonsburg, PA 15317

04/29/2022