

I, the undersigned, hereby certify that this plat is correct to the best of my knowledge and belief and shows all the information required by law and the regulations issued and prescribed by the Department of Environmental Protection.

*Ben R. Singleton*  
P.S. 2092

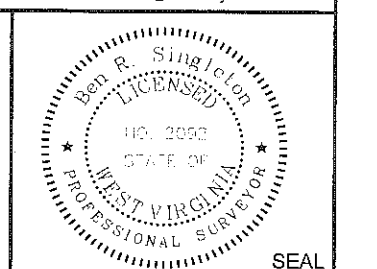

FILE NO: 145-34-G-10  
DRAWING NO: Big 176 H9  
SCALE: 1" = 1000'  
MINIMUM DEGREE OF ACCURACY: 1:2500  
PROVEN SOURCE OF ELEVATION: NGS CORS Station

**STATE OF WEST VIRGINIA**  
DEPARTMENT OF ENVIRONMENTAL PROTECTION  
**OIL AND GAS DIVISION**

DATE: October 4 20 11  
OPERATOR'S WELL NO. 513826  
API WELL NO  
47 103 02718H  
STATE COUNTY PERMIT

WELL TYPE:  OIL  GAS  LIQUID INJECTION  WASTE DISPOSAL  
(IF GAS) PRODUCTION:  STORAGE  DEEP  SHALLOW  
LOCATION: ELEVATION: 859' WATERSHED North Fork of Fishing Creek QUADRANGLE: Big Run  
DISTRICT: Grant COUNTY: Wetzel  
SURFACE OWNER: John W. and Florence E. Kilcoyne ACREAGE: 604.56  
ROYALTY OWNER: EQT Production Company, Inc. LEASE NO: 706740 ACREAGE: 1003.75  
PROPOSED WORK:  DRILL  CONVERT  DRILL DEEPER  FRACTURE OR STIMULATE  PLUG OFF OLD FORMATION  
 PERFORATE NEW FORMATION  OTHER PHYSICAL CHANGE IN WELL (SPECIFY)  
 PLUG AND ABANDON  CLEAN OUT AND REPLUG TARGET FORMATION: Marcellus ESTIMATED DEPTH: TVD=7100' MD=14,500'

WELL OPERATOR: EQT Production Company DESIGNATED AGENT: Rex C. Ray  
ADDRESS: 1710 Pennsylvania Avenue ADDRESS: 1710 Pennsylvania Avenue  
Charleston, WV 25302 Charleston, WV 25302 **03/16/2012**

WW-9

Proposed BIG 176 H9 WV 513826

47-103-01165

John W. and Florence E. Kilcoyne  
357/212  
804.56 Acres

John W. and Florence E. Kilcoyne  
357/212  
804.56 Acres

WV 513826  
BIG 176 H9

DMH  
12-22-11

MarkWest Liberty Midstream & Resources, LLC  
200 Acres

47-103-00302

ONE 620' ± @ 0.5% grade

Scale 1" = 500'



- ⊙ Denotes to install 12" minimum culvert
- ⊗ Denotes a proposed stream crossing (if applies) \*see table for culvert detail\*

Unless otherwise noted, all roads shown hereon are existing and shall be maintained in accordance with WV D.E.P., Office of Oil and Gas Erosion and Sediment Control Field Manual as revised 2/98

Entrances upon county/state roads shall be maintained in accordance with WV D.O.T. regulations, however, separate permits may be required by the WV D.O.T.

Sediment basins (traps) and appropriate erosion control barriers are to be constructed at all culverts and cross-drains as required in the aforementioned Erosion and Sediment Control Field Manual. Where field conditions dictate, alternative erosion control measures shall be enacted as required.

Earthwork contractors are responsible for notification to the operator and inspector prior to any deviation from this plan.

Temporary seed and mulch all slopes after construction of location.

Cut and stack all marketable timber.

Stacked brush may be used for sediment control.

Applications for separate Public Land Corporation Permits on the access roads stream crossings have been prepared (if applies).

Additional culverts and/or other drainage structures and sediment control devices may be required by the WV D.E.P. Oil & Gas Inspector.

Operator is responsible for the coordination with contractor and Allegheny Surveys regarding any changes or additions the state may require

Proposed Well # WV 513826  
Location Detail BIG 176 H9

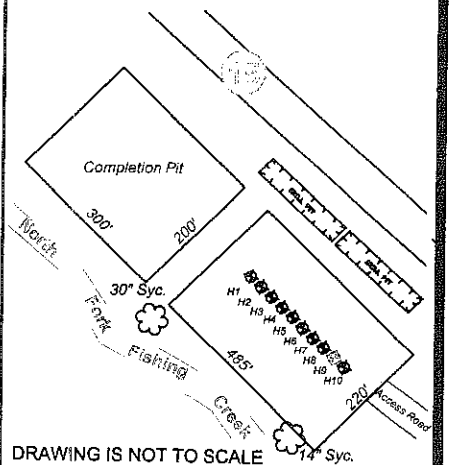

SECTION 5 OF THE BIG RUN 7.5' USGS QUADRANGLE	
Projected culvert inventory. (for bid purposes only)	
12" minimum diameter culverts	1 Culverts
36" minimum diameter culverts	1 Culverts

DRAWN BY: Jason Gravley      DATE: October 7, 2011      FILE NO. 145-34-G-10      DRAWING FILE NO. Big 176 H9 Rec



**SURVEYING AND MAPPING SERVICES PERFORMED BY:**  
**ALLEGHENY SURVEYS, INC.**  
1-800-482-8606  
Birch River Office      237 Birch River Road  
Phone: (304) 649-8606      P.O. Box 438  
Fax: (304) 649-8608      Birch River, WV 26610

- PROPERTY BOUNDARY
- ROAD
- DITCH
- SILT FENCE
- PROPOSED WELL LOCATION
- BROAD BASED DIP
- EXISTING GATE
- EXISTING CULVERT
- PROPOSED CULVERT
- CROSS DRAIN
- PIT-CUT WALLS
- PIT-COMPACTED WALLS
- AREA OF LAND APPLICATION OF PIT WASTE

03/16/2012