

(BOTTOM HOLE: 80°39'31.3")

LON: -80°40'35.2"

2755'

LAT: 39°37'30"

# MAP OF H.G. ENERGY, LLC -LONG 408 UNIT-

1 - Well ties and Latitude and Longitude were measured by DGPS (Sub-meter Mapping Grade). Bearings are referenced to UTM Grid North (Zone 17 North - NAD 1927).

2 - Surface owners and adjacent information obtained from the Wetzel County Assessor's tax records.

3 - No Title Opinion was provided to the Surveyor during this survey. This survey is subject to a complete Title Opinion.

UTM Coordinates (Zone 17N-NAD 1983)	
Surface	N-4,381,587m. E-527,801m.
Bottom Hole	N-4,380,416m. E-529,330m.

LOCATION REFERENCES	
NAD 1983	N 50°13' E 234' SPIKE S 66°10' E 174' SPIKE

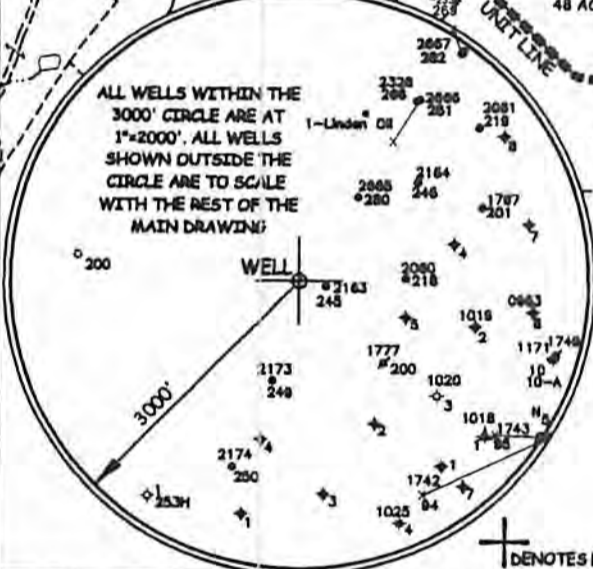
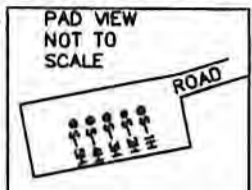

⊕ DENOTES LOCATION OF WELL ON U.S. TOPO MAPS.

JOB # 12-025  
 DRAWING # 12HG4001FOLDER  
 SCALE 1" = 1500'  
 MINIMUM DEGREE OF ACCURACY SUB-METER  
 PROVEN SOURCE OF ELEV. SUBMETER MAPPING GRADE GPS

I, THE UNDERSIGNED, HEREBY CERTIFY THAT THIS PLAT IS CORRECT TO THE BEST OF MY KNOWLEDGE AND BELIEF AND SHOWS ALL THE INFORMATION REQUIRED BY LAW AND THE REGULATIONS ISSUED AND PERSCRIBED BY THE DEPARTMENT OF ENVIRONMENTAL PROTECTION.



**WEST VIRGINIA DEPARTMENT OF ENVIRONMENTAL PROTECTION OFFICE OF OIL AND GAS**

**MOODY LAND SURVEYING, LLC**  
 ST. MARYS, WV 26170

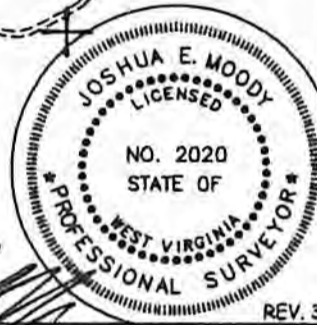

WEST VIRGINIA DEPARTMENT OF ENVIRONMENTAL PROTECTION OFFICE OF OIL AND GAS

JOSHUA E. MOODY, P.S. 2020  
 DATE 12/08/14  
 OPERATOR'S WELL # 408 S-1H

WELL TYPE: OIL  GAS  LIQUID INJECTION  WASTE DISPOSAL  HORIZONTAL   
 (IF "GAS") PRODUCTION  STORAGE  DEEP  SHALLOW   
 LOCATION: ELEVATION 1340' WATERSHED NORTH FOR, FISHING CREEK API WELL # 47-103-0288746A  
 DISTRICT GRANT COUNTY WETZEL STATE 47 COUNTY 103 PERMIT 0288746A  
 QUADRANGLE PINE GROVE 7.5'

SURFACE OWNER FRANCIS D. & FREEDA M. BROWN (surface hole) ACREAGE 103 ACRES +/-  
 OIL & GAS ROYALTY OWNER ROBERT B. MYERS ET AL LEASE ACREAGE 514.72 ACRES +/-  
 PROPOSED WORK: DRILL  CONVERT  DRILL DEEPER  REDRILL  FRACTURE OR STIMULATE  PLUG OFF OLD FORMATION  PERFORATE NEW FORMATION   
 OTHER PHYSICAL CHANGE IN WELL (SPECIFY) AS DRILLED LOCATION  
 PLUG & ABANDON  CLEAN OUT & REPLUG   
 TARGET FORMATION MARCELLUS ESTIMATED DEPTH TVD= 7,337.34' MD= 13,268'  
 WELL OPERATOR H.G. ENERGY, LLC DESIGNATED AGENT DIANE WHITE  
 ADDRESS 5260 DuPONT ROAD ADDRESS 5260 DuPONT ROAD  
PARKERSBURG, WV 26101 PARKERSBURG, WV 26101

LON: 80°40'00" LAT: 39°35'00.5" (BOTTOM HOLE: 39°34'22.3")