

**WV 514496**  
**EQT Production Company**  
**L.G. Robinson et. vir. Lease**  
**2600 Acres**

9932'  
 LATITUDE 39 - 30 - 00

LONGITUDE 80 - 27 - 30  
 7066'

- Folsom 109**
- H1, 514495
  - H2, 514496
  - H3, 514497
  - H4, 514498
  - H5, 514499
  - H6, 514500
  - H7, 514552
  - H8, 514553
  - H9, 514554
  - H10, 514555
  - H11, 515487
  - H12, 515488
  - H13, 515489
  - H14, 515490
  - H15, 515491
  - H16, 515492

- ⊙ Proposed Gas Well
- Located Corner, as noted
- Surface Tract Lines
- Reference Line
- Lease Boundary
- Creek or Drain
- 5 WV County Route
- 5 WV State Route

GRID NORTH

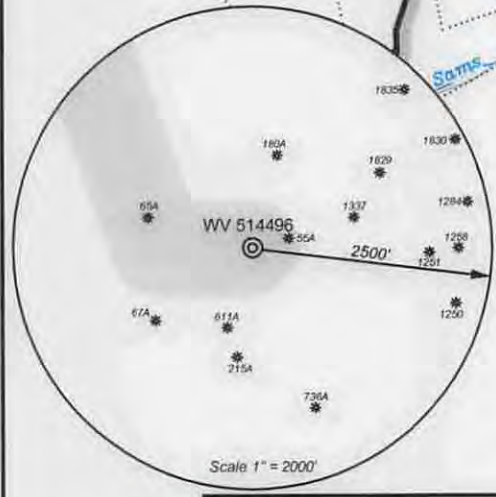

**WV 514496 coordinates:**  
 NAD 27 N: 358,730.84 E: 1,719,557.00  
 NAD 27 Lat: 39.480670 Long: -80.493564  
 NAD 83 UTM N: 4,370,251.13 E: 543,571.00  
**WV 514496 Landing Point coordinates:**  
 NAD 27 N: 358,730.30 E: 1,718,580.87  
 NAD 27 Lat: 39.480638 Long: -80.497023  
 NAD 83 UTM N: 4,370,246.01 E: 543,273.55  
**WV 514496 Bottom Hole coordinates:**  
 NAD 27 N: 361,603.35 E: 1,717,534.97  
 NAD 27 Lat: 39.488494 Long: -80.500841  
 NAD 83 UTM N: 4,371,115.99 E: 542,940.37

West Virginia Coordinate System of 1927 (North Zone) based upon Differential GPS Measurements.  
 Plat orientation, corner and well ties are based upon the grid north meridian.  
 Well location references are based upon the grid north meridian.  
 UTM coordinates are NAD83, Zone 17, Meters.

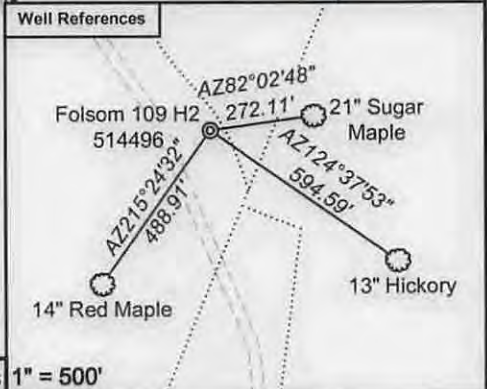

(⊙) Denotes Location of Well on United States Topographic Maps 1" = 500'



*I, the undersigned, hereby certify that this plat is correct to the best of my knowledge and belief and shows all the information required by law and the regulations issued and prescribed by the Department of Environmental Protection.*

*Ben R. Singleton*  
 P.S. 2092



FILE NO: 165-13  
 DRAWING NO: Folsom 109 H2  
 SCALE: 1" = 2000'  
 MINIMUM DEGREE OF ACCURACY: 1:2500  
 PROVEN SOURCE OF ELEVATION: NGS CORS Station

**STATE OF WEST VIRGINIA**  
 DEPARTMENT OF ENVIRONMENTAL PROTECTION  
**OIL AND GAS DIVISION**

DATE: February 2 20 15  
 OPERATOR'S WELL NO. 514496  
 API WELL NO. **H64**  
 47 - 103 - **03075**  
 STATE COUNTY PERMIT

WELL TYPE:  OIL  GAS  LIQUID INJECTION  WASTE DISPOSAL  
 (IF GAS) PRODUCTION:  STORAGE  DEEP  SHALLOW  
 LOCATION: ELEVATION: Original 1501 Proposed 1460 WATERSHED Sams Run of Fishing Creek QUADRANGLE: Wallace  
 DISTRICT: Grant COUNTY: Wetzel  
 SURFACE OWNER: Consolidation Coal Company ACREAGE: 175  
 ROYALTY OWNER: Ed Broome, Inc. et. al. LEASE NO: 713351 ACREAGE: 2600  
 PROPOSED WORK:  DRILL  CONVERT  DRILL DEEPER  FRACTURE OR STIMULATE  PLUG OFF OLD FORMATION  
 PERFORATE NEW FORMATION  OTHER PHYSICAL CHANGE IN WELL (SPECIFY)  
 PLUG AND ABANDON  CLEAN OUT AND REPLUG TARGET FORMATION: Marcellus ESTIMATED DEPTH: TVD 7828

WELL OPERATOR: EQT Production Company DESIGNATED AGENT: Rex C. Ray  
 ADDRESS: 115 Professional Place PO Box 280 Bridgeport, WV 26330  
 ADDRESS: 115 Professional Place PO Box 280 Bridgeport, WV 26330

07/03/2015

Topo Quad: Wallace 7.5' Scale: 1" = 2000'  
 County: Wetzel Date: November 25, 2014  
 District: Grant Project No: 165-34-00-13

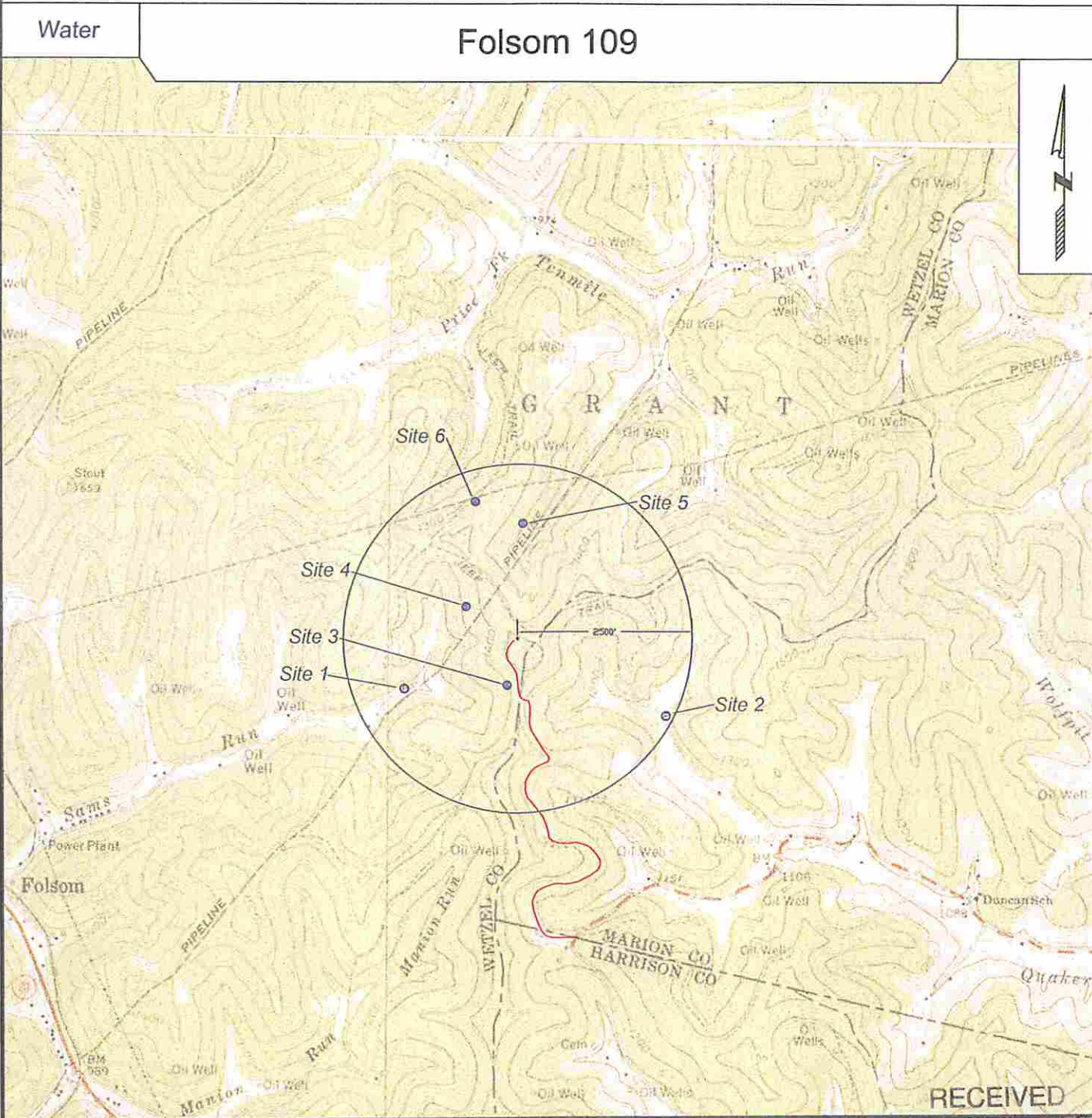

SURVEYING AND MAPPING SERVICES PERFORMED BY:  
**ALLEGHENY SURVEYS, INC.**  
 1-800-482-8606  
 237 Birch River Road  
 Birch River, WV 26610  
 PH: (304) 649-8606  
 FAX: (304) 649-8608

PREPARED FOR: **Office of Oil and Gas**  
**EQT Production Company**  
 P.O. Box 280  
 Bridgeport, WV 26330  
 WV Department of Environmental Protection

RECEIVED

07/03/2015