

RETTEW

RETTEW Associates, Inc.
27 Travata Street, Suite 101
Bridgeport, WV 26330
Phone: (800) 738-8395
Email: rettew@rettew.com
Website: www.rettew.com

SURFACE HOLE LOCATION (SHL):

UTM (NAD83, ZONE 17, METERS):
NORTHING: 4,390,725.031
EASTING: 528,025.402

"LANDING POINT" LOCATION (LPL):

UTM (NAD83, ZONE 17, METERS):
NORTHING: 4,390,756.362
EASTING: 527,986.793

BOTTOM HOLE LOCATION (BHL):

UTM (NAD83, ZONE 17, METERS):
NORTHING: 4,391,663.531
EASTING: 526,907.451

GRID NORTH
UTM, NAD83 DATUM, ZONE 17, US FT

LINE	DESCRIPTION	DISTANCE	DESCRIPTION
L1	N 18°54'36" E	1,221'	SHL TO LANDMARK
L2	S 64°09'25" E	1,171'	SHL TO LANDMARK
L3	S 19°31'32" E	1,441'	SHL TO LANDMARK
L4	N 50°16'34" W	1,768'	ASDRILLED BORE
L5	N 49°38'26" W	854'	ASDRILLED BORE
L6	N 49°26'13" W	1,137'	ASDRILLED BORE
L7	N 50°16'52" W	867'	ASDRILLED BORE
L8	N 49°57'13" W	4,626'	LPL TO BHL
L9	N 43°59'57" E	23'	SHL TO REF. PNT.
L10	N 59°00'51" W	175'	SHL TO REF. PNT.

TRACT	SURFACE OWNER (S) / ROYALTY OWNER (R)	TAX PARCEL	ACRES
1	RIDGETOP CAPITAL LP. (S)	12-14-25	±173.00
2	JAMES & JORETTA RITCHEA (S)	12-14-4	±62.11
3	SHERAL ALAN YOCUM (S)	12-14-22.4	±2.38
4	CHESAPEAKE APPALACHIA, LLC (S)	12-14-13	±85.30

Latitude: 39°40'00" SHL

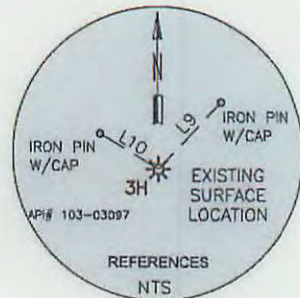

Longitude: 80°40'00"

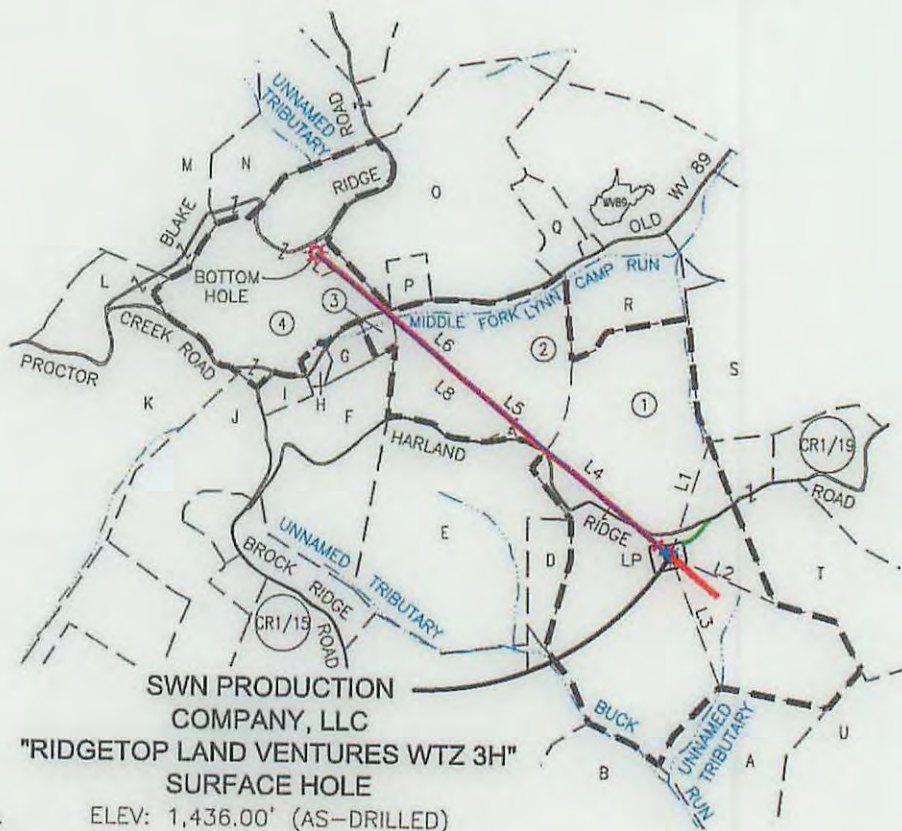
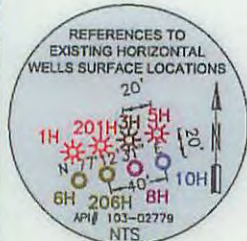

NOTES ON SURVEY

- COORDINATES SYSTEM IS UTM, NAD 83 DATUM, ZONE 17, U.S. FOOT AND WELL COORDINATES ESTABLISHED USING SURVEY GRADE GPS.
- SURFACE AND ROYALTY OWNER INFORMATION AND THEIR BOUNDARIES SHOWN HEREON WERE PLOTTED FROM DEEDS AND/OR TAX PARCEL MAPS PROVIDED BY CLIENT AND FIELD LOCATIONS.
- THIS PLAT DOES NOT REPRESENT A BOUNDARY SURVEY OF THE PARCELS SHOWN HEREON.
- NO DWELLINGS AND BUILDINGS WITHIN 625 FEET OF PROPOSED CENTER OF PAD.
- NO WATER WELLS OR DEVELOPED SPRINGS WITHIN 250 FEET OF PROPOSED WELL.
- NO PERENNIAL STREAMS, LAKES, PONDS, RESERVOIRS OR WETLANDS WITHIN 100 FEET OF THE LIMITS OF DISTURBANCE.
- NO NATURALLY PRODUCING TROUT STREAM WITHIN 300 FEET OF LIMITS OF DISTURBANCE.

I, THE UNDERSIGNED, HEREBY CERTIFY THAT THIS PLAT IS CORRECT TO THE BEST OF MY KNOWLEDGE AND BELIEF AND SHOWS ALL THE INFORMATION REQUIRED BY LAW AND REGULATIONS ISSUED AND PRESCRIBED BY THE DEPARTMENT OF ENVIRONMENTAL PROTECTION.

P.S. 2313



AS-DRILLED

ADJOINING OWNER INFORMATION
(SEE ADJOINING OWNER SHEET)

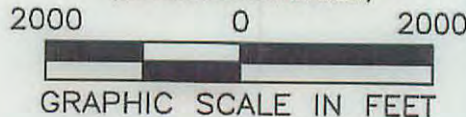

COMPANY:
SWN **SWN** ^{R/V}/_A
Production Company, LLC Production Company™

RIDGETOP LAND VENTURES WTZ
OPERATOR'S WELL #: 3H
API WELL #: 47 103 03097
STATE COUNTY PERMIT

(+) DENOTES LOCATION OF WELL ON UNITED STATES TOPOGRAPHIC MAPS
WVDEP
OFFICE OF OIL & GAS
601 57TH STREET
CHARLESTON, WV 25034

MINIMUM DEGREE OF ACCURACY: 1/200
PROVEN SURVEY SOURCE OF GRADE GPS ELEVATION: (NAVD 88, US FT)

WELL TYPE: OIL WASTE DISPOSAL PRODUCTION DEEP GAS LIQUID INJECTION STORAGE SHALLOW
 WATERSHED: LITTLE FISHING CREEK ELEVATION: 1,436.00' (AS-DRILLED)
 DISTRICT: PROCTOR COUNTY: WETZEL QUADRANGLE: WILEYVILLE, WV
 SURFACE OWNER: RIDGETOP CAPITAL, LP ACREAGE: ±173.00
 OIL & GAS ROYALTY OWNER: RIDGETOP CAPITAL, LP ACREAGE: ±173.00
 DRILL DRILL DEEPER REDRILL FRACTURE OR STIMULATE PLUG OFF OLD FORMATION PERFORATE NEW FORMATION
 CONVERT PLUG & ABANDON CLEAN OUT & REPLUG OTHER CHANGE (SPECIFY) AS-DRILLED
 TARGET FORMATION: MARCELLUS ESTIMATED DEPTH: 7,404' TVD 12,607' TMD

WELL OPERATOR: SWN PRODUCTION COMPANY, LLC DESIGNATED AGENT: DEE SOUTHALL
 ADDRESS: P.O. BOX 1300 ADDRESS: P.O. BOX 1300
 CITY: JANE LEW STATE: WV ZIP CODE: 26378 CITY: JANE LEW STATE: WV ZIP CODE: 26378

LEGEND:	REVISIONS:	DATE:
○ PROPOSED SURFACE HOLE / BOTTOM HOLE	△ ADDED PROPOSED LATERAL 11-05-2015	10-26-2015
★ EXISTING / PRODUCING WELLHEAD	△ REMOVE 500' BUFFER FROM LEGEND 11-16-2015	
⊗ ABANDONED WELL		
⊗ PLUGGED & ABANDONED WELL		
△ CUT CONDUCTOR		
— PROPOSED DHP		
--- TIE LINE		
--- LEASE BOUNDARY		
--- AS-DRILLED DHP		
--- ABANDONED PATH		
		DRAWN BY: J. ROSS
		SCALE: 1" = 2000'
		DRAWING NO: 087569007
		WELL LOCATION PLAT