

TOP HOLE (UTM NAD 83)  
 N) 4370065.4  
 E) 526113.4

BOTTOM HOLE (UTM NAD 83)  
 N) 4368285.7  
 E) 526741.2

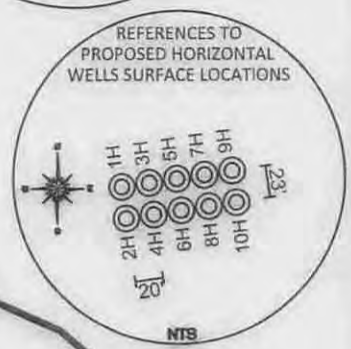
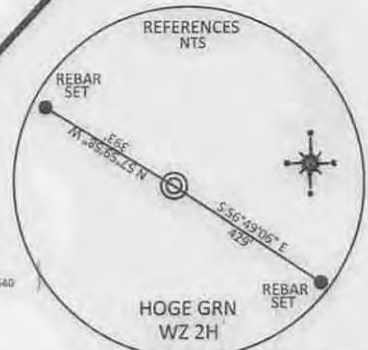
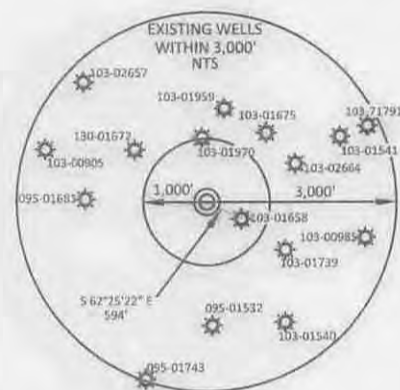

REFERENCE NOTES  
 Boundaries as shown taken from deeds, tax maps and field locations. A full boundary survey is not expressed nor implied. All bearings are based on true north. Ownership taken from public records Wetzell County, West Virginia JANUARY 2015  
 State Plane Coordinates & NAD 83 Lat/Long by differential submeter mapping grade GPS  
 Drafted by EAM

NO DWELLINGS FOUND WITHIN 650' OF THE CENTER OF THE WELL PAD  
 NO WATER WELLS FOUND WITHIN 250' OF THE CENTER OF WELL PAD

FILE #: AE004  
 DRAWING #: 2512  
 SCALE: PLAT - 1" = 1400'  
 TICK MARK - 1" = 2000'

MINIMUM DEGREE OF ACCURACY: 1/200

PROVEN SOURCE OF ELEVATION: SUBMETER MAPPING GRADE GPS

I, THE UNDERSIGNED, HEREBY CERTIFY THAT THIS PLAT IS CORRECT TO THE BEST OF MY KNOWLEDGE AND BELIEF AND SHOWS ALL THE INFORMATION REQUIRED BY LAW AND THE REGULATIONS ISSUED AND PRESCRIBED BY THE DEPARTMENT OF ENVIRONMENTAL PROTECTION.

Signed: *[Signature]*  
 L.L.S. #2124 : Ernest J. Benchek III



(+) DENOTES LOCATION OF WELL ON UNITED STATES TOPOGRAPHIC MAPS WVDEP  
 OFFICE OF OIL & GAS  
 601 57TH STREET  
 CHARLESTON, WV 25304

Well Type:  Oil  Waste Diposal  Production  Deep  
 Gas  Liquid Injection  Storage  Shallow

WATERSHED: FISHING CREEK  
 COUNTY/DISTRICT: WETZEL / GREEN  
 SURFACE OWNER: STATE OF WV PUBLIC LD CORP. DEPT. OF COMM. LBR & ENVR. DNR  
 OIL & GAS ROYALTY OWNER: STATE OF WV PUBLIC LD CORP. DEPT. OF COMM. LBR & ENVR. DNR  
 LEASE NUMBERS:

TARGET FORMATION: MARCELLUS  
 WELL OPERATOR: American Energy - Marcellus LLC  
 ADDRESS: 3501 NW 63rd Street  
 CITY: Oklahoma City STATE: OK ZIP CODE: 73116

DATE: MAY 19, 2015

OPERATOR'S WELL #: HOGES GRN WZ 2H

API WELL #: 47 103 03124 H6A  
 STATE COUNTY PERMIT

ELEVATION: 1,380' = Current  
 1,372.40' = Proposed

QUADRANGLE: CENTER POINT, WV  
 ACREAGE: 100.00 +/-  
 ACREAGE: 606.43 +/-

DRILL  CONVERT  DRILL DEEPER  REDRILL  FRACTURE OR STIMULATE   
 PLUG OFF FORMATION  PERFORATE NEW FORMATION  PLUG & ABANDON   
 CLEAN OUT & REPLUG  OTHER CHANGE  (SPECIFY):

ESTIMATED DEPTH: TVD: 7,342' TMD: 13,500'  
 DESIGNATED AGENT: Eric B. Gillespie  
 ADDRESS: 103 Taryn Lane  
 CITY: Cross Lanes STATE: WV ZIP CODE: 25313

07/24/2015

10303124

WELL NAME: HOGE S GRN WZ 2H  
QUAD: CENTER POINT, WV

RECEIVED  
Office of Oil and Gas  
JUN 18 2015  
WV Department of  
Environmental Protection

GREEN

M C E L R O Y

HOGE S GRN WZ 2H  
ELEVATION: 1,380

Stringtown  
(Alvy PO)

07/24/2015

TYLER CO  
GODDRIDGE CO

