

Latitude 39° 30'

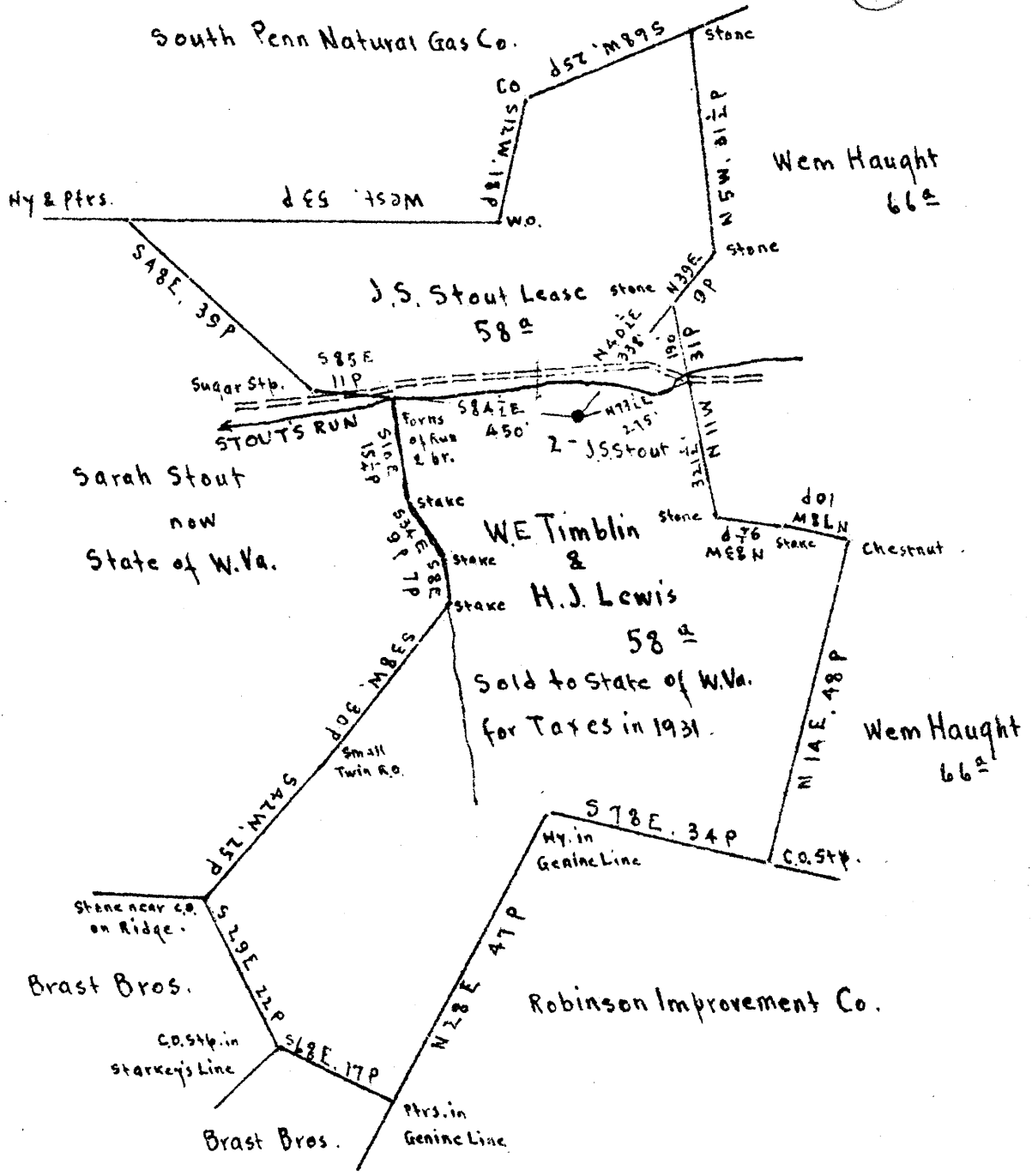

Longitude 80° 30'

Scale, 1" = 400 Feet



Surface: State of W.Va.
 Coal: State of W.Va.

New Location
 Drill Deeper
 Abandonment

MAY 21 1946

Handwritten notes:
 1132 W
 200 57 X

Company Road Supply Co.
 Address Salem, W.Va.
 Farm J.S. Stout
 Tract _____ Acres 58 Lease No. _____
 Well (Farm) No. 2 Serial No. _____
 Elevation (Spirit Level) _____ Floor - 1013.26
 _____ Ground - 1012.26
 Quadrangle GENTERPOINT
 County Wetzel District Grant
 Engineer E.C. Tabler
 Engineer's Registration No. _____
 File No. _____ Drawing No. _____
 Date Feb. 26th, 1946 Scale 1" = 400 Feet

STATE OF WEST VIRGINIA
 DEPARTMENT OF MINES
 OIL AND GAS DIVISION
 CHARLESTON

WELL LOCATION MAP
 FILE NO. WET-529-A

+ Denotes location of well on United States Topographic Maps, scale 1 to 62,500, latitude and longitude lines being represented by border lines as shown.
 - Denotes one inch spaces on border line of original tracing.

Latitude

+

0.745

1.33w

Longitude

Topo Location

7.5' Loc. _____ **15' Loc.** _____
_____ (calc.) _____

#208 MTW Co. Rep. 1909

Company South Penn

Farm JS Stout #2

15' Quad _____
(sec.)

7.5' Quad Folsom

District Grant

WELL LOCATION PLAT

County 103 **Permit** 70471



STATE OF WEST VIRGINIA
DEPARTMENT OF MINES
OIL AND GAS DIVISION

991

WELL RECORD

Permit No. 579-A

Oil or Gas Well X (KIND)

Company RAAD SUPPLY COMPANY
Address 184 East Main St., Salem, W.Va.
Farm J. S. Stout Acres 58
Location (waters) Stouts Run
Well No. 2 Elev. 1012.26
District Grant County Wetzel
The surface of tract is owned in fee by STATE OF W.VA.
Address _____
Mineral rights are owned by STATE OF W. VA.
Address _____

Casing and Tubing	Used in Drilling	Left in Well	Packers
Size			
16			Kind of Packer _____
13			
10	378'	None	Size of _____
8 1/4	1514'	None	
6 5/8	1816'	1816'	Depth set _____
5 3/16	2332'	2332'	
3			Perf. top _____
2	2773'	2773'	Perf. bottom _____
Liners Used			Perf. top _____
			Perf. bottom _____

Drilling commenced _____
Drilling completed June 17, 1898
Date Shot ? From 2957' To 2960'
With Shot 6 times-16-30-40-60-120&180 Qts.
Open Flow /10ths Water in _____ Inch
/10ths Merc. in _____ Inch
Volume _____ Cu. Ft.
Rock Pressure _____ lbs. _____ hrs.
Oil _____ bbls., 1st 24 hrs.
Fresh water _____ feet _____ feet
Salt water _____ feet _____ feet

CASING CEMENTED No SIZE _____ No. Ft. _____ Date _____
COAL WAS ENCOUNTERED AT 831 FEET 60 INCHES
_____ FEET _____ INCHES FEET _____ INCHES
_____ FEET _____ INCHES FEET _____ INCHES

Formation	Color	Hard or Soft	Top	Bottom	Oil, Gas or Water	Depth Found	Remarks
Conductor			16'				
Pittsburgh Coal			825	831'			
Dunkard Sand			1325	1350			
Salt Sand			1700	1809			
Big Lime			2036	2143			
Pencil cave			2030	2036			
Big Injun Sand			2143	2263			
Oil			2223		Oil		
Gantz Sand			2880	2900			
Fifty Foot Sand			2825	2855			
Stray Sand			2915				
Gordon Sand			2953	2965			
Gas & show oil			2918	2929	Gas, Oil		
Oil			2965		Oil		
Oil			2954	2960	Oil		
Total Depth			2973				

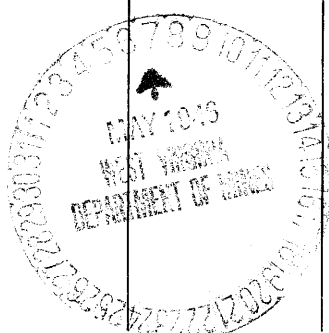

Formation	Color	Hard or Soft	Top	Bottom	Oil, Gas or Water	Depth Found	Remarks

Date May 6, 1946

APPROVED RAAD SUPPLY COMPANY, Owner

By G. M. Road
 Manager, Owner (Title)

