

*I, the undersigned, hereby certify that this plat is correct to the best of my knowledge and belief and shows all the information required by law and the regulations issued and prescribed by the Department of Environmental Protection.*

*Ben R. Singleton*

P.S. 2092

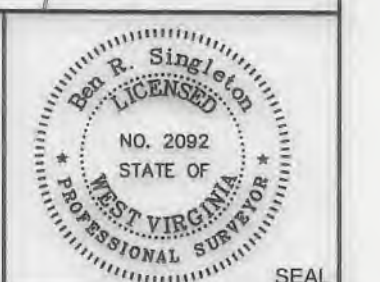

FILE NO: 208-19  
 DRAWING NO: Sizemore 5H  
 SCALE: 1" = 2000'  
 MINIMUM DEGREE OF ACCURACY: 1:2500  
 PROVEN SOURCE OF ELEVATION: NGS CORS Station

**STATE OF WEST VIRGINIA**  
 DEPARTMENT OF ENVIRONMENTAL PROTECTION  
**OIL AND GAS DIVISION**

DATE: May 28 20 20  
 OPERATOR'S WELL NO.: Sizemore 5H  
 API WELL NO ~~164~~  
 47 - 103 - 03346  
 STATE COUNTY PERMIT

WELL TYPE:  OIL  GAS  LIQUID INJECTION  WASTE DISPOSAL  
 (IF GAS) PRODUCTION:  STORAGE  DEEP  SHALLOW  
 LOCATION: ELEVATION: 1148' WATERSHED Tributary of Sugar Run QUADRANGLE: Littleton  
 DISTRICT: Center COUNTY: Wetzel  
 SURFACE OWNER: Anthony W. & Kimberly A. Sizemore ACREAGE: 75.36  
 ROYALTY OWNER: Anthony W. Sizemore LEASE NO: 870171 ACREAGE: 75.36  
 PROPOSED WORK:  DRILL  CONVERT  DRILL DEEPER  FRACTURE OR STIMULATE  PLUG OFF OLD FORMATION  
 PERFORATE NEW FORMATION  OTHER PHYSICAL CHANGE IN WELL (SPECIFY)  
 PLUG AND ABANDON  CLEAN OUT AND REPLUG TARGET FORMATION: Marcellus ESTIMATED DEPTH: 7,335'

WELL OPERATOR: EQT Production Company DESIGNATED AGENT: Joseph C. Mallow  
 ADDRESS: 400 Woodcliff Drive ADDRESS: 115 Professional Place PO Box 280  
 Canonsburg, PA 15317 Bridgeport, WV 26330



**Sizemore 5H  
LIT51  
EQT Production Company**

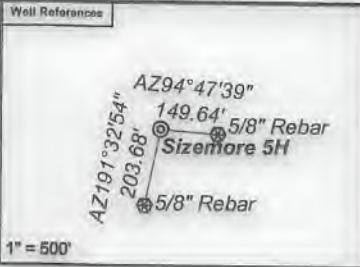

**Notes:**  
Sizemore 5H coordinates are  
NAD 27 N: 418,959.33 E: 1,710,207.25  
NAD 27 Lat: 39.645728 Long: -80.529130  
NAD 83 UTM N: 4,388,552.94 E: 540,416.88  
Sizemore 5H Landing Point coordinates are  
NAD 27 N: 417,591.03 E: 1,708,284.36  
NAD 27 Lat: 39.641911 Long: -80.535902  
NAD 83 UTM N: 4,388,126.27 E: 539,837.98  
Sizemore 5H Bottom Hole coordinates are  
NAD 27 N: 420,075.13 E: 1,705,691.62  
NAD 27 Lat: 39.648648 Long: -80.545211  
NAD 83 UTM N: 4,388,869.87 E: 539,035.45  
West Virginia Coordinate system of 1927 (North Zone)  
based upon Differential GPS Measurements.  
Plat orientation, corner and well ties are based upon  
the grid north meridian.  
Well location references are based upon the grid north  
meridian.  
UTM coordinates are NAD83, Zone 17, Meters.

Tract I.D.	Tax Map No.	Parcel No.	County	District	Surface Tract Owner	Acres
1	16	9	Wetzel	Center	Anthony Sizemore	75.36
2	16	8	Wetzel	Center	Larry D. Roberts	44.50
3	16	6	Wetzel	Center	Marilyn E. Thomas	70.97
4	12	0	Wetzel	Center	Nancy E. Jolliffe	44.77
5	12	18	Wetzel	Center	Homer L. Patricia J. Hostutler	3.46
6	12	16	Wetzel	Center	Nancy E. Jolliffe	308.81
7	12	10	Wetzel	Center	Florine Huggins	50.00
8	16	32	Wetzel	Center	Gertrude Teagarden, et al.	4.50
9	12	9	Wetzel	Center	Nancy E. Jolliffe	44.77
10	12	8	Wetzel	Center	Nancy E. Jolliffe	20.25
11	16	30	Wetzel	Center	Gertrude Teagarden, et al.	4.00
12	11	10	Wetzel	Center	Howard M. Henderson	49.00
13	11	9	Wetzel	Center	Howard M. Henderson	10.10
14	8	43	Wetzel	Center	Howard M. Henderson	112.00
15	17	9.1	Wetzel	Center	Jefferson Little, et al.	2.03
16	16	10.1	Wetzel	Center	Ray & Cassandra Blansking	5.72
17	16	12	Wetzel	Center	Thomas Jones, et al.	34.20
18	16	11	Wetzel	Center	Earl Null, et al.	20.00
19	16	33	Wetzel	Center	Anthony W. & Kimberly A. Sizemore	20.64
20	16	31	Wetzel	Center	Devona D. & Kelly M. Reed	18.25
21	16	28	Wetzel	Center	William J. Morris Revocable Trust	93.25
22	12	31	Wetzel	Center	John S. Starkey, et al.	22.50
23	16	8	Wetzel	Center	Marilyn E. Thomas	70.97
24	16	29	Wetzel	Center	Devona D. & Kelley M. Reed	20.25
25	16	47	Wetzel	Center	Mary V. Simpson	38.25
26	12	10.1	Wetzel	Center	Nancy E. Jolliffe	0.71
27	11	11	Wetzel	Center	Nancy E. Jolliffe	59.75
28	16	44	Wetzel	Center	Paul E. & Cecilia M. Wendt	23.00
29	16	43	Wetzel	Center	Stephen W. Hill, et al.	22.00
30	16	26	Wetzel	Center	John K. Parsinger	12.00
31	16	76	Wetzel	Center	John K. Parsinger	5.00
32	16	27	Wetzel	Center	William J. Morris Revocable Trust	16.50
33	16	5	Wetzel	Center	Shaun D. & Tamra M. Kuhn	48.00
34	12	17	Wetzel	Center	Parzy O. Rice	67.50
35	16	2	Wetzel	Center	Trevor G. Hostutler, et al.	21.50
36	16	1	Wetzel	Center	Steven P. & Brenda L. Sams	9.25
37	16	13.1	Wetzel	Center	Edward A. Glaser	15.50
38	16	27.1	Wetzel	Center	Harry & Marilyn Kennedy	61.31
39	16	26	Wetzel	Center	Thomas Moore, et al.	50.90
40	15	7	Wetzel	Center	Steven P. & James R. Barbe	90.00
41	15	7.1	Wetzel	Center	Steven P. & James R. Barbe	81.75
42	11	42	Wetzel	Center	Nicole J. & Ted J. Yowonske	128.40
43	11	41	Wetzel	Center	Nancy E. Jolliffe	47.07
44	11	27	Wetzel	Center	Nancy E. Jolliffe	47.50
45	16	5.1	Wetzel	Center	Nancy E. Jolliffe	3.00
46	11	25	Wetzel	Center	James B. & Margie L. Montgomery	15.00
47	8	54	Wetzel	Center	Howard M. Henderson	10.00
48	8	47	Wetzel	Center	Howard M. Henderson	14.75
49	11	26	Wetzel	Center	Nancy E. Jolliffe	43.00
50	8	55	Wetzel	Center	Ashley Murphy, et al.	9.43
51	8	44	Wetzel	Center	William D. Henderson	65.00
52	11	23	Wetzel	Center	James B. & Margie L. Montgomery	40.00
53	11	8	Wetzel	Center	James B. & Margie L. Montgomery	52.00
54	11	8	Wetzel	Center	Ray B. & Timmy R. Sapp	90.50
55	8	29	Wetzel	Center	Howard M. & William D. Henderson	57.00
56	11	6.1	Wetzel	Center	Larry L. & Lois J. Deam	94.50
57	16	0.1	Wetzel	Center	Nancy E. Jolliffe	1.03
58	12	20	Wetzel	Center	Nancy E. Jolliffe	2.27
59	12	19.2	Wetzel	Center	Marilyn E. Thomas	1.23
60	8	42	Wetzel	Center	Jeffrey P. & Howard M. Henderson	67.00
61	10	3	Wetzel	Center	Kimberly H. McMillit	0.50
62	16	4	Wetzel	Center	Nancy E. Jolliffe	1.20
63	10	1.1	Wetzel	Center	Mt. Zion Baptist Church	0.50
64	16	82	Wetzel	Center	Mt. Zion Baptist Church	0.48

Tract I.D.	Tax Map No.	Parcel No.	County	District	Surface Tract Owner	Acres
65	12	19.5	Wetzel	Center	Janis & Terry E. Fisher	0.15
66	12	19.3	Wetzel	Center	Janis Fisher	0.35
67	11	7	Wetzel	Center	Gilbert T. Peter, et al.	51.50
68	11	6.2	Wetzel	Center	Roger L. & Sandra K. Wade	4.00
69	16	35	Wetzel	Center	Gregory A. & Adair L. Wood	20.17
70	16	35.1	Wetzel	Center	Gregory A. & Adair L. Wood	2.08
71	16	53	Wetzel	Center	Gregory A. & Adair L. Wood	43.80

Lease No.	Owner	Acres
870172	Anthony & Kimberly Sizemore	36.37
870082	Kenneth & Jennifer Mason, et al.	47.5
870080	Ann W. Clutter, et al.	240.98
870173	Larry & Sharon Roberts	48.9
300729	Nancy Jolliffe, et al.	43

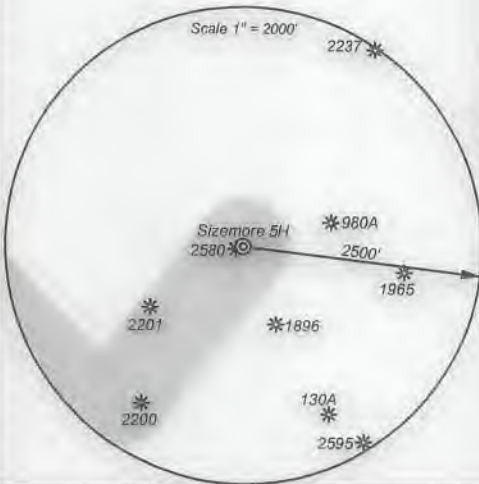
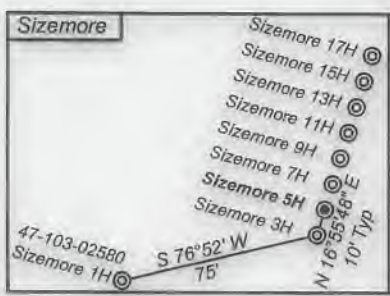

- ⊙ Proposed Gas Well
- ⊙ Located Corner, as noted
- Surface Tract Lines
- Reference Line
- Lease Boundary
- Creek or Drain
- ⊙ WV County Route
- ⊙ WV State Route



*I, the undersigned, hereby certify that this plat is correct to the best of my knowledge and belief and shows all the information required by law and the regulations issued and prescribed by the Department of Environmental Protection.*

*Ben R. Singleton*  
P.S. 2092



FILE NO: 208-19  
DRAWING NO: Sizemore 5H  
SCALE: 1" = 2000'  
MINIMUM DEGREE OF ACCURACY: 1:2500  
PROVEN SOURCE OF ELEVATION: NGS CORS Station



DATE: May 28 20 20  
OPERATOR'S WELL NO.: Sizemore 5H  
API WELL NO: 47-103-03346  
STATE COUNTY PERMIT

WELL TYPE:  OIL  GAS  LIQUID INJECTION  WASTE DISPOSAL  
(IF GAS) PRODUCTION:  STORAGE  DEEP  SHALLOW  
LOCATION: ELEVATION: 1148' WATERSHED Tributary of Sugar Run QUADRANGLE: Littleton  
DISTRICT: Center COUNTY: Wetzel  
SURFACE OWNER: Anthony W. & Kimberly A. Sizemore ACREAGE: 75.36  
ROYALTY OWNER: Anthony W. Sizemore LEASE NO: 870171 ACREAGE: 75.36  
PROPOSED WORK:  DRILL  CONVERT  DRILL DEEPER  FRACTURE OR STIMULATE  PLUG OFF OLD FORMATION  
 PERFORATE NEW FORMATION  OTHER PHYSICAL CHANGE IN WELL (SPECIFY)  
 PLUG AND ABANDON  CLEAN OUT AND REPLUG TARGET FORMATION: Marcellus ESTIMATED DEPTH: 7,335'

WELL OPERATOR: EQT Production Company DESIGNATED AGENT: Joseph C. Mallow  
ADDRESS: 400 Woodcliff Drive ADDRESS: 115 Professional Place PO Box 280  
Canonsburg, PA 15317 Bridgeport, WV 26330