

Antero Resources
Well No. Busch 3H
 Antero Resources Corporation

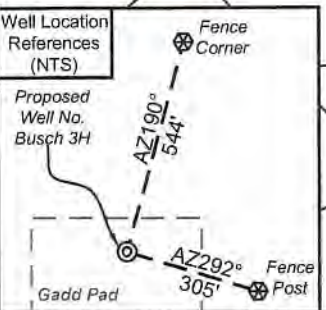

I, the undersigned, hereby certify that this plat is correct to the best of my knowledge and belief and shows all the information required by law and the rules issued and prescribed by the Department of Environmental Protection.

Bradley D. Miller
 Bradley D. Miller, P.S. 2167

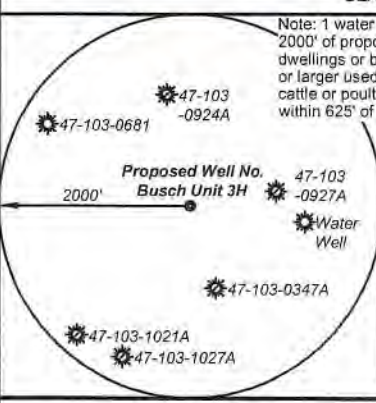

Legend

- Proposed gas well
- Monument, as noted
- Existing Well, as noted
- Digitized Well, as noted
- Creek or Drain
- Road
- Surface boundary (approx.)
- Interior surface tracts (approx.)
- Railroad

Notes
 West Virginia Coordinate System of 1927, North Zone based upon Differential GPS Measurements.
 Well No. Busch Unit 3H Top Hole coordinates are
 N: 384,876.95' Latitude: 39°32'59.71"
 E: 1,645,969.59' Longitude: 80°45'19.93"
 Bottom Hole coordinates are
 N: 396,058.63' Latitude: 39°34'49.65"
 E: 1,641,909.36' Longitude: 80°46'13.78"
 UTM Zone 17, NAD 1983
 Top Hole Coordinates Bottom Hole Coordinates
 N: 4,377,842.120m N: 4,381,228.026m
 E: 521,018.893m E: 519,725.179m
 Plat orientation and corner and well references are based upon the grid north meridian.
 Well location references are based upon the magnetic meridian.

Notes:
 Well No. Busch Unit 3H UTM Zone 17, NAD 1927
 Top Hole Coordinates
 N: 14,362,255.03'
 E: 1,709,328.09'
 Point of Entry Coordinates
 N: 14,362,254.66'
 E: 1,708,897.32'
 Bottom Hole Coordinates
 N: 14,373,363.64'
 E: 1,705,083.20'

	Bearing	Dist.
L1	S 40°42' E	2,566.3'
L2	S 45°39' W	1,532.2'
L3	N 65°19' W	1,009.0'
L4	N 39°27' W	848.2'
L5	N 89°06' W	430.9'

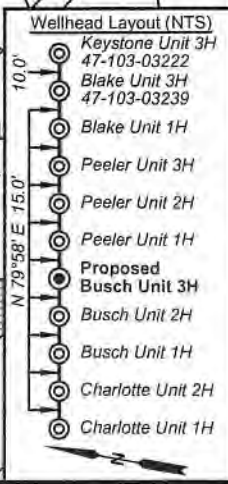

FILE NO: 235-34-G-17
 DRAWING NO: Busch 3H Well Plat
 SCALE: 1" = 1500'
 MINIMUM DEGREE OF ACCURACY: Submeter
 PROVEN SOURCE OF ELEVATION: CORS, Monroe County, OH

STATE OF WEST VIRGINIA
 DEPARTMENT OF ENVIRONMENTAL PROTECTION
OIL AND GAS DIVISION

DATE: April 28 2021
 OPERATOR'S WELL NO. Busch Unit 3H
 API WELL NO. 47-103-03406

WELL TYPE: OIL GAS LIQUID INJECTION WASTE DISPOSAL
 (IF GAS) PRODUCTION: STORAGE DEEP SHALLOW

LOCATION: ELEVATION: As-Built 1,223.8' WATERSHED: Fishing Creek QUADRANGLE: Porter Falls
 DISTRICT: Green William L. & Donald Paul VanDyke; COUNTY: Wetzel
 SURFACE OWNER: Delores J. Gadd Chesapeake Appalachia, LLC; Lee & Hall Royalties; Robert Wesley Ueltschy; ACREAGE: 60.5
 ROYALTY OWNER: Shiben Estates, Inc. (2); WVDNR; Ridgetop Royalties, LLC; Richards Resources LEASE NO: ACREAGE: 190; 29; 123.8; 37;

PROPOSED WORK: DRILL CONVERT DRILL DEEPER FRACTURE OR STIMULATE PLUG OFF OLD FORMATION
 PERFORATE NEW FORMATION OTHER PHYSICAL CHANGE IN WELL (SPECIFY) _____
 PLUG AND ABANDON CLEAN OUT AND REPLUG TARGET FORMATION: Marcellus Shale ESTIMATED DEPTH: 7,400' TVD
 20,500' MD

WELL OPERATOR: Antero Resources Corporation DESIGNATED AGENT: Dianna Stamper - CT Corporation System
 ADDRESS: 1615 Wynkoop Street ADDRESS: 5400 D Big Tyler Road
 Denver, CO 80202 Charleston, WV 25313

Antero Resources
Well No. Busch 3H
 Antero Resources Corporation



ID	TM/Par	Owner	Bk/Pg	Acres
1	16-22	William L. & Delores J. Gadd	348/169	60.50
2	16-23	Kenneth E. Butler	331/110	50.97
3	16-31	William L. & Delores J. Gadd	348/169	2.65
4	16-30	William L. & Delores J. Gadd	348/169	14.00
5	16-47	William M. Greenawalt & Lee A. Niezgoda	387/1	12.00
6	16-10	Loren & Shirley Haught	444/434	100.48
7	16-21.3	Mildred E. Caseman	WB45/396	12.00
8	16-21.2	Mildred E. Caseman	WB45/396	20.06
9	16-9	Richard A. & Susan L. Gardner	341/281	66.50
10	12-55	Bradley W. Ueltschy	330/37	100.00
11	12-56	Ronald K. Burgess	WB25/275	69.37
12	12-51	James Gail Morgan, Jr.	300/3	60.00
13	12-41	Robert W. & Bradley W. Uektschy	341/261	29.00
14	13-27	Donald P. Vandyke & Mark L. Vandyke	410/241	123.80
15	12-42.2	Donald P. Vandyke & Mark L. Vandyke	410/241	1.00
16	12-42	Donald P. Vandyke & Mark L. Vandyke	410/241	29.65
17	12-42.1	Donald P. Vandyke & Mark L. Vandyke	410/241	0.35
18	12-50	Richard B. & Jaynee C. Dallison	399/288	37.00
19	12-32	Donald P. Vandyke & Mark L. Vandyke	410/241	38.00
20	12-30	Martin E. Rogers	363/413	51.08
21	12-31	Bruce Allen Lawhorne, et al	419/878	40.00
22	12-20.1	Jerome E. II & Benita K. Staley	415/329	13.34
23	12-29	Jerome E. II & Benita K. Staley	415/329	1.50
24	12-28	Jerome E. II & Benita K. Staley	415/329	2.05
25	12-10	Charles & Wilda Lee Loy	299/009	4.85
26	12-11	Timothy L. & Michael A. McDiffitt	385/189	131.34
27	12-11.1	Timothy L. & Tammy D. McDiffitt	431/389	6.66
28	7-54	James Ronald Long	283/207	10.00
29	7-55	Cheryl Janette & Gary Lyn Harman	420/756	0.25
30	7-56	April D. Lancaster	410/707	8.80
31	8-35	George Woofter	286/203	1.00
32	8-36	Holbert W. Carrel Sr.	416/390	72.68

Leases	
A	Shiben Estates, Inc.
B	Ellen W. & Mark L. VanDyne
C	Sandra Rose Conley
D	John W. Bertram
E	BRC Appalachian Minerals I, LLC
F	Gordon Cummings
G	Mildred Caseman
H	Sielger Family Trust
I	Thomas E. Morris
J	Chesapeake Appalachia, LLC
K	Lee & Hall Royalties
L	Robert Wesley Ueltschy
M	James Gail Morgan, Jr.
N	Shiben Estates, Inc.
O	WV Division of Natural Resources
P	Donald Paul VanDyke
Q	Richard B. Dallison, et ux
R	Donald VanDyke
S	Ridgetop Royalties, LLC
T	David E. Bowyer
U	Bounty Minerals, LLC
V	OPEN
W	Raymond P. Gaston, et ux
X	Raymond P. Gaston, et ux
Y	Richards Resources
Z	WV Division of Natural Resources

FILE NO: 235-34-G-17
 DRAWING NO: Busch 3H Well Plat
 SCALE: 1" = 1500'
 MINIMUM DEGREE OF ACCURACY:
Submeter
 PROVEN SOURCE OF ELEVATION:
CORS, Monroe County, OH

STATE OF WEST VIRGINIA
 DEPARTMENT OF ENVIRONMENTAL PROTECTION
OIL AND GAS DIVISION

DATE: April 28 2021
 OPERATOR'S WELL NO. Busch Unit 3H
 API WELL NO
47 - 103 - 03406
 STATE COUNTY PERMIT

WELL TYPE: OIL GAS LIQUID INJECTION WASTE DISPOSAL
 (IF GAS) PRODUCTION: STORAGE DEEP SHALLOW

LOCATION: ELEVATION: As-Built 1,223.8' WATERSHED: Fishing Creek QUADRANGLE: Porter Falls
 DISTRICT: Green William L. & Richard B. Dallison, et ux; Donald VanDyke; David E. Bowyer; COUNTY: Wetzel
 SURFACE OWNER: Delores J. Gadd Chesapeake Appalachia, LLC; Lee & Hall Royalties; Robert Wesley Ueltschy; ACREAGE: 60.5
 ROYALTY OWNER: Shiben Estates, Inc. (2); WVDNR; Ridgetop Royalties, LLC; Richards Resources LEASE NO: _____ ACREAGE: 190; 29; 123.8; 37;
 PROPOSED WORK: DRILL CONVERT DRILL DEEPER FRACTURE OR STIMULATE PLUG OFF OLD FORMATION
 PERFORATE NEW FORMATION OTHER PHYSICAL CHANGE IN WELL (SPECIFY) _____
 PLUG AND ABANDON CLEAN OUT AND REPLUG TARGET FORMATION: Marcellus Shale ESTIMATED DEPTH: 7,400' TVD
20,500' MD

WELL OPERATOR: Antero Resources Corporation DESIGNATED AGENT: Dianna Stamper - CT Corporation System
 ADDRESS: 1615 Wynkoop Street ADDRESS: 5400 D Big Tyler Road
Denver, CO 80202 Charleston, WV 25313