

**Antero Resources**  
**Well No. Daags 1H**  
 Antero Resources Corporation

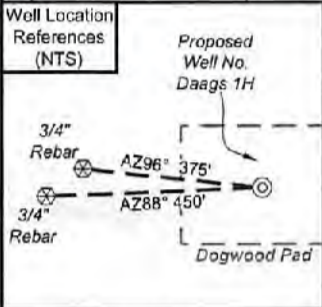

I, the undersigned, hereby certify that this plat is correct to the best of my knowledge and belief and shows all the information required by law and the rules issued and prescribed by the Department of Environmental Protection.

*Bradley D. Miller*

Bradley D. Miller, P.S. 2167



Leases				
A	Joan B. Hoge Trust			
B	Waco Oil & Gas Company Inc.			
C	BRC Appalachian Minerals I, LLC			
D	Morris Mountaineer Oil & Gas, LLC			
ID	TMP/Par	Owner	Bk/Pg	Acres
1	20-13	Dallison Lumber Inc.	440/243	208.00
2	20-17	Christopher N. Kise	420/812	34.30
3	20-25	Unknown Owner	---	42.00
4	20-36	Louisa Bassett	165/304	1.50
5	20-35	Louisa Bassett & Mrs. Irvin Bassett	168/157	72.00
6	20-33	David Edward Arthurs, et al	347/49	26.50

Legend	
	Proposed gas well
	Monument, as noted
	Existing Well, as noted
	Digitized Well, as noted
	Creek or Drain
	Road
	Surface boundary (approx.)
	Interior surface tracts (approx.)

Bearing	Dist.
L1 S 09°41' E	1,583.4'
L2 S 21°08' W	1,846.4'
L3 N 72°52' W	912.2'
L4 N 18°58' W	1,284.4'
L5 N 46°52' E	197.5'

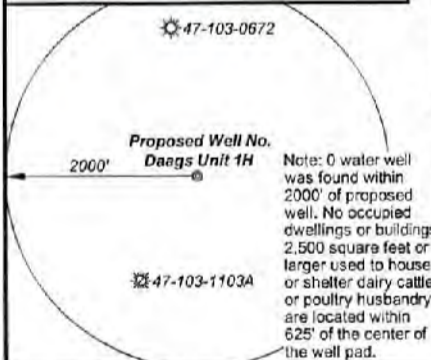
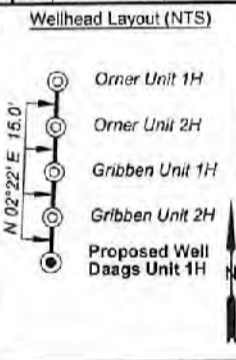

**Notes**  
 West Virginia Coordinate System of 1927, North Zone based upon Differential GPS Measurements.  
 Well No. Daags Unit 1H Top Hole coordinates are  
 N: 376,154.12' Latitude: 39°31'34.66"  
 E: 1,654,575.08' Longitude: 80°43'28.56"  
 Bottom Hole coordinates are  
 N: 374,118.12' Latitude: 39°31'14.67"  
 E: 1,655,432.54' Longitude: 80°43'17.26"  
 UTM Zone 17, NAD 1983  
 Top Hole Coordinates Bottom Hole Coordinates  
 N: 4,375,228.469m N: 4,374,612.552m  
 E: 523,664.905m E: 523,956.469m  
 Plat orientation and corner and well references are based upon the grid north meridian.  
 Well location references are based upon the magnetic meridian.

**Notes:**  
 Well No. Daags Unit 1H UTM Zone 17, NAD 1927  
 Top Hole Coordinates  
 N: 14,353,679.93'  
 E: 1,718,075.03'  
 Point of Entry Coordinates  
 N: 14,353,817.27'  
 E: 1,718,216.80'  
 Bottom Hole Coordinates  
 N: 14,351,659.20'  
 E: 1,718,966.06'

FILE NO: 325-34-G-17  
 DRAWING NO: Daags 1H Well Plat  
 SCALE: 1" = 1500'  
 MINIMUM DEGREE OF ACCURACY: Submeter  
 PROVEN SOURCE OF ELEVATION: CORS, Monroe County, OH

**STATE OF WEST VIRGINIA**  
 DEPARTMENT OF ENVIRONMENTAL PROTECTION  
**OIL AND GAS DIVISION**

DATE: June 29 20 21  
 OPERATOR'S WELL NO. Daags Unit 1H  
 API WELL NO **46A**  
 47 - 103 - **03425**  
 STATE COUNTY PERMIT

WELL TYPE:  OIL  GAS  LIQUID INJECTION  WASTE DISPOSAL  
 (IF GAS) PRODUCTION:  STORAGE  DEEP  SHALLOW

LOCATION: ELEVATION: 1,308' WATERSHED: Fishing Creek QUADRANGLE: TH: Pine Grove BH: Center Point  
 DISTRICT: Green Dallison COUNTY: **08/27/2021**  
 SURFACE OWNER: Lumber, Inc. Morris Mountaineer Oil & Gas, LLC; ACREAGE: 60.5  
 ROYALTY OWNER: Joan B. Hoge Trust; Waco Oil & Gas Co. Inc.; BRC Appalachian Minerals I, LLC; LEASE NO: ACREAGE: 23.0; 137.9125; 50.00; 68.9563;  
 PROPOSED WORK:  DRILL  CONVERT  DRILL DEEPER  FRACTURE OR STIMULATE  PLUG OFF OLD FORMATION  
 PERFORATE NEW FORMATION  OTHER PHYSICAL CHANGE IN WELL (SPECIFY) \_\_\_\_\_ 7,600' TVD  
 PLUG AND ABANDON  CLEAN OUT AND REPLUG TARGET FORMATION: Marcellus Shale ESTIMATED DEPTH: 11,000' MD

WELL OPERATOR: Antero Resources Corporation DESIGNATED AGENT: Dianna Stamper - CT Corporation System  
 ADDRESS: 1615 Wynkoop Street ADDRESS: 5400 D Big Tyler Road  
 Denver, CO 80202 Charleston, WV 25313

**Antero Resources**  
Well No. **Daags 1H**  
Antero Resources Corporation



**Notes**  
West Virginia Coordinate System of 1927, North Zone based upon Differential GPS Measurements.  
Well No. Daags Unit 1H Top Hole coordinates are  
N: 376,154.12' Latitude: 39°31'34.68"  
E: 1,654,575.08' Longitude: 80°43'28.56"  
Bottom Hole coordinates are  
N: 374,118.12' Latitude: 39°31'14.67"  
E: 1,655,432.54' Longitude: 80°43'17.26"  
UTM Zone 17, NAD 1983  
Top Hole Coordinates Bottom Hole Coordinates  
N: 4,375,228.469m N: 4,374,612.552m  
E: 523,664.905m E: 523,956.469m  
Plat orientation and corner and well references are based upon the grid north meridian.  
Well location references are based upon the magnetic meridian.

**Notes:**  
Well No. Daags Unit 1H UTM Zone 17, NAD 1927  
Top Hole Coordinates  
N: 14,353,679.93'  
E: 1,718,075.03'  
Point of Entry Coordinates  
N: 14,353,817.27'  
E: 1,718,216.80'  
Bottom Hole Coordinates  
N: 14,351,659.20'  
E: 1,718,986.06'

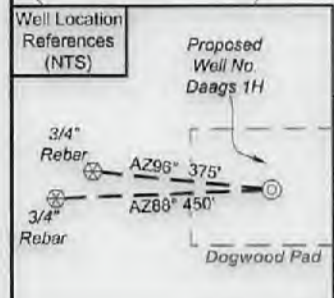

I, the undersigned, hereby certify that this plat is correct to the best of my knowledge and belief and shows all the information required by law and the rules issued and prescribed by the Department of Environmental Protection.

*Bradley D. Miller*  
Bradley D. Miller, P.S. 2167



**Leases**

A	Joan B. Hoge Trust
B	Waco Oil & Gas Company Inc.
C	BRC Appalachian Minerals I, LLC
D	Morris Mountaineer Oil & Gas, LLC

ID	TM/Par	Owner	Bk/Pg	Acres
1	20-13	Dallison Lumber Inc.	440/243	208.00
2	20-17	Christopher N. Kise	420/812	34.30
3	20-25	Unknown Owner	--/--	42.00
4	20-36	Louisa Bassett	165/304	1.50
5	20-35	Louisa Bassett & Mrs. Irvin Bassett	168/157	72.00
6	20-33	David Edward Arthurs, et al	347/49	26.50

**Legend**

- Proposed gas well
- Monument, as noted
- Existing Well, as noted
- Digitized Well, as noted
- Creek or Drain
- Road
- Surface boundary (approx.)
- Interior surface tracts (approx.)

Bearing	Dist.
L1	S 09°41' E 1,583.4'
L2	S 21°08' W 1,846.4'
L3	N 72°52' W 912.2'
L4	N 18°58' W 1,264.4'
L5	N 46°52' E 197.5'

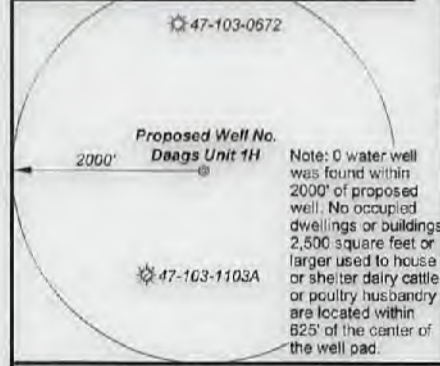
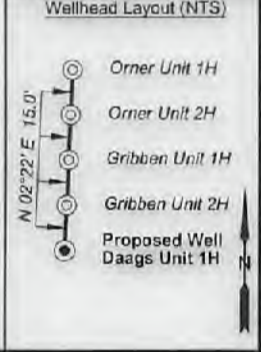

FILE NO: 325-34-G-17  
DRAWING NO: Daags 1H Well Plat  
SCALE: 1" = 1500'  
MINIMUM DEGREE OF ACCURACY: Submeter  
PROVEN SOURCE OF ELEVATION: CORS, Monroe County, OH

**STATE OF WEST VIRGINIA**  
DEPARTMENT OF ENVIRONMENTAL PROTECTION  
**OIL AND GAS DIVISION**

DATE: June 29 2021  
OPERATOR'S WELL NO. Daags Unit 1H  
API WELL NO. **47-103-03425**  
STATE COUNTY PERMIT

WELL TYPE:  OIL  GAS  LIQUID INJECTION  WASTE DISPOSAL  
(IF GAS) PRODUCTION:  STORAGE  DEEP  SHALLOW

LOCATION: ELEVATION: 1,308' WATERSHED: Fishing Creek QUADRANGLE: Pine Grove BH: Center Point  
DISTRICT: Green Dallison COUNTY: Wayne  
SURFACE OWNER: Lumber, Inc. MORRIS MOUNTAINEER OIL & GAS, LLC; ACREAGE: 60.5  
ROYALTY OWNER: Joan B. Hoge Trust; Waco Oil & Gas Co. Inc.; BRC Appalachian Minerals I, LLC; LEASE NO: ACREAGE: 23.0; 137.9125; 50.00; 68.9563;

PROPOSED WORK:  DRILL  CONVERT  DRILL DEEPER  FRACTURE OR STIMULATE  PLUG OFF OLD FORMATION  
 PERFORATE NEW FORMATION  OTHER PHYSICAL CHANGE IN WELL (SPECIFY)  
 PLUG AND ABANDON  CLEAN OUT AND REPLUG TARGET FORMATION: Marcellus Shale ESTIMATED DEPTH: 7,600' TVD 11,000' MD

WELL OPERATOR: Antero Resources Corporation DESIGNATED AGENT: Dianna Stamper - CT Corporation System  
ADDRESS: 1615 Wynkoop Street ADDRESS: 5400 D Big Tyler Road  
Denver, CO 80202 Charleston, WV 25313

08/27/2021

4710303425

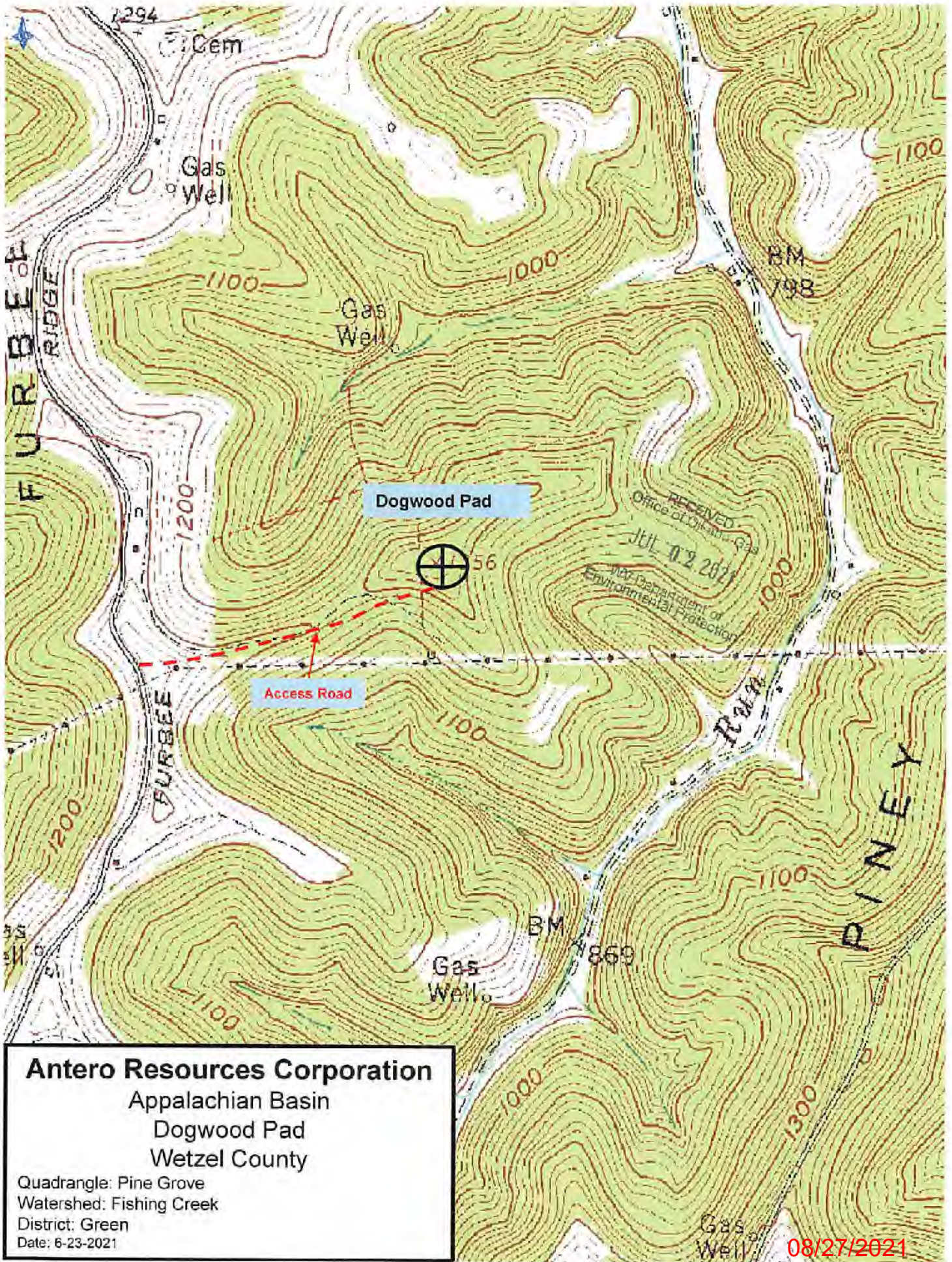

**Antero Resources Corporation**  
Appalachian Basin  
Dogwood Pad  
Wetzel County

Quadrangle: Pine Grove  
Watershed: Fishing Creek  
District: Green  
Date: 6-23-2021

08/27/2021