

(BH) 10,199'

(TH) 8,268'

TOP HOLE LATITUDE: 39°42'30"
BOTTOM HOLE LATITUDE: 39°45'00"

**ELMER LEASE
WELL N-18HU
310.9511 ± ACRES
EQT PRODUCTION COMPANY**

SEE
INSET
"C"

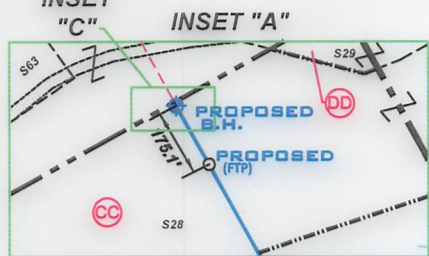

INSET "B"

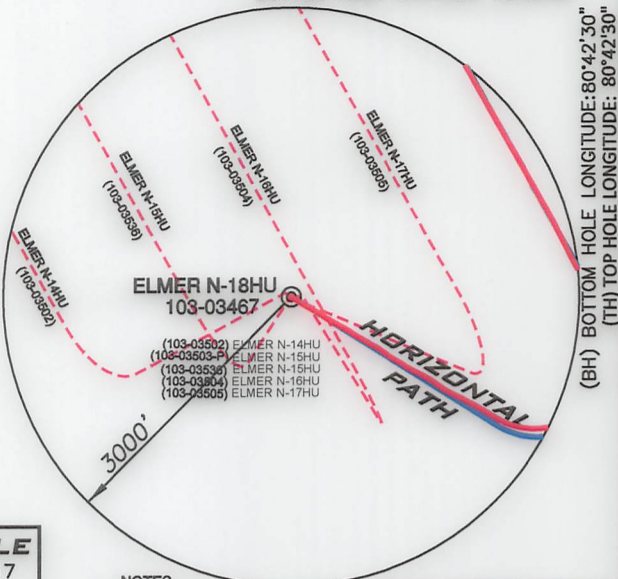
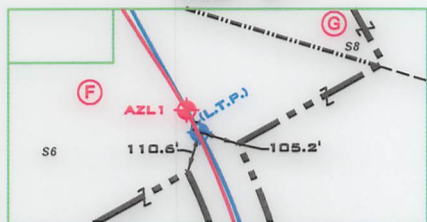

(BH) BOTTOM HOLE LONGITUDE: 80°42'30"
(TH) TOP HOLE LONGITUDE: 80°42'30"

(BH) 11,520'

(TH) 5,291'

SURFACE HOLE
UTM. NAD83, ZONE 17
IN METERS
N) 4,393,817.36
E) 522,503.39

LANDING POINT 1
UTM. NAD83, ZONE 17
IN METERS
N) 4,393,760.22
E) 523,503.79

BOTTOM HOLE
UTM. NAD83, ZONE 17
IN METERS
N) 4,396,711.96
E) 521,799.67

- NOTES**
- BORE PATH BASED ON GRID NORTH.
 - NO WATER WELLS WITHIN 250' OF WELL WERE FOUND, NO DWELLINGS WITHIN 625' OF PAD CENTER WERE FOUND.
 - OWNERSHIP TAKEN FROM PUBLIC RECORDS OF WETZEL COUNTY, WV IN JULY, 2022. COORDINATES AND WELL TIES BASED UPON DIFFERENTIAL GPS MEASUREMENTS.
 - WELL LOCATION REFERENCES ARE BASED UPON THE MAGNETIC MERIDIAN.
 - ALL DEEP WELLS WITHIN 1,000' ARE SHOWN ON THIS PLAT.
 - BOUNDARIES ALONG ROADWAYS ARE BASED UPON MEMORANDUM BY DICKIE, MCCAMEY & CHILCOTE, P.C. FILE 0058304.0401147

- LEGEND**
- LEASE TRACTS
 - SURFACE TRACTS
 - WELL LATERAL
 - POINT PLEASANT LEGS
 - UNIT BOUNDARY
 - LEASE # (SEE 6A1 FORM)
 - 400' BORE PATH OFFSET
 - 500' WELL BORE OFFSET
 - (FTP) PROPOSED FIRST TAKE POINT
 - (LTP) PROPOSED LAST TAKE POINT
 - FORCED POOL TRACT
 - ASDRILLED LEG
 - PERMITTED LEG

(+) DENOTES LOCATION ON UNITED STATES TOPOGRAPHIC MAPS

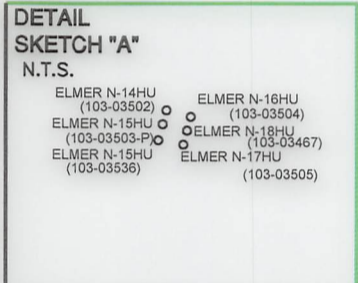

INSET "C"

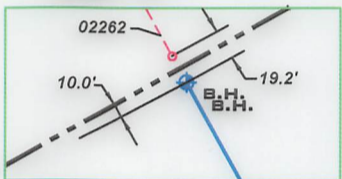

SURFACE HOLE
UTM. NAD83, ZONE 17
IN METERS
N) 4,393,817.36
E) 522,503.39

LANDING POINT 1
UTM. NAD83, ZONE 17
IN METERS
N) 4,393,430.11
E) 523,155.66

BOTTOM HOLE
UTM. NAD83, ZONE 17
IN METERS
N) 4,396,536.98
E) 521,904.58

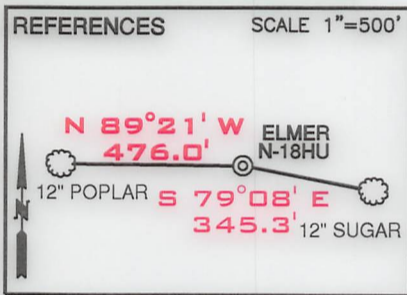

I, THE UNDERSIGNED, HEREBY CERTIFY THAT THIS PLAT IS CORRECT TO THE BEST OF MY KNOWLEDGE AND BELIEF AND SHOWS ALL THE INFORMATION REQUIRED BY LAW AND THE RULES ISSUED AND PRESCRIBED BY THE DEPARTMENT OF ENVIRONMENTAL PROTECTION

David L Jackson

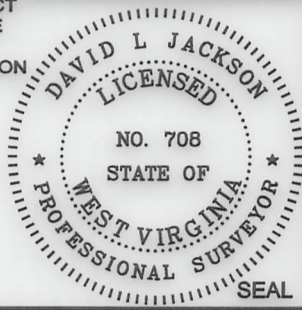

P.S. 708

JACKSON SURVEYING INC.
P.O. Box 1460
Clarksburg, WV 26302
304-623-5851



FILE NUMBER _____

DRAWING NUMBER ELMER_N-18HU_REV2

SCALE 1" = 2000'

MINIMUM DEGREE OF ACCURACY 1/200

PROVEN SOURCE OF ELEVATION SUBMETER MAPPING
GRADE GPS

WVDEP
OFFICE OF OIL & GAS
601 57TH STREET, SE
CHARLESTON, WV 25304

DATE: NOVEMBER 02, 2023

OPERATORS WELL NO. ELMER N-18HU

API WELL NO. 47-103-03467
STATE COUNTY PERMIT

LOCATION ELEVATION 1,276.50' **WATERSHED (HUC 10)** PROCTOR CREEK OF FRENCH CREEK - OHIO RIVER (HUC-10)
DISTRICT PROCTOR **COUNTY** WETZEL
QUADRANGLE WILEYVILLE 7.5' **LEASE NUMBER** SEE WW-6A1 FORM

SURFACE OWNER ELMORA TUTTLE HRS. **ACREAGE** 39.19
OIL & GAS ROYALTY OWNER ELMORA TUTTLE HRS. - SEE WW-6A1 **LEASE ACREAGE** 39.19
PROPOSED WORK: DRILL ___ CONVERT ___ DRILL DEEPER ___ REDRILL ___ FRACTURE OR STIMULATE ___ PLUG OFF OLD FORMATION ___
PERFORATE NEW FORMATION ___ OTHER PHYSICAL CHANGE (SPECIFY) **ASDRILLED**

TARGET FORMATION POINT PLEASANT **ESTIMATED DEPTH** TVD: 11,840' TMD: 25,116'

WELL OPERATOR EQT PRODUCTION COMPANY **DESIGNATED AGENT** JOSEPH C. MALLOW
ADDRESS 400 WOODCLIFF DRIVE **ADDRESS** 427 MIDSTATE DRIVE
CANONSBURG, PA 15317 CLARKSBURG, WV 25301

COUNTY NAME
PERMIT

12/13/2024

form wv6

**ELMER LEASE
WELL N-18HU
310.9511± ACRES
EQT PRODUCTION COMPANY**

GRID NORTH

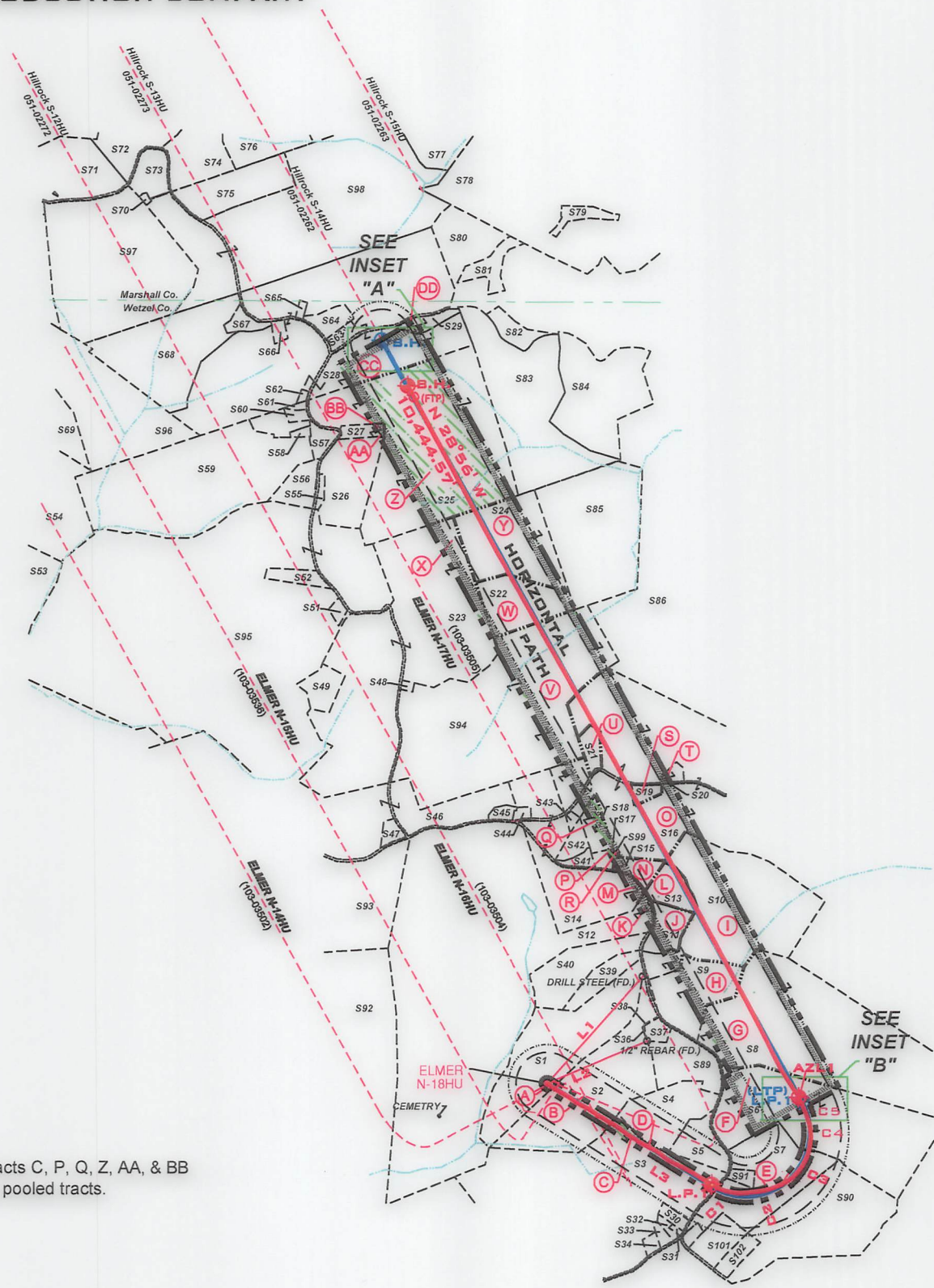

NOTE: Tracts C, P, Q, Z, AA, & BB are forced pooled tracts.

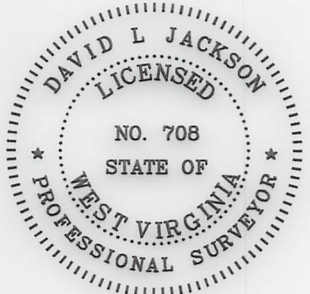

P.S. 708 *David L Jackson*

LINE	BEARING	DISTANCE
L1	N 41°47' E	1844.12'
L2	N 67°00' E	1399.04'
L3	S 58°21' E	2,489.53'

CURVE	CHORD BEARING	CHORD LENGTH	RADIUS	ARC LENGTH
C1	S 73°08' E	368.75'	715.83'	372.96'
C2	N 79°09' E	552.15'	1248.95'	556.75'
C3	N 36°05' E	625.34'	666.37'	650.92'
C4	N 05°27' W	366.46'	684.97'	370.97'
C5	N 23°31' W	278.66'	1795.47'	278.94'

ASDRILLED LEG
PERMITTED LEG

LEGEND

- LEASED TRACTS
- SURFACE TRACTS
- WELL LATERAL
- POINT PLEASANT LEGS
- UNIT BOUNDARY
- (A) LEASE # (SEE GA1 FORM)
- 400' BORE PATH OFFSET
- 500' WELL BORE OFFSET
- (FTP) PROPOSED FIRST TAKE POINT
- (LTP) PROPOSED LAST TAKE POINT
- FORCED POOL TRACT

12/13/2024

	OPERATOR'S	WELL #:	<u>ELMER N-18HU</u>	WELL PLAT
	DISTRICT:	<u>Proctor</u>		PAGE 2 OF 4
	COUNTY:	<u>Wetzel</u>		DATE: 11/02/2023
	STATE:	<u>WV</u>		
	API #:	<u>47-103-03467</u>		

form wv6

**ELMER LEASE
WELL N-18HU
310.9511 ± ACRES
EQT PRODUCTION COMPANY**

* FORCED POOLED TRACTS ARE HIGHLIGHTED

Parcels within Unit Boundary				
Tags	Number	Tax Map -Parcel	Surface Owner	Acres
A	S1	12-8-15	ELNORA TUTTLE HRS.	39.19
B	S2	12-8-16	CHARLES & BETTY HUGGINS	39.13
C	S3	12-8-20	NANCT TRUEX	95.35
D	S4	12-8-21.1	LINDA M. STOUT	15.26
E	S7	12-8-32	DAVID TODD & CINDY L. BATES & CHARLES M. THOMAS	27.287
F	S6	12-8-23	JACOB WOODROW & MARY JOSEPHINE NICE	59
G	S8	12-8-17	JACOB WOODROW & MARY JOSEPHINE NICE	85.69
H	S9	12-8-4	JACOB WOODROW & MARY JOSEPHINE NICE	20.893
I	S10	12-8-4.5	JACOB WOODROW & MARY JOSEPHINE NICE	51.107
J	S11	12-8-4.1	JACOB WOODROW & MARY JOSEPHINE NICE	6.171
K	S12	12-8-2	R. SHANE & KATHRYN GODDARD	178
L	S13	12-8-4.3	BRADY G. & SHARON L. HOWELL	5.59
M	S14	12-8-3	R. SHANE & KATHRYN GODDARD	31.13
N	S15	12-3-31	DOUGLAS & SUZANNE ESTEP	3.25
O	S16	12-3-30.4	FRIEND V. ESTEP, MICHAEL & JOAN ESTEP & DOUGLAS & SUZANNE ESTEP (RAYMOND ESTEP- L/E)	81.82
P	S17	12-3-39.1	WILLIAM NICE	1.31
Q	S18	12-3-39	FRIEND V. ESTEP, MICHAEL & JOAN ESTEP & DOUGLAS & SUZANNE ESTEP (RAYMOND ESTEP- L/E)	4.69
R	S99	p/o 12-3-39 & 12-3-30.4	DONALD & SUZANNE ESTEP	0.145
S	S19	12-3-30.2	APRIL ROSE & DONALD ALLEN POSTLETHWAIT	1.67
T	S20	12-3-30	APRIL ROSE POSTLETHWAIT ; MARY ROSE YOHO - L/E	1.48
U	S21	12-3-29	FRIEND V. ESTEP (RAYMOND F. ESTEP- L/E)	2.9
V	S94	12-3-21	LARRY J & MARY ANN KIRKLAND	99.53
W	S22	12-3-14.1	MATTHEW D. HALL	13
X	S23	12-3-13	LARRY J. & MARY ANN KIRKLAND	95
Y	S24	12-3-14	ROBERT W. BAXTER, FREDERICK J. BAXTER & ANN C. LINGER	27
Z	S25	12-3-4	MARY HOHMAN ET AL	85
AA	S26	12-3-3.1	DIANA & ROBERT L. SMITH	15.78
BB	S27	12-3-02	ROBERT LEE & DIANA G. SMITH	2.48
CC	S28	5-25-11.2	JAMES W. KLUG	110.491
DD	S29	12-3-42	J. M. KLUG	2.617

Adjoining Parcels Ownership Table			
Number	Tax Map -Parcel	Surface Owner	Acres
S5	12-8-22.1	BARRY C. KIRKLAND	7.401
S30	12-8-20.1	PAUL J. BLAKE	1.5
S31	12-8-20.3	PAUL J. BLAKE	0.25
S32	12-8-20.9	JOSHUA M. & COURTNEY R. NEFF	0.4
S33	12-8-20.8	JOSHUA M. & COURTNEY R. NEFF	0.99
S34	12-8-20.6	JOHN G. & DEBRA D. THROCKMORTON	1.046
S35	12-8-20.5	JOE B. MILLER & GERALD & SUE YEATER	5.44
S36	12-8-4.4	CHARLES & BETTY HUGGINS	0.69
S37	12-8-4.2	BRENT A. & KIMBERLY J. EDDY	1.861
S38	12-8-16.1	BRENT A. & KIMBERLY J. EDDY	0.06
S39	12-8-14	EDWARD C. & SANDRA K. MURRINER	5.33
S40	12-8-13	EDWARD C. & SANDRA K. MURRINER	15
S41	12-3-32.1	TIMOTHY L. & LEA ANN SUMMERS	1.78
S42	12-3-32	TIMOTHY L. SUMMERS	2.32
S43	12-3-30.3	TIMOTHY L. SUMMERS	0.61
S44	12-3-45	ANTIOCH CHURCH	0.774
S45	12-3-28	ANTIOCH CHURCH	1
S46	12-8-1.1	R. SHANE & KATHRYN GODDARD	92.69
S47	12-8-1.2	JOSH GODDARD	1.81
S48	12-3-21.1	LARRY J & MARY ANN KIRKLAND	0.47
S49	12-3-13.1	ZACHARY J. KIRKLAND	5
S50	12-2-22.1	DAVID A. NICE	54.66
S51	12-3-48	RONALD W. & JULIE A. NICE	1
S52	12-3-12	RODNEY DEAN JACKSON	3.625
S53	12-2-12	BERYL E. MASON	59.9
S54	12-2-13	JAY S. BOOTH; DANIEL T. BOOTH & DIANE BETH OVERDORFF	100
S55	12-3-3	ANITA LARELL SLOUGH	1.12
S56	12-3-4.2	DEREK L. BAKER	5.21
S57	12-3-4.3	JOSEPH P. & BARBARA A. CAIN	3.619
S58	12-3-4.8	ERIN HUBBS	0.621
S59	12-3-4.7	JOSEPH P. & BARBARA A. CAIN	67.3
S60	12-3-4.6	STEVEN P. WAYMAN	1.009
S61	12-3-4.5	HAZEL M. BLAIR	0.451
S62	12-3-1	JAMES W. KLUG	0.375
S63	12-3-4.3	ADAM W. FERRELL & BRITTANY M. LOY	1.97
S64	12-3-4.9	LOGAN & AMY TAYLOR	3.814
S65	12-3-4.7	WETZEL CO. EMERGENCY AMBULANCE	0.5
S66	12-3-4.4	JAMES A. & JO C. ESTEP	1.1
S67	05-25-11.1	EDWARD W. & DIANNA KLUG	2.343
S68	05-25-11.4	EDWARD W. KLUG, ET UX	32.787
S69	12-2-14.2	JOHN G. JR. & GERALDINE W. ROGERS	22.0007
S70	05-25-13.4	PARSONS CEMETERY	0.382
S71	05-25-14	ROY F. YOHO	23
S72	05-25-1	MICHAEL L. MASON	35.43
S73	05-25-13.2	DAVID A. KLUG	5.89
S74	05-25-13	WILLIAM M. FERDA, JR. & STEPHANIE L. PALICKA	16.014
S75	05-25-12.1	KENT & BETTY MASON	15
S76	05-25-1.5	RYAN J. BRATTON	21.35
S77	05-25-2	JAMES W. KLUG	122.3
S78	05-25-3	S.D. FERTITTA, ET UX	181.548
S79	05-25-3.1	S.D. FERTITTA, ET UX	3.022
S80	05-25-10	TERRY L. & TAMMY J. KIRKLAND, AS TRUSTEES OF THE TERRY & TAMMY KIRKLAND LIVING TRUST	18.75
S81	05-25-10.1	TERRY L. & TAMMY J. KIRKLAND, AS TRUSTEES OF THE TERRY & TAMMY KIRKLAND LIVING TRUST	5.25
S82	12-3-4.1	TERRY L. & TAMMY J. KIRKLAND, AS TRUSTEES OF THE TERRY & TAMMY KIRKLAND LIVING TRUST	4.102
S83	12-3-41.1	TERRY L. & TAMMY J. KIRKLAND, AS TRUSTEES OF THE TERRY & TAMMY KIRKLAND LIVING TRUST	74.138
S84	12-3-4.1	TERRY L. & TAMMY J. KIRKLAND, AS TRUSTEES OF THE TERRY & TAMMY KIRKLAND LIVING TRUST	10.5
S85	12-3-15	ROBERT W. BAXTER, FREDERICK J. BAXTER & ANN C. LINGER	38
S86	12-3-22	FRIEND V. ESTEP, MICHAEL & JOAN ESTEP & DOUGLAS & JOAN ESTEP (RAYMOND ESTEP - L/E)	22.5
S87	12-3-30.1	JOAN & MICHAEL J. ESTEP	1.75
S88	12-3-33	FRIEND V. ESTEP, MICHAEL & JOAN ESTEP & DOUGLAS & JOAN ESTEP (RAYMOND ESTEP - L/E)	58.32
S89	12-8-6	JEREMY S. & ERIN P. GODDARD	25
S90	12-8-32.8	DAVID TODD & CINDY L. BATES	36.425
S91	12-8-32.6	CHARLES W. THOMAS, JR.	1.309
S92	12-8-1	R SHANE & KATHRYN GODDARD	77
S93	12-8-1.1	R SHANE & KATHRYN GODDARD	92.69
S95	12-2-19	NICHOLAS M & ASHLEY N GODDARD	243.68
S96	12-2-14	DAVID L CUNNINGHAM	56.23
S97	5-25-14.1	JUDITH L WEIGAND	65
S98	5-25-12	MARION PARSONS JR, ET AL	85.16

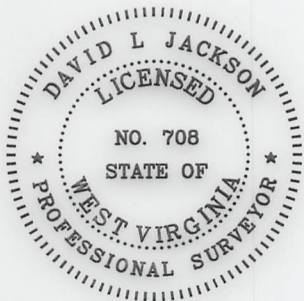

P.S. 708

David L Jackson

12/13/2024



OPERATOR'S
WELL #: ELMER N-18HU
DISTRICT: Proctor
COUNTY: Wetzel
STATE: WV
API #: 47-103-03467

WELL PLAT
PAGE 3 OF 4
DATE: 11/02/2023

form ww6

**ELMER LEASE
WELL N-18HU
310.9511± ACRES
EQT PRODUCTION COMPANY**

* FORCED POOLED TRACTS ARE HIGHLIGHTED

Lease ID	Tag	Parcel	Grantor, Lessor, Etc.	Deed Book/Page	
10*31435	A	12-8-15	HENRY AND NANCY GARNER	55	394
10*31435	B	12-8-16	HENRY AND NANCY GARNER	55	394
10*40570	C	12-8-20	HUBERT D MORRIS, ET AL	295A	175
10*31435	D	12-8-21.1	HENRY AND NANCY GARNER	55	394
10*31435	E	12-8-32	HENRY AND NANCY GARNER	55	394
10*31435	F	12-8-23	HENRY AND NANCY GARNER	55	394
10*40155	G	12-8-17	ROY J GODDARD AND DOROTHY GODDARD	47A	197
10*40155	H	12-8-4	ROY J GODDARD AND DOROTHY GODDARD	47A	197
10*40155	I	12-8-4.5	ROY J GODDARD AND DOROTHY GODDARD	47A	197
10*40155	J	12-8-4.1	ROY J GODDARD AND DOROTHY GODDARD	47A	197
10*31435	K	12-8-2	HENRY AND NANCY GARNER	55	394
10*40155	L	12-8-4.3	ROY J GODDARD AND DOROTHY GODDARD	47A	197
10*31435	M	12-8-3	HENRY AND NANCY GARNER	55	394
10*31435	N	12-3-31	HENRY AND NANCY GARNER	55	394
10*31435	O	12-3-30.4	HENRY AND NANCY GARNER	55	394
10*24010	P	12-3-39.1	JOHN ROBINSON DAVIS, ET AL	215A	419
10*24010	Q	12-3-39	JOHN ROBINSON DAVIS, ET AL	215A	419
10*31435	R	12-3-30.4	HENRY AND NANCY GARNER, ET AL	55	394
10*31435	S	12-3-30.2	HENRY AND NANCY GARNER	55	394
10*31435	T	12-3-30	HENRY AND NANCY GARNER	55	394
10*31435	U	12-3-29	HENRY AND NANCY GARNER	55	394
10*21681	V	12-3-21	DOROTHY J HAAS, ET AL	214A	358
10*39720	W	12-3-14.1	FREDERICK J BAXTER, ET AL	273A	326
10*22229	X	12-3-13	MURIEL A MILLER, ET AL	204A	150
10*39720	Y	12-3-14	FREDERICK J BAXTER, ET AL	273A	326
10*39463	Z	12-3-4	J P COOPER ET AL	56	245
10*39463	AA	12-3-3.1	J P COOPER ET AL	56	245
10*39463	BB	12-3-2	J P COOPER ET AL	56	245
10*22496	CC	5-25-11.2	JAMES W KLUG	923	543
10*22496	DD	12-3-42	JAMES W KLUG	923	543

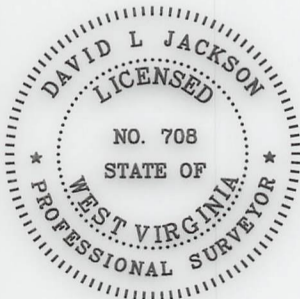

P.S. 708 *David L Jackson*

12/13/2024



OPERATOR'S	WELL #:	<u>ELMER N-18HU</u>	WELL PLAT
	DISTRICT:	<u>Proctor</u>	PAGE 4 OF 4
	COUNTY:	<u>Wetzel</u>	DATE: 11/02/2023
	STATE:	<u>WV</u>	
	API #:	<u>47-103-03467</u>	