

JEFFERSONS WELL 17V TUG HILL OPERATING

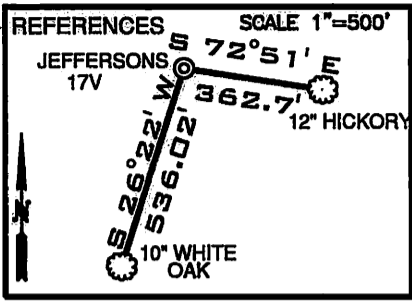

NOTES

1. NO WATER WELLS WITHIN 250' OF WELL WERE FOUND, NO DWELLINGS WITHIN 825' OF PAD CENTER WERE FOUND.
2. OWNERSHIP TAKEN FROM PUBLIC RECORDS OF WETZEL COUNTY, WV IN MARCH, 2019. COORDINATES AND WELL TIES BASED UPON DIFFERENTIAL GPS MEASUREMENTS.
3. WELL LOCATION REFERENCES ARE BASED UPON THE MAGNETIC MERIDIAN.
4. BOUNDARIES ALONG ROADWAYS ARE BASED UPON MEMORANDUM BY DICKIE, MCCAMEY & CHILCOTE, P.C. FILE 0058S04.0401147

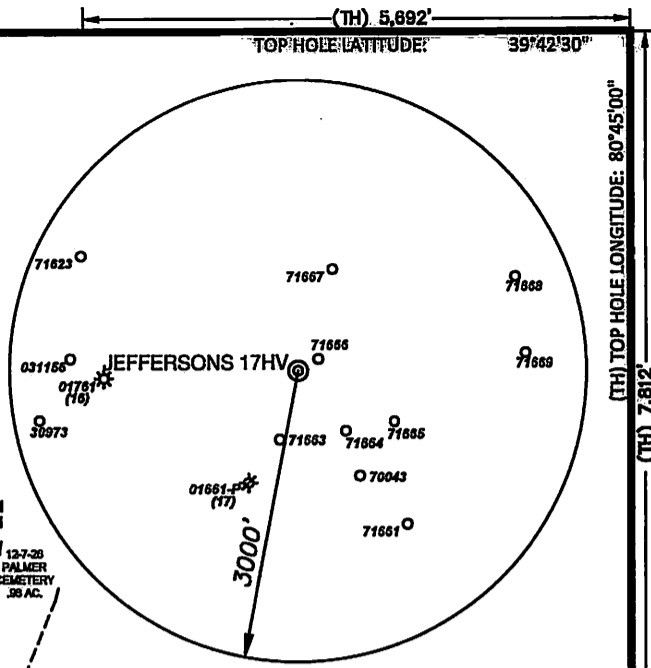

(*) DENOTES LOCATION ON UNITED STATES TOPOGRAPHIC MAPS

LEGEND	
---	SURFACE TRACTS
---	WELL LATERAL
----	UNIT BOUNDARY

SURFACE HOLE
UTM. NAD83, ZONE 17
IN METERS
N) 4,393,034.55
E) 519,719.57

DETAIL SKETCH "A"
N.T.S.

OJEFFERSONS 17V

FILE NUMBER _____
DRAWING NUMBER JEFFERSONS_17HV_REV
SCALE 1" = 500'
MINIMUM DEGREE OF ACCURACY 1/200
PROVEN SOURCE OF ELEVATION SUBMETER MAPPING
GRADE GPS

I, THE UNDERSIGNED, HEREBY CERTIFY THAT THIS PLAT IS CORRECT TO THE BEST OF MY KNOWLEDGE AND BELIEF AND SHOWS ALL THE INFORMATION REQUIRED BY LAW AND THE RULES ISSUED AND PRESCRIBED BY THE DEPARTMENT OF ENVIRONMENTAL PROTECTION

P.S. 708 *David L Jackson*



JACKSON SURVEYING INC.
P.O. Box 1460
Clarksburg, WV 26302
304-823-5851



WVDEP
OFFICE OF OIL & GAS
601 57TH STREET, SE
CHARLESTON, WV 25304

DATE: NOVEMBER 03, 2021

OPERATORS WELL NO. JEFFERSONS 17V
API WELL NO. _____

47-103-03473 H6A
STATE COUNTY PERMIT

LOCATION ELEVATION 1217.06' WATERSHED (HUC 10) PROCTOR CREEK OF FRENCH CREEK - OHIO RIVER (HUC-10)

DISTRICT PROCTOR COUNTY WETZEL

QUADRANGLE NEW MARTINSVILLE 7.5' LEASE NUMBER SEE WW-6A1 FORM

SURFACE OWNER EDWARD H. & JOAN E. ESTEP ACREAGE 92.302

OIL & GAS ROYALTY OWNER EDWARD H. & JOAN E. ESTEP LEASE ACREAGE 92.302

PROPOSED WORK: DRILL CONVERT DRILL DEEPER REDRILL FRACTURE OR STIMULATE PLUG OFF OLD FORMATION
PERFORATE NEW FORMATION OTHER PHYSICAL CHANGE (SPECIFY) _____

TARGET FORMATION MARCELLUS ESTIMATED DEPTH 6,764'

WELL OPERATOR TUG HILL OPERATING, LLC DESIGNATED AGENT DIANNA STAMPER
ADDRESS 1320 SOUTH UNIVERSITY DRIVE, SUITE 500 ADDRESS 5400 D BIG TYLER ROAD
FORT WORTH, TX 76107 CHARLESTON, WV 25313

COUNTY NAME
PERMIT

12/24/2021