



west virginia department of environmental protection

Office of Oil and Gas
601 57th Street, S.E.
Charleston, WV 25304
(304) 926-0450
fax: (304) 926-0452

Harold D. Ward, Cabinet Secretary
www.dep.wv.gov

Monday, August 22, 2022
PERMIT MODIFICATION APPROVAL
Horizontal 6A / New Drill

ANTERO RESOURCES CORPORATION
1615 WYNKOOP STREET

DENVER, CO 80202

Re: Permit Modification Approval for ECKLEBERRY 1H
47-103-03492-00-00

Lateral Extension

ANTERO RESOURCES CORPORATION

The Office of Oil and Gas has reviewed the attached permit modification for the above referenced permit. The attached modification has been approved and well work may begin. Please be reminded that the oil and gas inspector is to be notified twenty-four (24) hours before permitted well work is commenced.

If there are any questions, please feel free to contact me at (304) 926- 0450.

A blue ink signature of James A. Martin, written in a cursive style. Below the signature is a blue ink stamp.

James A. Martin
Chief

Operator's Well Number: ECKLEBERRY 1H
Farm Name: JAMES ALLEN SELL
U.S. WELL NUMBER: 47-103-03492-00-00
Horizontal 6A New Drill
Date Modification Issued: 08/22/2022

Promoting a healthy environment.

08/26/2022

ck # 4012201
a 2,500

STATE OF WEST VIRGINIA
DEPARTMENT OF ENVIRONMENTAL PROTECTION, OFFICE OF OIL AND GAS
WELL WORK PERMIT APPLICATION

1) Well Operator: Antero Resources Corporation 494507062 013-Wetzel Green Pine Grove 7.5
Operator ID County District Quadrangle

2) Operator's Well Number: Eckleberry Unit 1H MOD Well Pad Name: Furbee Pad

3) Farm Name/Surface Owner: James Allen Sell Public Road Access: Furbee Ridge Road

4) Elevation, current ground: 1240' Elevation, proposed post-construction: ~1212'

5) Well Type (a) Gas X Oil _____ Underground Storage _____

Other _____

(b) If Gas Shallow X Deep _____

Horizontal X _____

6) Existing Pad: Yes or No No

7) Proposed Target Formation(s), Depth(s), Anticipated Thickness and Expected Pressure(s):
Marcellus Shale: 7600' TVD, Anticipated Thickness- 55 feet, Associated Pressure- 2800#

8) Proposed Total Vertical Depth: 7600' TVD

9) Formation at Total Vertical Depth: Marcellus

10) Proposed Total Measured Depth: 26400' MD

11) Proposed Horizontal Leg Length: 15139.5'

12) Approximate Fresh Water Strata Depths: 575'

13) Method to Determine Fresh Water Depths: 47103308970000

14) Approximate Saltwater Depths: 2284'

15) Approximate Coal Seam Depths: 973'

16) Approximate Depth to Possible Void (coal mine, karst, other): None Anticipated

17) Does Proposed well location contain coal seams directly overlying or adjacent to an active mine? Yes _____ No X

(a) If Yes, provide Mine Info: Name: _____

Depth: _____

Seam: _____

Owner: _____

RECEIVED
Office of Oil and Gas

AUG 11 2022

WV Department of
Environmental Protection

WW-6B
(04/15)

API NO. 47- 103 - 03492
 OPERATOR WELL NO. Eckleberry Unit 1H MOD
 Well Pad Name: Furbee Pad

18)

CASING AND TUBING PROGRAM

TYPE	Size (in)	New or Used	Grade	Weight per ft. (lb/ft)	FOOTAGE: For Drilling (ft)	INTERVALS: Left in Well (ft)	CEMENT: Fill-up (Cu. Ft.)/CTS
Conductor	20"	New	H-40	79#	80	80	CTS, 77 Cu. Ft.
Fresh Water	13-3/8"	New	J/K-55	54.5#	625	625	CTS, 651 Cu. Ft.
Coal	9-5/8"	New	J/K-55	36#	2500	2500	CTS, 1018 Cu. Ft.
Intermediate							
Production	5-1/2"	New	P-110CY	20#	26400	26400	CTS, 5735 Cu. Ft.
Tubing	2-3/8"	New	N-80	4.7#			
Liners							

Donald L. Reynolds
8-19-22

TYPE	Size (in)	Wellbore Diameter (in)	Wall Thickness (in)	Burst Pressure (psi)	Anticipated Max. Internal Pressure (psi)	Cement Type	Cement Yield (cu. ft./k)
Conductor	20"	24"	0.375"	2250	50	Class A	~1.18
Fresh Water	13-3/8"	17-1/2"	0.38"	2730	1000	Class A	~1.18
Coal	9-5/8"	12-1/4"	0.352"	3520	1500	Class A	~1.18
Intermediate							
Production	5-1/2"	8-3/4" & 8-1/2"	0.415"	14,360	2500	Class G/H	~1.18
Tubing	2-3/8"	4.778"	0.19"	11,200			
Liners							

PACKERS



Kind:	N/A		
Sizes:	N/A		
Depths Set:	N/A		

19) Describe proposed well work, including the drilling and plugging back of any pilot hole:

Drill, perforate, fracture a new horizontal shallow well and complete Marcellus Shale.

*Antero will be air drilling the fresh water string which makes it difficult to determine when fresh water is encountered. Therefore, we have built in a buffer for the casing setting depth which helps to ensure that all fresh water zones are covered.

20) Describe fracturing/stimulating methods in detail, including anticipated max pressure and max rate:

Antero plans to pump Slickwater into the Marcellus Shale formation in order to ready the well for production. The fluid will be comprised of approximately 99 percent water and sand, with less than 1 percent special-purpose additives as shown in the attached "List of Anticipated Additives Used for Fracturing or Stimulating Well."

Anticipated Max Pressure - 9300 lbs
Anticipated Max Rate - 80 bpm

21) Total Area to be disturbed, including roads, stockpile area, pits, etc., (acres): 30.09 acres

22) Area to be disturbed for well pad only, less access road (acres): 13.86 acres

23) Describe centralizer placement for each casing string:

Conductor: no centralizers
Surface Casing: one centralizer 10' above the float shoe, one on the insert float collar and one every 4th joint spaced up the hole to surface.
Intermediate Casing: one centralizer above float joint, one centralizer 5' above float collar and one every 4th collar to surface.
Production Casing: one centralizer at shoe joint and one every 3 joints to top of cement in intermediate casing.

RECEIVED
Office of Oil and Gas

AUG 11 2022

24) Describe all cement additives associated with each cement type:

Conductor: no additives, Class A cement.
Surface: Class A cement with 2-3% calcium chloride and 1/4 lb of flake
Intermediate: Class A cement with 1/4 lb of flake, 5 gallons of clay treat
Production: Lead cement- 50/50 Class H/Poz + 1.5% salt + 1% C-45 + 0.5% C-16a + 0.2% C-12 + 0.45% C-20 + 0.05% C-51
Production: Tail cement- Class H + 45 PPS Calcium Carbonate + 1.0% FL-160 + 0.2% ACGB-47 + 0.05% ACSA-51 + 0.2% ACR-20

Environmental Protection

25) Proposed borehole conditioning procedures:

Conductor: blowhole clean with air, run casing, 10 bbls fresh water.
Surface: blowhole clean with air, trip to conductor shoe, trip to bottom, blowhole clean with air, trip out, run casing, circulate pipe capacity + 40 bbls fresh water followed by 25 bbls bentonite mud, 10 bbls fresh water spacer.
Intermediate: blowhole clean with air, trip to surface casing shoe, trip to bottom, blowhole clean with air, trip out, run casing, circulate 40 bbls brine water followed by 10 bbls fresh water and 25 bbls bentonite mud, pump 10 bbls fresh water.
Production: circulate with 14 lb/gal NaCl mud, trip to middle of lateral, circulate, pump high viscosity sweep, trip to base of curve, pump high viscosity sweep, trip to top of curve, trip to bottom, circulate, pump high viscosity sweep, trip out, run casing, circulate 10 bbls fresh water, pump 48 bbls barite pill, pump 10 bbls fresh water followed by 48 bbls mud flush and 10 bbls water.

*Note: Attach additional sheets as needed.

LEGEND

- ⊙ Proposed gas well
- ⊛ Existing Well, as noted
- ⊛ Digitized Well, as noted



The orientation of this survey is Grid North, and its coordinate base is the West Virginia Coordinate System of 1927, North Zone

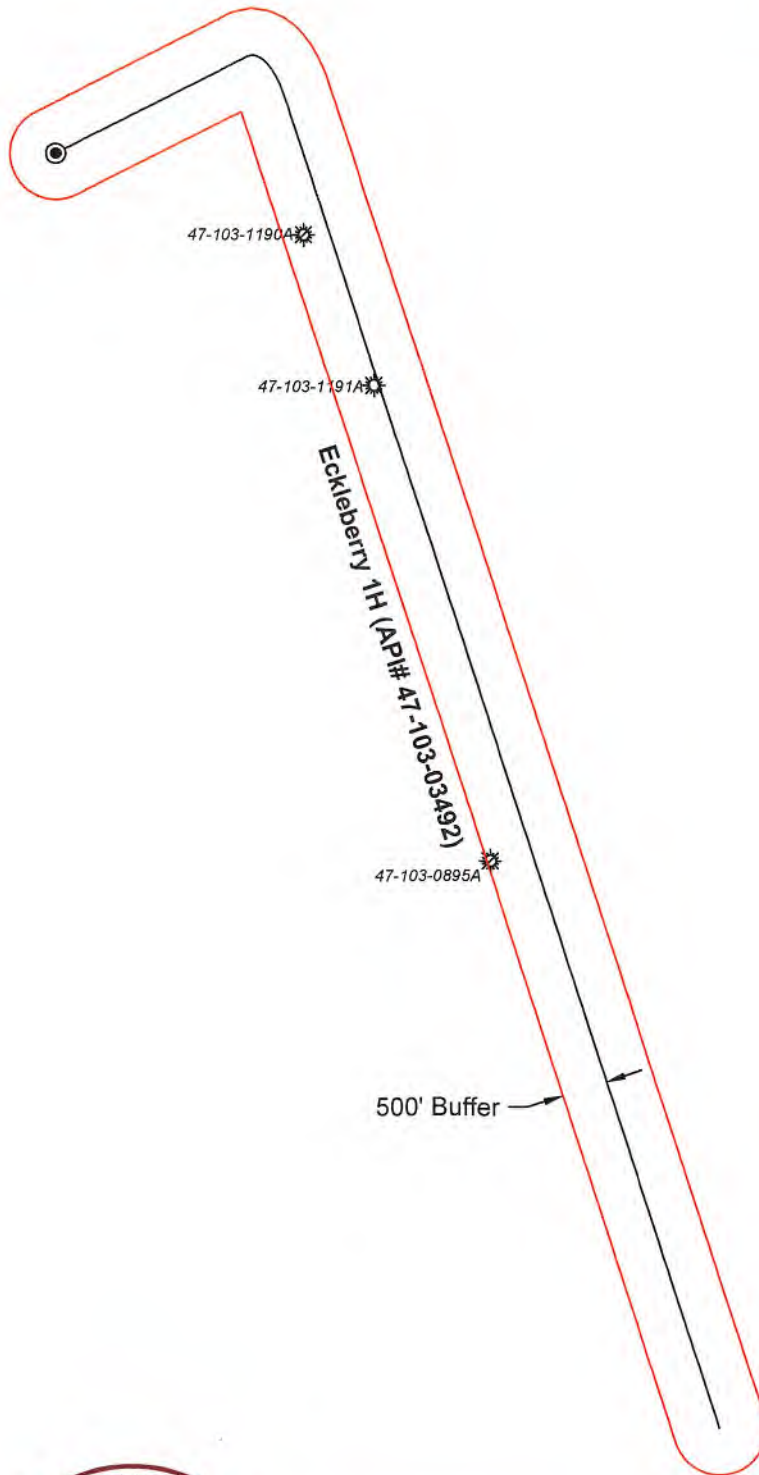

RECEIVED
Office of Oil and Gas

AUG 11 2022

WV Department of
Environmental Protection



Bridgeport Office
Phone: (304) 848-5035
Fax: (304) 848-5037

172 Thompson Drive
Bridgeport, WV 26330

PARTY CHIEF: C. Lynch	DRAWN BY: J. Smith
RESEARCH: J. Miller	PREPARED: August 4, 2022
SURVEYED: Dec. 2016	PROJECT NO: 120-34-G-18
FIELD CREW: C.L., K.M.	DRAWING NO: Eckleberry 1H BHLM AOR

Sheet 1 of 1



Scale: 1 inch = 2000 feet

08/26/2022

47 10 303 492

UWI (API Num)	Well Name	Well Number	Operator	Historical Operator	TD	Perforated Interval (shallowest, deepest)	Perforated Formation(s)	Producible Formation(s) not perf'd
47103311900000	F M STREIGHT ETAL 2	2457	MANUFACT LIGHT & HEAT	MANUFACT LIGHT & HEAT				
47103311910000	F M STREIGHT 1	1343	MANUFACT LIGHT & HEAT	MANUFACT LIGHT & HEAT				
47103308950000	AARON BASSETT	4223	HOPE NATURAL GAS	HOPE NATURAL GAS	2,804		Big Injun, Gordon	Weir, Benson, Alexander

RECEIVED
Office of Oil and Gas
AUG 11 2022
NY Department of
Environmental Protection

Antero Resources
Well No. Eckleberry 1H
BHL MOD
 Antero Resources Corporation



Proposed Well No. Eckleberry Unit 1H

Conc. Mons. L3 L4

Page 1 of 2

10,931' to Bottom Hole

6,519' to Top Hole

TOP HOLE LATITUDE 39 - 35 - 00
 BTM HOLE LATITUDE 39 - 32 - 30

Notes
 West Virginia Coordinate System of 1927, North Zone
 based upon Differential GPS Measurements
 Well No. Eckleberry Unit 1H Top Hole coordinates are
 N: 387,449.25' Latitude: 39°33'26.07"
 E: 1,652,795.48' Longitude: 80°43'53.25"
 Bottom Hole coordinates are
 N: 373,652.93' Latitude: 39°31'10.68"
 E: 1,659,953.69' Longitude: 80°42'19.49"
 UTM Zone 17, NAD 1983
 Top Hole Coordinates Bottom Hole Coordinates
 N: 4,378,660.562m N: 4,374,493.853m
 E: 523,085.425m E: 525,336.253m
 Plat orientation and corner and well references are based upon the grid north meridian
 Well location references are based upon the magnetic meridian.

TOP HOLE LONGITUDE 80 - 42 - 30
 BTM HOLE LONGITUDE 80 - 40 - 00

Well Location References (NTS)

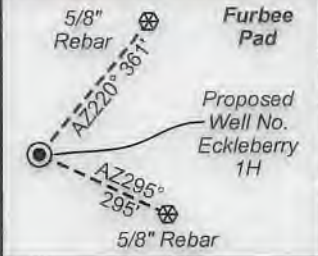

I, the undersigned, hereby certify that this plat is correct to the best of my knowledge and belief and shows all the information required by law and the rules issued and prescribed by the Department of Environmental Protection.

Bradley D. Miller, P.S. 2167



GRID NORTH
 SEAL

	Bearing	Dist.
L1	S 75°40' W	1,920.9'
L2	N 82°38' W	2,096.9'
L3	N 74°25' E	1,559.2'
L4	N 79°40' E	1,560.4'
L5	N 76°21' E	2,554.7'

- Legend**
- Proposed gas well
 - ⊕ Monument, as noted
 - ⊙ Existing Well, as noted
 - ⊙ Digitized Well, as noted
 - Creek or Drain
 - Road
 - Railroad Right-of-Way
 - Surface boundary (approx.)
 - Interior surface tracts (approx.)

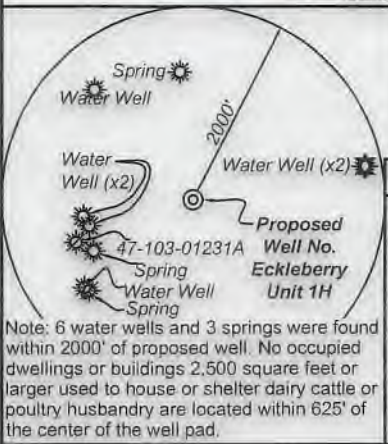

Note: 6 water wells and 3 springs were found within 2000' of proposed well. No occupied dwellings or buildings 2,500 square feet or larger used to house or shelter dairy cattle or poultry husbandry are located within 625' of the center of the well pad.

Notes:
 Well No. Eckleberry Unit 1H
 UTM Zone 17, NAD 1927
 Top Hole Coordinates
 N: 14,364,940.01'
 E: 1,716,107.82'
 Point of Entry Coordinates
 N: 14,365,584.18'
 E: 1,718,579.07'
 Bottom Hole Coordinates
 N: 14,351,269.66'
 E: 1,723,492.82'

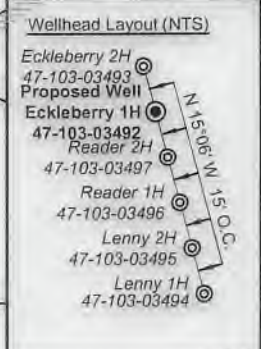

FILE NO: 120-34-G-18
 DRAWING NO: Eckleberry Unit 1H Well Plat
 SCALE: 1" = 2000'
 MINIMUM DEGREE OF ACCURACY: Submeter
 PROVEN SOURCE OF ELEVATION: WVDOT, Harrisville, WV

STATE OF WEST VIRGINIA
 DEPARTMENT OF ENVIRONMENTAL PROTECTION
OIL AND GAS DIVISION

DATE: August 9 20 22
 OPERATOR'S WELL NO. Eckleberry Unit 1H
 API WELL NO
 47 - 103 - 03492
 STATE COUNTY PERMIT

WELL TYPE: OIL GAS LIQUID INJECTION WASTE DISPOSAL
 (IF GAS) PRODUCTION: STORAGE DEEP SHALLOW
 LOCATION: ELEVATION: Existing 1240' Proposed 1212' WATERSHED: Fishing Creek QUADRANGLE: Pine Grove
 DISTRICT: Green James COUNTY: Wetzel
 SURFACE OWNER: A. Sell Shiben Estates, Inc.; Josephine Brast, et al; ACREAGE: 58.1 140.3333; 65.4875;
 ROYALTY OWNER: James Allen Sell; Marilyn Halley Seeley; Tribune Resources Minerals, LLC (3) LEASE NO: ACREAGE: 7.9; 203.163; 22;
 PROPOSED WORK: DRILL CONVERT DRILL DEEPER FRACTURE OR STIMULATE PLUG OFF OLD FORMATION
 PERFORATE NEW FORMATION OTHER PHYSICAL CHANGE IN WELL (SPECIFY) BHL_MOD
 PLUG AND ABANDON CLEAN OUT AND REPLUG TARGET FORMATION: Marcellus Shale ESTIMATED DEPTH: 7,600' TVD
 26,400' MD

WELL OPERATOR: Antero Resources Corporation DESIGNATED AGENT: Dianna Stamper - CT Corporation System
 ADDRESS: 1615 Wynkoop Street ADDRESS: 5400 D Big Tyler Road
 Denver, CO 80202 Charleston, WV 25313

08/26/2022



Leases	
A	James Allen Sell
B	William R. Stalnaker
C	Marilyn Halley Seeley
D	Tribune Resources Minerals, LLC
E	Linda Darlene Straight
F	Marcella K. Harrison
G	Tribune Resources Minerals, LLC
H	Shiben Estates, Inc.
I	AMP Fund II, LP
J	AMP Fund II, LP
K	Michael M. Holman
L	Tribune Resources Minerals, LLC
M	Robert G. Bassett, et ux
N	Tribune Resources Minerals, LLC
O	Josephine Brast, et al
P	Shiben Estates, Inc.

ID	TM-Par	Owner	Bk/Pg	Acres
1	17-12	James Allen Sell	370/148	58.10
2	17-60	Ross Bucher	411/765	79.00
3	17-1	James Allen Sell	370/148	15.35
4	13-71	Charles R. & Kay L. Blair	387/577	63.11
5	17-71.1	Clarence L. & Carol J. Lancaster	387/266	19.19
6	17-3.1	Bradford D. Highley	386/607	1.00
7	17-2	Clarence & Carol Lancaster	287/357	0.50
8	13-73	James Straight, et al	W57/427	14.60
9	13-78	Sebastian, Jr. & Marcella Harrison	281/94	25.37
10	17-4	James Straight	223/193	10.80
11	17-3	Bradford Highley	386/607	17.00
12	17-5	Coastal Forest Resources	444/105	90.00
13	17-14	Bradford Highley	386/607	18.53
14	17-14.2	Michael & Tammy Lemasters	384/10	2.18
15	17-14.1	Michael Lemasters	331/413	0.93
16	17-13	Russell & Carol Walls	416/637	1.53
17	17-19	Donna Bassett	299/614	19.10
18	17-19.4	Everett Haught	293/243	0.52
19	17-19.2	Everett Haught	428/118	0.15
20	17-19.1	Lloyd Bassett	270/106	0.35
21	17-19.5	Mitchel Eddy	415/429	0.24
22	17-19.3	Howard & Patricia Bassett	280/136	0.81
23	17-18	Samuel Highley	387/408	12.07
24	17-20	Heartland Forest Land Fund VII LP	431/936	123.50
25	17-27	Eliza Louiza Highley	303/352	2.70
26	17-29	Leslie & Georgia Bassett	319/394	66.00
27	17-38	Heartland Forest Land Fund VII, LP	431/936	60.00
28	17-31	Heartland Forest Land Fund VII, LP	431/936	120.33
29	17-49	Heartland Forest Land Fund VII, LP	431/936	20.90
30	17-50	EIP III, West Virginia LLC	463/193	69.00
31	20-14	Robert Bassett	371/32	126.74
32	20-14.4	Matthew D. Bassett, et al	421/365	97.18
33	20-14.2	Coastal Forest Resources Co.	444/105	37.40
34	20-14.1	Coastal Forest Resources Co.	444/105	49.25
35	20-21	Coastal Forest Resources Co.	444/105	29.00
36	20-15	Coastal Forest Resources Co.	444/105	198.00
37	20-20	Coastal Forest Resources Co.	444/105	26.00
38	20-37	Coastal Forest Resources Co.	444/105	246.84



FILE NO: 120-34-G-18
 DRAWING NO: Eckleberry Unit 1H Well Plat
 SCALE: 1" = 2000'
 MINIMUM DEGREE OF ACCURACY:
 Submeter
 PROVEN SOURCE OF ELEVATION:
 WVDOT, Harrisville, WV

STATE OF WEST VIRGINIA
 DEPARTMENT OF ENVIRONMENTAL PROTECTION
OIL AND GAS DIVISION

DATE: August 9 20 22
 OPERATOR'S WELL NO. Eckleberry Unit 1H
 API WELL NO
 47 - 103 - 03492
 STATE COUNTY PERMIT

WELL TYPE: OIL GAS LIQUID INJECTION WASTE DISPOSAL
 (IF GAS) PRODUCTION: STORAGE DEEP SHALLOW
 LOCATION: ELEVATION: Existing 1240' Proposed 1212' WATERSHED: Fishing Creek QUADRANGLE: Pine Grove
 DISTRICT: Green James COUNTY: Wetzel
 SURFACE OWNER: A. Sell Shiben Estates, Inc.; Josephine Brast, et al; ACREAGE: 58.1 140.3333; 65.4875;
 ROYALTY OWNER: James Allen Sell; Marilyn Halley Seeley; Tribune Resources Minerals, LLC (3) LEASE NO: ACRES: 257; 500; 300
 PROPOSED WORK: DRILL CONVERT DRILL DEEPER FRACTURE OR STIMULATE PLUG OFF OLD FORMATION
 PERFORATE NEW FORMATION OTHER PHYSICAL CHANGE IN WELL (SPECIFY) BHL_MOD 7,600' TVD
 PLUG AND ABANDON CLEAN OUT AND REPLUG TARGET FORMATION: Marcellus Shale ESTIMATED DEPTH: 26,400' MD

WELL OPERATOR: Antero Resources Corporation DESIGNATED AGENT: Dianna Stamper - CT Corporation System
 ADDRESS: 1615 Wynkoop Street ADDRESS: 5400 D Big Tyler Road
 Denver, CO 80202 Charleston, WV 25313

08/26/2022

Antero Resources
Well No. Eckleberry 1H
BHL MOD
 Antero Resources Corporation



Well Location References (NTS)

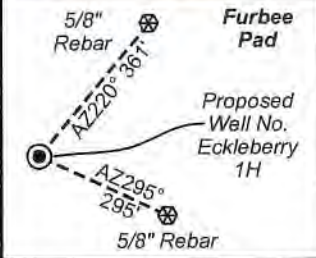

I, the undersigned, hereby certify that this plat is correct to the best of my knowledge and belief and shows all the information required by law and the rules issued and prescribed by the Department of Environmental Protection.

Bradley D. Miller
 Bradley D. Miller, P.S. 2167

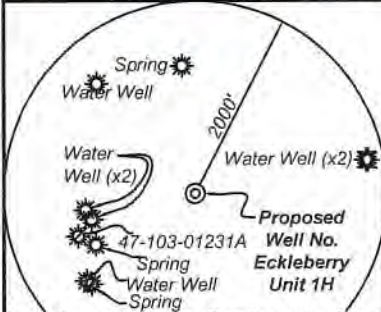

Note: 6 water wells and 3 springs were found within 2000' of proposed well. No occupied dwellings or buildings 2,500 square feet or larger used to house or shelter dairy cattle or poultry husbandry are located within 625' of the center of the well pad.

	Bearing	Dist.
L1	S 75°40' W	1,920.9'
L2	N 82°38' W	2,096.9'
L3	N 74°25' E	1,559.2'
L4	N 79°40' E	1,560.4'
L5	N 76°21' E	2,554.7'

- Legend
- Proposed gas well
 - Monument, as noted
 - Existing Well, as noted
 - Digitized Well, as noted
 - Creek or Drain
 - Road
 - Railroad Right-of-Way
 - Surface boundary (approx.)
 - Interior surface tracts (approx.)

FILE NO: 120-34-G-18
 DRAWING NO: Eckleberry Unit 1H Well Plat
 SCALE: 1" = 2000'
 MINIMUM DEGREE OF ACCURACY: Submeter
 PROVEN SOURCE OF ELEVATION: WVDOT, Harrisville, WV

STATE OF WEST VIRGINIA
 DEPARTMENT OF ENVIRONMENTAL PROTECTION
OIL AND GAS DIVISION

DATE: August 9 2022
 OPERATOR'S WELL NO. Eckleberry Unit 1H
 API WELL NO
 47 - 103 - 03492
 STATE COUNTY PERMIT

WELL TYPE: OIL GAS LIQUID INJECTION WASTE DISPOSAL
 (IF GAS) PRODUCTION: STORAGE DEEP SHALLOW
 LOCATION: ELEVATION: Existing 1240' Proposed 1212' WATERSHED: Fishing Creek QUADRANGLE: Pine Grove
 DISTRICT: Green James COUNTY: Wetzel
 SURFACE OWNER: A. Sell Shiben Estates, Inc.; Josephine Brast, et al; ACREAGE: 58.1
 ROYALTY OWNER: James Allen Sell; Marilyn Halley Seeley; Tribune Resources Minerals, LLC (3) LEASE NO: ACREAGE: 257; 500; 300
 PROPOSED WORK: DRILL CONVERT DRILL DEEPER FRACTURE OR STIMULATE PLUG OFF OLD FORMATION
 PERFORATE NEW FORMATION OTHER PHYSICAL CHANGE IN WELL (SPECIFY) BHL_MOD
 PLUG AND ABANDON CLEAN OUT AND REPLUG TARGET FORMATION: Marcellus Shale ESTIMATED DEPTH: 7,600' TVD
 26,400' MD

WELL OPERATOR: Antero Resources Corporation DESIGNATED AGENT: Dianna Stamper - CT Corporation System
 ADDRESS: 1615 Wynkoop Street ADDRESS: 5400 D Big Tyler Road
 Denver, CO 80202 Charleston, WV 25313

Notes
 West Virginia Coordinate System of 1927, North Zone based upon Differential GPS Measurements.
 Well No. Eckleberry Unit 1H Top Hole coordinates are
 N: 387,449.25' Latitude: 39°33'26.07"
 E: 1,652,795.48' Longitude: 80°43'53.25"
 Bottom Hole coordinates are
 N: 373,652.93' Latitude: 39°31'10.68"
 E: 1,659,953.69' Longitude: 80°42'19.49"
 UTM Zone 17, NAD 1983
 Top Hole Coordinates Bottom Hole Coordinates
 N: 4,378,660.562m N: 4,374,493.853m
 E: 523,085.425m E: 525,336.253m
 Plat orientation and corner and well references are based upon the grid north meridian.
 Well location references are based upon the magnetic meridian.

Notes:
 Well No. Eckleberry Unit 1H UTM Zone 17, NAD 1927
 Top Hole Coordinates
 N: 14,364,940.01'
 E: 1,716,107.82'
 Point of Entry Coordinates
 N: 14,365,584.18'
 E: 1,718,579.07'
 Bottom Hole Coordinates
 N: 14,351,269.66'
 E: 1,723,492.82'

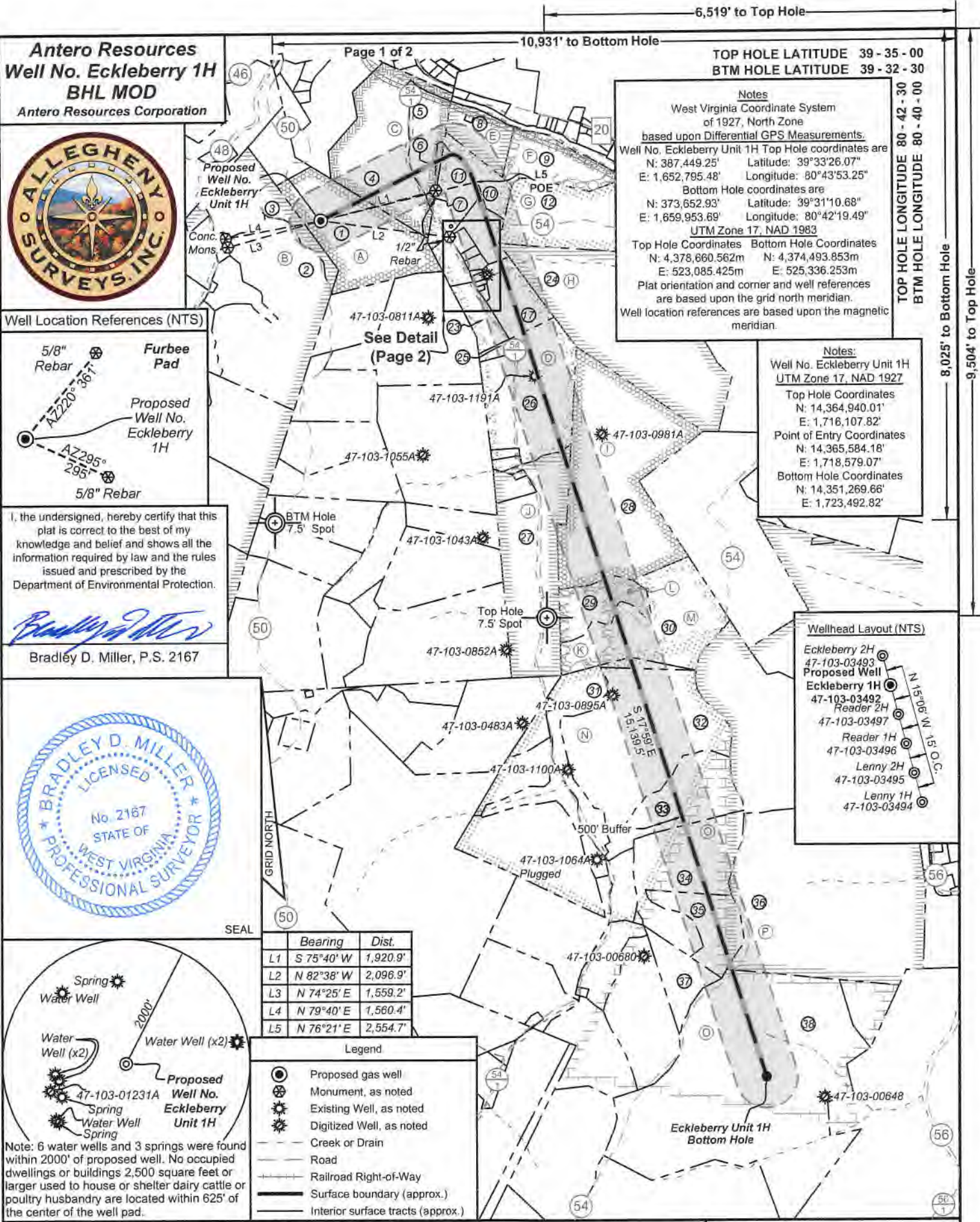
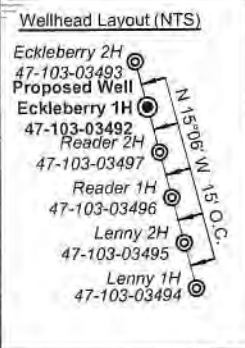

6,519' to Top Hole

10,931' to Bottom Hole

TOP HOLE LATITUDE 39 - 35 - 00
 BTM HOLE LATITUDE 39 - 32 - 30

TOP HOLE LONGITUDE 80 - 42 - 30
 BTM HOLE LONGITUDE 80 - 40 - 00

8,025' to Bottom Hole
 9,504' to Top Hole

08/26/2022



Leases	
A	James Allen Sell
B	William R. Stalnaker
C	Marilyn Halley Seeley
D	Tribune Resources Minerals, LLC
E	Linda Darlene Straight
F	Marcella K. Harrison
G	Tribune Resources Minerals, LLC
H	Shiben Estates, Inc.
I	AMP Fund II, LP
J	AMP Fund II, LP
K	Michael M. Holman
L	Tribune Resources Minerals, LLC
M	Robert G. Bassett, et ux
N	Tribune Resources Minerals, LLC
O	Josephine Brast, et al
P	Shiben Estates, Inc.

ID	TM-Par	Owner	Bk/Pg	Acres
1	17-12	James Allen Sell	370/148	58.10
2	17-60	Ross Bucher	411/765	79.00
3	17-1	James Allen Sell	370/148	15.35
4	13-71	Charles R. & Kay L. Blair	387/577	63.11
5	17-71.1	Clarence L. & Carol J. Lancaster	387/266	19.19
6	17-3.1	Bradford D. Highley	386/607	1.00
7	17-2	Clarence & Carol Lancaster	287/357	0.50
8	13-73	James Straight, et al	W57/427	14.60
9	13-78	Sebastian, Jr. & Marcella Harrison	281/94	25.37
10	17-4	James Straight	223/193	10.80
11	17-3	Bradford Highley	386/607	17.00
12	17-5	Coastal Forest Resources	444/105	90.00
13	17-14	Bradford Highley	386/607	18.53
14	17-14.2	Michael & Tammy Lemasters	384/10	2.18
15	17-14.1	Michael Lemasters	331/413	0.93
16	17-13	Russell & Carol Walls	416/637	1.53
17	17-19	Donna Bassett	299/614	19.10
18	17-19.4	Everett Haught	293/243	0.52
19	17-19.2	Everett Haught	428/118	0.15
20	17-19.1	Lloyd Bassett	270/106	0.35
21	17-19.5	Mitche Eddy	415/429	0.24
22	17-19.3	Howard & Patricia Bassett	280/136	0.81
23	17-18	Samuel Highley	387/408	12.07
24	17-20	Heartland Forest Land Fund VII LP	431/936	123.50
25	17-27	Eliza Louiza Highley	303/352	2.70
26	17-29	Leslie & Georgia Bassett	319/394	66.00
27	17-38	Heartland Forest Land Fund VII, LP	431/936	60.00
28	17-31	Heartland Forest Land Fund VII, LP	431/936	120.33
29	17-49	Heartland Forest Land Fund VII, LP	431/936	20.90
30	17-50	EIP III, West Virginia LLC	463/193	69.00
31	20-14	Robert Bassett	371/32	126.74
32	20-14.4	Matthew D. Bassett, et al	421/365	97.18
33	20-14.2	Coastal Forest Resources Co.	444/105	37.40
34	20-14.1	Coastal Forest Resources Co.	444/105	49.25
35	20-21	Coastal Forest Resources Co.	444/105	29.00
36	20-15	Coastal Forest Resources Co.	444/105	198.00
37	20-20	Coastal Forest Resources Co.	444/105	26.00
38	20-37	Coastal Forest Resources Co.	444/105	246.84

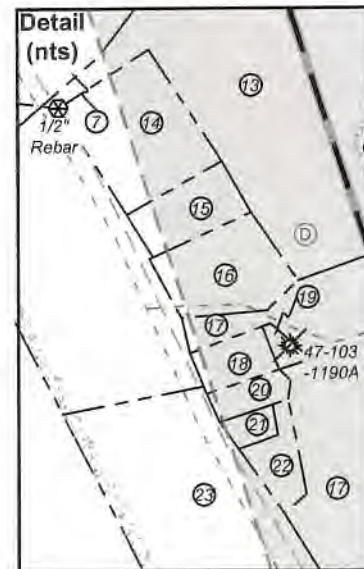

FILE NO: 120-34-G-18
 DRAWING NO: Eckleberry Unit 1H Well Plat
 SCALE: 1" = 2000'
 MINIMUM DEGREE OF ACCURACY:
 Submeter
 PROVEN SOURCE OF ELEVATION:
 WVDOT, Harrisville, WV

STATE OF WEST VIRGINIA
 DEPARTMENT OF ENVIRONMENTAL PROTECTION
OIL AND GAS DIVISION

DATE: August 9 20 22
 OPERATOR'S WELL NO. Eckleberry Unit 1H
 API WELL NO
 47 - 103 - 03492
 STATE COUNTY PERMIT

WELL TYPE: OIL GAS LIQUID INJECTION WASTE DISPOSAL
 (IF GAS) PRODUCTION: STORAGE DEEP SHALLOW
 Proposed 1212'
 LOCATION: ELEVATION: Existing 1240' WATERSHED: Fishing Creek QUADRANGLE: Pine Grove
 DISTRICT: Green James COUNTY: Wetzel
 SURFACE OWNER: A. Sell Shiben Estates, Inc.; Josephine Brast, et al; ACREAGE: 58.1
 ROYALTY OWNER: James Allen Sell; Marilyn Halley Seeley; Tribune Resources Minerals, LLC (3) LEASE NO: ACREAGE: 257; 500; 300
 PROPOSED WORK: DRILL CONVERT DRILL DEEPER FRACTURE OR STIMULATE PLUG OFF OLD FORMATION
 PERFORATE NEW FORMATION OTHER PHYSICAL CHANGE IN WELL (SPECIFY) BHL_MOD 7,600' TVD
 PLUG AND ABANDON CLEAN OUT AND REPLUG TARGET FORMATION: Marcellus Shale ESTIMATED DEPTH: 26,400' MD

WELL OPERATOR: Antero Resources Corporation DESIGNATED AGENT: Dianna Stamper - CT Corporation System
 ADDRESS: 1615 Wynkoop Street ADDRESS: 5400 D Big Tyler Road
 Denver, CO 80202 Charleston, WV 25313

08/26/2022

WW-6A1

Operator's Well Number Eckleberry Unit 1H MOD

INFORMATION SUPPLIED UNDER WEST VIRGINIA CODE
Chapter 22, Article 6A, Section 5(a)(5)
IN LIEU OF FILING LEASE(S) AND OTHER CONTINUING CONTRACT(S)

Under the oath required to make the verification on page 1 of this Notice and Application, I depose and say that I am the person who signed the Notice and Application for the Applicant, and that –

- (1) the tract of land is the same tract described in this Application, partly or wholly depicted in the accompanying plat, and described in the Construction and Reclamation Plan;
- (2) the parties and recordation data (if recorded) for lease(s) or other continuing contract(s) by which the Applicant claims the right to extract, produce or market the oil or gas are as follows:

Grantor, lessor, etc.	Grantee, lessee, etc.	Royalty	Book/Page
<u>A: James Allen Sell Lease</u> James Allen Sell	Antero Resources Corporation	1/8+	258A/0467
<u>C: Marilyn Halley Seeley Lease</u> Marilyn Halley Seeley EQT Production Company	EQT Production Company Antero Resources Corporation	1/8 Assignment	148A/0831 230A/0801
<u>D: Tribune Resources Minerals, LLC Lease</u> Tribune Resources Minerals, LLC Tribune Resources, LLC	Tribune Resources, LLC Antero Resources Corporation	1/8 Assignment	218A/0791 219A/0322
<u>H: Shiben Estates, Inc Lease</u> Shiben Estates, Inc.	Antero Resources Corporation	1/8+	202A/0238
<u>D: Tribune Resources Minerals, LLC Lease</u> Tribune Resources Minerals, LLC Tribune Resources, LLC	Tribune Resources, LLC Antero Resources Corporation	1/8 Assignment	218A/0791 219A/0322
<u>J: AMP Fund II, LP Lease</u> AMP Fund II, LP	Antero Resources Corporation	1/8+	255A/0685
<u>I: AMP Fund II, LP Lease</u> AMP Fund II, LP	Antero Resources Corporation	1/8+	255A/0685
<u>K: Michael M. Holman Lease</u> Michael M. Holman	Antero Resources Corporation	1/8+	247A/0722
<u>L: Tribune Resources Minerals, LLC Lease</u> Tribune Resources Minerals, LLC Tribune Resources, LLC	Tribune Resources, LLC Antero Resources Corporation	1/8 Assignment	218A/0797 219A/0322
<u>M: Robert G. Bassett, et ux Lease</u> Robert G. Bassett, et ux	Antero Resources Corporation	1/8+	212A/0094
<u>N: Tribune Resources Minerals, LLC Lease</u> Tribune Resources Minerals, LLC Tribune Resources, LLC	Tribune Resources, LLC Antero Resources Corporation	1/8+ Assignment	218A/0803 219A/0322
<u>O: Josephine Brast, et al Lease</u> Josephine Brast, et al South Penn Oil Co. Hope Natural Gas Company Hope Natural Gas Company Consolidated Gas Supply Corporation Consolidated Gas Supply Corporation Consolidated Gas Transmission Corporation	South Penn Oil Co. Hope Natural Gas Company Consolidated Gas Supply Corporation Consolidated Gas Transmission Corporation CNG Transmission Corporation	1/8 Assignment Assignment Assignment Name Change	0049/0591 009A/0230 0233/0387 066A/0069 012/0121

RECEIVED
Office of Oil and Gas
AUG 11 2022
West Virginia Department of
Environmental Protection

08/26/2022

WW-6A1

Operator's Well Number Eckleberry Unit 1H MOD

INFORMATION SUPPLIED UNDER WEST VIRGINIA CODE
Chapter 22, Article 6A, Section 5(a)(5)
IN LIEU OF FILING LEASE(S) AND OTHER CONTINUING CONTRACT(S)

Under the oath required to make the verification on page 1 of this Notice and Application, I depose and say that I am the person who signed the Notice and Application for the Applicant, and that –

- (1) the tract of land is the same tract described in this Application, partly or wholly depicted in the accompanying plat, and described in the Construction and Reclamation Plan;
- (2) the parties and recordation data (if recorded) for lease(s) or other continuing contract(s) by which the Applicant claims the right to extract, produce or market the oil or gas are as follows:

Grantor, lessor, etc.	Grantee, lessee, etc.	Royalty	Book/Page
CNG Transmission Corporation	Eastern States Oil & Gas Inc	Assignment	076A/0232
Eastern States Oil & Gas Inc	Equitable Production-Eastern States Inc	Name Change	0013/0014
Equitable Production-Eastern States Inc	Equitable Production Company	Merger	0013/0014
Equitable Production Company	EQT Production Company	Name Change	0013/0014
EQT Production Company	Tribune Resources, LLC	Assignment	179A/0653
Tribune Resources, LLC	Antero Resources Corporation	Assignment	219A/0322
<u>P: Shiben Estates, Inc. Lease</u>			
Shiben Estates, Inc.	Antero Resources Corporation	1/8+	198A/0540

RECEIVED
Office of Oil and Gas

AUG 11 2022

WV Department of
Environmental Protection

*Partial Assignments to Antero Resources Corporation include 100% rights to extract, produce and market the oil and gas from the Marcellus and any other formations completed with this well.

08/26/2022

WW-6A1
(5/13)

Operator's Well No. Eckleberry Unit 1H MOD

**INFORMATION SUPPLIED UNDER WEST VIRGINIA CODE
Chapter 22, Article 6A, Section 5(a)(5)
IN LIEU OF FILING LEASE(S) AND OTHER CONTINUING CONTRACT(S)**

Under the oath required to make the verification on page 1 of this Notice and Application, I depose and say that I am the person who signed the Notice and Application for the Applicant, and that –

- (1) the tract of land is the same tract described in this Application, partly or wholly depicted in the accompanying plat, and described in the Construction and Reclamation Plan;
- (2) the parties and recordation data (if recorded) for lease(s) or other continuing contract(s) by which the Applicant claims the right to extract, produce or market the oil or gas are as follows:

Lease Name or Number	Grantor, Lessor, etc.	Grantee, Lessee, etc.	Royalty	Book/Page
O: Josephine Brast, et al Lease				
	Josephine Brast, et al	South Penn Oil Co.	1/8	0049/0591
	South Penn Oil Co.	Hope Natural Gas Company	Assignment	009A/0230
	Hope Natural Gas Company	Consolidated Gas Supply Corporation	Assignment	0233/0387
	Consolidated Gas Supply Corporation	Consolidated Gas Transmission Corporation	Assignment	066A/0069
	Consolidated Gas Transmission Corporation	CNG Transmission Corporation	Name Change	0013/0151
	CNG Transmission Corporation	Eastern States Oil & Gas Inc	Assignment	076A/0232
	Eastern States Oil & Gas Inc	Equitable Production-Eastern States Inc	Name Change	0013/0014
	Equitable Production-Eastern States Inc	Equitable Production Company	Merger	0013/0014
	Equitable Production Company	EQT Production Company	Name Change	0013/0014
	EQT Production Company	Tribune Resources, LLC	Assignment	179A/0653
	Tribune Resources, LLC	Antero Resources Corporation	Assignment	219A/0322

*Partial Assignments to Antero Resources Corporation include 100% rights to extract, produce and market the oil and gas from the Marcellus and any other formations completed with this well.

- WV Division of Water and Waste Management
- WV Division of Natural Resources WV Division of Highways
- U.S. Army Corps of Engineers
- U.S. Fish and Wildlife Service
- County Floodplain Coordinator

RECEIVED
Office of Oil and Gas

AUG 11 2022

WV Department of
Environmental Protection

The applicant further acknowledges that any Office of Oil and Gas permit in no way overrides, replaces, or nullifies the need for other permits/approvals that may be necessary and further affirms that all needed permits/approvals should be acquired from the appropriate authority before the affected activity is initiated.

Well Operator: Antero Resources Corporation
 By: Tim Rady
 Its: Senior VP of Land



August 10, 2022

Antero Resources
1615 Wynkoop Street
Denver, CO 80202
Office 303.357.7310
Fax 303.357.7315

West Virginia Department of Environmental Protection
Office of Oil and Gas
Attn: Mr. Taylor Brewer
601 57th Street
Charleston, WV 25304

Mr. Brewer:

Antero Resources Corporation (Antero) would like to submit the following permit modifications for approved wells on the existing Furbee Pad; Eckleberry Unit 1H, Lenny Unit 1H-2H and Reader Unit 1H-2H.

Attached you will find the following:

- Revised Form WW-6B
- Revised Form WW-6A1
- Revised Mylar Plat
- AOR

If you have any questions please feel free to contact me at (303) 357-6961.

Thank you in advance for your consideration.

Sincerely,

A handwritten signature in blue ink that reads "Diane Blair".

Diane Blair
Permitting Agent
Antero Resources Corporation

Enclosures

RECEIVED
Office of Oil and Gas
AUG 11 2022
WV Department of
Environmental Protection

08/26/2022



Stansberry, Wade A <wade.a.stansberry@wv.gov>

Modification Horizontal H6A Well Work Permits API: (47-103-03492, 03494, 03495, 03496, & 03497)

1 message

Stansberry, Wade A <wade.a.stansberry@wv.gov>

Tue, Aug 23, 2022 at 5:53 PM

To: Mallory Stanton <mstanton@anteroresources.com>, Diane Blair <dblair@anteroresources.com>, Dani DeVito <ddevito@shalepro.com>, Scott Lemley <slemley@wvassessor.com>, "Greynolds, Kenneth L" <kenneth.l.greynolds@wv.gov>

I have attached a copy of the newly issued well [permit](#) numbers:

47-103-03492 - ECKLEBERRY UNIT 1H
47-103-03494 - LENNY UNIT 1H
47-103-03495 - LENNY UNIT 2H
47-103-03496 - READER 1H
47-103-03497 - READER 2H

These will serve as your copy.

Thank you,

Wade A. Stansberry

Environmental Resource Specialist 3

West Virginia Department of Environmental Protection

Office of Oil & Gas

601 57th St. SE





Charleston, WV 25304

(304) 926-0499 ext. 41115

(304) 926-0452 fax

Wade.A.Stansberry@wv.gov

5 attachments

-  **47-103-03492 - mod.pdf**
1310K
-  **47-103-03494 - mod.pdf**
1287K
-  **47-103-03495 - mod.pdf**
1225K
-  **47-103-03496 - mod.pdf**
1243K
-  **47-103-03497 -mod.pdf**
1185K

08/26/2022