

**ELMER LEASE
WELL N-14HU
472.7041 ± ACRES**

(BH) 7,123' (TH) 8,285'

TOP HOLE LATITUDE: 39°42'30"
BOTTOM HOLE LATITUDE: 39°45'00"

(BH) BOTTOM HOLE LONGITUDE: 80°45'00"
(TH) TOP HOLE LONGITUDE: 80°42'30"

(BH) 6,546' (TH) 5,274'



NOTE: L.P.1 and LTP are same point.

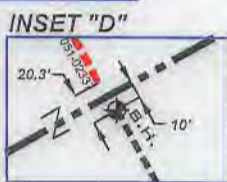
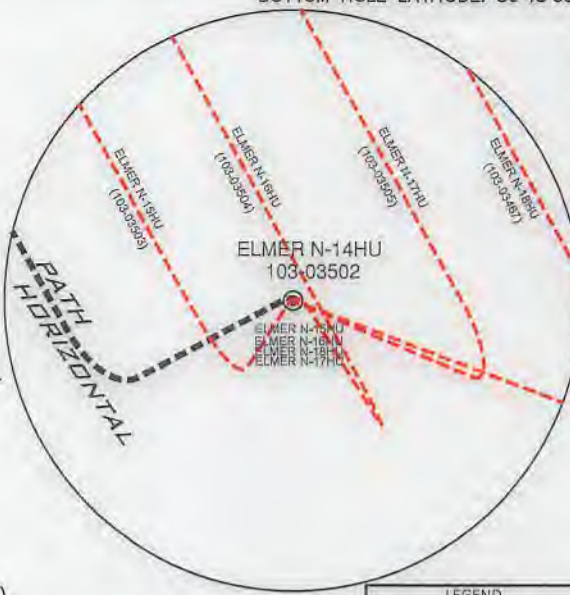

(+) DENOTES LOCATION ON UNITED STATES TOPOGRAPHIC MAPS

NOTES

1. BORE PATH BASED ON GRID NORTH.
2. NO WATER WELLS WITHIN 250' OF WELL WERE FOUND, NO DWELLINGS WITHIN 625' OF PAD CENTER WERE FOUND.
3. OWNERSHIP TAKEN FROM PUBLIC RECORDS OF WETZEL COUNTY, WV IN JULY, 2022.
4. COORDINATES AND WELL TIES BASED UPON DIFFERENTIAL GPS MEASUREMENTS.
5. WELL LOCATION REFERENCES ARE BASED UPON THE MAGNETIC MERIDIAN.
6. ALL DEEP WELLS WITHIN 1,000' ARE SHOWN ON THIS PLAT.
7. BOUNDARIES ALONG ROADWAYS ARE BASED UPON MEMORANDUM BY DICKIE, MCCAMEY & CHILCOOTE, P.C. FILE 0058304.0401147

LEGEND

- LEASED TRACTS
- SURFACE TRACTS
- WELL LATERAL
- POINT PLEASANT LEGS
- UNIT BOUNDARY
- LEASE # (SEE 6A1 FORM)
- 400' BORE PATH OFFSET
- 500' WELL BORE OFFSET
- (FTP) PROPOSED FIRST TAKE POINT
- (LTP) PROPOSED LAST TAKE POINT
- FORCED POOL TRACT

SURFACE HOLE
UTM. NAD83, ZONE 17
IN METERS
N) 4,393,822.46
E) 522,498.07

LANDING POINT 1
UTM. NAD83, ZONE 17
IN METERS
N) 4,393,719.48
E) 521,782.84

BOTTOM HOLE
UTM. NAD83, ZONE 17
IN METERS
N) 4,398,045.80
E) 519,269.82

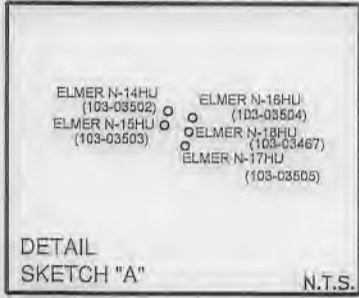

Deep Wells Within 2400' of Proposed Well's Surface Location and/or 500' of Well Lateral

API	OPERATOR
47-051-02337	Tug Hill Operating, LLC
47-103-03467	Tug Hill Operating, LLC
47-103-03505	Tug Hill Operating, LLC
47-103-03504	Tug Hill Operating, LLC
47-103-03503	Tug Hill Operating, LLC

LINE	BEARING	DISTANCE
L1	N 42°32' E	1843.03'
L2	N 67°54' E	1408.38'
L3	S 64°03' W	82.82'
L4	S 61°58' W	1,751.73'

CURVE	CHORD BEARING	CHORD LENGTH	RADIUS	ARC LENGTH
C1	S 77°42' W	142.75'	265.88'	144.51'
C2	N 73°35' W	182.23'	404.26'	183.81'
C3	N 53°07' W	227.81'	762.38'	228.67'
C4	N 38°45' W	423.64'	1448.81'	425.16'

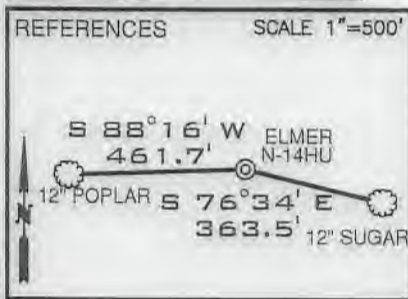

FILE NUMBER _____

DRAWING NUMBER ELMER_N-14HU_REV1

SCALE 1" = 2000'

MINIMUM DEGREE OF ACCURACY 1/200

PROVEN SOURCE OF ELEVATION SUBMETER MAPPING
GRADE GPS

I, THE UNDERSIGNED, HEREBY CERTIFY THAT THIS PLAT IS CORRECT TO THE BEST OF MY KNOWLEDGE AND BELIEF AND SHOWS ALL THE INFORMATION REQUIRED BY LAW AND THE RULES ISSUED AND PRESCRIBED BY THE DEPARTMENT OF ENVIRONMENTAL PROTECTION

P.S. 708
David L Jackson



JACKSON SURVEYING INC.
P.O. Box 1460
Clarksburg, WV 26302
304-623-5851

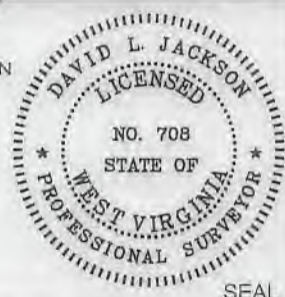

WVDEP
OFFICE OF OIL & GAS
601 57TH STREET, SE
CHARLESTON, WV 25304

WELL TYPE: OIL ___ GAS X LIQUID INJECTION ___ WASTE DISPOSAL ___
(IF "GAS") PRODUCTION X STORAGE ___ DEEP X SHALLOW ___

LOCATION ELEVATION 1276.50' WATERSHED (HUC 10) PROCTOR CREEK OF FRENCH CREEK - OHIO RIVER (HUC-10)

DISTRICT PROCTOR COUNTY WETZEL

QUADRANGLE WILEYVILLE 7.5' LEASE NUMBER SEE WW-6A1 FORM

SURFACE OWNER ELNORA TUTTLE HRS ACREAGE 39.19

OIL & GAS ROYALTY OWNER HENRY & NANCY GARNER - SEE WW-6A1 LEASE ACREAGE 39.19

PROPOSED WORK: DRILL X CONVERT ___ DRILL DEEPER ___ REDRILL ___ FRACTURE OR STIMULATE X PLUG OFF OLD FORMATION ___
PERFORATE NEW FORMATION ___ OTHER PHYSICAL CHANGE (SPECIFY) _____

TARGET FORMATION POINT PLEASANT ESTIMATED DEPTH TVD: 11,871' TMD: 29,065'

WELL OPERATOR TUG HILL OPERATING, LLC DESIGNATED AGENT DARREN BROWN, CT CORP

ADDRESS 1320 SOUTH UNIVERSITY DRIVE, SUITE 500 FORT WORTH, TX 76107 ADDRESS 5098 WASHINGTON STREET WEST, SUITE 407 CHARLESTON, WV 25313-1561

10/21/2022

COMPLY NAME PERMIT

form wwg

ELMER LEASE WELL N-14HU 472.7041 ± ACRES

LEGEND

- LEASED TRACTS
- - - SURFACE TRACTS
- - - WELL LATERAL
- - - POINT PLEASANT LEGS
- - - UNIT BOUNDARY
- (A) LEASE # (SEE 6AL FORM)
- 400' BORE PATH OFFSET
- 500' WELL BORE OFFSET
- (FTP) PROPOSED FIRST TAKE POINT
- (LTP) PROPOSED LAST TAKE POINT
- ▨ FORCED POOL TRACT

SCALE 1" = 2000'

Note: Tracts Q & V are forced pooled tracts

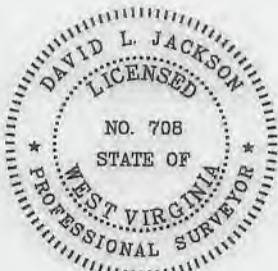

P.S. 708 *David L Jackson*

10/21/2022



TUG HILL OPERATING

OPERATOR'S
WELL #: ELMER N-14HU
DISTRICT: Proctor
COUNTY: Wetzel
STATE: WV **MOD**
API #: 47-103-03502

WELL PLAT
PAGE 2 OF 4
DATE: 09/26/2022
REVISED DATE:
09/28/2022

form ww6

**ELMER LEASE
WELL N-14HU
472.7041± ACRES**

Tags	Number	Tax Map -Parcel	Surface Owner	Acres
A	S1	12-8-15	ELNORA TUTTLE HRS	39.19
	S2	12-8-20.5	JOE MILLER, GERALD & SUE YEATER	44.85
C	S3	12-8-1	R. SHANE & KATHRYN GODDARD	77
G	S4	12-7-13.1	WAYNE PAUL GODDARD	18
I	S5	12-2-22.2	DAVID A. & MANDY L. TRUJEX	1.186
H	S6	12-7-11	JOSEPH R. VILLERS	1.5
J	S7	12-7-12	JOSEPH R. VILLERS	1.6
N	S8	12-3-24.4	SHARON HOWELL ET AL: GLORIA A. NICE - L/E	0.422
M	S9	12-3-23.6	KENNETH W. GODDARD	0.766
L	S10	12-3-23.1	KENNETH W. GODDARD	0.36
K	S11	12-3-26.1	JOSEPH MARK KLUG	3.242
	S12	12-3-27	CATHY A. PURPURA	0.227
O	S13	12-2-23	DAVID A. NICE	21.7
P	S14	12-2-21.1	DAVID A. NICE	54.66
Q	S15	12-2-21	MICHAEL KENNETH & ROSETTA ANNETTE COZART	11.4
T	S16	12-2-32	BERYL E. MASON	59.9
U	S17	12-2-13	JAY S. BOOTH; DANIEL T. BOOTH & DJANE BETH OVERDORFF	100
	S18	12-2-14	DAVID L. CUNNINGHAM	56.23
W	S19	12-2-14.2	JOHN G. JR & GERALDINE M. ROGERS	22.007
X	S20	12-2-14.1	SAMMY J. GREATHOUSE JR. : SAMMY J. GREATHOUSE SR. - L/E	18.67
	S21	05-25-11.4	EDWARD W. KLUG, ETUX	32.787
Y	S22	05-25-15	ROBERT S. KELLER, ETAL	15.073
Z	S23	12-2-14.3	QUENNA BENNETT	3.093
	S24	05-25-16.1	DAVID L. CUNNINGHAM	6.34
	S25	05-25-16.2	RODNEY J. LOY	1.087
BB	S26	05-26-12.1	ALVIN F. JR. & KRISTA R. STONEKING	2.011
EE	S27	05-25-17	CRAIG & ASHLEY FERRELL	22.79
DD	S28	05-25-18	JOSEPH JOHNSON, ETUX - LIFE	37.746
CC	S29	05-26-11	MARK A. YOHO	89.25
	S30	05-25-18.1	PAMELA JOAN FERRELL, ET VIR	2.491
	S31	05-25-19	JOSEPH JOHNSON ET UX - LIFE	1.973
FF	S32	05-26-8	RICHARD J. OTTE	18.27
GG	S33	05-26-20	RICHARD J. OTTE	4.2
	S34	05-23-11.5	ZACHARY R. STEVEN	7
	S35	05-23-11.8	ROY F. YOHO	2.25
	S36	05-23-11.3	COLIN R. YOHO	11.29
	S37	05-23-11.4	EVELYN L. HUDSON	10.879
	S38	05-23-13.1	JAMES R. & PAMELA J. FERRELL	0.7625
JJ	S39	05-23-13	LINDA D. GREATHOUSE	14.24
II	S40	05-23-12	MARK A. YOHO	3.05
HH	S41	05-23-9.1	JOHN W. VAN ORDEN, ETUX	23.376
	S42	05-23-9.4	JACKSON R. DAVIS, JR.	2.087
KK	S43	05-23-9.2	LINDA D. GREATHOUSE	25.58
	S44	05-23-8	CARL DAVID & SUZANNE L. GUSEMAN	29.5
	S45	05-23-9.3	LINDA D. GREATHOUSE	17.5
	S46	05-23-11.6	T.H. EXPLORATION II, LLC	0.094
	S47	05-23-11.2	EVELYN HUDSON	1.154
	S48	05-23-11	ROY F. YOHO	7
	S49	05-25-20.3	JAMES A. & JO C. ESTEP	4.49
	S50	05-25-20.2	JAMES M. ZAMBOTTI	1.347
	S51	05-25-20.1	JAMES M. ZAMBOTTI	2.746
	S54	05-25-1	MICHAEL L. MASON	35.43
	S55	05-25-14	ROY F. YOHO	23
	S56	05-25-13.2	DAVID A. KLUG	5.89
	S57	05-25-13	WILLIAM M. FERDA, JR., ETAL	16.014
	S58	05-25-13.4	PARSONS CEMETERY	0.382
	S59	05-25-12.1	KENT & BETTY MASON	15
	S60	05-25-11.1	EDWARD W. & DIANNA KLUG	2.343
	S61	12-3-44	JAMES A. & JO C. ESTEP	1.1
	S62	12-3-47	WETZEL CO. EMERGENCY AMBULANCE	0.5
	S63	12-3-49	LOGAN & AMY TAYLOR	3.814
	S64	12-3-43	ADAM W. FERRELL & BRITTANY M. LOY	1.97
	S65	05-25-16	CRAIG R. & ASHLEY FERRELL	23.5
	S66	12-3-1	JAMES W. KLUG	0.375

* FORCED POOLED TRACTS ARE HIGHLIGHTED



P.S. 708 *David L Jackson*

Tags	Number	Tax Map -Parcel	Surface Owner	Acres
	S67	12-3-4.5	HAZEL M. BLAIR	0.451
	S68	12-3-4.6	STEVEN P. WAYMAN	1.009
	S69	12-3-4.8	ERIN HUBBS	0.621
	S70	12-3-4.3	JOSEPH P. & BARBARA A. CAIN	3.619
	S71	12-3-2	ROBERT LEE & DIANA G. SMITH	2.48
	S72	12-3-3.1	DIANA & ROBERT L. SMITH	15.78
	S73	12-3-4.2	DEREK L. BAKER	5.21
	S74	12-3-3	ANITA LARELL SLOUGH	1.12
	S75	12-3-12	RODNEY DEAN JACKSON	3.625
	S76	12-3-48	RONALD W. & JULIE A. NICE	1
	S77	12-3-14	ROBERT W. BAXTER, FREDERICK J. BAXTER & ANN C. LINGER	27
	S78	12-3-14.1	MATTHEW D. HALL	13
	S79	12-3-13.1	ZACHARY J. KIRKLAND	5
	S80	12-3-21.1	LARRY J. & MARY ANN KIRKLAND	0.47
	S81	12-3-29	FRIEND V. ESTEP : RAYMOND F. ESTEP - L/E	2.9
	S82	12-3-30.4	FRIEND V. ESTEP, MICHAEL & JOAN ESTEP & DOUGLAS & JOAN ESTEP (RAYMOND ESTEP - L/E)	81.82
	S83	12-3-30.2	APRIL ROSE & DONALD ALLEN POSTLETHWAIT	1.67
	S84	12-3-30	MARY ROSE YOHO - L/E: APRIL ROSE POSTLETHWAIT	0.48
	S85	12-3-28	ANTIOCH CHURCH	1
	S86	12-3-45	ANTIOCH CHURCH	0.774
	S87	12-8-3	R. SHANE & KATHRYN GODDARD	31.13
	S88	12-3-30.3	TIMOTHY L. SUMMERS	0.61
	S89	12-3-32	TIMOTHY L. SUMMERS	2.32
	S90	12-3-39	FRIEND V. ESTEP, MICHAEL & JOAN ESTEP & DOUGLAS & JOAN ESTEP (RAYMOND ESTEP - L/E)	4.69
	S91	12-3-32.1	TIMOTHY L. & LE ANNA SUMMERS	1.78
	S92	12-3-39.1	WILLIAM NICE	1.31
	S93	12-3-31	DOUGLAS & SUZANNE ESTEP	3.25
	S94	12-8-4.3	BRADY G. & SHARON L. HOWELL	5.59
	S95	12-8-4.1	MARY JOSEPHINE & JACOB WOODROW NICE	6.171
	S96	12-8-13	EDWARD C. & SANDRA K MURRINER	15
	S97	12-8-14	EDWARD C. & SANDRA K MURRINER	5.33
	S98	12-8-16.1	BRENT A. & KIMBERLY J. EDDY	0.06
	S99	12-8-4.4	CHARLES & BETTY HUGGINS	0.69
	S100	12-8-4.2	BRENT A. & KIMBERLY J. EDDY	1.861
	S101	12-8-4	JACOB WOODROW & MARY JOSEPHINE NICE	20.893
	S102	12-8-21	EDUARDO C. & SONYA R. DEGUZMAN	11.51
	S103	12-8-21.1	LUNDA M. STOUT	15.26
	S104	12-8-22.1	BARRY C. KIRKLAND	7.401
	S105	12-8-32.6	CHARLES W. THOMAS JR.	1.309
	S106	12-8-32	CHARLES M. THOMAS, DAVID TODD & CINDY L. BATES	27.287
	S107	12-8-20.1	PAUL J. BLAKE	1.5
	S108	12-8-20.9	JOSHUA M. & COURTNEY R. NEFF	0.4
	S109	12-8-20.3	PAUL J. BLAKE	0.25
	S110	12-8-20.8	JOSHUA M. & COURTNEY R. NEFF	0.99
	S111	12-8-20.6	JOHN G. & DEBRA D. THROCKMORTON	1.046
	S112	12-8-20.7	RON JR. & SHANA CAMPBELL	5.44
	S113	12-8-18	CHARLES D. ROSE JR., ETAL: CHARLES & JUDITH ROSE - L/E	6.4
	S114	12-7-33	CHARLES D. ROSE JR., ETAL: CHARLES & JUDITH ROSE - L/E	5.75
	S115	12-7-32.1	CHARLES D. ROSE JR., ETAL: CHARLES & JUDITH ROSE - L/E	18
	S116	12-7-22.3	TIMOTHY ROGER FERGUSON	0.239
	S117	12-7-22.2	TIMOTHY ROGER FERGUSON	0.908
	S118	12-7-22.4	WAYNE PAUL GODDARD	0.084
	S119	12-7-9	MICHAEL J. & ALENA R. FAYAD	22.526
	S120	12-7-9.1	JAMES T. EDDY	17.47
	S121	12-7-22.1	NANCY C. MURPHY - LE: KARI KIM CLARK	0.82
	S122	12-7-10	WAYNE PAUL GODDARD	1.5
	S123	12-2-22	MARY JOSEPHINE NICE	2.95
	S124	12-2-22.3	DAVID L. & KIMBERLY L. NICE	1.65
	S125	12-2-20.2	MICHAEL K. COZART	1.025
	S126	12-2-20.1	SHIRLEY L. & KENNETH L. HAUGHT	1
	S127	12-2-20	MICHAEL K. & ROSETTA A. COZART	34.063
	S128	12-8-1.2	JOSH GODDARD	1.81
	S129	12-7-8.1	BRIAN & CHRISTINE L. NICE	7.628
	S130	12-7-8	MARK E. ELLER	1.012
	S131	12-7-7.5	MARK E. ELLER	1.94
	S132	12-7-7.1	MARK E. ELLER	1.41
	S133	12-2-25	MICHAEL K. & ROSETTA A. COZART	1.265
	S134	12-2-11.1	BERYL E. MASON	1.7
	S135	12-2-9	LAURA RICHARDS COOK	77
	S136	12-2-10	LAURA RICHARDS COOK	95
	S137	12-2-5	CLIFFORD W. & ALBERTA B. JOHNSON	75.96
	S138	12-2-6	CLIFFORD W. & ALBERTA B. JOHNSON	36
	S139	12-3-46	CATHY A. PURPURA	0.514
	S140	05-26-13	MARJORIE ANN STONEKING - LIFE	40
	S141	05-26-14	THERESA H. WALTON, AS TRUSTEE OF THE ROBERT D. & BONNIE L. OLIVER TRUST	27.56
	S142	05-26-10	THERESA H. WALTON, AS TRUSTEE OF THE ROBERT D. & BONNIE L. OLIVER TRUST	24.94
	S143	05-26-9	THERESA H. WALTON, AS TRUSTEE OF THE ROBERT D. & BONNIE L. OLIVER TRUST	21.75
	S144	05-26-21	RICHARD JOSEPH OTTE	1.25
	S145	05-23-14	DOMINION ENERGY TRANSMISSION, INC.	59.5
	S146	12-3-46	CATHY A. PURPURA	3.242
	S147	12-8-1.2	JOSH GODDARD	1.81
	S148	05-23-11.8	ROY F. YOHO	2.25
	S149	p/o 12-3-39 & 12-3-30.4	DOUGLAS & SUZANNE ESTEP	0.145
	S150	p/o 12-3-4.7 & 12-3-4.3	JOSHUA D. LEMASTERS & ERIN LEMASTERS	3.602

10/21/2022

OPERATOR'S WELL #: ELMER N-14HU WELL PLAT
 DISTRICT: Proctor PAGE 3 OF 4
 COUNTY: Wetzel DATE: 9/26/2022
 STATE: WV MD REVISED DATE: 09/28/2022
 API #: 47-103-03502



form ww6

**ELMER LEASE
WELL N-14HU
472.7041 ± ACRES**

Lease ID	TMP	Tag	Grantor, Lessor, Etc.	Deed Book/Page	
10*31435	12-8-15	A	HENRY AND NANCY GARNER	55	394
10*31435	12-8-2	B	HENRY AND NANCY GARNER	55	394
10*31435	12-8-1	C	HENRY AND NANCY GARNER	55	394
10*31436	12-7-32	D	J R HUGGINS	56	465
10*21035	12-7-22	E	THOMAS E GARNER AND BILLIE J GARNER, ET AL	200A	385
10*31435	12-8-1.1	F	HENRY AND NANCY GARNER	55	394
10*31435	12-7-13.1	G	HENRY AND NANCY GARNER	55	394
10*31435	12-7-11	H	HENRY AND NANCY GARNER	55	394
FORCE POOL	12-2-22.2	I	THOMAS E GARNER, ET AL	255A	816
10*31435	12-7-12	J	HENRY AND NANCY GARNER	55	394
10*31435	12-3-26.1	K	HENRY AND NANCY GARNER	55	394
10*31435	12-2-23.1	L	HENRY AND NANCY GARNER	55	394
10*31435	12-2-23.3	M	HENRY AND NANCY GARNER	55	394
10*31435	12-2-23.4	N	HENRY AND NANCY GARNER	55	394
10*21035	12-2-23	O	THOMAS E GARNER AND BILLIE J GARNER, ET AL	200A	385
FORCE POOL	12-2-22.1	P	THOMAS E GARNER, ET AL	166A	436
10*22571	12-2-21	Q	LINDA M YOHO, ET AL	209A	281
10*22571	12-2-18	R	LINDA M YOHO, ET AL	209A	281
10*21681	12-2-19	S	DOROTHY J HAAS, ET AL	214A	358
10*18336	12-2-12	T	ED BROOME INC, ET AL	198A	718
10*40304	12-2-13	U	DANIEL T BOOTH, ET AL	292A	309
10*39463	12-3-4.7	V	J P COOPER ET AL	56	245
10*18205	12-2-14.2	W	MELISSA PAINTER AND SHAUN PAINTER, ET AL	927 205A	639 891
10*27897	12-2-14.1	X	CAROL VASS, ET AL	1063 232A	605 346
10*18205	5-25-15	Y	MELISSA PAINTER AND SHAUN PAINTER	927 205A	639 891
10*18216	5-25-15	Y	BRUCE EDWARD BAILEY JR AND DARA BAILEY, ET AL	929	99
10*39461	12-2-14.3	Z	JAMES M PARSONS	73	195
10*31441	5-26-12	AA	JASON AND S M PARSONS	59	3
10*31441	5-26-12.1	BB	JASON AND S M PARSONS	59	3
10*14786	5-26-11	CC	TWILA O WHIPKEY, ET AL	799	61
10*14786	5-25-18	DD	TWILA O WHIPKEY, ET AL	799	61
10*14786	5-25-17	EE	TWILA O WHIPKEY, ET AL	799	61
10*14722	5-26-8	FF	HERBERT D MINOR, ET AL	724	200
10*14722	5-26-20	GG	HERBERT D MINOR, ET AL	724	200
10*17189	5-23-9.1	HH	ROBERT J HENRY	716	197
10*14969	5-23-12	II	REBECCA S WORD, ET AL	872	219
10*14786	5-23-13	JJ	TWILA O WHIPKEY, ET AL	799	61
10*17189	5-23-9.2	KK	ROBERT J HENRY	716	197

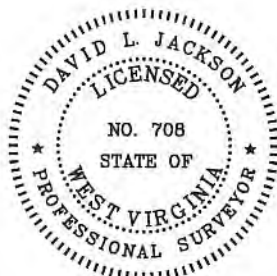

P.S.
708

David L Jackson

10/21/2022



**TUG HILL
OPERATING**

OPERATOR'S
WELL #: ELMER N-14HU
DISTRICT: Proctor
COUNTY: Wetzel
STATE: WV **MOD**
API #: 47-103-03502

WELL PLAT
PAGE 4 OF 4
DATE: 9/26/2022
REVISED DATE:
09/28/2022