



west virginia department of environmental protection

Office of Oil and Gas
601 57th Street, S.E.
Charleston, WV 25304
(304) 926-0450
fax: (304) 926-0452

Harold D. Ward, Cabinet Secretary
www.dep.wv.gov

Tuesday, October 18, 2022
WELL WORK PLUGGING PERMIT
Horizontal 6A Plugging

TUG HILL OPERATING, LLC
380 SOUTHPOINTE BOULEVARD, PLAZA II
SUITE 200
CANONSBURG, PA 15317

Re: Permit approval for ELMER N-15HU
47-103-03503-00-00

This well work permit is evidence of permission granted to perform the specified well work at the location described on the attached pages and located on the attached plat, subject to the provisions of Chapter 22 of the West Virginia Code of 1931, as amended, and all rules and regulations promulgated thereunder, and to any additional specific conditions and provisions outlined in the pages attached hereto. Notification shall be given by the operator to the Oil and Gas Inspector at least 24 hours prior to the construction of roads, locations, and/or pits for any permitted work. In addition, the well operator shall notify the same inspector 24 hours before any actual well work is commenced and prior to running and cementing casing. Spills or emergency discharges must be promptly reported by the operator to 1-800-642-3074 and to the Oil and Gas Inspector.

Upon completion of the plugging well work, the above named operator will reclaim the site according to the provisions of WV Code 22-6-30. Please be advised that form WR-38, Affidavit of Plugging and Filling Well, is to be submitted to this office within 90 days of completion of permitted well work, as should form WR-34 Discharge Monitoring Report within 30 days of discharge of pits, if applicable. Failure to abide by all statutory and regulatory provisions governing all duties and operations hereunder may result in suspension or revocation of this permit and, in addition, may result in civil and/or criminal penalties being imposed upon the operators.

Per 35 CSR 4-5.2.g this permit will expire in two (2) years from the issue date unless permitted well work is commenced. If there are any questions, please feel free to contact me at (304) 926- 0450.

James A. Martin
Chief

Operator's Well Number:
Farm Name: ELNORA TUTTLE
U.S. WELL NUMBER: 47-103-03503-00-00
Horizontal 6A Plugging
Date Issued: 10/18/2022

Promoting a healthy environment.

10/21/2022



TUG HILL

47 1 0 3 0 3 5 0 3 P

October 17, 2022

Mr. Scott Rodeheaver
WV Department of Environmental Protection
601 57th Street, SE
Charleston, WV 25304

RE: WR-35 Information
Plugging Permit Application
Elmer N-15HU

Mr. Rodeheaver

On Thursday, October 13, we received verbal permission from Taylor Brewer to plug our Elmer N-15HU well. A bit broke off in the hole and was unable to be retrieved.

Enclosed please find the WR-35 End of Well Work report, a copy of the email giving permission to plug the well, as well as a plugging permit application and proof of mailing to the appropriate parties. I will be sending in the WR-38, Plugging Affidavit, as soon as I receive it from our drilling team.

If you have any questions concerning this request, please feel free to contact me at 304-376-0111.

Sincerely,

Amy L. Morris
Permitting Specialist – Appalachia Region

RECEIVED
Office of Oil and Gas

OCT 18 2022

WV Department of
Environmental Protection

10/21/2022

11/10/2016

PLUGGING PERMIT CHECKLIST

Plugging Permit

- WW-4B
- WW-4B signed by inspector
- WW-4A

- SURFACE OWNER WAIVER or PROOF THAT APPLICATION WAS SENT BY REGISTERED OR CERTIFIED MAIL

- COAL OWNER/COAL OPERATOR/COAL LESSEE WAIVERS or PROOF THAT APPLICATION WAS SENT BY REGISTERED OR CERTIFIED MAIL
- WW-9 PAGE 1 (NOTARIZED)
- WW-9 PAGE 2 with attached drawing of road, location, pit and proposed area for land application
- WW-9 GPP PAGE 1 and 2 if well effluent will be land applied
- RECENT MYLAR PLAT OR WW-7
- WELL RECORDS/COMPLETION REPORT
- TOPOGRAPHIC MAP OF WELL, SHOWING PIT IF PIT IS USED
- MUST HAVE VALID BOND IN OPERATOR'S NAME
- CHECK FOR \$100 IF PIT IS USED

RECEIVED
Office of Oil and Gas
OCT 18 2022
WV Department of
Environmental Protection

10/21/2022

STATE OF WEST VIRGINIA
DEPARTMENT OF ENVIRONMENTAL PROTECTION
OFFICE OF OIL AND GAS

APPLICATION FOR A PERMIT TO PLUG AND ABANDON

4) Well Type: Oil ___ / Gas X / Liquid injection ___ / Waste disposal ___ /
(If "Gas, Production X or Underground storage ___) Deep X / Shallow ___

5) Location: Elevation 1,042.60' Watershed Proctor Creek of French Creek - Ohio River
District Proctor County Wetzel Quadrangle Wileyville 7.5'

6) Well Operator Tug Hill Operating, LLC 7) Designated Agent Darren Brown
Address 380 Southpointe Boulevard, Plaza II, Suite 200 Address 5098 Washington Street W, Suite 407
Canonsburg, PA 15317 Charleston, WV 25313-1561

8) Oil and Gas Inspector to be notified 9) Plugging Contractor
Name Ken Greynolds Name Halliburton Energy Services, Inc.
Address 613 Broad Run Road Address 121 Champion Way, Suite 200
Jane Lew, WV 26378 Canonsburg, PA 15317

10) Work Order: The work order for the manner of plugging this well is as follows:

1. RU Cementers

2. P&A well with 753 bbl of 100% Portland cement from TD to surface, or until cement is returned to surface, taking returns into cellar

3. Install cap, weld on, and RDMO marking cap with API/Wellname

RECEIVED
Office of Oil and Gas

OCT 18 2022

WV Department of
Environmental Protection

Notification must be given to the district oil and gas inspector 24 hours before permitted work can commence.

Work order approved by inspector Kenneth Greynolds Date _____

Digitally signed by Kenneth Greynolds
DN: CN = Kenneth Greynolds email = Kenneth.L.Greynolds@wv.gov C = AD O = WVDEP OJ = Oil and Gas
Date: 2022.10.17 14:51:07 -0400

10/21/2022

1) Date: 10/17/2022
2) Operator's Well Number
Elmer N-15HU
3) API Well No.: 47 - 103 - 03503

STATE OF WEST VIRGINIA
DEPARTMENT OF ENVIRONMENTAL PROTECTION, OFFICE OF OIL AND GAS
NOTICE OF APPLICATION TO PLUG AND ABANDON A WELL

4) Surface Owner(s) to be served:	5) (a) Coal Operator
(a) Name <u>Elнора Tuttle Heirs (Pad & Access Road)</u>	Name <u>Consol Energy, Inc. Attn: Casey Saunders</u>
Address <u>6768 Proctor Creek Road</u>	Address <u>275 Technology Drive, Suite 101</u>
<u>Proctor, WV 26055</u>	<u>Canonsburg, PA 15317-9565</u>
(b) Name <u>Charles Lee & Betty Jean Huggins (Pad & Access Road)</u>	(b) Coal Owner(s) with Declaration
Address <u>5352 Palmer Ridge Road</u>	Name <u>same</u>
<u>Proctor, WV 26055</u>	Address _____
(c) Name _____	Name _____
Address _____	Address _____
6) Inspector _____	(c) Coal Lessee with Declaration
Address _____	Name _____
Telephone _____	Address _____

TO THE PERSONS NAMED ABOVE: You should have received this Form and the following documents:

- (1) The application to Plug and Abandon a Well on Form WW-4B, which sets out the parties involved in the work and describes the well its and the plugging work order; and
- (2) The plat (surveyor's map) showing the well location on Form WW-6.

The reason you received these documents is that you have rights regarding the application which are summarized in the instructions on the reverses side. However, you are not required to take any action at all.

Take notice that under Chapter 22-6 of the West Virginia Code, the undersigned well operator proposes to file or has filed this Notice and Application and accompanying documents for a permit to plug and abandon a well with the Chief of the Office of Oil and Gas, West Virginia Department of Environmental Protection, with respect to the well at the location described on the attached Application and depicted on the attached Form WW-6. Copies of this Notice, the Application, and the plat have been mailed by registered or certified mail or delivered by hand to the person(s) named above (or by publication in certain circumstances) on or before the day of mailing or delivery to the Chief.

Well Operator Tug Hill Operating, LLC
 By: Amy L. Morris
 Its: Permitting Specialist - Appalachia Region
 Address 380 Southpointe Boulevard, Plaza II, Suite 200
Canonsburg, PA 15317
 Telephone 724-749-8388

Commonwealth of Pennsylvania - Notary Seal
 Susanne Deliere, Notary Public
 Washington County
 My commission expires January 15, 2025
 Commission number 1382332
 Member, Pennsylvania Association of Notaries

RECEIVED
Office of Oil and Gas

OCT 18 2022

Subscribed and sworn before me this 17th day of October, 2022
Susanne Deliere Notary Public
 My Commission Expires 1/15/2025

WV Department of
Environmental Protection

Oil and Gas Privacy Notice

The Office of Oil and Gas processes your personal information, such as name, address and phone number, as a part of our regulatory duties. Your personal information may be disclosed to other State agencies or third parties in the normal course of business or as needed to comply with statutory or regulatory requirements, including Freedom of Information Act requests. Our office will appropriately secure your personal information. If you have any questions about our use of your personal information, please contact DEP's Chief Privacy Officer at depprivacyoffier@wv.gov.

10/21/2022

4710303503P

U.S. Postal Service™
CERTIFIED MAIL® RECEIPT
Domestic Mail Only

For delivery information, visit our website at www.usps.com®.

OFFICIAL USE

Certified Mail Fee	\$
Extra Services & Fees (check box, add fee as appropriate)	
<input type="checkbox"/> Return Receipt (hardcopy)	\$
<input type="checkbox"/> Return Receipt (electronic)	\$
<input type="checkbox"/> Certified Mail Restricted Delivery	\$
<input type="checkbox"/> Adult Signature Required	\$
<input type="checkbox"/> Adult Signature Restricted Delivery	\$
Postage	\$
Total	\$

Charles Lee & Betty Jean Huggins
 5352 Palmer Ridge Road
 Proctor, WV 26055

PS Form 3800, April 2019 PSN 7530-02-000-9001

OCT 17 2022
Postmark Here

U.S. Postal Service™
CERTIFIED MAIL® RECEIPT
Domestic Mail Only

For delivery information, visit our website at www.usps.com®.

OFFICIAL USE

Certified Mail Fee	\$
Extra Services & Fees (check box, add fee as appropriate)	
<input type="checkbox"/> Return Receipt (hardcopy)	\$
<input type="checkbox"/> Return Receipt (electronic)	\$
<input type="checkbox"/> Certified Mail Restricted Delivery	\$
<input type="checkbox"/> Adult Signature Required	\$
<input type="checkbox"/> Adult Signature Restricted Delivery	\$
Postage	\$
Total	\$

Elnora Tuttle Heirs
 6768 Proctor Creek Road
 Proctor, WV 26055

PS Form 3800, April 2019 PSN 7530-02-000-9001

OCT 17 2022
Postmark Here

U.S. Postal Service™
CERTIFIED MAIL® RECEIPT
Domestic Mail Only

For delivery information, visit our website at www.usps.com®.

OFFICIAL USE

Certified Mail Fee	\$
Extra Services & Fees (check box, add fee as appropriate)	
<input type="checkbox"/> Return Receipt (hardcopy)	\$
<input type="checkbox"/> Return Receipt (electronic)	\$
<input type="checkbox"/> Certified Mail Restricted Delivery	\$
<input type="checkbox"/> Adult Signature Required	\$
<input type="checkbox"/> Adult Signature Restricted Delivery	\$
Postage	\$
Total	\$

Consol Energy, Inc.
 Attn: Casey Saunders
 275 Technology Drive, Suite 101
 Canonsburg, PA 15317

PS Form 3800, April 2019 PSN 7530-02-000-9001

OCT 17 2022
Postmark Here

RECEIVED
Office of Oil and Gas

OCT 18 2022

WV Department of
Environmental Protection

10/21/2022

STATE OF WEST VIRGINIA
DEPARTMENT OF ENVIRONMENTAL PROTECTION
OFFICE OF OIL AND GAS
FLUIDS/ CUTTINGS DISPOSAL & RECLAMATION PLAN

Operator Name Tug Hill Operating, LLC OP Code 494510851

Watershed (HUC 10) Proctor Creek of French Creek - Ohio River Quadrangle Wileyville 7.5'

Do you anticipate using more than 5,000 bbls of water to complete the proposed well work? Yes No

Will a pit be used? Yes No

If so, please describe anticipated pit waste: N/A - Cement will be mixed on site in trucks

Will a synthetic liner be used in the pit? Yes No If so, what ml.? n/a

Proposed Disposal Method For Treated Pit Wastes:

- Land Application (if selected provide a completed form WW-9-GPP)
- Underground Injection (UIC Permit Number _____)
- Reuse (at API Number _____)
- Off Site Disposal (Supply form WW-9 for disposal location)
- Other (Explain _____)

Will closed loop system be used? If so, describe: N/A - No drilling will be done

Drilling medium anticipated for this well (vertical and horizontal)? Air, freshwater, oil based, etc. N/A - No drilling will be done

-If oil based, what type? Synthetic, petroleum, etc. N/A - No drilling will be done

Additives to be used in drilling medium? N/A - No drilling will be done

Drill cuttings disposal method? Leave in pit, landfill, removed offsite, etc. N/A - No drilling will be done

-If left in pit and plan to solidify what medium will be used? (cement, lime, sawdust) N/A - No drilling will be done

-Landfill or offsite name/permit number? N/A - No drilling will be done

Permittee shall provide written notice to the Office of Oil and Gas of any load of drill cuttings or associated waste rejected at any West Virginia solid waste facility. The notice shall be provided within 24 hours of rejection and the permittee shall also disclose where it was properly disposed.

I certify that I understand and agree to the terms and conditions of the GENERAL WATER POLLUTION PERMIT issued on April 1, 2016, by the Office of Oil and Gas of the West Virginia Department of Environmental Protection. I understand that the provisions of the permit are enforceable by law. Violations of any term or condition of the general permit and/or other applicable law or regulation can lead to enforcement action.

I certify under penalty of law that I have personally examined and am familiar with the information submitted on this application form and all attachments thereto and that, based on my inquiry of those individuals immediately responsible for obtaining the information, I believe that the information is true, accurate, and complete. I am aware that there are significant penalties for submitting false information, including the possibility of fine or imprisonment.

Company Official Signature Jim Pancake
Company Official (Typed Name) Jim Pancake
Company Official Title VP, Geoscience

RECEIVED
Office of Oil and Gas
OCT 18 2022
WV Department of
Environmental Protection

Subscribed and sworn before me this 17th day of October, 2022

Susanne Deliere Notary Public

My commission expires 1/15/2025

Commonwealth of Pennsylvania - Notary Seal
Susanne Deliere, Notary Public
Washington County
My commission expires January 15, 2025
Commission number 1582302
Member, Pennsylvania Association of Notaries

Proposed Revegetation Treatment: Acres Disturbed 26.11 Prevegetation pH 6.0

Lime 3 Tons/acre or to correct to pH 6.5

Fertilizer type 10-20-20 or equivalent

Fertilizer amount 1/3 ton lbs/acre

Mulch 2.5 Tons/acre

Seed Mixtures

Temporary		Permanent	
Seed Type	lbs/acre	Seed Type	lbs/acre
Annual Ryegrass	40	Fox Tail/Grassy	40
		Perennial Rye	30
		Crown Vetch	20

Attach:

Maps(s) of road, location, pit and proposed area for land application (unless engineered plans including this info have been provided). If water from the pit will be land applied, provide water volume, include dimensions (L, W, D) of the pit, and dimensions (L, W), and area in acres, of the land application area.

Photocopied section of involved 7.5' topographic sheet.

Plan Approved by: Kenneth Greynolds

Digitally signed by Kenneth Greynolds
DN: CN = Kenneth Greynolds email = Kenneth.L.Greynolds@wv.gov C = AD O = WVDEP OU = Oil and Gas
Date: 2022.10.17 14:57:42 -0400

Comments: _____

RECEIVED
Office of Oil and Gas
OCT 18 2022
WV Department of
Environmental Protection

Title: Oil and Gas Inspector Date: _____

Field Reviewed? () Yes () No

**ELMER LEASE
WELL N-15HU
513.0901 ± ACRES**

TOP HOLE LATITUDE: 39°42'30"
BOTTOM HOLE LATITUDE: 39°45'00"

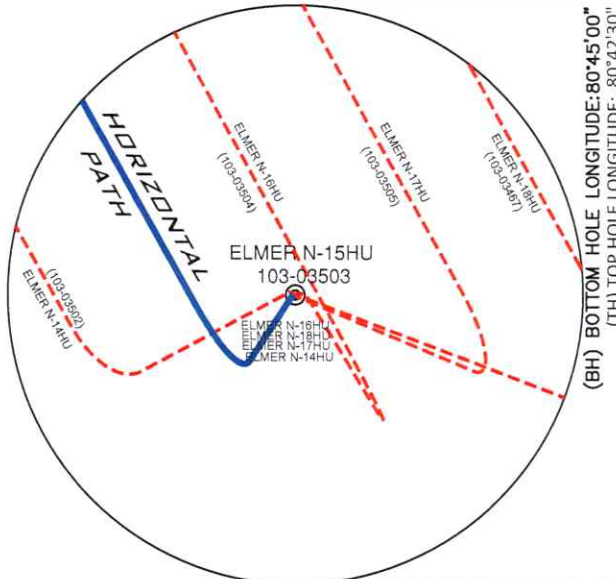
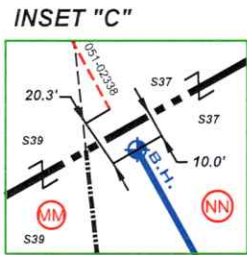
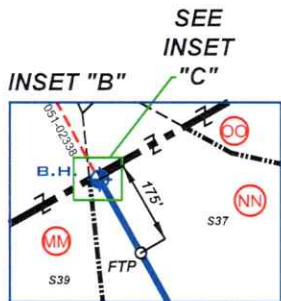

INSET "A"
NOTE: L.P.1 and LTP are same point.



- NOTES**
- BORE PATH BASED ON GRID NORTH.
 - NO WATER WELLS WITHIN 250' OF WELL WERE FOUND, NO DWELLINGS WITHIN 625' OF PAD CENTER WERE FOUND.
 - OWNERSHIP TAKEN FROM PUBLIC RECORDS OF WETZEL COUNTY, WV IN JULY, 2022.
 - COORDINATES AND WELL TIES BASED UPON DIFFERENTIAL GPS MEASUREMENTS.
 - WELL LOCATION REFERENCES ARE BASED UPON THE MAGNETIC MERIDIAN.
 - ALL DEEP WELLS WITHIN 1,000' ARE SHOWN ON THIS PLAT.
 - BOUNDARIES ALONG ROADWAYS ARE BASED UPON MEMORANDUM BY DICKIE, MCCAMEY & CHILCOTE, P.C. FILE 0058304.0401147

LEGEND

- LEASED TRACTS
- SURFACE TRACTS
- WELL LATERAL
- POINT PLEASANT LEGS
- UNIT BOUNDARY
- LEASE # (SEE 6A1 FORM)
- 400' BORE PATH OFFSET
- 500' WELL BORE OFFSET
- (FTP) PROPOSED FIRST TAKE POINT
- (LTP) PROPOSED LAST TAKE POINT
- FORCED POOL TRACT

SURFACE HOLE
UTM. NAD83, ZONE 17
IN METERS
N) 4,393,818.91
E) 522,497.19

BOTTOM HOLE
UTM. NAD83, ZONE 17
IN METERS
N) 4,393,818.97
E) 522,496.32

SURFACE HOLE
UTM. NAD83, ZONE 17
IN METERS
N) 4,393,818.91
E) 522,497.19

LANDING POINT 1
UTM. NAD83, ZONE 17
IN METERS
N) 4,393,786.21
E) 522,184.25

BOTTOM HOLE
UTM. NAD83, ZONE 17
IN METERS
N) 4,398,236.31
E) 519,599.77

(+) DENOTES LOCATION ON UNITED STATES TOPOGRAPHIC MAPS

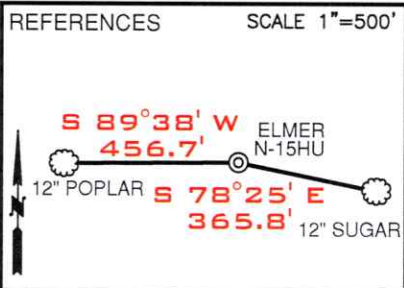
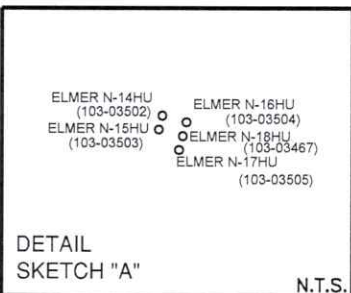

Deep Wells Within 2400' of Proposed Well's Surface Location and/or 500' of Well Lateral

API	OPERATOR
47-051-02338	Tug Hill Operating, LLC
47-103-03467	Tug Hill Operating, LLC
47-103-03502	Tug Hill Operating, LLC
47-103-03504	Tug Hill Operating, LLC
47-103-03505	Tug Hill Operating, LLC

LINE	BEARING	DISTANCE
L1	N 42°22' E	1,853.68'
L2	N 67°31' E	1,415.65'
L3	S 84°10' W	2.85'

RECEIVED
Office of Oil and Gas

OCT 18 2022

FILE NUMBER _____

DRAWING NUMBER ELMER_N-15HU_REV1

SCALE 1" = 2000'

MINIMUM DEGREE OF ACCURACY 1/200

PROVEN SOURCE OF ELEVATION SUBMETER MAPPING
GRADE GPS

I, THE UNDERSIGNED, HEREBY CERTIFY THAT THIS PLAT IS CORRECT TO THE BEST OF MY KNOWLEDGE AND BELIEF AND SHOWS ALL THE INFORMATION REQUIRED BY LAW AND THE RULES ISSUED AND PRESCRIBED BY THE DEPARTMENT OF ENVIRONMENTAL PROTECTION

P.S. 708

David L Jackson



JACKSON SURVEYING INC.
P.O. Box 1460
Clarksburg, WV 26302
304-623-5851

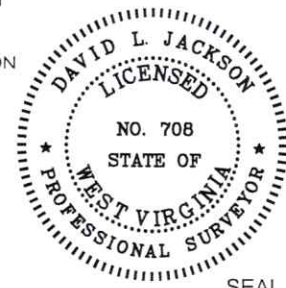

WVDEP
OFFICE OF OIL & GAS
601 57TH STREET, SE
CHARLESTON, WV 25304

WELL TYPE: OIL ___ GAS X LIQUID INJECTION ___ WASTE DISPOSAL ___
(IF "GAS") PRODUCTION X STORAGE ___ DEEP X SHALLOW ___

LOCATION ELEVATION 1276.50' WATERSHED (HUC 10) PROCTOR CREEK OF FRENCH CREEK - OHIO RIVER (HUC-10)
DISTRICT PROCTOR COUNTY WETZEL
QUADRANGLE WILEYVILLE 7.5' LEASE NUMBER SEE WW-6A1 FORM

SURFACE OWNER ELNORA TUTTLE HRS ACREAGE 39.19
OIL & GAS ROYALTY OWNER HENRY & NANCY GARNER - SEE WW-6A1 LEASE ACREAGE 39.19
PROPOSED WORK: DRILL ___ CONVERT ___ DRILL DEEPER ___ REDRILL ___ FRACTURE OR STIMULATE ___ PLUG OFF OLD FORMATION ___
PERFORATE NEW FORMATION ___ OTHER PHYSICAL CHANGE (SPECIFY) ASDRILLED

TARGET FORMATION POINT PLEASANT ESTIMATED DEPTH TVD: 1,101' TMD: 1,101'

WELL OPERATOR TUG HILL OPERATING, LLC DESIGNATED AGENT DARREN BROWN, CT CORP
ADDRESS 1320 SOUTH UNIVERSITY DRIVE, SUITE 500 FORT WORTH, TX 76107 ADDRESS 5098 WASHINGTON STREET WEST, SUITE 407 CHARLESTON, WV 25313-1561

10/21/2022

COUNTY NAME
PERMIT

form WVC

ELMER LEASE WELL N-15HU 513.0901± ACRES

LEGEND

- LEASED TRACTS
- SURFACE TRACTS
- WELL LATERAL
- POINT PLEASANT LEGS
- UNIT BOUNDARY
- LEASE # (SEE 6A1 FORM)
- 400' BORE PATH OFFSET
- 500' WELL BORE OFFSET
- PROPOSED FIRST TAKE POINT (FTP)
- PROPOSED LAST TAKE POINT (LTP)
- FORCED POOL TRACT

SCALE 1" = 2000'

- ASDRILLED LEG
- PERMITTED LEG

Note: Tracts F & T are forced pooled tracts.

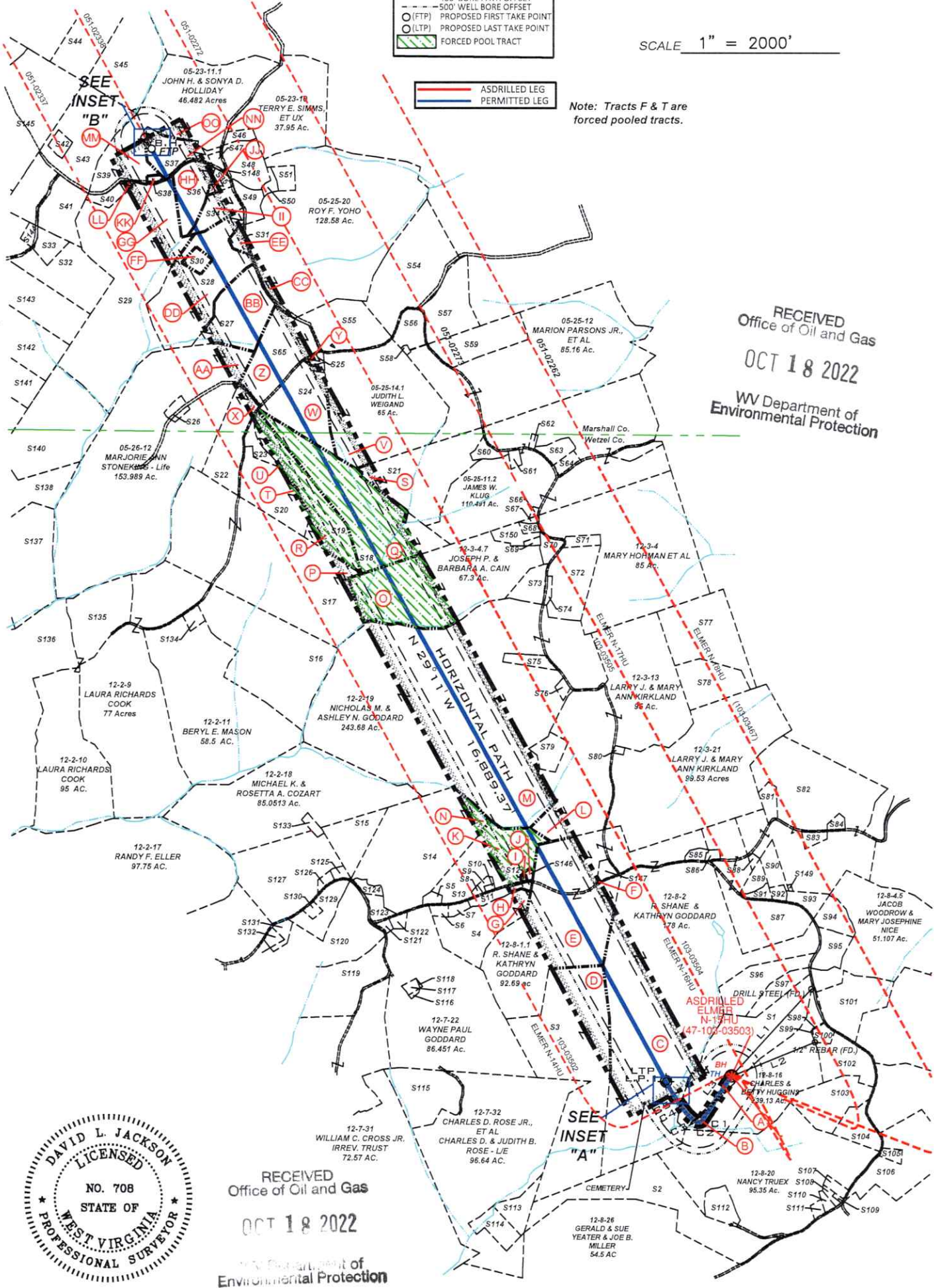

RECEIVED
Office of Oil and Gas
OCT 18 2022
WV Department of
Environmental Protection

RECEIVED
Office of Oil and Gas
OCT 18 2022
WV Department of
Environmental Protection



P.S. 708 *David L Jackson*

10/21/2022

	OPERATOR'S	WELL PLAT
	WELL #: <u>ELMER N-15HU</u>	<u>PAGE 2 OF 4</u>
	DISTRICT: <u>Proctor</u>	DATE: <u>10/15/2022</u>
	COUNTY: <u>Wetzel</u>	
	STATE: <u>WV</u>	
API #: <u>47-103-03503</u>		

FORM WV

**ELMER LEASE
WELL N-15HU
513.0901± ACRES**

* FORCED POOLED TRACTS ARE HIGHLIGHTED

Tags	Number	Tax Map -Parcel	Surface Owner	Acres
A	S1	12-8-15	ELNORA TUTTLE HRS	39.19
	S2	12-8-20.5	JOE MILLER, GERALD & SUE YEATER	44.85
D	S3	12-8-1	R. SHANE & KATHRYN GODDARD	77
G	S4	12-7-13.1	WAYNE PAUL GODDARD	18
	S5	12-2-22.2	DAVID A. & MANDY L. TRUOX	1.186
	S6	12-7-11	JOSEPH R. VILLERS	1.5
	S7	12-7-12	JOSEPH R. VILLERS	1.6
	S8	12-2-23.4	SHARON HOWELL ET AL: GLORIA A. NICE - L/E	0.422
	S9	12-2-23.3	KENNETH W. GODDARD	0.766
	S10	12-2-23.1	KENNETH W. GODDARD	0.36
H	S11	12-3-26.1	JOSEPH MARK KLUG	3.242
I	S12	12-3-27	CATHY A. PURPURA	0.227
K	S13	12-2-23	DAVID A. NICE	21.7
N	S14	12-2-22.1	DAVID A. NICE	54.66
	S15	12-2-21	MICHAEL KENNETH & ROSETTA ANNETTE COZART	11.4
	S16	12-2-12	BERYL E. MASON	59.9
P	S17	12-2-13	JAY S. BOOTH; DANIEL T. BOOTH & DIANE BETH OVERDORFF	100
Q	S18	12-2-14	DAVID L. CUNNINGHAM	56.23
R	S19	12-2-14.2	JOHN G. JR & GERALDINE M. ROGERS	22.007
T	S20	12-2-14.1	SAMMY J. GREATHOUSE JR. : SAMMY J. GREATHOUSE SR. - L/E	18.67
S	S21	05-25-11.4	EDWARD W. KLUG, ETUX	32.787
X	S22	05-25-15	ROBERT S. KELLER, ETAL	15.073
U	S23	12-2-14.3	QUENNA BENNETT	3.093
W	S24	05-25-16.1	DAVID L. CUNNINGHAM	6.34
Y	S25	05-25-16.2	RODNEY J. LOY	1.087
	S26	05-26-12.1	ALVIN F. JR. & KRISTA R. STONEKING	2.011
BB	S27	05-25-17	CRAIG & ASHLEY FERRELL	22.79
DD	S28	05-25-18	JOSEPH JOHNSON, ETUX - LIFE	37.746
GG	S29	05-26-11	MARK A. YOHO	89.25
FF	S30	05-25-18.1	PAMELA JOAN FERRELL, ET VIR	2.491
EE	S31	05-25-19	JOSEPH JOHNSON ET UX - LIFE	1.973
	S32	05-26-8	RICHARD J. OTTE	18.27
	S33	05-26-20	RICHARD J. OTTE	4.2
II	S34	05-23-11.5	ZACHARY R. STEVEN	7
JJ	S35	05-23-11.8	ROY F. YOHO	2.25
HH	S36	05-23-11.3	COLIN R. YOHO	11.29
NN	S37	05-23-11.4	EVELYN L. HUDSON	10.879
KK	S38	05-23-13.1	JAMES R. & PAMELA J. FERRELL	0.7625
MM	S39	05-23-13	LINDA D. GREATHOUSE	14.24
LL	S40	05-23-12	MARK A. YOHO	3.05
	S41	05-23-9.1	JOHN W. VAN ORDEN, ETUX	23.376
	S42	05-23-9.4	JACKSON R. DAVIS, JR.	2.087
	S43	05-23-9.2	LINDA D. GREATHOUSE	25.58
	S44	05-23-8	CARL DAVD & SUZANNE L. GUSEMAN	29.5
	S45	05-23-9.3	LINDA D. GREATHOUSE	17.5
	S46	05-23-11.6	T.H. EXPLORATION II, LLC	0.094
	S47	05-23-11.2	EVELYN HUDSON	1.154
	S48	05-23-11	ROY F. YOHO	7
	S49	05-25-20.3	JAMES A. & JO C. ESTEP	4.49
	S50	05-25-20.2	JAMES M. ZAMBOTTI	1.347
	S51	05-25-20.1	JAMES M. ZAMBOTTI	2.746
	S54	05-25-1	MICHAEL L. MASON	35.43
	S55	05-25-14	ROY F. YOHO	23
	S56	05-25-13.2	DAVID A. KLUG	5.89
	S57	05-25-13	WILLIAM M. FERDA, JR., ETAL	16.014
	S58	05-25-13.4	PARSONS CEMETERY	0.382
	S59	05-25-12.1	KENT & BETTY MASON	15
	S60	05-25-11.1	EDWARD W. & DIANNA KLUG	2.343
	S61	12-3-44	JAMES A. & JO C. ESTEP	1.1
	S62	12-3-47	WETZEL CO. EMERGENCY AMBULANCE	0.5
	S63	12-3-49	LOGAN & AMY TAYLOR	3.814
	S64	12-3-43	ADAM W. FERRELL & BRITTANY M. LOY	1.97
Z	S65	05-25-16	CRAIG R. & ASHLEY FERRELL	23.5
	S66	12-3-1	JAMES W. KLUG	0.375
	S67	12-3-4.5	HAZEL M. BLAIR	0.451
	S68	12-3-4.6	STEVEN P. WAYMAN	1.009

Tags	Number	Tax Map -Parcel	Surface Owner	Acres
	S69	12-3-4.8	ERIN HUBBS	0.621
	S70	12-3-4.3	JOSEPH P. & BARBARA A. CAIN	3.619
	S71	12-3-2	ROBERT LEE & DIANA G. SMITH	2.48
	S72	12-3-3.1	DIANA & ROBERT L. SMITH	15.78
	S73	12-3-4.2	DEREK L. BAKER	5.21
	S74	12-3-3	ANITA LARELL SLOUGH	1.12
	S75	12-3-12	RODNEY DEAN JACKSON	3.625
	S76	12-3-48	RONALD W. & JUJUE A. NICE	1
	S77	12-3-14	ROBERT W. BAXTER, FREDERICK J. BAXTER & ANN C. LINGER	27
	S78	12-3-14.1	MATTHEW D. HALL	13
	S79	12-3-13.1	ZACHARY J. KIRKLAND	5
	S80	12-3-21.1	LARRY J. & MARY ANN KIRKLAND	0.47
	S81	12-3-29	FRIEND V. ESTEP - RAYMOND F. ESTEP - L/E	2.9
	S82	12-3-30.4	FRIEND V. ESTEP, MICHAEL & JOAN ESTEP & DOUGLAS & JOAN ESTEP (RAYMOND ESTEP - L/E)	81.82
	S83	12-3-30.2	APRIL ROSE & DONALD ALLEN POSTLETHWAIT	1.67
	S84	12-3-30	MARY ROSE YOHO - L/E APRIL ROSE POSTLETHWAIT	0.48
	S85	12-3-28	ANTIOCH CHURCH	1
	S86	12-3-45	ANTIOCH CHURCH	0.774
	S87	12-8-3	R. SHANE & KATHRYN GODDARD	31.13
	S88	12-3-30.3	TIMOTHY L. SUMMERS	0.61
	S89	12-3-32	TIMOTHY L. SUMMERS	2.32
	S90	12-3-39	FRIEND V. ESTEP, MICHAEL & JOAN ESTEP & DOUGLAS & JOAN ESTEP (RAYMOND ESTEP - L/E)	4.69
	S91	12-3-32.1	TIMOTHY L. & LEA ANN SUMMERS	1.78
	S92	12-3-39.1	WILLIAM NICE	1.31
	S93	12-3-31	DOUGLAS & SUZANNA ESTEP	3.25
	S94	12-8-4.3	BRADY G. & SHARON L. HOWELL	5.59
	S95	12-8-4.1	MARY JOSEPHINE & JACOB WOODROW NICE	6.171
	S96	12-8-13	EDWARD C. & SANDRA K MURRINER	15
	S97	12-8-14	EDWARD C. & SANDRA K MURRINER	5.33
	S98	12-8-16.1	BRENT A. & KIMBERLY J. EDDY	0.06
	S99	12-8-4.4	CHARLES & BETTY HUGGINS	0.69
	S100	12-8-4.2	BRENT A. & KIMBERLY J. EDDY	1.861
	S101	12-8-4	JACOB WOODROW & MARY JOSEPHINE NICE	20.893
	S102	12-8-21	EDUARDO C. & SONYA R. DEGUZMAN	11.51
	S103	12-8-21.1	LINDA M. STOUT	15.26
	S104	12-8-22.1	BARRY C. KIRKLAND	7.401
	S105	12-8-32.6	CHARLES W. THOMAS JR.	1.309
	S106	12-8-32	CHARLES M. THOMAS, DAVID TODD & CINDY L. BATES	27.287
	S107	12-8-20.1	PAUL J. BLAKE	1.5
	S108	12-8-20.9	JOSHUA M. & COURTNEY R. NEFF	0.4
	S109	12-8-20.3	PAUL J. BLAKE	0.25
	S110	12-8-20.8	JOSHUA M. & COURTNEY R. NEFF	0.99
	S111	12-8-20.6	JOHN G. & DEBRA D. THROCKMORTON	1.046
	S112	12-8-20.7	RON JR. & SHANA CAMPBELL	5.44
	S113	12-8-18	CHARLES D. ROSE JR., ETAL: CHARLES & JUDITH ROSE - L/E	6.4
	S114	12-7-33	CHARLES D. ROSE JR., ETAL: CHARLES & JUDITH ROSE - L/E	5.75
	S115	12-7-32.1	CHARLES D. ROSE JR., ETAL: CHARLES & JUDITH ROSE - L/E	18
	S116	12-7-22.3	TIMOTHY ROGER FERGUSON	0.239
	S117	12-7-22.2	TIMOTHY ROGER FERGUSON	0.908
	S118	12-7-22.4	WAYNE PAUL GODDARD	0.084
	S119	12-7-9	MICHAEL J. & ALENA R. FAYAD	22.526
	S120	12-7-9.1	JAMES T. EDDY	17.47
	S121	12-7-22.1	NANCY C. MURPHY - L/E: KARI KIM CLARK	0.82
	S122	12-7-10	WAYNE PAUL GODDARD	1.5
	S123	12-2-22	MARY JOSEPHINE NICE	2.95
	S124	12-2-22.3	DAVID L. & KIMBERLY L. NICE	1.65
	S125	12-2-20.2	MICHAEL K. COZART	1.025
	S126	12-2-20.1	SHIRLEY L. & KENNETH L. HAUGHT	1
	S127	12-2-20	MICHAEL K. & ROSETTA A. COZART	34.063
	S128	12-8-1.2	JOSH GODDARD	1.81
	S129	12-7-8.1	BRIAN & CHRISTINE L. NICE	7.628
	S130	12-7-8	MARK E. ELLER	1.012
	S131	12-7-7.5	MARK E. ELLER	1.94
	S132	12-7-7.1	MARK E. ELLER	1.41
	S133	12-2-25	MICHAEL K. & ROSETTA A. COZART	1.265
	S134	12-2-11.1	BERYL E. MASON	1.7
	S135	12-2-9	LAURA RICHARDS COOK	77
	S136	12-2-10	LAURA RICHARDS COOK	95
	S137	12-2-5	CUFFORD W. & ALBERTA B. JOHNSON	75.96
	S138	12-2-6	CUFFORD W. & ALBERTA B. JOHNSON	36
	S139	12-3-46	CATHY A. PURPURA	0.514
	S140	05-26-13	MARJORIE ANN STONEKING - LIFE	40
	S141	05-26-14	THERESA H. WALTON, AS TRUSTEE OF THE ROBERT D. & BONNIE L. OLIVER TRUST	27.56
	S142	05-26-10	THERESA H. WALTON, AS TRUSTEE OF THE ROBERT D. & BONNIE L. OLIVER TRUST	24.94
	S143	05-26-9	THERESA H. WALTON, AS TRUSTEE OF THE ROBERT D. & BONNIE L. OLIVER TRUST	21.75
	S144	05-26-21	RICHARD JOSEPH OTTE	1.25
	S145	05-23-14	DOMINION ENERGY TRANSMISSION, INC.	59.5
J	S146	12-3-46	CATHY A. PURPURA	3.242
F	S147	12-8-1.2	JOSH GODDARD	1.81
	S148	05-23-11.8	ROY F. YOHO	2.25
	S149	p/o 12-3-39 & 12-3-30.4	DOUGLAS & SUZANNE ESTEP	0.145
	S150	p/o 12-3-4.7 & 12-3-4.3	JOSHUA D. LEMASTERS & ERIN LEMASTERS	10/21/2022

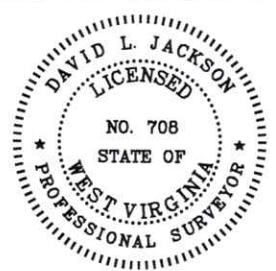

RECEIVED
Office of Oil and Gas
OCT 18 2022
WV Department of
Environmental Protection

P.S. 708 *David L Jackson*



OPERATOR'S
WELL #: ELMER N-15HU WELL PLAT
DISTRICT: Proctor PAGE 3 OF 4
COUNTY: Wetzel DATE: 10/15/2022
STATE: WV
API #: 47-103-03503

form wv6

**ELMER LEASE
WELL N-15HU
513.0901 ± ACRES**

Lease ID	TMP	Tag	Grantor, Lessor, Etc.	Deed Book/Page	
10*31435	12-8-15	A	HENRY AND NANCY GARNER	55	394
10*31435	12-8-16	B	HENRY AND NANCY GARNER	55	394
10*31435	12-8-2	C	HENRY AND NANCY GARNER	55	394
10*31435	12-8-1	D	HENRY AND NANCY GARNER	55	394
10*31435	12-8-1.1	E	HENRY AND NANCY GARNER	55	394
10*31435	12-8-1.2	F	HENRY AND NANCY GARNER	55	394
10*31435	12-7-13.1	G	HENRY AND NANCY GARNER	55	394
10*31435	12-3-26.1	H	HENRY AND NANCY GARNER	55	394
10*31435	12-3-27	I	HENRY AND NANCY GARNER	55	394
10*31435	12-3-46	J	HENRY AND NANCY GARNER	55	394
10*21035	12-2-23	K	THOMAS E GARNER AND BILLIE J GARNER, ET AL	200A	385
10*21643	12-2-23	K	LARRY D GARNER	200A	393
10*31435	12-2-23	K	HENRY AND NANCY GARNER	55	394
10*22229	12-3-13	L	MURIEL A MILLER, ET AL	204A	150
10*21681	12-2-19	M	DOROTHY J HAAS, ET AL	214A	358
FORCE POOL					
10*39463	12-2-22.1	N	THOMAS E GARNER, ET AL	166A	436
10*39463	12-3-4.7	O	J P COOPER ET AL	56	245
10*40304	12-2-13	P	DANIEL T BOOTH, ET AL	292A	309
10*18205	12-2-14	Q	MELISSA PAINTER AND SHAUN PAINTER, ET AL	927	639
				205A	891
10*18205	12-2-14.2	R	MELISSA PAINTER AND SHAUN PAINTER, ET AL	927	639
				205A	891
10*22494	5-25-11.4	S	EDWARD W KLUG & DIANNA KLUG JTWROS	920	109
				1063	605
10*27897	12-2-14.1	T	CAROL VASS, ET AL	232A	346
				73	195
10*39461	12-2-14.3	U	JAMES M PARSONS	944	465
				927	639
10*19727	5-25-14.1	V	S RICHARD MELLON, ET AL	205A	891
				927	639
10*18205	5-25-16.1	W	MELISSA PAINTER AND SHAUN PAINTER, ET AL	205A	891
				927	639
10*18205	5-25-15	X	MELISSA PAINTER AND SHAUN PAINTER, ET AL	205A	891
				927	639
10*18205	5-25-16.2	Y	MELISSA PAINTER AND SHAUN PAINTER, ET AL	205A	891
				927	639
10*18205	5-25-16	Z	MELISSA PAINTER AND SHAUN PAINTER, ET AL	205A	891
				59	3
10*31441	5-26-12	AA	JASON AND S M PARSONS	799	61
10*14786	5-25-17	BB	TWILA O WHIPKEY, ET AL	799	61
10*14786	5-25-20	CC	TWILA O WHIPKEY, ET AL	799	61
10*14786	5-25-18	DD	TWILA O WHIPKEY, ET AL	799	61
10*14786	5-25-19	EE	TWILA O WHIPKEY, ET AL	799	61
10*14786	5-25-18.1	FF	TWILA O WHIPKEY, ET AL	799	61
10*14786	5-26-11	GG	TWILA O WHIPKEY, ET AL	799	61
10*14786	5-23-11.3	HH	TWILA O WHIPKEY, ET AL	799	61
10*14786	5-23-11.5	II	TWILA O WHIPKEY, ET AL	799	61
10*14786	5-23-11.8	JJ	TWILA O WHIPKEY, ET AL	799	61
10*14786	5-23-13.1	KK	TWILA O WHIPKEY, ET AL	799	61
10*14969	5-23-12	LL	REBECCA S WORD, ET AL	872	219
10*14786	5-23-13	MM	TWILA O WHIPKEY, ET AL	799	61
10*14786	5-23-11.4	NN	TWILA O WHIPKEY, ET AL	799	61
10*14786	5-23-11.1	OO	TWILA O WHIPKEY, ET AL	799	61

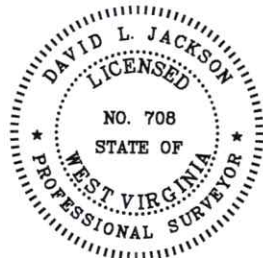

RECEIVED
Office of Oil and Gas
OCT 18 2022
WV Department of Environmental Protection

P.S. 708

David L Jackson

10/21/2022



**TUG HILL
OPERATING**

OPERATOR'S
WELL #: ELMER N-15HU
DISTRICT: Proctor
COUNTY: Wetzel
STATE: WV
API #: 47-103-03503

WELL PLAT
PAGE 4 OF 4
DATE: 10/15/2022



Kennedy, James P <james.p.kennedy@wv.gov>

Plugging permit approved 4710303503

1 message

Kennedy, James P <james.p.kennedy@wv.gov>

Tue, Oct 18, 2022 at 2:18 PM

To: Kenneth L Greynolds <kenneth.l.greynolds@wv.gov>, slemley@wvassessor.com, amorris@tug-hillop.com, Charles T Brewer <charles.t.brewer@wv.gov>

To whom it may concern, a plugging permit has been issued for 4710303503.

James Kennedy

WVDEP OOG

2 attachments

 **4710303503.pdf**
3158K

 **IR-8 Blank.pdf**
237K

10/21/2022