

**ELMER LEASE  
WELL N-15HU  
513.0901 ± ACRES**

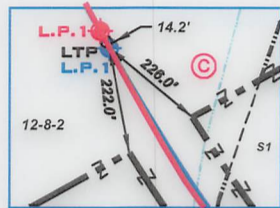

NOTE: L.P.1 and LTP are same point.

(+) DENOTES LOCATION ON UNITED STATES TOPOGRAPHIC MAPS

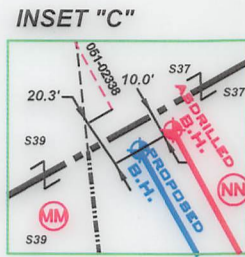
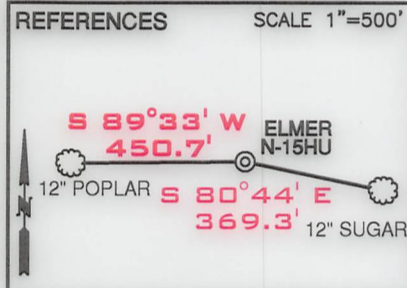
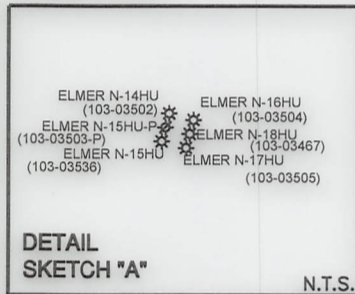

**SURFACE HOLE**  
UTM. NAD83, ZONE 17  
IN METERS  
**N) 4,393,814.39**  
**E) 522,496.06**

**LANDING POINT 1**  
UTM. NAD83, ZONE 17  
IN METERS  
**N) 4,393,793.27**  
**E) 522,180.25**

**BOTTOM HOLE**  
UTM. NAD83, ZONE 17  
IN METERS  
**N) 4,398,238.93**  
**E) 519,603.94**

- NOTES**
- BORE PATH BASED ON GRID NORTH.
  - NO WATER WELLS WITHIN 250' OF WELL WERE FOUND, NO DWELLINGS WITHIN 825' OF PAD CENTER WERE FOUND.
  - OWNERSHIP TAKEN FROM PUBLIC RECORDS OF WETZEL COUNTY, WV IN JULY, 2022.
  - COORDINATES AND WELL TIES BASED UPON DIFFERENTIAL GPS MEASUREMENTS.
  - WELL LOCATION REFERENCES ARE BASED UPON THE MAGNETIC MERIDIAN.
  - ALL DEEP WELLS WITHIN 1,000' ARE SHOWN ON THIS PLAT.
  - BOUNDARIES ALONG ROADWAYS ARE BASED UPON MEMORANDUM BY DICKIE, MCCAMEY & CHILCOTE, P.C. FILE 0058304.0401147

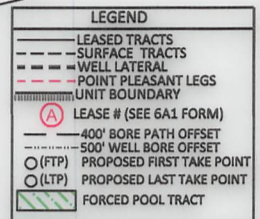

**SURFACE HOLE**  
UTM. NAD83, ZONE 17  
IN METERS  
**N) 4,393,814.39**  
**E) 522,496.06**

**LANDING POINT 1**  
UTM. NAD83, ZONE 17  
IN METERS  
**N) 4,393,786.21**  
**E) 522,184.25**

**BOTTOM HOLE**  
UTM. NAD83, ZONE 17  
IN METERS  
**N) 4,398,236.31**  
**E) 519,599.77**

Deep Wells Within 2400' of Proposed Well's Surface Location and/or 500' of Well Lateral

API	OPERATOR
47-051-02338	Tug Hill Operating, LLC
47-103-03467	Tug Hill Operating, LLC
47-103-03502	Tug Hill Operating, LLC
47-103-03504	Tug Hill Operating, LLC
47-103-03505	Tug Hill Operating, LLC

CURVE	CHORD BEARING	CHORD LENGTH	RADIUS	ARC LENGTH
C1	S 80°38' W	60.15'	55.42'	63.58'
C2	S 78°52' W	65.23'	54.58'	69.91'
C3	N 50°40' W	399.70'	759.26'	404.47'
C4	N 32°09' W	258.78'	1949.33'	256.97'

LINE	BEARING	DISTANCE
L1	N 42°09' E	1,867.27'
L2	N 67°02' E	1,425.00'
L3	S 29°44' W	763.41'
L4	N 28°54' W	185.59'

FILE NUMBER \_\_\_\_\_

DRAWING NUMBER ELMER\_N-15HU\_REV1

SCALE 1" = 2000'

MINIMUM DEGREE OF ACCURACY 1/200

PROVEN SOURCE OF ELEVATION SUBMETER MAPPING  
GRADE GPS

I, THE UNDERSIGNED, HEREBY CERTIFY THAT THIS PLAT IS CORRECT TO THE BEST OF MY KNOWLEDGE AND BELIEF AND SHOWS ALL THE INFORMATION REQUIRED BY LAW AND THE RULES ISSUED AND PRESCRIBED BY THE DEPARTMENT OF ENVIRONMENTAL PROTECTION

P.S. 708

*David L Jackson*



JACKSON SURVEYING INC.  
P.O. Box 1460  
Clarksburg, WV 26302  
304-623-5851

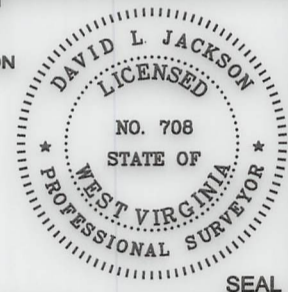

WVDEP  
OFFICE OF OIL & GAS  
601 57TH STREET, SE  
CHARLESTON, WV 25304

DATE: NOVEMBER 20, 2023

OPERATORS WELL NO. ELMER N-15HU  
API WELL NO. \_\_\_\_\_

WELL TYPE: OIL \_\_\_ GAS X LIQUID INJECTION \_\_\_ WASTE DISPOSAL \_\_\_  
(IF "GAS") PRODUCTION X STORAGE \_\_\_ DEEP X SHALLOW \_\_\_

47-103-03536  
STATE COUNTY PERMIT

LOCATION ELEVATION 1276.50' WATERSHED (HUC 10) PROCTOR CREEK OF FRENCH CREEK - OHIO RIVER (HUC-10)

DISTRICT PROCTOR COUNTY WETZEL

QUADRANGLE WILEYVILLE 7.5' LEASE NUMBER SEE WW-6A1 FORM

SURFACE OWNER ELNORA TUTTLE HRS ACREAGE 39.19

OIL & GAS ROYALTY OWNER HENRY & NANCY GARNER - SEE WW-6A1 LEASE ACREAGE 39.19

PROPOSED WORK: DRILL \_\_\_ CONVERT \_\_\_ DRILL DEEPER \_\_\_ REDRILL \_\_\_ FRACTURE OR STIMULATE \_\_\_ PLUG OFF OLD FORMATION \_\_\_  
PERFORATE NEW FORMATION \_\_\_ OTHER PHYSICAL CHANGE (SPECIFY) ASDRILLED

TARGET FORMATION POINT PLEASANT

PLUG & ABANDON \_\_\_ CLEAN OUT & REPLUG \_\_\_  
ESTIMATED DEPTH TVD: 11,712' TMD: 29,166'

WELL OPERATOR EQT PRODUCTION COMPANY

DESIGNATED AGENT JOSEPH C. MALLOW

ADDRESS 400 WOODCLIFF DRIVE  
CANONSBURG, PA 15317

ADDRESS 427 MIDSTATE DRIVE  
CLARKSBURG, WV 25301

COUNTY NAME  
PERMIT

**12/13/2024**







form wv6

**ELMER LEASE  
WELL N-15HU  
513.0901 ± ACRES**

Tags	Number	Tax Map -Parcel	Surface Owner	Acres
A	S1	12-8-15	ELNORA TUTTLE HRS	39.19
	S2	12-8-20.5	JOE MILLER, GERALD & SUE YEATER	44.85
D	S3	12-8-1	R. SHANE & KATHRYN GODDARD	77
G	S4	12-7-13.1	WAYNE PAUL GODDARD	18
	S5	12-2-22.2	DAVID A. & MANDY L. TRUEX	1.186
	S6	12-7-11	JOSEPH R. VILLERS	1.5
	S7	12-7-12	JOSEPH R. VILLERS	1.6
	S8	12-2-23.4	SHARON HOWELL ET AL: GLORIA A. NICE - L/E	0.422
	S9	12-2-23.3	KENNETH W. GODDARD	0.766
	S10	12-2-23.1	KENNETH W. GODDARD	0.36
H	S11	12-3-26.1	JOSEPH MARK KLUG	3.242
I	S12	12-3-27	CATHY A. PURPURA	0.227
K	S13	12-2-23	DAVID A. NICE	21.7
N	S14	12-2-22.1	DAVID A. NICE	54.66
	S15	12-2-21	MICHAEL KENNETH & ROSETTA ANNETTE COZART	11.4
	S16	12-2-12	BERYL E. MASON	59.9
P	S17	12-2-13	JAY S. BOOTH; DANIEL T. BOOTH & DIANE BETH OVERDORFF	100
Q	S18	12-2-14	DAVID L. CUNNINGHAM	56.23
R	S19	12-2-14.2	JOHN G. JR & GERALDINE M. ROGERS	22.007
T	S20	12-2-14.1	SAMMY J. GREATHOUSE JR. : SAMMY J. GREATHOUSE SR. - L/E	18.67
S	S21	05-25-11.4	EDWARD W. KLUG, ETUX	32.787
X	S22	05-25-15	ROBERT S. KELLER, ETAL	15.073
U	S23	12-2-14.3	QUENNA BENNETT	3.093
W	S24	05-25-16.1	DAVID L. CUNNINGHAM	6.34
Y	S25	05-25-16.2	RODNEY J. LOY	1.087
	S26	05-26-12.1	ALVIN F. JR. & KRISTA R. STONEKING	2.011
BB	S27	05-25-17	CRAIG & ASHLEY FERRELL	22.79
DD	S28	05-25-18	JOSEPH JOHNSON, ETUX - LIFE	37.746
GG	S29	05-26-11	MARK A. YOHO	89.25
FF	S30	05-25-18.1	PAMELA JOAN FERRELL, ET VIR	2.491
EE	S31	05-25-19	JOSEPH JOHNSON ET UX - LIFE	1.973
	S32	05-26-8	RICHARD J. OTTE	18.27
	S33	05-26-20	RICHARD J. OTTE	4.2
II	S34	05-23-11.5	ZACHARY R. STEVEN	7
JJ	S35	05-23-11.8	ROY F. YOHO	2.25
HH	S36	05-23-11.3	COLIN R. YOHO	11.29
NN	S37	05-23-11.4	EVELYN L. HUDSON	10.879
KK	S38	05-23-13.1	JAMES R. & PAMELA J. FERRELL	0.7625
MM	S39	05-23-13	LINDA D. GREATHOUSE	14.24
LL	S40	05-23-12	MARK A. YOHO	3.05
	S41	05-23-9.1	JOHN W. VAN ORDEN, ETUX	23.376
	S42	05-23-9.4	JACKSON R. DAVIS, JR.	2.087
	S43	05-23-9.2	LINDA D. GREATHOUSE	25.58
	S44	05-23-8	CARL DAVID & SUZANNE L. GUSEMAN	29.5
	S45	05-23-9.3	LINDA D. GREATHOUSE	17.5
	S46	05-23-11.6	T.H. EXPLORATION II, LLC	0.094
	S47	05-23-11.2	EVELYN HUDSON	1.154
	S48	05-23-11	ROY F. YOHO	7
	S49	05-25-20.3	JAMES A. & JO C. ESTEP	4.49
	S50	05-25-20.2	JAMES M. ZAMBOTTI	1.347
	S51	05-25-20.1	JAMES M. ZAMBOTTI	2.746
	S54	05-25-1	MICHAEL L. MASON	35.43
	S55	05-25-14	ROY F. YOHO	23
	S56	05-25-13.2	DAVID A. KLUG	5.89
	S57	05-25-13	WILLIAM M. FERDA, JR., ETAL	16.014
	S58	05-25-13.4	PARSONS CEMETERY	0.382
	S59	05-25-12.1	KENT & BETTY MASON	15
	S60	05-25-11.1	EDWARD W. & DIANNA KLUG	2.343
	S61	12-3-44	JAMES A. & JO C. ESTEP	1.1
	S62	12-3-47	WETZEL CO. EMERGENCY AMBULANCE	0.5
	S63	12-3-49	LOGAN & AMY TAYLOR	3.814
	S64	12-3-43	ADAM W. FERRELL & BRITTANY M. LOY	1.97
Z	S65	05-25-16	CRAIG R. & ASHLEY FERRELL	23.5
	S66	12-3-1	JAMES W. KLUG	0.375
	S67	12-3-4.5	HAZEL M. BLAIR	0.451
	S68	12-3-4.6	STEVEN P. WAYMAN	1.009

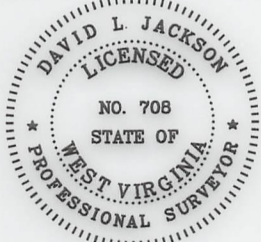

P.S. 708

*David L Jackson*



\* FORCED POOLED TRACTS ARE HIGHLIGHTED

Tags	Number	Tax Map -Parcel	Surface Owner	Acres
	S69	12-3-4.8	ERIN HUBBS	0.621
	S70	12-3-4.3	JOSEPH P. & BARBARA A. CAIN	3.619
	S71	12-3-2	ROBERT LEE & DIANA G. SMITH	2.48
	S72	12-3-3.1	DIANA & ROBERT L. SMITH	15.78
	S73	12-3-4.2	DEREK L. BAKER	5.21
	S74	12-3-3	ANITA LARELL SLOUGH	1.12
	S75	12-3-12	RODNEY DEAN JACKSON	3.625
	S76	12-3-48	RONALD W. & JULIE A. NICE	1
	S77	12-3-14	ROBERT W. BAXTER, FREDERICK J. BAXTER & ANN C. LINGER	27
	S78	12-3-14.1	MATTHEW D. HALL	13
	S79	12-3-13.1	ZACHARY J. KIRKLAND	5
	S80	12-3-21.1	LARRY J. & MARY ANN KIRKLAND	0.47
	S81	12-3-29	FRIEND V. ESTEP : RAYMOND F. ESTEP - L/E	2.9
	S82	12-3-30.4	FRIEND V. ESTEP, MICHAEL & JOAN ESTEP & DOUGLAS & JOAN ESTEP (RAYMOND ESTEP - L/E)	81.82
	S83	12-3-30.2	APRIL ROSE & DONALD ALLEN POSTLETHWAIT	1.67
	S84	12-3-30	MARY ROSE YOHO - L/E: APRIL ROSE POSTLETHWAIT	0.48
	S85	12-3-28	ANTIOCH CHURCH	1
	S86	12-3-45	ANTIOCH CHURCH	0.774
	S87	12-8-3	R. SHANE & KATHRYN GODDARD	31.13
	S88	12-3-30.3	TIMOTHY L. SUMMERS	0.61
	S89	12-3-32	TIMOTHY L. SUMMERS	2.32
	S90	12-3-39	FRIEND V. ESTEP, MICHAEL & JOAN ESTEP & DOUGLAS & JOAN ESTEP (RAYMOND ESTEP - L/E)	4.69
	S91	12-3-32.1	TIMOTHY L. & LEA ANN SUMMERS	1.78
	S92	12-3-39.1	WILLIAM NICE	1.31
	S93	12-3-31	DOUGLAS & SUZANNA ESTEP	3.25
	S94	12-8-4.3	BRADY G. & SHARON L. HOWELL	5.59
	S95	12-8-4.1	MARY JOSEPHINE & JACOB WOODROW NICE	6.171
	S96	12-8-13	EDWARD C. & SANDRA K MURRINER	15
	S97	12-8-14	EDWARD C. & SANDRA K MURRINER	5.33
	S98	12-8-16.1	BRENT A. & KIMBERLY J. EDDY	0.06
	S99	12-8-4.4	CHARLES & BETTY HUGGINS	0.69
	S100	12-8-4.2	BRENT A. & KIMBERLY J. EDDY	1.861
	S101	12-8-4	JACOB WOODROW & MARY JOSEPHINE NICE	20.893
	S102	12-8-21	EDUARDO C. & SONYA R. DEGUZMAN	11.51
	S103	12-8-21.1	LINDA M. STOUT	15.26
	S104	12-8-22.1	BARRY C. KIRKLAND	7.401
	S105	12-8-32.6	CHARLES W. THOMAS JR.	1.309
	S106	12-8-32	CHARLES M. THOMAS, DAVID TODD & CINDY L. BATES	27.287
	S107	12-8-20.1	PAUL J. BLAKE	1.5
	S108	12-8-20.9	JOSHUA M. & COURTNEY R. NEFF	0.4
	S109	12-8-20.3	PAUL J. BLAKE	0.25
	S110	12-8-20.8	JOSHUA M. & COURTNEY R. NEFF	0.99
	S111	12-8-20.6	JOHN G. & DEBRA D. THROCKMORTON	1.046
	S112	12-8-20.7	RON JR. & SHANA CAMPBELL	5.44
	S113	12-8-18	CHARLES D. ROSE JR., ETAL: CHARLES & JUDITH ROSE - L/E	6.4
	S114	12-7-33	CHARLES D. ROSE JR., ETAL: CHARLES & JUDITH ROSE - L/E	5.75
	S115	12-7-32.1	CHARLES D. ROSE JR., ETAL: CHARLES & JUDITH ROSE - L/E	18
	S116	12-7-22.3	TIMOTHY ROGER FERGUSON	0.239
	S117	12-7-22.2	TIMOTHY ROGER FERGUSON	0.908
	S118	12-7-22.4	WAYNE PAUL GODDARD	0.084
	S119	12-7-9	MICHAEL J. & ALENA R. FAYAD	22.526
	S120	12-7-9.1	JAMES T. EDDY	17.47
	S121	12-7-22.1	NANCY C. MURPHY - LE: KARI KIM CLARK	0.82
	S122	12-7-10	WAYNE PAUL GODDARD	1.5
	S123	12-2-22	MARY JOSEPHINE NICE	2.95
	S124	12-2-22.3	DAVID L. & KIMBERLY L. NICE	1.65
	S125	12-2-20.2	MICHAEL K. COZART	1.025
	S126	12-2-20.1	SHIRLEY L. & KENNETH L. HAUGHT	1
	S127	12-2-20	MICHAEL K. & ROSETTA A. COZART	34.063
	S128	12-8-1.2	JOSH GODDARD	1.81
	S129	12-7-8.1	BRIAN & CHRISTINE L. NICE	7.628
	S130	12-7-8	MARK E. ELLER	1.012
	S131	12-7-7.5	MARK E. ELLER	1.94
	S132	12-7-7.1	MARK E. ELLER	1.41
	S133	12-2-25	MICHAEL K. & ROSETTA A. COZART	1.265
	S134	12-2-11.1	BERYL E. MASON	1.7
	S135	12-2-9	LAURA RICHARDS COOK	77
	S136	12-2-10	LAURA RICHARDS COOK	95
	S137	12-2-5	CLIFFORD W. & ALBERTA B. JOHNSON	75.96
	S138	12-2-6	CLIFFORD W. & ALBERTA B. JOHNSON	36
	S139	12-3-46	CATHY A. PURPURA	0.514
	S140	05-26-13	MARJORIE ANN STONEKING - LIFE	40
	S141	05-26-14	THERESA H. WALTON, AS TRUSTEE OF THE ROBERT D. & BONNIE L. OLIVER TRUST	27.56
	S142	05-26-10	THERESA H. WALTON, AS TRUSTEE OF THE ROBERT D. & BONNIE L. OLIVER TRUST	24.94
	S143	05-26-9	THERESA H. WALTON, AS TRUSTEE OF THE ROBERT D. & BONNIE L. OLIVER TRUST	21.75
	S144	05-26-21	RICHARD JOSEPH OTTE	1.25
	S145	05-23-14	DOMINION ENERGY TRANSMISSION, INC.	59.5
J	S146	12-3-46	CATHY A. PURPURA	3.242
F	S147	12-8-1.2	JOSH GODDARD	1.81
	S148	05-23-11.8	ROY F. YOHO	2.25
	S149	p/o 12-3-39 & 12-3-30.4	DOUGLAS & SUZANNE ESTEP	0.145
	S150	p/o 12-3-4.7 & 12-3-4.3	JOSHUA D. LEMASTERS & TRACY LEMASTERS	602

12/15/2024

OPERATOR'S  
WELL #: ELMER N-15HU  
DISTRICT: Proctor  
COUNTY: Wetzel  
STATE: WV  
API #: 47-103-03536

WELL PLAT  
PAGE 3 OF 4  
DATE: 11/20/2023



form ww6

**ELMER LEASE  
WELL N-15HU  
513.0901 ± ACRES**

Lease ID	TMP	Tag	Grantor, Lessor, Etc.	Deed Book/Page	
10*31435	12-8-15	A	HENRY AND NANCY GARNER	55	394
10*31435	12-8-16	B	HENRY AND NANCY GARNER	55	394
10*31435	12-8-2	C	HENRY AND NANCY GARNER	55	394
10*31435	12-8-1	D	HENRY AND NANCY GARNER	55	394
10*31435	12-8-1.1	E	HENRY AND NANCY GARNER	55	394
10*31435	12-8-1.2	F	HENRY AND NANCY GARNER	55	394
10*31435	12-7-13.1	G	HENRY AND NANCY GARNER	55	394
10*31435	12-3-26.1	H	HENRY AND NANCY GARNER	55	394
10*31435	12-3-27	I	HENRY AND NANCY GARNER	55	394
10*31435	12-3-46	J	HENRY AND NANCY GARNER	55	394
10*21035	12-2-23	K	THOMAS E GARNER AND BILLIE J GARNER, ET AL	200A	385
10*21643	12-2-23	K	LARRY D GARNER	200A	393
10*31435	12-2-23	K	HENRY AND NANCY GARNER	55	394
10*22229	12-3-13	L	MURIEL A MILLER, ET AL	204A	150
10*21681	12-2-19	M	DOROTHY J HAAS, ET AL	214A	358
**FORCE					
POOL**	12-2-22.1	N	THOMAS E GARNER, ET AL	166A	436
10*39463	12-3-4.7	O	J P COOPER ET AL	56	245
10*40304	12-2-13	P	DANIEL T BOOTH, ET AL	292A	309
				927	639
10*18205	12-2-14	Q	MELISSA PAINTER AND SHAUN PAINTER, ET AL	205A	891
				927	639
10*18205	12-2-14.2	R	MELISSA PAINTER AND SHAUN PAINTER, ET AL	205A	891
10*22494	5-25-11.4	S	EDWARD W KLUG & DIANNA KLUG JTWROS	920	109
				1063	605
10*27897	12-2-14.1	T	CAROL VASS, ET AL	232A	346
10*39461	12-2-14.3	U	JAMES M PARSONS	73	195
10*19727	5-25-14.1	V	S RICHARD MELLON, ET AL	944	465
				927	639
10*18205	5-25-16.1	W	MELISSA PAINTER AND SHAUN PAINTER, ET AL	205A	891
				927	639
10*18205	5-25-15	X	MELISSA PAINTER AND SHAUN PAINTER, ET AL	205A	891
				927	639
10*18205	5-25-16.2	Y	MELISSA PAINTER AND SHAUN PAINTER, ET AL	205A	891
				927	639
10*18205	5-25-16	Z	MELISSA PAINTER AND SHAUN PAINTER, ET AL	205A	891
10*31441	5-26-12	AA	JASON AND S M PARSONS	59	3
10*14786	5-25-17	BB	TWILA O WHIPKEY, ET AL	799	61
10*14786	5-25-20	CC	TWILA O WHIPKEY, ET AL	799	61
10*14786	5-25-18	DD	TWILA O WHIPKEY, ET AL	799	61
10*14786	5-25-19	EE	TWILA O WHIPKEY, ET AL	799	61
10*14786	5-25-18.1	FF	TWILA O WHIPKEY, ET AL	799	61
10*14786	5-26-11	GG	TWILA O WHIPKEY, ET AL	799	61
10*14786	5-23-11.3	HH	TWILA O WHIPKEY, ET AL	799	61
10*14786	5-23-11.5	II	TWILA O WHIPKEY, ET AL	799	61
10*14786	5-23-11.8	JJ	TWILA O WHIPKEY, ET AL	799	61
10*14786	5-23-13.1	KK	TWILA O WHIPKEY, ET AL	799	61
10*14969	5-23-12	LL	REBECCA S WORD, ET AL	872	219
10*14786	5-23-13	MM	TWILA O WHIPKEY, ET AL	799	61
10*14786	5-23-11.4	NN	TWILA O WHIPKEY, ET AL	799	61
10*14786	5-23-11.1	OO	TWILA O WHIPKEY, ET AL	799	61

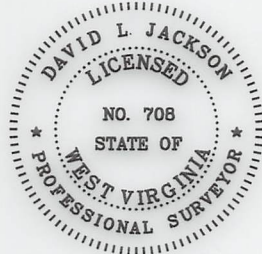

P.S.  
708

*David L Jackson*

12/13/2024



OPERATOR'S  
WELL #: ELMER N-15HU  
DISTRICT: Proctor  
COUNTY: Wetzel  
STATE: WV  
API #: 47-103-03536

WELL PLAT  
PAGE 4 OF 4  
DATE: 11/20/2023